



Sheffield LABS W24QA LED Table Lamp User Manual

[Home](#) » [Sheffield LABS](#) » Sheffield LABS W24QA LED Table Lamp User Manual 

Sheffield[™]
LABS

User Manual



Contents

- [1 PLEASE READ BEFORE USING](#)
- [2 LED table lamp](#)
- [3 INSTRUCTIONS](#)
- [4 PRODUCT SPECIFICATIONS](#)
- [5 PRODUCT MAINTENANCE](#)
- [6 Documents / Resources](#)
- [7 Related Posts](#)

PLEASE READ BEFORE USING

If you find that you have any trouble or missing or damaged parts please contact us.

If you need installation assistance, replacement parts, or have questions regarding our warranty, please contact our product consultants at customersupport@enchlites.com or call toll-free:

1-800-936-3213

Monday to Friday from 9:00 a.m. to 5:00 p.m., EST. English and Spanish spoke.
International Regions: Please contact your local distributor.

WARRANTY

Sheffield Labs products are manufactured under the highest quality and workmanship standards. Sheffield Labs guarantees the original buyer that this product will be free of fabrication, material, and finish defects for one year period starting at the purchase date. Sheffield Labs recommends professional installation for this product.

Should this product present any leaks derived from a fabrication or material defect during the warranty period, Sheffield Labs will supply the necessary replacement parts free of charge. Sheffield Labs will also replace any pieces presenting defects in finish or fabrication. This warranty is only valid under normal installation, use, and service conditions.

This warranty does not apply to any damage caused by normal wearing of the product, incorrect installation or operation, alterations or modifications performed by parties not authorized by Sheffield Labs, or the use of replacement parts of any brand other than Sheffield Labs. This warranty also excludes damages caused by the use of abrasive cleaners, containing alcohol or other organic solvents; whether the damage was caused by the consumer or third parties. Sheffield Labs will not be responsible for workmanship expenses, damages incurred during the installation, repair, or replacement, or for any direct, indirect, consequential damage or losses related to this product. This warranty is Sheffield Lab's sole responsibility, leaving no further right or actions to the original buyer or third parties and liberating Enchante Lites New York and any other subsidiaries, affiliates, shareholders, distributors, retailers, representatives, agents, and employees of these or any other responsibility for visible or hidden defects or damages of any kind.

The purchase, use, and ownership of this product imply acceptance on behalf of the original buyer of the terms and conditions of this warranty.

In order for the original buyer to make this warranty valid, any claim must be accompanied by an original purchase ticket. To make this warranty valid write Sheffield Labs to the email below with the subject: "Sheffield Labs Warranty". Explain the kind of defect and include the purchased ticket original, your full name and address, and phone number. Should the claim be compliant with warranty limitations, all necessary replacement parts will be mailed at no cost to the customer.

customersupport@enchlites.com

1-800-936-3213

Monday to Friday from 9:00 am to 5:00 pm

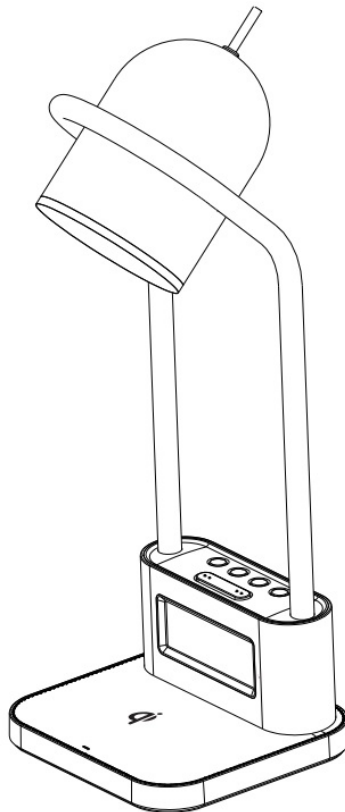



LED table lamp

Thank you for purchasing a Sheffield Labs product. All Sheffield Labs products are carefully engineered and factory tested for durability under normal conditions. We develop our products for simple installation. Follow our instructions to help you easily install your Sheffield Labs LED desk lamp.

USER MANUAL

SAVE THESE INSTRUCTIONS AND READ CAREFULLY BEFORE USE

For Customer Care, production operation information, or problem resolution, call toll-free at 1.800-936-3213



WARNING: TO PREVENT ELECTRIC SHOCK, MAKE SURE THE LAMP IS NOT PLUGGED IN UNTIL ALL STEPS ARE COMPLETE.



WARNING: PERSONS TURN THE LAMP DURING HANDLING.

- The LED lamp head (A) might get hot after several hours of continuous use. DO NOT place your hands directly on an LED light panel.
- Never use an extension cord unless the plug can be fully inserted into the receptacles in the extension cord.
- Do not alter the plug.
- The lamp head included with this unit cannot be replaced by the consumer.
- Do not place flammable material near or over the lamp.
- Ensure the lamp is not installed next to any air vents and is not in any moist or damp areas.
- INDOOR USE ONLY

NOTE: The important safety instructions appearing in this manual are not meant to cover all possible conditions and situations that may occur. It must be understood that common sense, caution, and care must be used with any electrical product.

CAUTION: Any change or modification to this product not expressly recognized by Enchants Living voids Enchants' responsibility for the proper function of the product. This product contains a button battery. If swallowed, it could cause severe injury or death. Seek medical attention immediately.

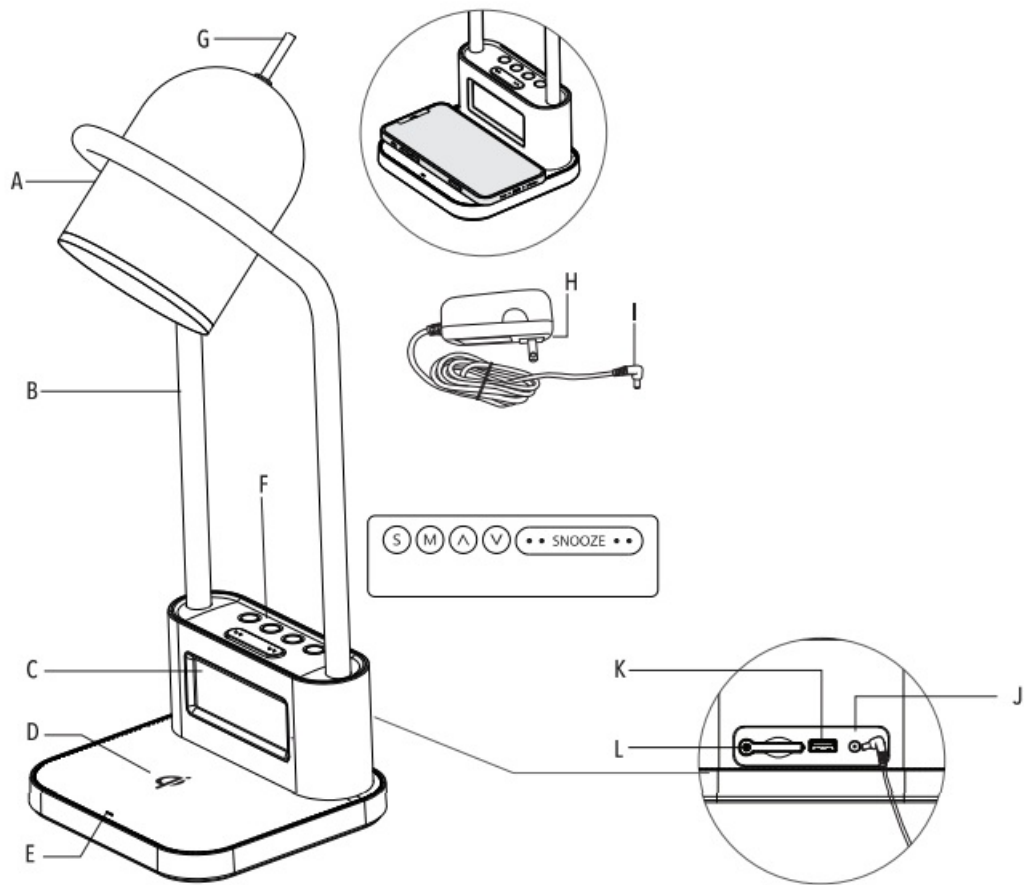

A	Lamp Head
B	Lamp Body
C	Alarm Display
D	Wireless Charging Pad
E	Wireless Charging Indicator
F	Function Key Panel
G	Touch Sensor
H	Power Adaptor
I	Power Connector
i	Power Adapter Input
K	USB-A Charging Port
L	battery compartment

INSTRUCTIONS

NOTE: THIS UNIT IS FULLY ASSEMBLED

1. Remove the lamp from the packing, placing the lamp base flat on a steady surface.
2. Connect power connector (I) into power adapter input (J) at the rear bottom of the lamp.
3. Plug the power adapter (H) into a standard household 120V AC outlet.

• **NOTE:** Only use the supplied power adapter to avoid damage or risk of fire.

4. Once plugged in, tap the touch sensing control switch (G) to power on the lamp head. The default brightness setting is low. Short taps allow you to toggle through the brightness levels (low, medium, high) and power the lamp head off.
5. To change the color temperature of the light, simply hold your finger down on the touch sensor (G) for 3 seconds at any point when the light is on. The default setting is cool white. To change, simply lift your finger and repeat until you reach your desired color temperature. (cool white, natural daylight, warm white).
6. Clock display and alarm functions.

Set time: To set the time, press the “S” button and the hour will begin to blink. Use the “A” and ‘v’ buttons to adjust. Click “S” again to adjust the minutes, and again to set. The display will stop blinking once complete. Please note that the display will exit the “set” mode if left untouched for over 30 seconds.

2/24h time modes:

To toggle between 12 (am/pm) and 24-hour time modes on the display, simply click the ‘A’ arrow at any time when not in ‘set’ mode.

Set alarm: This display features a dual alarm clock which allows for two independent alarms to be set.

Alarm 1: Press the “M” button to enter alarm set mode, and the bell icon “V” should appear on the display. Once it does, press the “S” button to set the alarm time using the arrow keys to adjust and toggle through hours and minutes by clicking “S”. Once the hour and minutes for the alarm are set, the display will switch to snooze setting. This allows you to set how long the alarm is silenced for when snooze is pressed. Using the arrow keys, you can set the snooze function from 5 to 30 minutes in intervals of 5. Once the desired snooze length is selected, press “5” one final time, and your alarm is set.

Alarm 2: Follow the same steps as setting alarm 1, but instead of pressing “M” once from the main display, press it twice before clicking ‘5’ to set the alarm time. The bell icon “2” will appear indicating this is the alarm you are now setting. To turn either alarm off entirely, hold down the SNOOZE button for three seconds from the main dock display, and the corresponding icons will appear on the screen indicating which alarm is on or off. The first long hold will turn alarm 1 on, a second hold will turn alarm 2 on, a third hold will turn both alarms on, and a fourth will turn both off.

Display Brightness:

The LCD display brightness can be adjusted or turned off entirely. To do so, simply click the SNOOZE button at any time when not in “set” mode. The default display setting is high and can be toggled through medium-low-off with each consecutive click.

7. Charging Functions.

Wirelessly charge your device on the Qi wireless charging pad (D) and a red indicator light on top of the base will indicate charging. If the red indicator light begins to flash, your device may not be centered on the charger. Once the indicator light turns green, charging is complete.

8. Battery Replacement

This lamp uses a CR2032 button/cell battery as a memory backup for the clock display. The battery compartment (L) is located on the back of the lamp. To remove/replace the battery, use a screwdriver to unlock the compartment (L) and slide it out.

PLEASE NOTE: Battery disposal should be in compliance with local regulations pertaining to the disposal of hazardous materials.

DO NOT INCINERATE
USB-A Charging

This lamp contains a 7.5V, 2.1A USB-A port (K) located at the rear of the lamp towards the base. USB ports can charge items such as tablets, cellular phones, etc. Simply insert the appropriate charging cable into the port (K) when plugged in to begin charging you twice. This lamp can charge two devices simultaneously using the wireless pad (D) and wired rear port (K).



Qi Certified Wireless Charging Technology



The "Qi" symbol is a trademark of the Wireless Power Consortium. All mobile devices with integrated wireless charging support "Qi".

an ENCHANTE brand

2021-2022 ENCHANTE ACCESSORIES, INC

NAG, JV, LIC | ENCHANTS LITES LLC

NEW YORK, NY 10001

Market: USA Brand: N/A Model #: W24QA Product: an LED table lamp Art Size: 100% Dims: 11" x 8.5" (27.94cm x 21.59cm)	File Name: 11439QJNLArtwor109MAY22 .pdf Date: 19MAY22	Printing: Non-coated, Double sided print (front and back)	Any alterations must be approved by the packaging department of Enchante Living. If revisions are made without the express permission of the packaging design dept, the responsible supplier will be charged back.
	Printing:  CMYK: 1 Color Process (1 C)	Non-Print DIE-LINE FOLD-LINE	

NOTE:

There will be a total of 3 sheets printed front and back. Once the pages are printed and folded in half, Please staple the pages on the folded crease, forming an 12 page booklet.

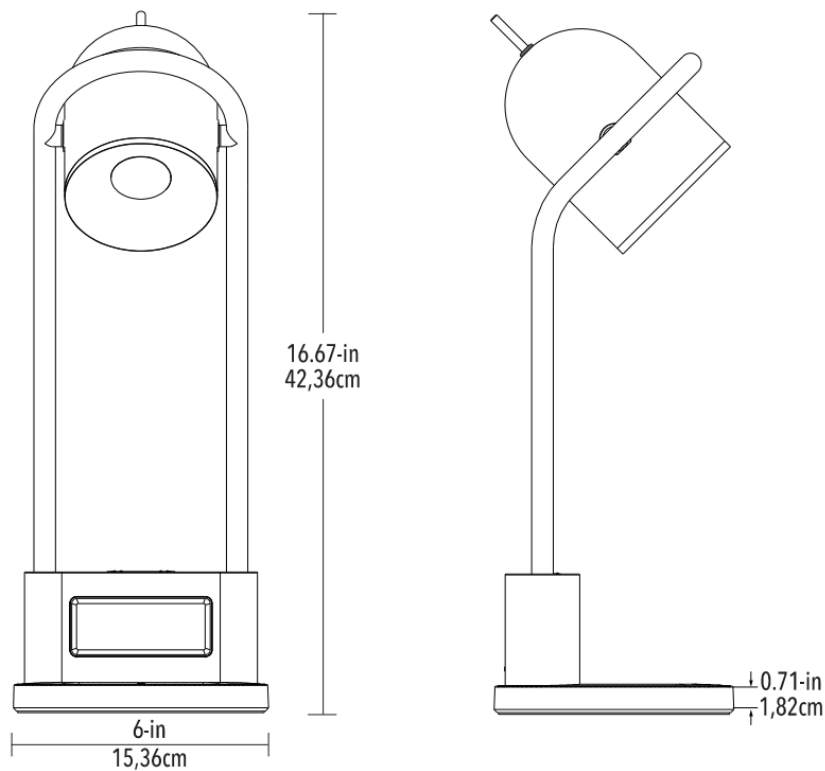

PRODUCT SPECIFICATIONS

Lumens:	180-230 LM
Total Wattage:	27 W
Power Adaptor:	12 V /2.5 A
Wireless Charger Output:	5 W
Color Temperature:	5500K±500I 4200K±400K I 3000K±280K
11513-A Port Output:	5V/2.1A

PRODUCT MAINTENANCE

1. Always ensure the power is OFF and the lamp has cooled down before performing any maintenance, cleaning, or adjustments.
2. To avoid injury or damage to the lamp, ensure that the adapter and any screws are secure before reconnecting to power.
3. To clean, wipe with a damp or dry clean cloth. Never soak the lamp with water.

FCC PART 15

Note: This equipment has been tested and found to comply with the limits for Class B digital devices, pursuant to Part 15 of the FCC rules. These limits are designed to provide reasonable protection against harmful interference in a residential installation. This equipment generates, uses, and can radiate radio frequency energy and, if not installed and used in accordance with the instructions, may cause harmful interference to radio communications. However, there is no guarantee that the interference will not occur in a particular installation. If this equipment does cause harmful interference to radio or television reception, which can be determined by turning the equipment off and on, the user is encouraged to try to correct the interference by one or more of the following measures:

- Reorient or relocate the receiving antenna.
- Increase the separation between the equipment and receiver.
- Connect the equipment into an outlet on a circuit different from that to which the receiver is connected.
- Consult the dealer or an experienced radio/Mednician for help.

Changes or modifications not expressly approved by the party responsible for compliance could void the user’s authority to operate the equipment. This device complies with Pan 15 of the FCC Rules. Operation is subject to the following two conditions:

1. this device may not cause harmful interference, and
2. this device must accept any interference received, including interference that may cause undesired operation.

This equipment complies With FCC radiation exposure Imita Set fonts (cc an uncontrolled environment. The equipment should be Metalled and operated with a minimum distance of 20cm between the radiator 8 your body.

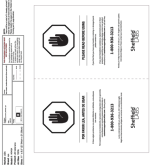

Documents / Resources

	<div> Sheffield LABS W24QA LED Table Lamp [pdf] User Manual </div> <div> W24QA, 2AQRG-W24QA, 2AQRGW24QA, W24QA LED Table Lamp, LED Table Lamp </div>
---	--