

Sheffield LABS W22Q10 LED Table Lamp User Manual

[Home](#) » [Sheffield LABS](#) » Sheffield LABS W22Q10 LED Table Lamp User Manual 

Contents

- [1 Sheffield LABS W22Q10 LED Table Lamp](#)
- [2 PLEASE READ BEFORE USING](#)
- [3 IMPORTANT SAFETY INSTRUCTIONS](#)
- [4 INSTRUCTIONS](#)
- [5 FCC PART 15](#)
- [6 PRODUCT OVERVIEW](#)
- [7 PRODUCT DIMENSIONS](#)
- [8 PRODUCT SPECIFICATIONS](#)
- [9 PRODUCT MAINTENANCE](#)
- [10 WARRANTY](#)
- [11 Documents / Resources](#)
- [12 Related Posts](#)

Sheffield[™]
LABS

Sheffield LABS W22Q10 LED Table Lamp

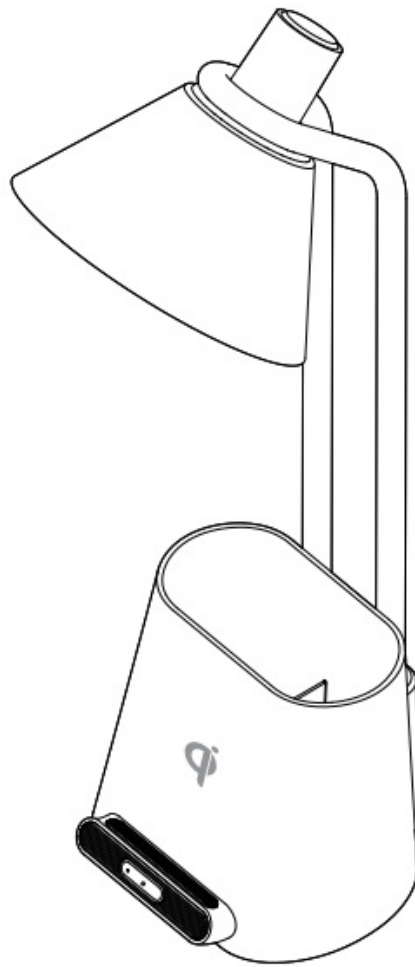

PLEASE READ BEFORE USING

- If you find that you have any trouble or missing or damaged ports please contact us.
- If you need installation assistance, replacement parts or have questions regarding our warranty, please contact our product consultants at customersupport@enchlites.com or call toll free: 1-800-936-3213 Monday to Friday from 9:00 a.m. to 5:00 p.m., EST. English and Spanish spoken. International Regions: Please contact your local distributor.

Thank you for purchasing a Sheffield Labs product. All Sheffield Labs products are carefully engineered and factory tested for durability under normal conditions. We develop our products for simple installation. Follow our instructions to help you easily install your Sheffield Labs LED desk lamp.

SAVE THESE INSTRUCTIONS AND READ CAREFULLY BEFORE USE

For Customer Care, production operation information or problem resolution, call toll free 1-800-936-3213

IMPORTANT SAFETY INSTRUCTIONS

A WARNING: TO REDUCE THE RISK OF FIRE, ELECTRIC SHOCK, OR INJURY TO PERSONS TURN THE LAMP OFF AND WAIT UNTIL LAMP AND ADAPTER ARE COOL BEFORE

A WARNING: TO PREVENT ELECTRIC SHOCK, MAKE SURE THE LAMP IS NOT PLUGGED IN UNTIL ALL STEPS ARE COMPLETE. HANDLING

- The LED lamp head (A) might get hot after several hours of continuous use. DO NOT place your hands directly on LED light panel
- Never use with an extension cord unless the plug can be fully inserted into the receptacles in the extension cord.

- Do not alter the plug.
- The lamp head included with this unit cannot be replaced by the consumer.
- Do not place flammable material near or over the lamp.
- Ensure the lamp is not installed next to any air vents and is not in any moist or damp areas.
- INDOOR USE ONLY

NOTE: The important safety instructions appearing in this manual are not meant to cover all possible conditions and situations that may occur. It must be understood that common sense, caution, and care must be used with any electrical product.

CAUTION: Any change or modification to this product not expressly recognized by Enchanté Living voids Enchanté's responsibility for proper function of product.

INSTRUCTIONS

NOTE: THIS UNIT IS FULLY ASSEMBLED

1. Remove lamp from packing, placing lamp base flat on a steady surface.
2. Connect power connector (6) into power adapter input (H) at the rear-bottom of the lamp.
3. Plug the power adapter (F) into a standard household 120V AC outlet.

NOTE: Only use with the supplied power adapter to avoid damage or risk of fire.

4. Tap the touch sensor (E) to power on the light. The lamp will default to the lowest brightness setting. Quick taps will toggle through all three brightness levels and a fourth tap will power the light off.

5. Wireless Charging:

Center your device on the Qi wireless charging pad (C) and a red indicator light next to the touch sensor (E) will

indicate charging. If the red indicator light begins to flash, your device may not be centered on the charger.

Once

the indicator light turns green, charging is complete.

The 'O' symbol is a trademark of the Wireless Power Consortium. AW mobile devices with integrated wireless charging support "O".

FCC PART 15

Note: This equipment has been tested and found to comply with the limits for a Class B digital device, pursuant to Part 15 of the FCC rules. These limits are designed to provide reasonable protection against harmful interference in a residential installation. This equipment generates, uses and can radiate radio frequency energy and, if not installed and used in accordance with the instructions, may cause harmful interference to radio communications. However, there is no guarantee that the interference will not occur in a particular installation. If this equipment does cause harmful interference to radio or television reception, which can be determined by turning the equipment off and on, the user is encouraged to try to correct the interference by one or more of the following measures:

- Reorient or relocate the receiving antenna
- Increase the separation between the equipment and receiver.
- Connect the equipment into an outlet on a circuit different from that to which the receiver is connected.
- Consult the dealer or an experienced radio/TV technician for help.

- Changes or modifications not expressly approved by the party responsible for compliance could void the user's authority to operate the equipment. This device complies with Part 15 of the FCC Rules. Operation is subject to the following two conditions:
 - this device may not cause harmful interference, and
 - this device must accept any interference received, including interference that may cause undesired operation
- This equipment complies with FCC radiation exposure limits set forth for an uncontrolled environment. This equipment should be installed and operated with minimum distance 20cm between the radiator & your body.

PRODUCT OVERVIEW

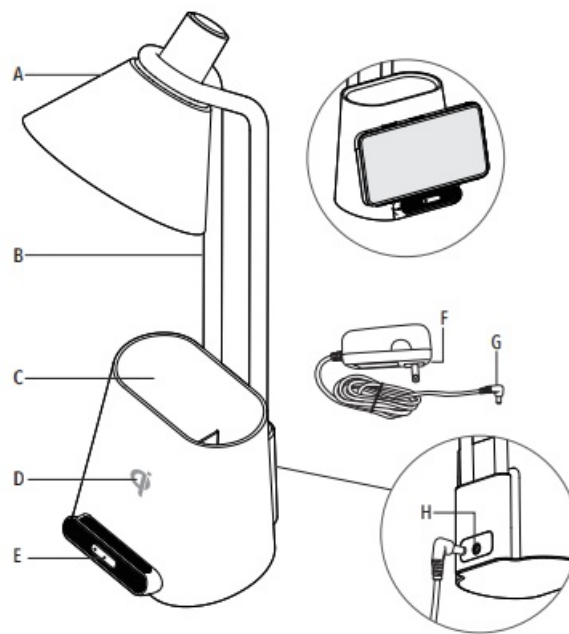

- A: LED Lamp Head
- B: Lamp Body
- C: Storage Compartment
- D: Wireless Charging Pad
- E: Touch Sensor
- F: Power Adaptor
- G: Power Connector
- H: Power Adapter Input

PRODUCT DIMENSIONS

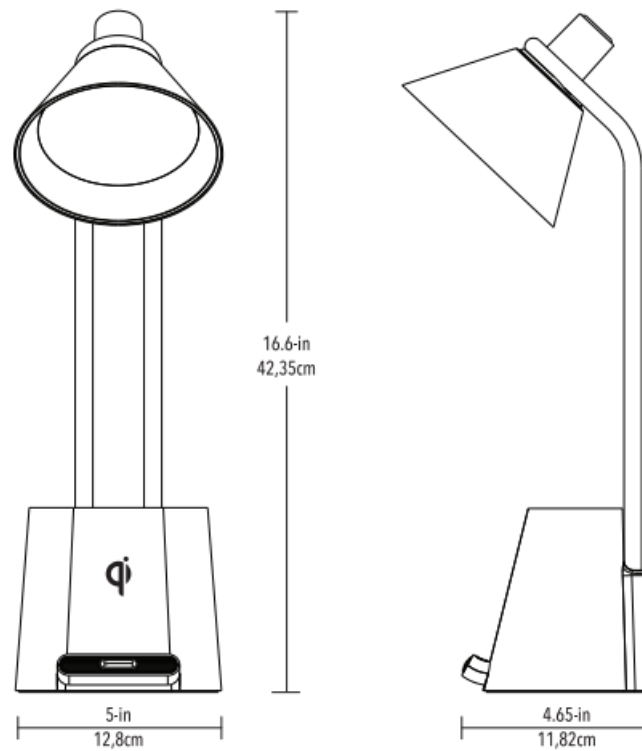

PRODUCT SPECIFICATIONS

Lumens:	250-350LM
Total Wattage:	24W
Power Adaptor:	12V / 2A
Wireless Charger Output:	10 W
Color Temperature:	4200±400K

PRODUCT MAINTENANCE

1. Always ensure the power is OFF and the lamp has cooled down before performing any maintenance, cleaning or adjustments.
2. To avoid injury or damage to the lamp, ensure that the adapter and any screws are secure before reconnecting to power.
3. To clean, wipe with a damp or dry clean cloth. Never soak the lamp with water.

WARRANTY

- Sheffield Labs products are manufactured under the highest quality and workmanship standards. Sheffield Labs guarantees the original buyer that this product will be free of Taorication, material and finish defects tor one year period starting at the purchase date. Sheffield Labs recommends professional installation for this product.
- Should this product present any leaks derived from a fabrication or material defect during the warranty period, Shemeld Labs will Supply the necessary replacement parts Tree or charge. Sheffield Labs will also replace any pieces presenting defects in finish or fabrication. This warranty is only valid under normal installation, use and service conditions.

- This warranty does not apply to any damage caused by normal wearing of the product, incorrect installation or operation, alterations or modifications performed by parties not authorized by Sheffield Labs, or the use of replacement parts any brand other than Sheffield Labs. The warranty also excludes damages caused by the use of abrasive cleaners, containing alcohol or other organic solvents; whether the damage was caused by the consumer or third parties. Sheffield Labs will not be responsible for workmanship expenses, damages incurred during the installation, repair or replacement, or for any direct, indirect, consequential damage or losses related to this product. This warranty being Sheffield Lab's sole responsibility, leaving no further right of actions to the original buyer, third parties and liberating Enchante Lites New York and any other subsidiaries, affiliates, shareholders, distributors, retailers, representatives, agents and employees of these or any other responsibility for visible or hidden defects or damages of any kind.
- The purchase, use, and ownership of this product imply acceptance on behalf of the original buyer of the terms and conditions of this warranty.
- In order for the original buyer to make this warranty valid, any claim must be accompanied by an original purchase ticket. To make this warranty valid write Sheffield Labs to the email below with the subject: "Sheffield Labs warranty". Explain the kind of defect and include the purchased ticket (original), your full name and address, and phone number. Should the claim be compliant with warranty limitations, all necessary replacement parts will be mailed at no cost to the customer.

customersupport@enchlites.com 1-800-936-3213 Monday to Friday from 9:00 am to 5:00 pm

Documents / Resources

	<p>Sheffield LABS W22Q10 LED Table Lamp [pdf] User Manual W22Q10, 2AQRG-W22Q10, 2AQRGW22Q10, LED Table Lamp, W22Q10 LED Table Lamp</p>
---	--