



Sharper Image Shiatsu Foot Massager 205087 User Manual

[Home](#) » [Sharper Image](#) » Sharper Image Shiatsu Foot Massager 205087 User Manual 

Item No. 205087



USER'S MANUAL

Note: Your item may vary in appearance from the picture above.

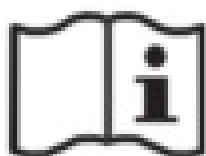
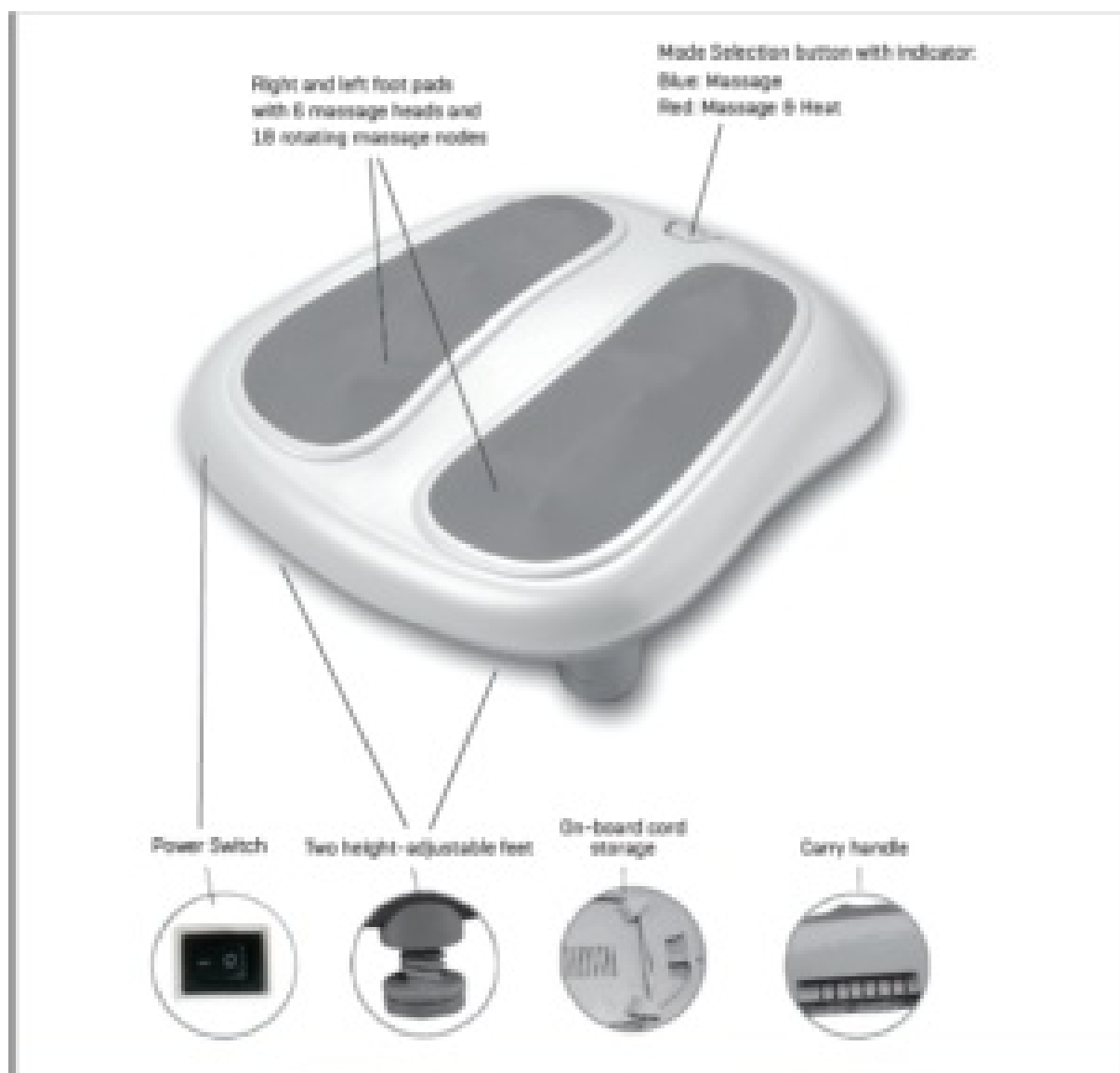

IMPORTANT INFORMATION! RETAIN FOR FUTURE USE!

Read the instruction manual carefully before using this device, especially the safety instructions, and keep the instruction manual for future use. Should you give this device to another person, it is vital that you also pass on these instructions for use.

EXPLANATION OF SYMBOLS

This instruction manual belongs to this device. It contains important information about starting up and operation. Read the instruction manual thoroughly. Non-observance of these instructions can result in serious injury or damage to the device.



WARNING

These warning notes must be observed to prevent any injury to the user.



CAUTION

These notes must be observed to prevent any damage to the device.



NOTE

These notes give you useful additional information on the installation or operation.



SAFETY INFORMATION

- Before connecting the device to the power supply, please ensure that the supply voltage stated on the rating plate is compatible with your main supply.
- Only use this unit according to the intended purpose as stated in the instructions. The device is not intended for commercial use.
- Never use the unit outdoors. Dry location use only.
- Do not sit or stand on the unit; it is not designed to support your full body weight.
- Never cover up the ventilation holes on the bottom of the device.
- Do not put any foreign objects into any of the openings. Avoid contact with pointed or sharp objects. The warranty is null and void if it is not used for the intended purpose.
- This device is not designed to be used by persons (including children) with limited physical, sensory or mental abilities, or by persons with insufficient experience and/or knowledge,

unless under observation by a person responsible for their safety, or unless instructed in the use of the device.

- Children must be supervised to ensure that they do not play with the device
- The device is fitted with a heat function and has hot surfaces. Persons who are sensitive to heat must be careful when using the device.
- Do not attempt to repair the unit yourself in the event of any defects. Not only does this render the warranty null and void but you can also run the risk of serious hazards (fire, electric shock, injury). Only have repairs carried out by authorized service points.
- Do not reach for the unit if it has fallen into water. First, immediately disconnect the main plug.
- Do not use any electrical equipment while in the bath or shower. Do not store or keep any electrical equipment in places where it could fall into the bathtub or washbasin.
- Do not use the unit under the bedclothes or under cushions.
- Keep the main cable away from hot surfaces.
- Never use the unit if the power cable has been damaged, if the unit does not work perfectly, if it has fallen into water or has been damaged.
- Never carry, pull or rotate the unit by the main cable or pinch the cable between objects.
- Do not allow the unit to become overheated due to excessively long use.
- Only pull the plug out of the socket when you have dry hands.
- If you are pregnant, suffer from diabetes or have a pacemaker, contact your doctor before using the unit.
- You should also contact your doctor before initial use of the unit, should you have any reservations about your personal tolerance to treatment or have any health-related questions.
- If you experience pains in the muscles and joints that persist after a long period of time, please inform your doctor. Persistent pains can be symptomatic of serious illness.
- Should you experience pain or discomfort during treatment, stop treatment immediately.
- If you experience unexplained pain or swelling in the legs or feet, or suffer from a muscle injury, you should consult your doctor before using the unit. Stop using the massage if you experience pain during or swelling after treatment.

OPERATING

Adjusting the height

You can adjust the height of the unit to your own particular requirements by turning the two adjustable feet on the underside of the unit. There are 3 height levels. Each adjustable foot will “click” in place when reaching one of the three levels. (Be sure that the appliance is switched off and disconnected from the AC outlet before adjusting the height).

Switching on and operating the appliance

Place the Shiatsu Foot Massager on the floor in front of a comfortable chair and plug it into an AC outlet. Sit down in a comfortable position.

1. Power on the unit by turning on the Power switch.
2. Press Mode selection button to select massage mode and start foot massage, the indicator will light blue. Carefully put your feet on the foot pads.
3. Press the Mode selection button again to activate the heat function if you like, the indicator will light red.

4. Press the Mode selection button a third time to stop using the unit.
5. Turn off the Power switch to switch off the appliance completely and unplug the appliance from the wall outlet after use.

Duration of massage treatment

In general, you can allow approximately 10 to 15 minutes operation for each massage session, one to two times a day. Make sure the appliance is cooled down completely before using it again!

• MISCELLANEOUS

Cleaning and maintenance

- Before cleaning the unit, make sure it's switched off and disconnected from the AC outlet.
- Use only a soft, damp washcloth to clean the surface of the unit. Only do so once the unit has cooled down completely.
- Do not use any strong detergents for cleaning, e.g. scouring cream or other cleansing agents, as they may damage the surface of the unit.
- Store the unit in a cool, dry place.
- Use only a soft, damp washcloth to clean the surface of the unit. Only do so once the unit has cooled down completely.

Disposal

This product should not be disposed of together with domestic waste. Please hand in all electrical or electronic devices at a municipal or commercial collection point so that they can be disposed of in an environmentally acceptable manner. Consult your municipal authority for information about disposal.

TECHNICAL SPECIFICATIONS

Name and model: Shiatsu Foot Massager

Power supply: 120V 60Hz

Power consumption: 30W

Dimensions: (L x W x H): 40.5 x 36.5 x 12 cm

Approximate weight: 7.3 lbs.

WARRANTY/CUSTOMER SERVICE

Sharper Image branded items purchased from SharperImage.com include a 1-year limited replacement warranty. If you have any questions not covered in this guide, please call our Customer Service department at 1 (877) 210-3449. Customer Service agents are available Monday through Friday, 9:00 a.m. to 6:00 p.m. ET.

Shiatsu Foot Massager [Manual Original](#)

Shiatsu Foot Massager [Manual Optimized](#)