



# Sharper Image Pocket Video Drone 207160 User Manual

[Home](#) » [Sharper Image](#) » Sharper Image Pocket Video Drone 207160 User Manual 

## Contents

### 1 SHARPER IMAGE®

#### 1.1 POCKET VIDEO DRONEItem No. 207160

### 2 Related Posts

**SHARPER IMAGE®**

**POCKET VIDEO DRONE**  
Item No. 207160



Thank you for purchasing the Sharper Image Pocket Video Drone. Please read this guide and store it for future reference.

## INSTALLATION OF FAN BLADES

The fan blades should be installed correctly. A corresponds with A, B corresponds with B, etc. Press down the fan

blades so that they connect to the motor shaft.

### FOLDING/UNFOLDING ARMS

Fold the front arms near the camera first, then fold the back arms. Do the exact opposite when unfolding.



### LITHIUM-ION BATTERY

Remove the battery from the battery holder and disconnect it from the power socket. Next, connect the USB-plug charger to your computer's USB port, then connect it to the charging socket on your drone. When charging, the LED will light up; when fully charged the LED light will be off. Charging time is about 60 minutes.

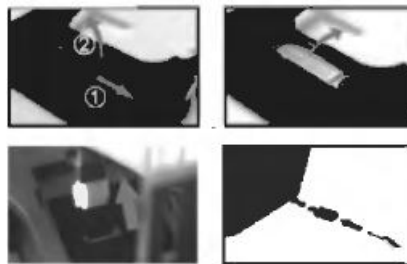

### LITHIUM-ION BATTERY WARNINGS

- There are certain risks involved when using lithium batteries. They may cause fire, bodily injury, and/or property damage. Users must be aware of the risks that come with using this product. Manufacturers, retailers and dealers bear no responsibility in regard to accidents
- If battery leakage occurs, please avoid contact with your eyes and/or skin. If contact occurs, please flush your eyes with clean water and seek medical care immediately
- Please remove the plug immediately if you sense any peculiar smells

### BATTERY CHARGING

- Please use only the charger included with this device
- Do not overcharge the battery. Please pull out the charger once the device is fully charged
- Do not charge the battery next to open flames or on the surface of electro-conductive objects. When charging, observe the battery at all times
- Do not charge the battery if it hasn't cooled down
- Charging temperature should be between 32°F-104°F

### RECYCLING

- Do not dispose of this product or its battery with normal household waste
- Please dispose of this product and its battery in accordance with local laws

### APP INSTRUCTIONS

WI-FI

1. Use your phone to scan the QR code. Download and install the control software "WiFi UFO"

**NOTE:** Android, Google Play, and IOS are all supported.



2. Turn on your drone and the lights will flash. Next, turn on your mobile phone and connect to Wi-Fi (WIFI UFO-1111###), as shown in Figure 2.



FIGURE 2



FIGURE 3



FIGURE 4



FIGURE 5



FIGURE 6

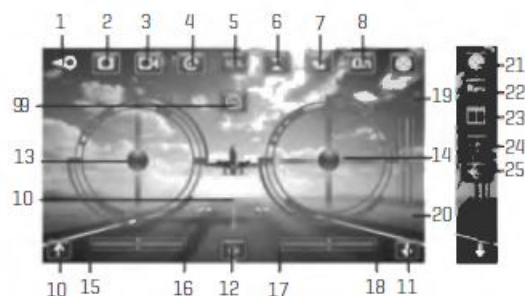

FIGURE 7

3. Open the App and enter the main interface as shown in Figure 3. Click “Play” in the manipulation interface, as shown in Figure 4. Click to enter the ordinary control interface, as shown in Figure 5. The Altitude Hold Key becomes yellow. Next, enter the Altitude Hold interface as shown in Figure 6. Click for more settings, as shown in Figure 7.

4. When the video links successfully, you can view the images that the Wi-Fi camera transmits through your mobile phone’s screen.

## APP INTERFACE DESCRIPTION



1. Return
2. Photo
3. Video
4. Document (Album/Video)
5. Speed Control: 30%, 60%, 100%
6. Altitude Hold
7. Gravity Induction
8. Show/Hide Steering Wheel
9. 360° Flips/Rolls
10. One-Key Takeoff
11. One-Key Landing
12. Emergency Stop
13. Left Joystick (Throttle)
14. Right Joystick (Rudder)
15. Left Rotation Fine-Tuning
16. Right Rotation Fine-Tuning
17. Left Side Flight Fine-Tuning

- 18. Right Side Flight Fine-Tuning
- 19. Forward Fine-Tuning
- 20. Backward Fine-Tuning
- 21. More Settings
- 22. Camera Reverse
- 23. 3D Display
- 24. Headless Mode
- 25. One-Key Calibration

## ACCELEROMETER MODE

- Click into Accelerometer Mode, then move the phone in any direction for remote control (Figure 1)

## SELFIE MODE

- In Altitude Hold Mode, you can control the drone and make the camera view itself. Click the camera button on the screen to take selfies (Figure 2)

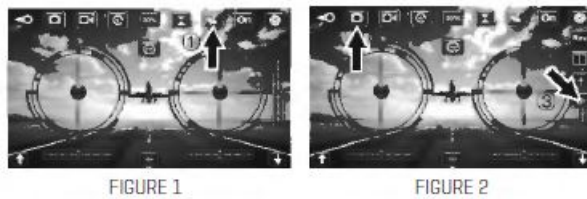

## ONE-KEY CALIBRATION

- This function is only allowed when the drone is on the ground

## UNLOCKING YOUR DRONE

Unlock the drone prior to flight. Click the Altitude Hold icon shown in Figure 1, then click on the area in Figure 2 to unlock.



## OPERATING YOUR DRONE



**NOTE:** After flight, please disconnect the battery plug from the power connection.

1. Connect the power plug of your drone with the lithium-ion battery socket as shown in the figure above. Place your drone on a level surface (do not move it when the indicator light is flashing).
2. Place the drone in an open space. Before flight, make sure that the rear part of your drone is pointing directly at you.



Push up on the Left Joystick (Throttle).

The rotating speed of the blades will increase and the drone will ascend.

Push down on the Left Joystick (Throttle).

The rotating speed of the blades will decrease and the drone will descend.

Push the Left Joystick (Throttle) to the left (the drone will turn left).

Push the Left Joystick (Throttle) to the right (the drone will turn right).

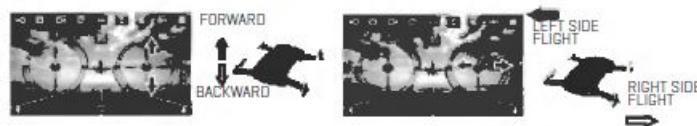

Push up on the Right Joystick (Rudder).

The drone will fly forward.

Push down on the Right Joystick (Rudder).

The drone will fly backward.

Push the Right Joystick (Rudder) to the right (the drone will turn right).

Push the Right Joystick (Rudder) to the left (the drone will turn left).



If the drone revolves to the left while hovering, press the Right Rotation Fine-Tuning key continuously until it is back to normal.

If the drone revolves to the right while hovering, press the Left Rotation Fine-Tuning key continuously until it is back to normal.



If the drone flies to the left while hovering, press the Right Side Flight Fine-Tuning key continuously until it is back to normal.

If the drone flies to the right while hovering, press the Left Side Flight Fine-Tuning key continuously until it is back to normal.

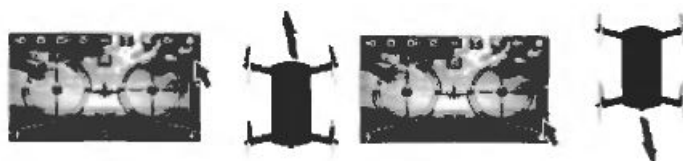

If the drone flies backwards while hovering, press the Forward Fine-Tuning key continuously until it is back to normal.

If the drone flies forward while hovering, press the Backward Fine-Tuning key continuously until it is back to normal.

**NOTE:** When the drone is roughly 11 inches from the ground, it will become unstable due to a blade vortex. This is called the “Ground Effect.” The lighter the drone is, the greater this effect will be.

### PRE-FLIGHT ENVIRONMENT

1. When flying indoors, select a wide-open space free of barriers, pets, and people.
2. When flying outdoors, choose a warm, sunny, windless day. DO NOT fly in extreme temperatures. Flying in extreme temperatures may affect the performance of this device. DO NOT fly on windy days as the drone is easily affected by strong winds. Flying in strong wind conditions could result in damage to your drone.

### ALTITUDE HOLD

When you release the Left Joystick (Throttle) after ascending/descending, the drone will still hover when the joystick is released.



### 3D FLIPS/ROLLS

Once you’ve mastered basic flight maneuvers, you can try some more adventurous rotations. Fly the drone 9 ft. in the air, then push the rotation button and the Right Joystick (Rutter) to one direction. The drone will rotate in the direction you push the joystick.



### WARRANTY / CUSTOMER SERVICE

Sharper Image branded items purchased from SharperImage.com include a 1-year limited replacement warranty. If you have any questions not covered in this guide, please call our Customer Service department at 1 (877) 210-3449. Customer Service agents are available Monday through Friday, 9:00 a.m. to 6:00 p.m. ET.

**SHARPER IMAGE®**

The SHARPER IMAGE® name and logo are registered trademarks.

©Sharper Image. All Rights Reserved.

[Sharper-Image-Pocket-Video-Drone-207160-Manual-Optimized](#)

[Sharper-Image-Pocket-Video-Drone-207160-Manual-Original.Pdf](#)