



# Sharper Image Automatic Shoe Cover Dispenser User Manual

[Home](#) » [Sharper Image](#) » Sharper Image Automatic Shoe Cover Dispenser User Manual 

## AUTOMATIC SHOE COVER DISPENSER

**Item No: 206133**

Thank you for purchasing the Sharper Image Automatic Shoe Cover Dispenser.  
Please read these instructions prior to using this device for the first time.

## PRODUCT STRUCTURE

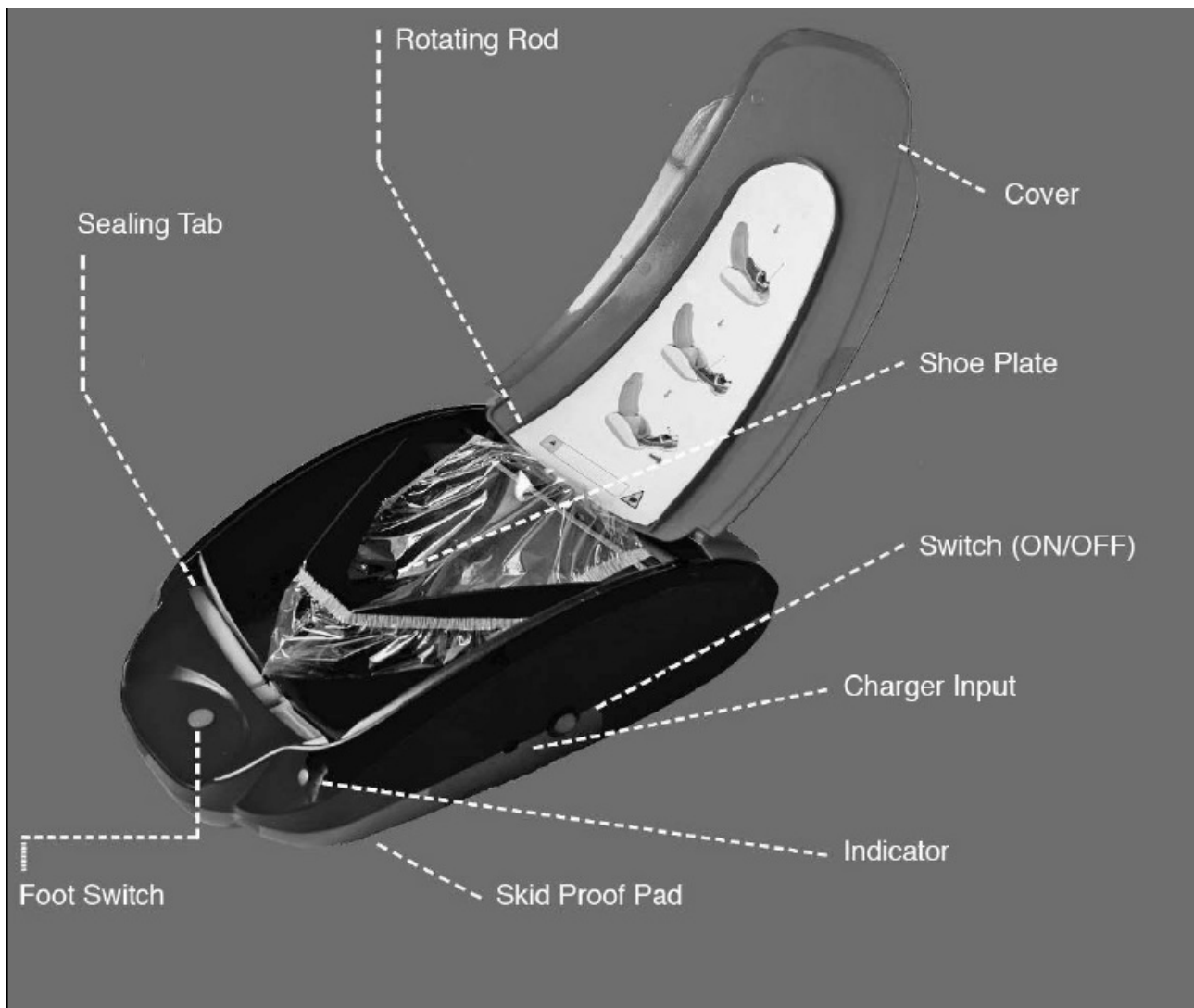

## HOW TO USE

1. Place the Automatic Shoe Cover Dispenser on the floor. Press the unit firmly on the floor to ensure the skid proof pads stay in place. *Note: If the unit is easy to move when using, wipe both the floor and skid proof pads with a wet towel.*
2. When the unit is turned on the indicator light will illuminate. Press the foot switch for 1 second to activate. *Note: The indicator light will go off automatically after 1 minute and enter power saving mode.*

## HOW TO USE IN 3 STEPS



1. Ensure the film is curled upwards before placing your heel between the shoe plates.

2. Slowly slide your foot down the unit. Press the tip of your toe on the foot switch for 3 seconds. Hold for a few seconds to seal. After the seal plates open back up remove your foot. *Note: For best results, keep shoe in place for three seconds after the heating element completes its cycle to enhance the wrapping quality and tightness.*
3. The unit will automatically clip the film and seal it. If the film did not completely cut after the sealing clip opened, pull the film lightly to remove the excess. *Note: Before stepping into the foot switch, raise your heel more so that the shoe will fit more precisely.*

## HOW TO INSTALL FILM ROLL



1. Pull the top cover open.
2. Place the roll of film into the dedicated compartment. Using the ends on the roll, align to the track until you hear a click. *Note: Make sure the film rolls over when rolling out (not under). Do not throw away black knobs, they are not included with replacement rolls.*
3. Insert the roll of film over the spool. Make sure the roll is securely placed on each side.
4. Pull the film through the shoe plates.
5. Press the foot switch to cut off excess film. Hold for 3 seconds.
6. Check to make sure the film seal is facing up.
7. See video online at [SharperImage.com](http://SharperImage.com) for detailed instructions.

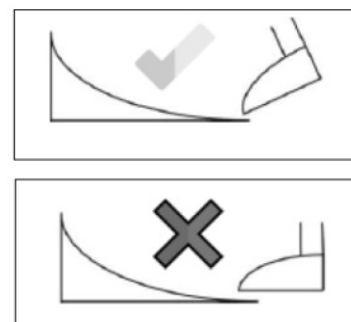

## HOW TO CHARGE

1. Plug the charger into an AC power outlet.
2. Plug the charging cable into the charging jack of the unit.

## NOTE

- Ensure the unit is switched on when charging.
- Unplug the charger after charging is finished.
- The indicator light will illuminate red while charging and turn green when charging has finished.

- Flashing red light will alert you when the unit needs to be charged.
- Flashing green light will turn red when the unit is in use.

### MAINTENANCE

- Turn the unit off before cleaning it.
- Wash the unit with water or detergent.
- Clean the skid proof pads on the bottom of the unit to make sure the unit stays in place while in use.
- If the unit won't be in use for an extended amount of time, pack it away and place it in a dry place.

### TROUBLESHOOTING

Problems	Causes	Solutions
Indicator doesn't light up when working	The unit will not turn on.	Turn on the unit.
	The unit continues to turn on and off.	Turn the unit off for 30 seconds then turn back on.
Film is too tight when using	The film is blocked after coming off the roll.	Open the cover and reinstall the film roll.
The film's seal is easily cracked	The film is too tight.	Install film again.
	There is dust in the seal plates.	Clean dust off the seal plates.
The unit easily moves while in use	There is water on the floor.	Dry the water on the floor.
	There is dust on the floor.	Clean the floor.
	The skid proof pads aren't dry and clean.	Clean the skid proof pads.

### SPECIFICATIONS

Temperature	140 °F
Battery type	Lithium Battery
Charging time	Approximatively 2 hours
Voltage	13.6 V
Power	20 W

### WARNINGS

European directive 2012/19/UE on Waste Electrical and Electronic Equipment (WEEE), requires that old household electrical appliances are not thrown into the normal flow of municipal waste. Old appliances must be collected separately to optimize the recovery and recycling of materials they contain and reduce the impact on human health and the environment.

- To ensure battery safety when charging, please check the AC power supply voltage.
- Don't touch the charger or a live socket.
- Unplug the charger after it's fully charged.
- Unplug the charger immediately and contact our service center if it emits smoke or burns when charging.
- Do not disassemble the unit or change the battery.
- Please dispose of used batteries properly.
- DO NOT put your fingers into the range of the sealing clip when the unit is in use.
- Keep away from children. This unit is not a toy.
- Keep unit away from water.

## **WARRANTY / CUSTOMER SERVICE**

Sharper Image branded items purchased from SharperImage.com include a 1-year limited replacement warranty. For Customer Service, please call 1 (877) 210-3449.

Sharper Image Automatic Shoe Cover Dispenser User Manual – [Original PDF](#)

Sharper Image Automatic Shoe Cover Dispenser User Manual – [Optimized PDF](#)