



# SHARP XL-B517D Micro Component System User Manual

[Home](#) » [Sharp](#) » SHARP XL-B517D Micro Component System User Manual 

## Contents

- 1 SHARP XL-B517D Micro Component System
- 2 Important safety instructions
- 3 What is included in the box
- 4 Panels & Controls
- 5 Remote control
- 6 Preparation for use
- 7 BASIC FUNCTIONS
- 8 FM radio operation
- 9 DAB+ Operations
- 10 Menu Operation
- 11 CD operations
- 12 Bluetooth Operation
- 13 Connect other audio devices
- 14 USB Operation
- 15 Troubleshooting
- 16 Technical specification
- 17 Documents / Resources
  - 17.1 References
- 18 Related Posts

# SHARP

**SHARP XL-B517D Micro Component System**



## Important safety instructions

**CAUTION** Please, read these safety instructions and respect the following warnings before the appliance is operated:

The lightning flash with the arrowhead symbol, within an equilateral triangle, is intended to alert the user to the presence of uninsulated “dangerous voltage” within the product’s enclosure that may be of sufficient magnitude as to constitute a risk of electric shock to persons. The exclamation point within an equilateral triangle is intended to alert the user to the presence of important operating and maintenance (servicing) instructions in the literature accompanying the appliance. This symbol means that the product should be disposed of in an environmentally friendly manner and not with general household waste.

- **AC voltage**
- **DC voltage**
- **Class II equipment**

In order to prevent fire always keep candles and other open flames away from this product.

### Warning:

- Always follow basic safety precautions when using this appliance, especially when children are present.
- Children should be supervised to ensure that they do not play with the appliance.
- Do not damage the power cord, or place any heavy objects on it, do not stretch it or bend it. Also do not use extension cables. Damage to the power cord may result in fire or electric shock.
- If the power supply cord is damaged, it must be replaced by the manufacturer, a service agent or a similarly qualified person.
- Ensure that the unit is plugged into an AC 220-240V 50Hz power outlet. Using higher voltage may cause the unit to malfunction or even catch fire.
- If the power plug does not fit into your outlet, do not force the plug into the electrical socket.
- To switch off the unit place it in to standby and unplug it from the mains power supply.
- Do not disconnect or connect the power cord with wet hands. It may cause an electric shock.
- Disconnect the power cord if the unit is not used for a long period of time.
- Ensure that the mains plug is always easily accessible.
- This product does not contain any parts that are serviceable by the user. In case of a fault, contact the manufacturer or authorized service department. Exposing the internal parts inside the device may endanger your life. The manufacturer’s guarantee does not extend to faults caused by repairs carried out by unauthorized

third parties.

- Do not use this product immediately after unpacking. Wait until it warms up to room temperature before using it.
- Ensure this product is used in moderate climates only (not in tropical/subtropical climates).
- Place product on a flat, stable surface that is not subject to vibrations.
- Ensure the product and its parts do not overhang the edge of the supporting furniture.
- To reduce the risk of fire, electric shock or damage to this product, do not expose it to direct sunlight, dust, rain, and moisture. Never expose it to dripping or splashing and do not place objects filled with liquids on or near the product.
- Do not install near any heat sources such as radiators, heat registers, stoves, or other apparatus (including amplifiers) that produce heat.
- Do not place the product where the humidity is high and ventilation is poor.
- Ensure a minimum distance of 5 cm around the apparatus for sufficient ventilation. Do not block any ventilation openings on the unit and ensure they are not covered with items such as newspapers, tablecloths, curtains, etc.
- NEVER let anyone, especially children, push anything into holes, slots or any other openings in the unit's casing as this could result in a fatal electric shock.
- Storms are dangerous for all-electric appliances. If the mains or aerial wiring is struck by lightning, the appliance might get damaged, even if it is turned off. You should disconnect all the cables and connectors of the appliance before a storm.
- Do not move the unit during disc playback. During playback, the disc rotates at high speed. Do not lift or move the unit during playback, as doing so may damage the disc or the unit.
- Do not turn up the volume while listening to a section with very low-level inputs or no audio signals. If you do, the speaker may be damaged when a peak level section is suddenly played.

## **Maintenance**

- Unplug the power cable from the power source before cleaning the appliance.
- Use a soft and clean rag to clean the outside of the unit. Never clean it with chemicals or detergent.

## **Batteries**

- Observe the correct polarity when inserting the batteries.
- Do not expose batteries to high temperatures and do not place them on locations where the temperature might increase quickly, e.g. near the fire or in the direct sunshine.
- Do not expose batteries to excessive radiant heat, do not throw them into the fire, do not disassemble them and do not try to recharge un-rechargeable batteries. They could leak or explode.
- Never use different batteries together or mix new and old ones.
- When the Remote Control is not to be used for a long time (more than a month), remove the battery from the Remote Control to prevent it from leaking.
- If the batteries leak, wipe away the leakage inside the battery compartment and replace the batteries with new ones.
- Do not use any batteries other than those specified.

### **Do not ingest battery, chemical burn hazard**

- If a battery is swallowed, it can cause severe internal burns in just 2 hours and lead to death. Keep new and

used batteries away from children. If the battery compartment does not close securely, stop using the product and keep it away from children. If you think batteries might have been swallowed or placed inside any part of the body, seek immediate medical attention.

### **Disposal of this equipment and Batteries**

- Do not dispose of this product or its batteries as unsorted municipal waste. Return it to a designated collection point for the recycling of WEEE in accordance with local law. By doing so, you will help to conserve resources and protect the environment.
- Most EU countries regulate the disposal of batteries by law. Contact your retailer or local authorities for more information.
- The symbol shown to the right appears on electrical equipment and batteries (or their packaging) to remind users of the disposal requirements. If “Hg” or ‘Pb’ appears below the symbol, this means that the battery contains traces of mercury (Hg) or lead (Pb), respectively.
- Users are requested to use the locally provided return facilities for used equipment and batteries.

### **CAUTION**

- Appliances with built in CD player are marked with this caution label
- THIS UNIT IS A CLASS 1 LASER PRODUCT. THIS UNIT USES A VISIBLE LASER BEAM WHICH COULD CAUSE HAZARDOUS RADIATION EXPOSURE IF DIRECTED. BE SURE TO OPERATE THE PLAYER CORRECTLY AS INSTRUCTED. WHEN THIS UNIT IS PLUGGED INTO THE WALL OUTLET, DO NOT PLACE YOUR EYES CLOSE TO THE OPENINGS TO LOOK INTO THE INSIDE OF THIS UNIT.
- USE OF CONTROLS OR ADJUSTMENTS OR PERFORMANCE OF PROCEDURES OTHER THAN THOSE SPECIFIED HEREIN MAY RESULT IN HAZARDOUS RADIATION EXPOSURE.
- DO NOT OPEN COVERS AND DO NOT REPAIR YOURSELF. REFER SERVICING TO QUALIFIED PERSONNEL.

### **CE and UKCA statement:**

- Hereby, Sharp Consumer Electronics Poland sp. z o.o. declares that this audio device is in compliance with the essential requirements and other relevant provisions of RED Directive 2014/53/EU and UK Radio Equipment Regulations 2017.
- The full text of the EU declaration of conformity is available by following the link [www.sharpconsumer.com](http://www.sharpconsumer.com) and then entering the download section of your model and choosing “CE Statements”.

### **Trademarks:**



The Bluetooth® word mark and logos are registered trademarks owned by Bluetooth SIG,. Inc.

### **What is included in the box**

- 1 x Main unit
- 2 x Speaker
- 1 x Remote control
- 2 x AAA battery
- 1 x User guide
- 1 x Quick start guide
- 1 x Power cord

## Panels & Controls

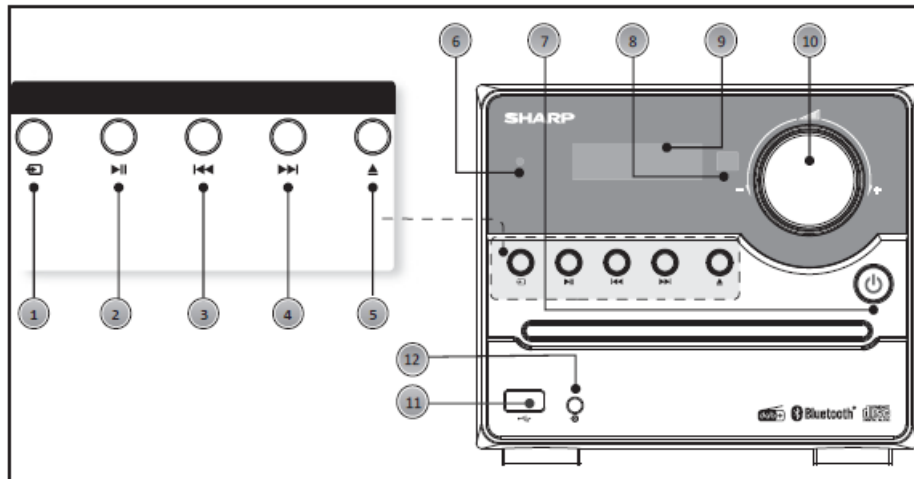

### Front panel

1. **SOURCE:** Press to select the modes.
2. **PLAY/PAUSE:** Press to pause or play the music.
3. **PREVIOUS:** Press to skip to previous song/ station, press and hold to fast rewind/scan.
4. **NEXT:** Press to skip to next song/station, press and hold to fast forward/scan.
5. **EJECT:** Press to open/close CD drawer (in CD mode)
6. **Standby indicator:** lit when in standby
7. **STANDBY:** press to turn on or enter standby
8. **Remote Sensor:** Point the remote at the sensor within a 7m range.
9. **Display Screen:** Shows information in relation to the mode/function being used.
10. **VOLUME+/- knob:** Turn to adjust the volume level.
11. **USB Port:** Used to connect a USB flash disk.
12. **Audio Input Socket:** Used to connect external audio sources.

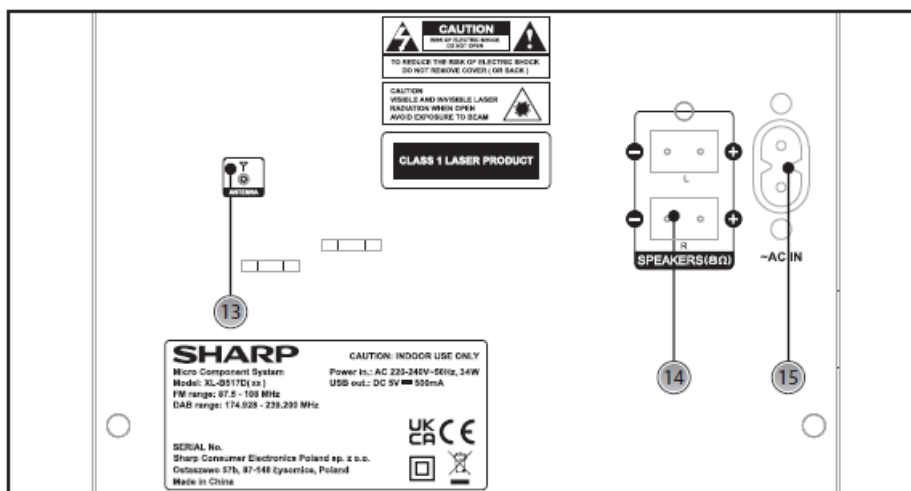

### Rear panel

13. **Antenna:** To receive the DAB/FM signal.
14. **Speaker Terminals:** Connect the speakers to the main unit.
15. **Power supply:** Connect the power lead.

### Remote control

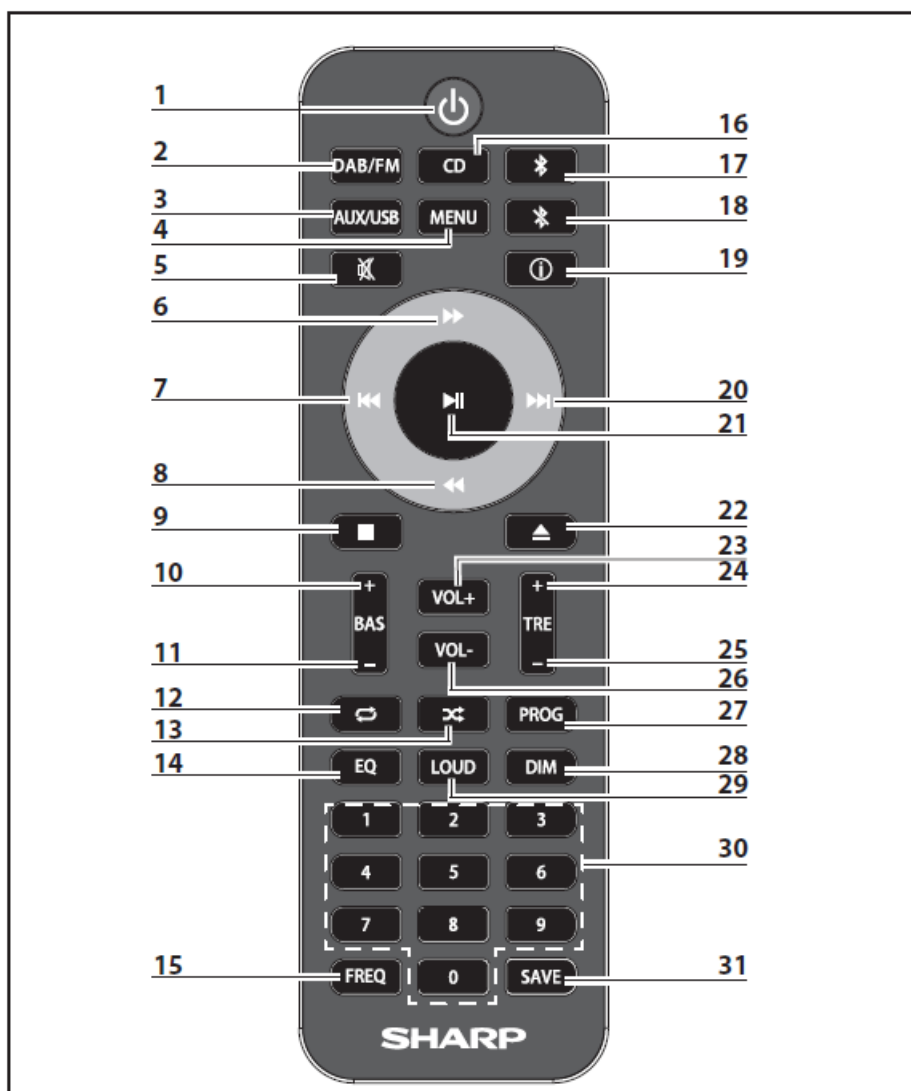

1. **STANDBY:** Press to turn on the unit or enter Standby mode.
2. **DAB/FM:** Press to select DAB mode, press again to select FM mode.

3. **AUX/USB:** Press to select AUX mode, press again to select USB mode.
4. **MENU:** Press to enter or exit Menu.
5. **MUTE:** Press to mute the sound, press again or press VOL+ or VOL- to resume.
6. **FAST FORWARD:** Press to fast forward the track that is currently playing.
7. **PREVIOUS:** Press to skip to the previous song/saved station.
8. **FAST REWIND:** Press to fast-rewind the song that is currently playing.
9. **STOP:** In CD/USB mode, press to stop playback.
10. **BASS +:** Press to increase the bass.
11. **BASS -:** Press to decrease the bass.
12. **REPEAT:** Press to repeat song in CD mode.
13. **RANDOM:** Press to play music in a random order.
14. **EQ:** Press repeatedly to select the sound equaliser pre-set.
15. **FREQ:** Frequency: in FM mode, press to enter a frequency manually.
16. **CD:** Press to enter CD mode.
17. **BLUETOOTH:** Press to enter Bluetooth mode.
18. **BLUETOOTH disconnect:** Press to disconnect a paired Bluetooth device.
19. **INFORMATION:** Press repeatedly to cycle through information displays relating to the audio source/mode.  
When in the MENU, press the button to return the previous MENU level.
20. **NEXT:** Press to skip to next song/station.
21. **PLAY/PAUSE:** Start or pause the playback
22. **EJECT:** Press to open/close CD drawer (in CD mode).
23. **VOLUME +:** Press to increase volume.
24. **TREBLE +:** Press to increase the treble.
25. **TREBLE -:** Press to decrease the treble.
26. **VOLUME -:** Press to decrease volume.
27. **PROGRAM:** Press to program the playback order.
28. **DIM:** Press to select the display brightness level Low/Medium/High.
29. **LOUD:** Press to increase the level of bass at low volume levels.
30. **NUMBER (0-9):** Use to select songs, presets or enter frequency.
31. **SAVE:** Press to save your favourite stations.

### **Fitting or replacing the remote control batteries**

1. To open the battery compartment, push your thumb down on to the circle on the battery compartment cover and slide it down.
2. Fit two AAA batteries observing polarity +/- as shown. When replacing the batteries, use only the same type of battery supplied.
3. Re-fit the battery cover and clip it in place.

### **Preparation for use**

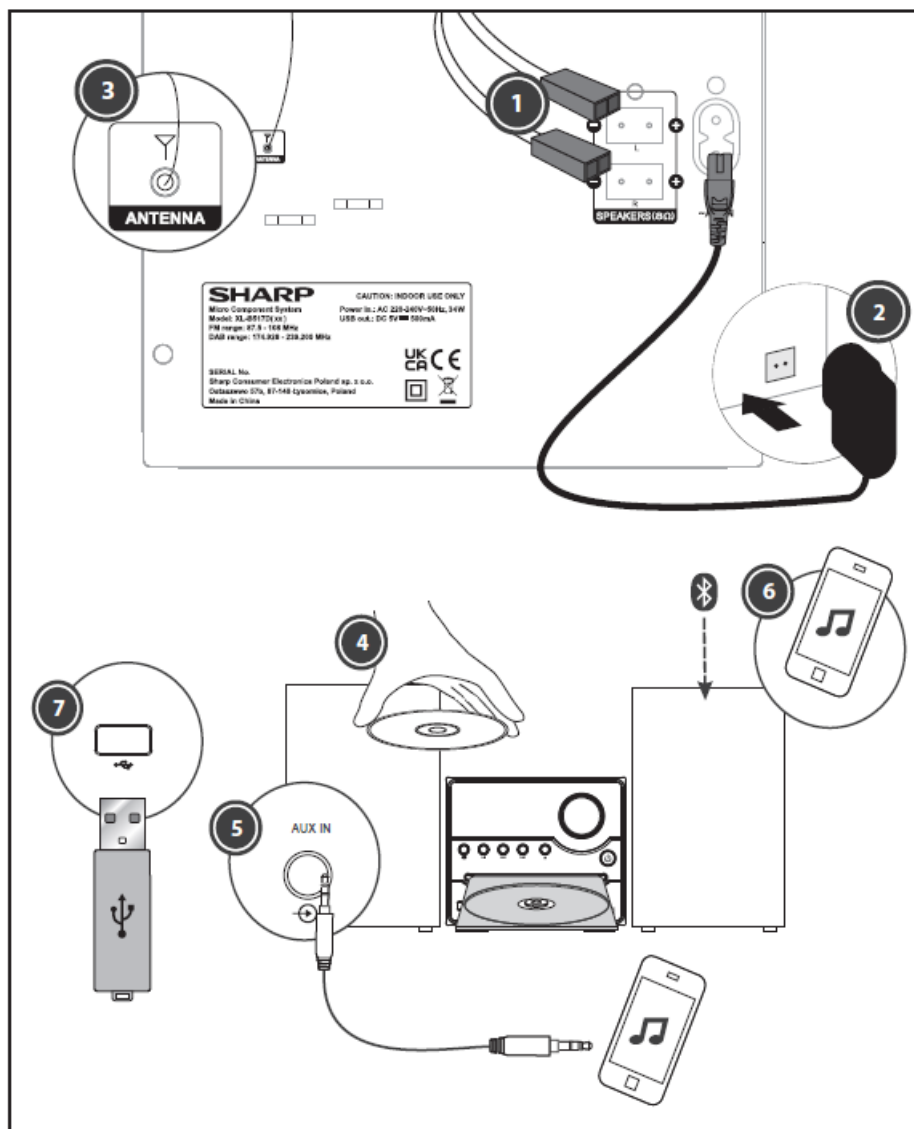

1. Place a speaker on either side of the main unit, preferably at the same height and with at least 150mm space between each speaker to the main unit. Connect the speaker plugs to the rear of the unit. Take care to match the speaker placed to the LEFT output on the rear of the unit. Repeat for the RIGHT speaker.
2. Please ensure that the voltage marked on the rating label, located on the rear panel, is the same as the voltage in your area. Insert the power lead into the AC IN socket on the back of the unit. Plug the other end of the cable into the wall socket.
3. Press the STANDBY button on the main unit to turn it ON. Extend the ANTENNA to get the best reception. Press the button on the unit, or DAB/FM button on the remote control to enter the DAB/FM mode. To use the radio in DAB/FM mode, follow the instructions in the FM or DAB RADIO OPERATION chapter of the User Manual.
4. Press the button on the unit, or the CD button on the remote control to enter the CD mode. Press the button to open the disc drawer and insert a disc. Press the button again to close. The CD will begin playing from the first track.
5. Press the button on the unit, or the AUX button on the remote control to enter the Aux In (Audio) mode. Connect your audio device to the AUX IN socket via a 3.5mm aux-in cable. Control playback via your connected audio device.
6. Press the button on the unit, or button on the remote control button to enter the Bluetooth mode. Activate the Bluetooth-enabled device and select the "SHARP XL-B517D". Select the song you want and press to play.
7. Press the button on the unit, or the USB button on the remote control to enter the USB mode. Plug the USB



device into the USB port on the front panel of the unit, and it will read the USB and play automatically.

## BASIC FUNCTIONS

### Setting the time/date

1. To set the time/date manually, long-press the MENU button when the unit is on standby. Use the keys to change the values and press to confirm. To set the time/date automatically, press the
2. MENU button when the unit is on. Select the SYSTEM menu and press to confirm. Select Time from the SYSTEM menu and then AUTO UPDATE where you will be able to select the source of the update. Press MENU to exit.

**Switching modes** To switch between the modes: DAB+, FM, CD, Bluetooth, USB and AUX-IN, press SOURCE button on the unit or the corresponding button (DAB/FM, CD, , AUX/USB) on the remote control.

### Volume control

1. **Increase:** Rotate the VOLUME control on the main unit clockwise or press the VOL+ button on the remote.
  2. **Decrease:** Rotate the VOLUME control on the main unit anti-clockwise or press the VOL- button on the remote.
- **EQ effects** Press the EQ button on the remote repeatedly to cycle through a set of equalizer presets to adjust the sound. Choose from CLASSIC, ROCK, POP, JAZZ, DANCE, LIVE, and Off.
  - **Loudness function** This function will increase the level of bass at low volume levels. Press the LOUD button on the remote to enable the effect. Press again to disable the eff etc.
  - **Mute function** Press the button at any time to mute the sound output. Press again to unmute.
  - **Tone controls** To adjust the bass, use the BAS+ or BAS- buttons on the remote control. To adjust the treble, use the TRE+ or TRE- buttons on the remote control.
  - **Standby mode** Press the STANDBY button on the unit or the remote to put the system into standby mode. To resume normal operation, press this button again.

**NOTE:** This unit is designed to enter STANDBY mode automatically, after about 15 minutes (approximately) of inactivity. Press the STANDBY button to wake the unit.

**NOTE:** When you power on the unit from standby, it will resume in the mode that was last used.

### FM radio operation

1. Press the source button on the unit, or DAB/FM button on the remote control twice to enter FM mode. (FM frequency: 87.50-108.00MHz)
2. Press the / buttons on the remote control to decrease or increase the frequency in 0.05MHz increments.
3. Press and hold the / buttons on the remote control to scan through the frequency range quickly. The scan will stop once it has found a station.
4. Press and hold the button to scan through the frequency range quickly; it will store any stations found automatically.
5. **SAVE a station:** You can store up to 30 FM stations in memory. You can store up to 30 FM stations in memory.

- Press the **FREQ** button and then, using the number buttons enter the frequency that you want to store.
- Press the **SAVE** button, it will show “P01” on the display. ^ Press the / button to select the station preset number you want to save the frequency under.
- Press the **SAVE** button again to Confirm.

#### 6. Recall the preset stations:

- Press the / button to recall your stored stations.

**Note:** RDS is available on stations that support this service

## DAB+ Operations

1. Press the **SOURCE** button on the unit or the **DAB/FM** button on the remote control to switch to the DAB+ mode.
2. The first time the unit enters DAB mode it will start scanning for stations automatically.
3. **Station tuning** – see the Menu Operation section of this User Manual for guidance on how to navigate the MENU.
  - Full scan – In MENU select **<Full scan>**, and press the button to enable full scanning. Alternatively, press and hold >|| when in DAB mode.
  - Manual tune – In MENU select **<Manual tune>** and press / button to select station from 5A:174.928MHz to 13F:239.200MHz. Then press the button to activate the selected station.
4. **Store Stations:**
  - It is possible to store up to 30 of your favorite stations. This will enable you to access your favorites quickly & easily.
  - To store a preset, you must first be listening to the station you would like to save.
  - Press and hold one of the number buttons 0-9 to store the station under that number.
  - Alternatively, press **SAVE**, use / to select the preset number and press **SAVE** again. ^ To recall a stored station preset press the corresponding number on the number keypad.

## Menu Operation

Press the **MENU** button to enter the menu settings. Use the / button to select the menu contents. Press the button to confirm the selection or to enter the next setting interface. Press the button to go back to the previous setting interface. Press the **MENU** button to exit the menu.

### \*DAB only

1. Full scan\* – Select the **<Full scan>**, and press button to enable full scanning.
2. Manual tune\* – Select the **<Manual tune>** and press /button to select station from 5A:174.928MHz to 13F:239.200MHz. Then press button to activate the selected station.
3. DRC (Dynamic range control)\* This function will analyse the audio signal to reduce loud noises and amplify more quiet ones. This will enable a more clear and consistent sound delivery, particularly at lower volumes. Enter the menu and find **<<DRC>>**, use the / button to select either **DRC OFF**, **DRC HIGH** or **DRC LOW**, press the button to confirm.
4. Station order\* Enter the menu and find **<<Station Order>>**, press the button, then the / button to select one of the station ordering options: **<< Multiplex >>**, **<< Alphanumeric >>**, **<< Active >>**.

**NOTE:** Station Name with question mark: ?Station Name (e.g. ? BBC RADIO 4) This implies that the station is not available due to poor signal or it is not broadcasting. Try repositioning antenna.

5. Pruning stored stations\*: If the unit has performed a scan in a different location, you may find there are some stored stations that no longer receive a signal. The prune function will automatically remove stations with no signal from the stored station list. Enter the <<Main menu>>, press / to find and enter <<Prune station>>, then select <<Yes>> to prune.

6. TA\* (Traffic Announcement) Plays local radio live traffic announcements. TA is on by default.

**FM only\*\***

7. Scan setting\*\* – Strong station only/All stations

8. Audio setting\*\* – stereo allowed/Forced mono

9. System setting

- Time – Time set up
- Language – language set up
- Factory Reset – To reset the unit to the original settings, enter the factory reset interface, follow the directions to <Press ENTER to prune station> and press the button. Then the unit will restart.
- Software upgrade
- SW version – Information about the software version of the system.

## CD operations

1. Press the source button on the unit, or the CD button on the remote control to enter the CD mode. Press the button to open the disc drawer, put a CD in, then press the button again to close.
2. Press the button to pause or play the song.
3. Press the button on the remote control to stop playing, press the button to re-start.
4. Press the / button to skip to the previous or next song.
5. Press the / button on the remote control to fast forward or fast rewind the playback, press again to resume normal speed.
6. To directly select a specific song press the corresponding number buttons 0-9 on the remote control.

**Example:**

- If the tracking number consists of two digits, for example, 25, press button “2”, and then button “5” to select the 25th track.
- You can just press the number 9 – single-digit works.

7. **REPEAT button:** While in playing mode, press the button to set repeat mode.

- For CD and CD-R discs, press the button to repeat playing songs.
- Press once to repeat the current song. Press again to repeat all tracks.
- Press a third time to cancel.

8. Press the button on the remote control to play the tracks in random order. Press again to resume.

9. You can set the disc to play tracks in a programmed order:

- Press the button on the remote control to stop playing.
- Press the PROGRAM button on the remote control. The screen displays: P01.
- Use the number buttons on the remote or / to select the song.
- Press the PROG button again to confirm the selection and the screen will then display P02. Repeat the process for your second selection and so on...

- Press the PROGRAM button on the remote control to confirm.
- To begin the programmed order, press the button.
- To cancel the program sequence, press the button twice.

#### **Notes:**

- MP3 files are supported.
- Unsupported file formats are skipped. For example, Word documents (.doc) or MP3 files with extension .dlf are ignored and not played.

## **Bluetooth Operation**

The Microsystem has Bluetooth capability and is able to receive a signal within a range of 7 metres. To pair the Microsystem with a Bluetooth device:

1. Press the source button on the unit, or button on the remote control to enter Bluetooth mode. The unit will display "Bluetooth Not Connected".
2. Activate your Bluetooth device and select the search mode.
3. Select "SHARP XL-B517D" from the search list and connect.
4. Enter "0000" for a password if prompted.
5. When the devices are connected to each other, a confirmation sound will be made and the display will show "Bluetooth Connected".
6. You can now playback music from your device. Please note that the volume on the Bluetooth source device operates independently of the volume of the unit.
7. To turn off the Bluetooth function: switch to another function on the Microsystem, disable the function on your Bluetooth source device; or press the button on the remote control.

## **Connect other audio devices**

Audio (AUX IN) allows your unit quickly and easily to connect to an MP3 player or other external sources.

1. Use a 3.5mm audio cable to connect your external audio device to the AUX IN socket on the front panel.
2. Press the source button on the unit, or AUX/USB button on the remote control to switch to the AUX IN mode.
3. You may need to operate the external audio device directly for playback features.
4. Please note that the volume on the Audio source device operates independently of the volume of the unit.

## **USB Operation**

It is possible to listen to music stored on a USB flash drive via the USB device interface of the unit.

### **Connecting a USB flash drive:**

1. Switch the unit on and select USB mode by pressing the SOURCE button or pressing the AUX/USB button on the remote control twice.
2. Connect the USB flash drive to the USB device interface on the front panel of the unit.

3. The unit will now play songs that are saved on the USB device.

#### **Notes:**

- MP3 files are supported.
- Unsupported file formats are skipped. For example, Word documents (.doc) or MP3 files with extension .dlf are ignored and not played
- Even when the files are in a supported format (MP3), some may not play or display depending on the compatibility.
- In some cases, reading may be as long as 60 seconds, this is not a malfunction.
- Depending on the amount of data and media speed, it may take longer for the unit to read the USB device.
- The maximum USB memory size is 32GB.
- USB memory device must be formatted in FAT, FAT16 or FAT32

### **Troubleshooting**

#### **No Power**

##### **Reason**

- Power cable not connected to wall socket
- The power socket is not switched on

##### **Solution**

- Make sure the plug is connected
- Switch the power on

##### **No Sound from AUX/Bluetooth input Reason**

- Volume is too low
- AUX/Bluetooth source volume is too low

##### **Solution**

- Increase the volume
- Increase the output volume of the AUX/Bluetooth source

##### **Sound is distorted from AUX Input Reason**

- Volume is too high
- AUX source volume is too high

##### **Solution**

- Reduce the volume
- Reduce the output volume of the AUX source

#### **Unable to play CD**

##### **Reason**

- No disc in the tray
- Disc not loaded properly
- Disc is dirty

- **Solution**

- insert a compatible disc
- Check the disc loaded correctly
- Clean the disc

- **Static Sound Reason**

- Poor reception

- **Solution**

- Re-locate the antenna

- **The desired station not found Reason**

- Weak signal
- Station not available in your area

- **Solution**

- Use the manual tune function
- See DAB availability website

- **Weak or no DAB signal Reason**

- DAB not available in your area

- **Solution**

- See DAB availability website

- **I can hear a burbling noise on some stations or Station Name with question mark: ?Station Name (e.g ? BBC RADIO 4) Reason**

- Weak DAB signal or DAB station not broadcasting

- **Solution**

- Try re-positioning the aerial

- **Unit switches off after 15 minutes of inactivity Reason**

- Auto standby mode in operation

- **Solution**

- This unit is designed to enter STANDBY mode automatically after 15 minutes of inactivity. Press the STANDBY button to wake up the unit.

## Technical specification

<b>Model</b>	<b>XL-B517D</b>
Radio Signal	87.5 – 108MHz
DAB+ signal	174.928 – 239.200MHz





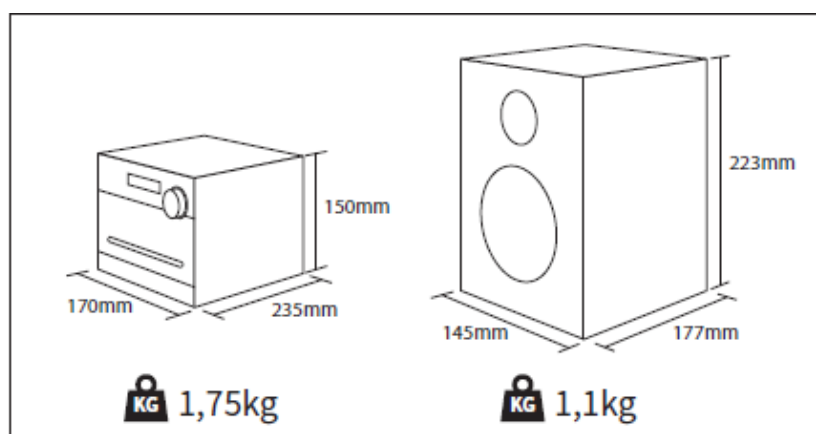

Power Supply	AC 220-240V~ 50Hz
Power Consumption	34 W
Standby Power Consumption	<0,5 W
Output Power	2 x 7,5 W (RMS)
Impedance	2 x 8 $\Omega$
Frequency Response	60Hz – 20KHz
<b>Bluetooth</b>	
Version	V 5.0
Maximum power transmitted	<20 dbm
Frequency bands	2402 MHz ~ 2480 MHz

CD player				
Disc format		CD, CD-R, CD-RW, MP3		
Remote Control				
Battery Type		2x AAA / 1.5V		



## Documents / Resources



  User manual XL-B517D [SHARP] [B517D] [Micro Component System]	<a href="#">SHARP XL-B517D Micro Component System</a> [pdf] User Manual XL-B517D, Micro Component System, XL-B517D Micro Component System
  User manual XL-B517D [SHARP] [B517D] [Micro Component System]	<a href="#">SHARP XL-B517D Micro Component System</a> [pdf] User Manual XL-B517D Micro Component System, XL-B517D, Micro Component System, Component System
  User manual XL-B517D [SHARP] [B517D] [Micro Component System]	<a href="#">SHARP XL-B517D Micro Component System</a> [pdf] User Manual XL-B517D Micro Component System, XL-B517D, Micro Component System, Component System

References

- [🌐 Index English - mer.eu](#)
- [S Sharp Consumer Products Europe - Sharp Europe](#)
- [S Sharp Consumer Products Europe - Sharp Europe](#)
- [S Sharp Consumer Products Europe - Sharp Europe](#)