

SHARP
UA-KIL80E-W
Air Purifier with
Humidifying
Function



SHARP UA-KIL80E-W Air Purifier with Humidifying Function Instruction Manual

[Home](#) » [Sharp](#) » SHARP UA-KIL80E-W Air Purifier with Humidifying Function Instruction Manual 

Contents

- 1 SHARP UA-KIL80E-W Air Purifier with Humidifying Function
- 2 IMPORTANT SAFETY INSTRUCTIONS
 - 2.1 Information on Disposal
- 3 OPERATION PRINCIPLE
- 4 PART NAMES
- 5 BEFORE FIRST USE
- 6 OPERATION
- 7 CARE AND MAINTENANCE
 - 7.1 PRE-FILTER
- 8 REPLACEMENT
- 9 TROUBLESHOOTING
- 10 ERROR DISPLAY
- 11 SPECIFICATIONS
- 12 More Information
- 13 Documents / Resources
 - 13.1 References
- 14 Related Posts

SHARP

SHARP UA-KIL80E-W Air Purifier with Humidifying Function



Thank you for purchasing this SHARP Air Purifier.
Please read this manual carefully before using the product.
This manual should be kept in a safe place for handy reference.

IMPORTANT SAFETY INSTRUCTIONS

Always follow basic safety precautions when using electrical appliances, including the following:

WARNING

Always observe the following to reduce the risk of electrical shock, fire, or injury:

OPERATION

- Read all instructions before using the product.
- Use only a 220 – 240 volt outlet.
- Do not use the product if the power cord or plug is damaged or if the connection to the wall outlet is loose.
- Periodically remove dust from the plug.
- When removing the power plug, always hold the plug and never pull on the cord. Failure to do so can cause a short circuit resulting in electrical shock or fire.
- Be careful not to damage the power cord. When removing the product, do not damage the power cord with the casters. Failure to do so can cause electric shock, heat generation, or fire.
- Do not remove the plug when your hands are wet.

- Be sure to remove the power plug when refilling the Water Tank, before performing maintenance, when removing and attaching and replacing the filter and when not using for a long time. Failure to do so can cause a short circuit resulting in electrical shock or fire.
- If the power cord is damaged, it must be replaced by the manufacturer, its service agent, a Sharp authorized Service Centre or similarly qualified persons in order to avoid a hazard. Contact the nearest Service Centre for any problems, adjustments, or repairs.
- Do not repair or disassemble the product yourself.
- Do not insert fingers or foreign objects into the Air Inlet or Air Outlet.
- Do not expose the product to water. Doing so can cause a short circuit or electrical shock.
- When carrying the product, first remove the Water Tank and Humidifying Tray, and then hold the product by the handles on both sides.
- Do not drink the water in the Humidifying Tray or Water Tank.
- Replace the water in the Water Tank daily with fresh tap water, and regularly clean the Water Tank and Humidifying Tray. When the product is not in use, dispose of the water in the Water Tank and Humidifying Tray. Leaving water in the Water Tank or Humidifying Tray can cause mold, bacteria, and bad odours. In rare cases, such bacteria can be a health hazard.
- This appliance can be used by children aged from 8 years and above and persons with reduced physical, sensory or mental capabilities or lack of experience and knowledge if they have been given supervision or instruction concerning use of the appliance in a safe way and understand the hazards involved. Children shall not play with the appliance. Cleaning and user maintenance shall not be made by children without supervision.

INSTALLATION

- Do not use this product near gas appliances or fireplaces.
- When the product is operated with gas appliances in same room, Ventilate a room periodically, otherwise it may cause Carbon monoxide poisoning.
- Do not operate the product in rooms where aerosol insecticides are present. Do not operate the product in rooms where there is oily residue, incense, sparks from lit cigarettes, or chemical fumes in the air.
- Keep the product away from water.
- Do not operate the product in places where it may get wet, such as a bathroom.

MAINTENANCE

- Be cautious when cleaning the product. Strong corrosive cleansers can damage the exterior.

CAUTION

OPERATION

- Do not block the Air Inlet or Air Outlet.
- Always operate the product in an upright position.
- Do not move the product when it is in operation.
- Do not move or change the direction of the product while dragging the casters.
- If the product is on easily damaged flooring, an uneven surface, or thick-piled carpet, lift it up when moving.

- When moving the product by its casters, move it slowly and in a horizontal direction.
- Turn the product off and remove the Water Tank before moving, take care not to catch your fingers.
- Do not operate the product without the filters, the Water Tank, and the Humidifying Tray properly installed.
- When refilling the Water Tank, make sure of no water leaking from the Water Tank.
- Be sure to wipe off any excess water on the outside of the Water Tank.
- Do not use hot water (40 °C or more), chemical agents, aromatic substances, dirty water, or other damaging substances. Doing so can deform the product or cause it to malfunction.
- Use only fresh tap water. Using other water sources risks the growth of molds, fungi, or bacteria.
- Do not shake the Water Tank with holding the carrying handle.

INSTALLATION

- Do not place the product near or on hot objects, such as stoves or heaters, or where it may come into contact with steam.

MAINTENANCE

- Clean the exterior with a soft cloth only. Do not use volatile fluids or detergents. The product surface may be damaged or cracked with Benzine paint thinner or polishing powder. In addition, the sensors may malfunction as a result.
- Do not scrub the Pre-Filter hard during its maintenance.
- Do not wash and reuse the HEPA filter and the Deodorizing filter.
- Doing so will not improve filter performance and can also cause electric shock or operating malfunctions.
- The frequency of descaling maintenance will depend on the hardness of and the impurities in the water that you use; the harder the water the more often descaling will be necessary.
- Do not use detergents other than instructions when perform maintenance of the Humidifying Tray and Cover. It may cause deformation, tarnishing, cracking (water leakage).
- Avoid spilling water when removing or cleaning the Humidifying Tray.
- Do not remove the Float and the Roller. If the Float comes off.
- Do not remove the Humidifying Filter from the Filter Frame except replacing it.

NOTE

What to do if the product interferes with radio or TV reception

If the air purifier interferes with radio or television reception, try one or more of the following measures:

- Adjust or reposition the receiving antenna.
- Increase the distance between the product and the radio or TV.
- Connect the equipment into an outlet on a circuit different from that of the radio or TV receiver.
- Consult the dealer or a qualified radio or TV technician.

INSTALLATION

- Avoid locations where the sensors are exposed to direct wind.
- Doing so can cause the product to malfunction.
- Avoid locations where furniture, fabrics, or other objects can come in contact with the product and interfere with the intake and outtake of air.
- Avoid locations where the product is exposed to condensation or drastic changes in temperature. Appropriate room temperature is between 0 – 35 °C.
- Place the product on a level and stable surface with sufficient air circulation. Strong wind or Dust through the window may prevent the unit's air purifying performance and efficacy.
- When placed on heavy carpet, the product may vibrate slightly. Place the product on a level surface to avoid water leakage from the Water Tank and Humidifying Tray
- Avoid locations that generate grease or oily smoke. Doing so can cause the product exterior to crack and the sensors to malfunction.
- The dust collecting ability of the product is effective even when the product is as close to 3 cm from the wall, the surrounding walls and floor may get dirty. Please place the product at a distance from the wall. The wall directly behind the Air Outlet may become dirty over time. When using the product for an extended period of time at the same location, periodically clean the walls adjacent to it.

MAINTENANCE

- Follow the instructions in this manual for proper filter care and maintenance.



Attention: Your product is marked with this symbol. It means that used electrical and electronic products should not be mixed with general household waste. There is a separate collection system for these products.

Information on Disposal

Information on Disposal for Users (private households)

In the European Union

IF YOU WISH TO DISPOSE OF THIS EQUIPMENT, DO NOT USE THE ORDINARY WASTE BIN, AND DO NOT PUT THEM INTO A FIREPLACE!

Used electrical and electronic equipment should always be collected and treated SEPARATELY in accordance with local law. Separate collection promotes an environment-friendly treatment, recycling of materials, and minimizing final disposal of waste. IMPROPER DISPOSAL can be harmful to human health and the environment due to certain substances! Take USED EQUIPMENT to a local, usually municipal, collection facility, where available.

If in doubt about disposal, contact your local authorities or dealer and ask for the correct method of disposal. ONLY FOR USERS IN THE EUROPEAN UNION, AND SOME OTHER COUNTRIES; FOR INSTANCE NORWAY AND SWITZERLAND: Your participation in separate collection is requested by law.

The symbol shown above appears on electrical and electronic equipment (or the packaging) to remind the users of this. Users from PRIVATE HOUSEHOLDS are requested to use existing return facilities for used equipment. Return is free of charge. If the equipment has been used for BUSINESS PURPOSES, please contact your SHARP dealer who will inform you about take-back. You might be charged for the costs arising from take-back. Small equipment (and small quantities) might be taken back by your local collection facility. For Spain: Please contact the

established collection system or your local authority for take-back of your used products.

In other Countries outside the EU

- If you wish to discard this product, please contact your local authorities and ask for the correct method of disposal.
- For Switzerland: Used electrical or electronic equipment can be returned free of charge to the dealer, even if you don't purchase a new product. Further collection facilities are listed on the homepage of www.swico.ch or www.sens.ch.

Information on Disposal for Business Users

In the European Union

If the product is used for business purposes and you want to discard it:

- Please contact your SHARP dealer who will inform you about the take-back of the product. You might be charged for the costs arising from take-back and recycling.
- Small products (and small amounts) might be taken back by your local collection facilities.
- For Spain: Please contact the established collection system or your local authority for take-back of your used products.

In other Countries outside the EU

- If you wish to discard of this product, please contact your local authorities and ask for the correct method of disposal.

OPERATION PRINCIPLE

The illustration in this instruction manual is UA-KIL80E.

FEATURES

Unique Combination of Air Treatment Technologies

Plasmacluster



HIGH-DENSITY 25000 *

- Plasmacluster treats the air similar to the way nature cleans the environment by emitting a balance of positive and negative ions.

“Plasmacluster” and “Device of a cluster of grapes” are trademarks of Sharp Corporation.

* The number in this technology mark indicates an approximate number of ions supplied into air of 1 cm³, which is measured around the centre of a room applicable floor area (at 1.2 m height above the floor) when the product is placed close to a wall at the MED mode setting.

Triple Filtration System + Humidification

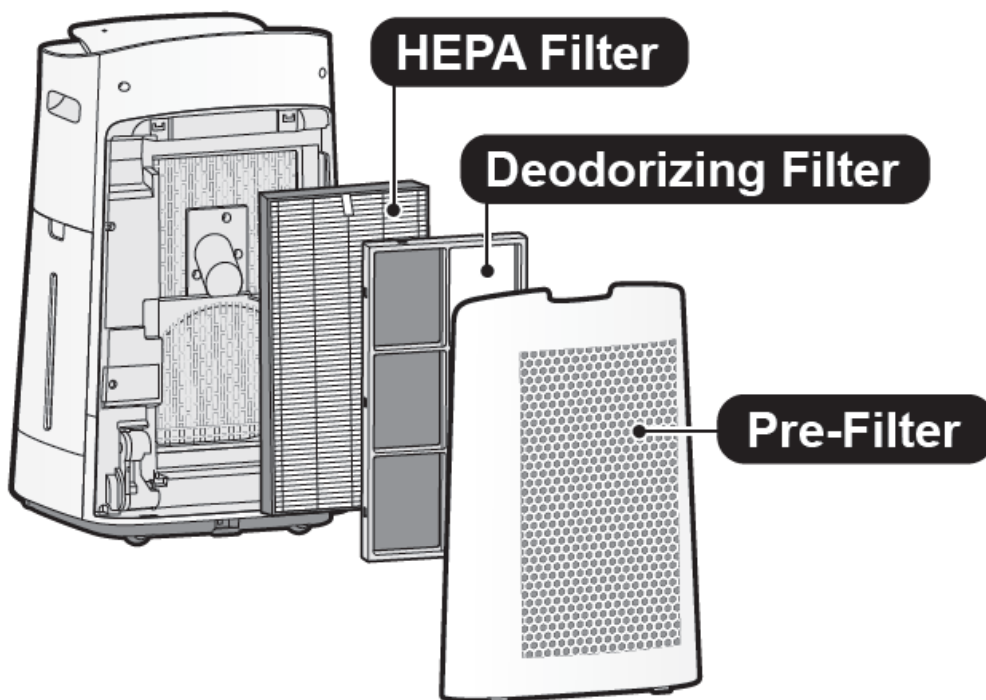

- Pre-Filter
 - Pre-filter traps dust larger than approx 240 micron particles.
- Deodorizing Filter
 - Deodorizing filter absorbs many common household odours.
- HEPA Filter
 - HEPA filter traps 99.97% of particles as small as 0.3 microns.
- Humidifying Function

- Comfortable Humidity Indoors Keeps Your Skin and Throat Moisturized and Healthy.

Unique Airflow

- Powerful air suction and unique airflow quickly and efficiently collect dust and other particles.

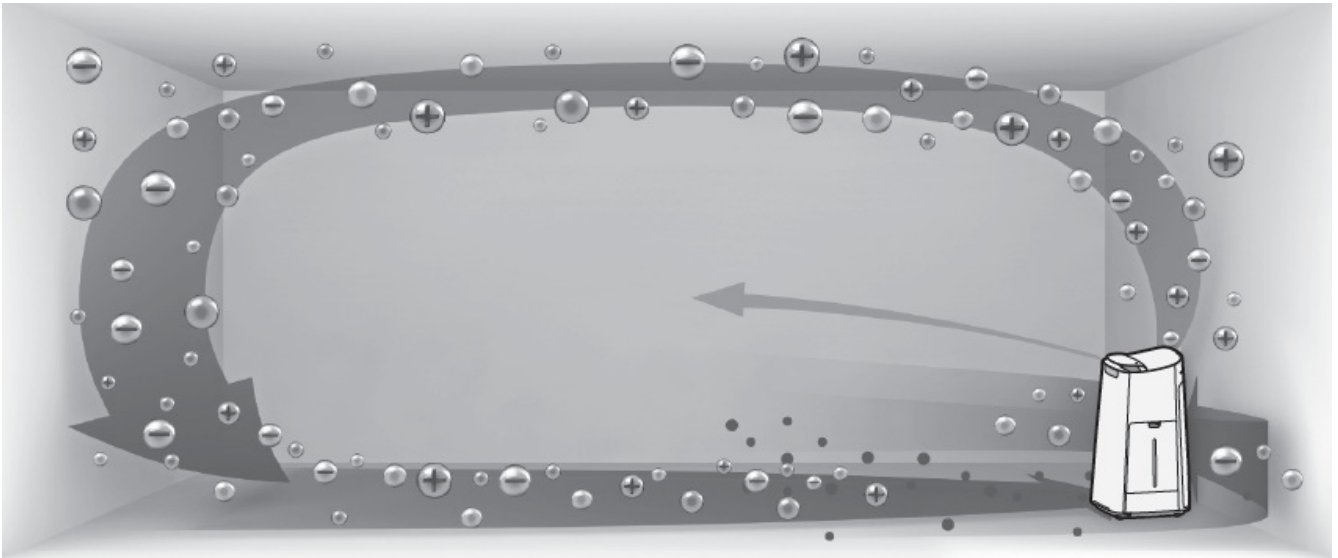

- Faster airflow at a 20° angle collects dust at lower levels in the room for more effective cleaning.
- Plasmacluster can remove static electricity and can thus prevent dust from attaching to walls and other surfaces.

PRE-FILTER AUTO CLEANING (Only UA-KIL80E)

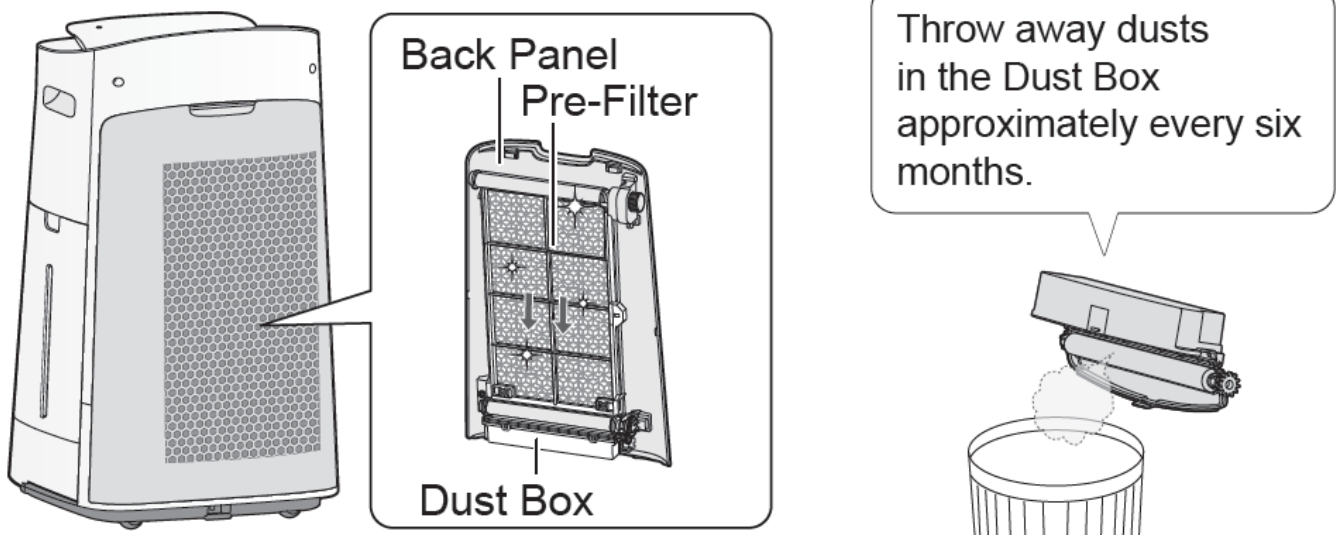

- Removing dusts trapped and held on the Pre-Filter by the auto cleaning unit will help in prevent impairing the efficiency of the dust collecting performance.

Please read before operating your new Air Purifier

- The air purifier draws in room air through the Air Inlet, circulates it through a Pre-Filter, a Deodorizing Filter and a HEPA Filter inside the product, and then discharges it through the Air Outlet. The HEPA Filter can remove 99.97% of dust particles as small as 0.3 microns that pass through the filter and also helps absorb odours.

- The Deodorizing Filter gradually absorbs odours as they pass through the filter.
- Some odours absorbed by the filters will break down over time, causing additional odours.
- Depending on usage conditions, and especially if the product is used in environments significantly more severe than a normal household, these odours may become noticeable sooner than expected. If these odours persist, replace the filters.
- When minerals in tap water adhere to the filters and become a hard and white, they absorb odours in the room that can cause the emission of an unpleasant odour when the Humidifying
- Filter is dry. (Varies depending on water quality and other environmental factors) If this occurs, perform the Humidifying Filter maintenance.

NOTE

- The air purifier is designed to remove air-suspended dust and the odours.
- The air purifier is not designed to remove harmful gases such as carbon monoxide contained in cigarette smoke.
- The air purifier may not completely remove an odour if the source of the odour is still present.

PART NAMES

*The illustration in this instruction manual is UA-KIL80E.

OPERATION PANEL / FRONT DISPLAY

OPERATION PANEL

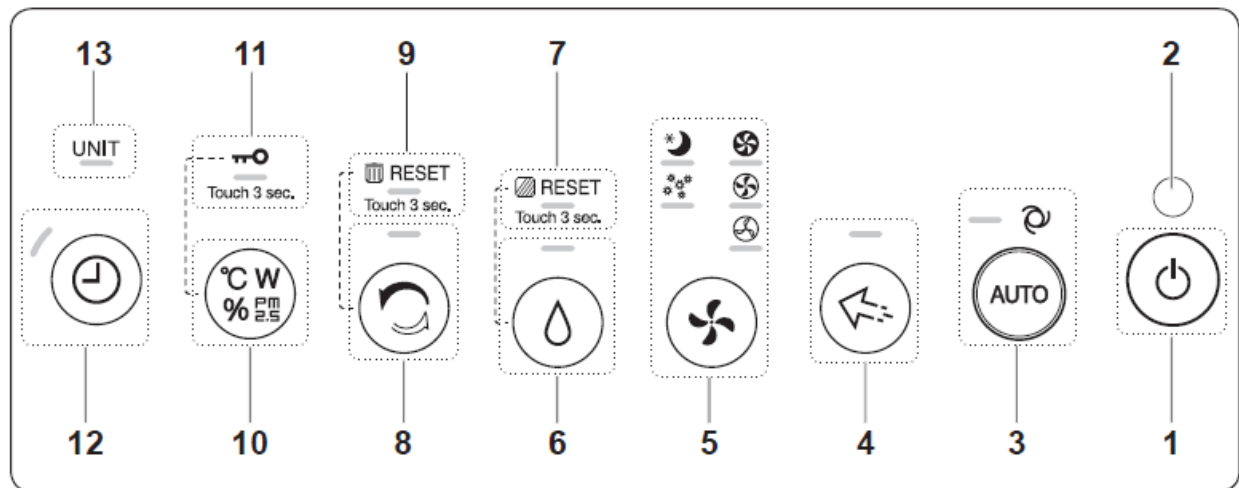

FRONT DISPLAY

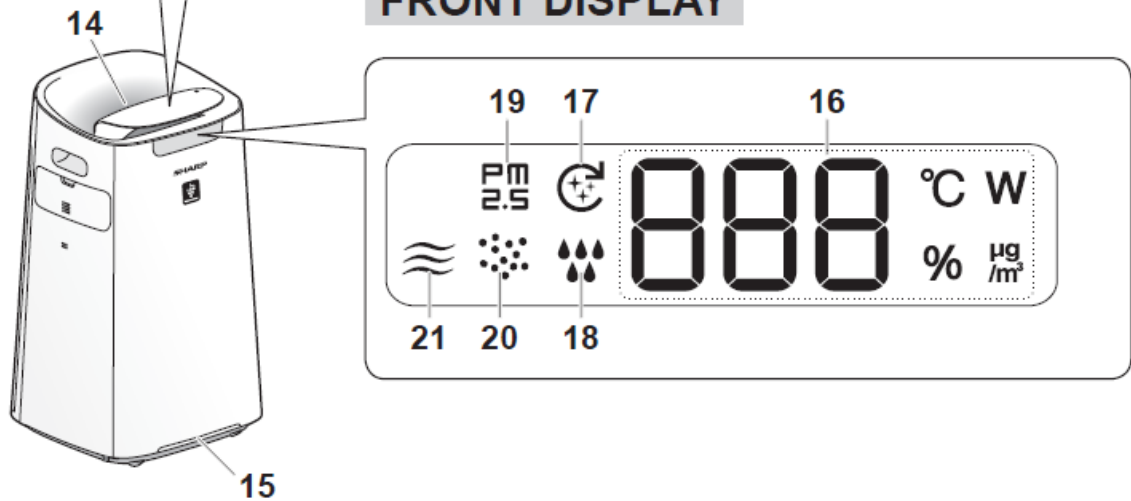

LIGHT SENSOR

- When the Light Control is set to “Auto”, Front Display and Cleanliness Indicator will automatically switch ON or OFF based on room brightness.

NOTE: Detection range of Light sensor

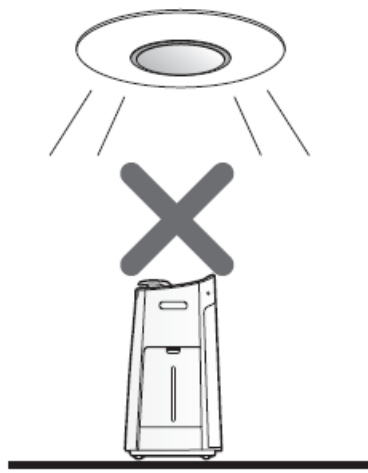

Directly under
a light fixture.

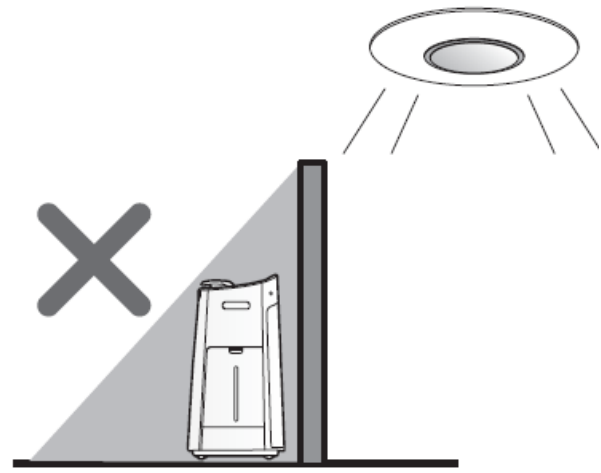

In shadow

- Do not install the product in the following places.
- The Light Sensor may not sense correctly.

1	Power ON/OFF Button
2	Light Sensor
3	Auto Mode Button, Lamp (White)
4	Plasmacluster Ion Spot Button, Lamp (White)
5	Mode Button, Lamps (White)
6	Humidify ON/OFF Button, Lamp (White) ----- (Touch 3 sec.) Filter Reset Button
7	Filter Maintenance Lamp (Orange)
8	Clean Ion Shower Button, Lamp (White) ----- (Touch 3 sec.) Dust Box Reset Button <i>(Only UA-KIL80E)</i>
9	Dust Box Reset Lamp (Orange) <i>(Only UA-KIL80E)</i>
10	Switching Display Button ----- (Touch 3 sec.) Child-Lock Button
11	Child-Lock Lamp (White)
12	ON/OFF Timer Button, Lamp (White)
13	Unit Replacement Lamp (Red)
14	Plasmacluster Ion Indicator (Blue)
15	Cleanliness Indicator • Indicates the air purity of the room with colour changes and flashing speeds. Cleanliness Indicator turns off when the air is clean. When the air changes from dirty to clean, it flashes blue for a while and then turns off. <div style="text-align: center; margin-top: 10px;"> <div style="display: inline-block; text-align: left; vertical-align: middle;"> Clean ↑↓ Impure </div> <div style="display: inline-block; text-align: left; vertical-align: middle; margin-left: 10px;"> Turn off or Blue (Flashing) Yellow (Flashing) Red (Flashing fast) </div> </div>

16	<p>Display</p> <ul style="list-style-type: none"> • Timer Indicates setting time or remaining time of ON/OFF timer. 3H • PM2.5 Concentration* PM2.5 10 µg/m³ to 499 µg/m³ is displayed. 9 µg/m³ or less Lo ↔ 34 ↔ Hi 500 µg/m³ or more • Temperature* Temperature 0 °C to 50 °C is displayed. -1 °C or less Lo °C ↔ 25 °C ↔ Hi °C 51 °C or more • Humidity* Humidity 25 % to 75 % is displayed. 24 % or less Lo % ↔ 55 % ↔ Hi % 76 % or more • Wattage* Indicates wattage by current operation. 28 W <p><small>* The displayed numbers are approximate.</small></p>
17	Pre-Filter Auto Cleaning Indicator (White) (Only UA-KIL80E)
18	Humidifying Indicator White Humidify ON Off Humidify OFF Red (Flashing) the product needs water
19	PM2.5 Indicator (White) Indicates the Sensitive Dust Sensor detects microscopic dust.
20	Dust Indicator (White) Indicates the Sensitive Dust Sensor detects usual dust.
21	Odour Indicator (White) Indicates the Odour Sensor detects odours.

MAIN BODY

The illustration in this instruction manual is UA-KIL80E.

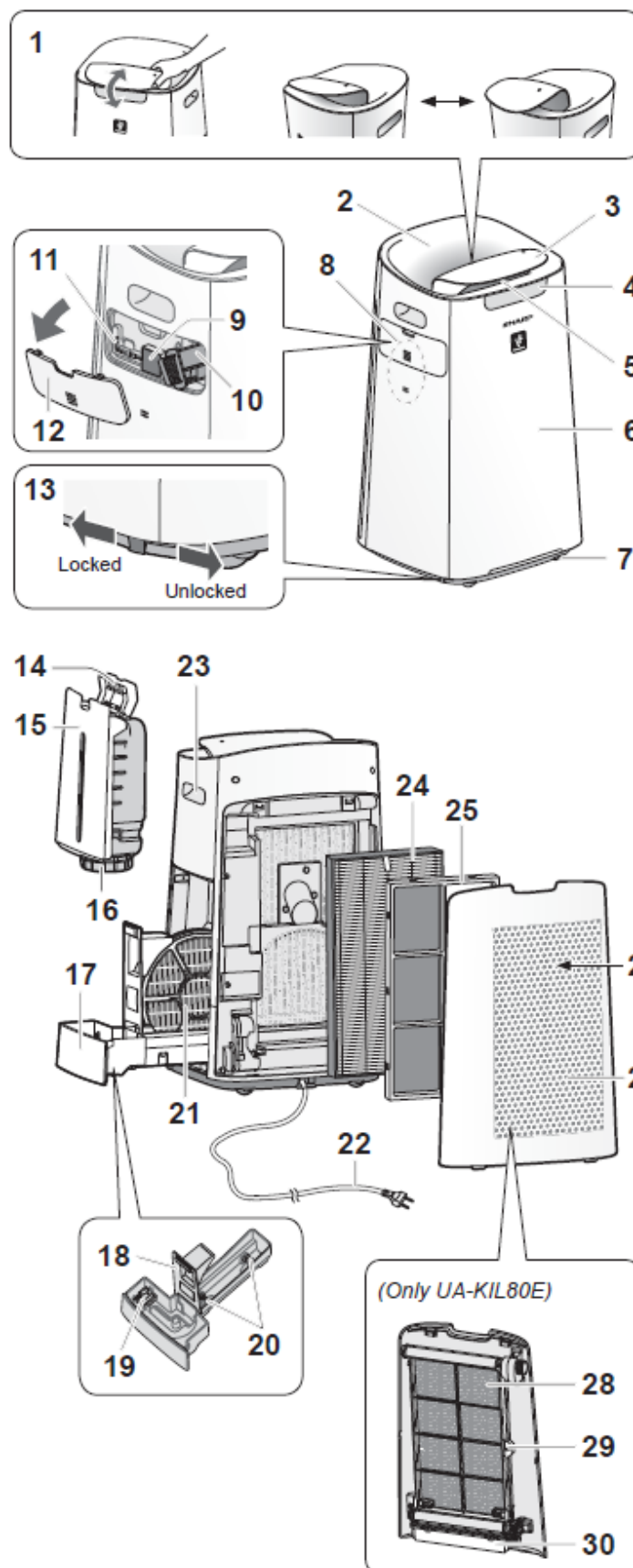

1	Louver
2	Air Outlet (Back)
3	Operation Panel
4	Front Display

5	Air Outlet (Front)
6	Main Body
7	Caster (4 Locations)
8	Sensor (Internal) Temperature / Humidity / Sensitive Dust / Odour
9	Sensor Filter
10	Unit* Holder (Plasmacluster Ion Generating Unit)
11	Unit* Cleaning Brush
12	Unit* Cover
13	Caster Stopper (Right & Left)
14	Tank Handle
15	Water Tank
16	Tank Cap
17	Humidifying Tray
18	Tray Panel
19	Float
20	Roller
21	Humidifying Filter
22	Power Cord, Plug
23	Handle (2 Locations)
24	HEPA Filter
25	Deodorizing Filter
26	Air Inlet
27	Back Panel with Pre-Filter (Only UA-KIL60E)

	Back Panel <i>(Only UA-KIL80E)</i>
28	Pre-Filter <i>(Only UA-KIL80E)</i>
29	Pre-Filter Lock <i>(Only UA-KIL80E)</i>
30	Dust Box <i>(Only UA-KIL80E)</i>

The Unit refers to Plasmacluster Ion Generating Unit. (The same as below.)

BEFORE FIRST USE



Always be sure to remove the power plug from the wall outlet.

FILTER INSTALLATION

1. Remove the Back Panel.

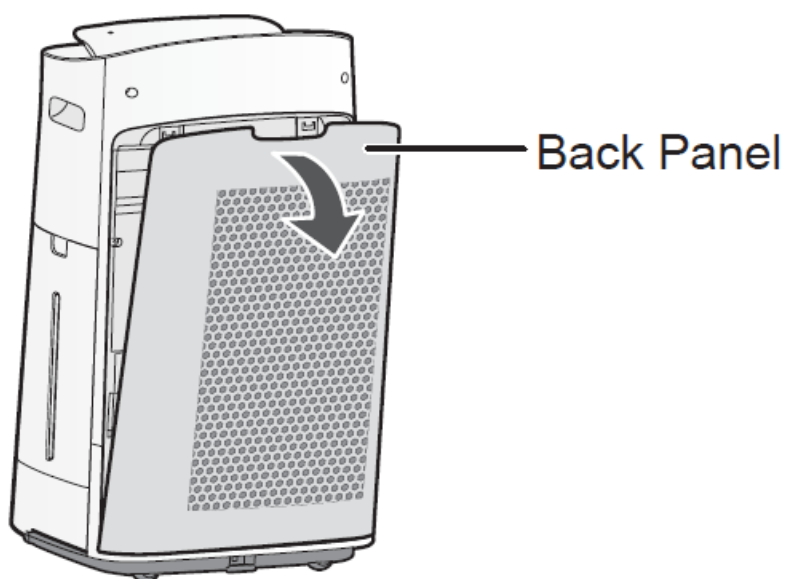

2. Remove the plastic bag from the each filter.

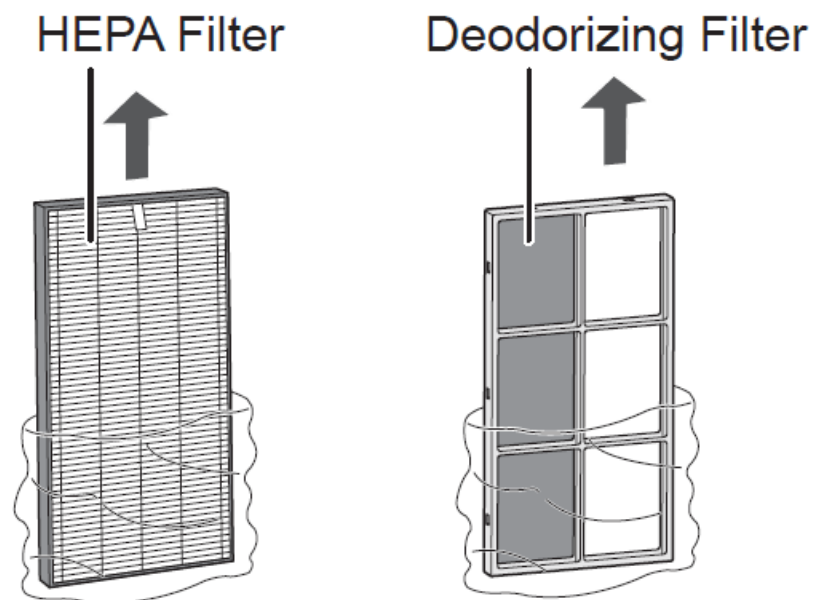

3. Install the filters in the correct order as shown.

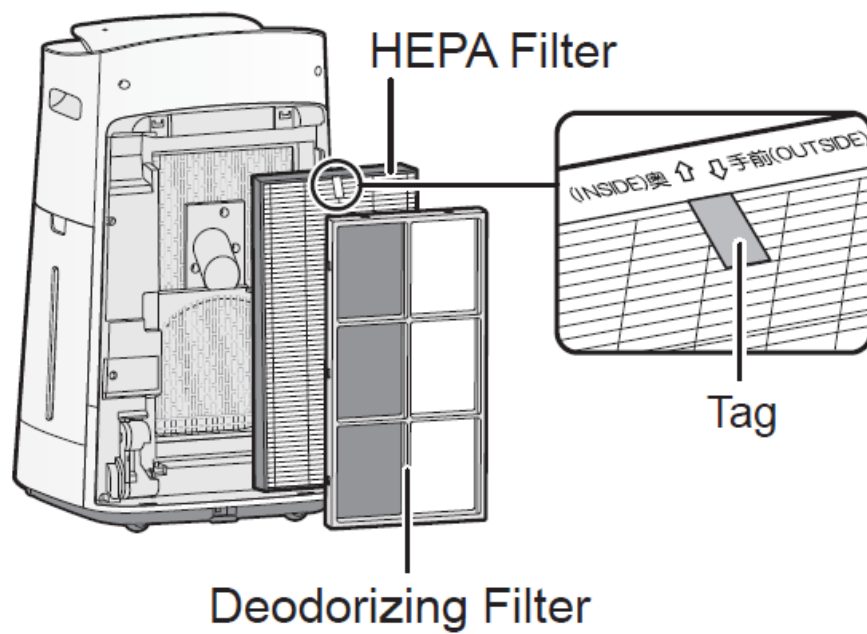

4. Install the Back Panel.

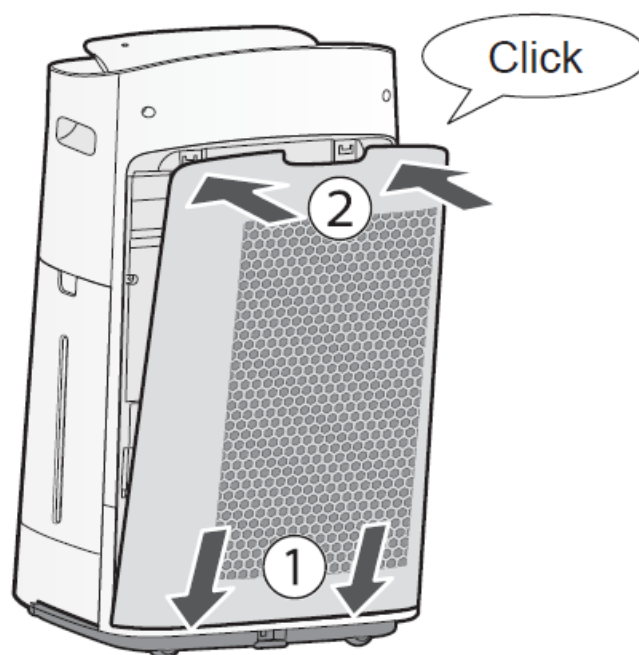

NOTE

- When replacing the filter, making a memo of the start of use date is recommended.

REFILLING THE WATER TANK

1. Remove the Water Tank.

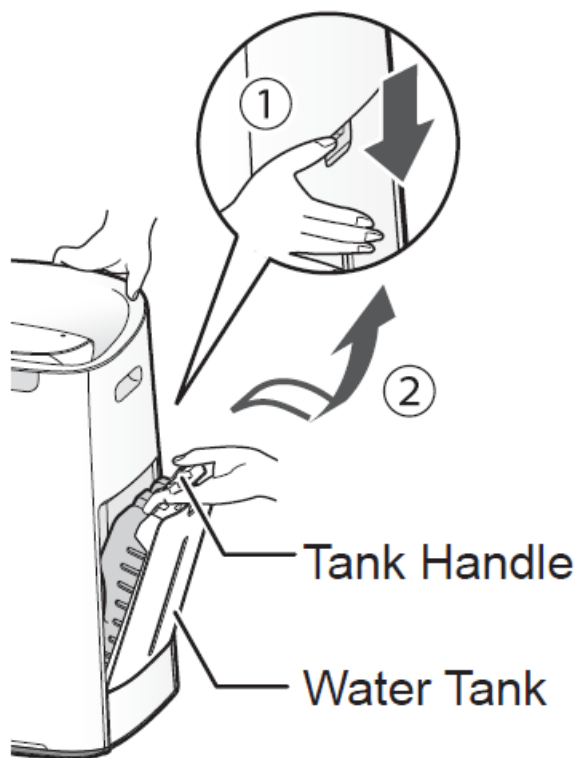

2. Fill the Water Tank with the tap water.

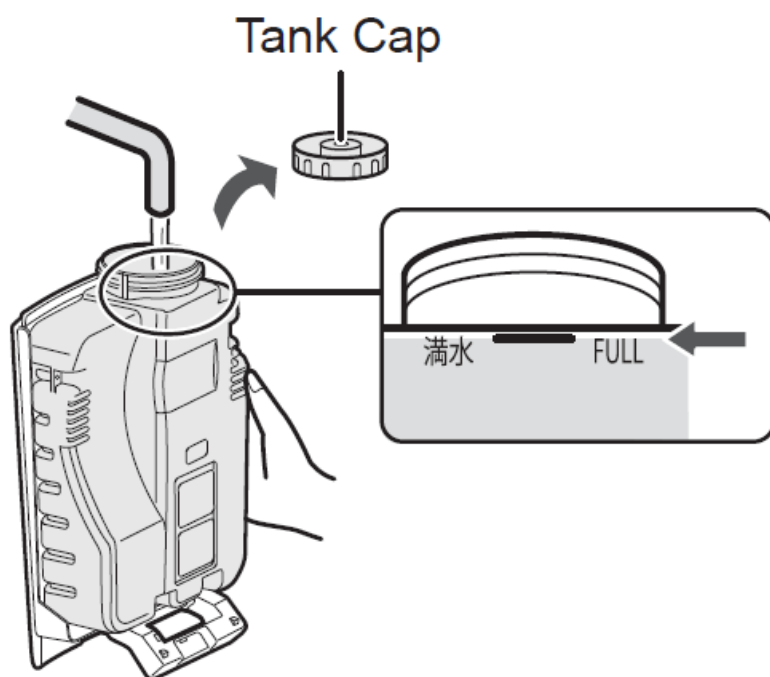

3. To prevent leaks, securely tighten the Tank Cap.

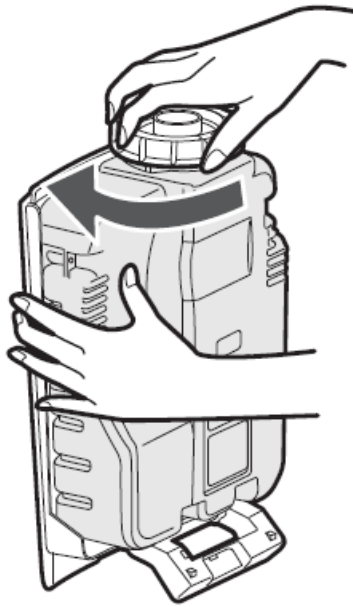

4. Install the Water Tank.

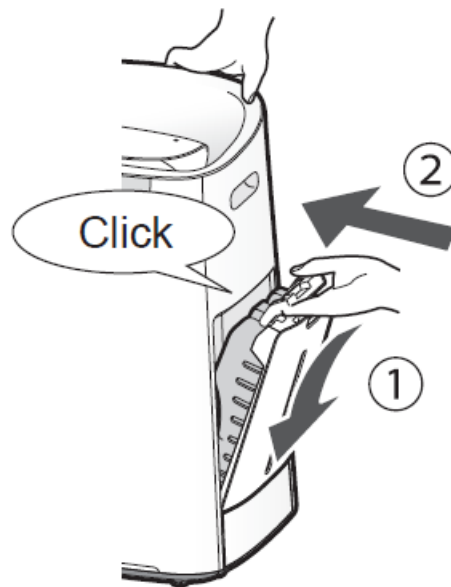

OPERATION

START/STOP

START



STOP



NOTE

- When the product starts operation, the operation starts in the previous mode it was operated in.

AUTO MODE



- The fan speed is automatically controlled depending on the six detection. (PM2.5 / Usual dust / Odour / Temperature / Humidity / Light)

PLASMACLUSTER ION SPOT MODE

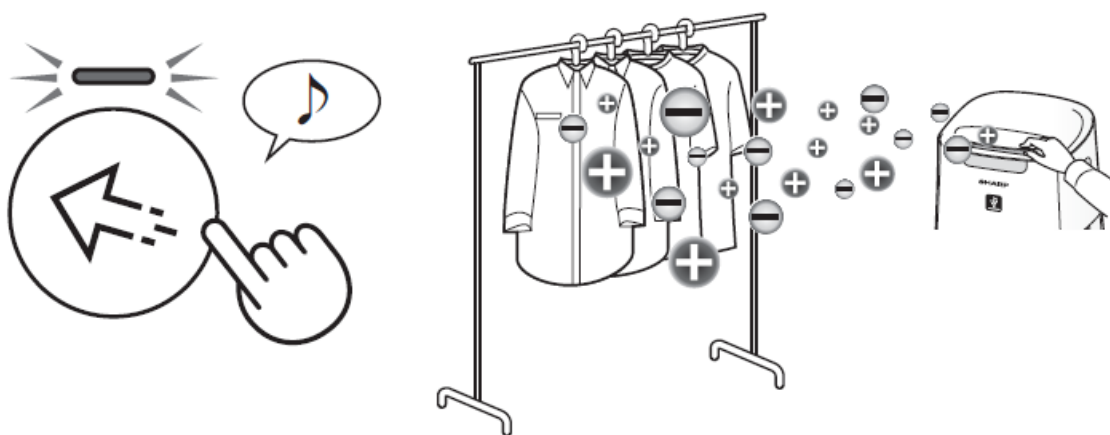

Adjust Front Louver manually.

- Use this mode when you want to remove adhering odour, germs, and other substances from clothes, sofas and curtains.
- Discharges stronger air with high-density Plasmacluster ions only in the forward direction.

NOTE

- The Plasmacluster ion cannot be turned "OFF".

SELECT AIR VOLUME AND MODE

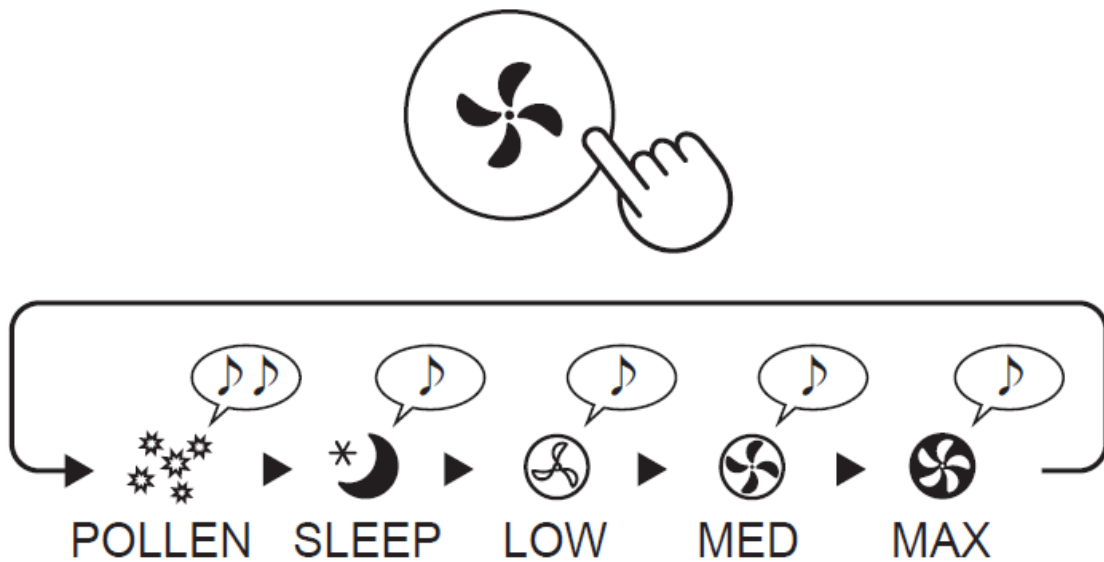

POLLEN:

- The Sensitive Dust Sensor sensitivity is automatically increased and quickly detects impurities such as dust and pollen and clean the air powerfully.

SLEEP:

- The product will operate quietly, and the fan speed is automatically switched depending on the amount of impurities in the air.
- When the Light Control is set to “Auto”, Front Display and Cleanliness Indicator automatically go off.

HUMIDIFICATION SETTING

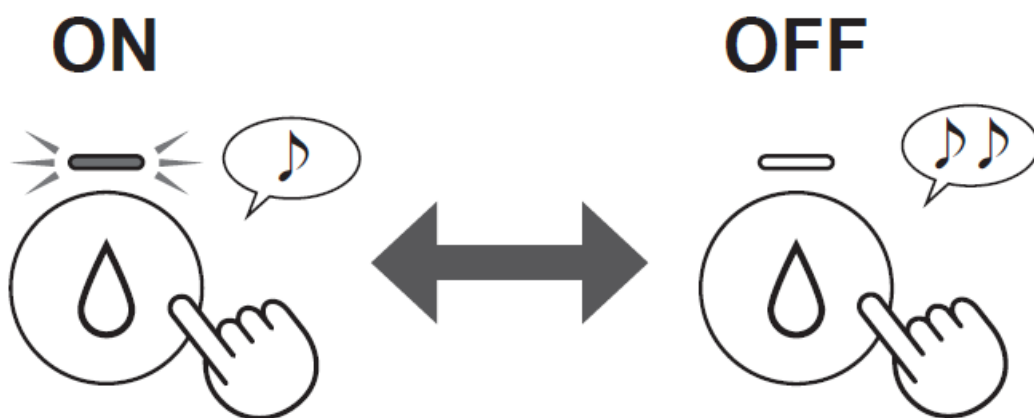

NOTE

- When operating with humidification ON in the modes in the table below, the product automatically controls humidity by sensing temperature and humidity. (Except MAX / MED / LOW mode.)

Temperature	Humidity	
	ALL MODE (Except MAX / MED / LOW / SLEEP)	SLEEP MODE
– 18 °C	65 %	65 %
18 °C – 24 °C	60 %	65 %
24 °C – 28 °C	55 %	60 %
28 °C –	45 %	50 %

CLEAN ION SHOWER MODE



The product releases Plasmacluster ions with strong airflow and collects dusts while decreasing static electricity for 10 minutes. After that, the Sensitive dust sensor sensitivity is automatically increased and quickly detects impurities and clean the air powerfully for 50 minutes.

NOTE

- When the operation finishes after 60 minutes, the product will return to the prior operation mode. It is able to change the other mode during this mode.
- The Plasmacluster ion cannot be turned “OFF”.

CHILD LOCK

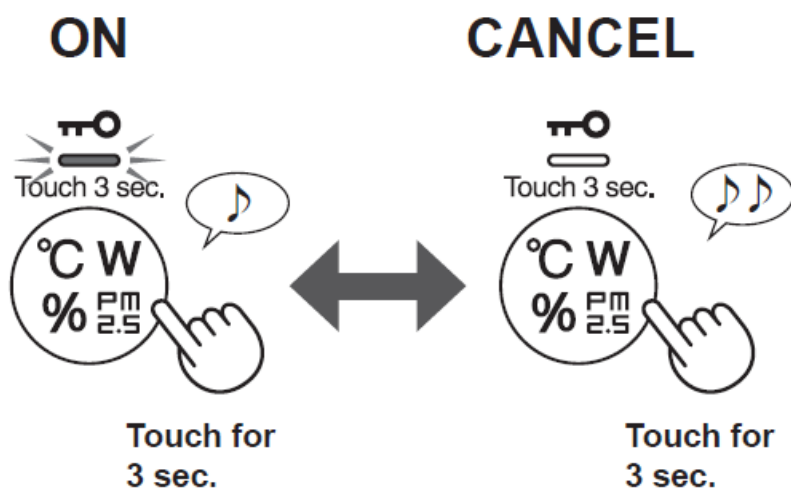

- The operation panel will be locked.

SWITCH DISPLAY

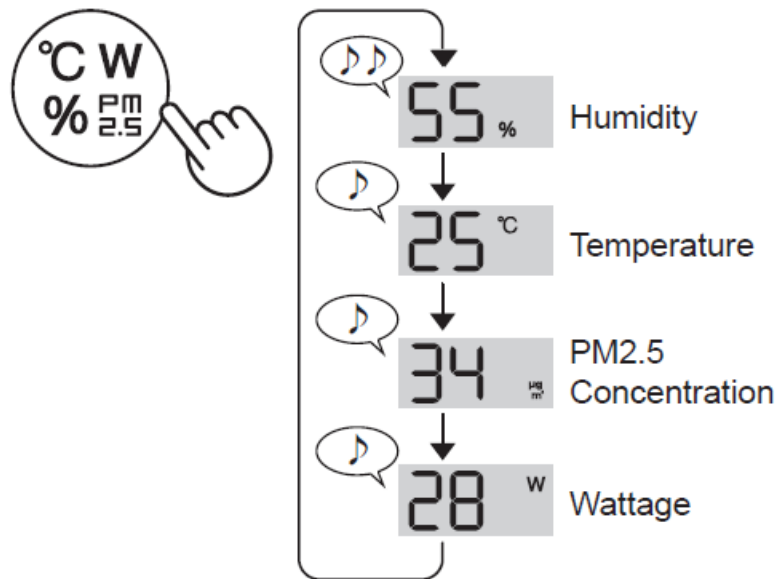

ON/OFF TIMER

- ON TIMER:
 - Select the length of time you want. The product automatically starts once the selected time is passed.
- OFF TIMER:
 - Select the length of time you want. The product automatically stops once the selected time is reached.

(ON TIMER: with the product OFF)

(OFF TIMER: with the product ON)

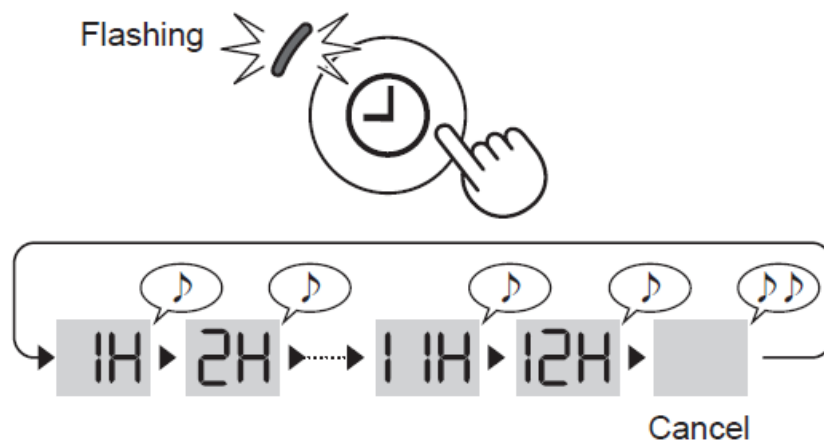

NOTE

- ON TIMER:
 - If there is no operation in 8 seconds, the setting will be finished with a beep. The ON/ OFF TIMER Lamp will be on and display the remaining hour before the operation starts.
 - You may reset the timer by touching the ON/ OFF Timer Button again.
- OFF TIMER:

- If there is no operation in 8 seconds, the setting will be finished with a beep. The Display will be back to its previous status.
- After the setting is done, touch once the ON/ OFF Timer Button, the remaining hour of the operation will show, and touch twice, you may reset the timer.

PRE-FILTER AUTO CLEANING

(Only UA-KIL80E)

The pre-filter auto cleaning will operate for about 8 minutes automatically when the product reaches a certain operating time since a completion of the previous pre-filter auto cleaning. During the pre-filter auto cleaning, the on-going operation will be suspended. You can set the pre-filter auto cleaning interval to 48 hours or 720 hours. The default is 48 hours.

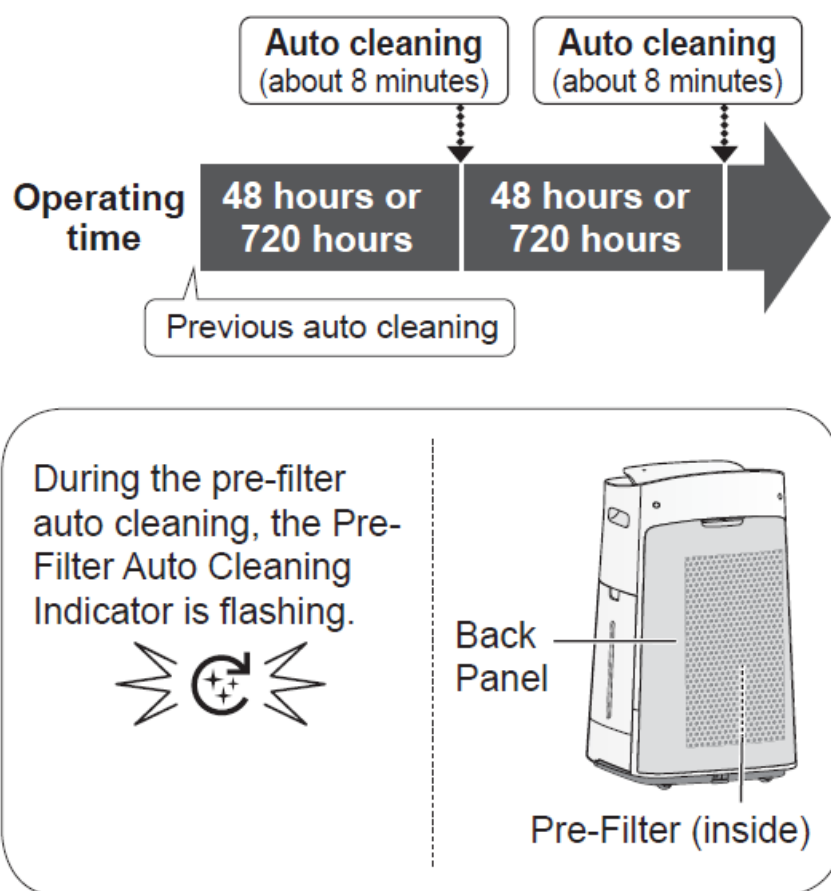

NOTE

- Depending on the conditions, the start of auto cleaning maybe delayed.
 - (Example: When the light sensor detects that the room brightness is “dark”.)



- If you want to stop the auto cleaning, touch Power ON/OFF Button.
- If you want to start the auto cleaning manually, Please touch Auto Mode Button and Mode Button 3 seconds at once.

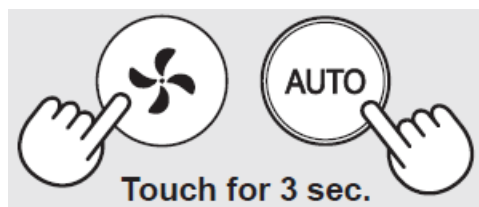

HOW TO CHANGE VARIOUS SETTING

You can change the functions in the table.

1. (with the product OFF)



2. Select "Function number".

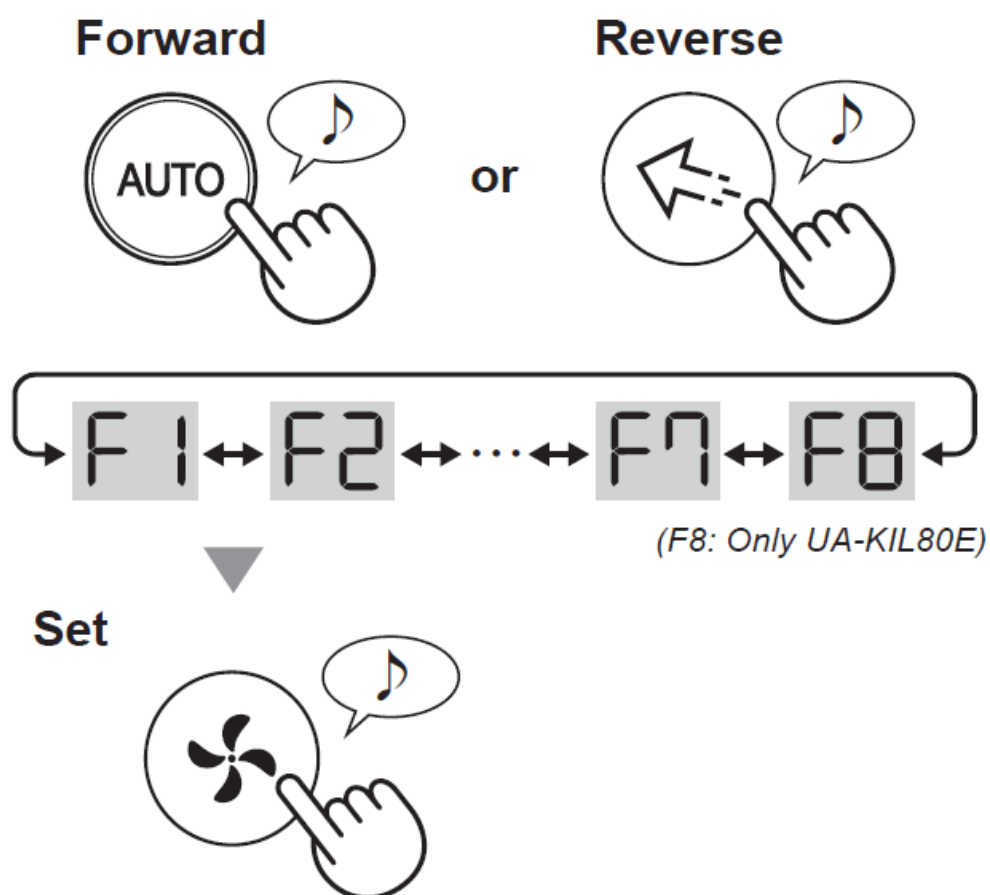

3. Select "Setting number".

Forward



or

Reverse



Set



4. Touch Power ON/OFF Button to finish the setting mode.



Turn off

Function	Setting
F1 Light Control You can select the brightness of the Front Display and Cleanliness Indicator.	01 Turn off When set to "Turn off", the "Dim" light illuminates for 8 seconds after operation starts and then the light turns off. The Humidifying Indicator flashes darker only when the product needs water. The Unit Replacement Lamp flashes darker only when the Plasmacluster Ion Generating Unit need to be replaced. 02 Dim 03 Auto (default) Light automatically switches ON or OFF based on room brightness. Room is bright : light is ON / Room is dark : light is OFF Even though room is bright, the light will turn off when operating in sleep mode.
F2 Plasmacluster Ion ON/OFF	01 OFF 02 ON (default)
F3 Auto restart If the product is unplugged or if there is a power failure, the product will resume operation with the previous settings after power is restored.	01 Cancellation 02 ON (default)
Adjusting sensor sensitivity (F4 - F6)	
F4 Light Sensor	01 Low
F5 Sensitive Dust Sensor	02 Standard (default)
F6 Odour Sensor	03 High
F7 Sound Indicator Setting You can set the product to make a beeping sound when the Water Tank is empty.	01 Cancellation (default) 02 ON
F8 The interval of Pre-Filter Auto Cleaning <i>(Only UA-KIL80E)</i>	01 720 hours 02 48 hours (default)

CARE AND MAINTENANCE



Always be sure to remove the power plug from the wall outlet.

CARE INDEX

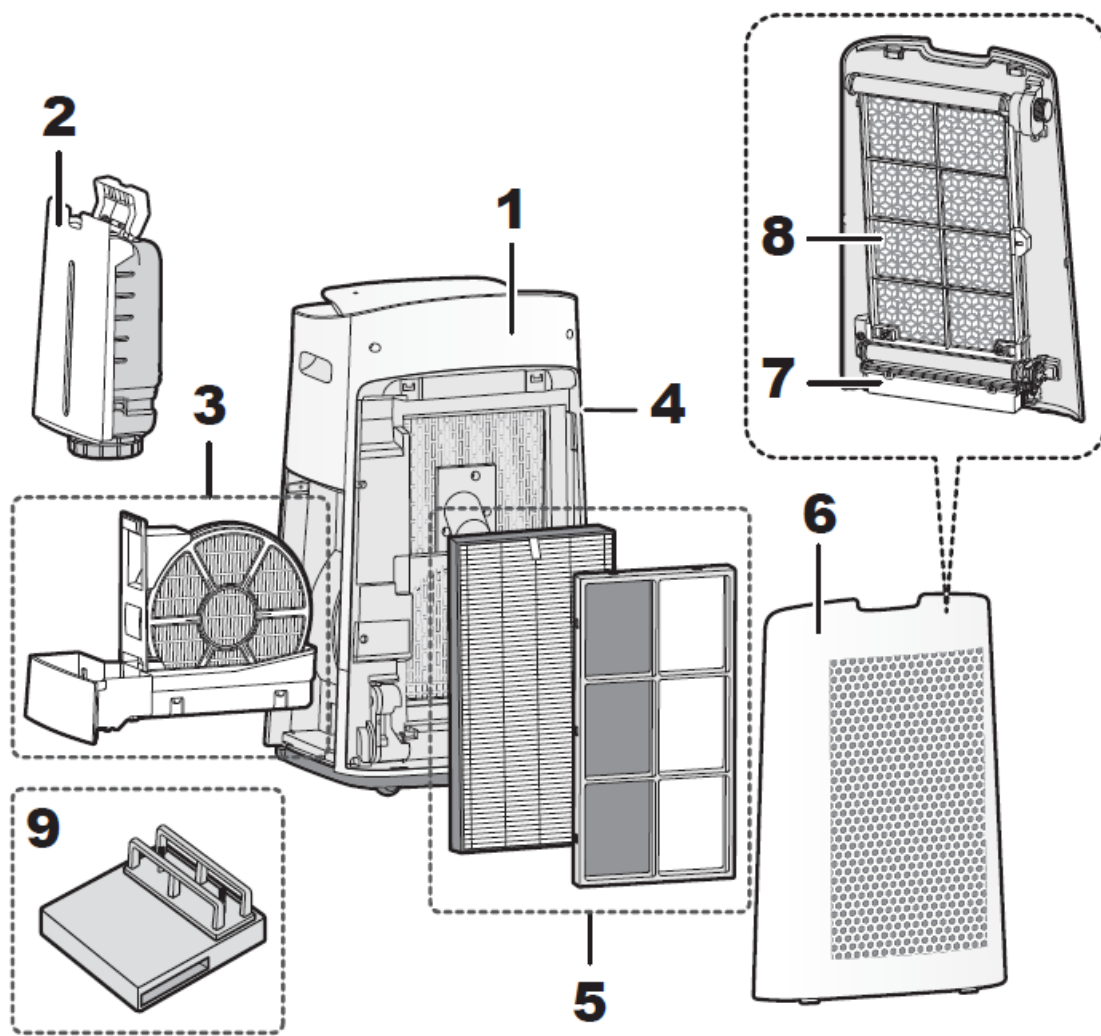

Place	
1	Main Body
2	Water Tank
3	Humidifying Filter / Humidifying Tray
4	Sensors
5	HEPA Filter / Deodorizing Filter
6	Back Panel with Pre-Filter (Only UA-KIL60E) Back Panel <i>(Only UA-KIL80E)</i>
7	Dust Box <i>(Only UA-KIL80E)</i>
8	Pre-Filter <i>(Only UA-KIL80E)</i>
9	Plasmacluster Ion Generating Unit

FILTER MAINTENANCE LAMP

When the cumulative operation period or the water containing period is more than approximately 720 hours, the Filter Maintenance Lamp will turn on.

- The Lamp is off when there is no water filled. (Only UA-KIL80E)
- It will not calculate the time when the product is unplugged.
- 30 days × 24 hours = 720 hours

This is a reminder to perform the maintenance described Humidifying Filter and Tray, Main Body, Back Panel, and Sensors. After performing maintenance, reset the Filter Maintenance Lamp.

RESET



MAIN BODY



- Wipe with a dry, soft cloth.

WATER TANK



- Rinse the inside with water.

NOTE: How to clean hard to remove dirt.

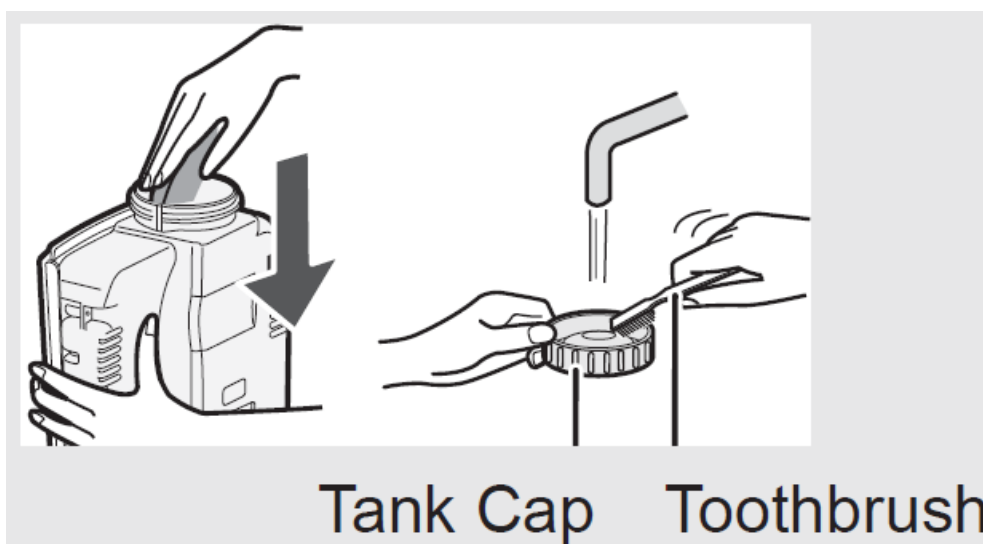

- Clean the inside of the Water Tank with a soft sponge and the Tank Cap with a cotton swab or toothbrush.

HUMIDIFYING FILTER / HUMIDIFYING TRAY

1. Remove the Humidifying Filter and Tray.

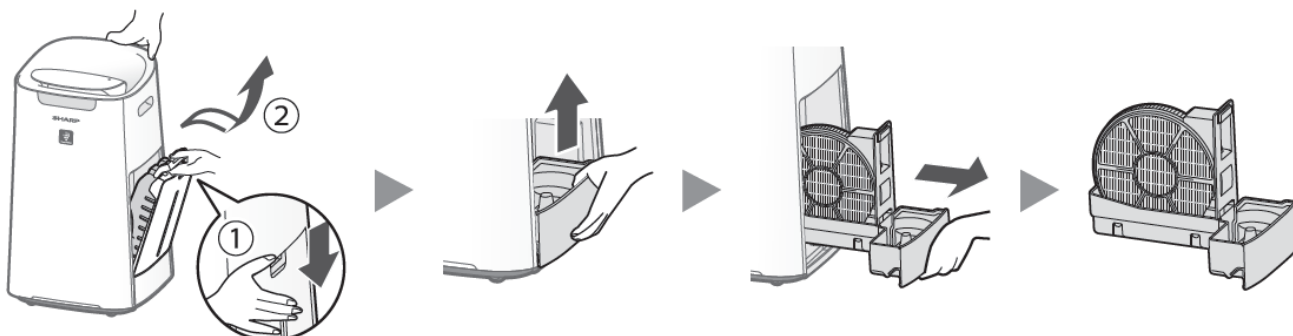

2. Rinse with plenty of water.

- Do not remove the Float and the Rollers. If they come off , refer to below.

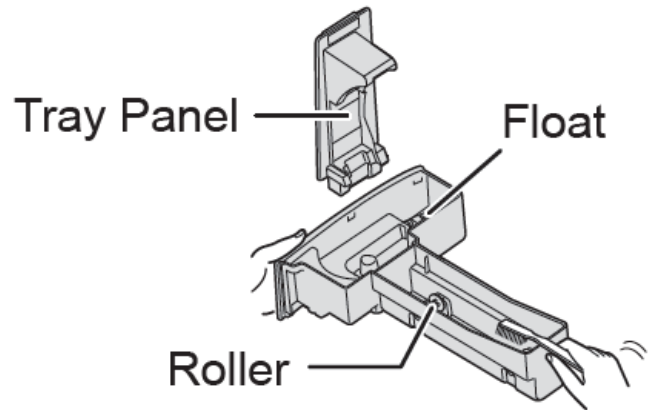
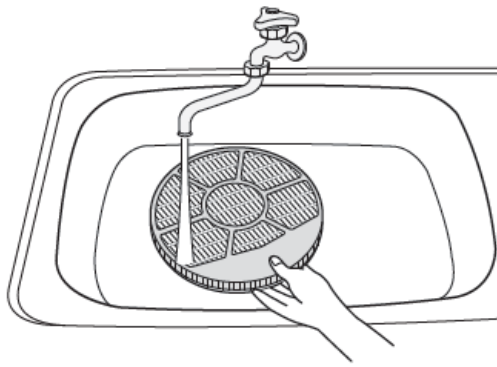

3. Attach the Humidifying Filter and Tray.

- After maintenance, correctly reattach the parts.

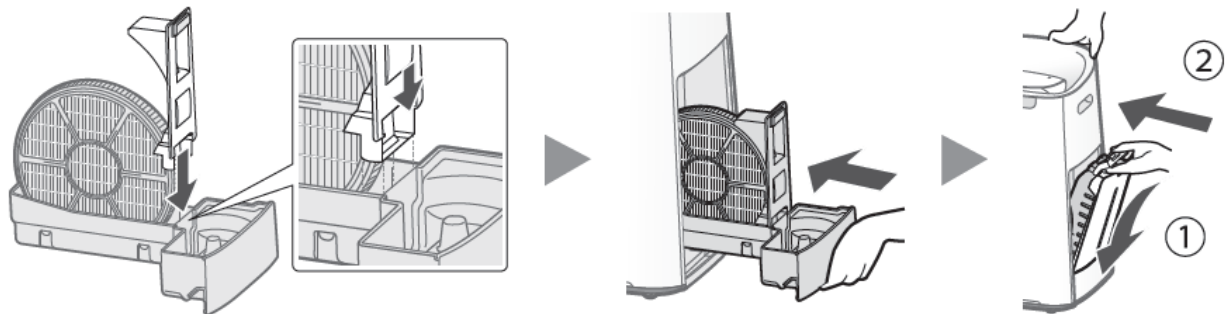

NOTE: How to clean hard to remove dirt.

	Kitchen detergent (only Humidifying tray)	Citric acid (available at some drugstores)	100% bottled lemon juice with no pulp
1	1. Fill the tray half-way with water. 2. Add a small amount of kitchen detergent.	2 1/2 cups of water 3 teaspoons	3 cups of water 1/4 cup
2	Soak for 30 minutes.	Soak for 30 minutes.	Soak for 30 minutes. (When using lemon juice as your descaling solution, allow for more soak time.)
3	Rinse off the kitchen detergent or the descaling solution with clean water.		

NOTE: How to install the Float and the Rollers

Float

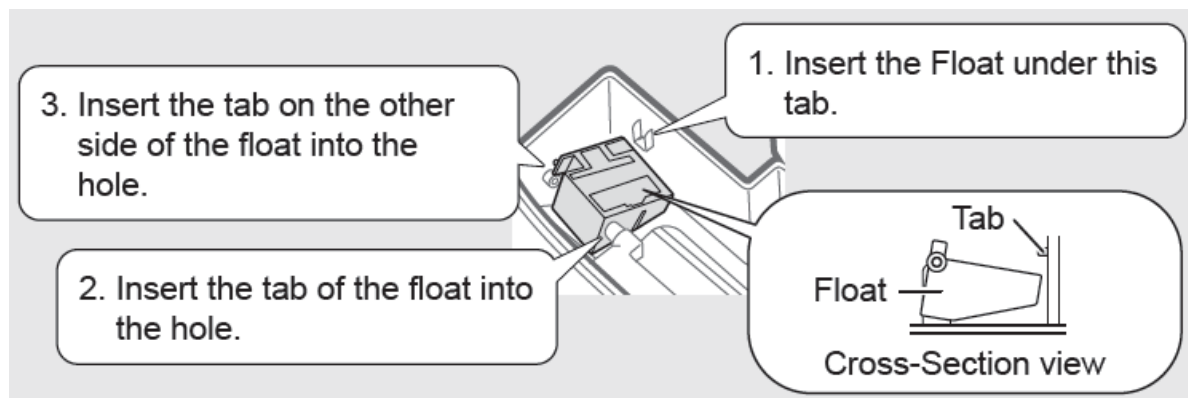

Roller

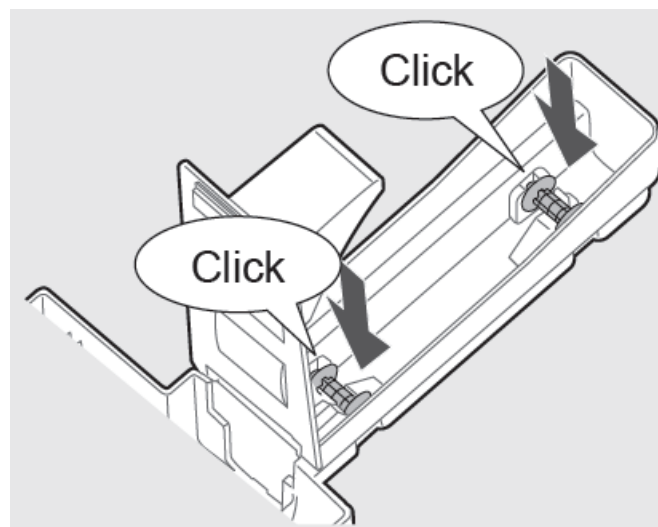

SENSORS

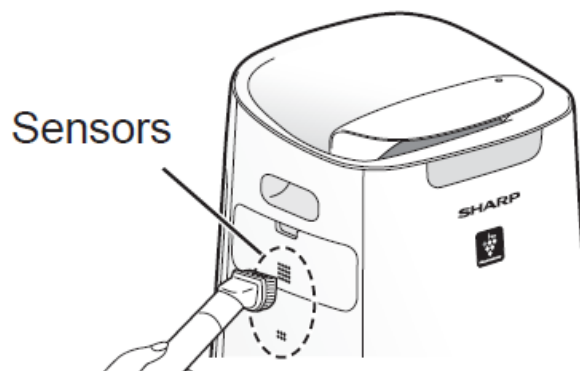

- Remove the dust gently with a cleaning tool such as a vacuum cleaner.

NOTE: How to clean hard to remove dirt.

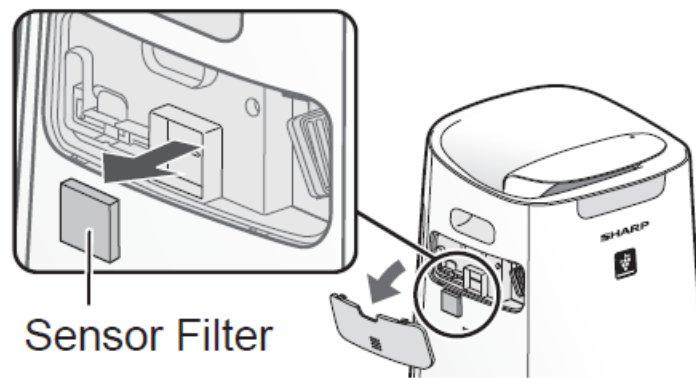

1. Remove the Unit Cover.
2. Remove the Sensor Filter.
3. If the Sensor Filter is very dirty, wash it with water and dry it thoroughly.

HEPA FILTER / DEODORIZING FILTER

- Remove the dust on the filters.

HEPA Filter

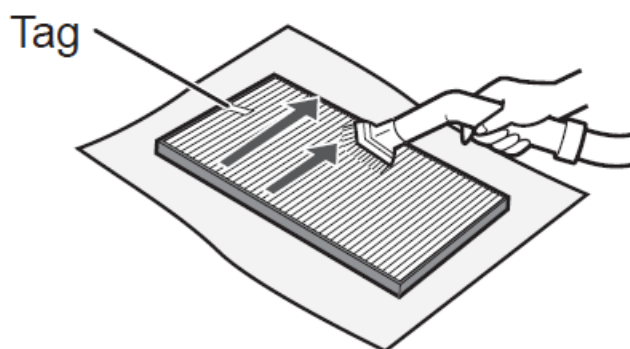

- Clean only the tagged surface. Do not clean up the opposite surface. The filter is fragile, so be careful not to give too much pressure.

Deodorizing Filter

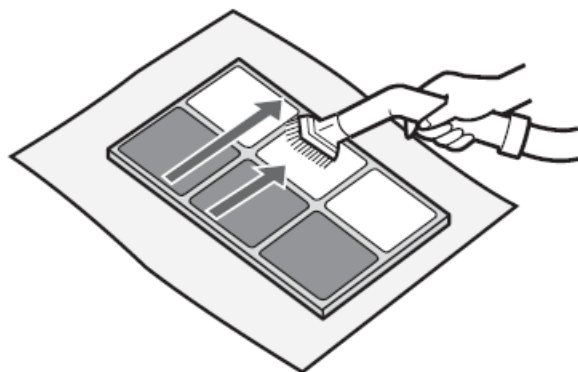

- Both surfaces can be cleaned. The filter may be broken if being too much pressure is applied on it, so please handle it with care.

NOTE

- Do not wash the filters. Do not expose to sunlight. (Otherwise these filters may lose efficacy.)
- Some odours absorbed by the filters will break down over time, causing additional odours.
- Depending on usage conditions, and especially if the product is used in environments significantly more severe than a normal household, these odours may become noticeable sooner than expected.
- Replace the filter in those cases or if dust is unable to be removed after maintenance.

BACK PANEL WITH PRE-FILTER

(Only UA-KIL60E)

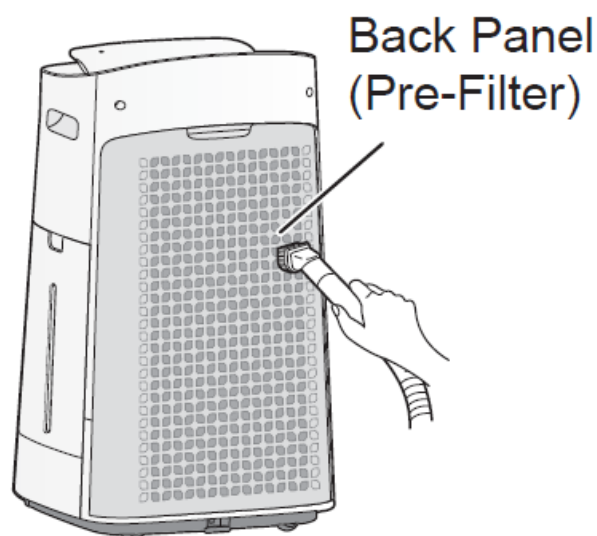

- Remove the dust gently with a cleaning tool such as a vacuum cleaner.

NOTE

- Do not apply excessive pressure when scrubbing the Back Panel.
- How to clean hard to remove dirt.

1. Add a small amount of kitchen detergent to water and soak for about 10 minutes.
2. Rinse off the kitchen detergent with clean water.
3. Completely dry the filter in a wellventilated area.

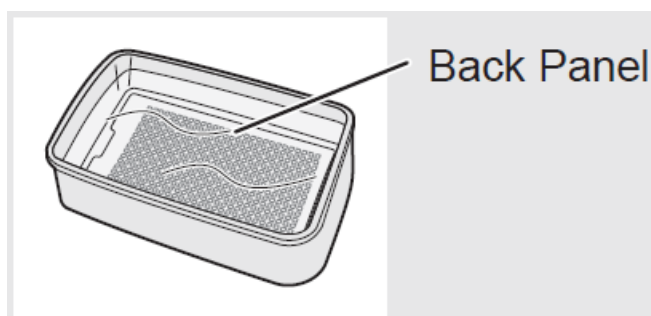

BACK PANEL

(Only UA-KIL80E)

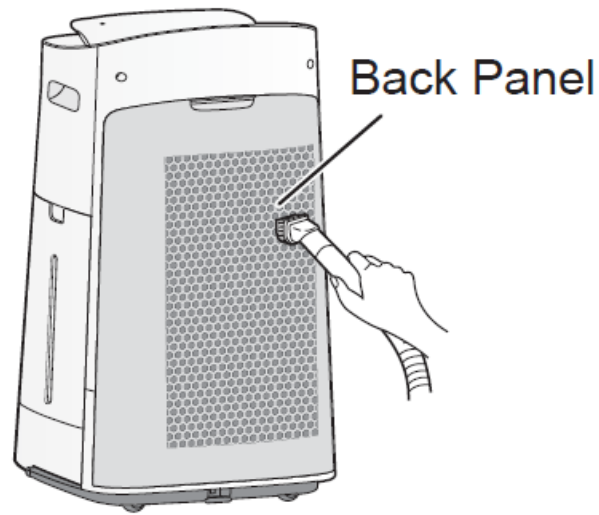

- Remove the dust gently with a cleaning tool such as a vacuum cleaner.

DUST BOX (Only UA-KIL80E)

DUST BOX RESET LAMP



When the Dust Box Reset Lamp will turn on, please throw away the dusts in the Dust Box.

- The Lamp will turn on every 6 months if the product is used for 24 hours per day.

1. Remove the Back Panel.
2. Remove the Dust Box.

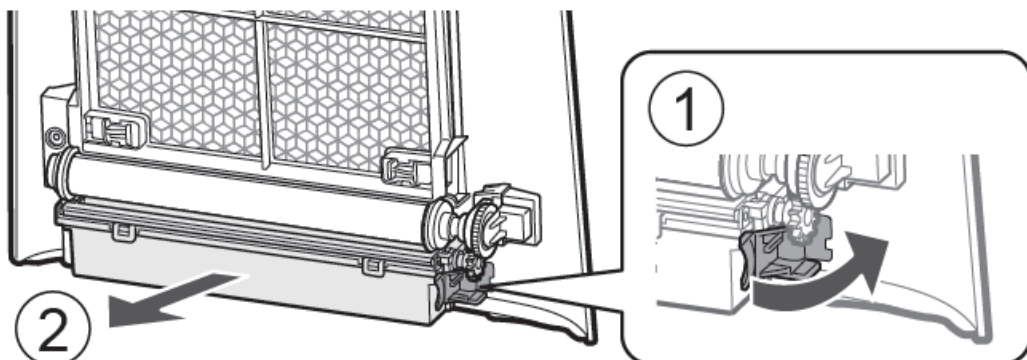

3. Throw away the dusts in the Dust Box.

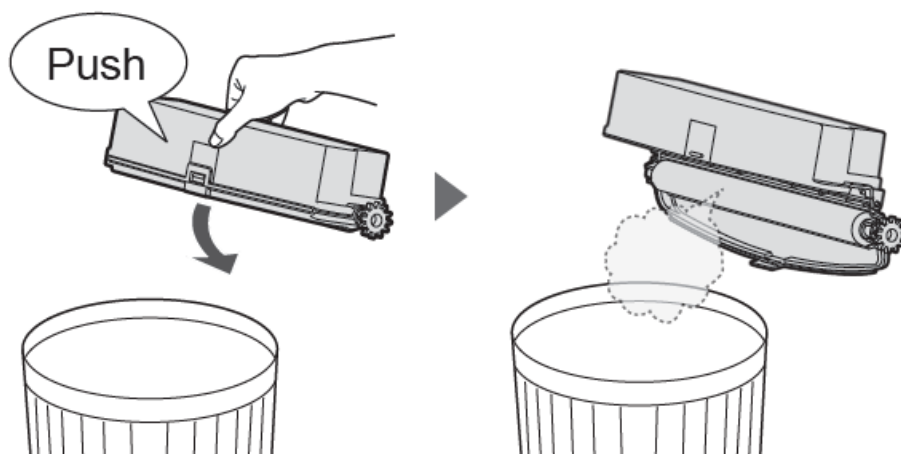

4. Close the cover of the Dust Box.

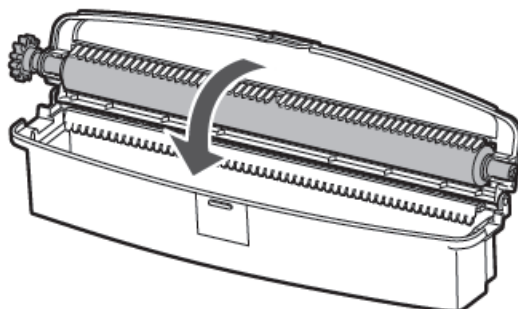

5. Install the Dust Box.

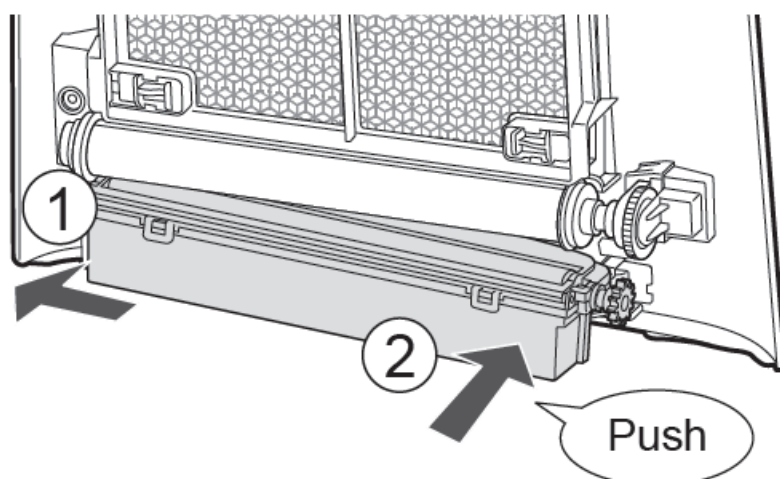

6. Install the Back Panel.

7. Reset the Dust Box Reset Lamp.

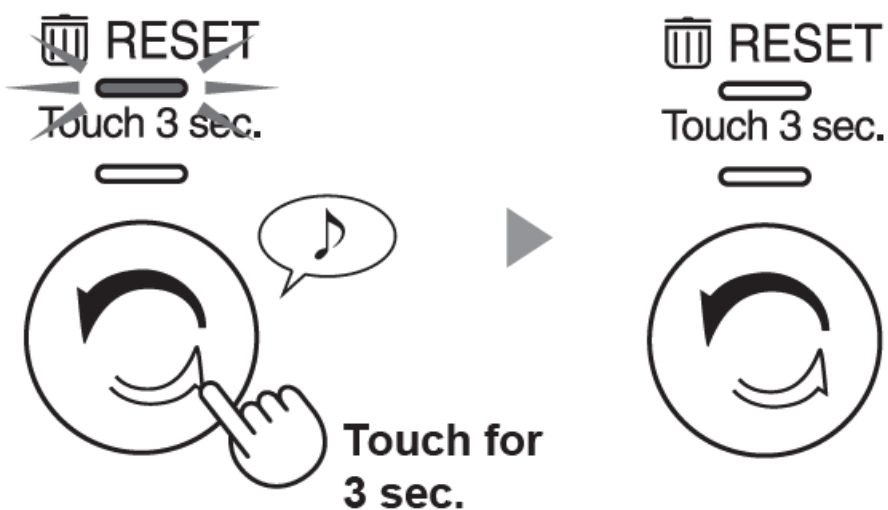

NOTE How to clean hard to remove dirt.

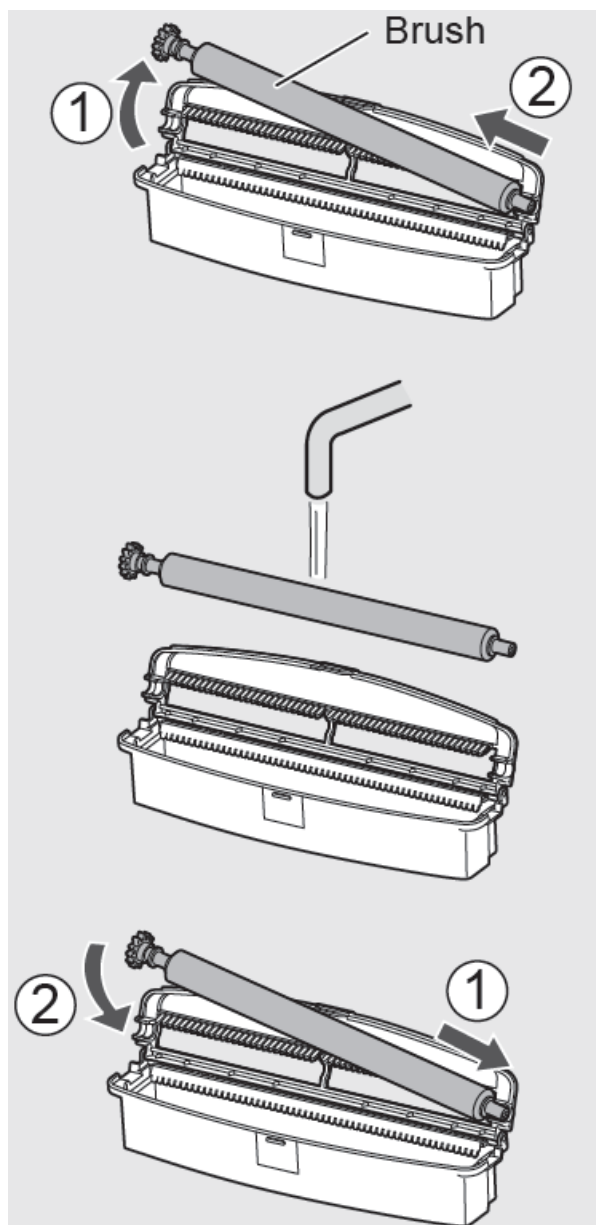

1. Remove the Brush.
2. Wash with water.
 - Dry them thoroughly.
3. Attach the Brush.

PRE-FILTER

PRE-FILTER (Only UA-KIL80E)

1. Remove the Back Panel and the Dust Box.
2. Remove the Pre-Filter Lock.

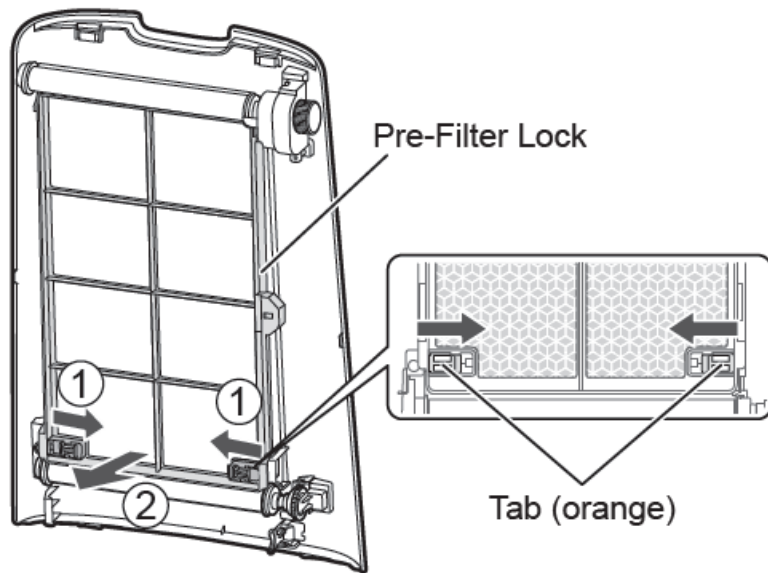

3. Remove the Shaft.

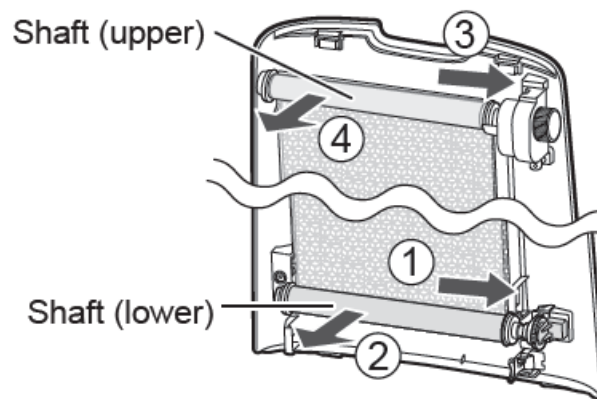

4. Remove the Cap and pull out the Pre-Filter from the Shaft.

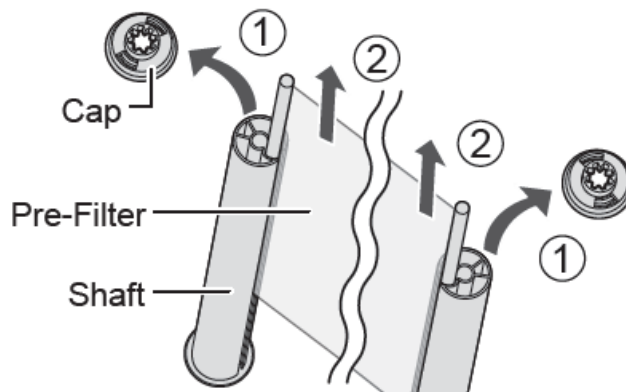

5. Soaking and cleaning the Pre-Filter.

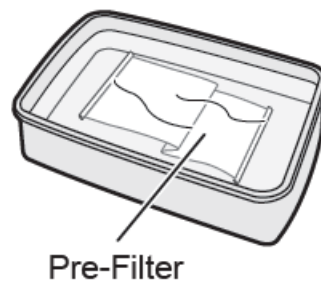

1. Add a small amount of kitchen detergent to water and soak for about 10 minutes.
2. Rinse off the kitchen detergent with clean water.
3. Dry it thoroughly.

• **NOTE:** Do not clean it too hard. Do not wash it with a washing machine. (Otherwise it might cause

damage.)

- Do not dry it with a dryer. (Otherwise it might cause shrinkage.)

6. Insert the Pre-Filter shaft into the groove of the Shaft.

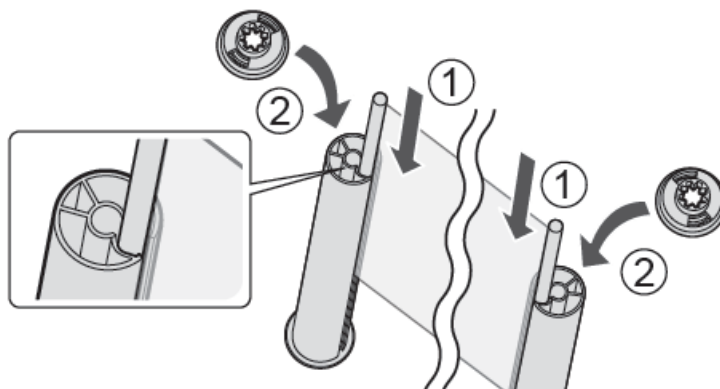

7. Attach the Shaft (upper) to the Back Panel.

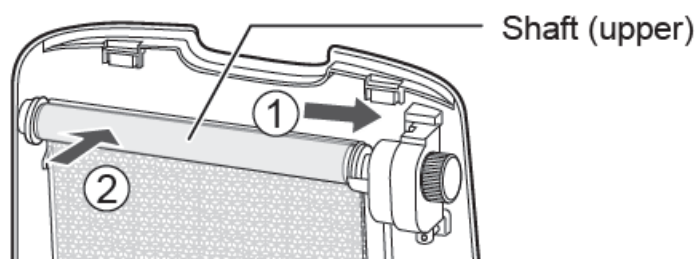

8. Roll up the Pre-Filter.

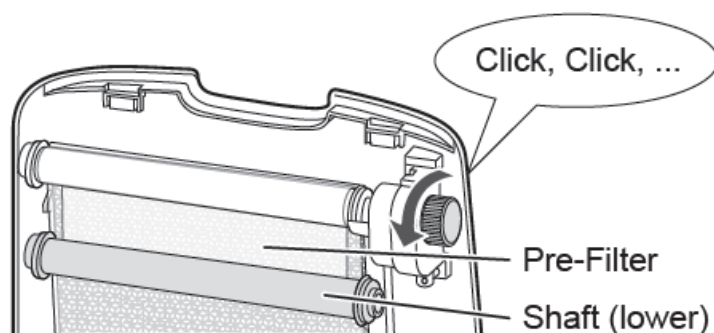

9. Pull down the Shaft (lower) and attach it to the Back Panel.

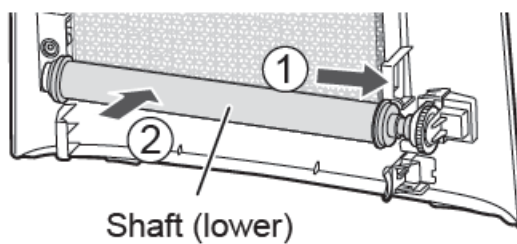

10. Install the Pre-Filter Lock.

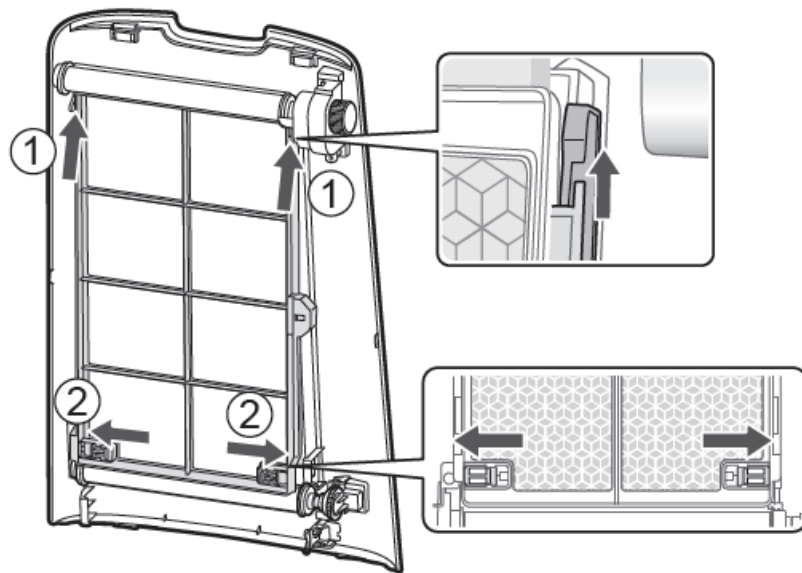

11. Install the Dust Box and the Back Panel.

PLASMACLUSTER ION GENERATING UNIT (Electrode Section)

1. Remove the Unit Cover, and pull out the Unit Holder.



2. Remove dusts from the Electrode Section.

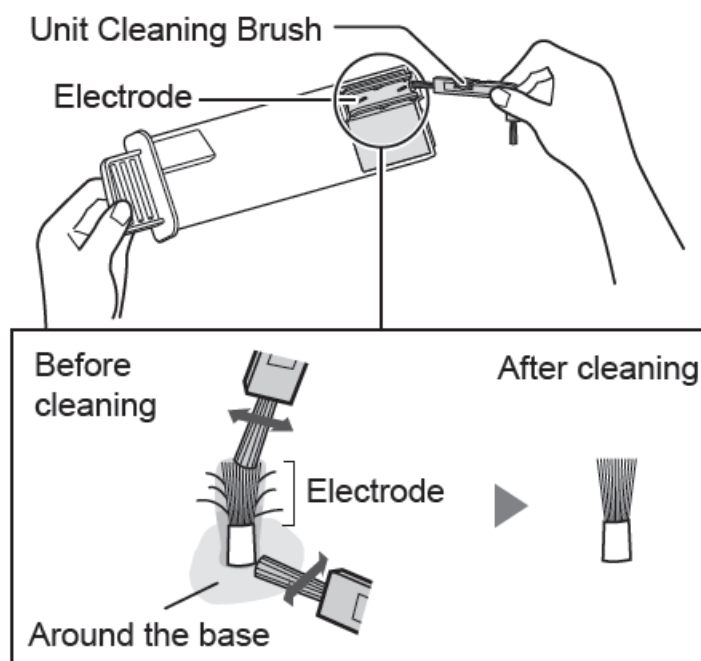

3. Insert the Unit Holder in the product, and install the Unit Cover.



NOTE

- Do not clean with anything other than the Unit Cleaning Brush. Doing so could lead to failures in the Unit.
- A bent electrode could be cut off and dropped during the cleaning process, but it will not change the performance.
- Do not touch the electrode directly. Doing so could lead to pain / itching.
- Do not transform the Electrode Section. Doing so can damage it.
- Do not touch the Connection Terminals. Doing so can damage them.

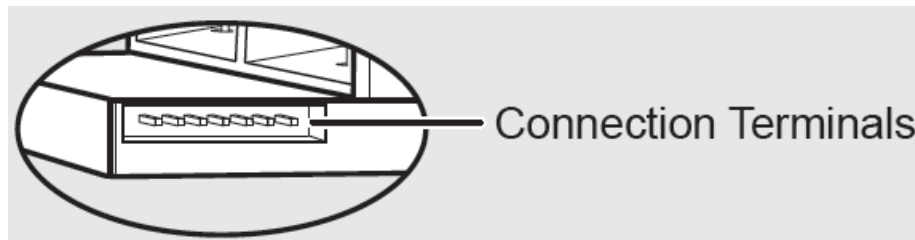

REPLACEMENT



Always be sure to remove the power plug from the wall outlet.

FILTERS

LIFE OF FILTERS

Filter life varies depending on the room environment, usage conditions, and location of the product. Lifespan of HEPA filter and Deodorizing filter and replacement suggestions are based on purifying a room in which 5 cigarettes are smoked per day and the product's dust collection and deodorizing performance has declined to half the level of a new filter.

We recommend replacing the filter more frequently if the product is used in conditions significantly more severe (PM2.5 etc.,) than a normal household.

- HEPA Filter : About 10 years after opening
- Deodorizing Filter : About 10 years after opening
- Humidifying Filter : About 10 years after opening

Replacement Filter Model

Consult your dealer when purchasing a replacement filter.

Replacement Filter	UA-KIL80E	UA-KIL60E
HEPA Filter (1 unit)	UZ-KIL8HF	UZ-HD6HF
Deodorizing Filter (1 unit)	UZ-HG6DF	
Humidifying Filter (1 unit)	UZ-KIL8MF	

HEPA Filter



Deodorizing Filter

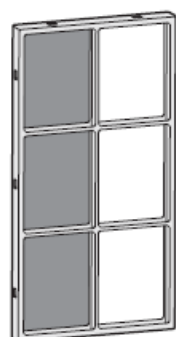

Humidifying Filter

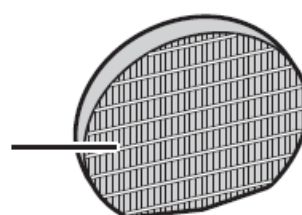

Filter Frame

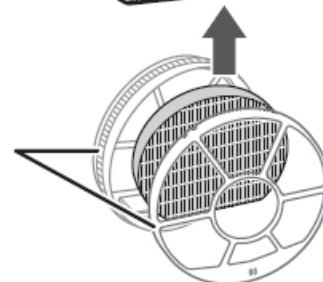

* Do not dispose the Filter Frame.

Disposing of filters



Dispose of used filters according to local laws and regulations.

- HEPA Filter material:
 - Polypropylene
 - Polyethylene
- Deodorizing Filter material:
 - Paper
 - ABS resin
- Humidifying Filter material:
 - Polyester
 - Rayon

PLASMACLUSTER ION GENERATING UNIT

UNIT REPLACEMENT LAMP

When the total operation time exceeds 17,500 hours, the Unit Replacement Lamp will flash to indicate that the Plasmacluster Ion Generating Unit needs replacement.

Operating time	
17,500 hours  Flash slowly	Replace the Plasmacluster Ion Generating Unit
19,000 hours  Flash quickly	No Plasmacluster ions will be released by the Plasmacluster Ion Generating Unit.

- The replacement time is not related to the selected operation mode.

Replacement Plasmacluster Ion Generating Unit Model

- Consult your dealer when purchasing a replacement Plasmacluster Ion Generating Unit.

UZ-C90M

- Remove the claw of Unit Holder (1), and remove the Plasmacluster Ion Generating Unit (2).

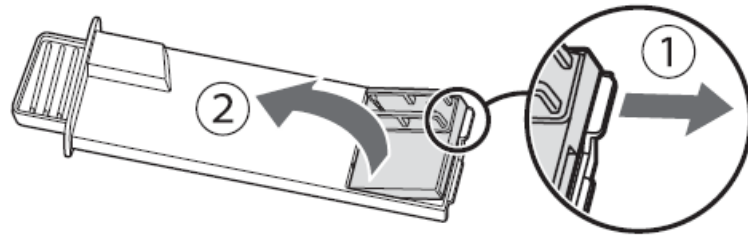

Attach the New Unit.

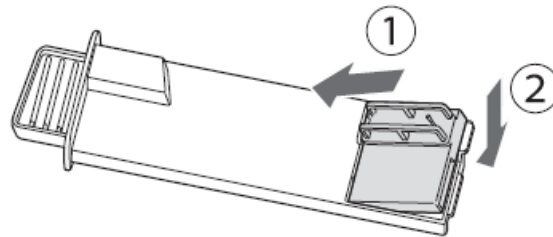

Disposing of Plasmacluster Ion Generating Unit

Dispose of used Plasmacluster Ion Generating Unit according to local laws and regulations. material:

- Polybutylene Terephthalate
- electronic parts

TROUBLESHOOTING

Before calling for service, please review the Troubleshooting list below, since the problem may not be the product malfunction.

Odour and smoke persists

- Check the filters. If they appear to be extremely dirty, clean or replace them.

Air discharged from the product has an odour

- Check to see if the filters are extremely dirty.
- Clean or replace the filters.
- Use only fresh tap water. Using other water sources risks the growth of mold, fungi, or bacteria.

The product does not operate when cigarette smoke is in the air

- Make sure the product is installed in a location in which the sensors can detect cigarette smoke.
- Check to see if the Sensitive Dust Sensor openings are blocked or clogged. If they are blocked or clogged, clean the Sensor Filter or the Back Panel.

Smell from a new product and/or filter

- Immediately after removing the plastic bag, a slight odour may occur. This odour is not harmful for filter performance or human exposure.

The product makes a clicking or ticking sound

- The product may make clicking or ticking sounds when it is generating ions.

The Cleanliness Indicator is blue or off even when the air is not clean

- The air may have been dirty when the product was plugged in. Unplug the product, wait one minute, and then plug the product in again.

The Cleanliness Indicator is red even when the air is clean

- Dirty or clogged Sensitive Dust Sensor openings interfere with sensor operation. Gently clean the Sensor Filter or the Back Panel.

The Cleanliness Indicator changes colour frequently

- The Cleanliness Indicator automatically changes colour when the Sensitive Dust Sensor and Odour Sensor detect impurities. If you are concerned about the change, you can change sensor sensitivity.

Filter Maintenance Lamp is on

- Whenever after performing maintenance or replacing the Humidifying Filter, connect the power cord to an outlet and then touch the Filter Reset Button.

The Front Display is turned off

- When the Light Control is set to "Auto", the light automatically turns off when the room is dark or operating in sleep mode. Moreover, when the Light Control is set to "Turn off", the light is always off.
- If you do not want the light to be off, set the Light Control to the "Dim" setting.

The Front display does not match weather report or another hygrometer or thermometer in the room

- Outdoor and indoor as well as the home environment (the volume of traffic nearby, number of stories in home, etc.) may cause a reading different than those data.
- There is a difference in the level within the same room.

The Humidifying Indicator on the Front Display does not light up when the tank is empty

- The room has reached the appropriate level of humidity and has stopped humidifying.
- Check the styrofoam float for impurities. Clean the Humidifying Tray. Make sure that the product is on a level

surface.

The water level in the tank does not decrease or decreases slowly

- Check to see if the Humidifying Tray and Water Tank are correctly installed. Check the Humidifying Filter.
- If the filter is extremely dirty, clean or replace it.

The operation stopped halfway No airflow projected from the Air Outlet. (Only UA-KIL80E)







- During the Pre-Filter Auto Cleaning, the on-going operation will be suspended. The Pre-Filter Auto Cleaning will operate for about 8 minutes while the Pre-Filter Auto Cleaning Indicator is flashing.

The Pre-Filter Auto Cleaning function will not perform

(Only UA-KIL80E)

- Is the interval of the Pre-Filter Auto Cleaning set to 720 hours?
 - You can set the interval to 48 hours or 720 hours.
- Is it dark in the room?
 - The Pre-Filter Auto Cleaning will not start if it is dark in the room.
- Is the air in the room dirty?
 - The Pre-Filter Auto Cleaning will not start if the Cleanliness Indicator is flashing.
- Are there any buttons touched?
 - If there is any button touched, the Pre-Filter Auto Cleaning will not start until 10 minutes later.

ERROR DISPLAY

	<ul style="list-style-type: none"> The concentration of Plasmacluster ion is descending. ⇒ Maintain the Plasmacluster Ion Generating Unit (Electrode Section).
 <i>(Only UA-KIL80E)</i>	<ul style="list-style-type: none"> Make sure the Back Panel is installed correctly.
	<ul style="list-style-type: none"> Make sure that the Humidifying Filter, Humidifying Tray and Roller are properly installed, and then turn the power to ON again.
 <i>(Only UA-KIL80E)</i>	<ul style="list-style-type: none"> Make sure the Pre-Filter is installed correctly. Make sure the Dust Box is installed correctly. Make sure the Brush in the Dust Box is installed correctly.
	<ul style="list-style-type: none"> Make sure the Plasmacluster Ion Generating Unit inserted properly. ⇒ Pull out the Plasmacluster Ion Generating Unit and insert it to the end again, and then carry out the operation again.
 	<ul style="list-style-type: none"> Unplug the product, wait one minute, and then plug the product in again.

SPECIFICATIONS

Model		UA-KIL80E			UA-KIL60E		
Power supply		220 – 240 V ~ 50 – 60 Hz					
Fan Speed Adjustment		MAX	MED	LOW	MAX	MED	LOW
CLEAN AIR	Fan Speed (m ³ / hour)	498	258	90	408	222	90
	Rated Power (W)	103	29	6.4	61	19	5.5
	Noise Level (dBA) *1	55	44	21	51	41	20
CLEAN AIR & HUMIDIFY	Fan Speed (m3 / hour)	378	258	96	360	240	90
	Rated Power (W)	49	31	7.5	42	23	6.5
	Noise Level (dBA) *1	48	44	23	48	42	21
	Humidification (mL / hour) * 2	700	540	230	660	500	230
Standby power (w)		1.2			1.0		
Recommended Room Size (m2) *3		~ 62			~ 50		
High density Plasmacluster ion recommend ed room size (m2) *4		~ 35			~ 26		
Water Tank Capacity (L)		Approx. 3.6					
Sensors		Sensitive Dust / Odour / Light / Temperature & Humidity					
Filter Type		HEPA* ⁵ / Deodorizing / Humidifying					
Cord Length (m)		2.0					
Dimensions (mm)		400 (W) × 359 (D) × 693(H)			400 (W) × 339 (D) × 686 (H)		
Weight (kg)		Approx. 11.8			Approx. 10.8		

- *1 Noise level is measured based on the JEM1467 standard of the Japan Electrical Manufacturers' Association.
- *2 The amount of humidification changes in accordance with indoor and outdoor temperature and humidity.
 - The amount of humidification increases as temperatures rises or humidity decreases.
 - The amount of humidification decreases as temperatures decrease or humidity rises.
 - Measurement Conditions: 20 °C, 30 % humidity (according to JEM1426).
- *3 The recommended room size is appropriate for operating the product of maximum fan speed.
 - The recommended room size is an area in which a given amount of dust particles can be removed in 30 minutes (according to JEM1467).

- ***4** Room size in which approximately 25000 ions per cubic centimetre can be measured in the centre of the room when the product is placed next to a wall, is running at MED mode settings, and is at a height of approximately 1.2 metres from the floor.
- ***5** The filter removes more than 99.97% of particles at least 0.3 microns in size (according to JEM1467).

Standby Power

- When the product's power plug is inserted in a wall outlet it consumes standby power in order to operate electrical circuits.
- To conserve energy, unplug the power cord when the product is not in use.

More Information

- Sharp Consumer Electronics Poland sp. z o.o.
- Ostaszewo 57B, 87-148 Łysomice, Poland
- SHARP CORPORATION OSAKA, JAPAN
- www.sharpconsumer.eu

FACTORY USE ONLY



Scan



SDA/MAN/0112

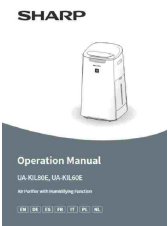

Documents / Resources

 <p>SHARP</p> <p>Operation Manual</p> <p>UA-KIL80E, UA-KIL80E-W</p> <p>Air Purifier with Humidifying Function</p> <p>[EN] [DE] [ES] [FR] [IT] [PL] [RU]</p>	<p>SHARP UA-KIL80E-W Air Purifier with Humidifying Function [pdf] Instruction Manual</p> <p>UA-KIL80E-W Air Purifier with Humidifying Function, UA-KIL80E-W, Air Purifier with Humidifying Function, Purifier with Humidifying Function, Humidifying Function, Function</p>
--	---

References

- [User Manual](#)

[Manuals+](#), [Privacy Policy](#)

This website is an independent publication and is neither affiliated with nor endorsed by any of the trademark owners. The "Bluetooth®" word mark and logos are registered trademarks owned by Bluetooth SIG, Inc. The "Wi-Fi®" word mark and logos are registered trademarks owned by the Wi-Fi Alliance. Any use of these marks on this website does not imply any affiliation with or endorsement.