

Sharp CS-4194 ELECTRONIC PRINTING CALCULATOR



Sharp CS-4194 ELECTRONIC PRINTING CALCULATOR OPERATION MANUAL

[Home](#) » [Support](#) » Sharp CS-4194 ELECTRONIC PRINTING CALCULATOR OPERATION MANUAL 

SHARP

Contents

- 1 Sharp CS-4194 ELECTRONIC PRINTING CALCULATOR
- 2 OPERATIONAL NOTES
- 3 INSTALLING OF BATTERY FOR MEMORY PROTECTION
- 4 OPERATING CONTROLS
- 5 INK RIBBON REPLACEMENT
- 6 ERRORS
- 7 REPLACEMENT OF BATTERY FOR MEMORY PROTECTION
- 8 SPECIFICATIONS
- 9 RESETTING THE UNIT
- 10 CALCULATION EXAMPLES
- 11 FAQs
- 12 References
- 13 Related Posts

Sharp CS-4194 ELECTRONIC PRINTING CALCULATOR



Notes for handling Lithium batteries:
CAUTION

- The danger of explosion if the battery is incorrectly replaced.
- Replace only with the same or equivalent type recommended by the manufacturer.
- Dispose of used batteries according to the manufacturer's instructions.

Caution!

The socket outlet shall be installed near the equipment and shall be easily accessible.

OPERATIONAL NOTES

To ensure the trouble-free operation of your SHARP calculator, we recommend the following:

1. The calculator should be kept in areas free from extreme temperature changes, moisture, and dust.
2. A soft, dry cloth should be used to clean the calculator. Do not use solvents or a wet cloth.
3. Since this product is not waterproof, do not use it or store it where fluids, for example water, can splash onto it. Raindrops, water spray, juice, coffee, steam, perspiration, etc. will also cause malfunction.
4. While the memory protection battery is not installed, the tax/discount rate set up will be cleared upon terminating the AC power supply. The tax/discount rate set up will also be cleared when the memory protection battery is removed from the unit.
5. If service should be required on this equipment, use only a SHARP servicing dealer, a SHARP-approved service facility, or a SHARP repair service where available.
6. Do not wind the AC cord around the body or otherwise forcibly bend or twist it.

SHARP will not be liable nor responsible for any incidental or consequential economic or property damage caused by misuse and/or malfunctions of this product and its peripherals, unless such liability is acknowledged by law.

INSTALLING OF BATTERY FOR MEMORY PROTECTION

Before using for the first time, remove the attached lithium battery, and install it in the equipment according to the following procedure.

If the power cord is unplugged by accident when operating with AC power only, the set tax rate and the contents of memory will be lost.

1. Turn the power switch "OFF" and unplug the power supply plug from the outlet.
2. Remove the battery cover on the back of the unit. (Fig. 1)

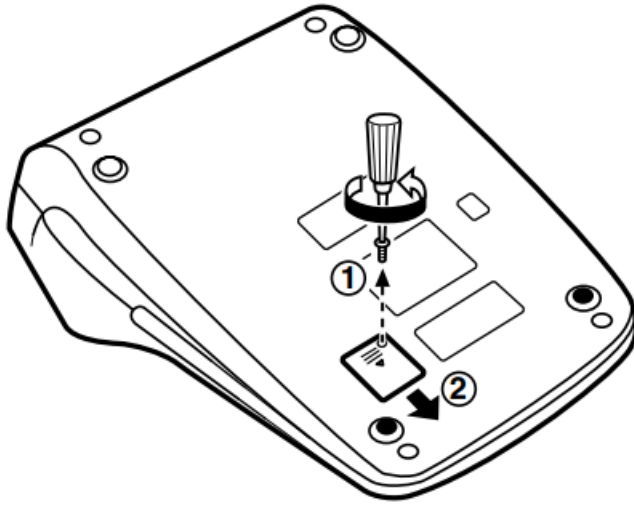

Fig. 1



Fig. 2

Wipe the battery well with a dry cloth and place the plus "+" side upward. (Fig. 2)

3. Replace the battery cover by reversing the removal procedure.
4. Press the RESET switch on the back of the unit.

After battery installation

- Connect the power supply plug to an outlet and turn the power switch "ON".
Check that "0." is displayed. If "0." is not displayed, remove the battery, reinstall it, and check the display again.
- On the battery replacement date label found on the back of the unit, write down the month and year when the battery is installed, as a reference for the next battery replacement.

OPERATING CONTROLS

1.  **POWER SWITCH; PRINT / ITEM COUNT MODE SELECTOR:**



- "OFF": Power of.
- ".": Power ON. Set to the nonprint mode. ("...--" will be printed.)
- "P": Power ON. Set to the print mode. ("...+" will be printed.)
- "P-IC": Power ON. Set to the print and item count mode. The counter will count the number of times that



has been pressed in addition.

Notes: • Each time  is used in subtraction, 1 will be subtracted from the count.

- The count is printed when the calculated result is obtained.

- Pressing of , , , and  clears the counter.

- The counter has a maximum capacity of 3 digits (up to ± 999).

If the count exceeds the maximum, the counter will recount from zero.

2. DECIMAL SELECTOR:

Presets the number of decimal places in the answer. In the “F” position, the answer is displayed in the floating decimal system.

↑ 5/4 ↓

3. ROUNDING SELECTOR:

Example: Set the decimal selector to “2”.

$4 \div 9 = 0.444 \dots$, $5 \div 9 = 0.555 \dots$

	4 <input type="text"/> \div 9 <input type="text"/> \pm	5 <input type="text"/> \div 9 <input type="text"/> \pm
↑	0.45	0.56
5/4	0.44	0.56
↓	0.44	0.55

Note: The decimal point floats during successive calculations by the use of \times or \div .

If the decimal selector is set to “F” then the answer is always rounded down (\downarrow).

K • A

4. CONSTANT / ADD MODE SELECTOR:

- “K” : The following constant functions will be performed:

Multiplication: The calculator will automatically remember the first number entered (the multiplicand)

and \times the instruction.

5. **Division:** The calculator will automatically remember the second number entered (the divisor) and \div the instruction.

“•”: **Neutral**

“A”: Use of the Add mode permits addition and subtraction of numbers without entry of the decimal point. When the Add mode is activated, the decimal point is automatically positioned according to the decimal selector setting.

Use $*$, \times or \div , and will automatically override the Add mode and decimally correct answers will be printed at the preset decimal position.

6. GRAND TOTAL MODE SELECTOR:

“GT”: This selector will accumulate the following: (“+*” will be printed.)

- Addition and subtraction totals obtained with $*$.

- Product and quotient totals obtained with \pm or $-=$.

- Results obtained using $\%$. “•”: Neutral



7. **PAPER FEED KEY**



8. **LAST DIGIT CORRECTION KEY**



9. **CHANGE SIGN KEY:**

Changes the algebraic sign of a number (i.e. positive to negative or negative to positive).



10. **NON-ADD / SUBTOTAL KEY:**

- **Non-Add** – When this key is pressed right after entry of a number in the Print mode, the entry is printed on the left-hand side with “#”. This key is used to print out numbers not subject to calculations such as codes, dates, etc.
- **Subtotal** – Used to get subtotal(s) of additions and/or subtractions. When pressed following



or



, the subtotal is printed with “◇” and the calculation may be continued.

By pressing this key event in the Non-print mode, the displayed number is printed without any symbol.



11. **TOTAL KEY:**

Prints the total of addition and subtraction with “ * ”.

This key also serves as a clear key for the calculation register and resets an error condition.

12. **CE: CLEAR ENTRY KEY:**

Clears numbers entered before use of a function key.

Also used to clear an overflow error caused by an entry.



13. **FIRST RECALL MEMORY KEY**



14. **FIRST RECALL AND CLEAR MEMORY KEY**



15. **PRE-TAX KEY**



16. **TAX-INCLUDING KEY:**

This key is used for calculations with the tax/discount rate.



17. **STORE KEY:**

This key is used to store the tax/ discount rate.

- A maximum of 4 digits can be stored (decimal point is not counted as a digit).
- To store a discount rate, press first.
- Only one rate can be stored. If you enter a new rate, the previous rate will be cleared.



18. **GRAND TOTAL KEY:**

Prints and clears the “GT” memory contents.



19. **SECOND RECALL MEMORY KEY**



20. **SECOND RECALL AND CLEAR MEMORY KEY**

21. DISPLAY

Display format:

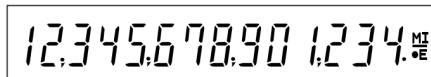

Symbols:

- **M**: First memory symbol

Appears when a number has been stored in First memory.

- **I**: Second memory symbol

Appears when a number has been stored in Second memory.

- **-**: Minus symbol

Appears when a number is negative.

- **E**: Error symbol

This appears when an overflow or other error is detected.

- **.**: Total memory symbol

Appears when a number is in the grand total memory.

* Although all available symbols are shown here for instruction purposes, these symbols will not appear on the screen simultaneously.

INK RIBBON REPLACEMENT

1. Remove the paper roll from the calculator. (Tear the paper and remove it from the print mechanism by using



2. Set the power switch to OFF. Make sure that the print wheel has stopped.
3. Remove the printer cover by sliding it towards the back of the calculator. (Fig. 1)
4. Remove the used ribbon.
5. Install the new ribbon.
6. With the black side of the ribbon facing upwards, place one of the reels on the reel shaft on the right. (Fig. 2)
Make sure that the reel is securely in place.
7. Thread the ribbon around the outside of the metal guides. (Fig. 3)
8. Take up any slack by manually turning one of the reels.
9. Replace the printer cover.
10. Replace the paper roll.

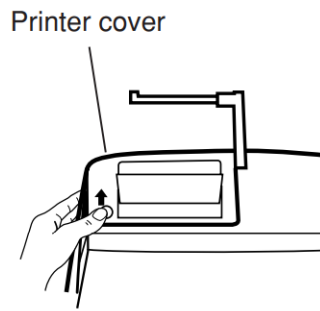

Fig. 1

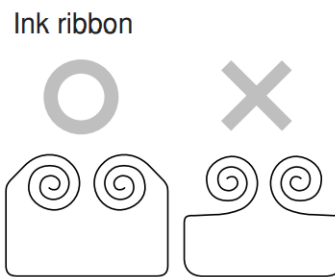

Fig. 2

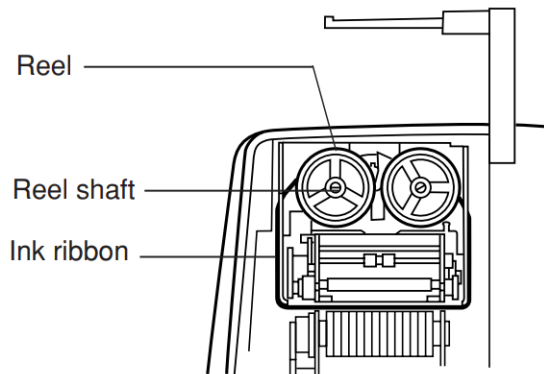

Fig. 3

PAPER ROLL REPLACEMENT

1. Lift the paper holder up. (Fig. 1)
2. Fold the leading edge of the paper roll 3 to 5 cm. (Do not fold it slantwise.) (Fig. 2)
3. Insert the paper roll from the left side of the paper holder and make sure the paper roll is set in the proper direction (with the paper feeding from the bottom). (Fig. 3)
4. Insert the leading edge of the paper into the opening directly behind the print mechanism. (Fig. 4)
5. Press the paper feed key and feed the paper under the edge of the paper cutter. (Fig. 5)

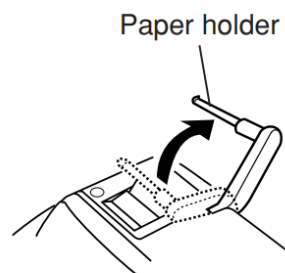

Fig. 1

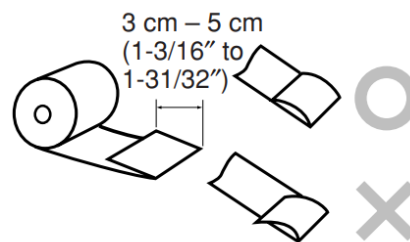

Fig. 2

6.



Fig. 3

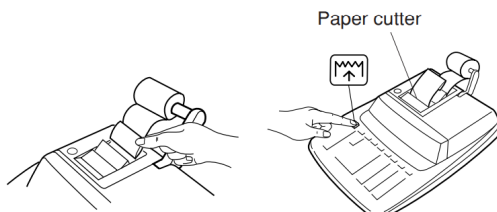

Fig. 4

Fig. 5

DO NOT PULL PAPER BACKWARD AS THIS MAY CAUSE DAMAGE TO THE PRINTING MECHANISM.

ERRORS



Several situations will cause an overflow or an error condition. When this occurs, the error symbol “E” will be displayed and all keys will electronically lock.

The contents of the memory at the time of the error are retained.

If “0•E” then “,” is printed in red at the time of an error (in Non-print mode, error symbols are only displayed), must



be used to clear the calculator.

If an “E” with any numerals except zero is displayed, the error may be cleared with  or  and the calculation can still be continued.



Error conditions:

1. Entry of more than 14 digits or 13 decimals.

This error can be cleared with or .

2. When the integer portion of an answer exceeds 14 digits.

3. When the integer portion of the contents of the memory exceeds 14 digits. ( 99999999999999  1 )

4. When any number is divided by zero. (Ex. 5  0 )

REPLACEMENT OF BATTERY FOR MEMORY PROTECTION

Time for battery replacement

Replace with a new battery once 2 year.

Method of battery replacement

Use one lithium battery (CR2032).

Note: When replacing the battery, the set tax rate and the memory contents will be lost.

You may want to write down the tax rate and other important numbers on a sheet of paper.

1. Turn the power switch “OFF” and unplug the power supply plug from the outlet.
2. Remove the battery cover on the back of the unit. (Fig. 1)
3. Remove the exhausted battery and install one new lithium battery. Wipe the battery well with a dry cloth and place the plus “+” side upward. (Fig.2)
4. Replace the battery cover by reversing the removal procedure.
5. Press the RESET switch on the back of the unit (See page 13).

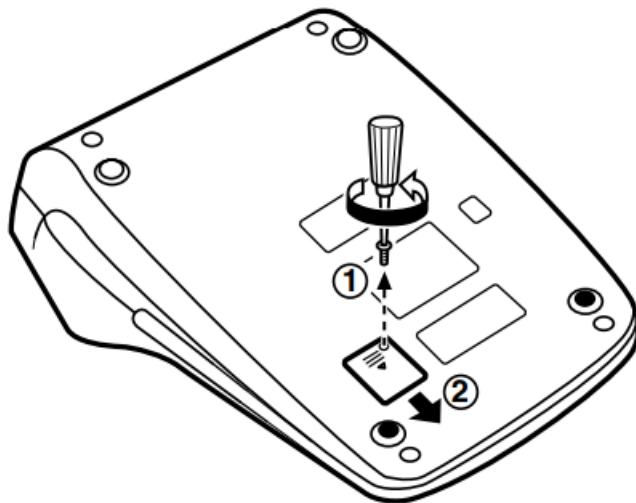

Fig. 1

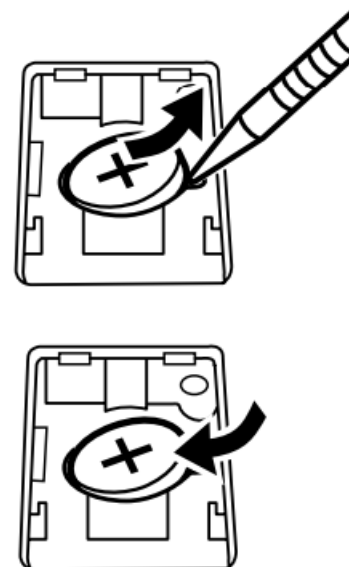

Fig. 2

After battery replacement

- Connect the power supply plug to an outlet and turn the power switch “ON”.
Check that “0.” is displayed. If “0.” is not displayed, remove the battery, reinstall it, and check the display again.
- Reset the tax rate.
- On the battery replacement date label found on the back of the unit, write down the month and year when the battery is replaced, as a reference for the next battery replacement.

Precautions on battery use

- Do not leave an exhausted battery in the equipment.
- Do not expose the battery to water or flame, and do not take it apart.
- Store batteries out of the reach of small children.

SPECIFICATIONS

- **Operating capacity:** 14 digits
- **Power supply:** Operating:
- **AC:** 220V–230V, 50Hz
- **Memory backup:** 3V (DC) (Lithium battery CR2032 × 1)
- **Memory Protection Battery lifespan:** Approx. 2 years. (tested and confirmed at 25°C (77°F); may change due to usage environment)
- **Calculations:** Four arithmetic calculations, constant multiplication and division, power calculation, add-on/discount calculation, repeat addition and subtraction, reciprocal calculation, grand total calculation, item count calculation, markup calculation, memory calculation, etc.

PRINTING SECTION

- **Printer:** Mechanical printer
- **Printing speed:** Approx. 4.3 lines/sec.
- **Printing paper:** 57 mm (2-1/4") ~ 58 mm (2-9/32") wide 80 mm (3-5/32") in diameter (max.)
- **Operation temperature:** 0°C ~ 40°C (32°F ~ 104°F)
- **Power consumption:** 53 mA
- **Dimensions:** 250 mm (W) × 345 mm (D) × 78 mm (H) 9-27/32" (W) × 13-19/32" (D) × 3-1/16" (H)
- **Weight:** Approx. 2.0 kg (4.41 lb.) (with battery)
- **Accessories:** 1 lithium battery, 1 battery replacement date label (attached on the unit's back body), 1 paper roll, 1 ink ribbon and operation manual.

WARNING

THE VOLTAGE USED MUST BE THE SAME AS SPECIFIED ON THIS CALCULATOR. USING THIS CALCULATOR WITH A VOLTAGE HIGHER THAN THAT SPECIFIED IS DANGEROUS AND MAY RESULT IN A FIRE OR OTHER TYPE OF ACCIDENT CAUSING DAMAGE. SHARP WILL NOT BE HELD RESPONSIBLE FOR ANY DAMAGE RESULTING FROM USE OF THIS CALCULATOR WITH OTHER THAN THE SPECIFIED VOLTAGE.

RESETTING THE UNIT

Strong impacts, exposure to electrical fields, or other unusual conditions may render the unit inoperative, and pressing the keys will have no effect. If this occurs, you will have to press the RESET switch on the bottom of the unit. The RESET switch should be pressed only when:

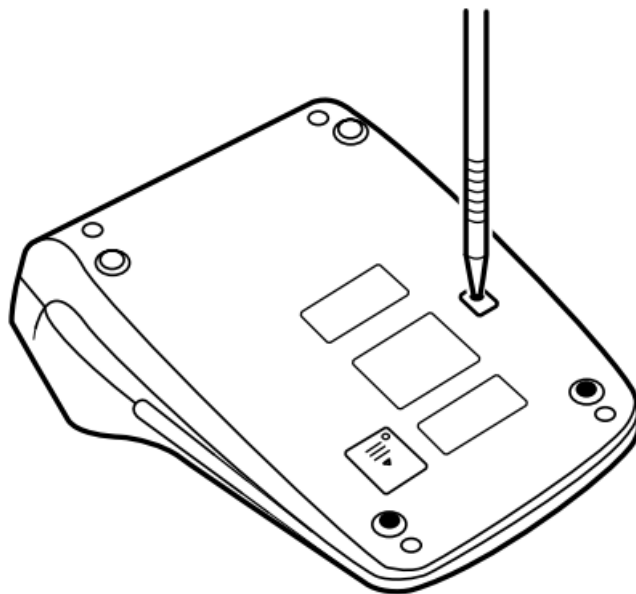

- an abnormal event occurs and all keys are disabled.
- you install or replace the battery.

Notes:

- Pressing the RESET switch will clear the stored tax rate and other data stored in the memory.
- Use only a ballpoint pen to press the RESET switch. Do not use anything breakable or anything with a sharp tip, such as a needle.
- After pressing the RESET switch, connect the power supply plug to an outlet. Turn the power switch "ON" and

check that “0.” is displayed.

CALCULATION EXAMPLES

- 1. Set the decimal selector as specified in each example.
The rounding selector should be in the “5/4” position unless otherwise specified.
- 2. The total mode selector and the constant/ add mode selector should be in the “•” position (off position) unless otherwise specified.
- 3. The print/item count mode selector should be in the “P” position unless otherwise specified.
- 4. If an error is made while entering a number, press or and enter the correct number.
- 5. Negative values are printed with “-” symbol in red.
- 6. Not all the punctuation marks will be printed. Large numbers will be printed as, e.g.: 12345678,901,234.

PERCENT

A. $100 \times 25\% =$

F643210

(1)	(2)	(3)
100 <div>×</div>	100.	100. ×
25 <div>%</div>		25. %
		25.00 *
	25.00	

B. $123 \div 1368 = (\%)$

F643210

(1)	(2)	(3)
123 <div>÷</div>	123.	123. ÷
1368 <div>%</div>		1.368. %
		8.99 *
	8.99	

$\frac{1}{7} =$

↑ 5/4 ↓

F643210

(1)	(2)	(3)
7 <div>÷</div>	7.	7. ÷
<div>÷</div>	1.	7. ÷
<div>±</div>		7. =
	0.1428571428571	0.1428571428571 *

ADD-ON AND DISCOUNT

- 5% add-on to 100

(1)	(2)	(3)
100 <input type="text" value="x"/>	100.	100 · ×
5 <input type="text" value="%"/>		5 · %
		<div>Increased amount</div> <div>Erhöhung</div> <div>Majoration</div> <div>Incremento</div> <div>5·00 * <div>Importo incrementato</div><div>Tillagt belopp</div><div>Extra bedrag</div><div>Quantia aumentada</div><div>Lisäty määrä</div></div>
<input type="text" value="±"/>	5.00	5·00 +
		<div>New amount</div> <div>Neuer Betrag</div> <div>Total majoré</div> <div>Nueva cantidad</div> <div>105·00 * <div>Nuovo importo</div><div>Nytt belopp</div><div>Nieuwe bedrag</div><div>Nova quantia</div><div>Uusi määrä</div></div>
	105.00	

- 10% discount on 100

(1)	(2)	(3)
100 <input type="text" value="x"/>	100.	100 · ×
10 <input type="text" value="%"/>		10 · %
		<div>Discount</div> <div>Abschlag</div> <div>Remise</div> <div>Descuento</div> <div>10·00 * <div>Sconto</div><div>Rabatt</div><div>Korting</div><div>Desconto</div><div>Vähennys</div></div>
<input type="text" value="-="/>	10.00	10·00 −
		<div>Net amount</div> <div>Nettobetrag</div> <div>Montant net</div> <div>Cantidad neta</div> <div>90·00 * <div>Nuovo importo</div><div>Nettobelopp</div><div>Nettobedrag</div><div>Quantia líquida</div><div>Uusi määrä</div></div>
	90.00	

ITEM COUNT CALCULATION

(1)	(2)	(3)
<input type="checkbox"/> *		
100.55 <input type="checkbox"/> ±	100.55	100.55 +
200 <input type="checkbox"/> ±	300.55	200.00 +
<input type="checkbox"/> ±	500.55	200.00 +
400.55 <input type="checkbox"/> ±	901.10	400.55 +
500.65 <input type="checkbox"/> ±	1,401.75	500.65 +
<input type="checkbox"/> *		005 (a)
		1,401.75 * (b)
	1,401.75	

GRAND TOTAL

(1)	(2)	(3)
<input type="checkbox"/> GT <input type="checkbox"/> *		
100 <input type="checkbox"/> ±	100.	100. +
200 <input type="checkbox"/> ±	300.	200. +
300 <input type="checkbox"/> ±	600.	300. +
<input type="checkbox"/> *		600. * ①
	600. •	+
300 <input type="checkbox"/> ±	300. •	300. +
400 <input type="checkbox"/> ±	700. •	400. +
500 <input type="checkbox"/> ±	1,200. •	500. +
<input type="checkbox"/> *		1,200. * ②
	1,200. •	+
500 <input type="checkbox"/> ±	500. •	500. +
600 <input type="checkbox"/> ±	100. •	600. -
700 <input type="checkbox"/> ±	600. •	700. +
<input type="checkbox"/> *		600. * ③
	600. •	+
<input type="checkbox"/> GT		2,400. * ④
	2,400.	*

FAQs

Is the Sharp CS-4194 suitable for professional use in financial sectors?

Absolutely, the Sharp CS-4194 is highly suitable for professional use in the financial sector. Its robust functionality, including complex calculations and print capability, makes it a reliable tool for accountants, bankers, and financial analysts.

Can the Sharp CS-4194 perform tax calculations, and if so, how?

Yes, the Sharp CS-4194 can perform tax calculations. It has dedicated tax keys that simplify the process of

adding or subtracting a preset tax rate to a given amount, making it a useful tool for businesses and individuals dealing with tax-related calculations.

How does the printing feature of the Sharp CS-4194 enhance its functionality?

The printing feature of the Sharp CS-4194 allows for the quick production of hard copies of calculations, ideal for record-keeping, financial tasks, and for reviewing long series of calculations to ensure accuracy.

What are the basic features of the Sharp CS-4194 Electronic Printing Calculator?

The Sharp CS-4194 Electronic Printing Calculator offers features like a 12-digit display, two-color printing, and a range of basic and advanced mathematical functions including tax calculations, currency conversion, and a grand total key.

What type of power source does the Sharp CS-4194 require?

The Sharp CS-4194 typically operates on an AC power source, ensuring steady and reliable usage without the need for frequent battery changes, which is ideal for office settings.

How user-friendly is the Sharp CS-4194 for beginners?

The Sharp CS-4194 is designed with simplicity in mind, making it user-friendly for beginners. Its clear display, labeled keys, and intuitive functions allow new users to easily navigate and perform basic calculations.

Is there a specific way to replace the ink ribbon in the Sharp CS-4194?

Replacing the ink ribbon in the Sharp CS-4194 requires carefully opening the printer compartment and installing a compatible ribbon. It's important to follow the manufacturer's instructions to avoid damage or improper installation.

Can the Sharp CS-4194 handle currency conversion calculations?

Yes, the Sharp CS-4194 can handle currency conversions, which is beneficial for businesses dealing with international transactions. Users can input exchange rates to easily convert between different currencies.

What type of printing technology is used in the Sharp CS-4194?

The Sharp CS-4194 uses dot matrix printing technology, providing reliable and clear printing for financial documents and calculations.

How durable is the Sharp CS-4194 for long-term office use?

The Sharp CS-4194 is known for its durability and is built to withstand the rigors of daily use in a busy office environment, making it a long-lasting investment for businesses.

Does the Sharp CS-4194 have any memory functions?

Yes, the Sharp CS-4194 includes memory functions such as store, recall, clear, and total recall, which are essential for complex calculations and managing multiple calculations at once.

Are there any special maintenance tips for the Sharp CS-4194 to ensure its longevity?

To ensure the longevity of the Sharp CS-4194, it's recommended to keep it clean from dust, avoid exposure to extreme temperatures, and replace the ink ribbon as needed. Regular checks and gentle handling will help maintain its functionality over time.

Download This Manual PDF: [Sharp CS-4194 ELECTRONIC PRINTING CALCULATOR OPERATION MANUAL](#)

References

- [User Manual](#)