



SHARP PN Series MultiSync Option Board Installation Guide

SHARP

Installation Manual

Option Board

MultiSync®

PN-M652

PN-M552

PN-M502

PN-M432

PN-P656

PN-P556

PN-P506

PN-P436

This manual describes the Option Board installation procedure for installers.

Please check the Operation Manual of your monitor before installing the Option Board for additional information.

Contents [[hide](#)]

[1 Installing an Option Board](#)

[2 Contents to be used](#)

[3 Installation](#)

[4 Documents / Resources](#)

[4.1 References](#)

Installing an Option Board

You can install Option Boards that are compatible with Intel® Smart Display Module Small (Intel® SDM-S), Intel® Smart Display Module Large (Intel® SDM-L) specifications and Raspberry Pi Compute Modules, offered by SHARP.

TIP: Unless your monitor is purchased as part of a special bundle package, no Option Boards will be in the box or installed in the monitor. These are optional accessories available for separate purchase. Please contact your supplier for a list of Option Boards available for your monitor.

Contents to be used

Slot cover: 1 set

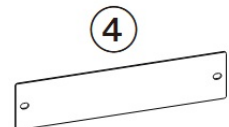
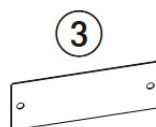
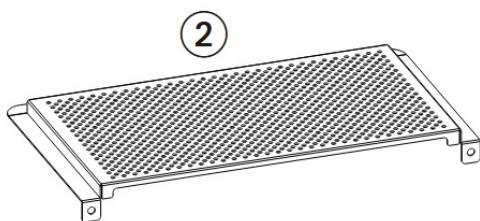

Installation

1. **Turn off the main power switch.**
2. **If signal cables or the power cord is connected to the monitor, please disconnect them.**
3. **Place the monitor face down on a flat even surface that is larger than the monitor screen. Use a sturdy table that can easily support the weight of the**

monitor.

To avoid scratching the LCD panel, always place a soft cloth, such as a blanket that is larger than the monitor's screen area, on the table before laying the monitor face down. Make sure there is nothing on the table that can damage the monitor.

4. Remove slot cover ① (Figure 1).

When install an Intel SDM-L, slide the Center rail to the right and remove it. Reverse the process to reattach it (**Figure 2**).

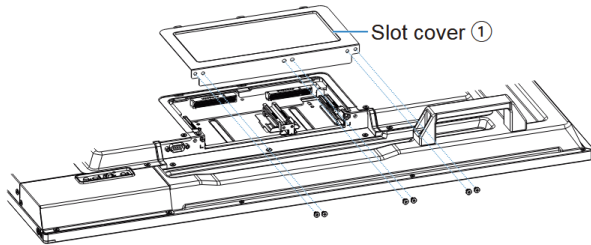

Figure 1

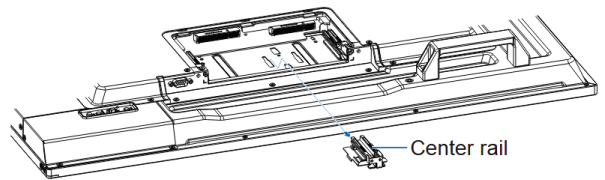
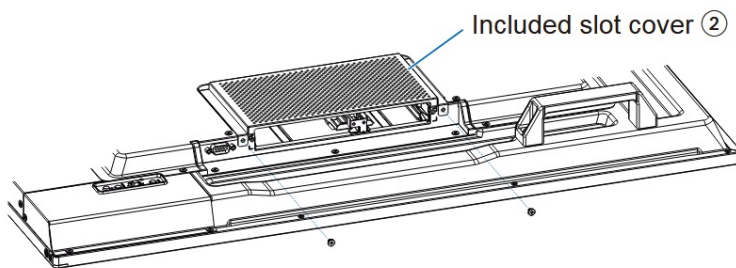

Figure 2

5. Install the slot cover ② with two removed screws used for slot cover ①.

Recommended fasten force for all screws is 50~80 N•cm.



6. Insert the Option Board into the slot and affix it in place with the two removed screws used for slot cover ①.

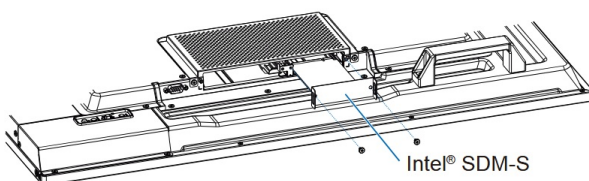

Intel® SDM-S

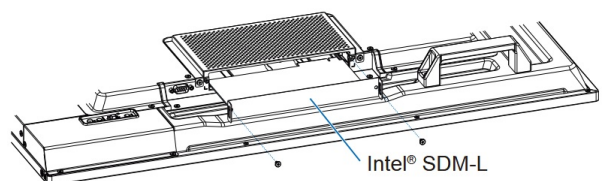

Intel® SDM-L

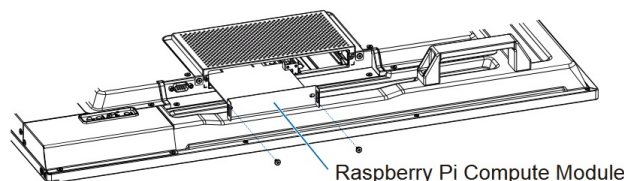

Raspberry Pi Compute Module

7. For slot that is not in use, install the slot cover ③ or ④ with the two removed screws used for slot cover ①.

When installing the included slot cover, install it with the completely painted side facing out.

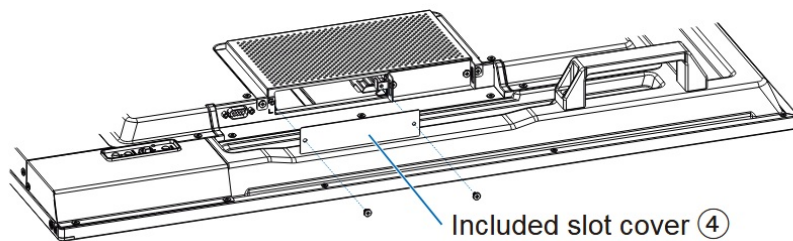

NOTE:

- Make sure the board is inserted into the slot in the correct orientation.
- Do not apply excessive force to manipulate the Option Board before attaching it with screws.

⚠ WARNING: Ensure the Option Board is securely fastened using the original screws to prevent falling out. A falling Option Board may expose you to danger.

MultiSync is a trademark or registered trademark of Sharp NEC Display Solutions, Ltd. in Japan and other countries.

Intel and the Intel logo are trademarks of Intel Corporation or its subsidiaries.

All other brands and product names are trademarks or registered trademarks of their respective owners.

SHARP
SHARP CORPORATION

Documents / Resources

SHARP

Installation Manual

Option Board

M652, M552, P656, P556, PN Series MultiSync Option Board, MultiSync Option Board, Option Board, Board

SHARP PN Series MultiSync Option Board [pdf] Installation Guide

M652, M552, P656, P556, PN Series MultiSync Option Board, MultiSync Option Board, Option Board, Board

References

- [User Manual](#)

Sharp

Board, M552, M652, MultiSync Option Board, Option Board, P556, P656, PN Series MultiSync Option Board, Sharp

Leave a comment

Your email address will not be published. Required fields are marked *

Comment *

Name

Email

Website

☐ Save my name, email, and website in this browser for the next time I comment.

Post Comment

Search:

e.g. whirlpool wrf535swhz

Search

[Manuals+](#) | [Upload](#) | [Deep Search](#) | [Privacy Policy](#) | [@manuals.plus](#) | [YouTube](#)

This website is an independent publication and is neither affiliated with nor endorsed by any of the trademark owners. The "Bluetooth®" word mark and logos are registered trademarks owned by Bluetooth SIG, Inc. The "Wi-Fi®" word mark and logos are registered trademarks owned by the Wi-Fi Alliance. Any use of these marks on this website does not imply any affiliation with or endorsement.