



# Shark WW200C Series Dry Hard Floor Cleaning System User Guide

[Home](#) » [Shark](#) » Shark WW200C Series Dry Hard Floor Cleaning System User Guide 

## Contents

- [1 Shark WW200C Series Dry Hard Floor Cleaning System](#)
- [2 Specifications](#)
- [3 FAQ](#)
  - [3.1 Q: Can I use the product to pick up large objects?](#)
  - [3.2 Q: Can children operate the Hydro Duo?](#)
  - [3.3 Q: Can I clean the product by immersing it in water?](#)
- [4 Documents / Resources](#)
  - [4.1 References](#)
- [5 Related Posts](#)

**Shark WW200C Series Dry Hard Floor Cleaning System**

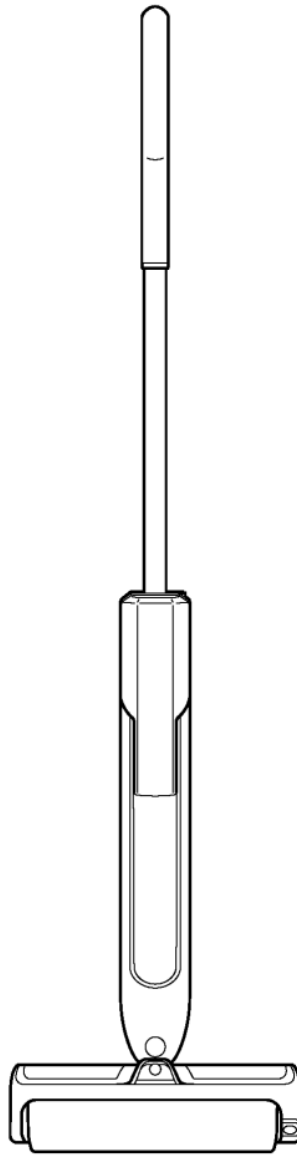

## USER GUIDE



- A** Handle
- B** Spray Trigger
- C** Pole
- D** Power Button
- E** Clean Solution Tank
- F** Debris Holder
- G** Nozzle Cover
- H** Spray Nozzle
- I** Brushroll
- J** Charging Dock
- K** Shark® Hard Floor Multi-Surface Concentrate
- L** Brushroll Cleaning Tool
- M** Debris Illumination Light

Brushroll  
Drying Post

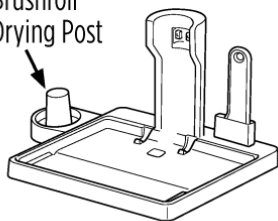

**J**

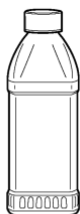

**K**



**L**

**Note:** Not all accessories come with all units and may vary by model. Please visit [www.sharkclean.com](http://www.sharkclean.com) for more details.

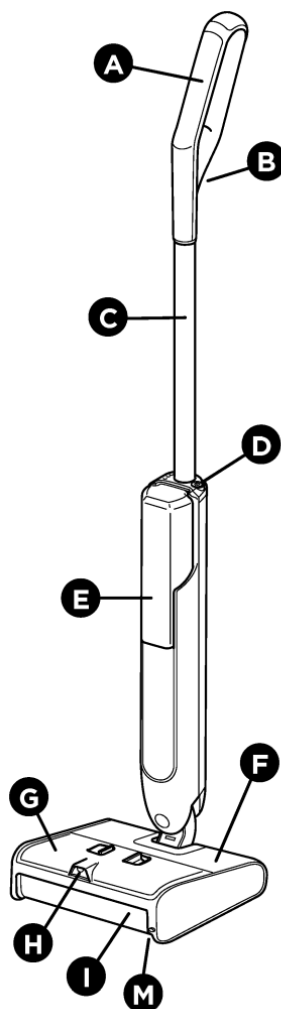

1

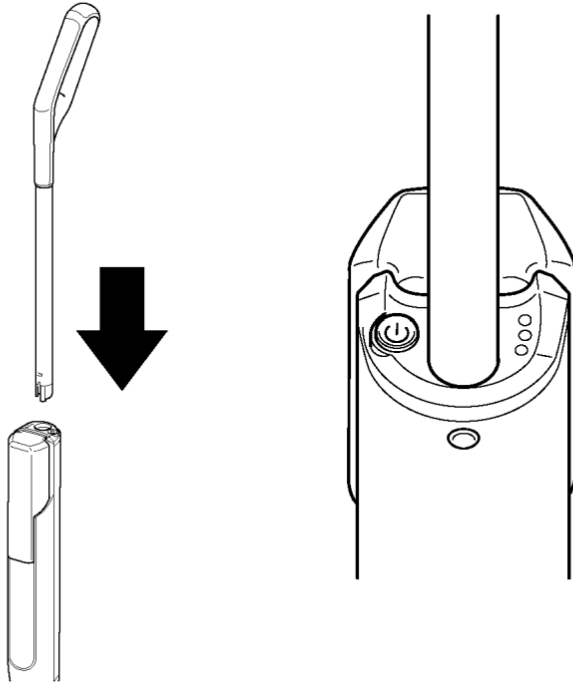

2

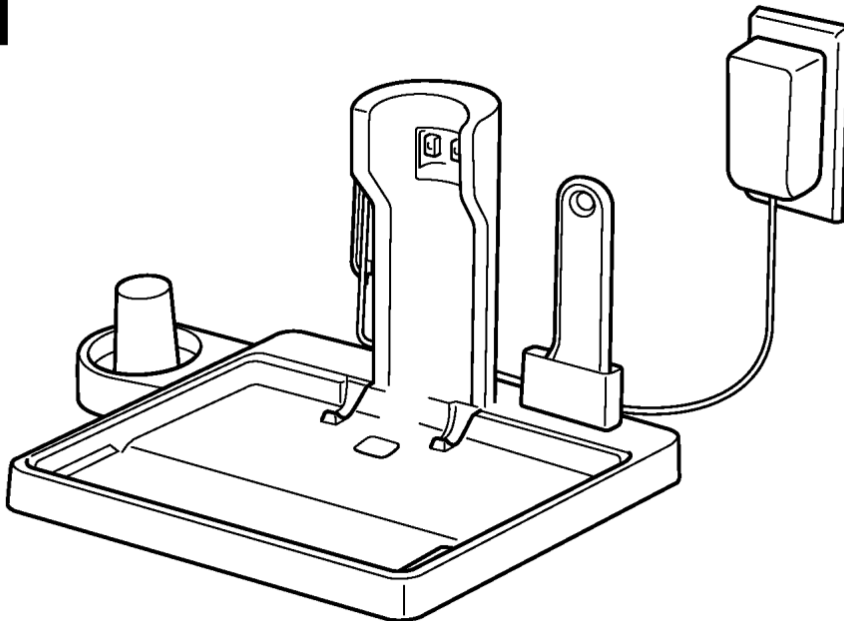

3

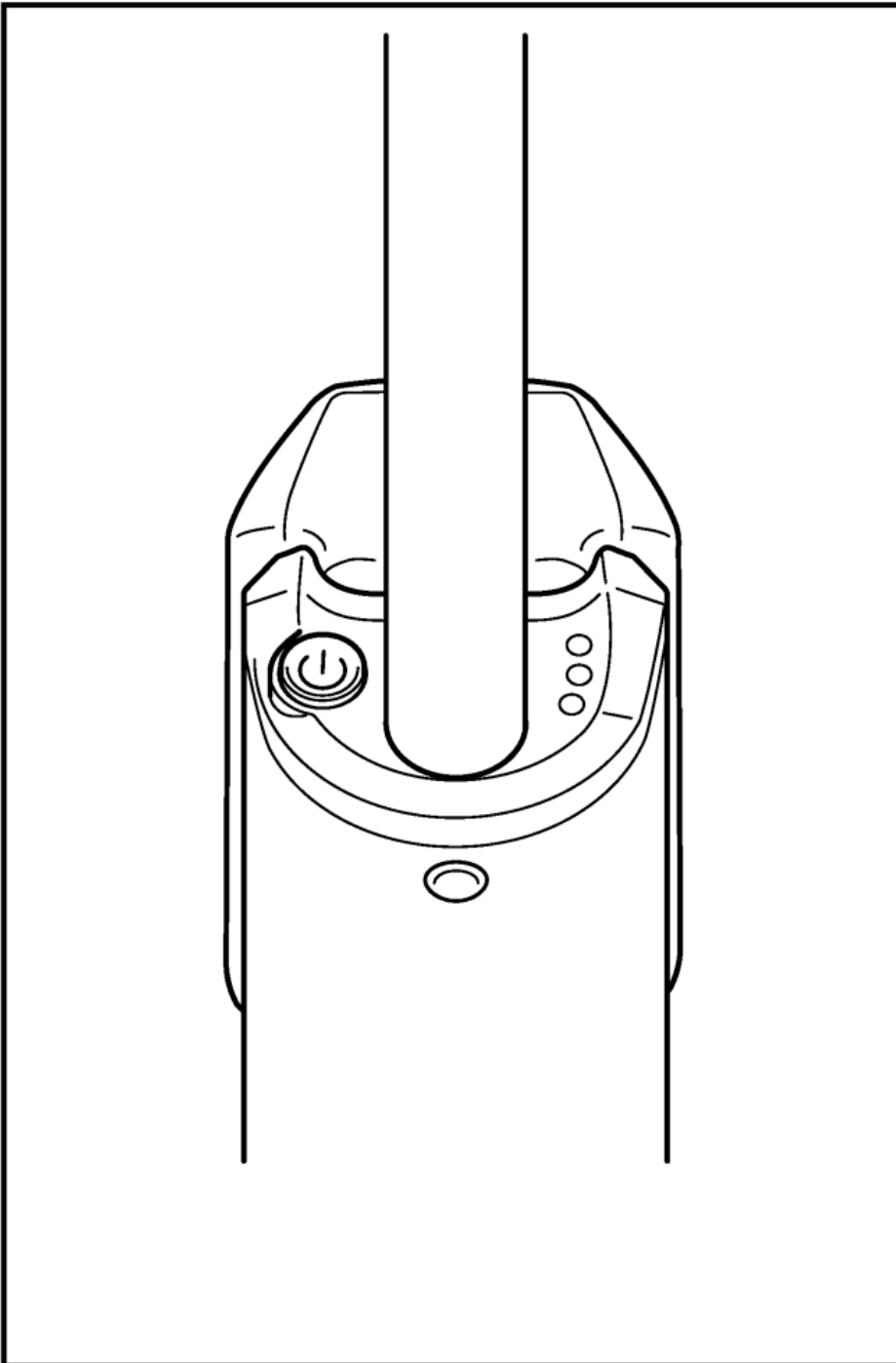
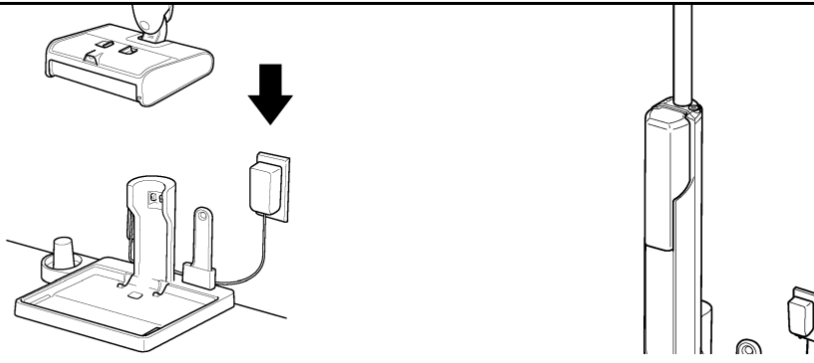

**BATTERY LEVEL (In Use/While Charging)**

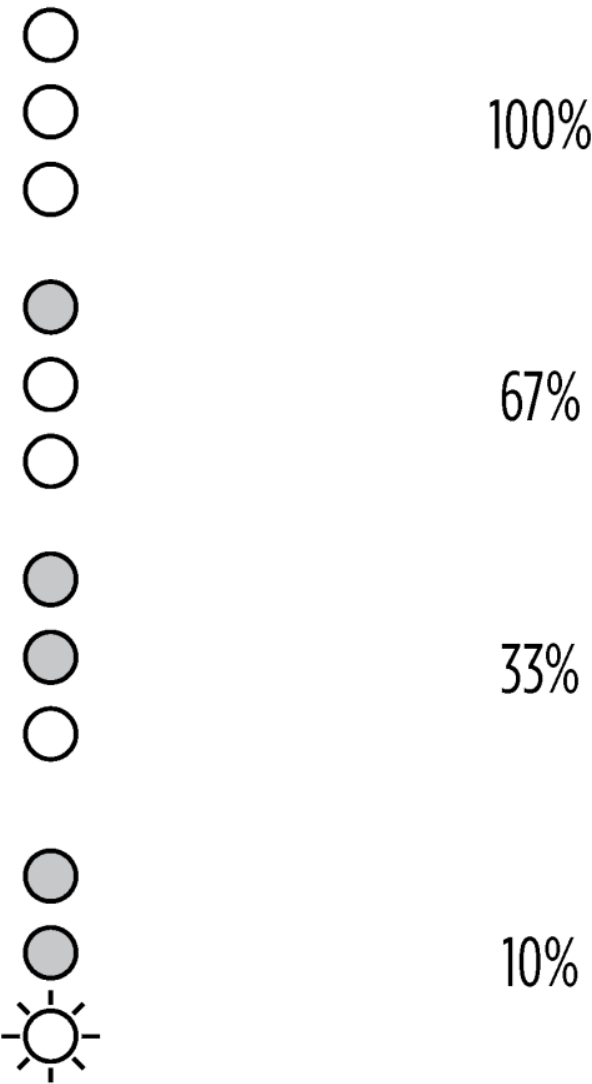

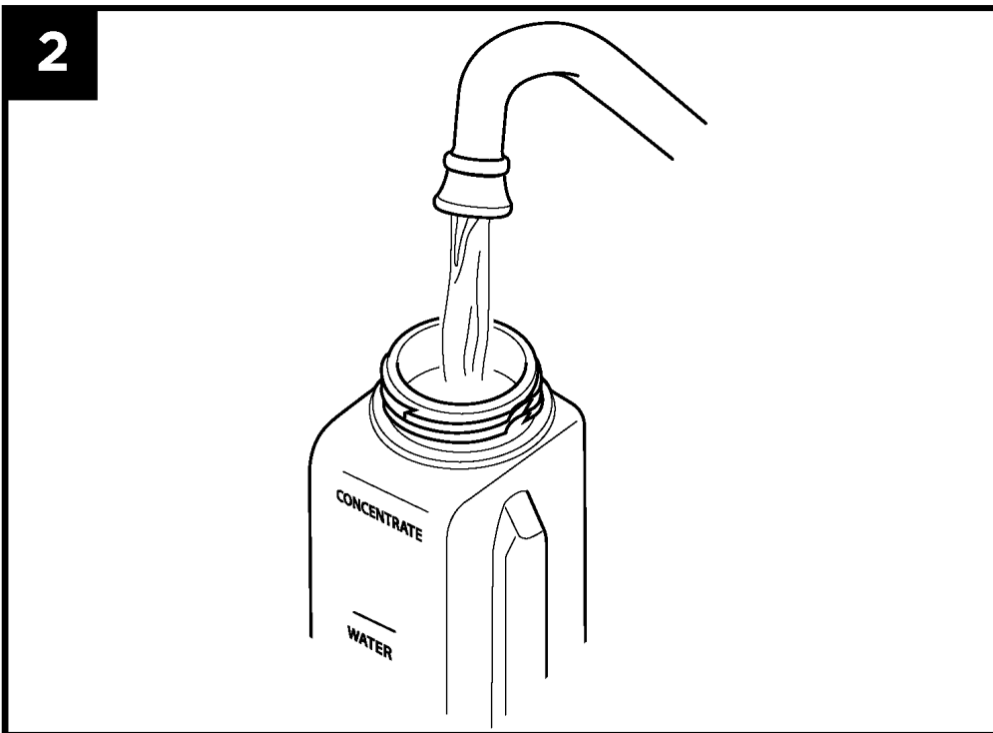
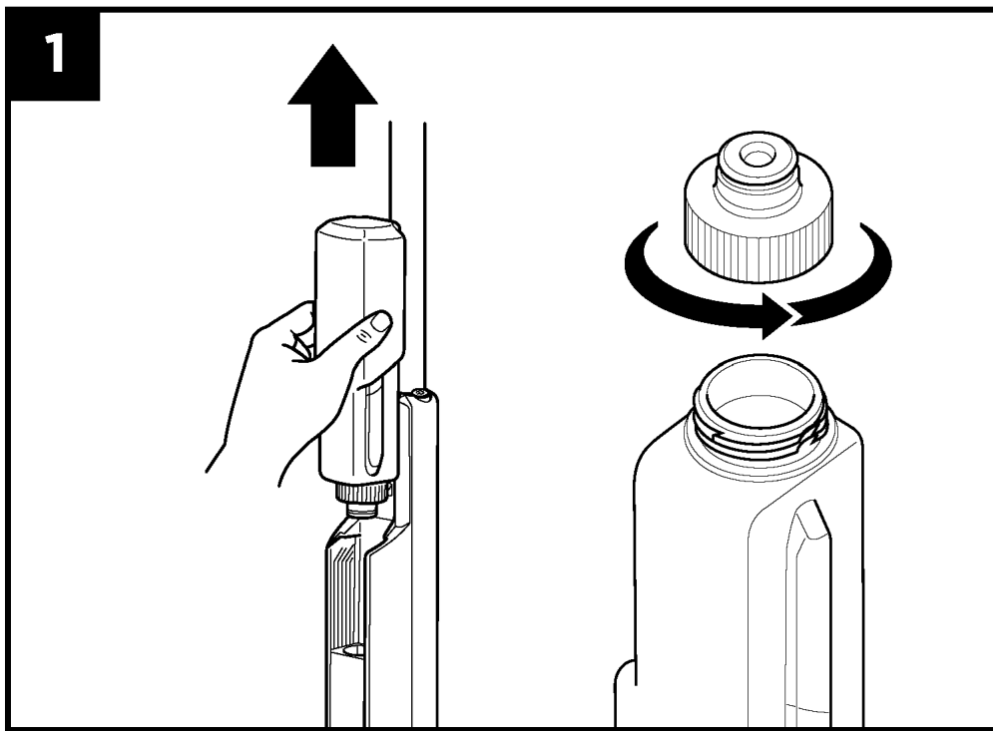

3



4

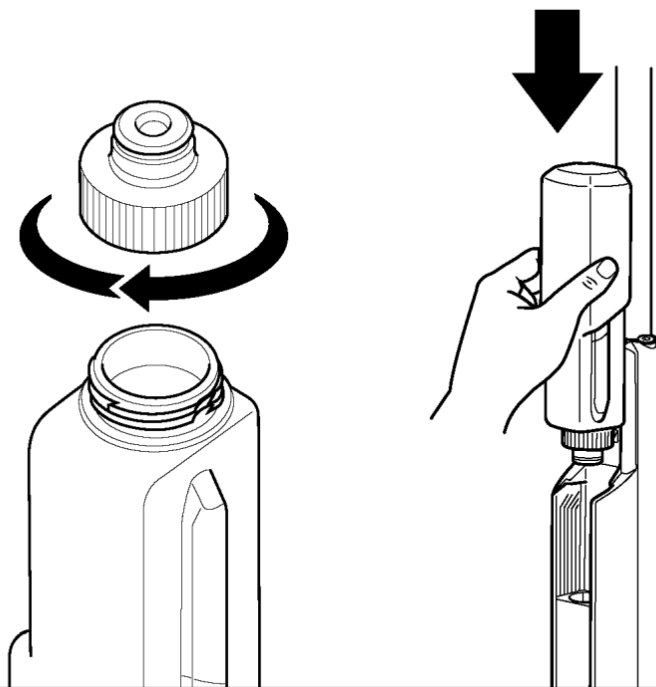



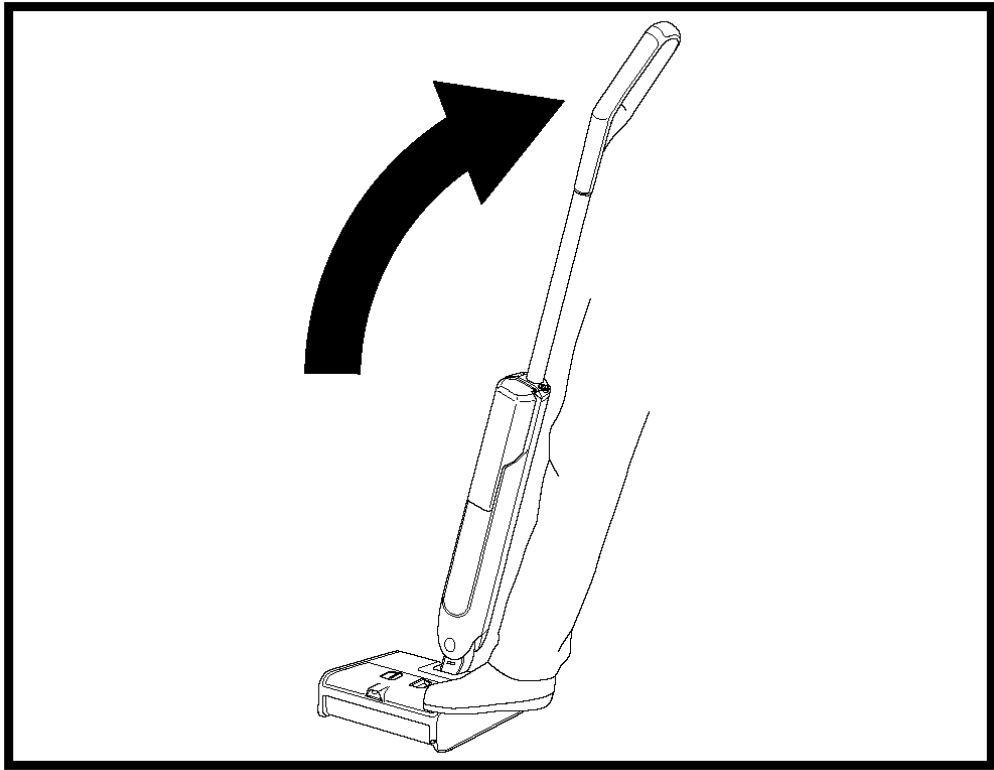
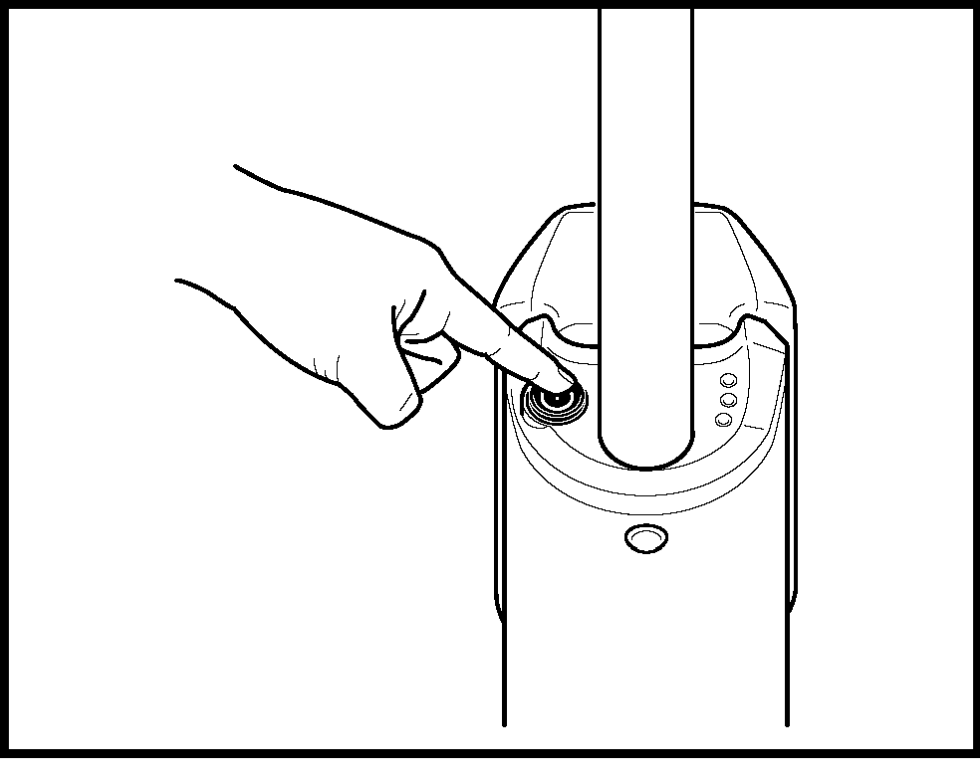

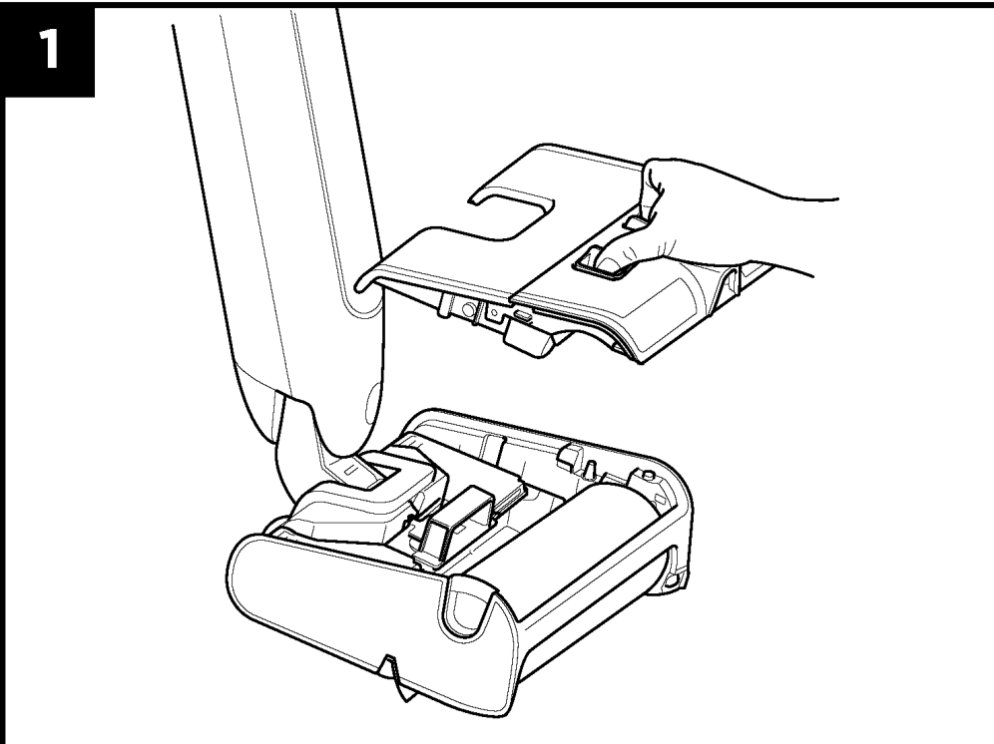
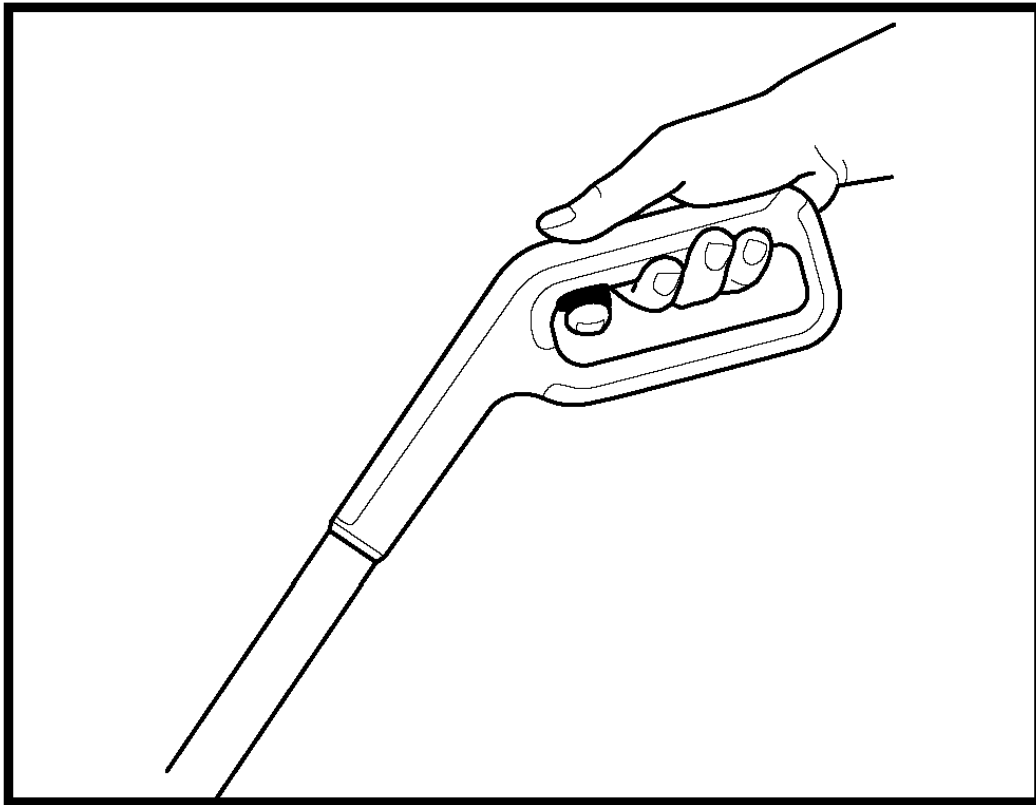

2

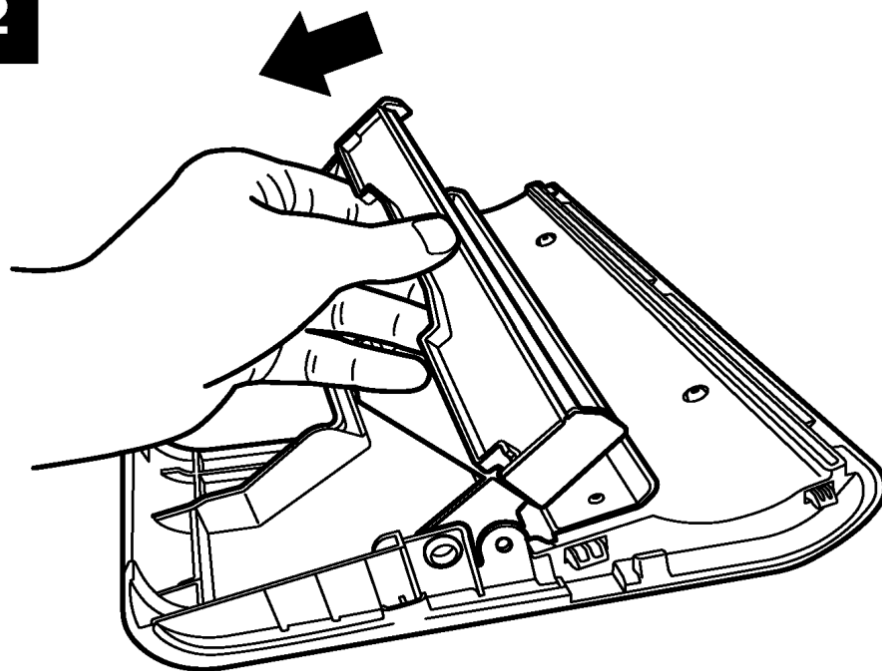

3

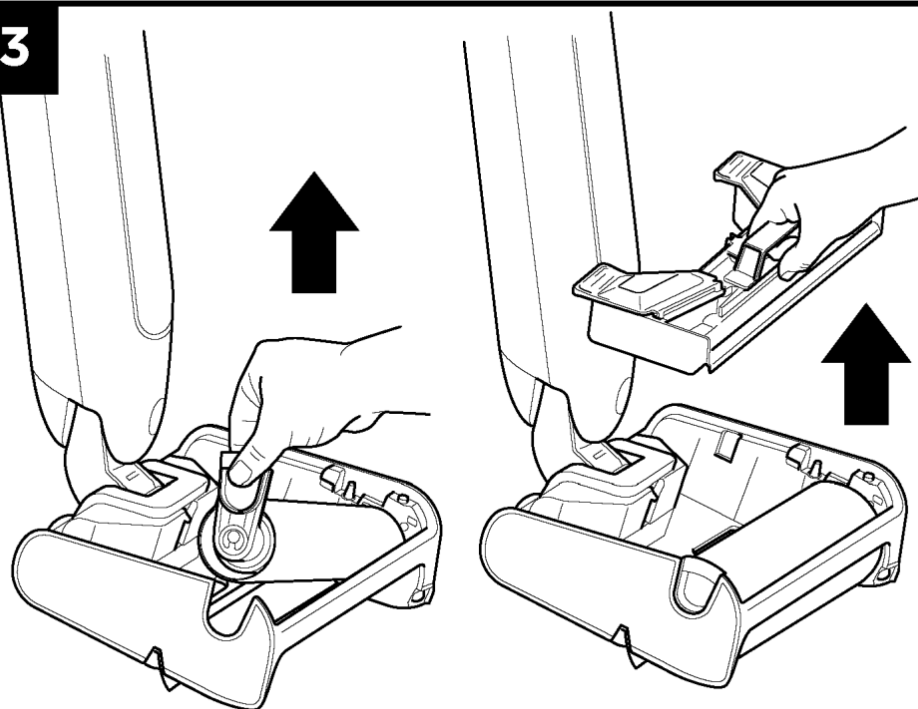

4

fig. 1

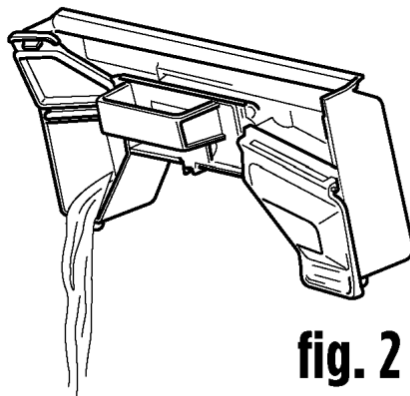
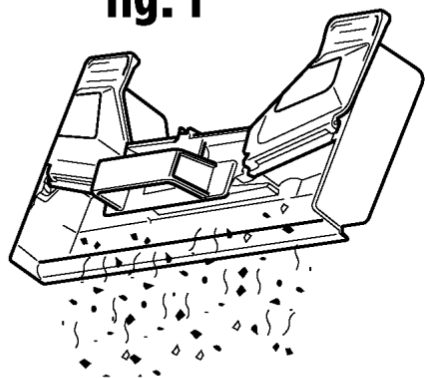
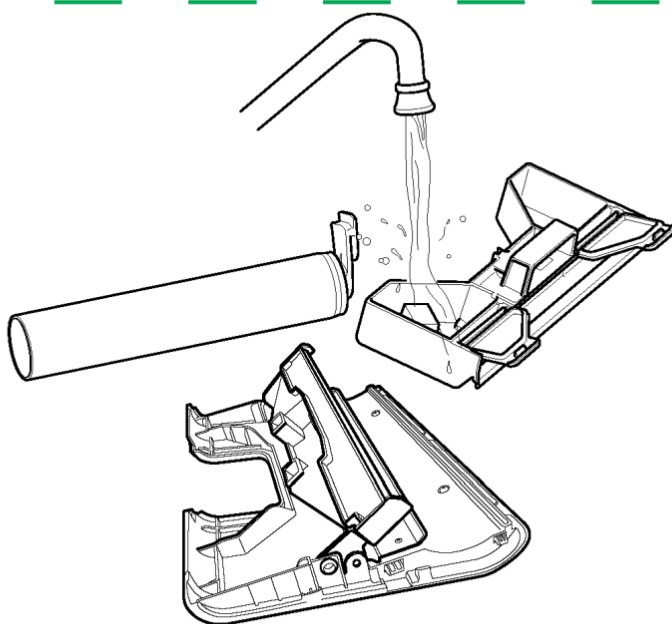
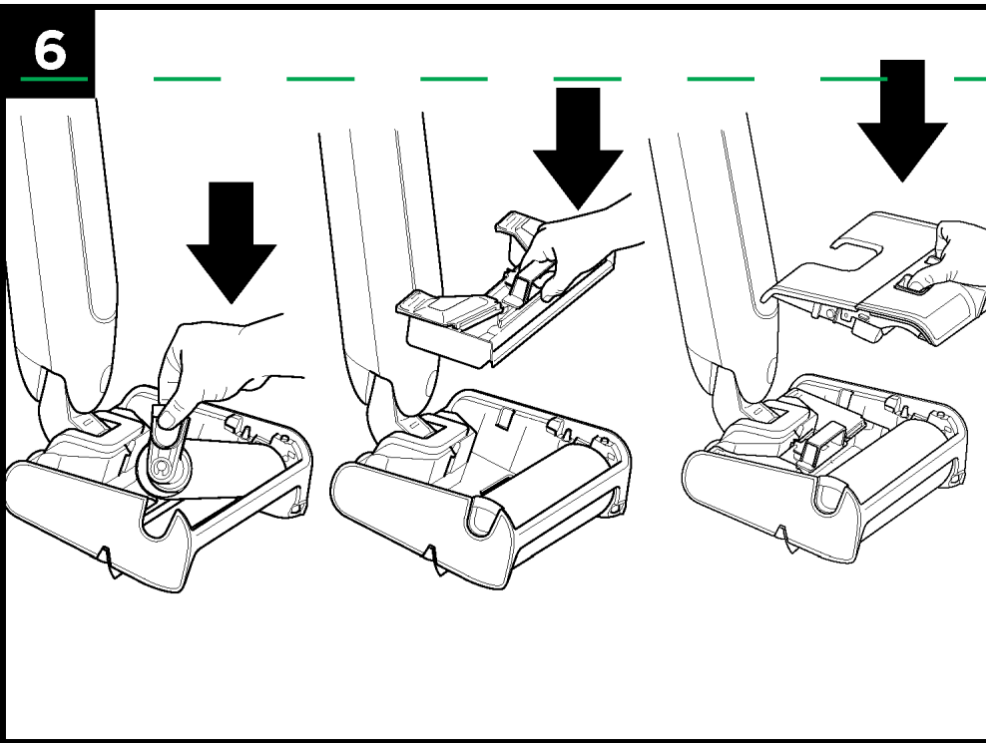

fig. 2



5



6

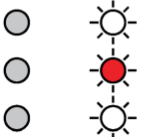
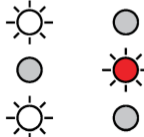

#### ERROR MESSAGES

LIQUID CHAMBER IN DEBRIS HOLDER IS FULL	COVER NOT ATTACHED	BRUSHROLL JAM
 <p>Alternative blinking WHITE and RED (all lights)</p>	 <p>Alternating blinking WHITE and RED</p>	 <p>SOLID RED (No Blinking)</p>



## Specifications

- Model: WW200C Series
  - Type: Wet-Dry Hard Floor Cleaning System
  - Power Source: Electric
  - Components: Brushroll, Drying Post
  - Website: [www.sharkclean.com](http://www.sharkclean.com)
- 

## FAQ

**Q: Can I use the product to pick up large objects?**

A: No, it is not recommended to pick up large objects with the Hydro Duo.

**Q: Can children operate the Hydro Duo?**

A: Children should not operate the Hydro Duo and must be supervised when it is in use.

**Q: Can I clean the product by immersing it in water?**

A: No, do not immerse or spray water on the body of the Hydro Duo. Clean the surface with a dry cloth.

## Documents / Resources

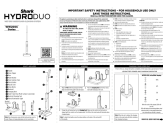
	<a href="#">Shark WW200C Series Dry Hard Floor Cleaning System</a> [pdf] User Guide WW200C, WW200C Series Dry Hard Floor Cleaning System, WW200C Series, Dry Hard Floor Cleaning System, Floor Cleaning System, Cleaning System
-------------------------------------------------------------------------------------	------------------------------------------------------------------------------------------------------------------------------------------------------------------------------------------------------------------------------------

## References

- [User Manual](#)

[Manuals+](#), [Privacy Policy](#)

This website is an independent publication and is neither affiliated with nor endorsed by any of the trademark owners. The "Bluetooth®" word mark and logos are registered trademarks owned by Bluetooth SIG, Inc. The "Wi-Fi®" word mark and logos are registered trademarks owned by the Wi-Fi Alliance. Any use of these marks on this website does not imply any affiliation with or endorsement.