



Shark V2940C Cordless Floor And Carpet Sweeper User Manual

[Home](#) » [Shark](#) » Shark V2940C Cordless Floor And Carpet Sweeper User Manual 

Contents

- 1 Shark V2940C Cordless Floor And Carpet Sweeper User Manual
- 2 IMPORTANT SAFETY INSTRUCTIONS
- 3 TO MAXIMIZE THE LIFE OF YOUR NI-CD BATTERIES:
- 4 QUICK START
 - 4.1 ASSEMBLE
 - 4.2 CLEAN
 - 4.3 EMPTY
- 5 ASSEMBLY
- 6 CHARGING YOUR CORDLESS FLOOR AND CARPET SWEEPER
- 7 USING YOUR CORDLESS FLOOR AND CARPET SWEEPER
- 8 EMPTYING THE DUST CONTAINER
- 9 MAINTENANCE
 - 9.1 CLEANING THE ROTATING BRUSH
 - 9.2 REMOVING AND REPLACING THE BATTERY
- 10 TROUBLESHOOTING GUIDE
- 11 ORDERING REPLACEMENT PARTS
- 12 WARRANTY & PRODUCT REGISTRATION
- 13 PRODUCT REGISTRATION
- 14 DOWNLOAD
- 15 Related Posts

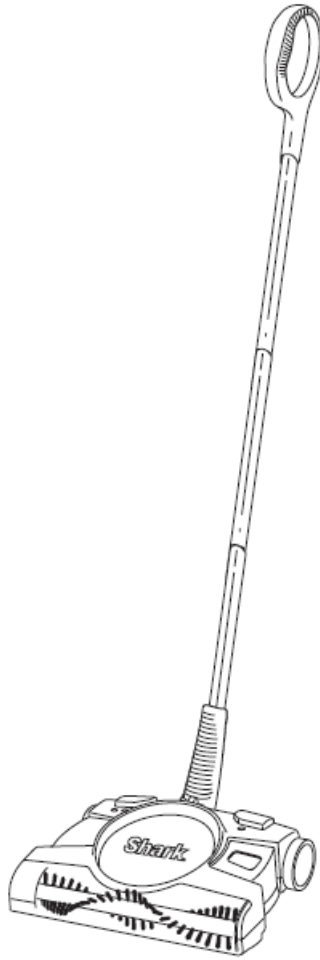

**MODEL: V2940C
OWNER'S GUIDE**

www.sharkclean.com

IMPORTANT SAFETY INSTRUCTIONS

For Household Use Only

READ ALL INSTRUCTIONS BEFORE USING YOUR SHARK® CORDLESS FLOOR AND CARPET SWEEPER.

WHEN USING YOUR SHARK CORDLESS FLOOR AND CARPET SWEEPER, BASIC SAFETY PRECAUTIONS SHOULD ALWAYS BE OBSERVED, INCLUDING THE FOLLOWING:

WARNING: TO REDUCE THE RISK OF FIRE, ELECTRIC SHOCK OR INJURY:

1. Read and follow all label, operational and marking instructions.
2. Use ONLY as described in this manual. Use only manufacturer's recommended attachments.
3. DO NOT allow to be used as a toy. Close attention is necessary when used by or near children.
4. DO NOT use for any purpose other than described in this user's guide.
5. DO NOT use with damaged cord or plug.

Do not use the cordless floor and carpet sweeper if it has been dropped, damaged, left outdoors, or dropped in water. Return it to EURO-PRO Operating LLC for examination, repair or adjustment.

6. DO NOT abuse the charger cord. Never carry the charger or base by the cord or yank to disconnect from an outlet; instead grasp the charger and pull to disconnect.
7. Keep the charger cord away from heated surfaces.

8. DO NOT use the charger with an extension cord. Plug the charger directly into an electrical outlet. Use charger only in a standard electrical outlet.
9. DO NOT attempt to use the charger with any other product or attempt to charge this product with another charger. Use only the charger model KA12D090020023U supplied with this cordless floor and carpet sweeper.
10. DO NOT charge this unit outdoors.
11. DO NOT use outdoors or on wet surfaces.
12. DO NOT handle plug or appliance with wet hands.
13. Use only on dry, indoor surfaces.
14. DO NOT put any object into openings. Do not use with brush roll blocked; keep free of fiber, lint, hair and anything that may prevent the brush roll from working.
15. Keep hair, loose clothing, fingers and all parts of body away from openings and moving parts.
16. DO NOT pick up anything that is burning or smoking, such as cigarettes, matches or hot ashes.
17. DO NOT use to pick up flammable or combustible liquids such as gasoline or use in areas where they may be present.
18. DO NOT attempt to change accessories while the unit is running.
19. DO NOT use the cordless floor and carpet sweeper without the dust container in place.
20. Use extra care when cleaning on stairs.
21. Store the cordless floor and carpet sweeper indoors. Store after use to prevent accidents.
22. Leaks from battery cells can occur under extreme conditions. If the liquid gets on the skin – wash immediately with soap and water. If the liquid gets into the eyes, flush them immediately with clean water for a minimum of 10 minutes and seek medical attention.
23. This product includes rechargeable nickel cadmium batteries. Batteries must be recycled or disposed of properly. Do not incinerate the batteries or expose to high temperatures as they may explode.
24. The cordless floor and carpet sweeper must be disconnected from the power supply when removing the battery.
25. To reduce the risk of electrical shock, do not put the charger and sweeper body in water or other liquid. Do not place or store the appliance where it can fall or be pulled into a tub or sink.

TO MAXIMIZE THE LIFE OF YOUR NI-CD BATTERIES:

1. Charge for 20 hours before initial use. Failure to do so will reduce the product's battery life significantly.
2. After first use, discharge the unit fully and then recharge for 16 hours.
3. For best battery performance, remove the charging adapter from the unit after the charging period has completed.
4. Do not store the unit with the charging adapter attached and plugged in.
5. For maximum battery life, only recharge the unit when the batteries are close to fully discharged. It is best to fully discharge the batteries at least once a month.
6. DO NOT store in areas of high temperature or humidity.
7. After 3 months of non-use, the product should be fully discharged and then recharged to maximize battery power.
8. Ni-Cd batteries have a long useful life but at some time they will need to be replaced. To purchase replacement batteries, visit www.sharkclean.com.

NOTE: The power button must be in the "Off" position in order to charge the unit. If the charging indicator does not light, press the power button once.

SAVE THESE INSTRUCTIONS

Thank you for purchasing the Shark® Cordless Floor and Carpet Sweeper

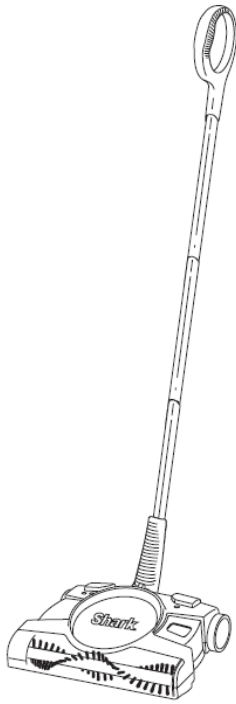

QUICK START

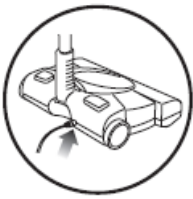

IMPORTANT: Before you can start using your new cordless floor and carpet sweeper, charge it for 20 hours.

NOTE: The charging adapter will be shipped inside the packaging.

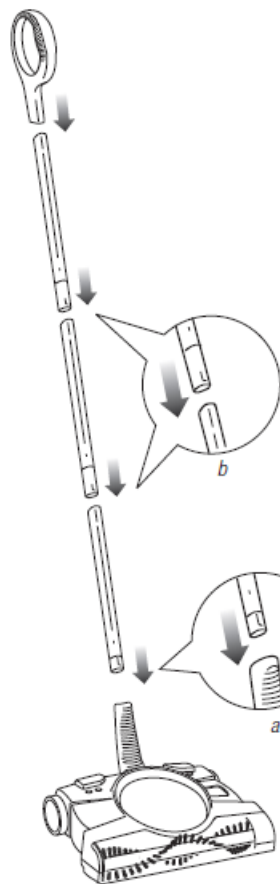

Fig. 1



Fig. 2

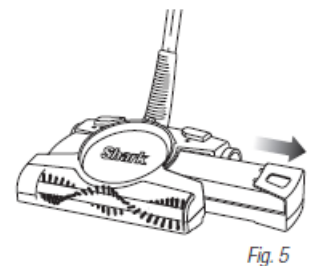

Fig. 5



Fig. 3



Fig. 4



Fig. 6

ASSEMBLE

1. Insert the lower handle extension tube (the shortest of the three tubes) into the lower handle (a). Then assemble the other two extension tubes and insert the assembly into the lower handle extension tube (b). Now attach the upper handle to the top extension tube. (Fig. 1)

CLEAN

2. Pull back on the handle and press lightly on the body of the unit with your foot to engage the steering. (Fig. 2)
3. Using your foot, press the power button and push the unit forward over the surface you wish to clean. (Fig. 3)
4. Press the speed button on the right with your foot to change the speeds. One light indicates the speed optimized to clean bare floors and two lights indicate the speed optimized to clean carpets and larger debris on bare floors. (Fig. 4)

EMPTY

5. When you're finished cleaning, pull the dust container straight out from the side. (Fig. 5)

NOTE: Be careful not to accidentally turn the unit on.

6. Empty dust container contents. (Fig. 6) If desired, you may rinse with water to clean the dust container – but dry thoroughly before replacing.

When finished, replace the dust container.

ASSEMBLY

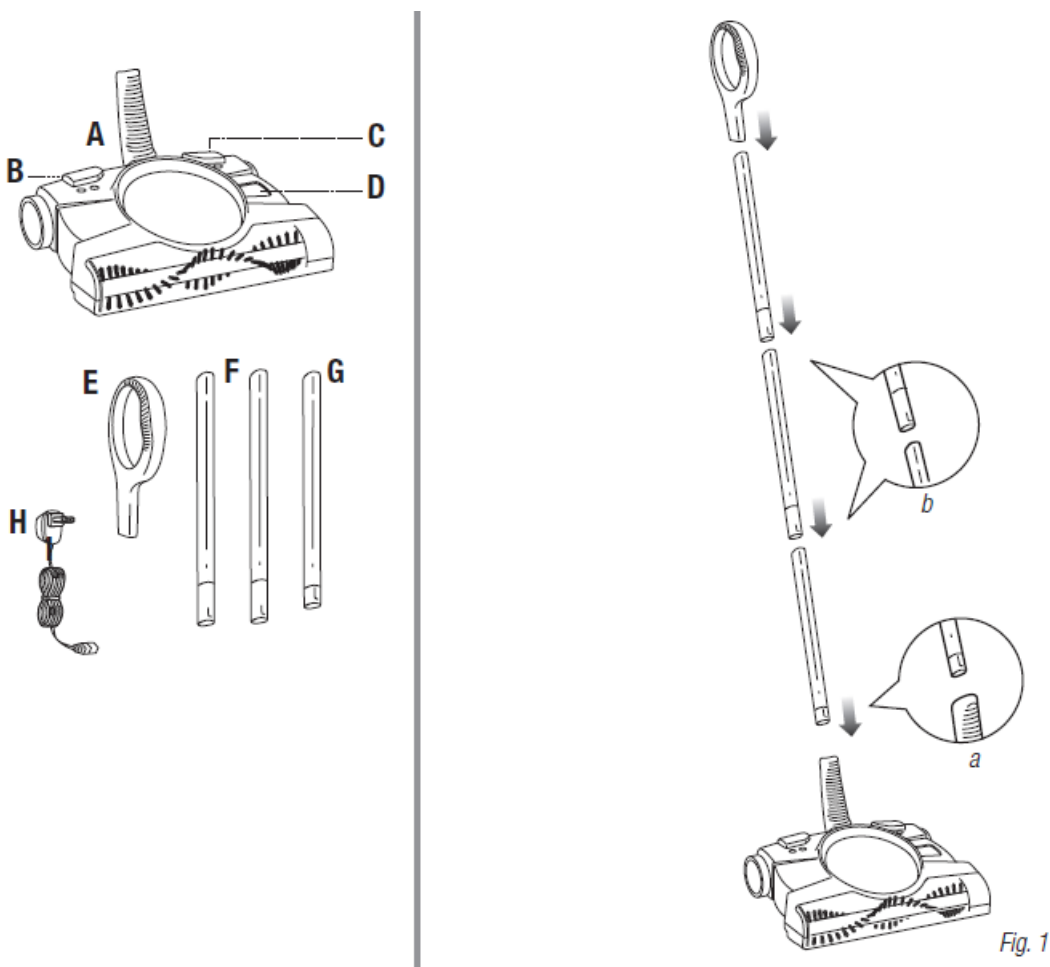

COMPONENTS:

A. Main Unit

- B. Speed Control Button
- C. Power Button
- D. Dust Container
- E. Upper Handle
- F. Extension Tubes
- G. Lower Handle Extension Tube
- H. Charging Adapter

ASSEMBLY OF YOUR FLOOR AND CARPET SWEEPER:

NOTE: The charging adapter and lower handle will be shipped inside the packaging.

IMPORTANT: Charge the batteries for 20 hours before using the unit for the first time. See page 7 for instructions on charging your unit.

1. Insert the lower handle extension tube (the shortest of the three tubes) into the lower handle (a). Then assemble the other two extension tubes and insert the assembly into the lower handle extension tube (b). Now attach the upper handle to the top extension tube. (Fig. 1)

CHARGING YOUR CORDLESS FLOOR AND CARPET SWEEPER

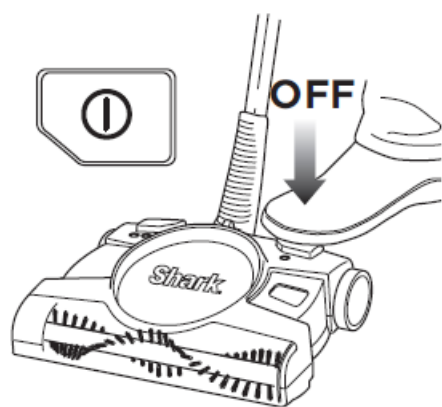

Fig. 2

1. Always make sure that the unit is turned off. (Fig. 2)
2. Insert the charger plug into the hole on the back of the unit. Plug the charger into a wall outlet. The light next to the power button will illuminate when the unit is charging. If the unit is plugged in and the light is not illuminated, press the power button once. The light should now be illuminated indicating that the unit is charging. (Fig. 3)

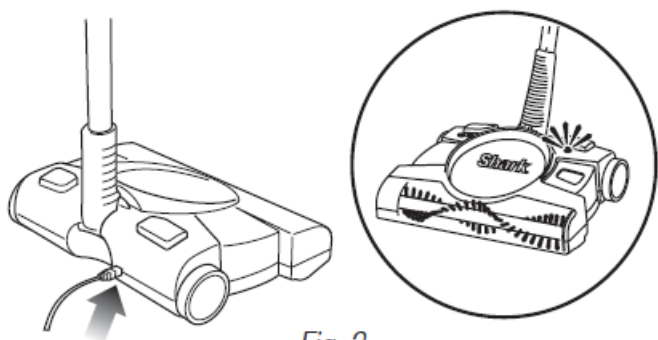

Fig. 3

3. Charge the battery for 20 hours before initial use and 16 hours for each recharge. Your cordless floor and carpet sweeper is powered by Ni-Cd batteries that need this time to build up their charge.

4. For best battery performance, remove the charging adapter from the unit after the charging period has completed. Storing the unit with the adapter attached and plugged in will reduce the battery life.

IMPORTANT: Although many adaptors look similar, it's important to use only the adaptor that came with the unit (XA2940).

NOTE: If you notice a decrease in run time over time, recondition the batteries by running the sweeper until the sound drops significantly, then turn off the unit and charge for 20 hours.

This battery reconditioning process can also be performed as monthly maintenance.

USING YOUR CORDLESS FLOOR AND CARPET SWEEPER

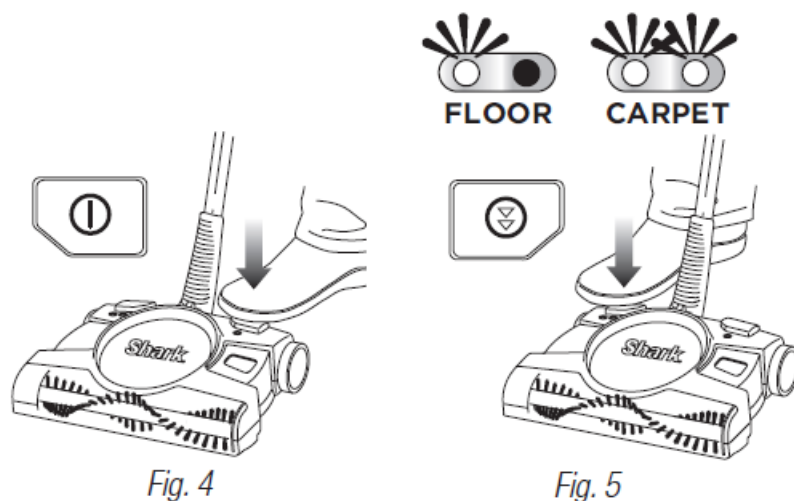

If the brush roll stops moving, it's probably due to the anti-jam feature. This feature protects the motor from becoming overheated. If the brush becomes overloaded, it will stop turning and both speed indicator lights will stay on. Turn off your unit by pressing the power button once. See page 9 for instructions on removing or cleaning the brush roll. Wait for 10 seconds to let your unit cool down. Now press the power button again and you're ready to resume cleaning!

1. Press the power button to start the unit. When finished cleaning, press the power button again to turn the unit off. (Fig. 4)

2. You can adjust the speed of the brush roll to suit the floors that you are cleaning. Press the button on the right (opposite the power button) to switch between speeds. One light indicates the speed optimized to clean bare floors and two lights indicate the speed optimized to clean carpets and larger debris on bare floors. (Fig. 5)

3. Do not use the unit to pick up liquids or clean wet floors.

4. Do not use the unit on concrete, tar or other rough surfaces.

5. Do not use the unit to pick up pieces of string or fabrics. Do not use the unit to clean tasseled or frayed carpets.

EMPTYING THE DUST CONTAINER

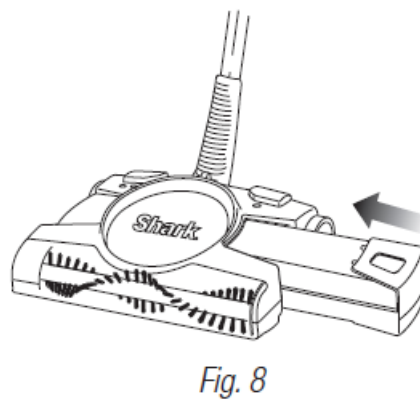
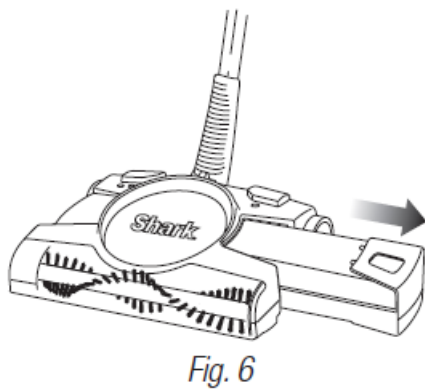

1. To achieve the best performance, empty the dust container after each use. Pull the dust container straight out from the side. (Fig. 6)

NOTE: Be careful not to accidentally turn the unit on.

2. Empty dust container contents. (Fig. 7) If desired, you may rinse with water to clean the dust container – but dry thoroughly before replacing.

3. Re-insert the dust container into the unit. (Fig. 8).

MAINTENANCE

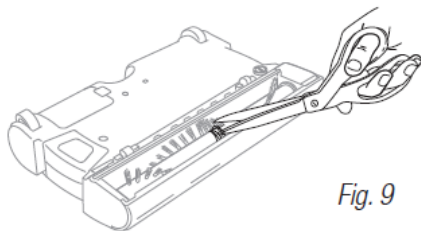

Fig. 9

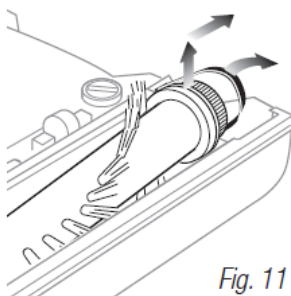

Fig. 11

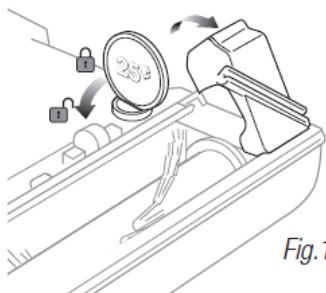

Fig. 10

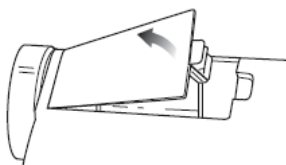

Fig. 12

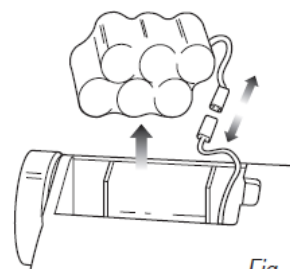

Fig. 13

CAUTION: Do not clean the unit while it is charging.

1. Once a month, wipe down the unit with a dry cloth, including the area under the dust container. Wipe away any hair, fiber or other dirt that may have built up in the chamber and on the rotating brush. Do not use any harsh cleaner or chemicals.
2. Do not immerse the unit in water.

CLEANING THE ROTATING BRUSH

1. Pull the dust container straight out from the side. (Fig. 6)
2. Turn the unit upside down. Be careful not to accidentally turn the unit on!
3. Remove all hair, string or fibers wrapped around the brush bar. Using a pair of scissors, carefully cut along the raised guide to remove anything wound around the brush bar. Avoid damaging or cutting the bristles. (Fig. 9)
4. Use a coin to remove the trap door if you need to remove the brush roll to either clean it or replace it. (Fig. 10)
5. Carefully lift and remove the brushbar from the belt. (Fig. 11) To reinsert the brushbar, slide the brush bar into the bushing and then place the belt over the ridges of the brushbar cap. Replace the trap door and lock in place.

REMOVING AND REPLACING THE BATTERY

NOTE: If uncertain as to how to remove your battery pack, we suggest you take the unit to a reputable small appliance service technician to have this service performed.

1. Pull the dust container straight out from the side. (Fig. 6)
2. Turn the unit upside down. Be careful not to accidentally turn the unit on!
3. Push in the locking tab and lift off the battery compartment cover. (Fig. 12)
4. Carefully lift out the battery pack and disconnect the wire terminals by pressing on the latch and pulling apart the wire terminal connectors. Remove the battery pack. (Fig. 13)
5. Connect the wire terminal from the unit to the wire terminal connector of the new battery pack and replace the battery pack into the unit.
6. Tuck the wiring inside the battery compartment and replace the cover.
7. Follow the instructions on page to charge your new battery pack. Please call customer service at 1-800-798-

7398

if you have any problems removing the battery pack.

IMPORTANT This appliance contains Ni-Cd batteries. The batteries must be recycled or disposed of in accordance with local regulations. Please consult your Yellow Pages or local recycling center for more information.

WARNING: Never use ordinary batteries for replacement as these may leak and cause damage. Use only battery pack XB2940 for replacement.

Ni-Cd BATTERY MUST BE RECYCLED OR DISPOSED OF PROPERLY

TROUBLESHOOTING GUIDE

PROBLEM	POSSIBLE REASONS AND SUGGESTED SOLUTION
The unit will not operate	Batteries need to be recharged. Batteries are dead and need to be replaced. There is no power in the electrical outlet supplying the charging adapter. Try to charge using a different outlet. Ensure the wire terminal connectors on the battery pack are securely attached. Clear any obstruction from the rotating brush. Turn unit off for 10 seconds, and then restart. If the unit still doesn't work, call Customer Service at 1-800-798-7398.
The unit will not pick up	Empty the dust container. Recharge the battery.
Dust is escaping from the unit	Empty the dust container. Ensure that the dust container is properly in place.
The rotating brush will not pick up	Check for and remove any excessive material on the brush roll or in the bottom of the unit. Empty the dust container.
The unit will not charge	Press the power button once to turn the unit "OFF". There is no power in the electrical outlet supplying the charging adapter. Try to charge using a different outlet. Ensure the wire terminal connectors on the battery pack are securely attached. Charging adapter may not be working. Call Customer Service at 1-800-798-7398.
Runtime has decreased over time	Batteries are dead and need to be replaced. Run the sweeper until the sound drops significantly, then turn off the unit and charge for 20 hours to recondition the batteries. Note: This battery reconditioning process can also be performed as monthly maintenance.

ORDERING REPLACEMENT PARTS

REPLACEMENT	PARTS
A. XB2940	Battery Pack
B. XA2940	AC Adapter
C. 1121FK-2940	Brush Bar Replacement Kit

To order any of the above replacement parts, go to www.sharkclean.com or call 1-800-798-7398.

WARRANTY & PRODUCT REGISTRATION

EURO-PRO ONE-YEAR (1) LIMITED WARRANTY

EURO-PRO Operating LLC warrants this product to be free from material defects and workmanship for a period of one (1) year from the date of purchase when utilized for normal household use, subject to the following conditions, exclusions and exceptions.

The liability of EURO-PRO Operating LLC is limited solely to the cost of the repair or replacement of the unit at our option. This Limited Warranty does not cover normal wear of parts and does not apply to any unit that has been tampered with or used for commercial purposes. This Limited Warranty does not cover damage caused by misuse, abuse, negligent handling or damage due to faulty packaging or mishandling in transit. This Limited Warranty does not cover damage or defects caused by or resulting from damages from shipping or repairs, service or alteration to the product or any of its parts, which have been performed by a repair person not authorized by EURO-PRO Operating LLC.

If your appliance fails to operate properly while in use under normal household conditions within the warranty period, you may return the complete appliance and accessories with proof of purchase and date, freight prepaid. For customer service support, call 1-800-798-7398 or visit our website at www.sharkclean.com.

If the appliance is found by EURO-PRO Operating LLC to be defective, in EURO-PRO Operating LLC's sole discretion, we will repair or replace it free of charge. Proof of purchase date and a check made payable to EURO-PRO Operating LLC in the amount of \$19.95 to cover the cost of return shipping and handling must be included.*

Non-durable parts including, without limitation, filters, brushes and electrical parts which normally require replacement are specifically excluded from warranty.

This Limited Warranty is extended to the original purchaser of the unit and excludes all other legal, implied and/or conventional warranties. The responsibility of EURO-PRO Operating LLC if any, is limited to the specific obligations expressly assumed by it under the terms of this Limited Warranty. In no event is EURO-PRO Operating LLC liable for incidental or consequential damages to anyone of any nature whatsoever. Some states do not permit the exclusion or limitation of incidental or consequential damages, so the above may not apply to you. This Limited Warranty gives you specific legal rights, and you may also have other rights which vary from state to state or province to province.

***IMPORTANT:** Carefully pack item to avoid damage in shipping. Be sure to include proof of purchase date and to attach a tag to item before packing including your name, complete address and phone number with a note giving purchase information, model number and what you believe is the problem with the item. We recommend you insure the package (as damage in shipping is not covered by your warranty). Mark the outside of your package "ATTENTION CUSTOMER SERVICE". We are constantly striving to improve our products, therefore the specifications contained herein are subject to change without notice.

PRODUCT REGISTRATION

Please visit www.sharkclean.com or call 1-800-798-7398 to register your new Shark® product within ten (10) days of purchase. You will be asked to provide the store name, date of purchase and model number along with your name and address.

The registration will enable us to contact you in the unlikely event of a product safety notification. By registering you acknowledge to have read and understood the instructions for use, and warnings set forth in the accompanying instructions.

DROIT D'AUTEUR © EURO-PRO OPERATING LLC 2013
USA: Newton, MA 02459
CANADA: Ville St-Laurent, QC H4S 1A7
PRINTED IN CHINA

Illustrations may differ from actual product.
Euro-Pro and Shark, are trademarks of Euro-Pro Operating LLC.
V2940C.E.F.131115.4
www.sharkclean.com
1-800-798-7398

DOWNLOAD

Shark V2940C Cordless Floor And Carpet Sweeper:

Quick Start Guide / Owner's Guide – [[Download PDF](#)]
