



Shark RV1000 Series IQ Robot Vacuum with Self-Empty Base User Manual

[Home](#) » [Shark](#) » Shark RV1000 Series IQ Robot Vacuum with Self-Empty Base User Manual 

Contents

- [1 Shark RV1000 Series IQ Robot Vacuum with Self-Empty Base User Manual](#)
- [2 DOWNLOAD THE SHARKCLEAN APP](#)
- [3 SETUP](#)
- [4 OPTIMIZING YOUR HOME FOR CLEANING](#)
- [5 CONNECTING THE SHARKCLEAN APP AND ROBOT](#)
- [6 Questions?](#)
- [7 WHAT TO EXPECT](#)
- [8 Download](#)
- [9 Related Posts](#)

Shark RV1000 Series IQ Robot Vacuum with Self-Empty Base User Manual



QUICK START GUIDE

This article contains the Guide for the RV1000 Series Shark IQ Robot Vacuum with Self-Empty Base. This supports the following product SKUs RV1000, RV1000C and RV1001.

DOWNLOAD THE SHARKCLEAN APP

To stay current on our latest updates and features,
DOWNLOAD THE SHARKCLEAN APP.
Search “SharkClean” in the app store.



SETUP

STEP 1: PREP THE ROBOT

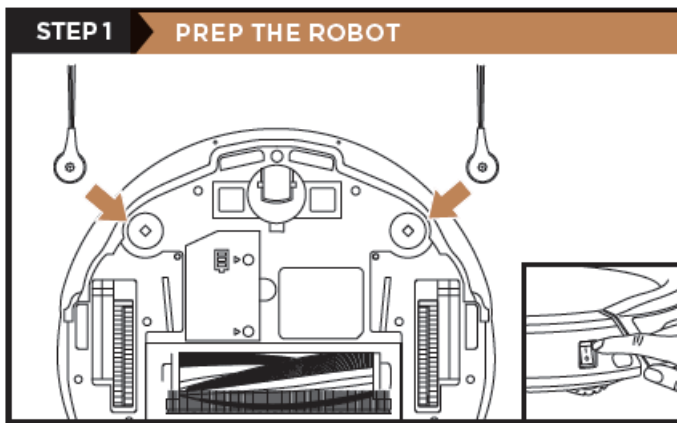

Remove protective film from robot and dock, attach side brushes, and power robot on.

STEP 2: SET UP THE DOCK

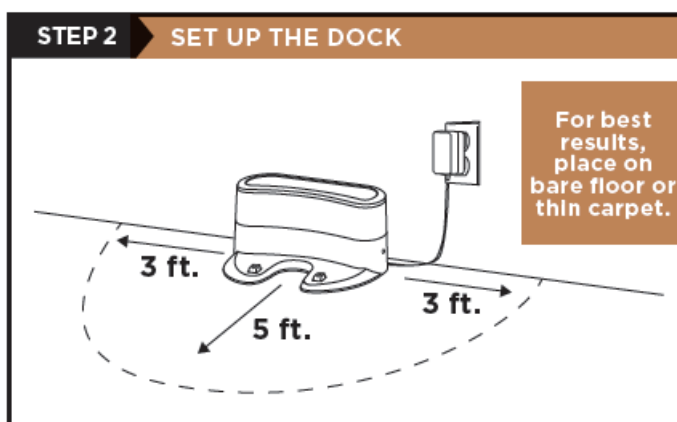

Find a permanent location for the dock in a central area with a strong Wi-Fi signal. Place the dock with its back against the wall, and connect the charging cord to the back. The Indicator Light will illuminate green when the dock has power.

STEP 3: CHARGE THE ROBOT

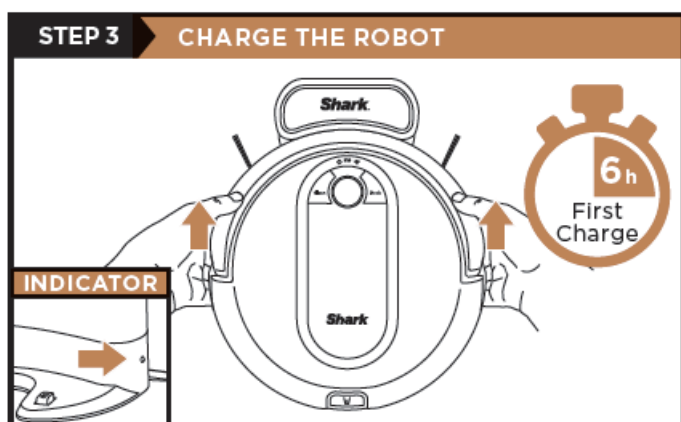

Place robot on dock to charge. The dock indicator light will flash blue and the robot will beep when charging begins.

STEP 4: DOWNLOAD THE APP

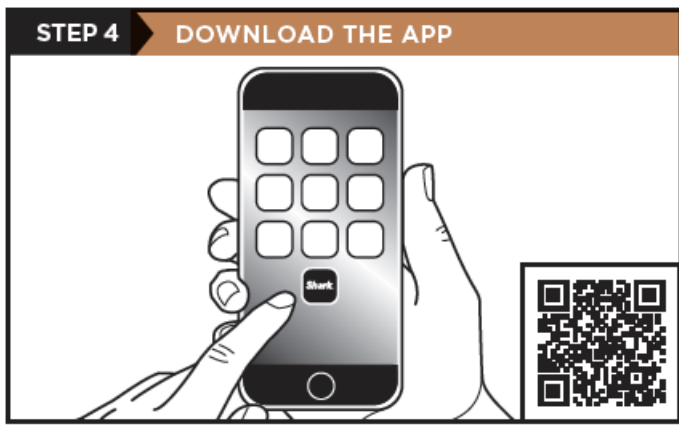

Search “SharkClean” in the app store or scan the QR code and download.

NOTE: For more information on connecting your robot, see next page.

OPTIMIZING YOUR HOME FOR CLEANING

STEP 5: PREP YOUR HOME



Clear cords and remove small objects like toys, clothing, or drapes from floors. Open interior doors where you want your robot to clean.

STEP 6: SET UP FOR SUCCESS

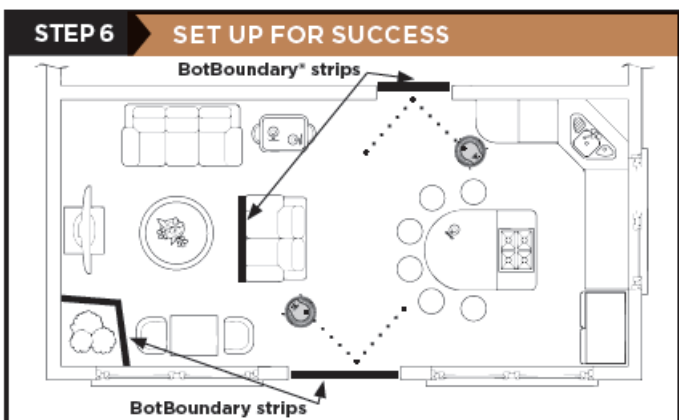

Use the BotBoundary strips to keep your robot out of the areas you would like it to avoid:

- Near power cords or phone chargers that might cause tangles
- In front of high thresholds

CONNECTING THE SHARKCLEAN APP AND ROBOT

Search SharkClean in the app store and download to get started.

STEP 1: Create An Account

Open the SharkClean app and set up your account.



STEP 2: Activate Robot Wi-Fi

Hold down Dock and Clean buttons simultaneously until the Wi-Fi light () on the robot blinks.

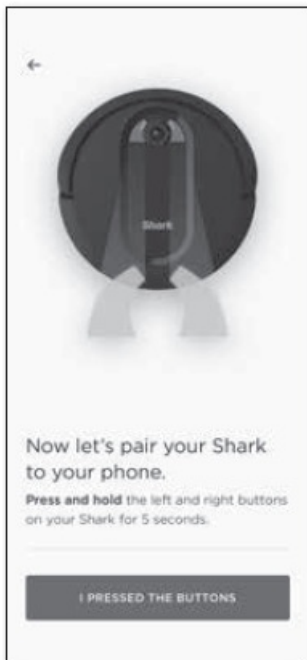

STEP 3: Select Robot

- Exit the app and open Wi-Fi settings.
- Select your robot (Ex. Shark_RVXXX) from the menu.
- Exit settings and return to the SharkClean app.

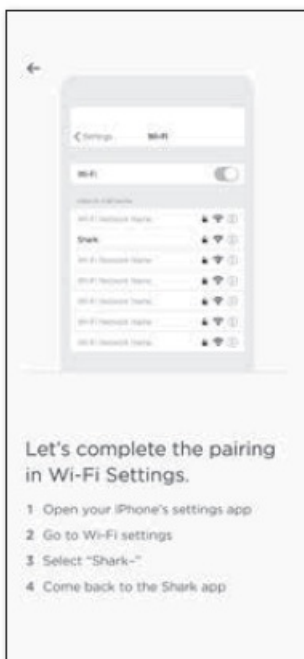

STEP 4: Connect To Home Wi-Fi

Select your home Wi-Fi network and enter your password.

NOTE: Most networks are 2.4ghz— your app will only work on this type.



STEP 5: Success!

When pairing is complete, the Success screen will appear.



Questions?

Two Easy Steps If You're Stuck:

1. Having trouble connecting to your robot? Call 1-888-228-5531 for robot support.
2. For additional help, visit: sharkclean.com/support
 - How-to Videos
 - FAQs
 - Troubleshooting
 - Tips & Tricks

Smart Home Setup

To set up voice control using Google Home or Amazon Alexa, visit sharkclean.com/app for instructions.

WHAT TO EXPECT

As your robot learns your home, you may need to make some small adjustments to optimize performance.

INTERACTIVE MAP

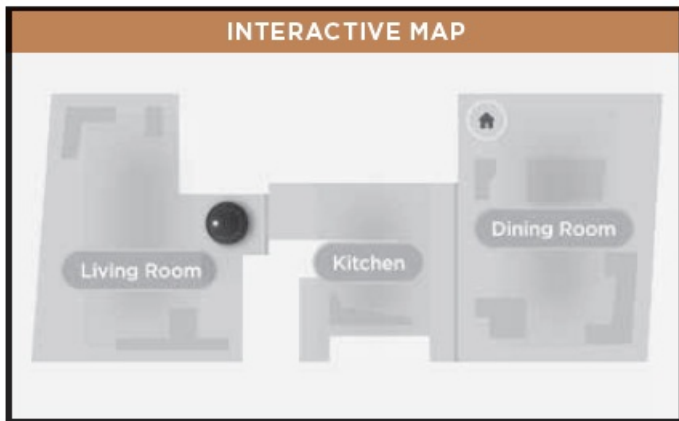

Depending on your home layout, your robot may take several runs to build a complete map.

SCHEDULING

For a constant state of clean, set up a cleaning schedule in the app.

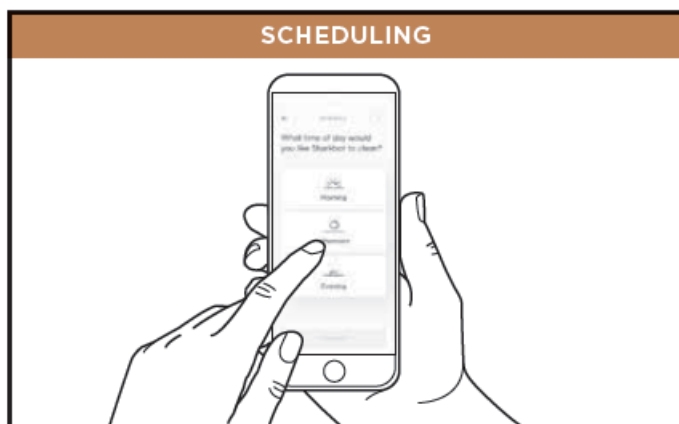

AVOID MOVING THE ROBOT OR DOCK

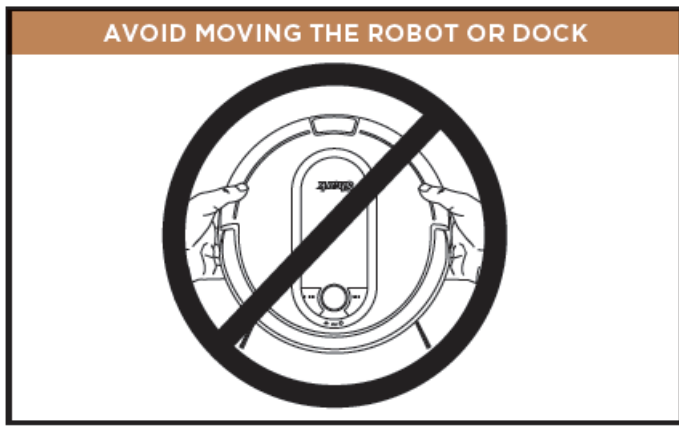

While your robot is cleaning, do not pick it up and move it, or move the charging dock—this could impact the robot's ability to map your home.

EMPTYING THE DUST BIN

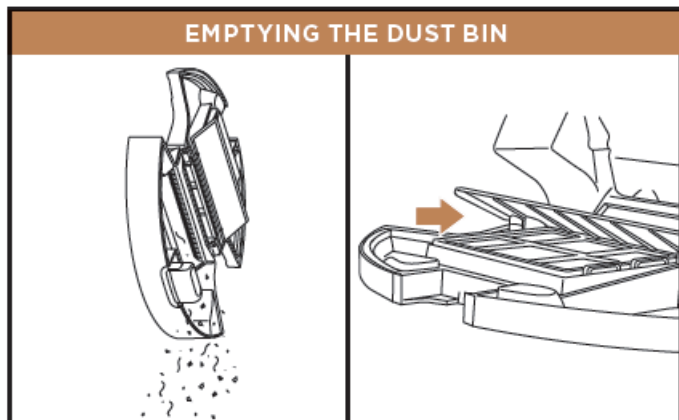

During the first few weeks of use, the dust bin will need to be emptied frequently. Empty debris and dust into trash.

Look between the filter and plastic shield and make sure there is no debris buildup.

LIGHTING CONDITIONS

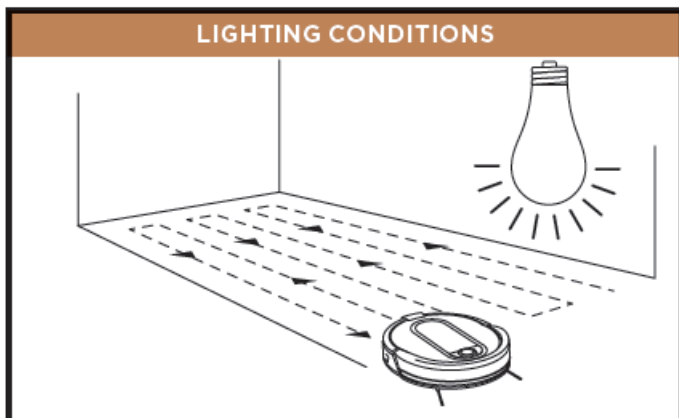

Run your robot in well-lit conditions. If you are running your robot at night, make sure to turn on the lights.

DOORWAYS AND THRESHOLDS

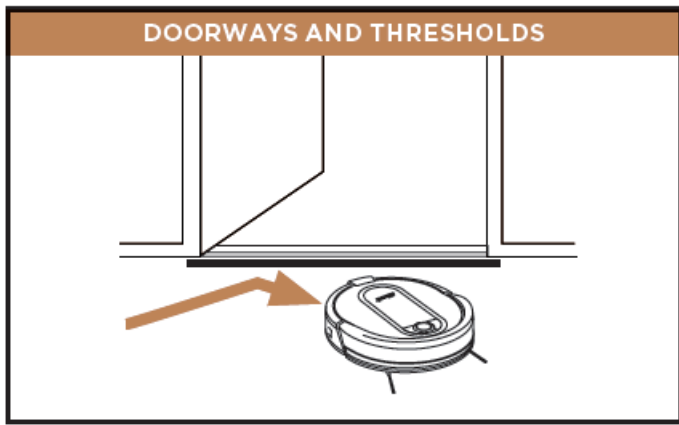

Your robot can easily climb over most common thresholds. However, in some situations they may present a challenge. Use BotBoundary® strips to block off these areas.

© 2019 SharkNinja Operating LLC. BOTBOUNDARY and SHARK are registered trademarks of SharkNinja Operating LLC. IQ NAV, SHARK IQ ROBOT is a trademark of SharkNinja Operating LLC.
RV1000_QSG_E_MP_Mv19

Download

Shark RV1000 Series IQ Robot Vacuum with Self-Empty Base:

Quick Start Guide – [[Download PDF](#)]

Owner's Guide – [[Download PDF](#)]
