



# Shark RV900S Series Robot Self-Empty Vacuum User Manual

[Home](#) » [Shark](#) » Shark RV900S Series Robot Self-Empty Vacuum User Manual 

Shark RV900S Series Robot Self-Empty Vacuum



## Contents

### 1 SETUP

- 1.1 STEP 1 PREP THE ROBOT
- 1.2 STEP 2 SET UP THE BASE
- 1.3 STEP 3 PLUG IN THE BASE
- 1.4 STEP 4 CHARGE THE ROBOT

### 2 OPTIMIZING YOUR HOME FOR CLEANING

- 2.1 STEP 5 PREP YOUR HOME
- 2.2 STEP 6 DOWNLOAD THE SHARKCLEAN® APP

### 3 WHAT TO EXPECT

- 3.1 AVOID MOVING THE ROBOT OR BASE
- 3.2 CHECK BASE FILL LEVEL
- 3.3 LIGHTING CONDITIONS
- 3.4 DOORWAYS AND THRESHOLDS

### 4 Documents / Resources

- 4.1 References

### 5 Related Posts

## SETUP

## STEP 1 PREP THE ROBOT

- Remove protective film from robot and base.
- Snap the single side brush onto the post on the bottom of the robot.
- Turn on the power by pressing the button on the side of the robot to the (I) ON position.

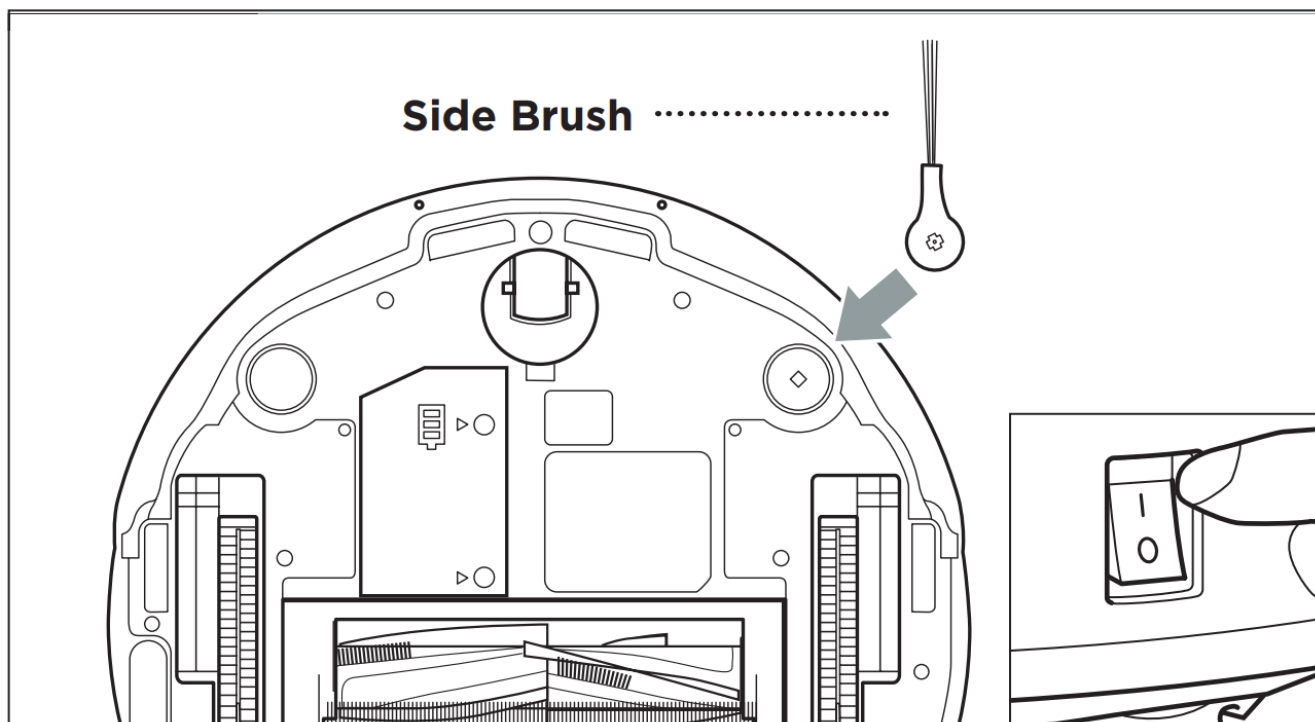

## STEP 2 SET UP THE BASE

Find a permanent location for the base. Place it with its back against a wall, in an area with a strong Wi-Fi signal. Remove any objects that are closer than 3 ft. from either side of the base, or closer than 5 ft. from the front. For best results, set up base on bare floor.

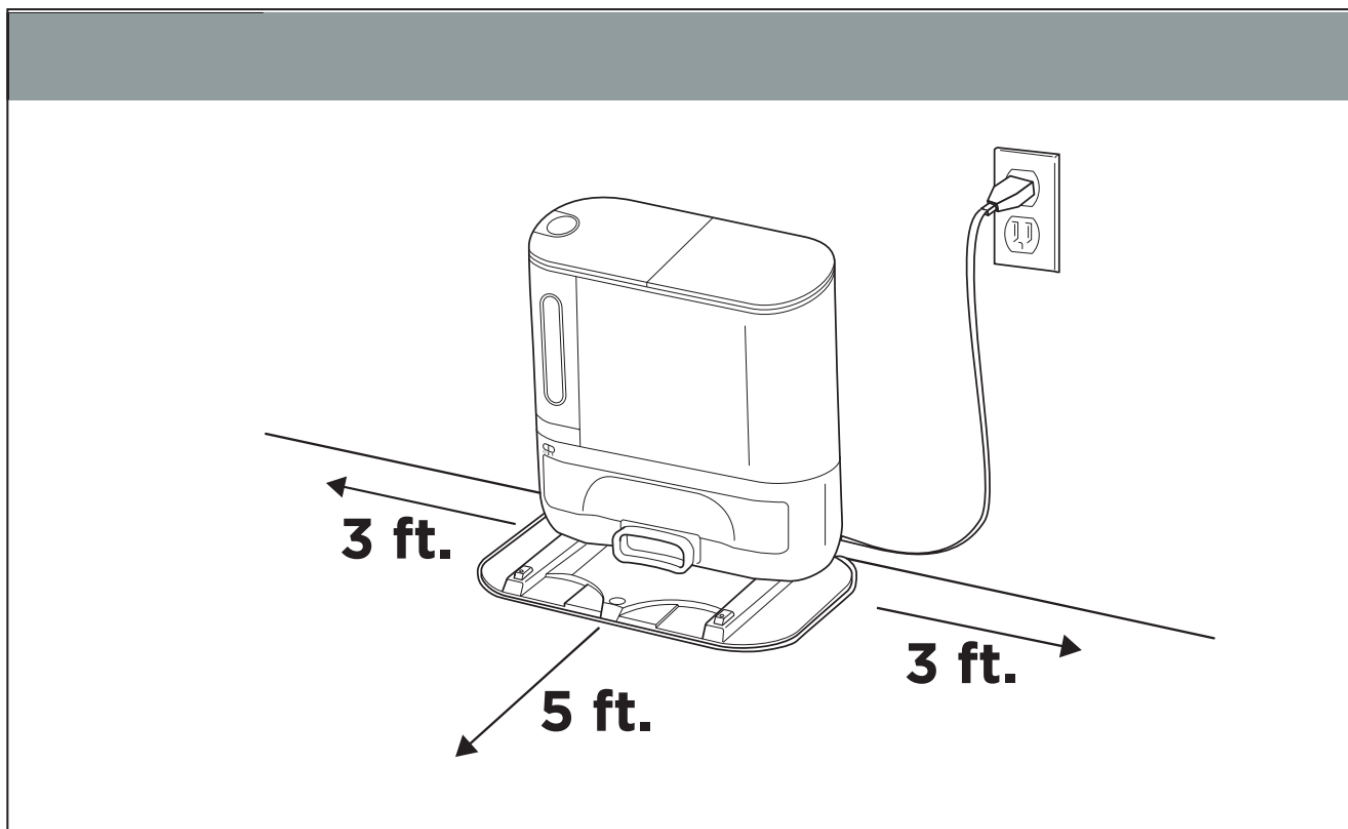

### STEP 3 PLUG IN THE BASE

- Plug the base power cord into an electrical outlet.
- Turn the power switch on the back of the base to the (I) ON position.
- The green power indicator light  on the base will illuminate when the base has power.

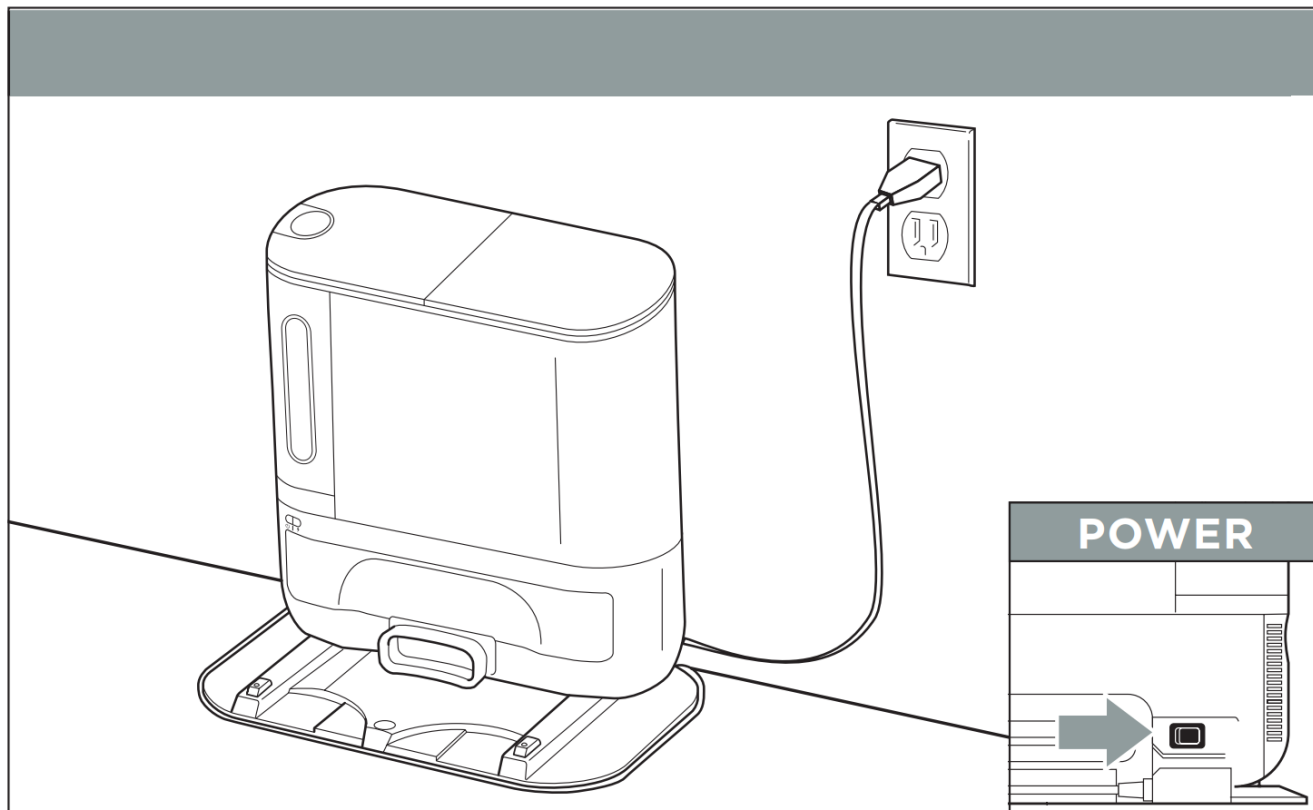

### STEP 4 CHARGE THE ROBOT

- To charge, place robot with its BACK side against base.  
Turn power switches on BOTH robot and base to (I) ON position.
- When charging begins, robot will beep and BLUE charging indicator light on base will PULSE. When robot is fully charged, light will turn SOLID blue.

**NOTE:** Every time the robot returns to the base, it will make a loud noise as it empties debris. This is normal and no cause for concern.

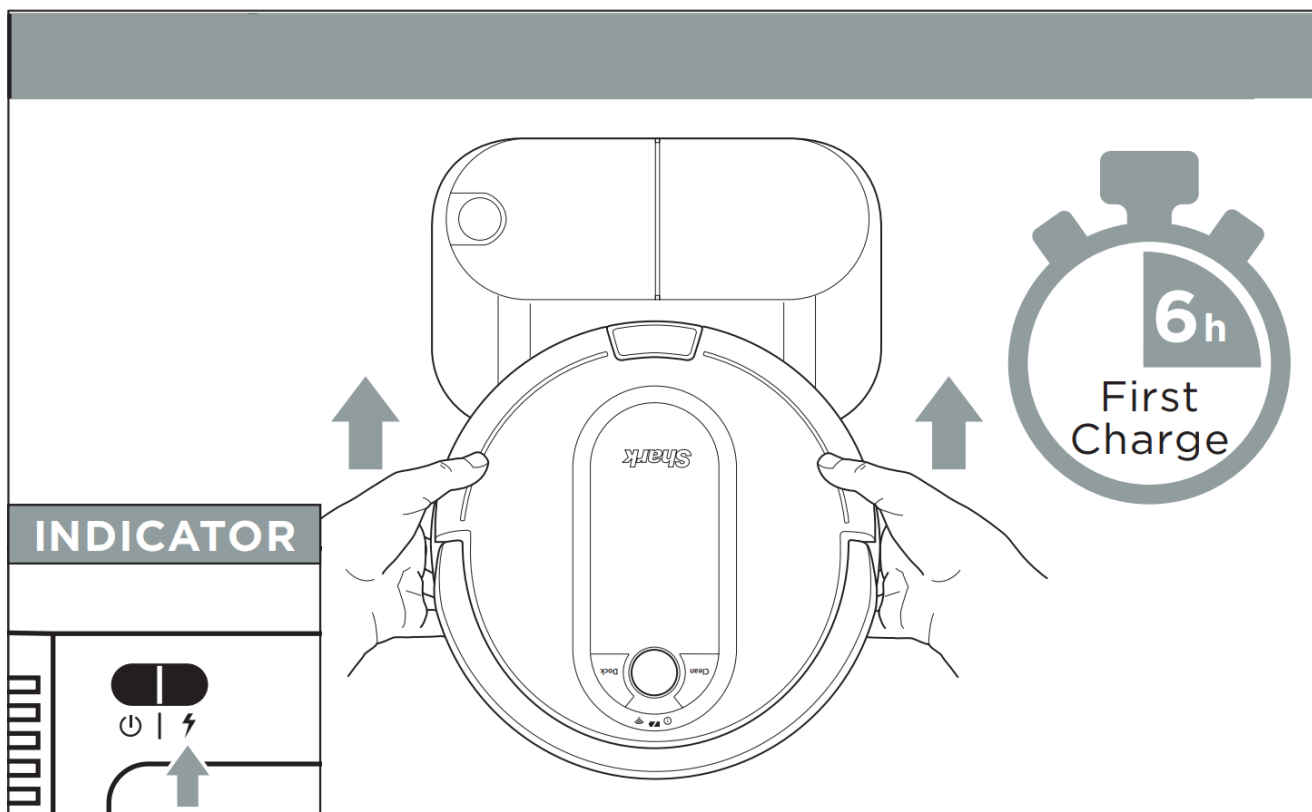

## OPTIMIZING YOUR HOME FOR CLEANING

### STEP 5 PREP YOUR HOME

Clear cords and remove small objects like toys, clothing, or drapes from floors. Open interior doors in rooms you want your robot to clean. For best results, run your robot in well-lit conditions.

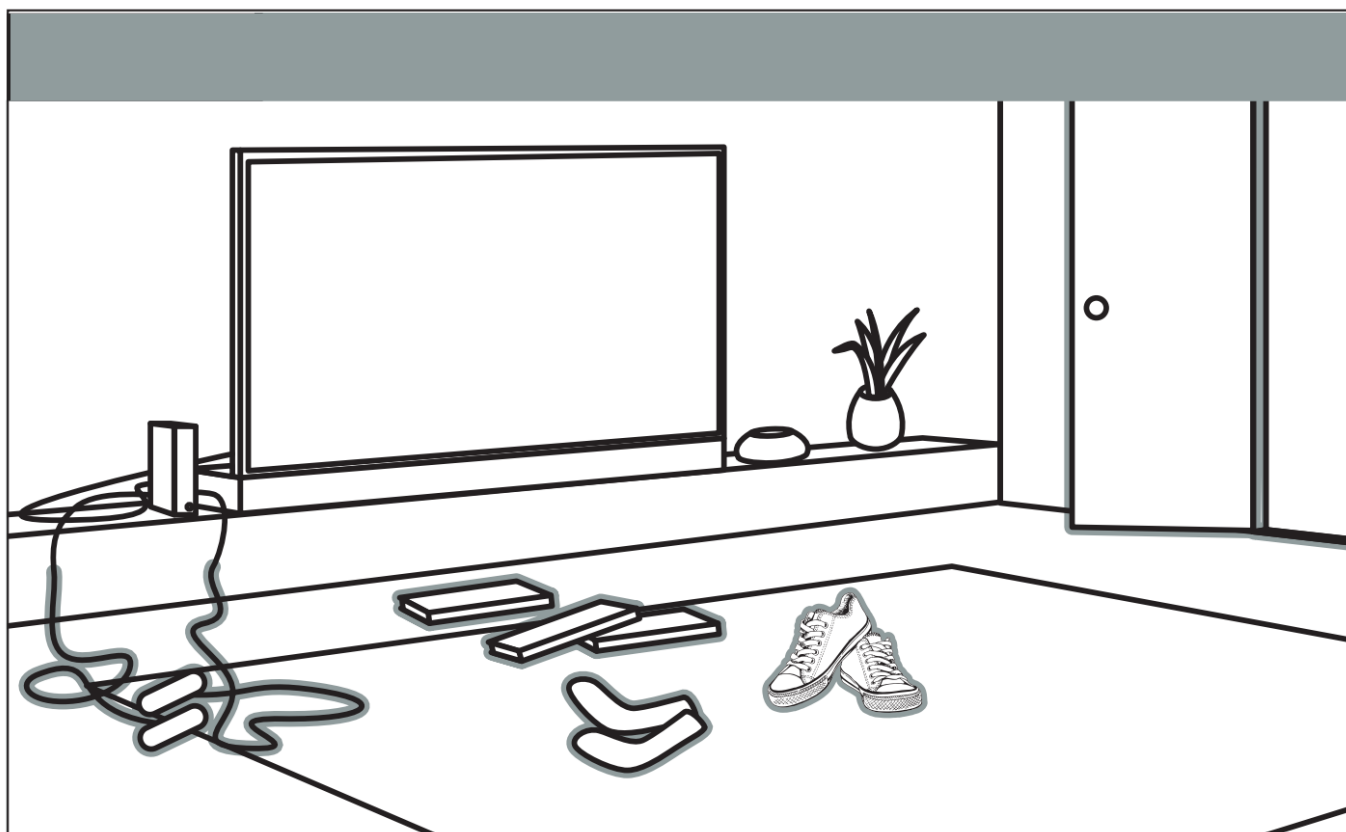

### STEP 6 DOWNLOAD THE SHARKCLEAN® APP

Scan QR code with your phone's camera to quickly find and download the app



Search “Shark Clean” in the app store. Some of the exclusive features in the app:

- Cleaning Reports • Scheduled Cleaning
- Extended Clean • Cleaning Modes

## WHAT TO EXPECT

As your robot learns your home, you may need to make some small adjustments to optimize performance.

### AVOID MOVING THE ROBOT OR BASE

While your robot is cleaning, DO NOT pick it up and move it, or move the charging base—this will impact the robot's ability to clean your home.

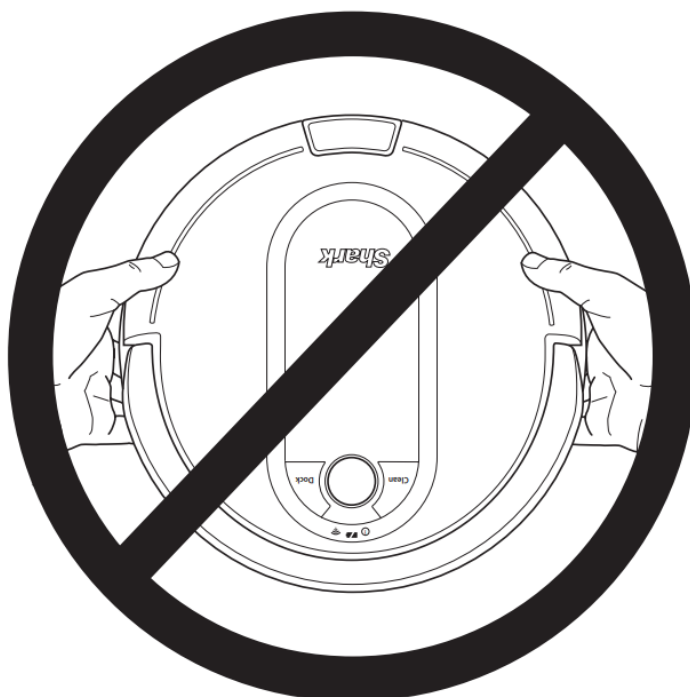

### CHECK BASE FILL LEVEL

During the first few weeks, your robot will empty more debris than usual. Check the fill level regularly. The dust bin

is designed to hold up to 30 days' worth of debris, but home environments vary, and the bin may fill up quicker in some homes.

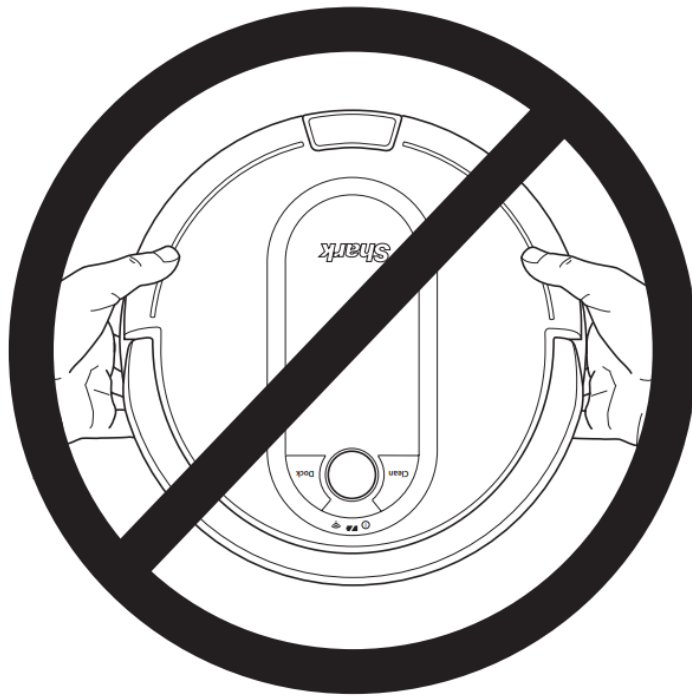

#### LIGHTING CONDITIONS

For best results, run your robot in well-lit conditions.

If you run your robot at night, keep the lights on in the areas to be cleaned.

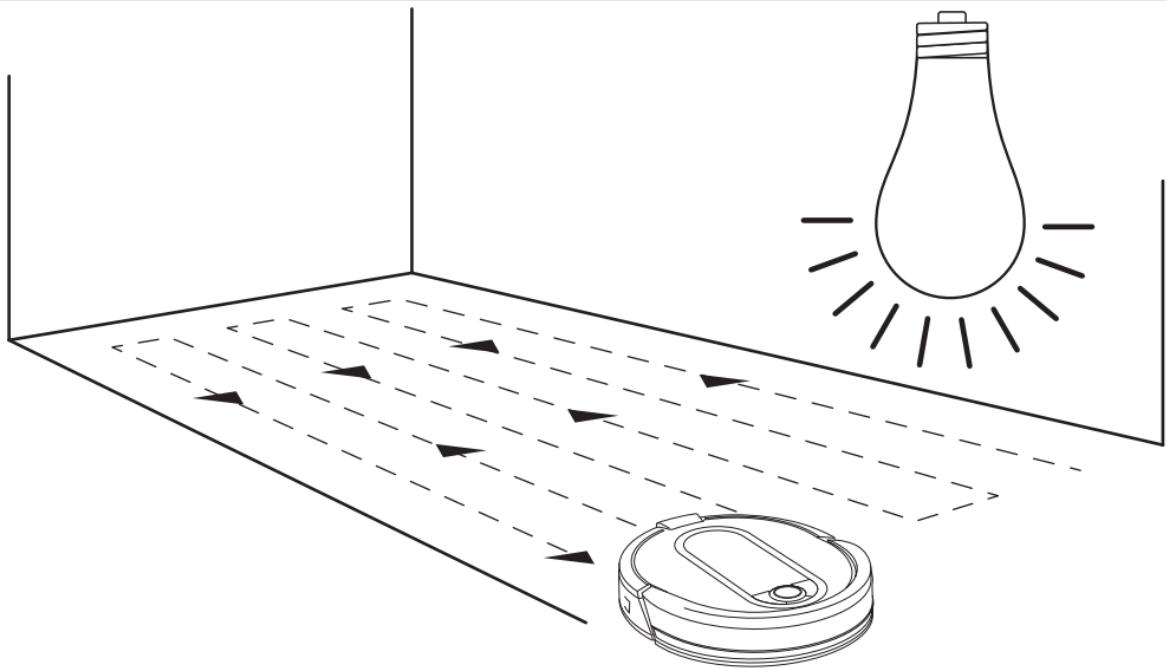

#### DOORWAYS AND THRESHOLDS

Your robot can easily climb over most thresholds, but if one is higher than an inch, block it off with a BotBoundary® strip. BotBoundary strips are not included in the box. To purchase, please visit [sharkaccessories.com](https://sharkaccessories.com).

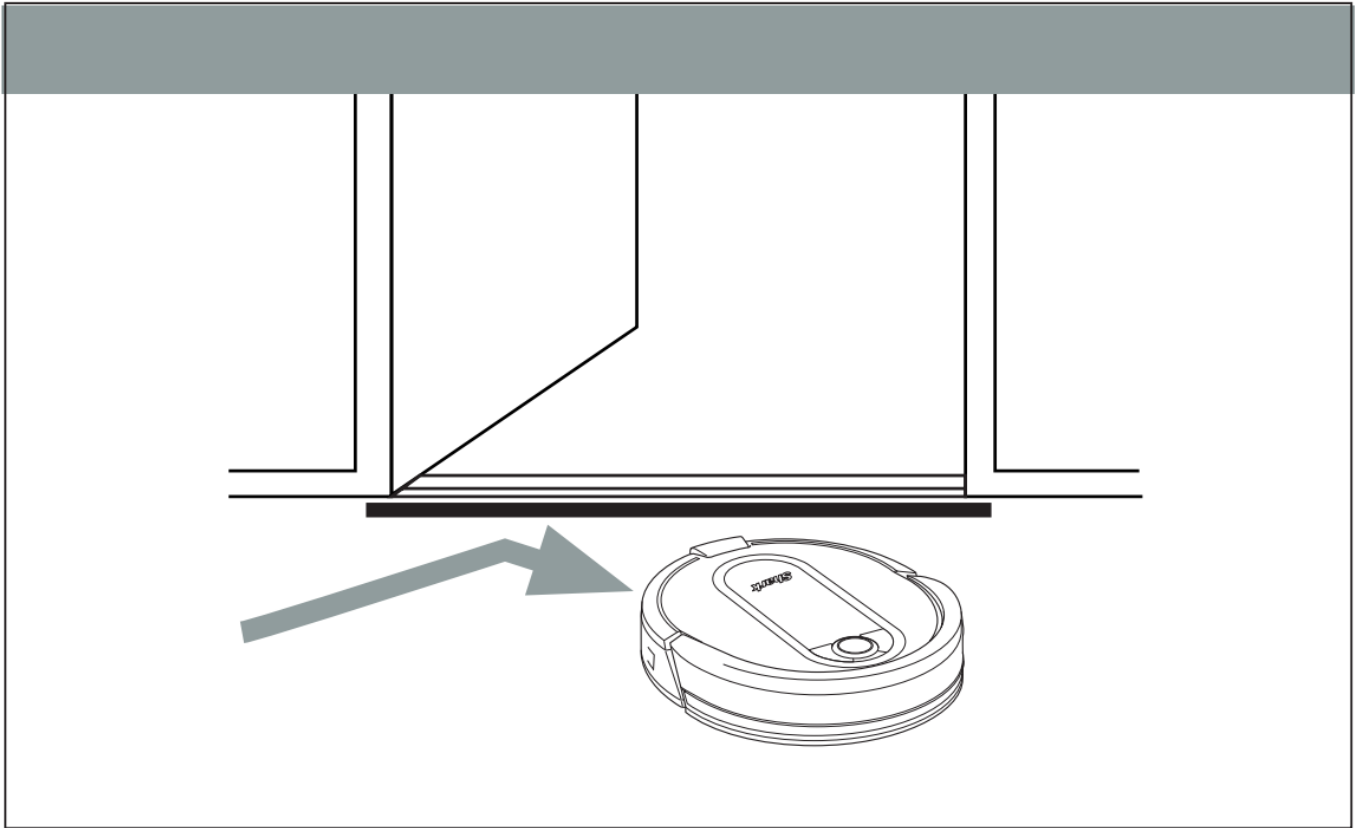

### **CAN'T CONNECT TO WI-FI?**

#### **Restart your phone**

- Turn off phone, wait a few minutes, then turn it back on and connect to Wi-Fi.

#### **Reboot your robot**

- Make sure the power switch on the back of the BASE is in the ON position.
- Press the power button on the side of the ROBOT to the OFF position. Wait 10 seconds, then press it again to turn power back ON.

#### **Reboot your router**

- Unplug the router power cable for 30 seconds, then plug it back in. Allow several minutes for your router to reboot completely

### **Questions? One Easy Step If You're Stuck:**

Having trouble connecting to your robot?

For how-to videos, FAQs, troubleshooting, and tips & tricks visit: [sharkclean.com/support](https://sharkclean.com/support)

#### **Smart Home Setup**

To set up voice control using Google Home or Amazon Alexa, visit [sharkclean.com/app](https://sharkclean.com/app) for instructions.





@sharkcleaning

## Documents / Resources

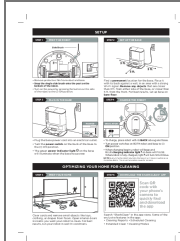

[Shark RV900S Series Robot Self-Empty Vacuum](#) [pdf] User Manual  
RV900S Series Robot Self-Empty Vacuum, RV900S Series, Robot Self-Empty Vacuum, Self-Empty Vacuum, Vacuum

## References

- [Find Sharkclean Parts & Accessories | Sharkclean](#)
- [S Robot Vacuum Cleaner | Automatic Vacuum | Shark® Robotic Vacuum](#)

Manuals+.