

Shark
RV2620WDEU
Matrix Robot 2
In 1 Robotic
Vacuum
Cleaner



Shark RV2620WDEU Matrix Robot 2 In 1 Robotic Vacuum Cleaner Instructions

[Home](#) » [Shark](#) » Shark RV2620WDEU Matrix Robot 2 In 1 Robotic Vacuum Cleaner Instructions 

Contents

- [1 Shark RV2620WDEU Matrix Robot 2 In 1 Robotic Vacuum Cleaner](#)
- [2 Usage Instructions:](#)
- [3 SETUP](#)
- [4 FAQs](#)
- [5 Documents / Resources](#)
 - [5.1 References](#)

Shark

Shark RV2620WDEU Matrix Robot 2 In 1 Robotic Vacuum Cleaner



Specifications

- Product Name: ROBOT 2-in-1 Robotic Vacuum Cleaner
- Model: RV2620WDEU
- Manufacturer: SharkNinja
- Website: sharkclean.eu

Product Information:

The ROBOT 2-in-1 Robotic Vacuum Cleaner is a smart cleaning device designed to efficiently clean your home. It features advanced technology such as laser navigation for precise cleaning and can be controlled through the SharkClean App.

Usage Instructions:

Safety Instructions:

Before using the vacuum cleaner, carefully inspect all parts for any damage. Do not use the device if any part is damaged. Always use identical replacement parts as specified in the user manual.

Battery Usage:

Ensure to use Bot-Boundary strips around reflective surfaces and floors to define no-go zones for the vacuum cleaner. Do not place these strips within 3 meters of the docking station.

Setting Up:

1. Place the charging dock on a flat surface.
2. Download the SharkClean App by scanning the QR code with your smartphone camera.
3. Turn on the robotic vacuum cleaner and let it charge for at least 6 hours for the initial setup.

App Features:

- Room selection
- Spot cleaning
- No-go zones
- Scheduling
- Carpet zones

IMPORTANT SAFETY INSTRUCTIONS

PLEASE READ CAREFULLY BEFORE USE • FOR HOUSEHOLD USE ONLY

WARNING

To reduce the risk of fire, electric shock, injury, or property damage:

- CHILDREN OR ANIMALS SHOULD NOT BE LEFT UNATTENDED IN ANY ROOMS THAT THE ROBOTIC VACUUM HAS ACCESS TO DURING CLEANING.

LASER WARNING

THIS PRODUCT HAS A CLASS 1 LASER. ALWAYS TURN OFF THE POWER BEFORE LIFTING THE ROBOTIC VACUUM CLEANER OR PERFORMING ANY MAINTENANCE ON IT. DO NOT LOOK DIRECTLY INTO LASER.

- IF THE CHARGING CABLE PLUG DOES NOT FIT FULLY INTO THE SOCKET, CONTACT A QUALIFIED ELECTRICIAN. DO NOT FORCE INTO SOCKET OR TRY TO MODIFY TO FIT.

GENERAL WARNINGS

When using an electrical appliance, basic precautions should always be followed, including the following:

1. This appliance consists of a Wet/Dry Robot Floor Cleaner vacuum and charging dock with power supply. These components contain electrical connections, electrical wiring, and moving parts that potentially present risk to the user.
2. Before each use, carefully inspect all parts for any damage. If a part is damaged, discontinue use.
3. Use only identical replacement parts. See replacement accessories page of this booklet.
4. This Wet/Dry Robot Floor Cleaner contains no serviceable parts.
5. Use only as described in this manual. DO NOT use Wet/Dry Robot Floor Cleaner for any purpose other than those described in this manual.
6. With exception of filters, dust cups and pads, DO NOT expose any parts of the Wet/ Dry Robot Floor Cleaner to water or other liquids.
7. DO NOT put hands into any opening in the dock or robot.

USE WARNINGS

8. This product has a Class 1 Laser. Always turn off the power before lifting the robotic vacuum cleaner or performing any maintenance on it.
9. DO NOT look directly into laser.
10. Always turn off the robotic vacuum cleaner before inserting or removing the filter, dustbin, or fluid reservoir.
11. DO NOT handle plug, charging dock, charging cable, or Wet/Dry Robot Floor Cleaner with wet hands. Cleaning and user maintenance must not be done by children without supervision
12. Children should NOT play with the appliance.
13. This appliance can be used by children aged from 8 years and above and persons with reduced physical, sensory, or mental capabilities or lack of experience and knowledge if they have been given supervision or instruction concerning use of the appliance in a safe way and understand the hazards involved.
14. DO NOT use the robot without the dustbin, filter, and fluid reservoir in place.
15. DO NOT damage the charging cord:
 - DO NOT pull or carry charging dock by the cord or use the cord as a handle.
 - DO NOT unplug by pulling on cord. Grasp the plug, not the cord.
 - DO NOT close a door on the cord, pull the cord around sharp corners, or leave the cord near heated surfaces.
 - The supply cord cannot be replaced. If the cord is damaged the appliance should be scrapped.
16. DO NOT put any objects into nozzle or accessory openings. DO NOT use with any opening blocked; keep free of dust, lint, hair, and anything that may reduce airflow.
17. DO NOT use if Wet/Dry Robot Floor Cleaner airflow is restricted. If the air paths become blocked, turn the vacuum cleaner off and remove all obstructions before turning on the unit again.
18. Keep nozzle and all vacuum openings away from hair, face, fingers, uncovered feet, or loose clothing.
19. DO NOT use if Wet/Dry Robot Floor Cleaner is not working as it should, or has been dropped, damaged, left outdoors, or dropped into water.
20. DO NOT place vacuum cleaner on unstable surfaces.
21. DO NOT use to pick up:

- Liquids.
- Large objects.
- Hard or sharp objects (glass, nails, screws, or coins).
- Large quantities of dust (drywall dust, fireplace ash, or embers.)
- DO NOT use as an attachment to power tools for dust collection.
- Smoking or burning objects (hot coals, cigarette butts, or matches).
- Flammable or combustible materials (lighter fluid, petrol, or kerosene).
- Toxic materials (chlorine bleach, ammonia, or drain cleaner).
- Toxic materials (high concentrations of chlorine bleach liquid, high concentrations of ammonia, or drain cleaning solution).

22. DO NOT use in the following areas:

- Outdoor areas near fireplaces with
- Spaces that are enclosed and may contain explosive or toxic fumes or vapors (lighter fluid, petrol, kerosene, paint, paint thinners, mothproofing substances, or flammable dust
- In an area with a space heater
- Near fireplaces with unobstructed entrances.

23. Turn off the Wet/Dry Robot Floor Cleaner before any adjustment, cleaning, maintenance or troubleshooting.

Note: in the OFF (O) position, the robot still uses a small amount of power.

24. Allow all filters to air-dry completely before reinstalling them to prevent liquid from being drawn into electric parts.

25. DO NOT modify or attempt to repair the robotic vacuum cleaner or the battery yourself, except as indicated in this Owner's Guide. DO NOT use the vacuum if it has been modified or damaged.

26. Remove all spilled or leaked liquid from the dock landing mat, base or floor, as it could lead to risk of electrical shock.

27. When refilling the reservoir, check for leaks, as pooled liquids are a slipping hazard and may cause electrical shock. If the reservoir is damaged, it must be replaced.

28. Use caution walking on mopped floors, as they may be slippery while damp.

29. DO NOT use any household cleaners (all-purpose cleaners, glass cleaners, bleach) on any of the polished high gloss surfaces on the docking station or robot vacuum cleaner as they contain chemicals that may damage these surfaces. Instead use a cloth dampened with water to gently clean.

30. To minimise the risk of the robot traveling beyond an unsafe boundary (stair or cliff edges, fireplaces, water hazards), establish these areas as no-go zones using the mapping feature in the SharkClean mobile app. Upon setting the boundary, run the vacuum and visually confirm that the settings effectively prevent the robot from passing beyond the set boundary. Adjust settings as necessary. For nonapp users, use a boundary to block off an unsafe boundary.

BATTERY USE

31. The battery is the power source for the vacuum. Carefully read and follow all charging instructions.

32. To prevent unintentional starting, ensure the vacuum is powered off before picking it up or carrying it. DO NOT carry the appliance with your finger on the power switch.

33. Use ONLY the Shark® charging dock XDKR2600WFEU and use only battery RVBAT850A. Use of batteries or battery chargers other than those indicated may create a risk of fire.

34. Keep the battery away from all metal objects such as paper clips, coins, keys, nails, or screws. Shorting the battery terminals together increases the risk of fire or burns.

35. Under abusive conditions, liquids may be ejected from the battery. Avoid contact with this liquid, as it may

cause irritation or burns. If contact occurs, flush with water. If liquid contacts eyes, seek medical help.

36. Robotic vacuum cleaner should not be stored, charged, or used at temperatures below 50°F (10°C) or above 104°F (40°C). Ensure the battery and vacuum have reached room temperature before charging or use. Exposing the robot or battery to temperatures outside of this range may damage the battery and increase the risk of fire.
37. DO NOT expose the Wet/Dry Robot Floor Cleaner or battery to fire or temperatures above 130°C (265°F) as it may cause explosion.

NO-GO ZONES AND BOTBOUNDARY STRIPS

38. DO NOT put BotBoundary strips underneath
39. DO NOT place BotBoundary strips on top of one another.
40. Always use no-go zones or Bot-Boundary strips around reflective flooring and surfaces.
41. No-go zones or BotBoundary strips should always be used near carpeted stairs.
42. DO NOT use no-go zones or Bot-Boundary strips within 3 metres of the dock.
43. For your robot's cliff sensors to work properly, all runners, rugs, carpets, or small thresholds (like child gates) must be 20 centimetres from any stairs (or must be continuous and extend over the edge of the stairs). If a runner, rug, carpet, or small threshold that is less than 20 centimetres from the stairs cannot be moved, you must use a no-go zone or a BotBoundary strip to block off the stairs.

SAVE THESE INSTRUCTIONS

For the latest warnings and cautions, go to www.sharkclean.co.uk/robohelp

DOWNLOAD THE SHARKCLEAN APP



Scan QR code with your phone's camera to quickly find and download the app

GETTING THE MOST OUT OF YOUR EXPECTATION ROBOT

To get the best experience, download the SharkClean app and follow the tips below.

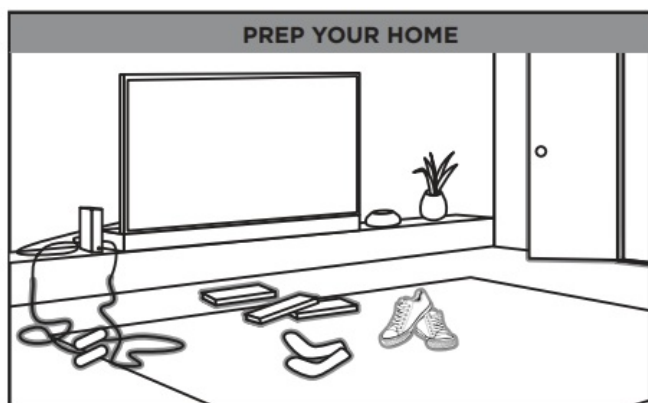

- Before each clean, clear cords and remove small objects like clothing or toys that are less than 11.5cm tall.
- Open interior doors in rooms you want your robot to clean.
- For a constant state of clean, set up a whole-home cleaning schedule in the app.
- Use the interactive home map for an even more customizable clean.

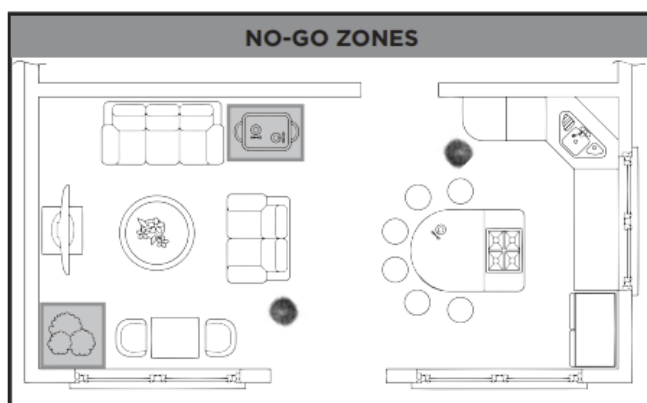
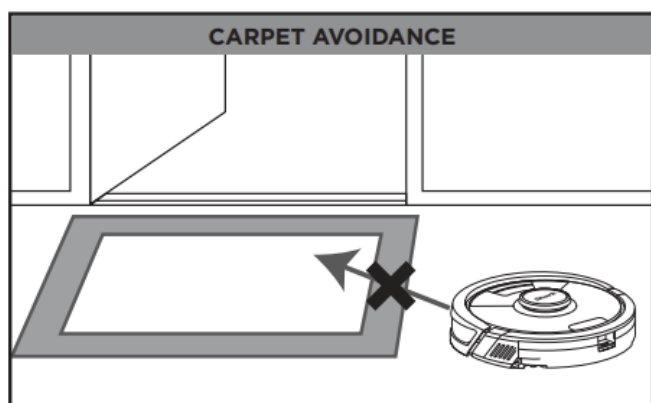

- When your home map is set up, you can use the app to identify carpets and rugs so the robot can avoid them when it mops. If rugs are blocking your robot's path to another room in mopping mode, you may need to move them.
- Create no-go zones in the app to keep your robot out of the areas you would like it to avoid:
 - Near power cords or phone chargers.
 - In front of high thresholds.

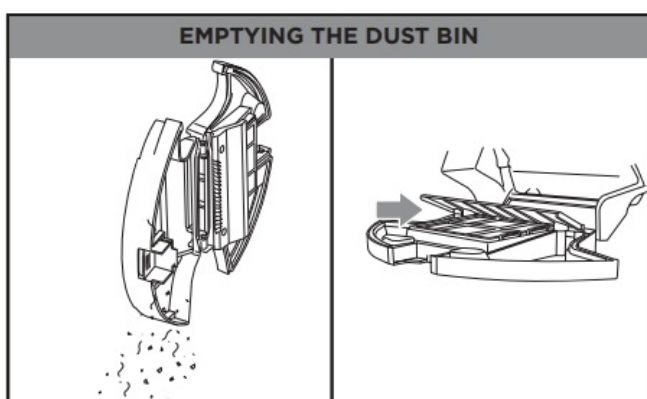
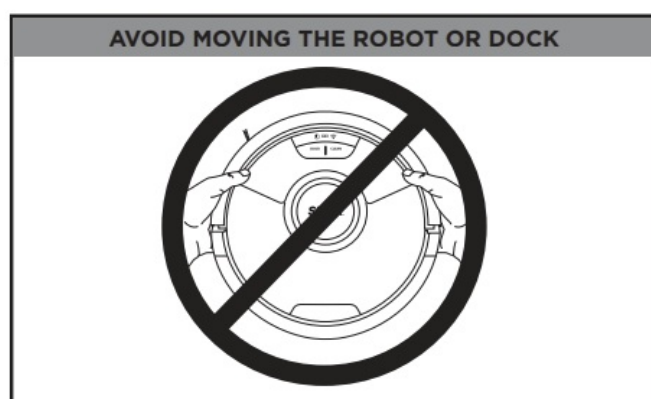

- While your robot is cleaning, do not pick it up and move it, or move the charging dock—this will impact the robot's ability to map your home.
- During the first few weeks of use, the dust bin will need to be emptied more frequently, as the robot cleans

areas that were previously hard to reach. Empty debris and dust into trash. Remove any debris between the filter and the plastic shield.

SETUP

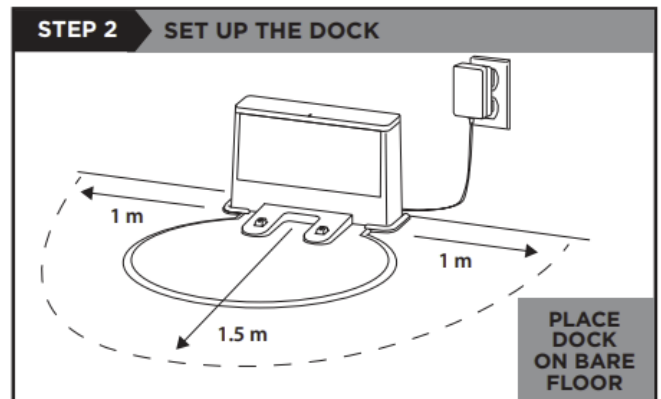
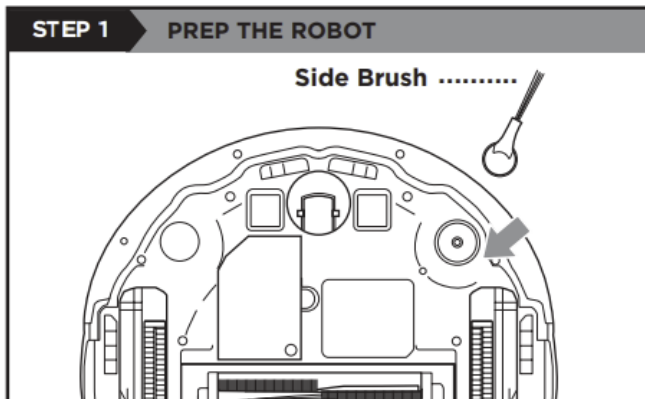

- Remove protective film from robot and dock.
- Attach side brush.
- Find a permanent location for the dock in a spot with a strong Wi-Fi signal.
- Place the dock on bare floor, away from rugs or carpets, with its back against the wall.
- Attach the landing mat to the bottom of the dock.
- Plug in the dock. The indicator light will illuminate green when the dock has power.

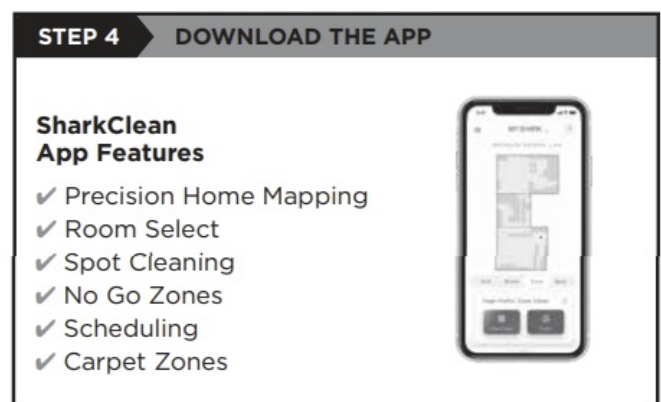
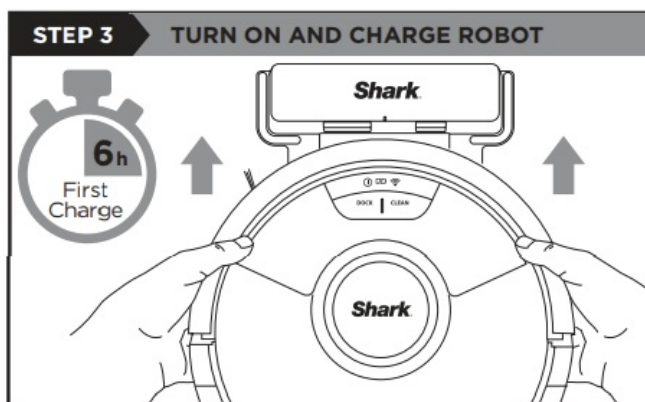

- To turn on the robot, press the DOCK button for 5 to 7 seconds until the lights illuminate on the robot.
- To charge, place the robot on the dock's charging contacts. It may take up to 6 hours to charge completely.
- Search "SharkClean" in the app store or scan the QR code on the front cover to download the app.

Questions? Steps if You're Stuck:

- Having trouble connecting to your robot?
- For how-to videos, FAQs, troubleshooting, and tips & tricks visit: sharkclean.eu.
- For full instruction booklet visit: qr.sharkclean.com/<https://qr.sharkclean.com/RV2620EU> or

SCAN HERE USING YOUR SMARTPHONE CAMERA



- To use the app, your phone must be connected to a 2.4 GHz network. The app will not work on a 5 GHz network.
- DO NOT use a VPN or a proxy server.
- Make sure Wi-Fi isolation is turned off on the router.



Restart your phone

- Turn off phone, wait a few minutes, then turn it back on and connect to Wi-Fi.

Reboot your robot

- Take robot off dock and press and hold down the CLEAN button on the robot for 12 seconds. Turn your robot back on by placing it on the dock.

Reboot your router

- Unplug the router power cable for 30 seconds, then plug it back in. Allow several minutes for your router to reboot completely.

BEFORE YOU CLEAN

- Your robot will need to complete an Explore Run without the mopping Module attached to create a map of your home.
- In the Explore Run, your robot will wander around your home as it creates a map.
- After this run, you can create Carpet Zones in the areas of your home that you want the robot to avoid while mopping. If you do not want to set up Carpet Zones, or do not have carpets or rugs in your home, you can skip this step.
- Now you're ready to clean.

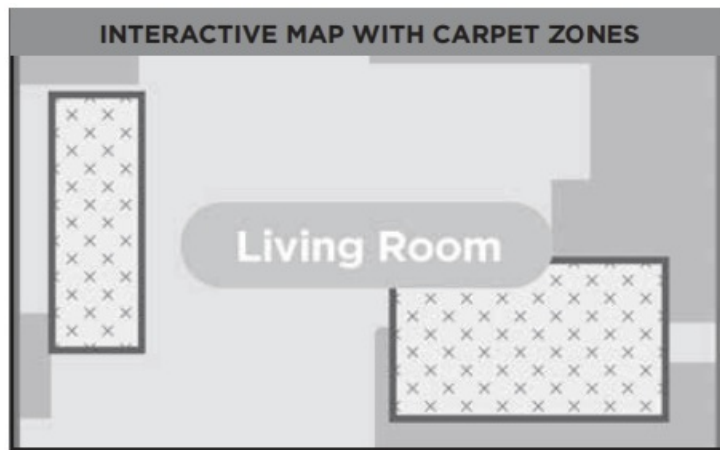

HOW TO SET UP MOPPING MODE

- Attach the fluid mopping Module to your robot to enter Mopping Mode. In this mode, your robot will vacuum and mop simultaneously.

ATTACH MOPPING PAD

- Insert the flat edge of the pad through the slot in the mopping Module.
- Secure to the back of the mopping Module.

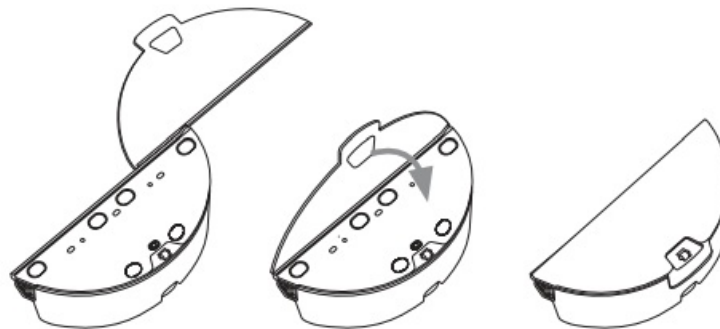

FILL MOPPING MODULE

- Fill with water to the water line.

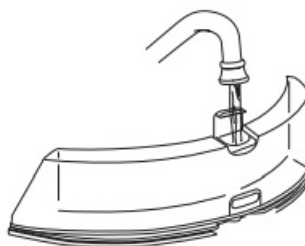

INSERT MOPPING MODULE INTO ROBOT

- Firmly push the mopping Module into the back of the robot. (Do not remove the dust bin.)
- When properly inserted, the mopping Module will click securely into place.

- Your robot is ready to simultaneously vacuum and mop your hard floors.

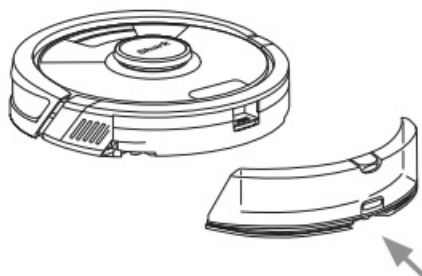

REMOVE MOP ACCESSORIES AFTER USE

- Press the release button at the fill port and slide out the mopping Module.
- Pour out the water.
- Remove the pad and follow the care instructions on the back of the pad.

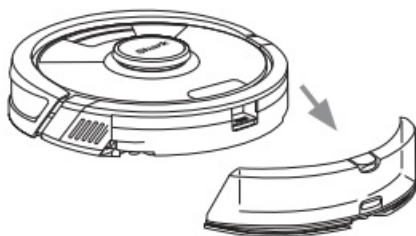

TWO (2) YEAR LIMITED GUARANTEE RV2620WDEU

- When a consumer buys a product in Europe, they get the benefit of legal rights relating to the quality of the product (your “statutory rights”).
- You can enforce these rights against your retailer. However, at Shark® we are so confident about the quality of our products that we give the product owner an additional manufacturer’s guarantee of two years. These terms and conditions relate to our manufacturer’s guarantee only – your statutory rights are unaffected.
- The conditions below describe the prerequisites and scope of our guarantee. They do not affect your statutory rights or the obligations of your retailer and your contract with them.

Shark® Guarantees

- A household appliance like a Robot Vacuum constitutes a sizeable investment. Your new machine needs to work properly for as long as possible. The guarantee it comes with is an important consideration, and reflects how much confidence the manufacturer has in its product and manufacturing quality.
- Every Shark® machine comes with a free parts and labour guarantee. Our customer service helpline (0800 862 0453) is open from 9.00am to 6.00pm Monday – Friday. It’s free to call, and you’ll be put straight through to a Shark® representative. You’ll also find online support at www.sharkclean.eu.
- How do I register my extended Shark® guarantee?
- You can register your guarantee online within 28 days of purchase. To save time, you’ll need the following information about your machine:
 - Date you purchased the machine (receipt or delivery note).
- To register online, please visit www.Sharkclean.eu/uk/register-guarantee. Products purchased directly from

Shark® are automatically registered.

- What is covered by the free Shark® guarantee?
- Repair or replacement (at Shark's discretion) of your Shark® machine, including all parts and labour. A Shark® guarantee is in addition to your legal rights as a consumer.
- What are the benefits of registering my free Shark® guarantee?
- When you register your guarantee we'll have your details to hand if we ever need to get in touch. If you further agree to receive communications from us, you can also receive tips and advice on how to get the best out of your Shark® Robot Vacuum and hear the latest news about new Shark® technology and launches.
- If you register your guarantee online, you'll get instant confirmation that we've received your details.
- How long are new Shark® machines guaranteed for?
- Our confidence in our design and quality control means that your new Shark® Robot Vacuum is guaranteed for two years.
- Where can I buy genuine Shark® spares and accessories?
- Shark® spares and accessories are developed by the same engineers who developed your Shark® Robot Vacuum. You'll find a full range of Shark® spares, replacement parts and accessories for all Shark® machines at www.sharkclean.eu.
- Please remember that damage caused by use of non-Shark® spares is not covered under your guarantee.
- What is not covered by the free Shark® guarantee?
 1. Normal wear and tear of wearable parts, which require regular maintenance and/or replacement to ensure the proper functioning of your unit, are not covered by this guarantee. Replacement parts are available for purchase at sharkclean.eu.
 2. Any unit that has been tampered with or used for commercial purposes.
 3. Accidental damage and faults caused by negligent use or care, misuse, neglect, careless operation or handling of the Robot Vacuum which is not in accordance with this Shark® Instruction booklet supplied with your machine.
 4. Use of parts not assembled or installed in accordance with these instructions.
 5. Faulty installation (except where installed by Shark®).
 6. Repairs or alterations carried out by parties other than Shark® or its agents.

PLEASE READ CAREFULLY AND KEEP FOR FUTURE REFERENCE.

These instructions are designed to help you keep your Shark AI Robot running at peak performance.

- SharkNinja Europe Limited, 3150 Century Way, Thorpe Park, Leeds, LS15 8ZB
- SharkNinja Germany GmbH, Rotfeder-Ring 9, 60327 Frankfurt am Main, Germany
- sharkclean.eu

Illustrations may differ from actual product. We are constantly striving to improve our products; therefore the specifications contained herein are subject to change without notice.

- Illustrations may differ from actual product
- We are constantly striving to improve our products; therefore the specifications contained here in are subject to change without notice.
- © 2024 SharkNinja Operating LLC. SHARK is a registered trademark in the European Union of SharkNinja

Operating LLC.

- Apple App Store is a trademark of Apple Inc.
- Google, Android and Google Play are trademarks of Google LLC.

sharkclean.eu

- © 2024 SharkNinja Operating LLC. RV2620WDEU_Series_QSG_240315_Mv2

FAQs

Q: How do I connect the vacuum cleaner to Wi-Fi?

A: To connect to Wi-Fi, follow the instructions in the SharkClean App after downloading it. Make sure your Wi-Fi network is compatible with the device.

Q: What should I do if the vacuum cleaner or charging station is moved?

A: Avoid moving the vacuum cleaner or charging station to ensure proper functioning. If moved, recalibrate the device as per the user manual instructions.

Documents / Resources

	<p>Shark RV2620WDEU Matrix Robot 2 In 1 Robotic Vacuum Cleaner [pdf] Instructions RV2620WDEU Matrix Robot 2 In 1 Robotic Vacuum Cleaner, RV2620WDEU, Matrix Robot 2 In 1 Robotic Vacuum Cleaner, Robotic Vacuum Cleaner, Vacuum Cleaner</p>
--	---

References

- [Processing QR Code](#)
- [Processing QR Code](#)
- [Processing QR Code](#)
- [User Manual](#)

[Manuals+](#), [Privacy Policy](#)

This website is an independent publication and is neither affiliated with nor endorsed by any of the trademark owners. The "Bluetooth®" word mark and logos are registered trademarks owned by Bluetooth SIG, Inc. The "Wi-Fi®" word mark and logos are registered trademarks owned by the Wi-Fi Alliance. Any use of these marks on this website does not imply any affiliation with or endorsement.