

Shark RV2600WD Series AI Ultra Robot User Guide

[Home](#) » [Shark](#) » Shark RV2600WD Series AI Ultra Robot User Guide 

Contents

- [1 Shark RV2600WD Series AI Ultra Robot](#)
- [2 GETTING THE MOST OUT OF YOUR ROBOT](#)
- [3 SETUP](#)
- [4 BEFORE YOU CLEAN](#)
- [5 HOW TO SET UP MOPPING MODE](#)
- [6 Documents / Resources](#)
 - [6.1 References](#)
- [7 Related Posts](#)

Shark[®]

Shark RV2600WD Series AI Ultra Robot



Please be sure to read the enclosed Shark® Owner's Guide prior to using your robot.

GETTING THE MOST OUT OF YOUR ROBOT

To get the best experience, download the SharkClean® app and follow the tips below.

PREP YOUR HOME

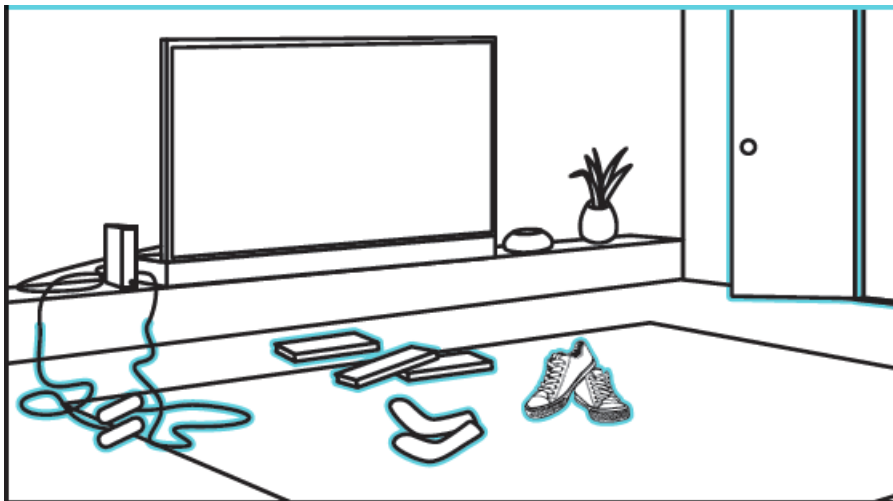

- Before each clean, clear cords and remove small objects like clothing or toys that are less than 3.5" tall.
- Open interior doors in rooms you want your robot to clean.

SCHEDULING AND INTERACTIVE

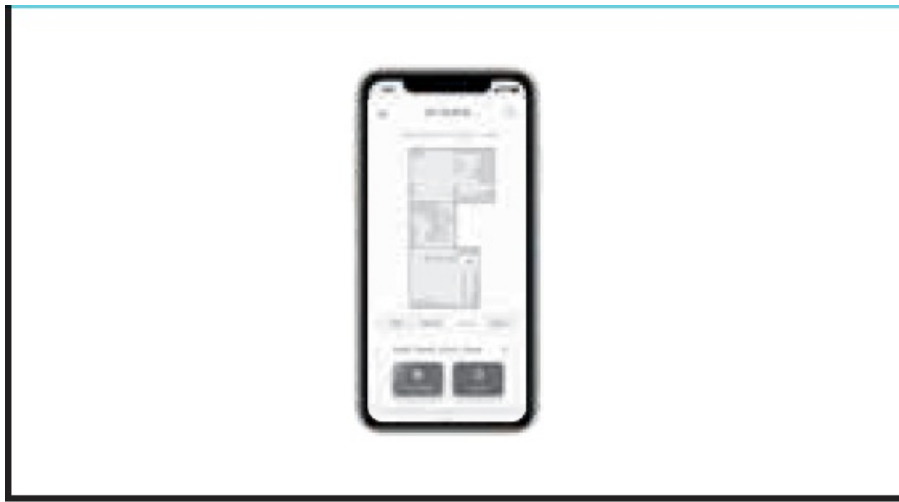

- For a constant state of clean, set up a whole-home cleaning schedule in the app.
- Use the interactive home map for an even more customizable clean

CARPET AVOIDANCE

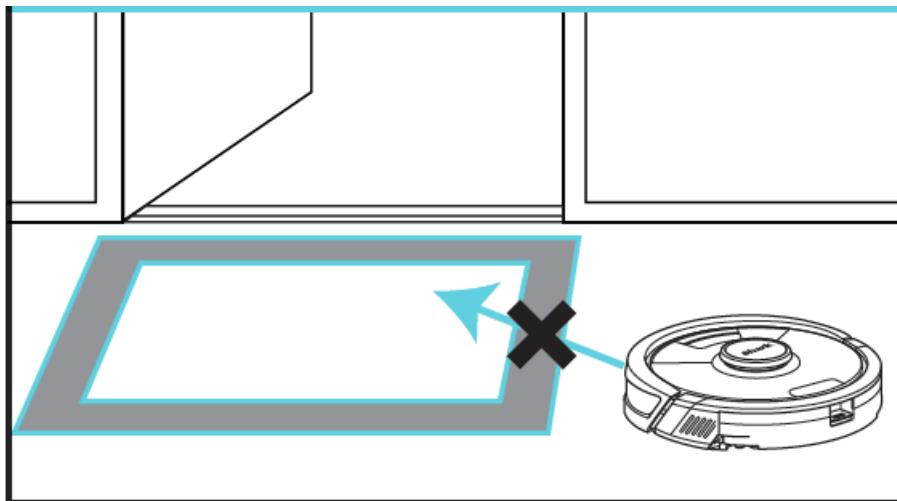

When your home map is set up, you can use the app to identify carpets and rugs so the robot can avoid them when it mops. If rugs are blocking your robot's path to another room in mopping mode, you may need to move them

NO-GO ZONES

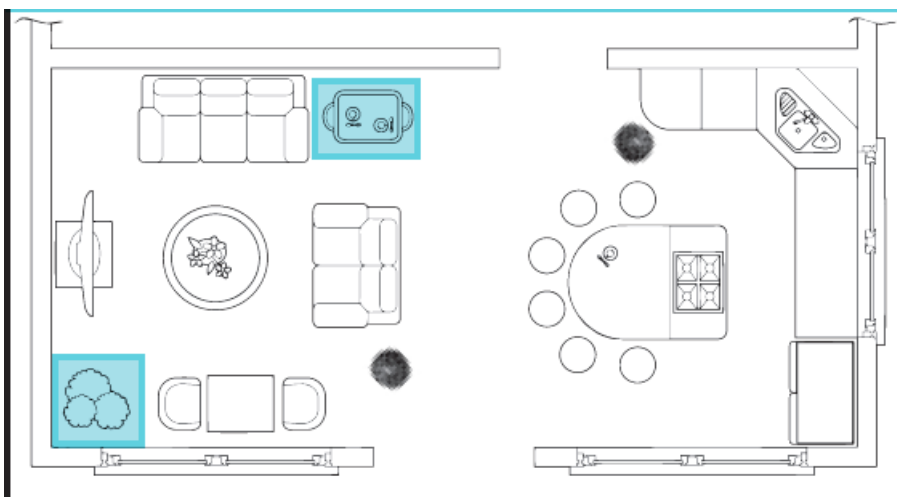

Create no-go zones in the app to keep your robot out of the areas you would like it to avoid:

- Near power cords or phone chargers.
- In front of high thresholds

AVOID MOVING THE ROBOT OR DOCK

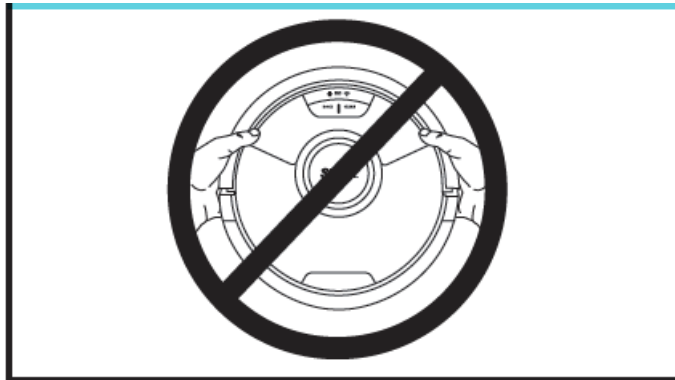

While your robot is cleaning, do not pick it up and move it, or move the charging dock—this will impact the robot's ability to map your home.

EMPTYING THE DUST BIN

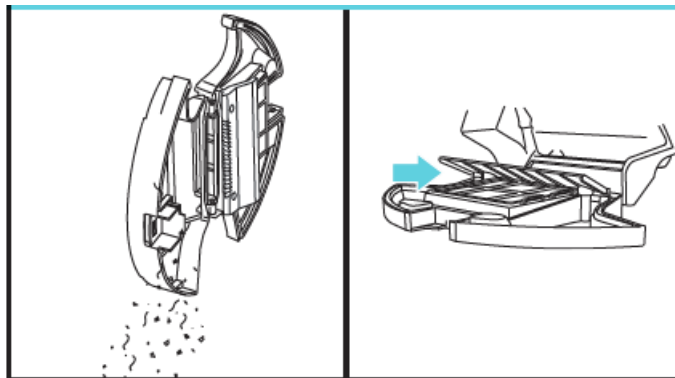

During the first few weeks of use, the dust bin will need to be emptied more frequently, as the robot cleans areas that were previously hard to reach.
Empty debris and dust into trash. Remove any debris between the filter and the plastic shield.

SETUP

• STEP 1 PREP THE ROBOT

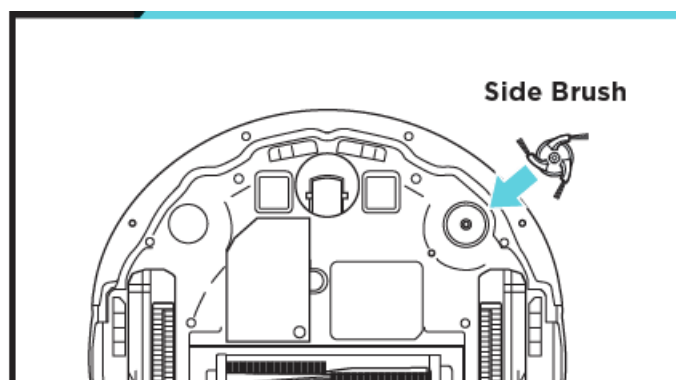

- Remove protective film from robot and dock.
- Attach side brush.

Note: Side brush may vary.

• STEP 2 SET UP THE DOCK

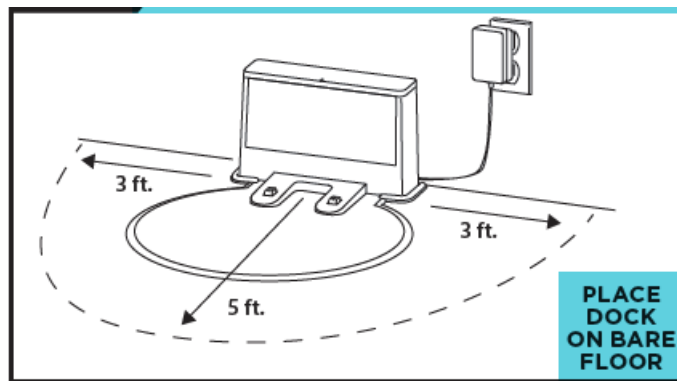

- Find a permanent location for the dock in a spot with a strong Wi-Fi signal.
- Place the dock on bare floor, away from rugs or carpets, with its back against the wall.
- Attach the landing mat to the bottom of the dock.
- Plug in the dock. The indicator light will illuminate green when the dock has power.

• STEP 3 TURN ON AND CHARGE ROBOT

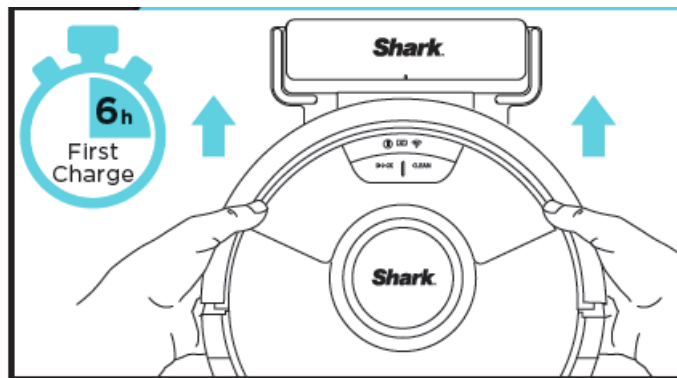

- To turn on the robot, press the DOCK button for 5 to 7 seconds until the lights illuminate on the robot.
- To charge, place the robot on the dock's charging contacts. It may take up to 6 hours to charge completely.

• STEP 4 DOWNLOAD THE APP

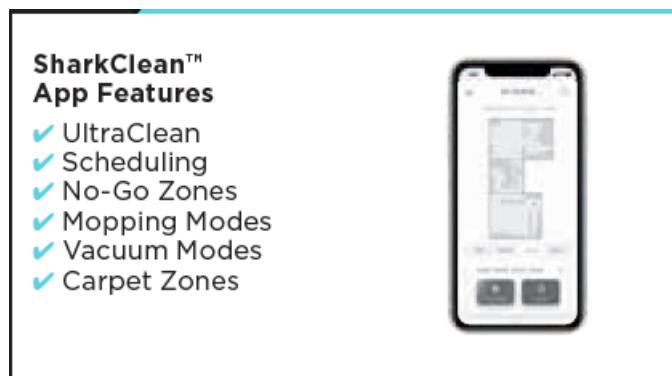

- Search "SharkClean" in the app store or scan the QR code on the front cover to download the app.

CAN'T CONNECT TO WI-FI?

• Restart your phone

- Turn off phone, wait a few minutes, then turn it back on and connect to Wi-Fi.

• Reboot your robot

- Take robot off dock and press and hold down the CLEAN button on the robot for 12 seconds. Turn your robot back on by placing it on the dock.

• Reboot your router

- Unplug the router power cable for 30 seconds, then plug it back in. Allow several minutes for your router to restart.

to reboot completely.

Two Easy Steps If You're Stuck:

1. Having trouble connecting to your robot? Call 1-888-228-5531 for robot support.
2. For additional help, visit: sharkclean.com/support
 1. Owner's Guide
 2. Troubleshooting
 3. How-to Videos
 4. FAQs
 5. Tips & Tricks

Smart Home Setup

To set up voice control using Google Home or Amazon Alexa, visit sharkclean.com/app for instructions

To use the app, your phone must be connected to a 2.4 GHz network. The app will not work on a 5 GHz network.

- DO NOT use a VPN or a proxy server.
- Make sure Wi-Fi isolation is turned off on the router.

BEFORE YOU CLEAN

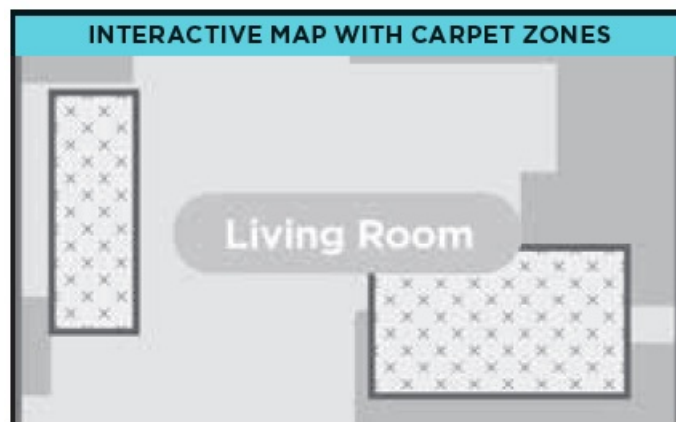

- Your robot will need to complete an Explore Run without the fluid reservoir attached to create a map of your home.
- During the Explore Run, your robot will roam around your home as it creates a map.
- After this run, you can create Carpet Zones in the app to keep the robot away from carpets and rugs while mopping. If you do not want to set up Carpet Zones, or do not have carpets or rugs in your home, you can skip this step.
- Now you're ready to clean

HOW TO SET UP MOPPING MODE

To put your robot in mopping mode, fill the fluid reservoir, attach the pad, and install the reservoir into the back of the robot. In this mode, your robot will vacuum and mop simultaneously

ATTACH MOPPING PAD

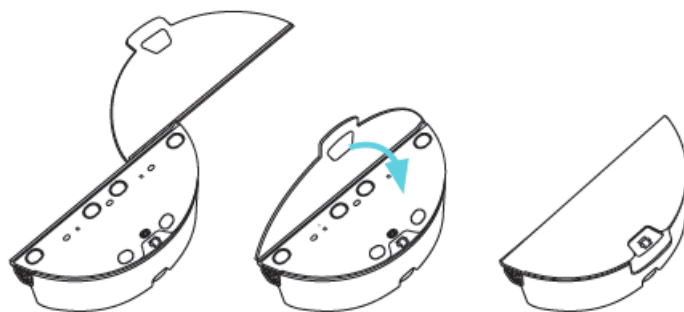

- Insert the flat edge of the pad through the slot in the fluid reservoir.
- Secure the pad to the back of the reservoir

ADD WATER AND FLOOR CLEANER TO RESERVOIR

Add water through the fill port to the water line, then add cleaning solution up to the line marked VACMOP™ Floor Cleaner

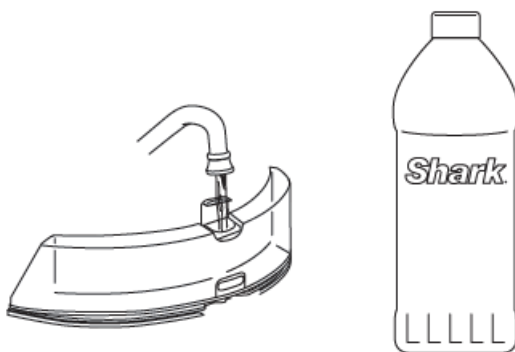

FOR BEST RESULTS, USE SHARK VACMOP™ FLOOR CLEANER.

INSERT FLUID RESERVOIR INTO ROBOT

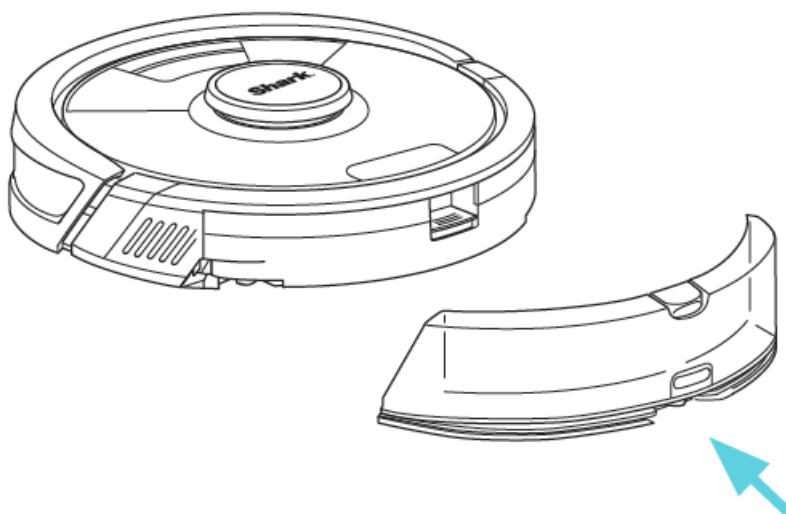

- Firmly push the fluid reservoir into the back of the robot. (Do not remove the dust bin.)
- When properly inserted, the fluid reservoir will click securely into place.
- Your robot is ready to simultaneously vacuum and mop your hard floors.

REMOVE MOP ACCESSORIES AFTER USE

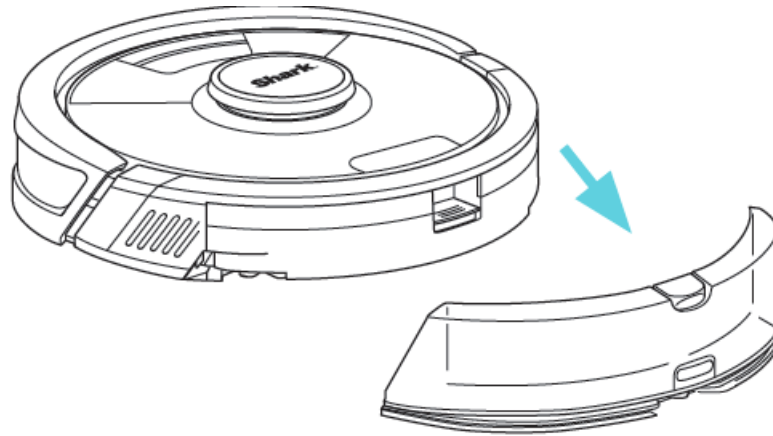

- Press the release button at the fill port and slide out the fluid reservoir.
- Pour all remaining liquid out of the reservoir.
- Remove the pad and follow the care instructions on the back of the pad.

Scan QR code with your phone's camera to quickly find and download the app



© 2022 SharkNinja Operating LLC. SHARK and SHARKCLEAN are registered trademarks of SharkNinja Operating LLC. VACMOP is a trademark of SharkNinja Operating LLC. APPLE, the Apple logo, and iPhone are trademarks of Apple Inc., registered in the U.S. and other countries. APP STORE is a service mark of Apple Inc., registered in the U.S. and other countries. GOOGLE, GOOGLE ASSISTANT, GOOGLE PLAY, the Google Play logo, and Android are trademarks of GOOGLE LLC.

Documents / Resources

	<p>Shark RV2600WD Series AI Ultra Robot [pdf] User Guide RV2600WD Series AI Ultra Robot, RV2600WD Series, AI Ultra Robot, Ultra Robot, Robot</p>
---	--

References

- [S Robot Vacuum Cleaner | Automatic Vacuum | Shark® Robotic Vacuum](#)