



Shark RV2000WDBRN Series Robot Floor Cleaner User Guide

[Home](#) » [Shark](#) » Shark RV2000WDBRN Series Robot Floor Cleaner User Guide 

Contents

- [1 Shark RV2000WDBRN Series Robot Floor Cleaner](#)
- [2 DOWNLOAD THE SHARKCLEAN APP](#)
- [3 SETUP](#)
- [4 BEFORE YOU CLEAN](#)
- [5 HOW TO SET UP VACMOP™ MODE](#)
- [6 GETTING THE MOST OUT OF YOUR ROBOT](#)
- [7 Documents / Resources](#)
 - [7.1 References](#)
- [8 Related Posts](#)

Shark

Shark RV2000WDBRN Series Robot Floor Cleaner



DOWNLOAD THE SHARKCLEAN APP



Scan QR code with your phone's camera to quickly find and download the app

SETUP

- Before cleaning, clear cords and remove small objects like clothing or toys that are less than 2.8" tall.
- Open interior doors in rooms you want your robot to clean.



- Remove the protective film from the robot and dock.
- Snap the 2 color-coded side brushes onto the matching colored pegs on the bottom of the robot.
- Power on your robot using the side switch.

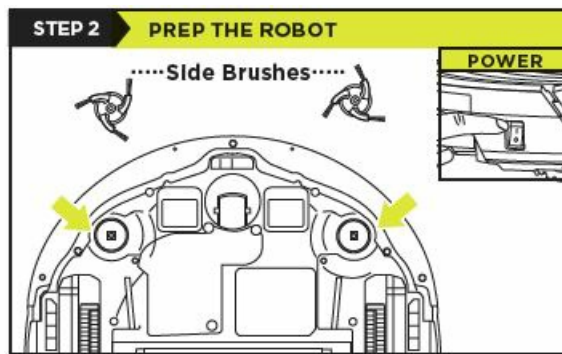

- Find a permanent location for the dock in a spot with a strong Wi-Fi signal.
- Place the dock on bare floor, away from rugs or carpets, with its back against the wall.
- Attach the landing mat to the bottom of the dock.
- Plug in the dock. The indicator light will illuminate green when the dock has power.

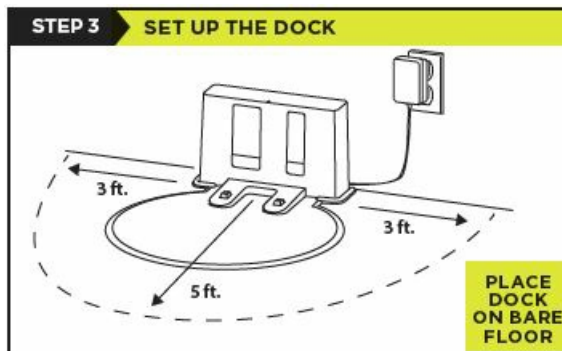

- Place the robot on the dock to charge. The dock indicator light will turn blue and the robot will beep when charging begins.

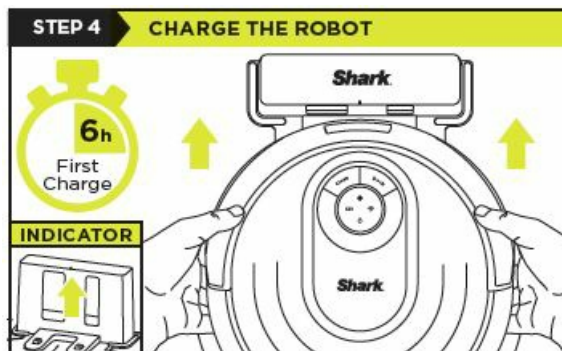

- Search “SharkClean” in the app store or scan the QR code on the front cover to download the app.
 - To use the app, your phone must be connected to a 2.4 GHz network. The app will not work on a 5 GHz network.
 - DO NOT use a VPN or a proxy server.
 - Make sure Wi-Fi isolation is turned off on the router.



BEFORE YOU CLEAN

Your robot will need to complete an Explore Run without the fluid reservoir attached to create a map of your home. In the Explore Run, your robot will wander around your home as it creates a map. After this run, you have the option to create Carpet Zones in the areas of your home that you want the robot to avoid while mopping. If you do not want to set up Carpet Zones or do not have carpets or rugs in your home, you can skip this step.

Now you're ready to clean.

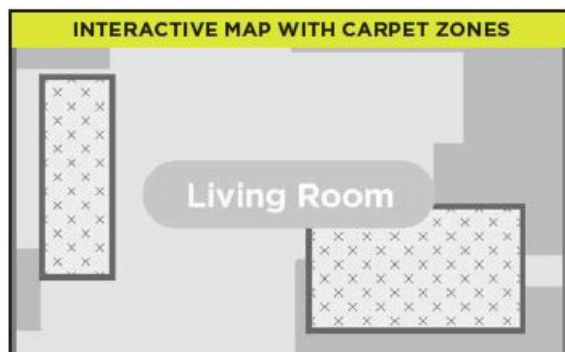

HOW TO SET UP VACMOP™ MODE

Attach the fluid reservoir to your robot to enter VACMOP Mode. In this mode, your robot will vacuum and mop simultaneously.

ATTACH MOPPING PAD

- Insert the flat edge of the pad through the slot in the fluid reservoir.
- Secure to the back of the reservoir.

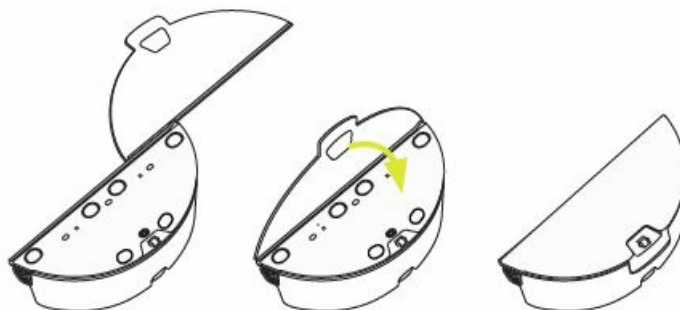

FILL FLUID RESERVOIR

Fill with VACMOP starter cleaning solution or with room temperature water, up to the MAX fill line.

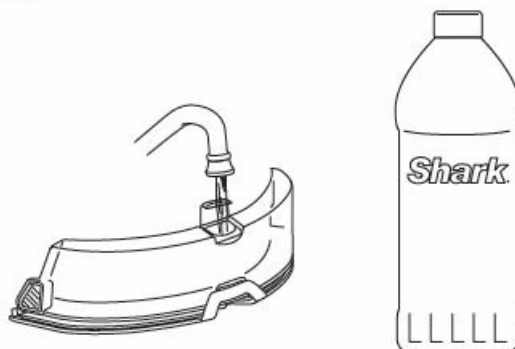

**FOR BEST RESULTS, USE
SHARK® VACMOP FLOOR CLEANER.**

INSERT RESERVOIR INTO ROBOT

- Firmly push the reservoir into the back of the robot. (Do not remove the dust bin.)
- BOTH sides of the reservoir should CLICK when it slides into place completely.
- The water droplet icon () will illuminate when reservoir is properly inserted.
- Your robot is ready to simultaneously vacuum and mop your hard floors.

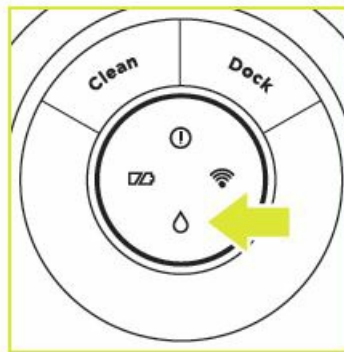
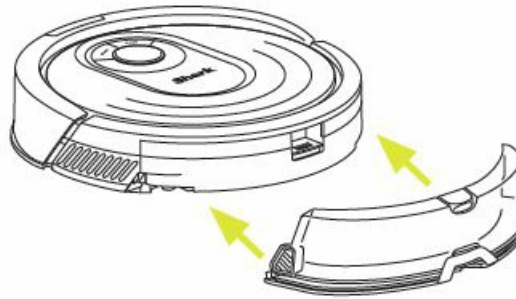

REMOVE MOP ACCESSORIES AFTER USE

- Slide out the fluid reservoir.
- Pour out the cleaning solution or water.
- Remove the pad and follow the care instructions on the back of the pad.

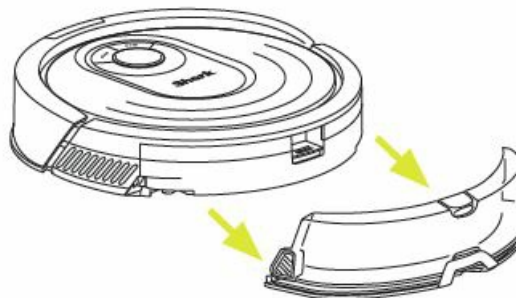

GETTING THE MOST OUT OF YOUR ROBOT

To get the best experience, download the SharkClean app and follow the tips below.

- After completing the Explore Run, the robot will create an interactive map in the app, where you can create rooms and set up no-go zones.



- For a constant state of clean, set up a whole-home cleaning schedule in the app.



- Once the robot has mapped your home, you can use the app to identify carpets and rugs on the map so the robot can avoid them when it mops. If there are rugs blocking your robot's path to another room, you may need to move them.

Note: BotBoundary® strips can be used to physically block off areas and are available for purchase at sharkaccessories.com.

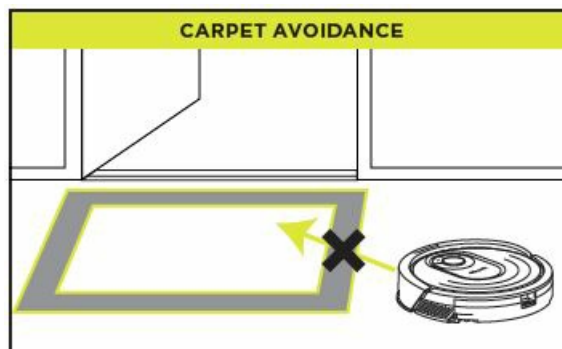

- Create no-go zones in the app to keep your robot out of the areas you would like it to avoid:
 - Near power cords or phone chargers.
 - In front of high thresholds.



- While your robot is cleaning, do not pick it up and move it, or move the charging dock—this will impact the robot's ability to map your home.

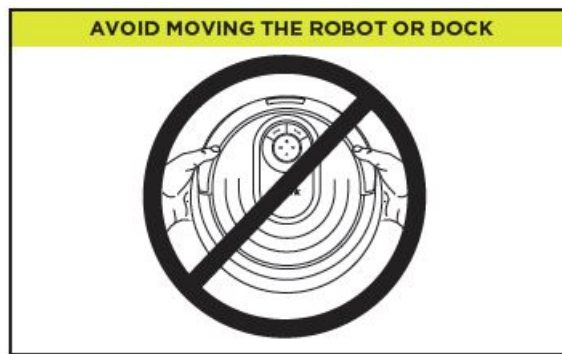

- During the first few weeks of use, the dust bin will need to be emptied more frequently, as the robot cleans areas that were previously hard to reach. Empty debris and dust into trash. Remove any debris between the filter and the plastic shield.

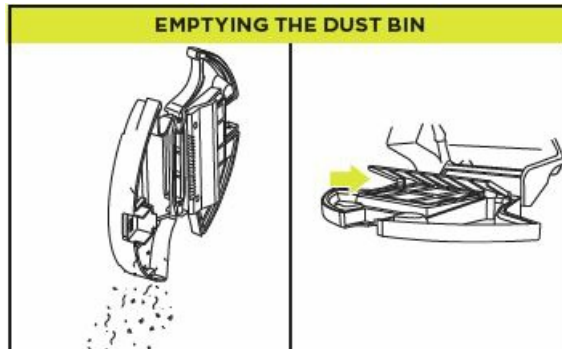

CAN'T CONNECT?

Restart your phone

Reboot your robot

- Press the power button on the side of the ROBOT to the OFF position. Wait 10 seconds, then press it to the (I) ON position.

Reboot your router

- Unplug the router power cable for 30 seconds, then plug it back in. Allow several minutes for your router to reboot completely.

Two Easy Steps If You're Stuck:

1. Having trouble connecting to your robot? Call 1-855-460-5425 for robot support.
2. For additional help, visit sharkclean.com/support.
 - How-to Videos
 - FAQs
 - Troubleshooting
 - Tips & Tricks

Smart Home Setup

To set up voice control using Google Home or Amazon Alexa, visit sharkclean.com/app for instructions.

© 2021 SharkNinja Operating LLC. BOTBOUNDARY, SHARK, and SHARKCLEAN are registered trademarks of SharkNinja Operating LLC. VACMOP is a trademark of SharkNinja Operating LLC. APPLE, the Apple logo, and iPhone are trademarks of Apple Inc., registered in the U.S. and other countries. APP STORE is a service mark of Apple Inc., registered in the U.S. and other countries. GOOGLE, GOOGLE ASSISTANT, GOOGLE PLAY, the Google Play logo, and Android are trademarks of GOOGLE LLC.

Documents / Resources

| | |
|---|--|
|  | Shark RV2000WDBRN Series Robot Floor Cleaner [pdf] User Guide RV2000WDBRN Series Robot Floor Cleaner, RV2000WDBRN Series, Robot Floor Cleaner, Flo or Cleaner, Cleaner |
|---|--|

References

- [🌐 Find Sharkclean Parts & Accessories | Sharkclean](#)
- [🇸 Vacuum Cleaners, Steam Mops, Hair Care & Air Purifiers | Shark Home Cleaning](#)
- [🇸 Robot Vacuum Cleaner | Automatic Vacuum | Shark® Robotic Vacuum](#)