

SHAREVISION  
RC22 Carplay  
Wireless Adapter



# SHAREVISION RC22 Carplay Wireless Adapter User Manual

[Home](#) » [SHAREVISION](#) » SHAREVISION RC22 Carplay Wireless Adapter User Manual 

## Contents

- [1 SHAREVISION RC22 Carplay Wireless Adapter](#)
- [2 Product Information](#)
- [3 Product Usage Instructions](#)
- [4 Frequently Asked Questions](#)
- [5 For Carplay Wireless Adapter](#)
- [6 Product Accessories](#)
- [7 Product operation instructions](#)
- [8 Frequently Asked Questions](#)
- [9 For Android Auto Wireless Adapter](#)
- [10 Product Accessories](#)
- [11 Frequently Asked Questions](#)
- [12 FCC](#)
- [13 Documents / Resources](#)
  - [13.1 References](#)
- [14 Related Posts](#)

# SHAREVISION

**SHAREVISION RC22 Carplay Wireless Adapter**



## Product Information

### Specifications:

- Dimensions: 55x77mm
- Compatibility: iPhone 6 and above, iOS 10 and above
- Functionality: Converts wired Carplay to wireless Carplay

## Product Usage Instructions

### Product Operation Instructions:

1. Connect the product with the multimedia data port of the car using the provided data cable.
2. Turn on your iPhone's Wi-Fi, Bluetooth, and Carplay function.
3. Enable Bluetooth on your iPhone and search for the Bluetooth display name "smartbox – \*\*\*", click on it to pair and connect successfully.
4. After successful pairing, you can start using wireless Carplay for a more enjoyable driving experience.
5. Once the adapter is connected to the in-vehicle device for the first time, it will automatically reconnect in the future.

### Product Update System:

1. Turn on Wi-Fi on your iPhone and connect to the corresponding display name using password 88888888.
2. Enter IP address 192.168.1.101 in Safari browser, click on "meto upgrade" and wait for the upgrade process to complete.
3. After the upgrade, unplug and plug the adapter again, ignore previous Bluetooth connections, and reconnect for use.

### Notes:

1. Ensure your iPhone model is iPhone 6 or above with iOS 10 or above.
2. Make sure your car has the factory wired Carplay; check compatibility on Apple's website.
3. The product supports both Carplay and Auto functions based on multimedia system settings.

## Frequently Asked Questions

### Frequently Asked Questions:

1. **Q: Why doesn't the indicator light of the product turn off automatically when the car is turned off?**

A: This product does not have a battery; the indicator light behavior is determined by the car's Multimedia USB data port.

2. **Q: Why can't I always connect?**

A: Make sure to turn on Wi-Fi, Bluetooth, and Carplay switches simultaneously for successful connections.

## For Carplay Wireless Adapter

Thank you for purchasing our product. For optimal performance and safety, please read these instructions carefully before operating your product.

### Summary

The wireless carplay adapter converts wired carplay to wireless carplay, realizing the interconnection between iPhone and car. You can easily enjoy music, navigation and other functions wirelessly, plug and play, and keep the original car operation. This interconnection provides drivers with more driving pleasure and reduces the frequency of iPhone use.

We are committed to providing our customers with a safer driving experience.

## Product Accessories

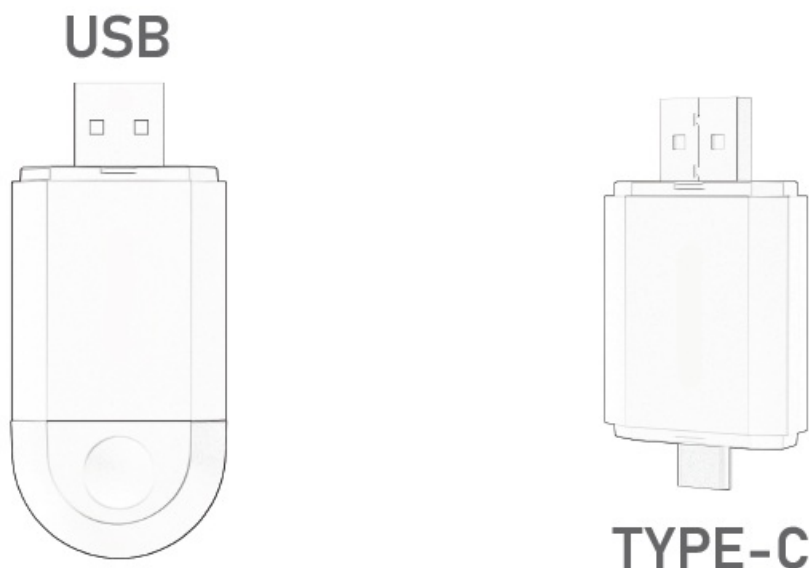

(Pictures are for reference only, subject to the real thing)

## Product operation instructions

- Connect the product with the multimedia data port of the car with the data cable respectively.

- Turn on the iPhone WIFI, Bluetooth, Carplay function.
- Turn on the iPhone Bluetooth search page, search for Bluetooth display name "smartbox – \*\*\*\*", click on the pairing and connect successfully.

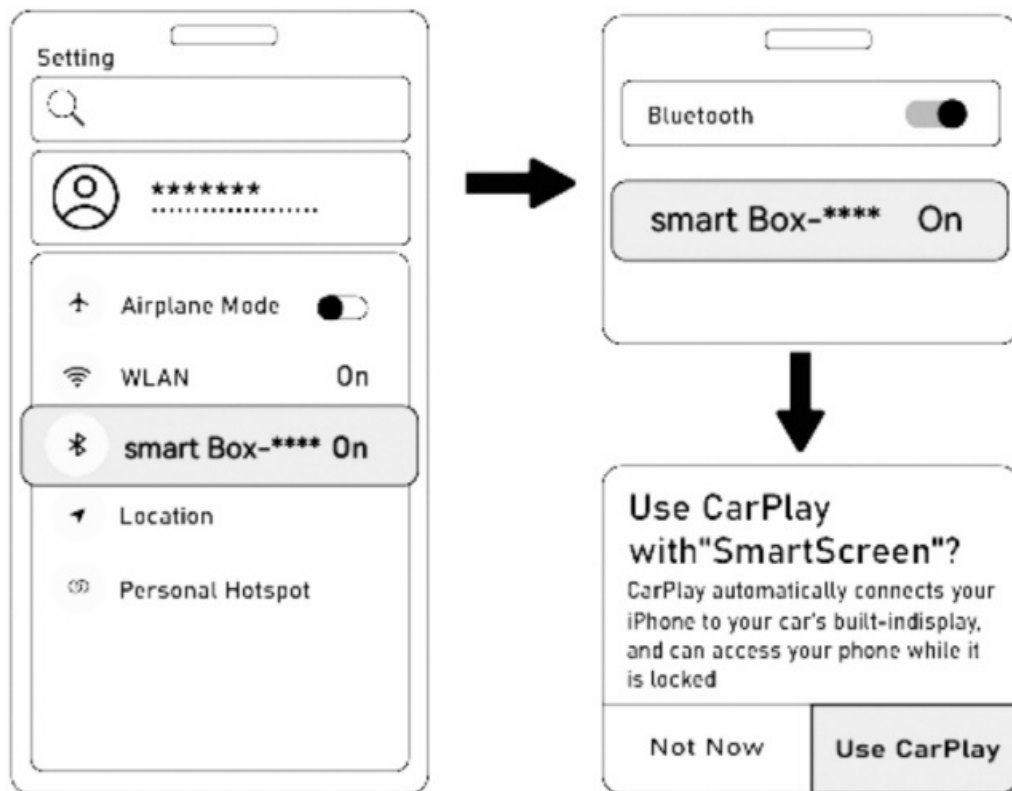

(Pictures are for reference only, subject to the real thing)

- After successful pairing, you will be able to use the driving pleasure brought by wireless Carplay.

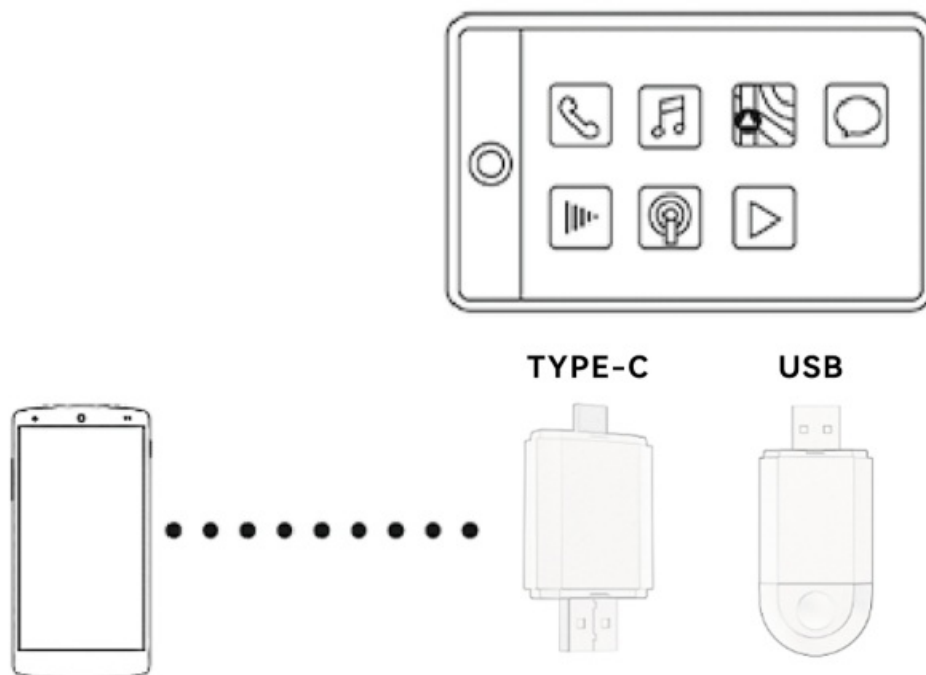

(Pictures are for reference only, subject to the real thing)

- After the wireless carplay adapter connected to the in-vehicle device for the first time, it will be connected

automatically the next time.

## Product Update System

- Turn on the Wi-Fi on your iPhone, find the corresponding display name, enter the password “88888888”, then click “Connect”.
- Enter the IP address 192.168.1.101 in Safari browser, then click “meta upgrade”; wait a few minutes for the upgrade.
- After the upgrade is completed, plug and unplug the box again, ignore the previous Bluetooth, and reconnect the Bluetooth for use.

## Notes

- iPhone model and version requirements: iPhone6 and above, iOS 10 and above.
- Make sure your car with the factory wired CarPlay, more than 800 models to choose from, specific model query, <https://www.apple.com/ios/carplay/available-models/>
- Multimedia with CarPlay and Auto function, while the product also supports CarPlay and Auto function, when connecting to the CarPlay function, the multimedia needs to be switched to the CarPlay mode and connected using an Apple phone; when connecting to the Auto function, the multimedia needs to be switched to the AndroidAuto mode and connected using an Android phone.

## Frequently Asked Questions

- **Why doesn't the indicator light of the product turn off automatically when the car is turned off?**

A: This product does not have a battery, the exact time the lights go out is determined by the Multimedia USB data port, the lights out time is different for each car.

- **Why can't I always connect?**

A:

- Turn on the WIFI, Bluetooth and Carplay switches at the same time.
- The car multimedia must support wired Carplay function;
- Whether the product indicator light is on;
- Whether the product is connected to the multimedia data interface.

- **Can the product be paired with more than one iPhone?**

A: Yes, if you want to change the iPhone, you need to turn off the Bluetooth and WIFI function switch of the used iPhone.

- **Can't it reconnect automatically?**

A: The product can only connect to the last paired device, and you can't turn off the WIFI and Bluetooth switch.

- **No sound when you call?**

A: You can select the sound output mode as Carplay mode in the iPhone call page, some cars need to set it manually.

- **Sound delay, navigation delay?**

A: Playing music and navigation use iPhone traffic, if the iPhone signal is not stable, the above problems will occur.

- **Why is the connection suddenly disconnected?**

A: The product data line has a limiting function, the disconnection is caused by the loosening of the car data port and the data line.

- **Why can't Carplay start or the device is incompatible/unrecognized USB?**

A:

- Re-unplug the device and restart the multimedia.
- Replace the data cable.

## **For Android Auto Wireless Adapter**

Thank you for purchasing our product. For optimal performance and safety, please read these instructions carefully before operating your product.

### **Summary**

Wireless Smart Car Adapter converts wired Android Auto to wireless Android Auto realizing the interconnection between phones and car. You can easily enjoy music, navigation and other functions wirelessly, plug and play, and keep the original car operation. This interconnection provides drivers with more driving pleasure and reduces the frequency of phones use. We are committed to providing our customers with a safer driving experience.

### **Product Accessories**

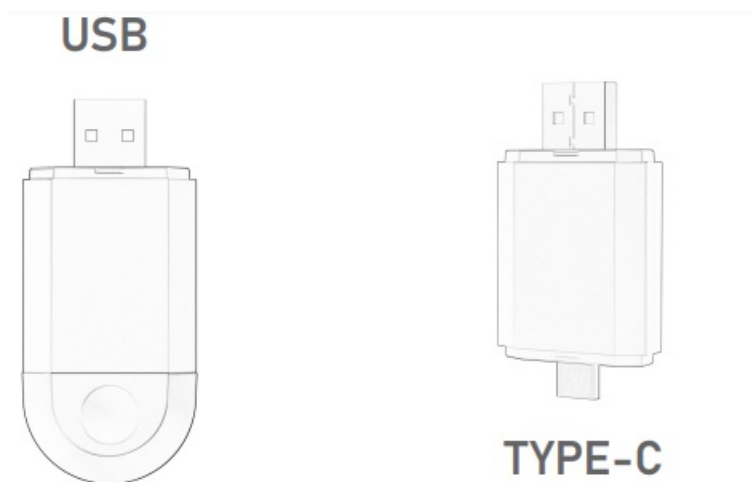

(Pictures are for reference only, subject to the real thing)

### **Product operation instructions**

- Connect the product with the multimedia data port of the car with the data cable respectively.
- Open the cell phone WIFI, Bluetooth function switch.
- Open the cell phone Bluetooth search page, search for Bluetooth display name "smartbox – \*\*\*\*", click on the pairing and connect successfully.

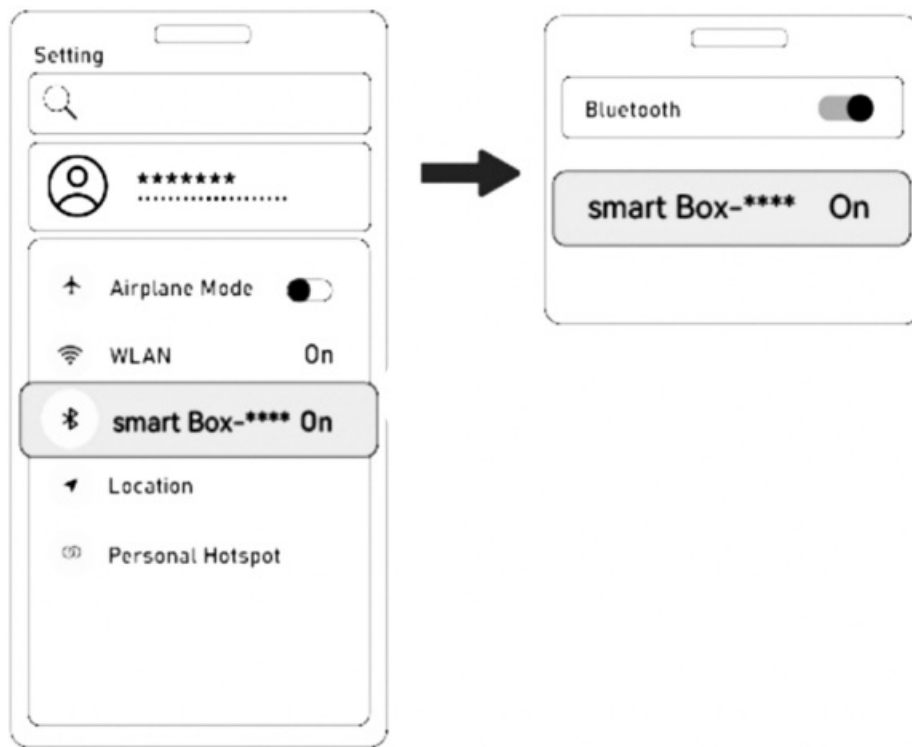

(Pictures are for reference only, subject to the real thing)

- After successful pairing, You will be able to use the driving pleasure brought by wireless AndroidAuto.

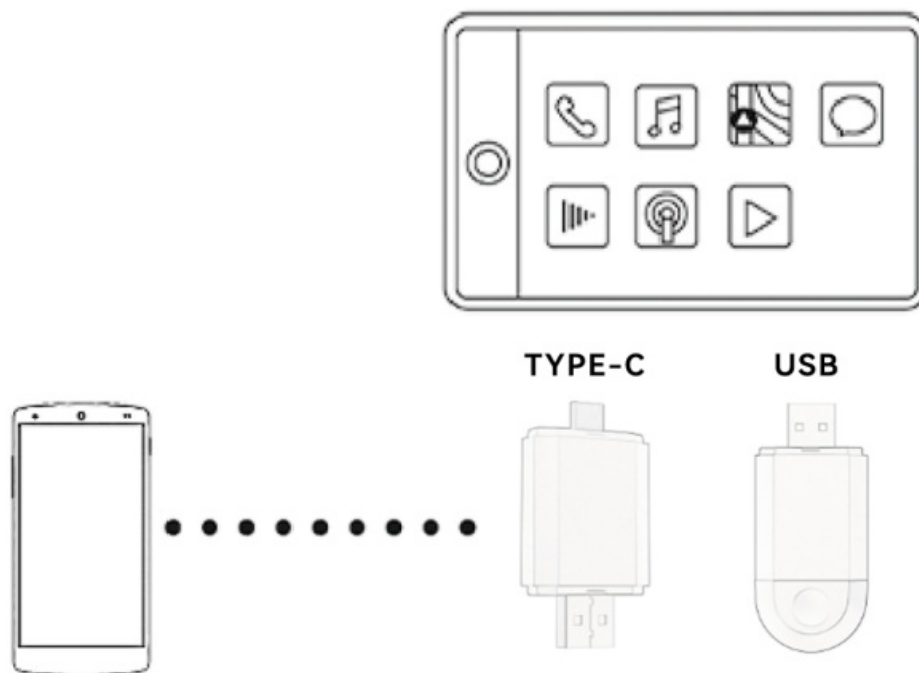

(Pictures are for reference only, subject to the real thing)

- After the Smart Box is connected to the in-vehicle device for the first time, it will be connected automatically the next time.

## Product Update System

- Connect the Android Smartbox to the vehicle, turn off the Bluetooth and WiFi switch of the mobile phone, then

turn on the WiFi switch, find the WIFI name, enter the password "88888888", open Google Chrome, enter the IP address 192.168.1.101 in the address bar. click Switch P2P. Toggle P2P, the prompt P2P toggle OK appears!!!

- Open the mobile phone's WIFI – Wi-Fi Direct – choose the display name of the box and connect. Open Google Chrome, enter the IP address 192.168.1.101 in the address bar, and click Update to start the update. Unplug the device and successfully repair it so that you can use it normally.

## Notes

- Mobile phone model and version requirements: Overseas version of Android phone, Google phone Android 11 and above version. 1.5.2 The original car must support wired AndroidAuto function.
- Multimedia with CarPlay and Auto function, while the product also supports CarPlay and Auto function, when connecting to the CarPlay function, the multimedia needs to be switched to the CarPlay mode and connected using an Apple phone; when connecting to the Auto function, the multimedia needs to be switched to the AndroidAuto mode and connected using an Android phone.

## Frequently Asked Questions

- **Why doesn't the indicator light of the product turn off automatically when the car is turned off?**

A. This product does not have a battery, the exact time the lights go out is determined by the Multimedia USB data port, the lights out time is different for each car.

- **Why can't I always connect?**

A:

- Turn on the WIFI, Bluetooth switches at the same time.
- In-car multimedia must support wired AndroidAuto function;
- Whether the product indicator light is on;
- Whether the product is connected to the multimedia data interface.

- **Can the product be paired with more than one cell phone?**

A: Yes, if you want to change the cell phone, you need to turn off the Bluetooth and WIFI function switch of the used cell phone.

- **Can't it reconnect automatically?**

A: The product can only connect to the last paired device. And you can't turn off the WIFI and Bluetooth switch.

- **I can't hear when I make a call?**

A: In the call page, you need to select the sound output as AndroidAuto mode. Some cars need to connect the cell phone to the Bluetooth of the car.

- **Sound delay, navigation delay?**

A: Playing music and navigation use cell phone traffic, if the cell phone signal is not stable, the above problems will occur.

- **Why is the connection suddenly disconnected?**

A: The product data line has a limiting function, the disconnection is caused by the loosening of the car data port and the data line.

- **Why can't AndroidAuto start or the device is incompatible /unrecognized USB?**

A:

- Re-unplug the device and restart the multimedia.
- Replace the data cable.



## FCC

This device complies with part 15 of the FCC Rules.

### Operation is subject to the following two conditions:

1. This device may not cause harmful interference, and
2. this device must accept any interference received, including interference that may cause undesired operation.

Any Changes or modifications not expressly approved by the party responsible for compliance could void the user's authority to operate the equipment.

**Note:** This equipment has been tested and found to comply with the limits for a Class B digital device, pursuant to part 15 of the FCC Rules. These limits are designed to provide reasonable protection against harmful interference in a residential installation. This equipment generates uses and can radiate radio frequency energy and, if not installed and used in accordance with the instructions, may cause harmful interference to radio communications. However, there is no guarantee that interference will not occur in a particular installation. If this equipment does cause harmful interference to radio or television reception, which can be determined by turning the equipment off and on, the user is encouraged to try to correct the interference by one or more of the following measures:

- Reorient or relocate the receiving antenna.
- Increase the separation between the equipment and receiver.
- Connect the equipment into an outlet on a circuit different from that to which the receiver is connected.
- Consult the dealer or an experienced radio/TV technician for help.

This equipment complies with FCC radiation exposure limits set forth for an uncontrolled environment. This equipment should be installed and operated with minimum distance 20cm between the radiator & your body.

## Documents / Resources

	<a href="#">SHAREVISION RC22 Carplay Wireless Adapter</a> [pdf] User Manual RC22, RC22 Carplay Wireless Adapter, Carplay Wireless Adapter, Wireless Adapter, Adapter
---	---

## References

- [iOS - CarPlay - Apple](#)
- [User Manual](#)

[Manuals+](#), [Privacy Policy](#)

This website is an independent publication and is neither affiliated with nor endorsed by any of the trademark owners. The "Bluetooth®" word mark and logos are registered trademarks owned by Bluetooth SIG, Inc. The "Wi-Fi®" word mark and logos are registered trademarks owned by the Wi-Fi Alliance. Any use of these marks on this website does not imply any affiliation with or endorsement.