



[Home](#) » [SHANGHAI](#) » **Shanghai GD UNI PAD FLIP Universal Wireless Keypad User Guide** 

Contents [[hide](#)]

- [1 Shanghai GD UNI PAD FLIP Universal Wireless Keypad](#)
- [2 GETTING STARTED](#)
- [3 PROGRAM THE INITIAL PIN](#)
- [4 CHANGING AN EXISTING PIN](#)
- [5 BATTERY](#)
- [6 INSTALLATION](#)
- [7 FCC](#)
- [8 Documents / Resources](#)
 - [8.1 References](#)

Shanghai

Shanghai GD UNI PAD FLIP Universal Wireless Keypad



GETTING STARTED

Locate the LEARN button on the garage door opener.

NOTE: Your garage door opener may look different.

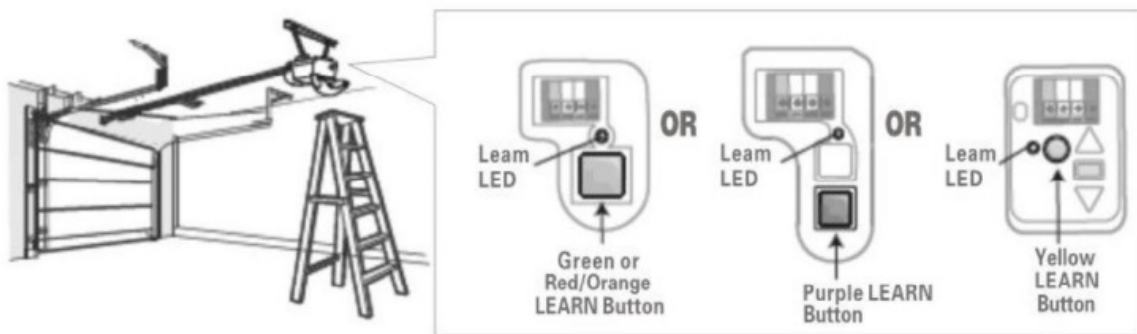

PROGRAM THE INITIAL PIN

Before You Begin

Programming is time-sensitive.

1. Write a 4-digit PIN# of your choice in steps 4 and 6.
2. Find and write your opener ID# from the list below to use in step 4.
- 3.

Number of Button Press Needed	Compatible Brand	Type/Color of Smart/DIPswitch
1	Linear	MegaCode 1997-Current
2	Chamberlain/LiftMaster/Craftsman	Orange/Red Button 1997-2005
3	Chamberlain/LiftMaster/Craftsman	Purple Button 2005-Current
4	Chamberlain/LiftMaster/Craftsman	Green Button 1993-1996
5	Genie/overhead Door	Intellicode 2005-Current
6	Genie/overhead Door	Intellicode 2005-Current
7	Stanley	Security Code 1998-Current
8	Chamberlain/LiftMaster/Craftsman	Yellow Button 2011-Current
9	Wayne Dalton	Rolling Code 372.5MHz 1993- Current
10	Chamberlain/LiftMaster/Craftsman	9 Code Switch 1990-1992
11	Chamberlain/LiftMaster/Craftsman	9 Code Switch 1990-1992
12	Genie 12-Code	12 Code Switch 1985
13	Linear 10-Code	Ez Code 10 Code Switch
14	Chamberlain/LiftMaster/Craftsman	8 Code Switch
15	Stanley Multi Code	10 Code Switch
16	Genie 9-Code	9 Code Switch
17	Linear Moor-O-Matic	8 Code Switch
18	Chamberlain/LiftMaster/Craftsman	7 Code Switch

Press and hold the and# buttons until the keypad stops flashing.

4. IMPORTANT: You have 10 seconds to complete this step. If the keypad light turns off before completing this step, go back to step 3.

Enter your 4-digit PIN and press#. Enter the opener ID and press#.

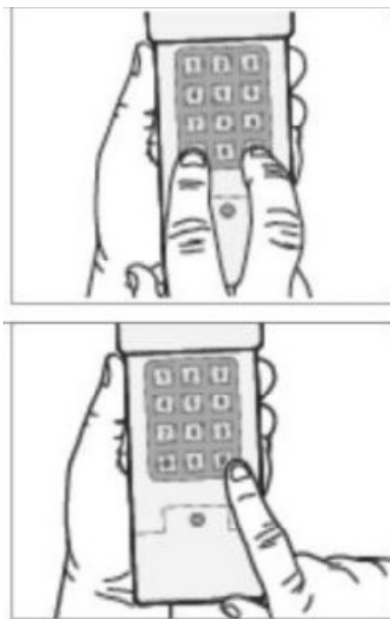

5. Press and quickly release the LEARN button on the garage door opener.

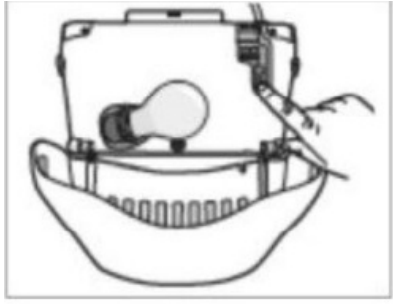

6. ENTER your 4-digit PIN and press the 0 key.

NOTE: For Genie and Overhead Door units, press the Okey twice.

7. Test by entering your 4-digit PIN, then press and hold the Okey until door activates.

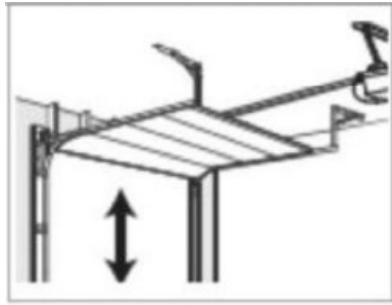

CHANGING AN EXISTING PIN

1. Enter the existing 4-digit PIN#, and press
2. Enter a new 4-digit PIN and press
3. Test by entering your new 4-digit PIN# and press the Okey

BATTERY

Replace the 9-Volt battery when the keypad light becomes dim or does not light up. Slide cover up, remove battery cover, and replace battery.

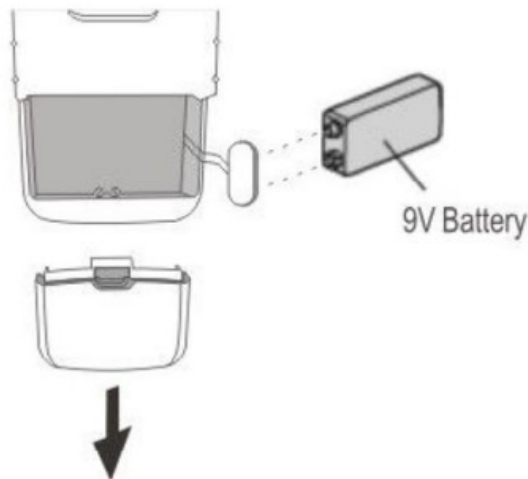

INSTALLATION

Install out of reach of small children at a minimum height of 5 feet (1.5 m) above floors, landings, steps or any other adjacent walking surface, and away from ALL moving parts of door. Secure keypad to a smooth surface. Mount the keypad out of the path of the moving garage door, but within sight of it (4" [10 cm] clearance is needed for the cover).

1. At the keypad cover bottom, pinch sides and firmly slide the cover from the keypad.
2. Remove the battery cover to show mounting holes.
3. Remove the battery and mount the keypad using screws provided.
4. Reassemble the battery cover and keypad cover.

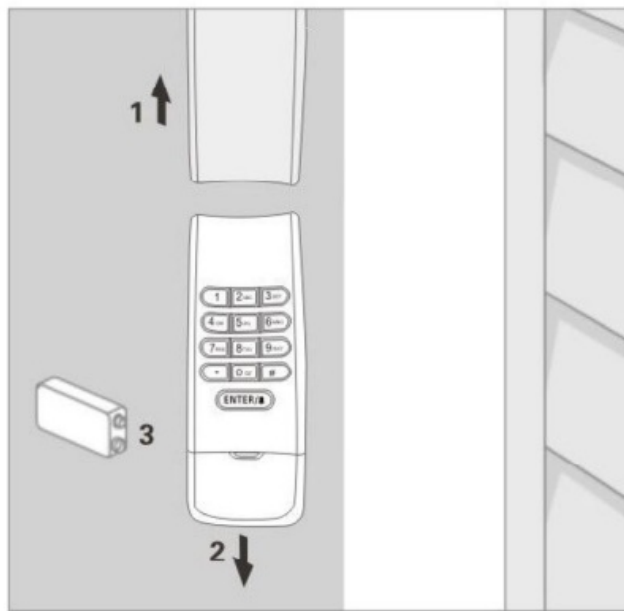

FCC

Please take attention that changes or modifications not expressly approved by the party responsible for compliance could void the user's authority to operate the equipment.

This device complies with Part 15 of the FCC Rules. Operation is subject to the following two conditions:

1. This device may not cause harmful interference.
2. This device must accept any interference received, including interference that may cause undesired operation

Documents / Resources



[Shanghai GD UNI PAD FLIP Universal Wireless Keypad \[pdf\]](#) User Guide
2ANHJGDUNIPADFLIP, gdunipadflip, GD UNI PAD FLIP Universal Wirele
ss Keypad, GD UNI PAD FLIP, Universal Wireless Keypad, Wireless Keyp
ad, Keypad

References

- [User Manual](#)

SHANGHAI

2ANHJGDUNIPADFLIP, GD UNI PAD FLIP, GD UNI PAD FLIP Universal Wireless Keypad, gdunipadflip, Keypad, Shanghai, Universal Wireless Keypad, Wireless Keypad

—Previous Post

[Shanghai P3 POS Terminal User Guide](#)

Next Post—

[Shanghai R19 ROUND Garage Remote Control Owner’s Manual](#)

Leave a comment

Your email address will not be published. Required fields are marked *

Comment *

Name

Email

Website

☐ Save my name, email, and website in this browser for the next time I comment.

Post Comment

Search:

e.g. whirlpool wrf535swhz

Search

[Manuals+](#) | [Upload](#) | [Deep Search](#) | [Privacy Policy](#) | [@manuals.plus](#) | [YouTube](#)

This website is an independent publication and is neither affiliated with nor endorsed by any of the trademark owners. The "Bluetooth®" word mark and logos are registered trademarks owned by Bluetooth SIG, Inc. The "Wi-Fi®" word mark and logos are registered trademarks owned by the Wi-Fi Alliance. Any use of these marks on this website does not imply any affiliation with or endorsement.