



Shada nl 2-250W Trailing Edge Dimmer Instruction Manual

[Home](#) » [Shada nl](#) » Shada nl 2-250W Trailing Edge Dimmer Instruction Manual 

Shada nl



LED's light
CONTROL
Trailing Edge-dimmer
Art.nr.: 191011

Contents

- [1 Installation](#)
- [2 Safety Instructions:](#)
- [3 Warranty and after-sales service:](#)
- [4 Instructions for cleaning and maintenance:](#)
- [5 Disposal instructions: General information on disposal](#)
- [6 Documents / Resources](#)
 - [6.1 References](#)
- [7 Related Posts](#)

  **Installation**

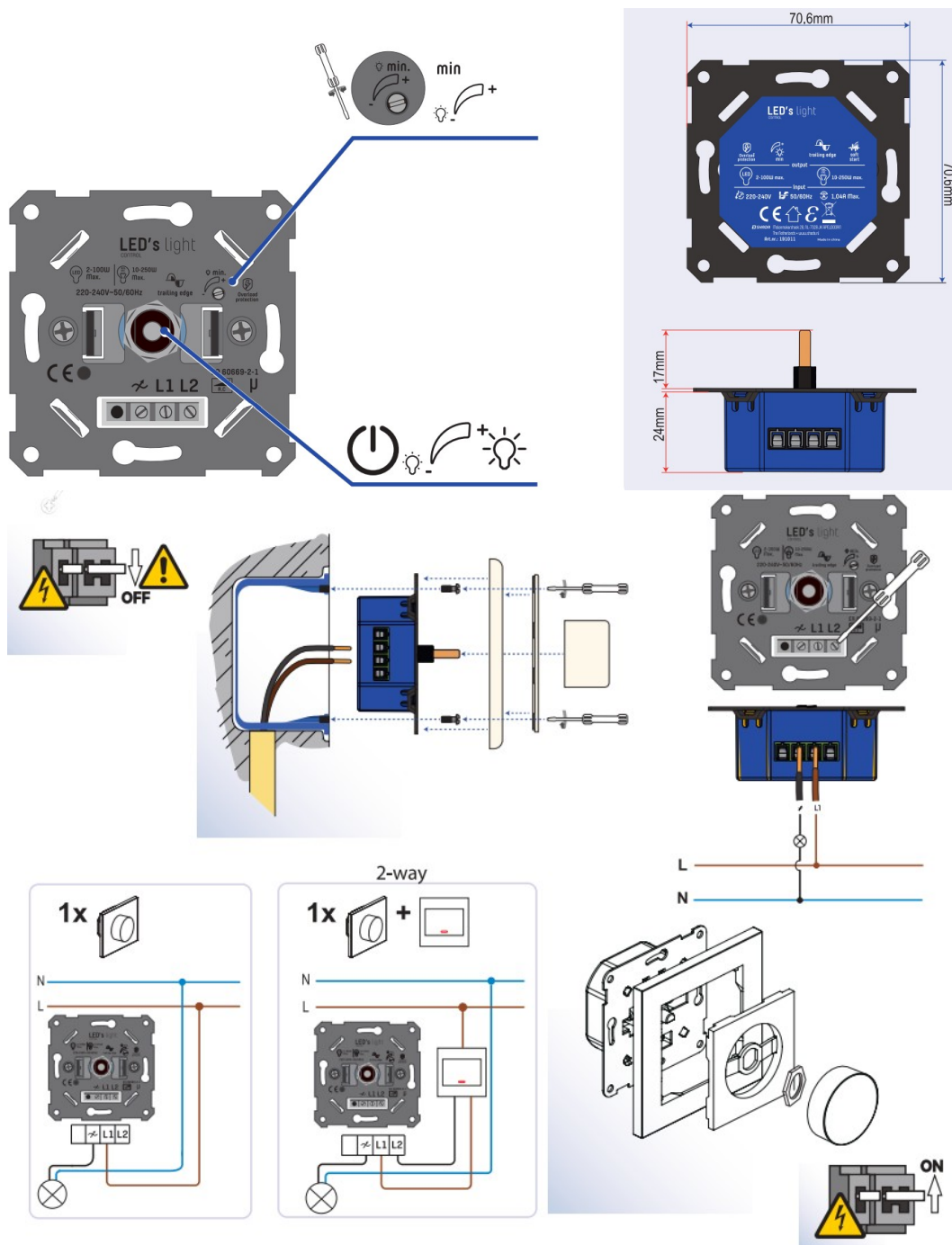

Safety Instructions:

Make sure you have fully read and understood the instructions in this document before installing or using the product according to the installation wiring diagram (if applicable). Keep this document for future use and use the product only as described in this document. Any use of the product other than as described in this manual may damage the product or injure the user (e.g. short circuit, fire, or electric shock). Disconnect the product from the power source if problems occur. Do not drop the product and avoid impacts. Do not use the product if any part is damaged or defective. Replace a damaged or defective product immediately.

If work must be done on high voltage power lines, it must be done by a qualified electrician to reduce the risk of electric shock. Ensure that the product is adequately ventilated during use. Never cover an electrical (LED) device during use as this generates heat and can cause damage. LEDs can be extremely bright and cause serious eye damage. never look directly into the light source! If a product is intended for indoor and/or outdoor use only, this is indicated on the product/components or in the manual. Keep the product out of the reach of children or animals.



Warranty and after-sales service:

Our Shada products are subject to strict quality standards and are regularly checked for their technical properties and functions by independent testing institutes. We provide a 24-month warranty on this product, provided it has been used, installed and maintained as intended. Full warranty terms for our Shada products and further information can be found on our homepage. If you need further assistance or have comments or suggestions, please visit www.shada.ni/ni/contact or contact us directly.



Instructions for cleaning and maintenance:

Do not use detergents or abrasives. Do not clean the inside of the device. Repairs to the product should only be performed by qualified trade personnel. Clean the outside of the device with a soft, damp cloth (do not use a microfiber cloth)



Disposal instructions: General information on disposal

According to the European WEEE Directive, electrical and electronic devices must not be disposed of with household waste. Their components must be recycled or disposed of separately, as they can be toxic and hazardous. Improper disposal of components may cause permanent damage to the environment. Details are regulated by the respective national legislation. The symbol on the product, operating instructions and/or packaging refers to these regulations. By separating, recycling and disposing of old appliances, you are making an important contribution to protecting our environment. Replaceable batteries and lamps must be removed from the electrical/electronic product before returning the product(s) for recycling and must be offered separately.

Disposal instructions for

- Luminaires with replaceable light source:
Remove the light source from the lamp and take the light source separately to recycling (electronic waste collection point). If both the light source and surrounding product (eg. luminaire housing) are to be disposed of, the light source and surrounding product must be offered separately. If necessary, check whether the lamp can be repaired (e.g. by replacing the light source) to avoid unnecessary electronic waste.
- Luminaires with permanently installed light source:
The light source cannot be replaced. Please recycle the entire product.
- Luminaires with separate / replaceable power supply
If necessary, check whether the lamp can be repaired {eg. by replacing the power supply} to avoid unnecessary electronic waste. If it is not possible to replace the power supply unit, recycle the product.
- Luminaires with integrated/non-interchangeable power supply unit:
The power supply unit cannot be replaced. Please recycle the entire product.

For the environment!

In terms of sustainability, large amounts of electronic waste can be avoided by replacing light sources and other components (e.g. power supplies). Therefore, please check whether replacement light sources or other replaceable components are available. These can usually be made available to you quickly and free of charge during the warranty period.

The manual must be passed on to third parties if the complete product is passed on.



Caution! Risk of electric shock.



Class II – A class II electrical appliance is double insulated and designed so that it does not require @ safety connection to electrical earth,



Not suitable for use in humid areas



The item should be disposed of separately from household waste. The item should be handed in for recycling in accordance with local environmental regulations for waste disposal. By separating a marked item from household waste, you will help reduce the volume of waste sent to incinerators or Land-fill and minimize any potential negative impact on human alth and the envionment.



This product caries the CE mark, which confirms that this product meets EU safety, heathh and environmental protection requirements.

Shada nl



Molenmakershoek 28,
NL-7328 JK APELDOORN – The Netherlands
www.shada.nl

Documents / Resources

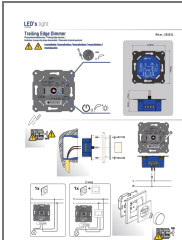

[Shada nl 2-250W Trailing Edge Dimmer](#) [pdf] Instruction Manual
2-250W Trailing Edge Dimmer, 2-250W, Trailing Edge Dimmer, Edge Dimmer, Dimmer

References

- [User Manual](#)