

SHAD
W0SX14IF System
Side Case Racks



SHAD W0SX14IF System Side Case Racks Installation Guide

[Home](#) » [SHAD](#) » SHAD W0SX14IF System Side Case Racks Installation Guide 

Contents

- [1 SHAD W0SX14IF System Side Case Racks](#)
- [2 Introduction](#)
- [3 Tools Required](#)
- [4 Installation](#)
- [5 Specifications](#)
- [6 Installation Guide](#)
- [7 FAQs](#)
- [8 Documents / Resources](#)
 - [8.1 References](#)

SHAD

SHAD W0SX14IF System Side Case Racks



Introduction

The SHAD W0SX14IF System Side Case Racks are designed to offer a sturdy and reliable mounting solution for SHAD side cases on motorcycles. These racks ensure a secure fit while maintaining a sleek, lightweight profile that complements the bike's aesthetics. Built with high-quality materials, they provide excellent support for long-distance touring, city commuting, and everyday use.

Tools Required

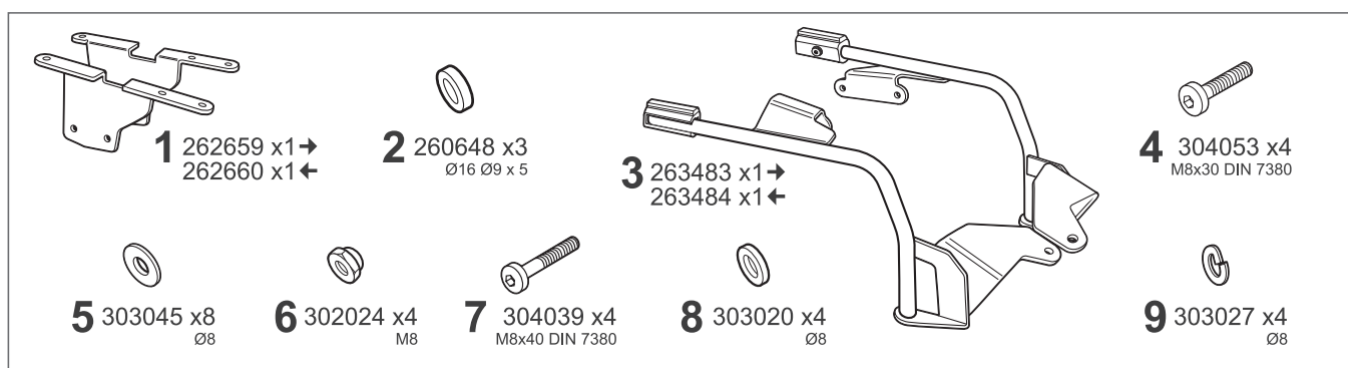

WARNING!

Do not fully tighten the screws until it is ensured that the KIT is correctly attached and aligned. Check tightness every 4 months.

IMPORTANT: Based on European models. For compatibility with models in other continents, check www.shad.es

Installation

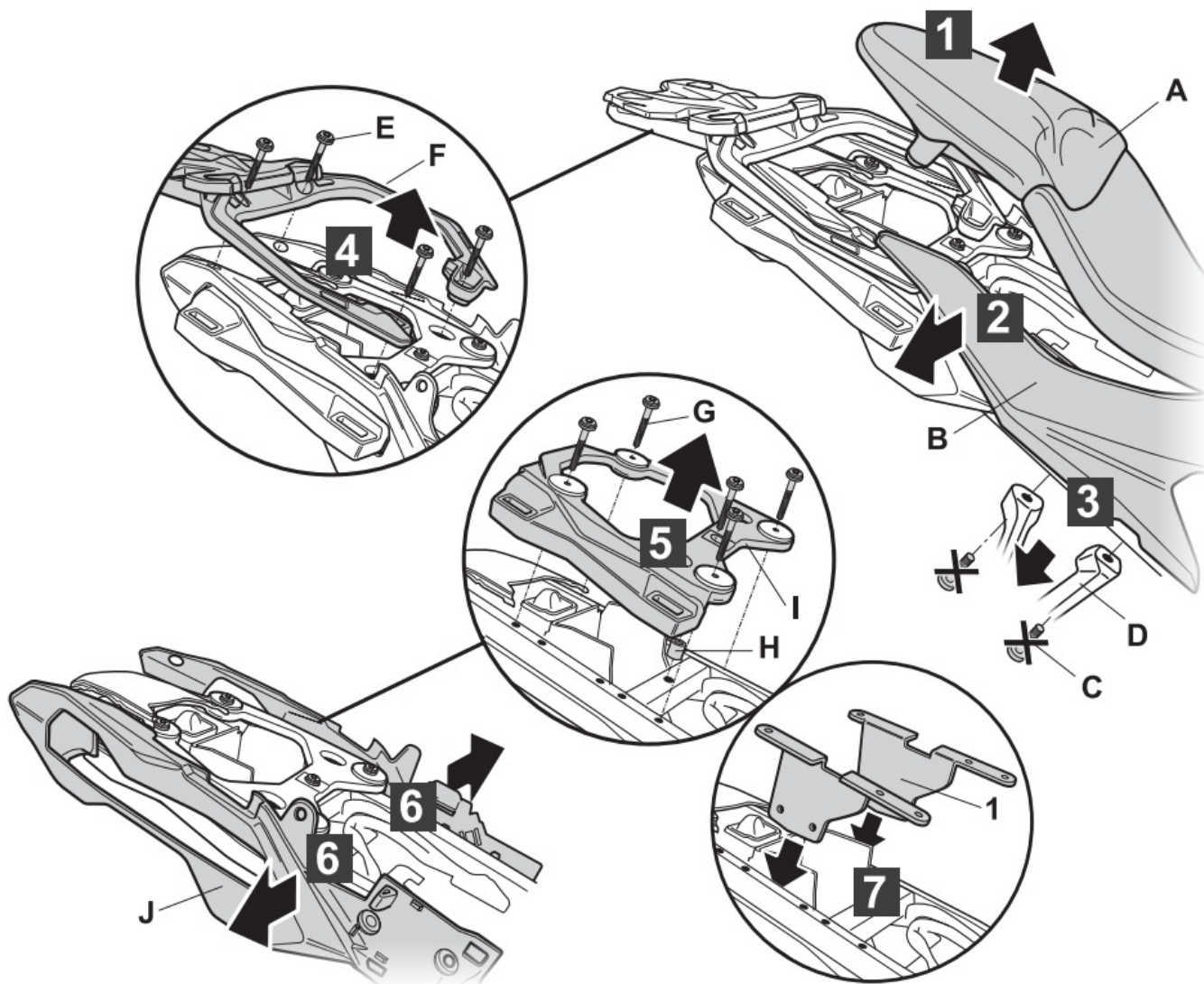

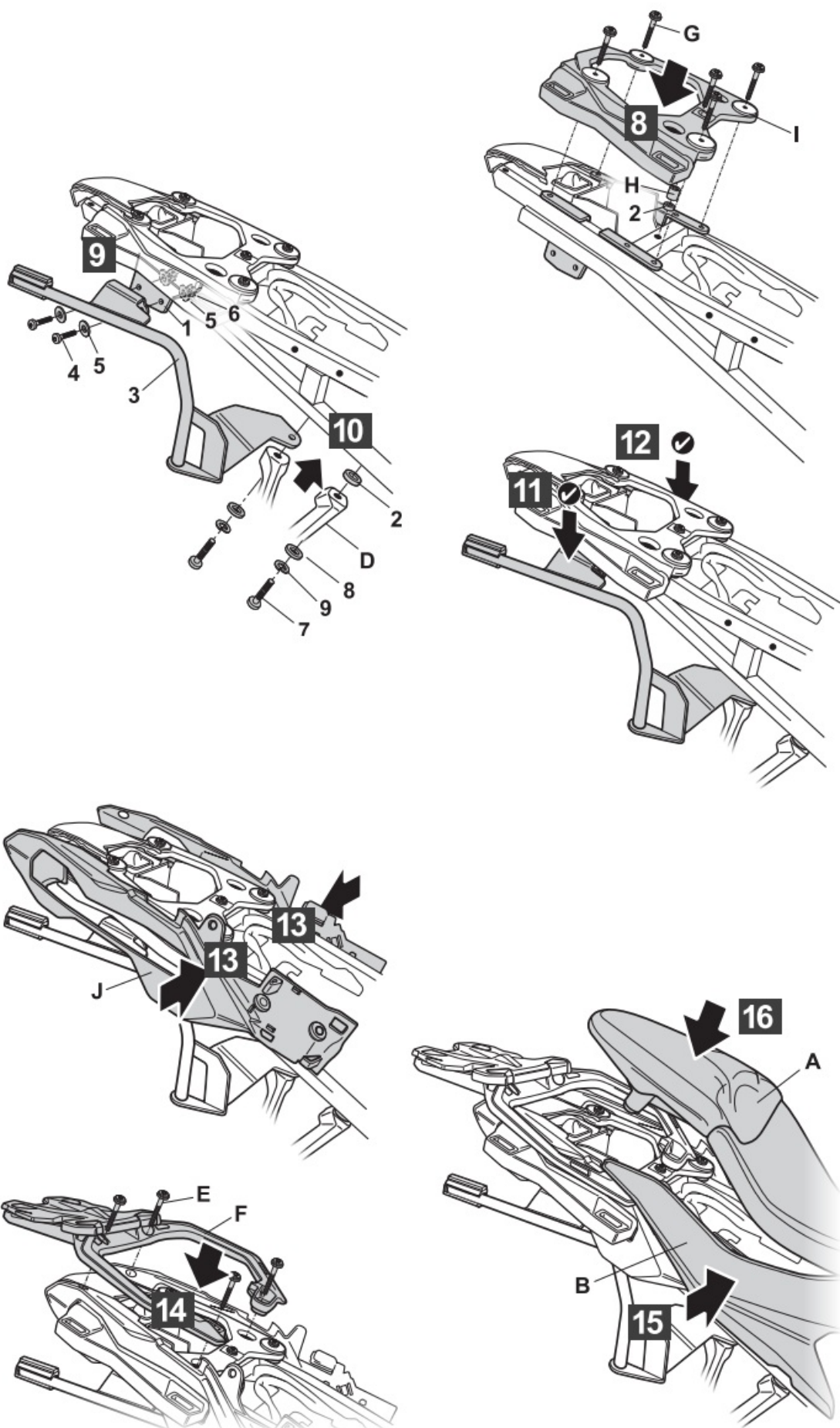

Specifications

- Brand: SHAD

- Model: W0SX14IF
- Compatibility: Designed for specific motorcycle models (check SHAD's compatibility chart)
- Material: High-resistance steel
- Color: Black
- Mounting Type: Bolt-on system
- Weight: Lightweight but durable
- Side Case Compatibility: Works with SHAD's side cases, such as SH35, SH36, and other compatible models
- Design: Minimalist, ensuring close-fitting integration with the bike

Installation Guide

Preparation

- Gather all necessary tools (wrenches, screwdrivers, Allen keys).
- Ensure your motorcycle is stable on a center stand or paddock stand.

Removing Existing Components

- If applicable, remove the stock grab rails or any pre-installed racks.
- Retain any necessary hardware that may be reused.

Attaching the Side Racks

- Align the SHAD W0SX14IF side case rack with the designated mounting points on your bike.
- Secure the racks using the provided bolts and washers.
- Tighten bolts evenly to ensure a balanced fit.

Final Adjustments

- Ensure the racks are symmetrically aligned.
- Recheck all fastenings and tighten them as necessary.
- Attach SHAD side cases and test the fit.

FAQs

Are the SHAD W0SX14IF side case racks compatible with all motorcycles?

No, these racks are designed for specific motorcycle models. Always check SHAD's official compatibility guide before purchasing.

Can I install these racks without professional help?

Yes, the installation process is straightforward and can be done at home with basic tools. However, if you are unsure, professional installation is recommended.

Do these racks require any modifications to the motorcycle?

No permanent modifications are needed. The racks use existing mounting points on the motorcycle.

Documents / Resources

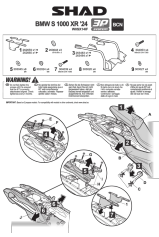
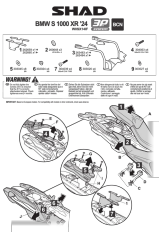
	<p>SHAD W0SX14IF System Side Case Racks [pdf] Installation Guide W0SX14IF, W0SX14IF BMW S 1000 XR 24 3P SYSTEM, W0SX14IF System Side Case Racks, W0SX14IF, System Side Case Racks, Side Case Racks, Case Racks</p>
	<p>SHAD W0SX14IF System Side Case Racks [pdf] Installation Guide W0SX14IF, W0SX14IF BMW S 1000 XR 24 3P SYSTEM, W0SX14IF System Side Case Racks, W0SX14IF, System Side Case Racks, Side Case Racks, Case Racks</p>

References

- [User Manual](#)

[Manuals+](#), [Privacy Policy](#)

This website is an independent publication and is neither affiliated with nor endorsed by any of the trademark owners. The "Bluetooth®" word mark and logos are registered trademarks owned by Bluetooth SIG, Inc. The "Wi-Fi®" word mark and logos are registered trademarks owned by the Wi-Fi Alliance. Any use of these marks on this website does not imply any affiliation with or endorsement.