



SHAD E091CL Click System Tank Bag User Guide

[Home](#) » [SHAD](#) » SHAD E091CL Click System Tank Bag User Guide 



Contents

- [1 SHAD E091CL Click System Tank Bag](#)
- [2 Specifications](#)
- [3 Product Usage Instructions](#)
- [4 Care and Maintenance](#)
- [5 Assembly](#)
- [6 ACCESSORIES](#)
- [7 Contact Information](#)
- [8 Documents / Resources](#)
 - [8.1 References](#)

SHAD E091CL Click System Tank Bag



Specifications

- Product Name: Click System Tank Bag
- Model Number: E091CL
- Weight: 2 kg
- Lock Type: Combination lock

Product Usage Instructions

1. Mounting and Installation:

Before mounting the Click System Tank Bag, it is crucial to carefully read through the instructions from start to finish. Failure to follow the recommended mounting and installation instructions will void the warranty. The manufacturer is not liable for any damage, injury, or death resulting from improper use and installation of the product.

2. Inspection and Maintenance:

Regularly inspect the knobs, bolts, screws, straps, and locks for signs of wear, corrosion, and fatigue. Never drive with any lock, knob, or rack in an open or unlocked position. Ensure that all components are in good working condition before each use.

3. Theft Prevention:

The Shad locks included with the product are designed to deter vandalism and theft. However, they should not be considered theft-proof. It is recommended to remove valuable gear from the tank bag if your vehicle will be unattended for an extended period.

4. Compliance with Laws:

Check the specific laws in your country regarding transportation systems and the projection of objects beyond the perimeter of a vehicle. Be aware of the width and height of your cargo, as it will affect the vehicle's driving behaviour.

5. Speed and Caution:

For the safety of your vehicle and luggage system, obey all posted speed limits and traffic cautions. Adjust your

speed according to road conditions and the load being carried.

6. Consultation with Shad Dealer:

If you have any questions regarding the operations and limits of Shad Products, it is recommended to consult with your Shad dealer for expert advice.

7. Intended Use:

Do not use Shad carriers and accessories for purposes other than those for which they were designed. Ensure that the product is used within its intended capacity. Failure to follow these guidelines or the product's instructions will void the warranty.

8. Protection from Elements:

Prolonged exposure to the elements may cause discolouration of fabrics and wear away plastic components. It is advisable to store the tank bag in a dry and protected area when not in use.

9. Load Distribution:

When packing the tank bag, make sure that the loads are evenly distributed inside the cargo box or bag. This will help maintain stability and balance during travel.

10. Waterproof Features:

While the tank bag may have waterproof zippers and rain covers, it does not guarantee that the bag is completely waterproof. Take necessary precautions to protect your belongings from water damage.

FAQ (Frequently Asked Questions):

Are the Click System Fitting Kit and Bike Compatibility sold separately?

Yes, the Click System Fitting Kit is sold separately from the Click System Tank Bag. Additionally, bike compatibility information can be checked on the shad.es website.









How do I set my combination for the lock?

To set your combination for the lock, follow these steps:

1. Put the dials at the original number (0-0-0).
2. Press down the reset button (a) with a tool until you hear a click sound.
3. Set your desired combination by turning the dials (b), for example, 8-8-8.
4. Push the button (c) towards the direction of the arrow, and the reset button (a) will return when you hear another click sound. Now, your combination is set. Please remember it by heart.

Care and Maintenance

Warning

	MAXIMUM WEIGHT		9L Capacity
	MAXIMUM SPEED, CHECK LOCAL LAWS.		Reflective
	ALWAYS SECURE AND LOCK PRODUCTS.		Combination lock
	ONLY USE RECOMMENDED CLEANING PRODUCTS.		
	BAGS ARE NOT DESIGNED TO PROTECT FRAGILE OBJECTS.		

- Before mounting, carefully read through the instructions from start to finish. Failure to follow recommended mounting and installation instructions voids the warranty. Manufacturer is not liable for any damage, injury or death that results from improper use and installation of products. By installing these products, the user accepts all liabilities.
- Knobs, bolts, screws, straps and locks must be periodically inspected for signs of wear, corrosion, and fatigue. Never drive with any lock, knob or rack in an open or unlocked position.
- Shad locks are designed to deter vandalism and theft but should not be considered theft-proof. Remove valuable gear if your vehicle is unattended for an extended period.
- Check country-specific laws regarding transportation systems and the projection of objects beyond the perimeter of a vehicle. Be aware of the width and height of your cargo. All cargo will affect the vehicle's driving behaviour.
- For the safety of your vehicle and luggage system, obey all posted speed limits and traffic cautions. Adapt your speed to the conditions of the road and the load being carried.
- Consult with your Shad dealer if you have any questions regarding the operations and limits of Shad Products.
- Do not use Shad carriers and accessories for purposes other than those for which they were designed.
- Do not exceed their carrying capacity. Failure to follow these guidelines or the product's instructions will void the warranty.
- Prolonged exposure to the elements might discolour fabrics and wear away plastic components.
- Make sure that loads are evenly distributed inside the cargo box or bag.
- Waterproof zippers and rain covers do not guarantee that the bag is waterproof.

Assembly

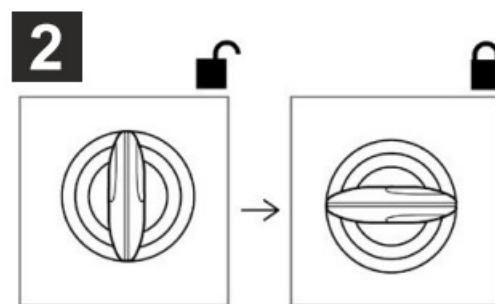
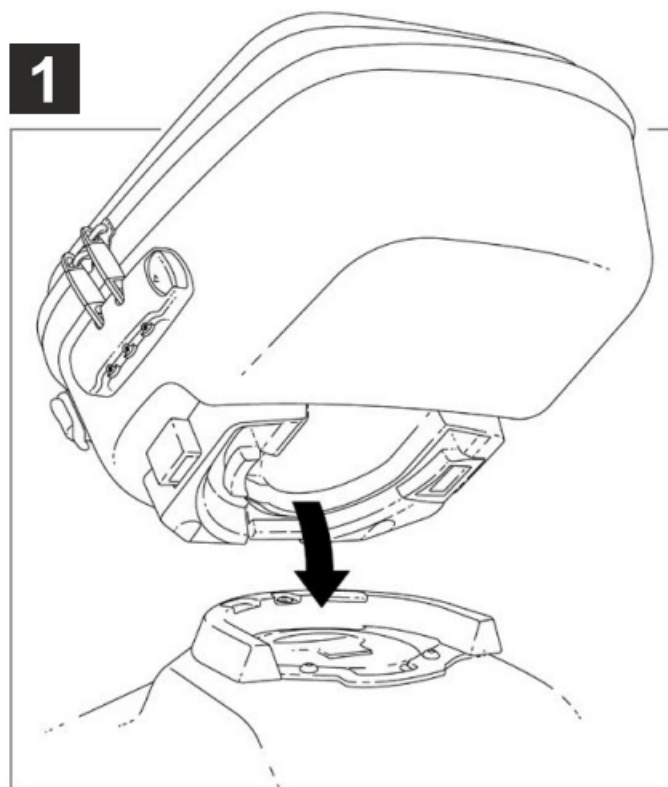

RELEASE

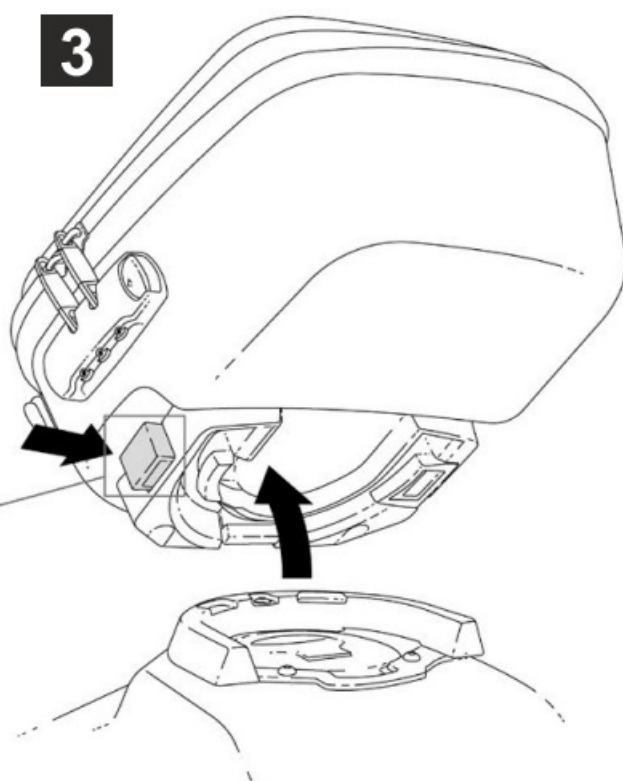
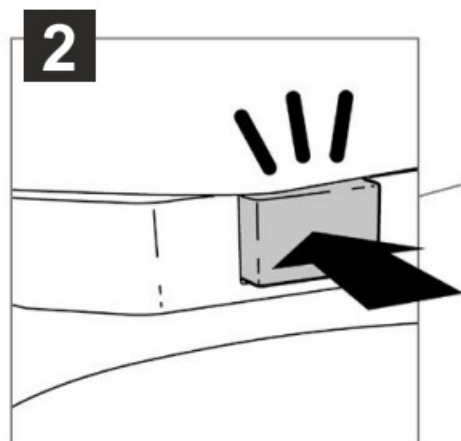
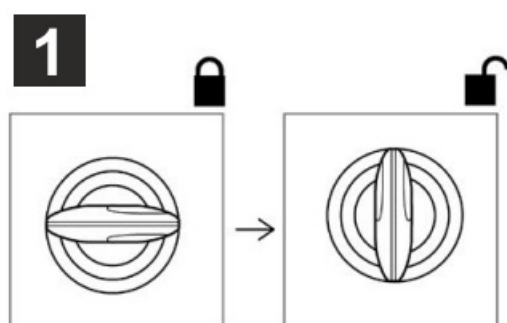

OPEN

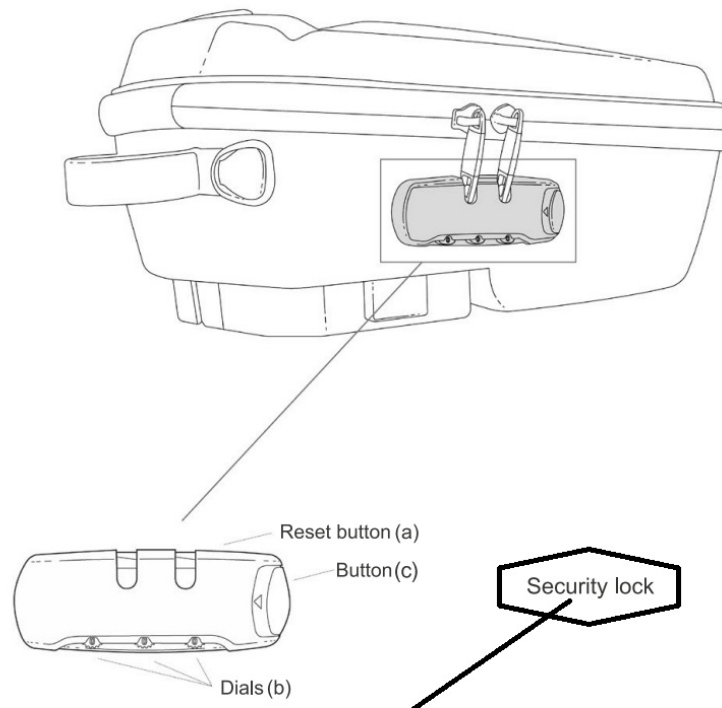

Security Lock

The original number is 0-0-0; To set your combination, follow these steps.

1. Put the dials at their original number 0-0-0;
2. Press down the reset button (a) with a tool until you hear the “click” sound.
3. Set your combination by turning the dials (b) for example 8-8-8. Then.
4. Push the button (c) towards the direction of the arrow and the reset button (a) will be back when you hear the “click” sound.

Now you have finished setting your combination. Please remember it by heart.

ACCESSORIES

CLICK SYSTEM FITTING KIT Sold separately



BIKE COMPATIBILITY



BIKE COMPATIBILITY



Check bike compatibility on the [shad.es](https://www.shad.es) website

Contact Information

SHAD EUROPE NAD HEADQUARTERS **Tel:** (+34) 935 795 866 Octave Lecante, 2-6 Mollet del Valles, 08100 Barcelona – Spain

SHAD CHINA **Tel:** (+86) 21 6236 5730 Room 501 (Zone 1-T3), No.1, Lane 268, Tai Hong Road, Minhang District, 201107 Shanghai – China

SHAD USA **Tel:** (+1) 305 652 6366 19096 NE 4th Court Miami FL, 33179 USA

SHAD INDONESIA **Tel:** (+62) 21 2271 8560 Jl. Kemang Selatan VIII No.56 Unit B Jakarta 12730 Indonesia

RESOURCE REDUCTION 60% SELF SUSTAINING FACTORIES 1200 TREES PLANTED 414 2 tree-nation ISO 14001:2015

[WWW.SHAD.ES](https://www.shad.es)

Documents / Resources



[SHAD E091CL Click System Tank Bag](#) [pdf] User Guide

E091CL Click System Tank Bag, E091CL, Click System Tank Bag, System Tank Bag, Tank Bag, Bag

References

- [Home - SHAD](#)
- [User Manual](#)