



SEWOSY SHOKV1 Alarm Button Green with LED Indication and Alarm Signal Instruction Manual

[Home](#) » [SEWOSY](#) » SEWOSY SHOKV1 Alarm Button Green with LED Indication and Alarm Signal Instruction Manual 

SEWOSY SHOKV1 Alarm Button Green with LED Indication and Alarm Signal Instruction Manual



Contents

- 1 REFERENCES
- 2 TECHNICAL SPECIFICATIONS
- 3 MOUNTING
- 4 CABLE DUCT ENTRY
- 5 MANUAL CALL POINT RESET
- 6 RESET KEY SLOTS
- 7 CONNECTION
- 8 JUMPER CONFIGURATIONS
- 9 DIMENSIONS
- 10 Documents / Resources
 - 10.1 References
- 11 Related Posts

REFERENCES

References	Designation
SHOKV1	Manual call point 1 contact
SHOKV2	Manual call point 2 contacts
SHOKV3	Manual call point 2 contacts and Buzzer / LED
SHOKV4	Manual call point 2 contacts with cover opening detection and Buzzer / LED

TECHNICAL SPECIFICATIONS

General specifications of the manual call point

- **Operating voltage** : 12-24V DC (+10%)
- **Consumption** : 12V DC – max. 45 mA / 24V DC – max. 62 mA
- **Switching rate (C/NO/NC)** : 250V AC – 5 A / 30V DC – 4 A
- **IP rating** : IP 40 uniquement only for indoor use
- **Conductor's cross section** : max 1 mm²
- **Operating temperature** : 0 / +50°C
- **Weight** : 0,17 kg

KIT

Reset Key x2

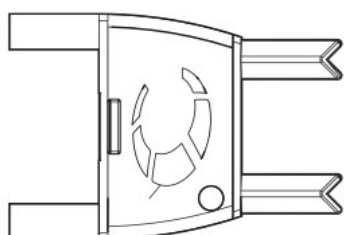

SHOK_K

Protection cover x1

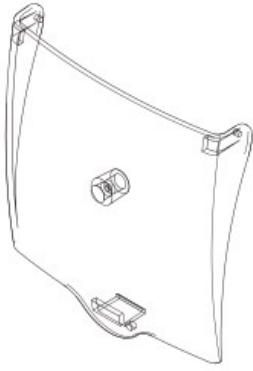

**SHOK_C (SHOKV1 – V2 – V3) SHOK_P
SHOK_CA (SHOKV4)**

Cover screw for surface mounting x1

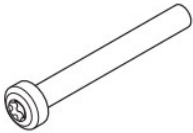

K30x25

Cover screw and nut for semi-flush mounting x1

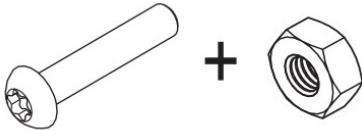

M3x16 M3

Green plastic seal x1



SHOK_P

MOUNTING

Semi-flush mounting

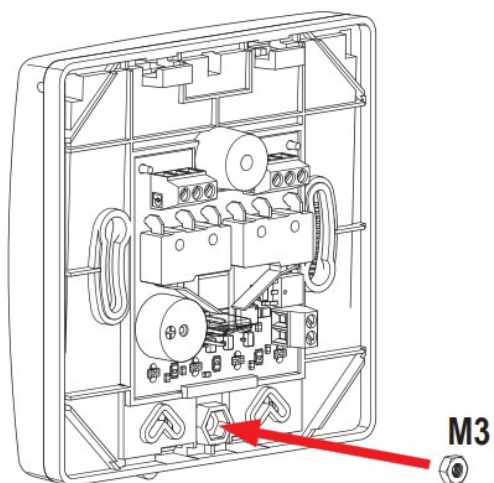
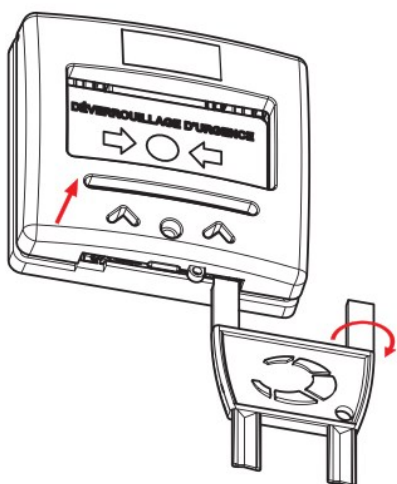

Non fournies
Not provided

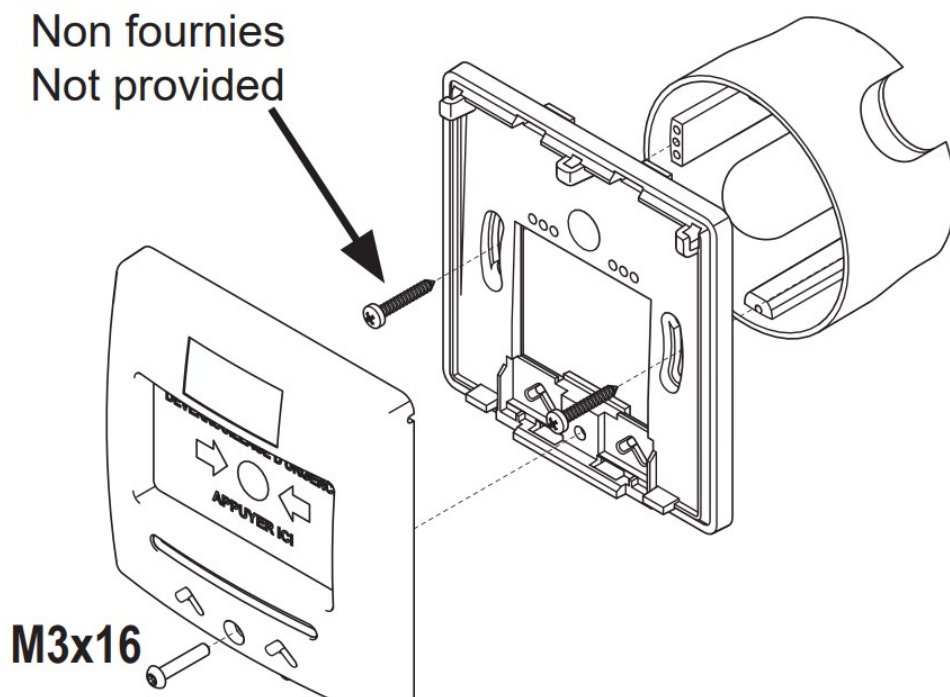

Surface mounting

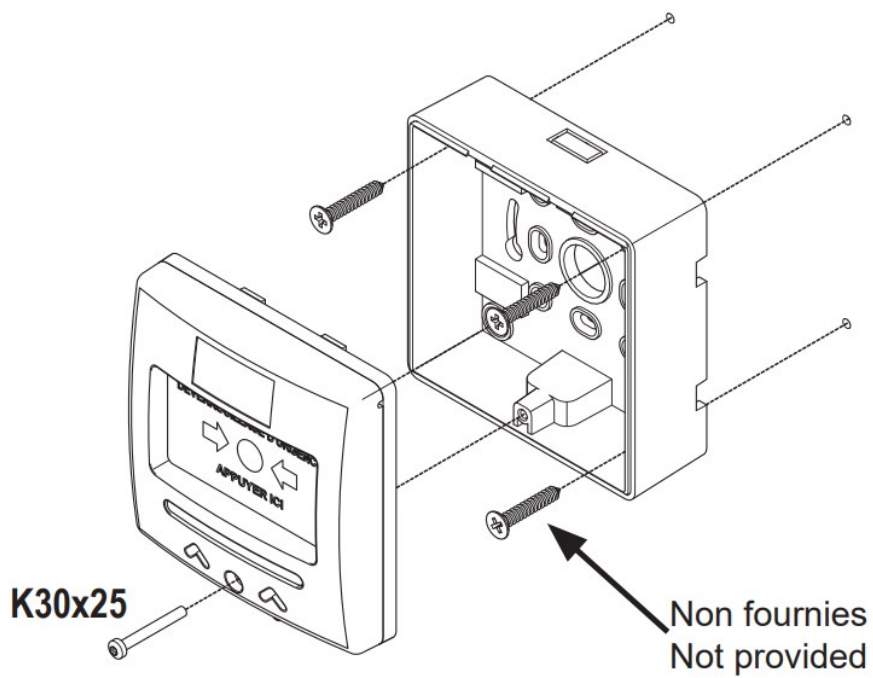

Surface mounting possible with standard 60 mm outlet box

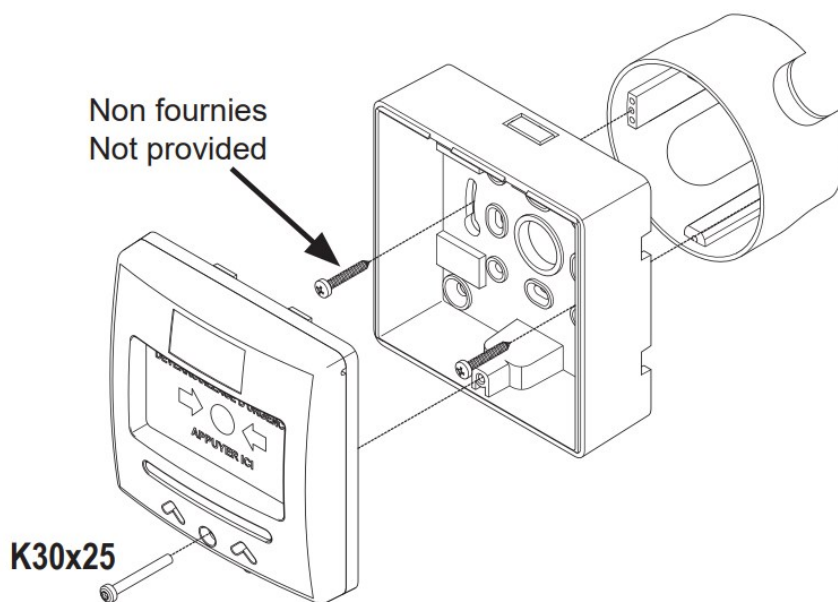

Mounting of the cover

Surface mounted

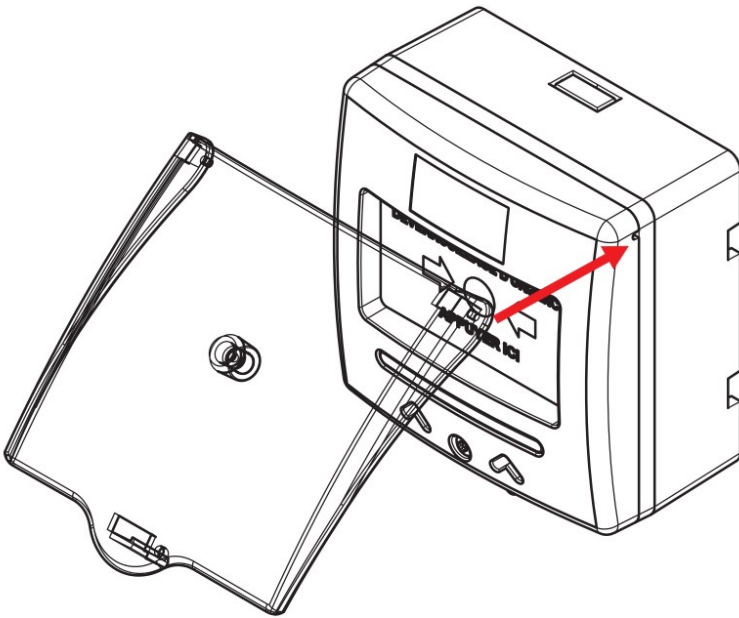

Semi-flush mounted

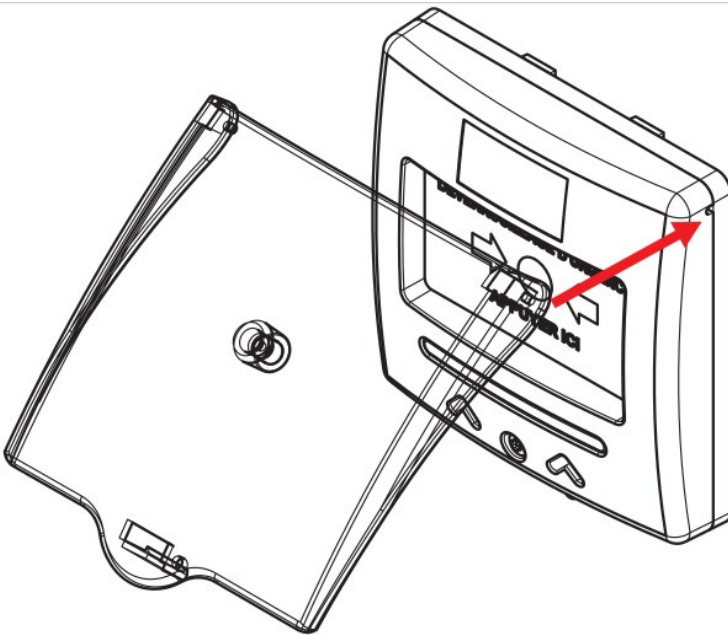

CABLE DUCT ENTRY

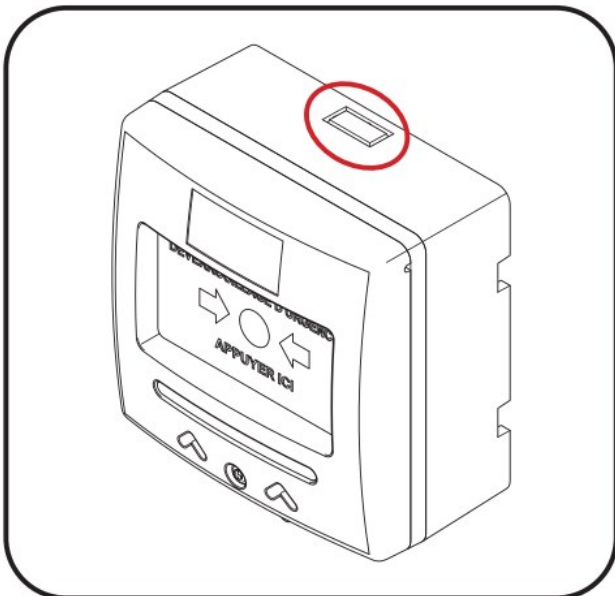

MANUAL CALL POINT RESET

Front reset

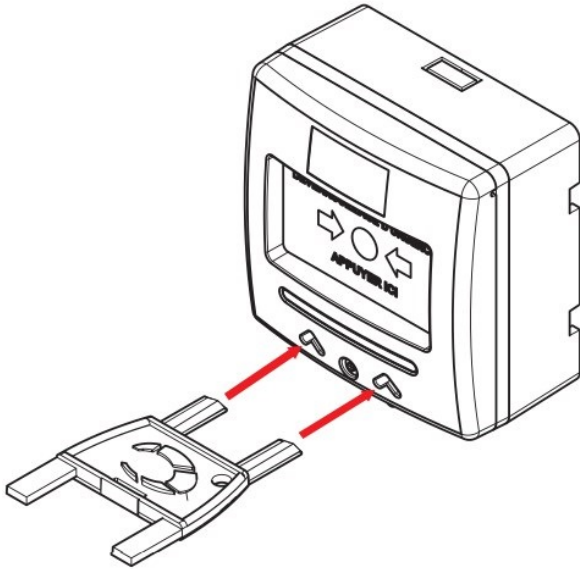

OR

Reset below

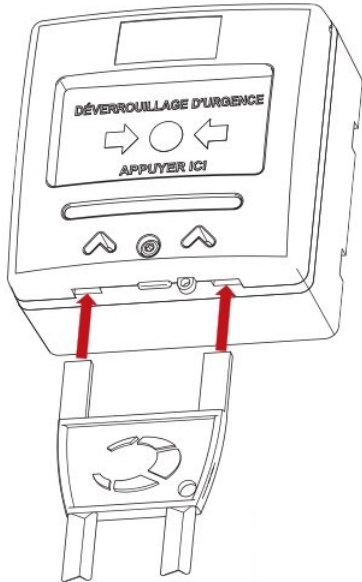

RESET KEY SLOTS

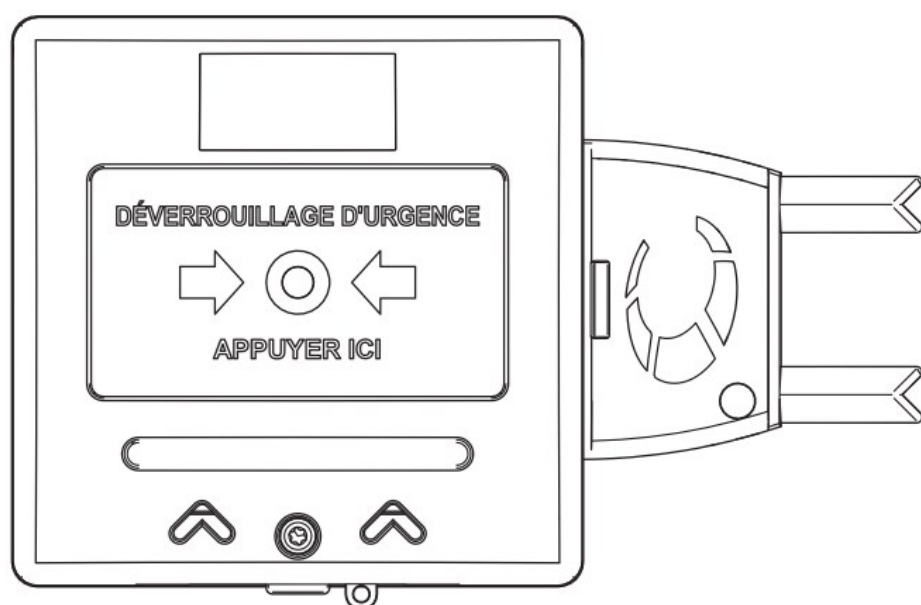
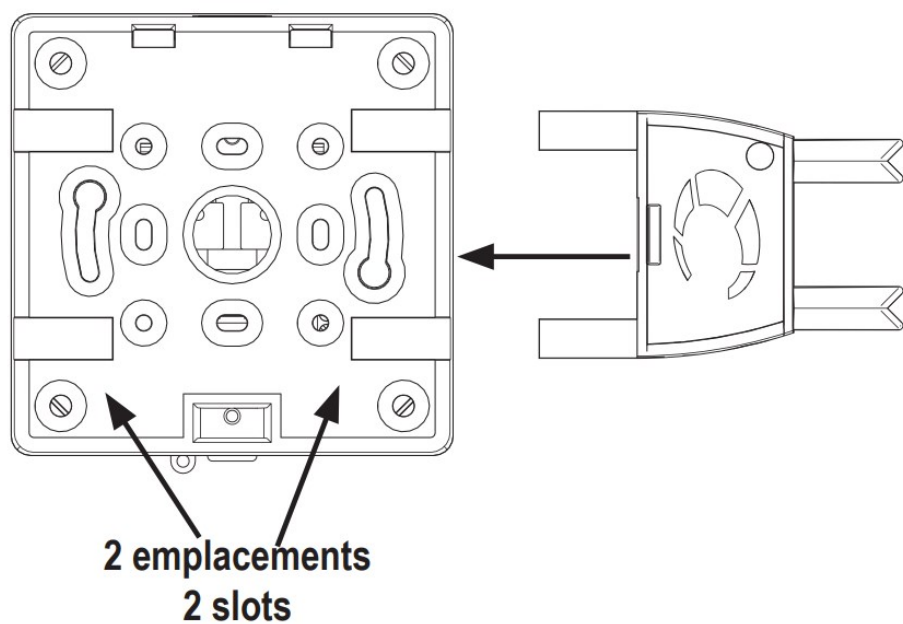

CONNECTION

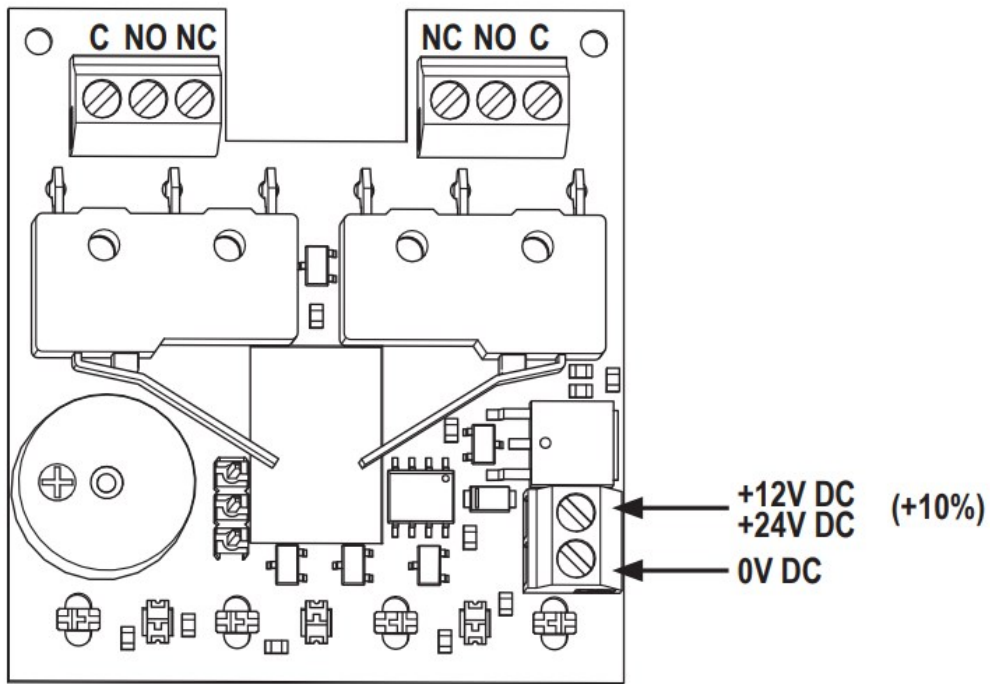

Connecting whilst switched on

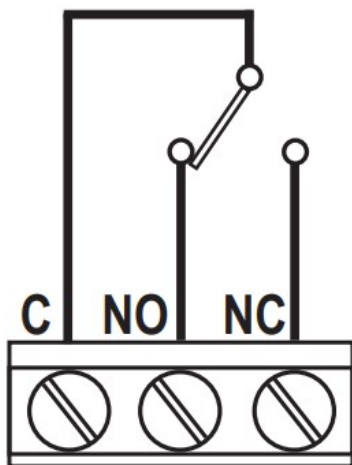

Connecting whilst disarmed (factory setting)

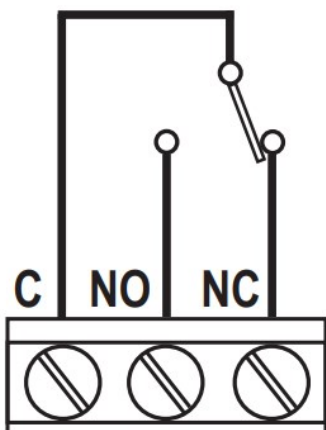

The electronic board is fixed to the manual call point. Do not remove it!

JUMPER CONFIGURATIONS

SHOKV3

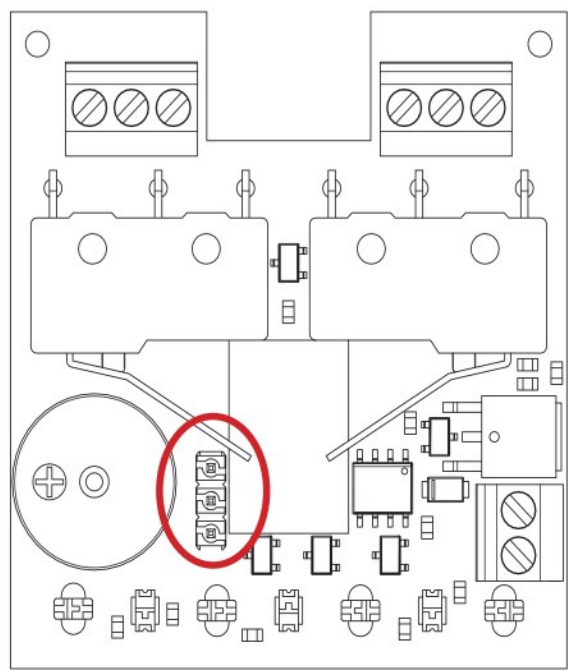

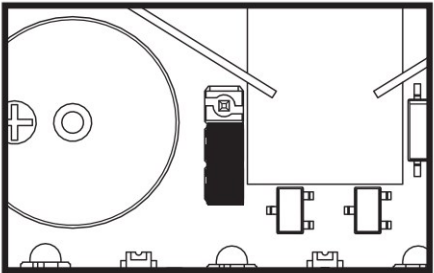
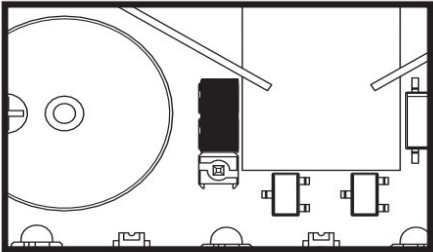
Jumper	STATE OF THE BUZZER
	When triggered, the buzzer sounds continuously (ON – 70 dB)
	Buzzer disabled (OFF)

STATE OF THE LEDs

- **Call point switched on:** Green
- **Call point disarmed:** Red

SHOKV4

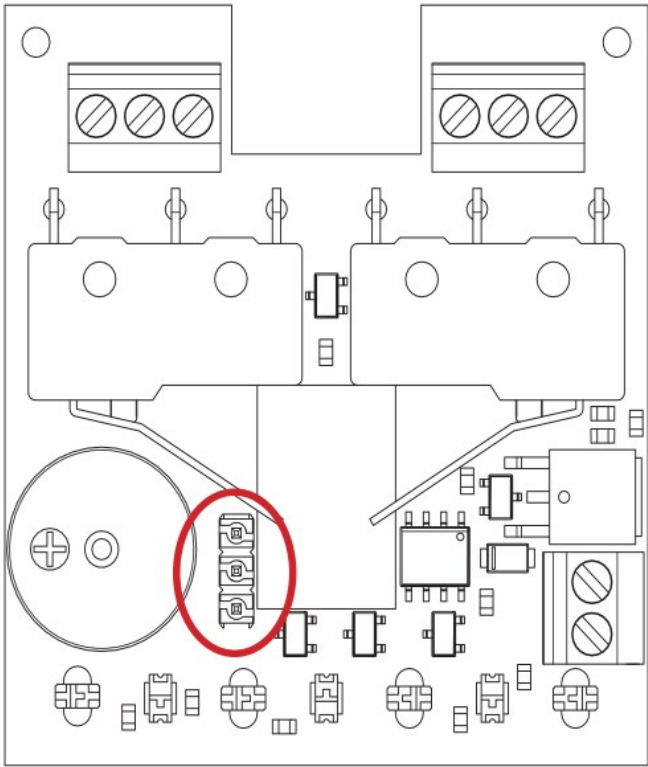

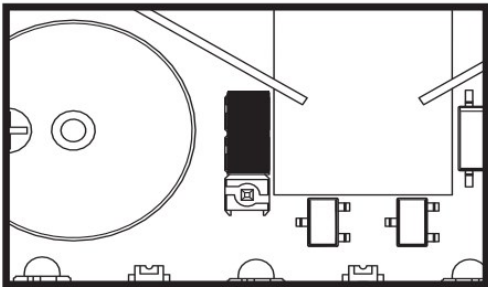
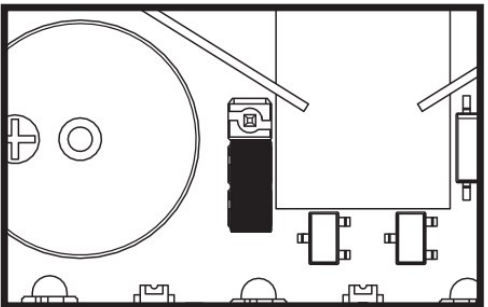
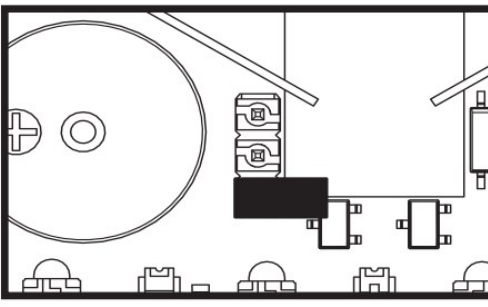
Jumper	STATE OF THE BUZZER
	<p>When the cover is opened, the buzzer sounds discontinuously (ON – 70 dB)</p> <p>When triggered, the buzzer sounds continuously (ON – 70 dB)</p>
	<p>When the cover is opened, the buzzer is disabled (OFF)</p> <p>When triggered, the buzzer sounds continuously (ON – 70 dB)</p>
	<p>Buzzer disabled (OFF)</p>

STATE OF THE LEDs

- Call point switched on: Green
- Call point disarmed: Red
- Cover open: Flashing: white

DIMENSIONS

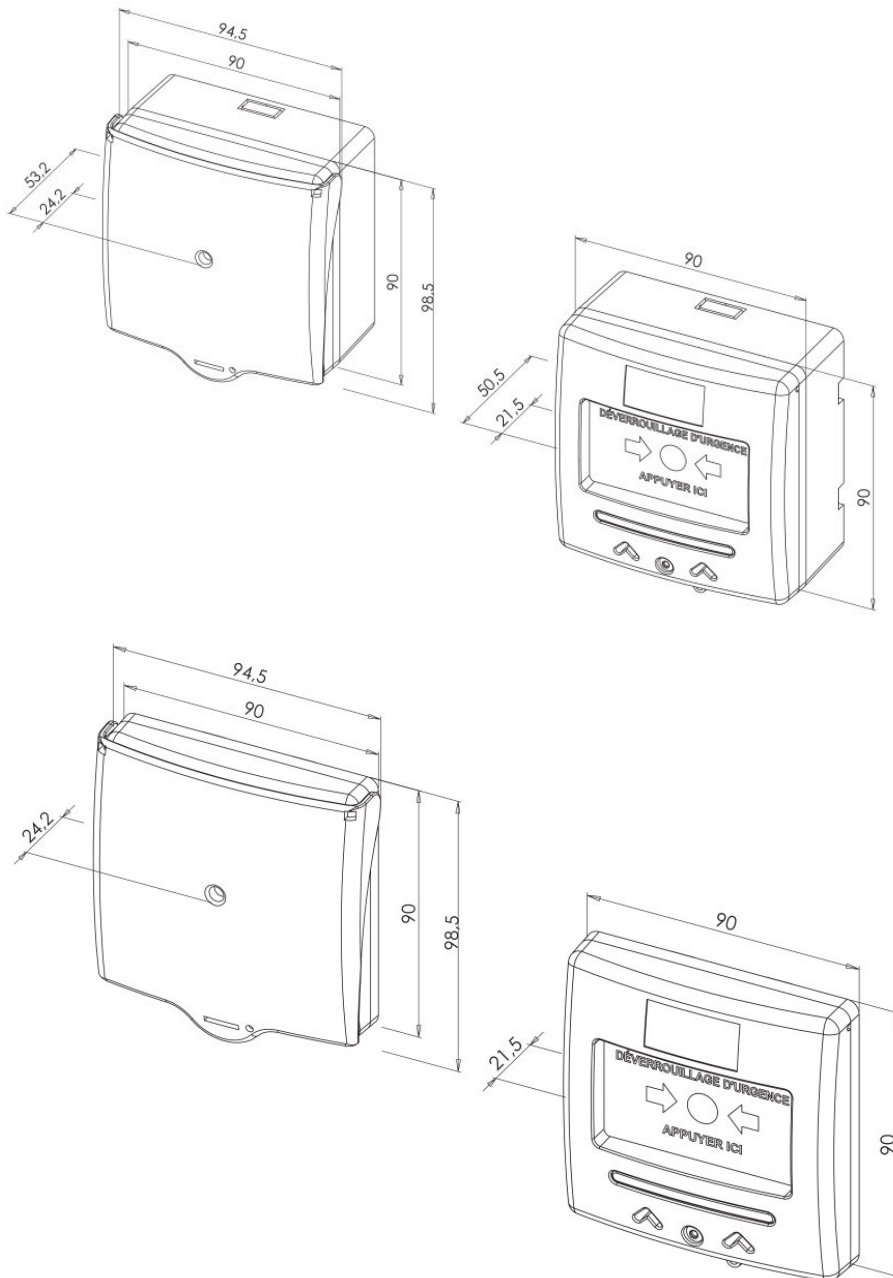

SHOK

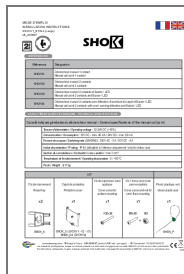

[SEWOSY SHOKV1 Alarm Button Green with LED Indication and Alarm Signal](#) [pdf] Instruction Manual
SHOKV1 Alarm Button Green with LED Indication and Alarm Signal, SHOKV1, Alarm Button Green with LED Indication and Alarm Signal, LED Indication and Alarm Signal, Alarm Signal

References

- [Accueil – Sewosy - Fabricant de produits de verrouillage électrique et électromagnétique](#)