

# SE-3 Server Express Pouched Condiment Dispenser Owner's Manual

[Home](#) » [SERVER](#) » SE-3 Server Express Pouched Condiment Dispenser Owner's Manual 

SE-3 Server Express Pouched Condiment Dispenser

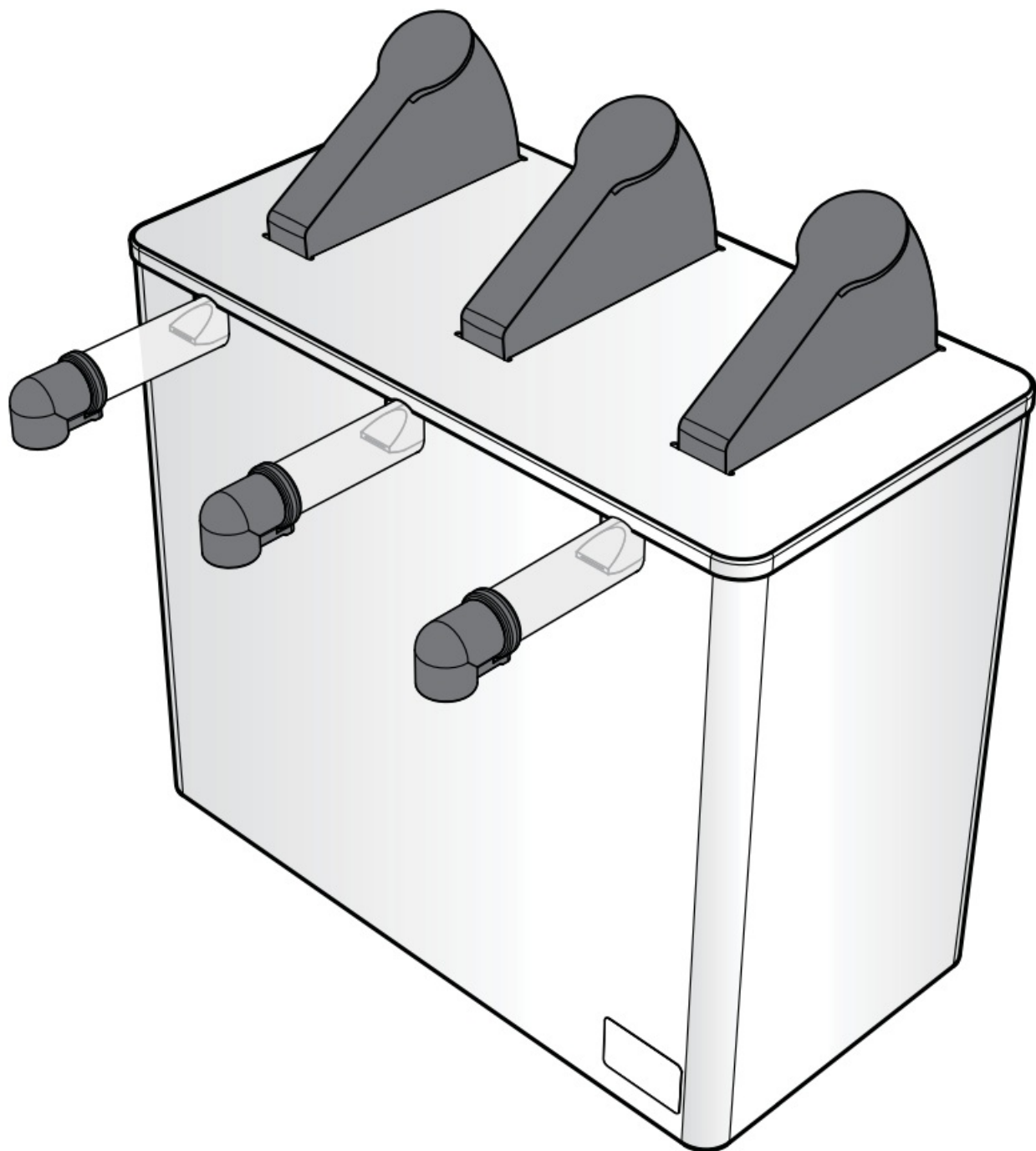

## Contents

- 1 [Server Express™](#)
- 2 [Thank You](#)
- 3 [SERVER EXPRESS™ MODELS](#)
- 4 [PARTS](#)
- 5 [SAFETY](#)
- 6 [DROP-IN UNITS](#)
- 7 [PUMP MODEL 07398](#)
- 8 [PUMP ASSEMBLY](#)
- 9 [SETUP](#)
- 10 [TAKE-DOWN & DISASSEMBLY](#)
- 11 [PORTION CONTROL](#)
- 12 [CLEANING](#)
- 13 [CARE OF STAINLESS STEEL](#)
- 14 [TROUBLESHOOTING](#)
- 15 [SERVER PRODUCTS LIMITED WARRANTY](#)
- 16 [GENERAL SERVICE, REPAIR OR RETURNS](#)
- 17 [NEED HELP?](#)
- 18 [Documents / Resources](#)
  - 18.1 [References](#)
- 19 [Related Posts](#)

## Server Express™

Used with pouches up to 1½ gallons with 16mm fitments.

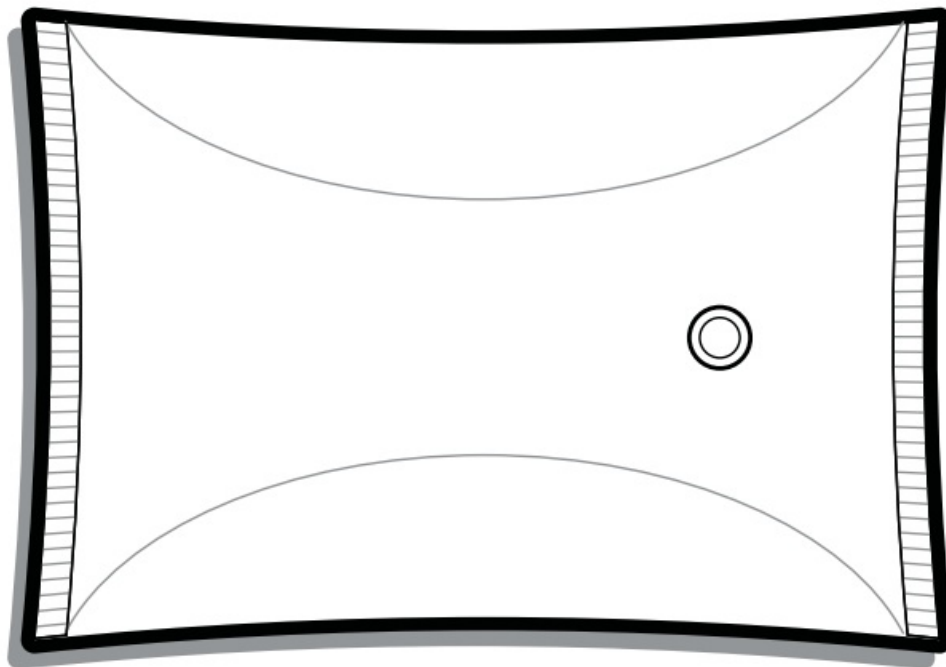

## Thank You

Thank You for purchasing our Server Express™ Pouched Condiment Dispenser. This portion controlled unit is sealed and sanitary, achieves excellent evacuation and has only a few parts for easy clean-up. SIMPLIFY CONDIMENT MANAGEMENT— GO POUCHED

## SERVER EXPRESS™ MODELS

- **SE-3 07124**

Triple

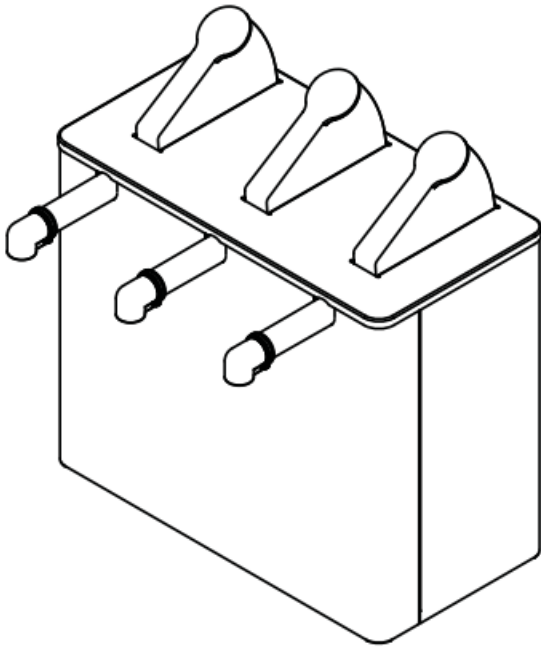

- **SE-4 07180**

Quadruple

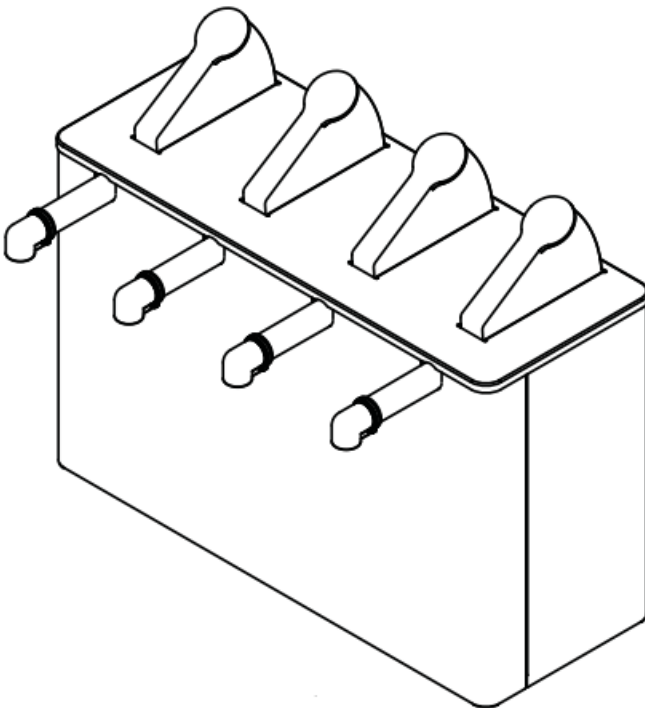

- **SE-5 07122**

Quintuple

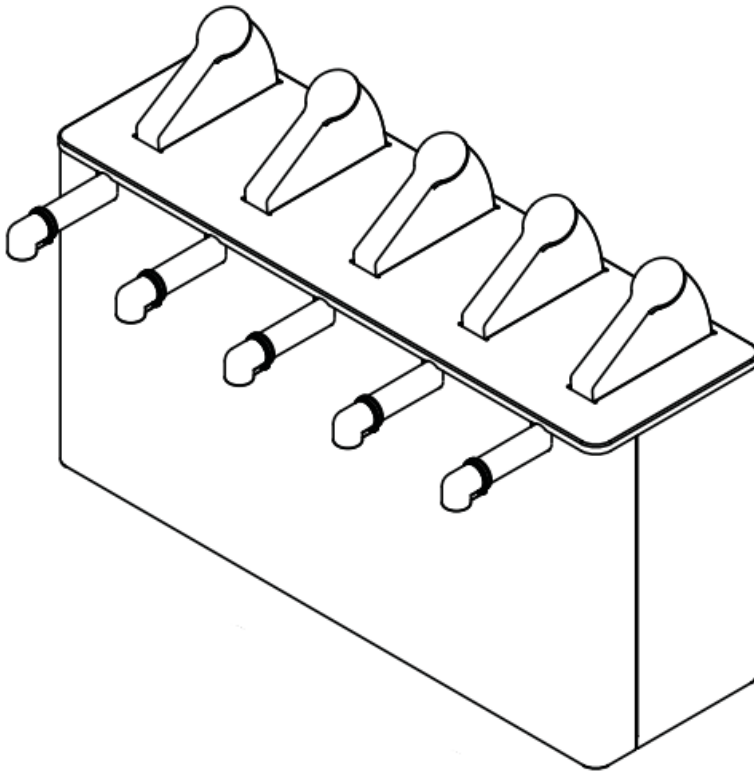

- **SE-3DI 07127**  
Triple Drop-In

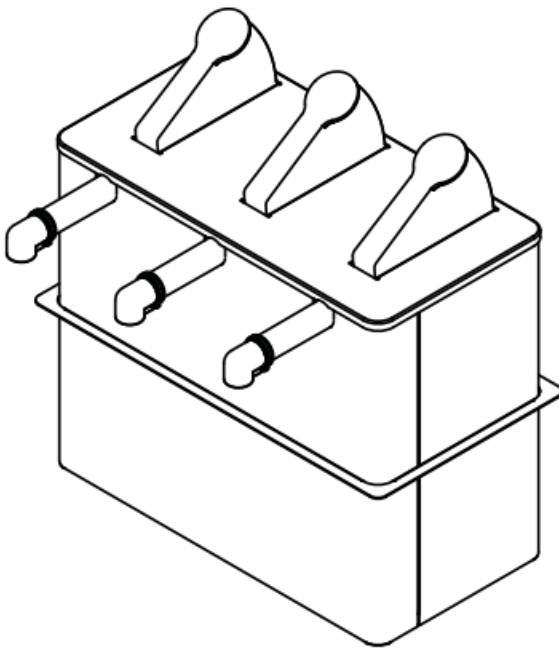

- **SE-4DI 07190**  
Quadruple Drop-In

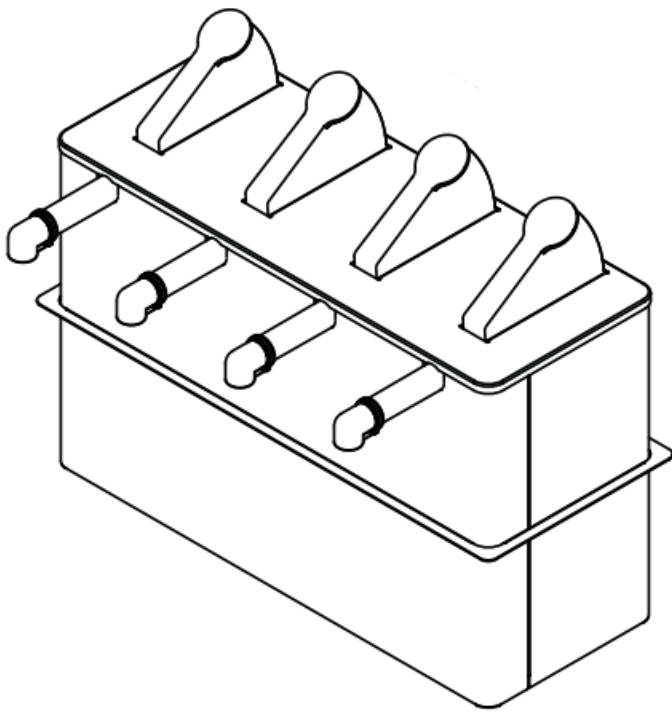

- SE-5DI **07123**  
Quintuple Drop-In

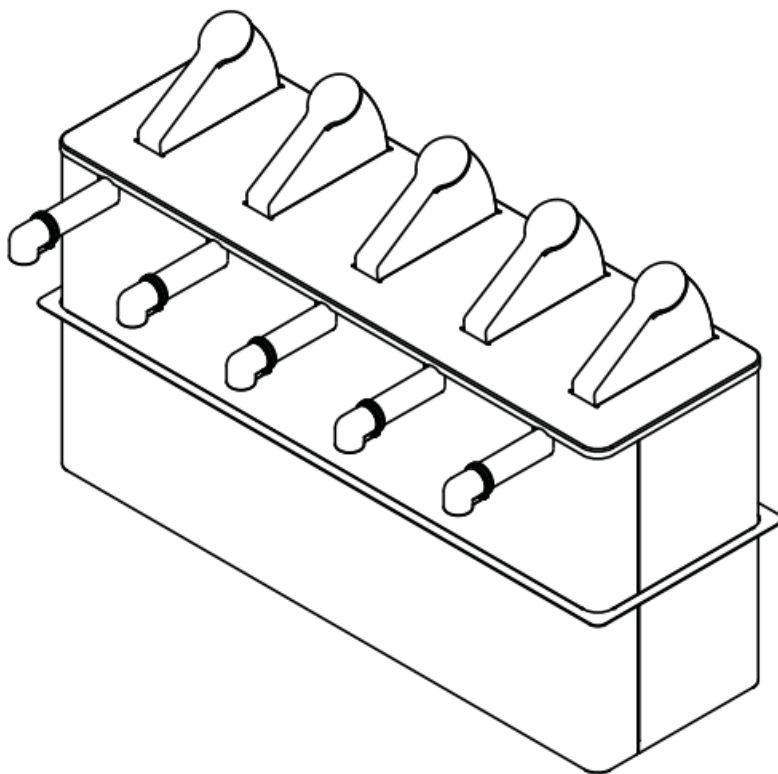

## PARTS

MODEL(S) (ROUNDED CORNERS)	LID	LID ASSEMBLY
07124, 07127	<a href="#">07865</a>	<a href="#">07866</a>
07180, 07190	<a href="#">07843</a>	<a href="#">07867</a>
07122, 07123	<a href="#">07851</a>	<a href="#">07868</a>
<b>OLDER MODELS (LIDS WITH SQUARE CORNERS)</b>		
07124, 07127	<a href="#">07079</a>	<a href="#">07083</a>
07180, 07190	<a href="#">07185</a>	<a href="#">07186</a>
07122, 07123	<a href="#">07104</a>	<a href="#">07105</a>

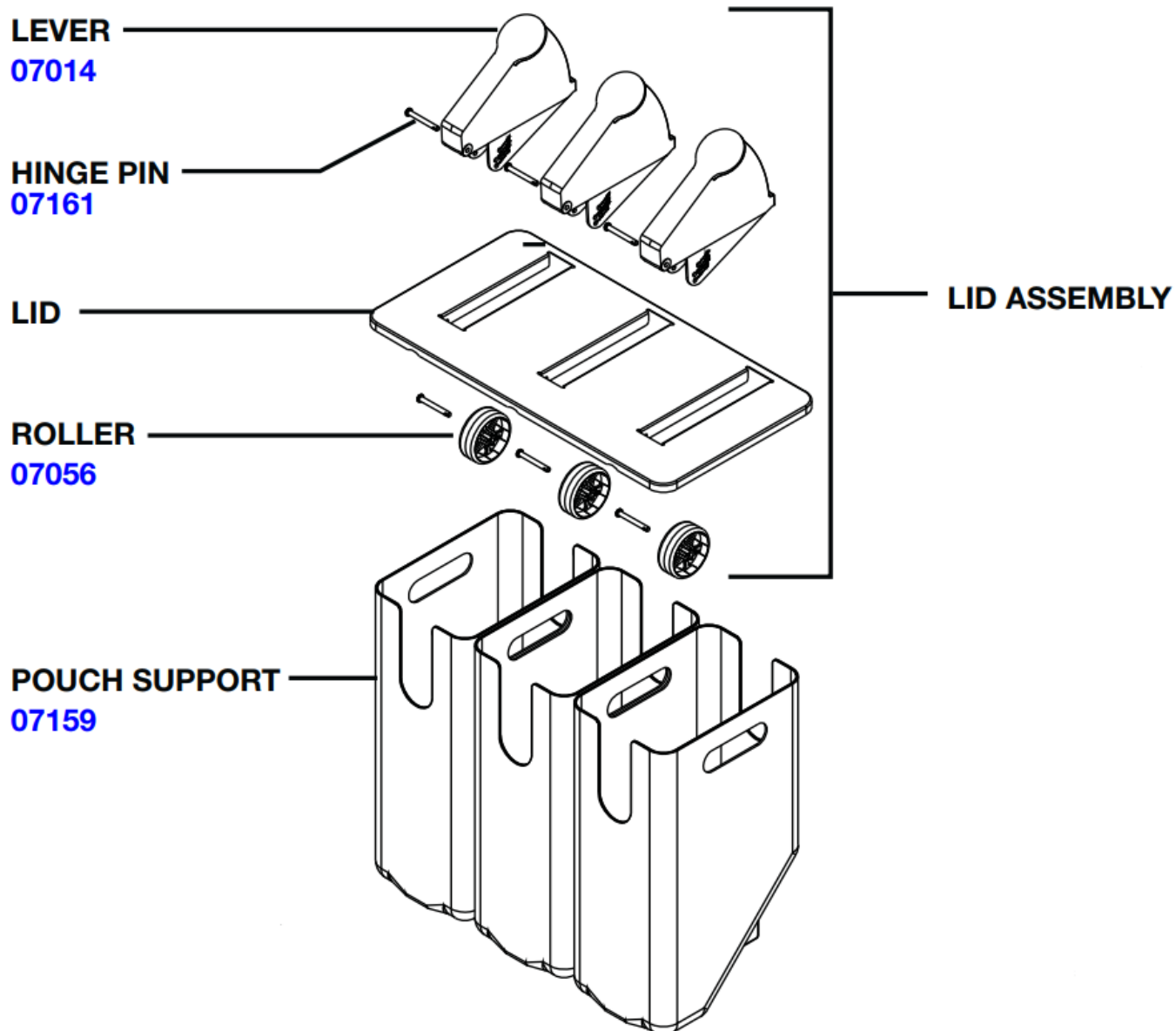

MODEL	REPLACEMENT SHROUD
07124	<a href="#">07863</a>
07127	<a href="#">07864</a>
07180	<a href="#">07848</a>
07190	<a href="#">07849</a>
07122	<a href="#">07856</a>
07123	<a href="#">07857</a>

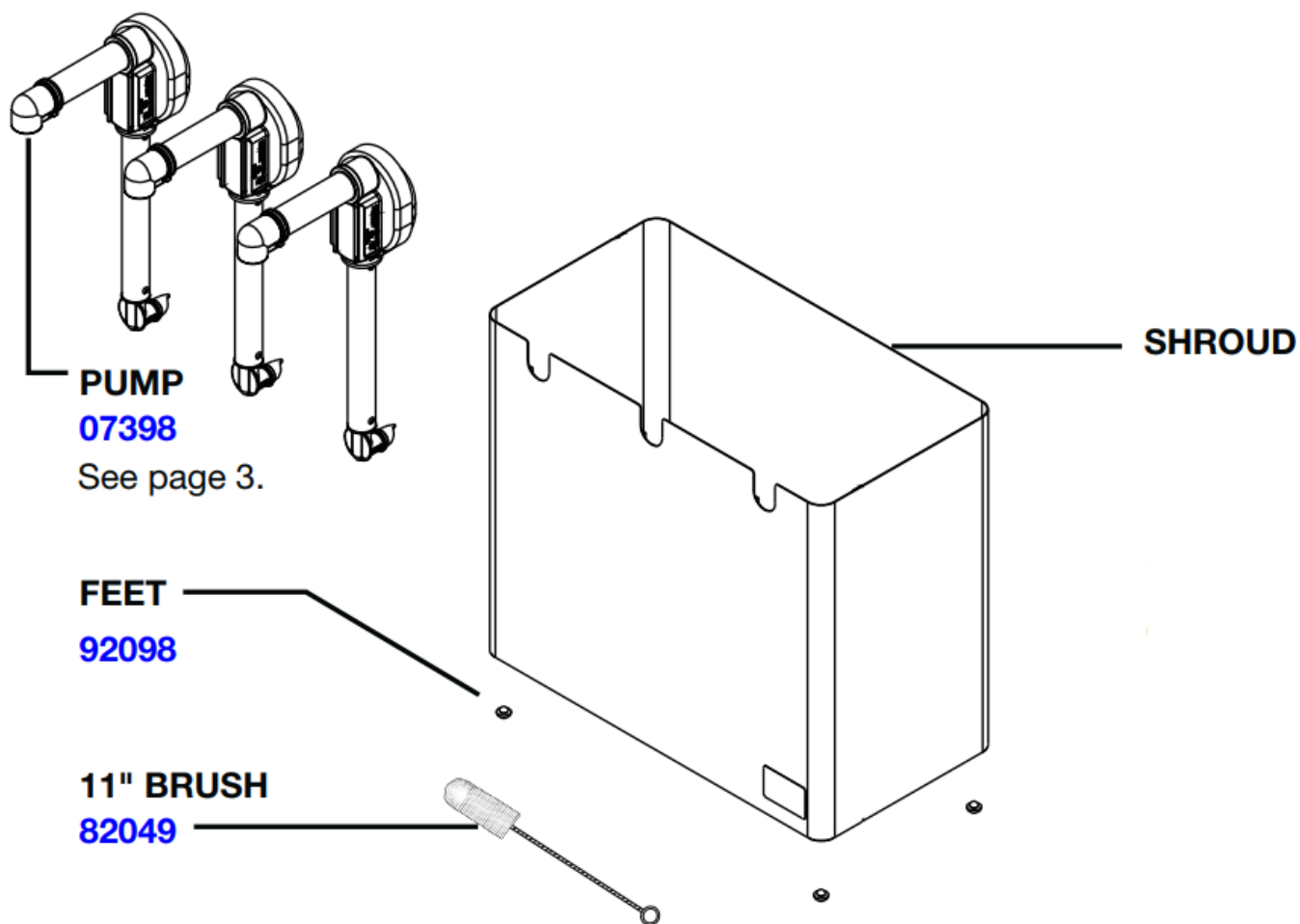

## SAFETY

According to food and safety regulations, most foods must be stored and/or served at certain temperatures or they could become hazardous. Check with local food and safety regulators for specific guidelines. Server Products, Inc. cannot be responsible for the serving of potentially hazardous product.



### IMPORTANT

Clean, rinse, sanitize, and dry parts daily or regularly to comply with local sanitization requirements.





NSF International lists this pump as: “Not acceptable for dispensing potentially hazardous foods.”



**DROP-IN UNITS**

Drop-in units can be used either on a countertop surface or can be dropped into an opening in a countertop.

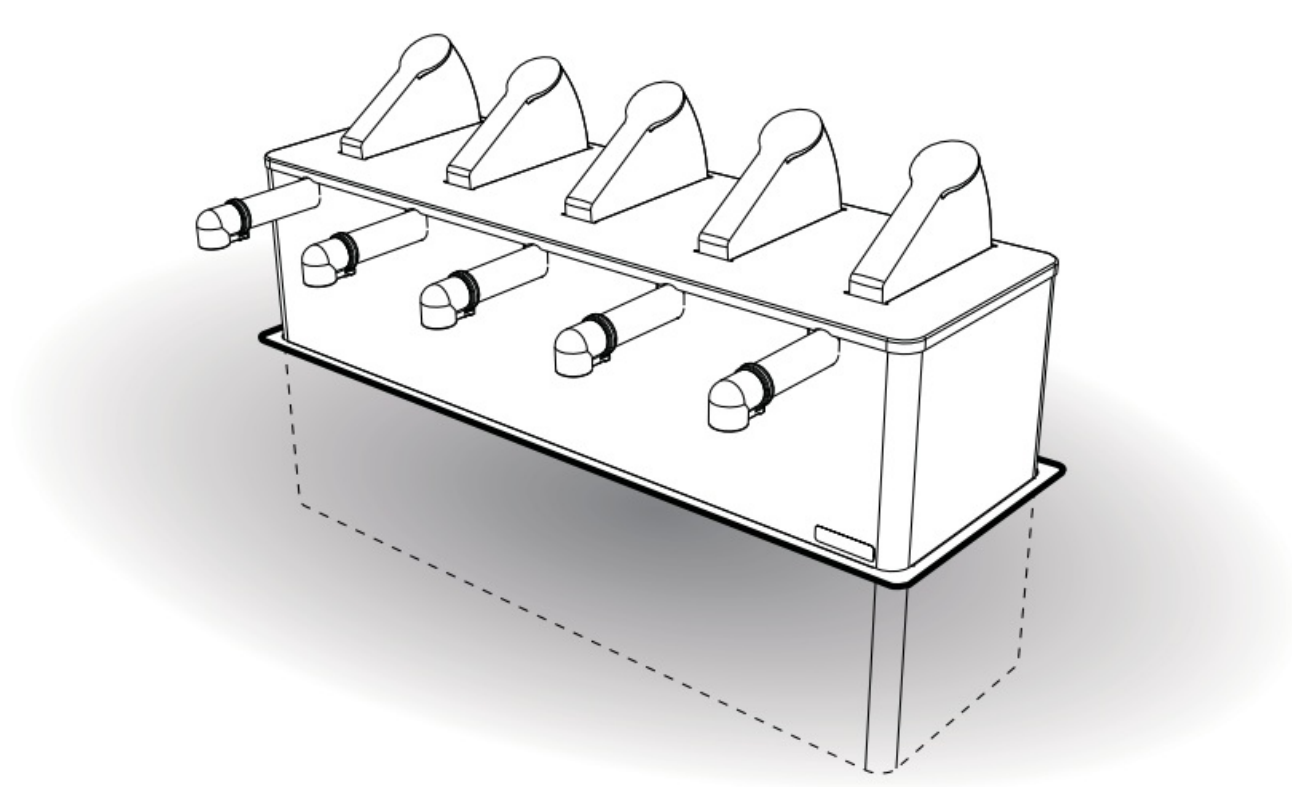

Drop-in units can be used either on a countertop surface or can be dropped into an opening in a countertop.

MODEL NUMBER	RECOMMENDED COUNTERTOP OPENING SIZE
07127 TRIPLE	8 1/2" x 16 3/8"
07190 QUADRUPLE	8 1/2" x 21 13/16"
07123 QUINTUPLE	8 1/2" x 27 3/16"

**PUMP MODEL [07398](#)**

\*Unit includes 2 each spare parts.

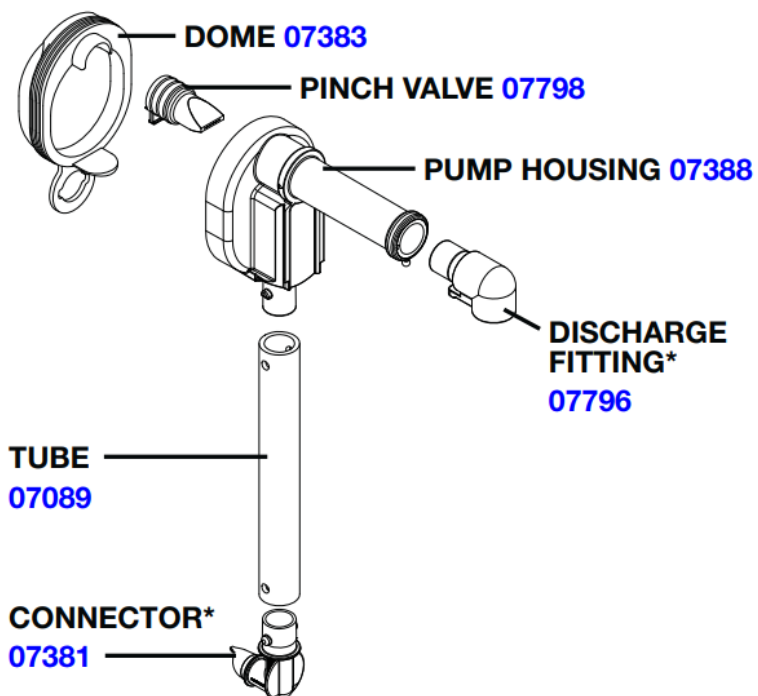
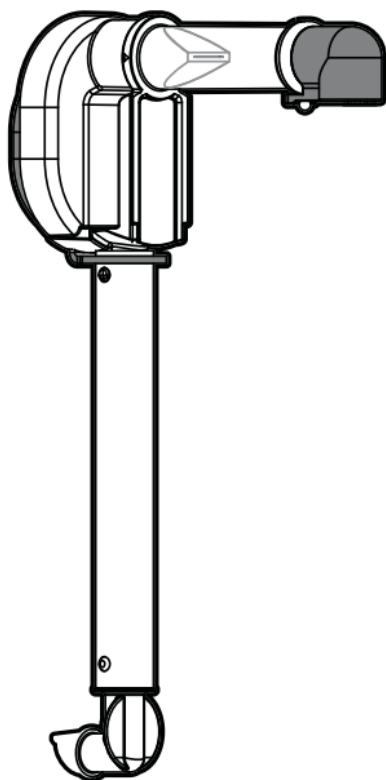

## PUMP ASSEMBLY

WASH ALL PARTS PROPERLY BEFORE USE.

1. **INSERT PINCH VALVE** into pump housing.

**TIP:** Squeeze the pinch valve open before installation to ensure it isn't stuck shut.

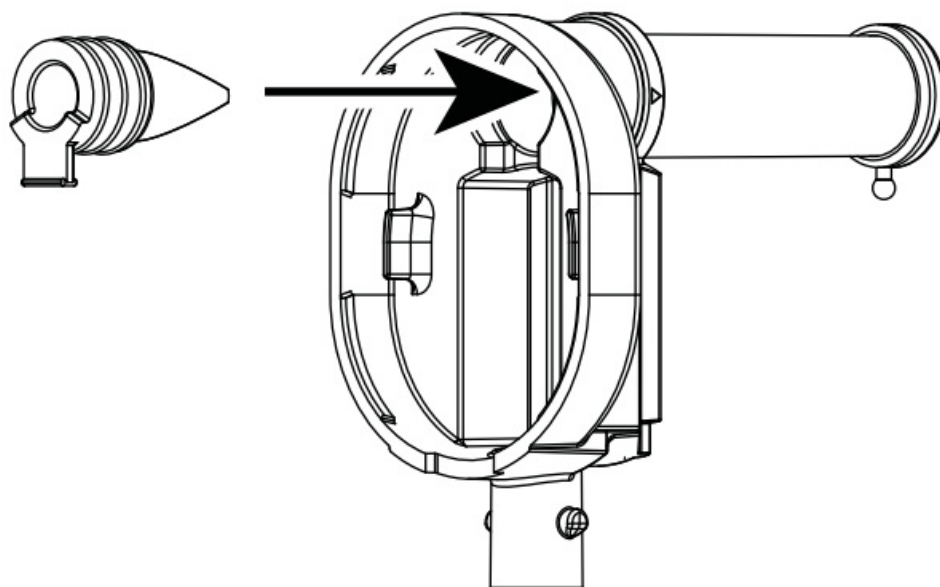

2. **INSTALL DOME**

Press dome into housing fully. Ensure valve flap covers bottom opening.

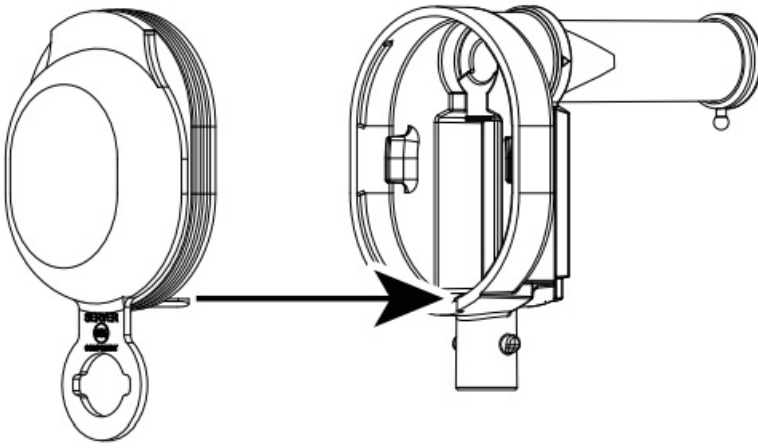

Wrap loop around lower opening to secure dome.

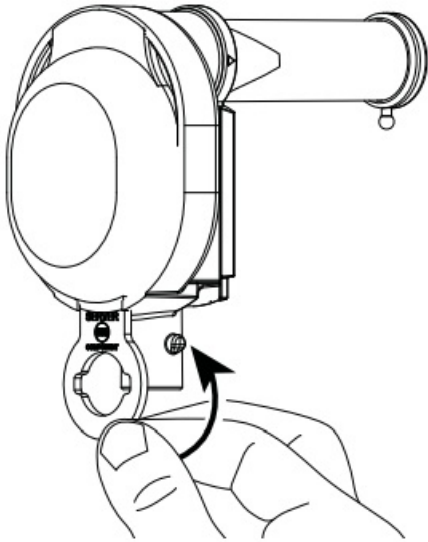

### 3. INSTALL TUBE

Lubricate with a small amount of clean water. Rotate and position until both pegs on housing fit into holes on tube.

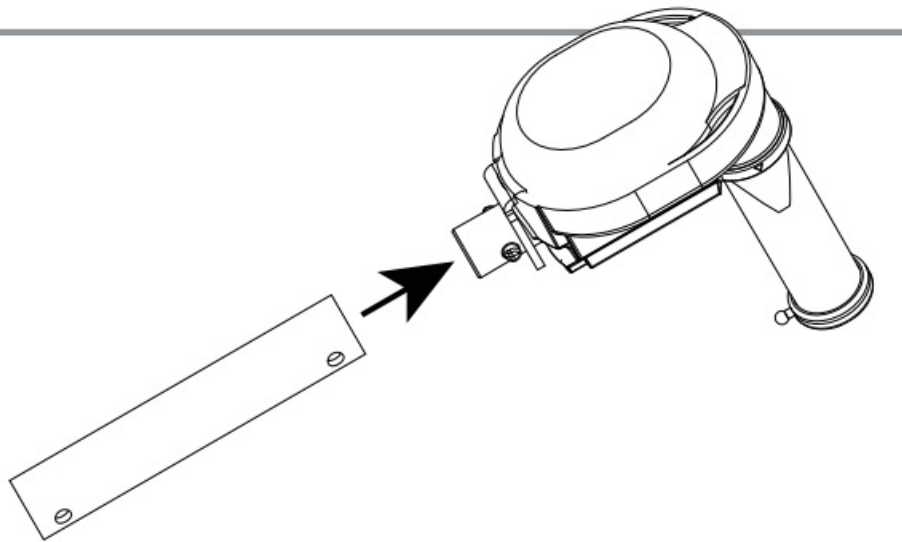

### 4. INSERT CONNECTOR

Lubricate with a small amount of clean water. Rotate and position until both pegs on connector fit into holes on tube. Connector must point away from end of discharge tube.

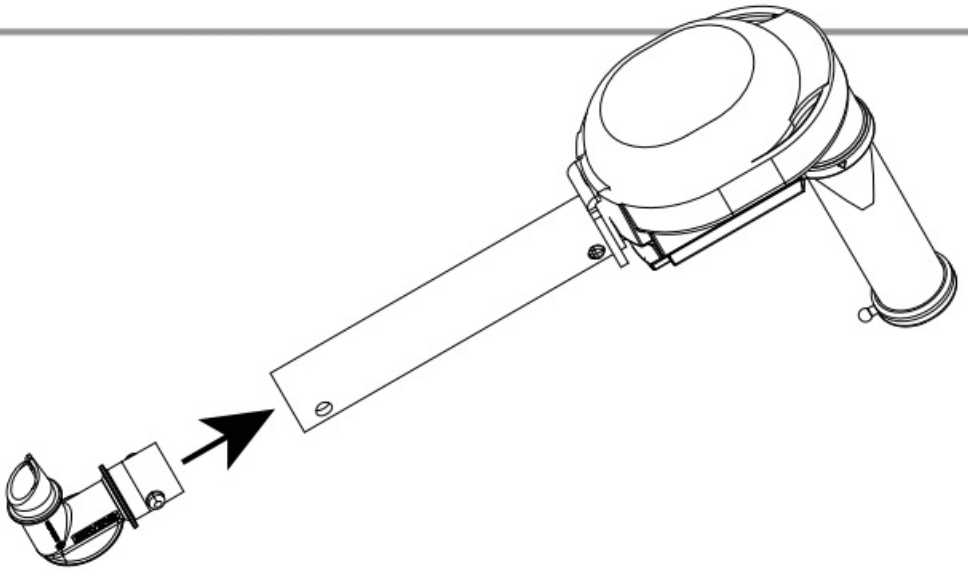

5. **INSERT DISCHARGE FITTING** into pump housing discharge tube. Place loop of fitting around peg on end of discharge tube to secure.

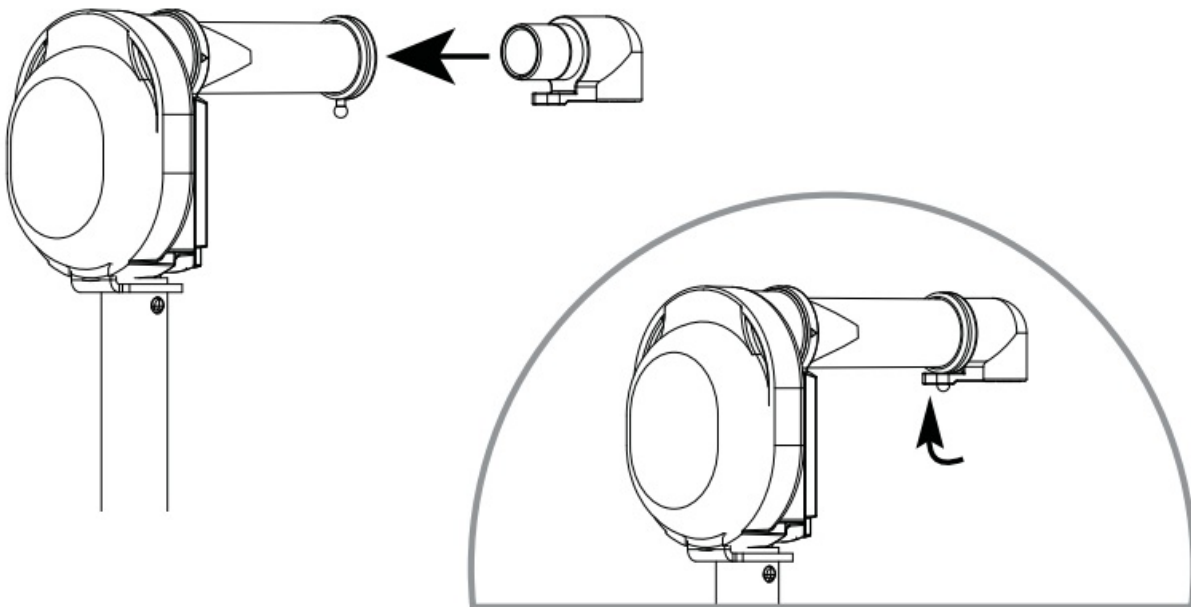

## SETUP

### 1. ATTACH POUCHES TO PUMPS

Firmly press piercing connector into center of pouch fitment. An audible click indicates a secure connection.

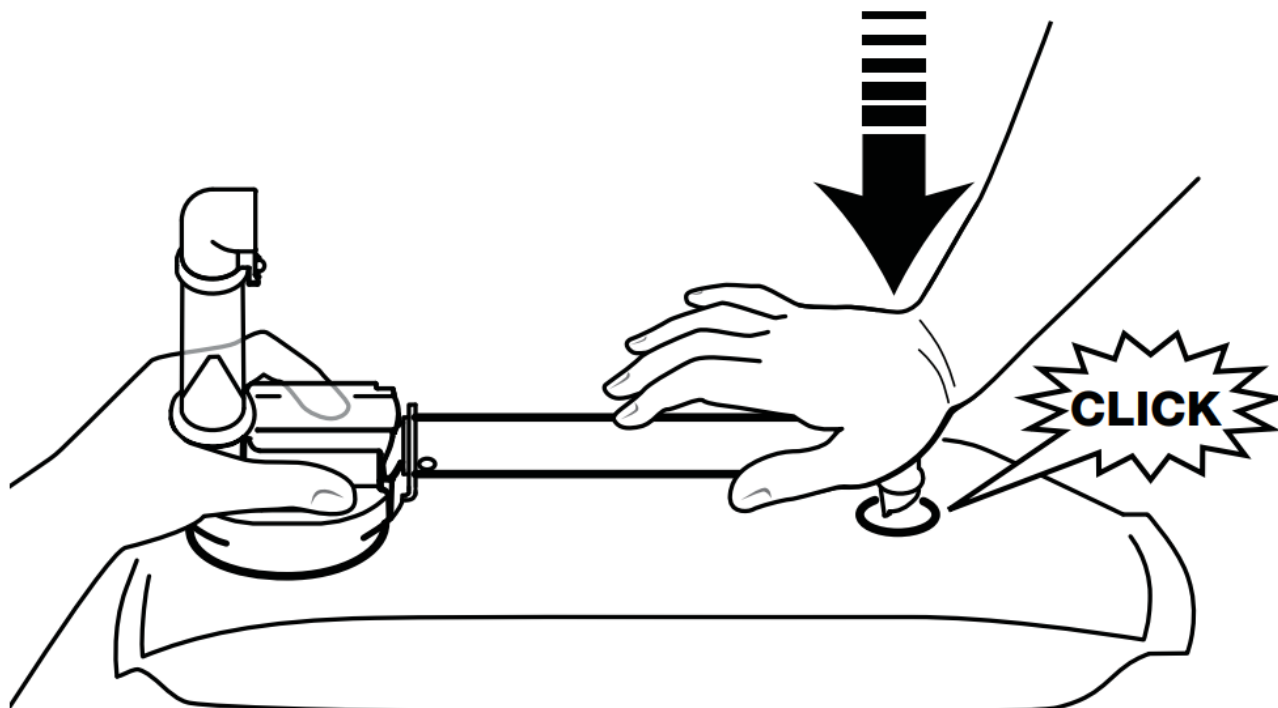

## 2. INSTALL PUMPS

Slide pouch and pump into pouch support within shroud. Align pump guides into slots in shroud.

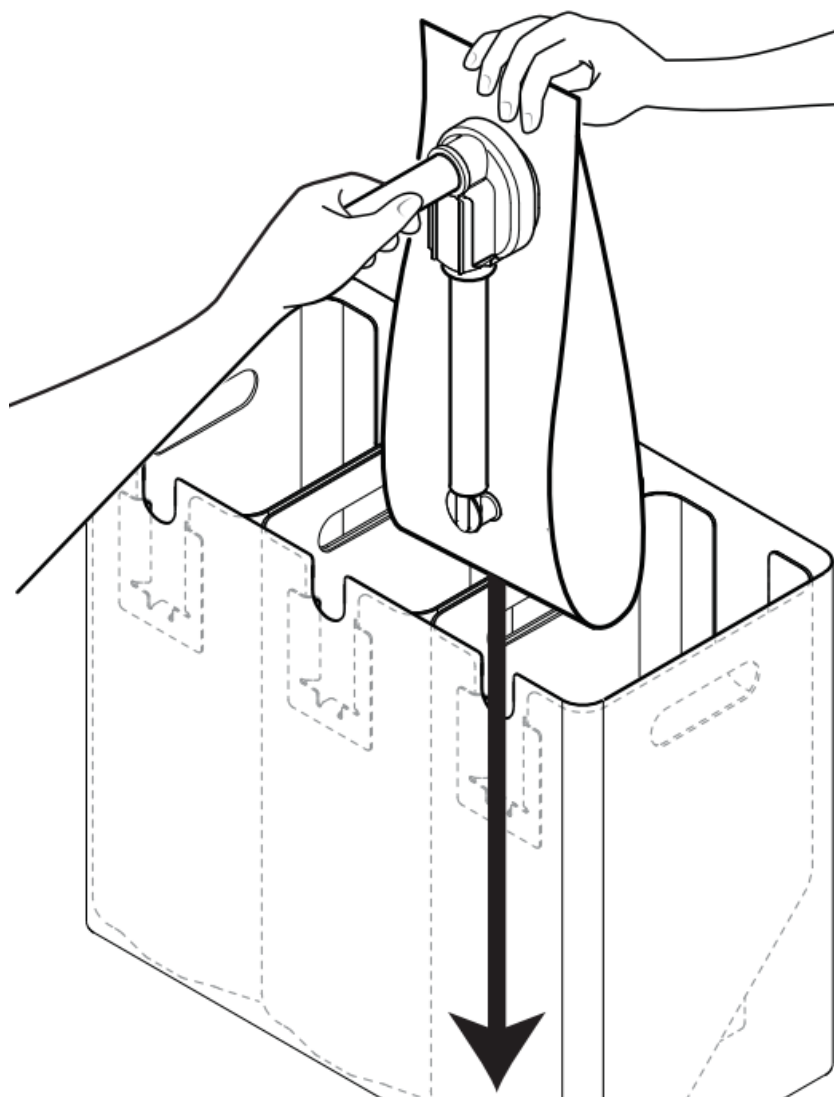

## 3. PLACE LID ON TOP

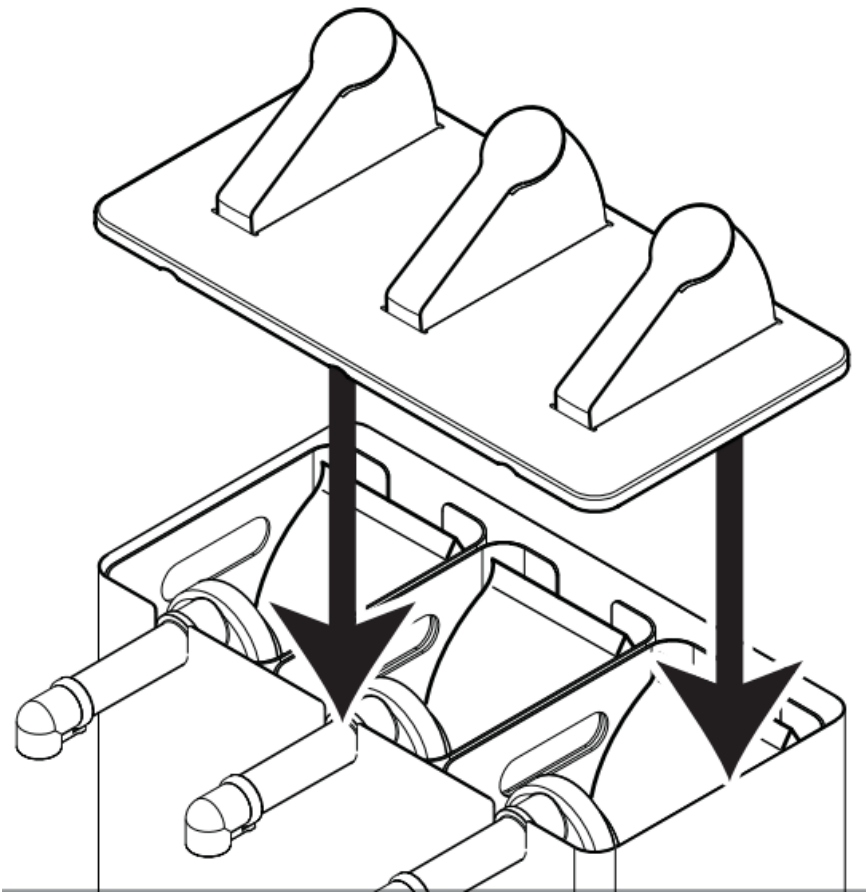

#### 4. PRIME PUMPS

Press lever several times until you see product in discharge tube.

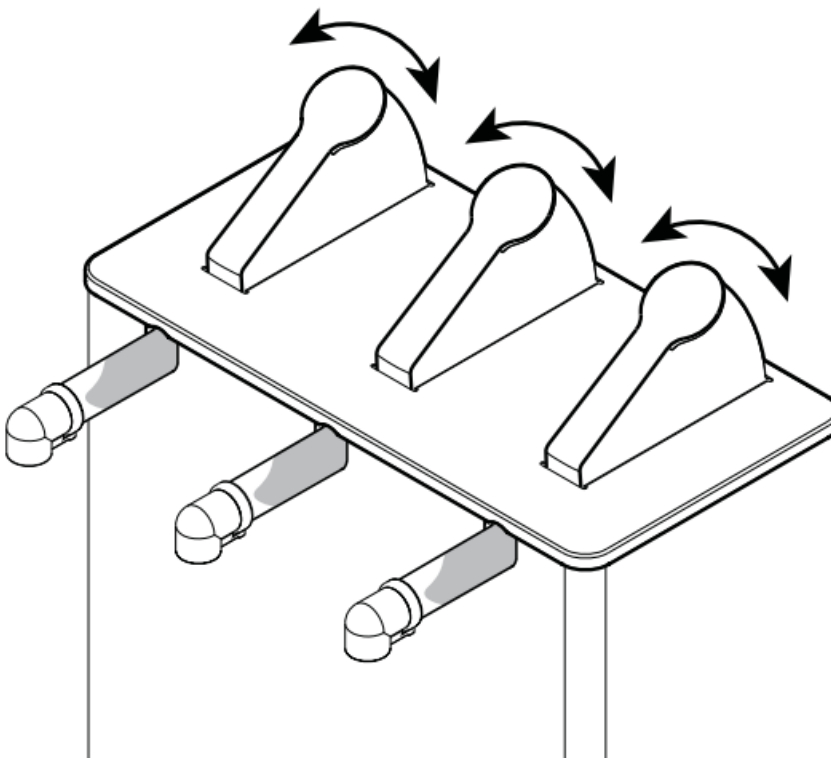

#### TAKE-DOWN & DISASSEMBLY

1. REMOVE LID
2. REMOVE PUMP & POUCH
3. DETACH PUMP FROM POUCH

#### 4. FLUSH & RINSE PUMP

Place lower end of pump into container of hot water. Pump until all remaining product is expelled and only water flows from discharge tube.

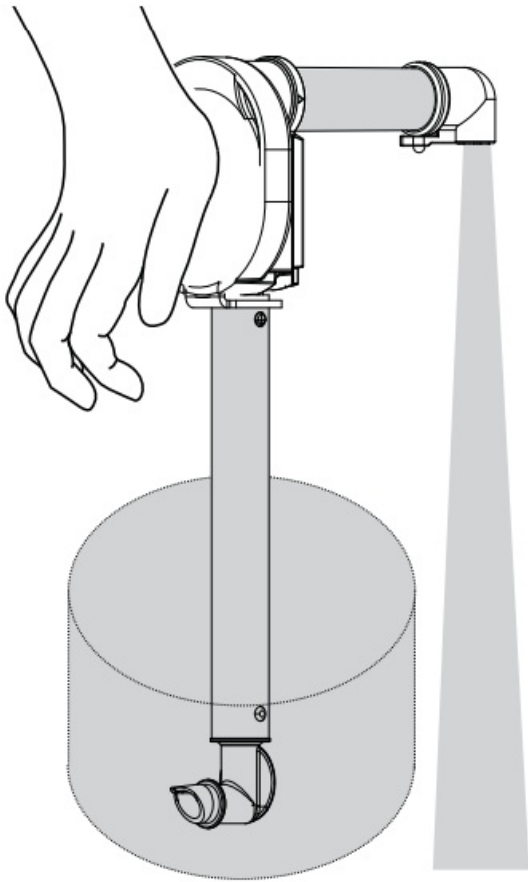

#### 5. DISASSEMBLE

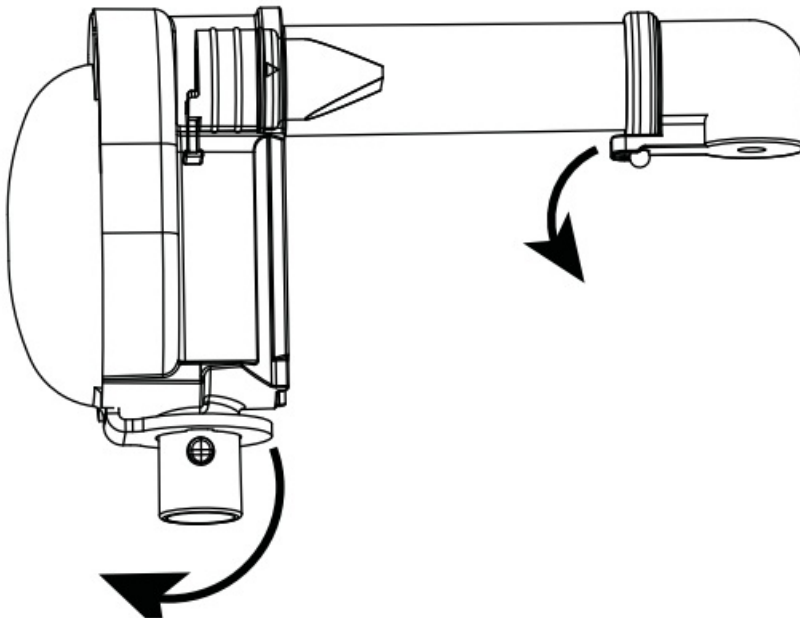

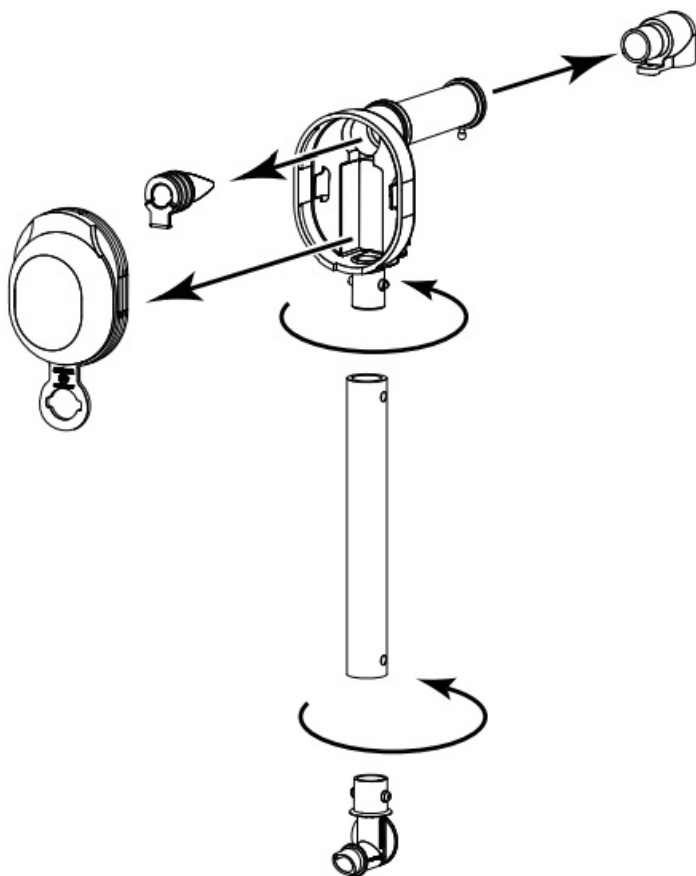

## PORTION CONTROL

**THE LID IS SET TO DELIVER 1 OZ PORTIONS.**

If lid reassembly is needed, or to specify a different portion size:

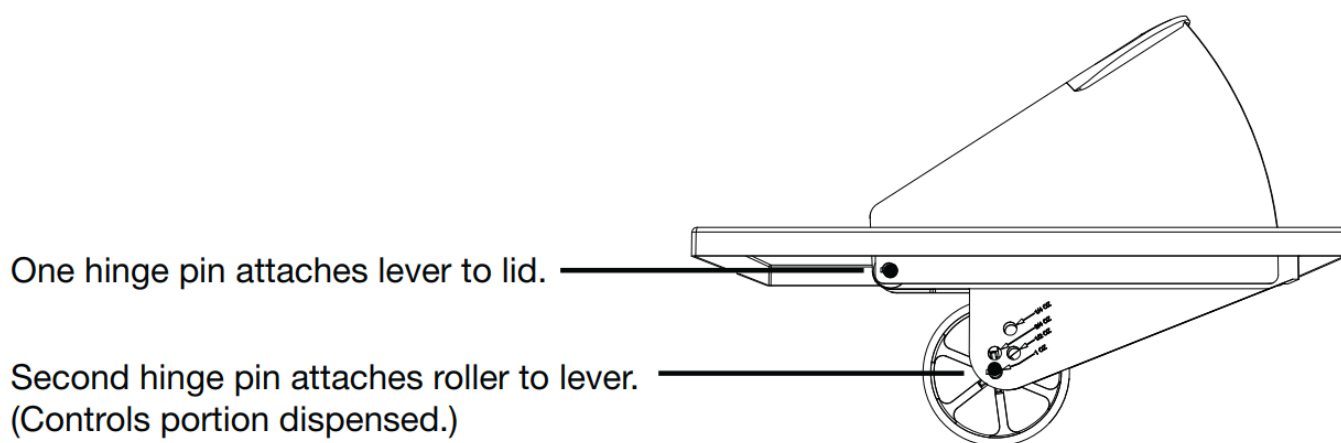

Install hinge pin through center roller hole and desired portion hole on lever. Pin snaps into place.



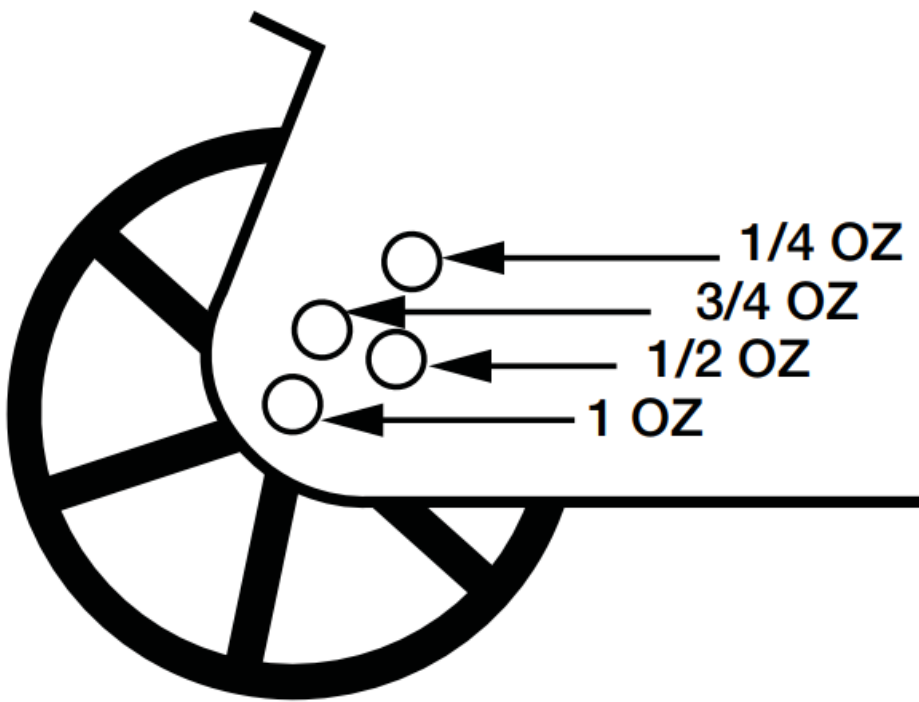
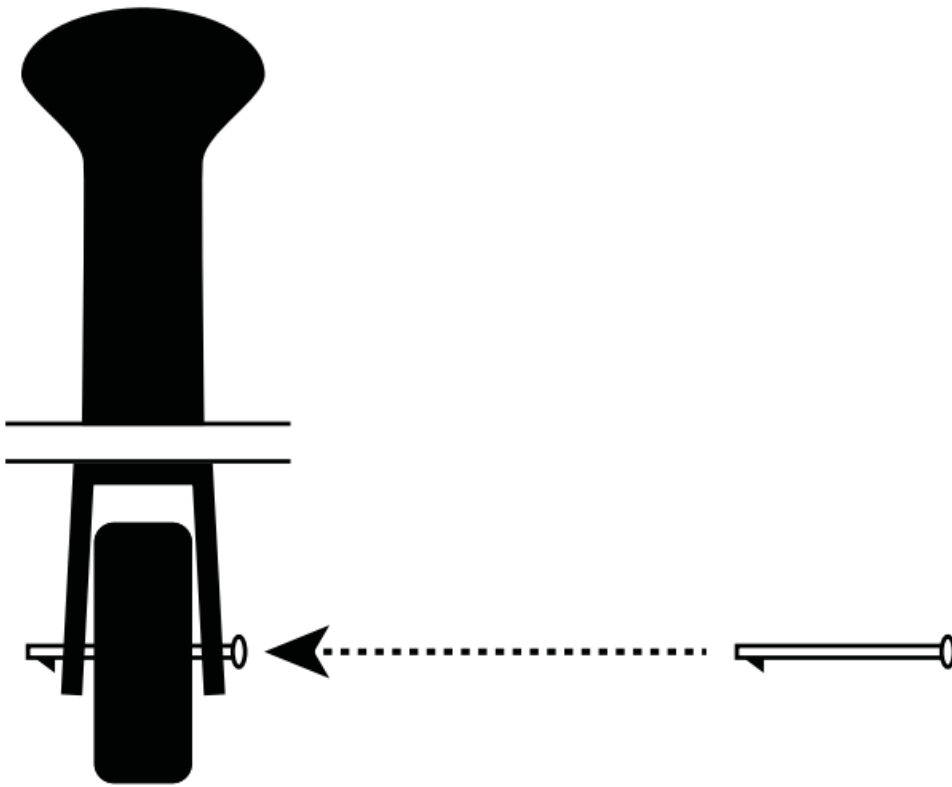

CLEANING



1. **CLEAN** After disassembling, clean all washable parts with soap and hot water.
2. **RINSE** fully with clear water.
3. **SANITIZE** all parts according to local sanitization requirements. All parts in contact with food must be sanitized.
4. **AIR DRY** all parts fully.

**YES!**

Use dishwashing soap and hot water

- External surfaces may be wiped clean with a clean damp cloth.
- Glass and surface cleaners approved for use in food contact areas may be used.
- Do not use abrasive, caustic or ammonia based cleansers.
- Do not use metal scrapers or cleaning pads that could scratch surfaces.

### **Pump cleaning**

- Use nylon brush to clean any confined areas.
- Pump components are dishwasher safe.
- Refer to instruction manual provided with pump.

### **CARE OF STAINLESS STEEL**

This unit is constructed with stainless steel— one of the best materials for food serving and storage.

If you notice corrosion beginning on any stainless steel surface, you may need to change the cleansing agent, sanitizing agent, or the cleaning procedures you are using.

- A mildly abrasive nylon or brass brush may be used to remove any stubborn food or mineral deposits on interior surfaces of unit.
- Fully rinsing and drying all parts can help prevent corrosion. Elements and minerals in tap water can accumulate on stainless steel parts and create corrosion.
- Do not use products containing acids, alkalines, chlorine, or salt. These agents can corrode stainless steel.

## TROUBLESHOOTING

### DIFFICULT TO ATTACH PARTS?

- Wet parts with clean water to help fit.

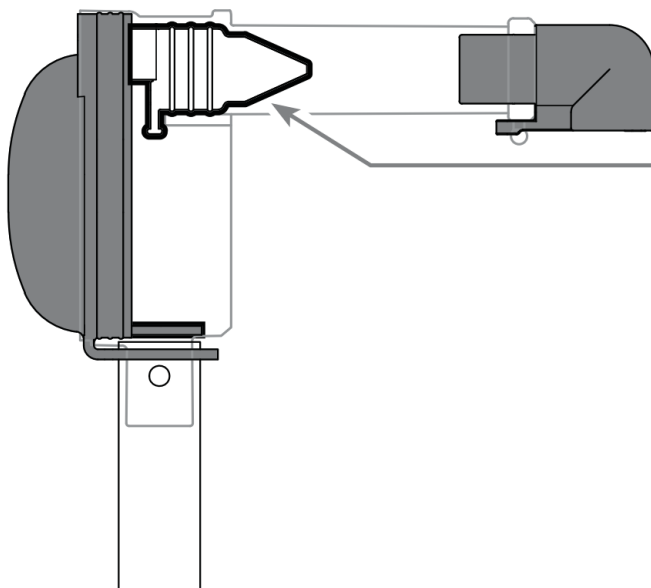

### PRODUCT DOESN'T PUMP?

- Ensure pinch valve is inserted in housing.
- Ensure connector is snapped fully in place to fitment in pouch.
- Ensure pump is properly attached to pouch.
- Clean pump thoroughly.
- Ensure pump is properly installed into retaining slots inside front wall of shroud.

**TIP:** Squeeze the pinch valve open before installation to ensure it isn't stuck shut.

### DOMES POPS OFF?

- Clean thoroughly. Food residue could prevent a tight seal between dome and housing.
- Ensure dome edges are flush with housing.

## SERVER PRODUCTS LIMITED WARRANTY

**2** YEAR  
WARRANTY

Server Products equipment is backed by a two-year limited warranty against defects in materials and workmanship.

For complete warranty information go to: [www.Server-Products.com](http://www.Server-Products.com)

## GENERAL SERVICE, REPAIR OR RETURNS

Before sending any item to Server Products for service, repair, or return, contact Server Products customer service to request a Return Authorization Number. Merchandise must be sent to Server Products with this number. Service is extremely prompt. Typically, units are repaired and ship out within 48 hours of receipt.

Merchandise being returned for credit must be in new and unused condition and not more than 90 days old and will be subject to a 20% restocking charge.

## NEED HELP?

### Server Products Inc.

3601 Pleasant Hill Road  
Richfield, WI 53076 USA



262.628.5600 | 800.558.8722



[SPSALES@SERVER-PRODUCTS.COM](mailto:SPSALES@SERVER-PRODUCTS.COM)

Please be prepared with your Model, Part, Series Number and Description. This information is located on the lid and/or base of the unit. Individual Part Numbers listed on pages 2 and 3. For part information on older models, or for other questions, please contact Server Products customer service department.

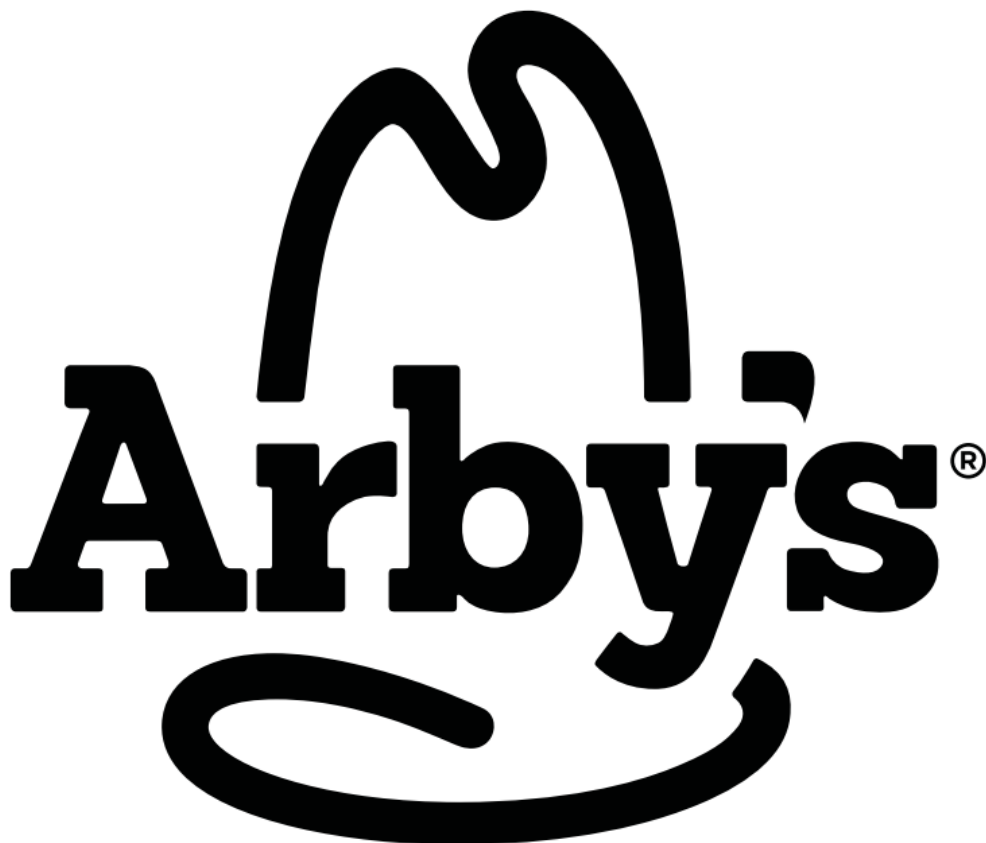



# SERVER

---

## Documents / Resources

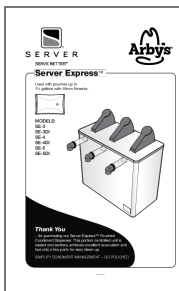

[SERVER SE-3 Server Express Pouched Condiment Dispenser](#) [pdf] Owner's Manual  
SE-3 Server Express Pouched Condiment Dispenser, SE-3, Server Express Pouched Condiment Dispenser, Express Pouched Condiment Dispenser, Pouched Condiment Dispenser, Condiment Dispenser, Dispenser

## References

- [products.com](#)
- [Server Products](#)
- [Manual-Hub.com - Free PDF manuals!](#)
- [User Manual](#)

[Manuals+](#), [Privacy Policy](#)

This website is an independent publication and is neither affiliated with nor endorsed by any of the trademark owners. The "Bluetooth®" word mark and logos are registered trademarks owned by Bluetooth SIG, Inc. The "Wi-Fi®" word mark and logos are registered trademarks owned by the Wi-Fi Alliance. Any use of these marks on this website does not imply any affiliation with or endorsement.