



SERVER CW-DI ConserveWell Drop In Unit with Timer Instruction Manual

[Home](#) » [SERVER](#) » SERVER CW-DI ConserveWell Drop In Unit with Timer Instruction Manual 

Contents

- 1 SERVER CW-DI ConserveWell Drop-In Unit with Timer
- 2 OPTIONAL
- 3 ATTACH 3 LOCATION BLOCKS
- 4 INSERT UNIT
- 5 INSERT WATER PAN
- 6 WHEN COUNTDOWN TIMER ENDS
- 7 RESETTING COUNTDOWN TIMER
- 8 UNIT TAKE-DOWN
- 9 SAFETY
- 10 CLEANING
- 11 CARE OF STAINLESS STEEL
- 12 WIRING DIAGRAM
- 13 TROUBLESHOOTING
- 14 CONSERVEWELL® DROP-IN
- 15 Documents / Resources
 - 15.1 References
- 16 Related Posts



SERVER CW-DI ConserveWell Drop-In Unit with Timer



SELECT COUNTERTOP HOLE

for unit to drop into.

Consider best placement for ease of use. 6" of clearance needed below countertop. Ensure cord can reach power source.

EXISTING HOLE

Unit fits within countertop hole cutout diameters 5.5"—6.5"

TIP: Unit is factory assembled to fit 6" diameter hole. Skip steps 2 & 3 if countertop hole is 6" wide.



OPTIONAL

ADD ANTI-ROTATIONAL FOOT

to prevent unit pivoting within countertop hole.

1. REMOVE OUTER SCREW
from cord guard.
2. INSERT ANTI-ROTATIONAL FOOT

in place of removed screw.

3. DRILL FOOT HOLE IN COUNTERTOP

Refer to cutout template for details.

Drill 3/4" diameter hole in countertop.

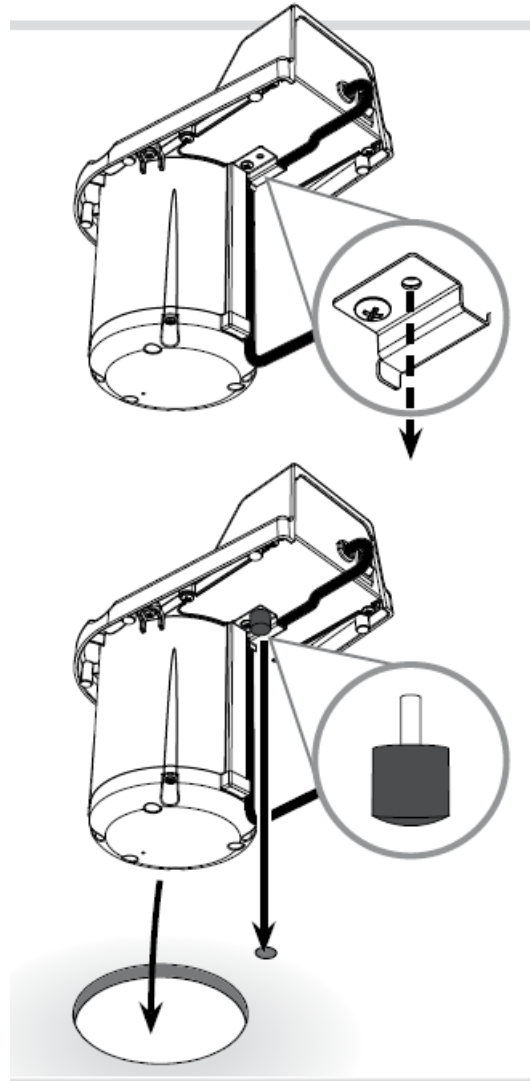

5.75" —6.5" diameter countertop holes:

Locate foot hole center 3.75"

from large countertop hole center.

5.5" up to 5.75" diameter countertop hole:

Locate foot hole center 3.5"

from large countertop hole center.

UNIT & ANTI-ROTATIONAL FOOT WILL FIT INTO CORRESPONDING COUNTERTOP HOLES.

SELECT LOCATION BLOCK HARDWARE

to create proper fit within countertop hole.

Hole diameter determines which 3 location blocks to use.

If size is between two listed dimensions, refer to smaller diameter.

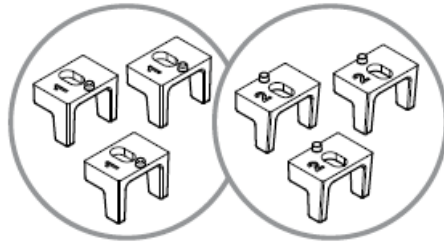

ATTACH 3 LOCATION BLOCKS

to underside of rim.

Place each location block peg into slot in underside of rim.

Slide location blocks either away from or towards base.

Refer to chart below.

LOCATION BLOCKS

- No location blocks needed
5.5"
- BLUE, embossed with "1"
5.75"
- BLUE, embossed with "1"
6"
- RED, embossed with "2"
6.25"
- RED, embossed with "2"
6.5"

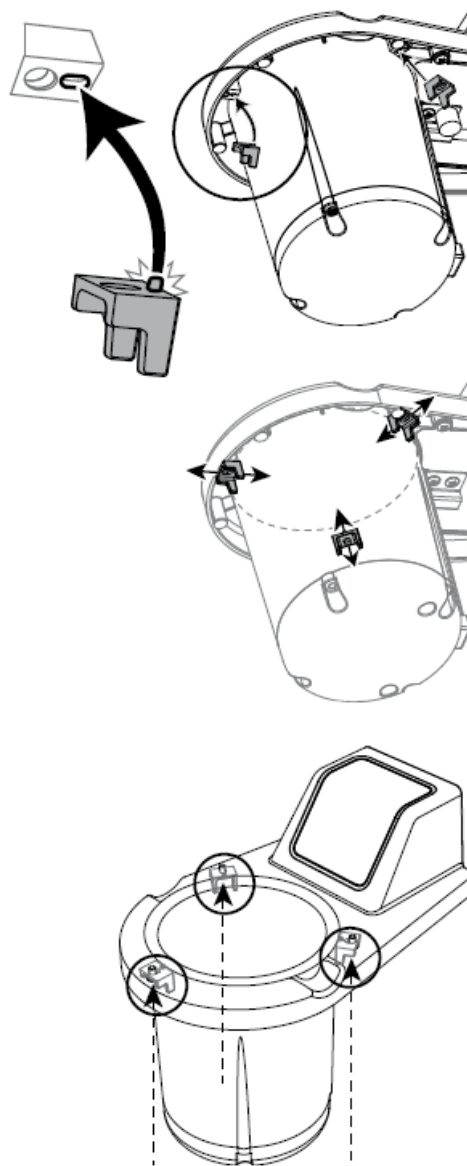

LOCATION BLOCK FITTING

- Remove all location blocks
5.5"
- BLUE, slide towards base
5.75"
- BLUE, slide away from base
6"
- RED, slide towards base
6.25"
- RED, slide away from base
6.5"

Screw in each location block using 1 screw and Phillips-head screwdriver.

INSERT UNIT

and cord into countertop hole. Refer to CORD GUARD instructions below.

Secure excess cord to prevent accidental damage.

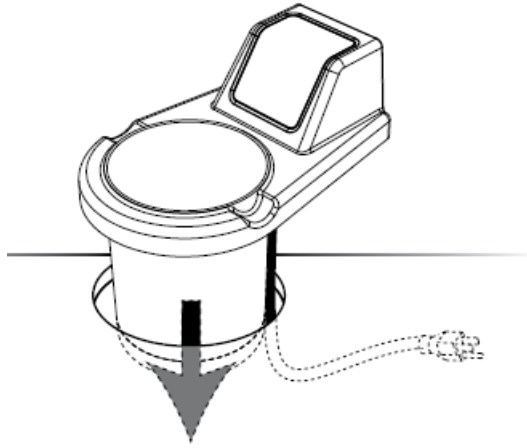

CORD GUARD

CAUTION- PREVENT CORD DAMAGE

Secure cord within cord guard when plug is used below counter.

USE CORD GUARD WHEN CORD IS PLUGGED IN BELOW COUNTERTOP

Affix cord guard using 2 screws and Phillips-head screwdriver.

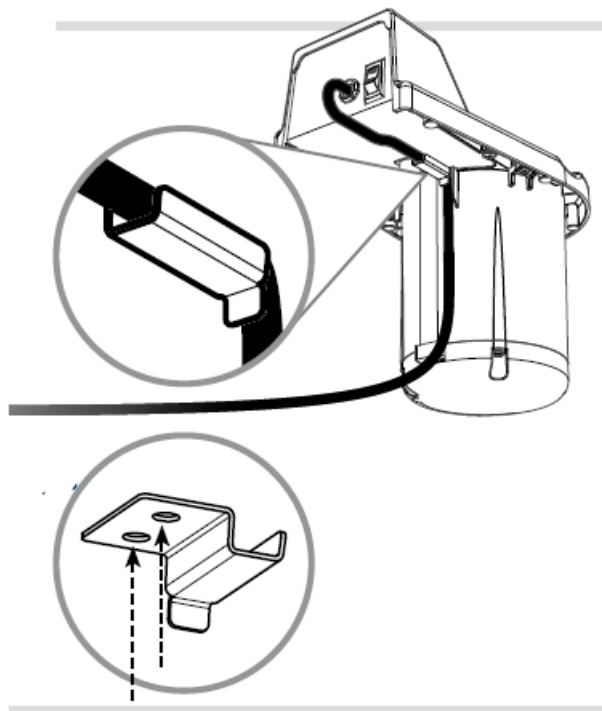

DO NOT USE CORD GUARD WHEN CORD IS PLUGGED IN ABOVE COUNTERTOP

1. DETACH CORD GUARD

Use Phillips-head screwdriver to remove both screws.

2. RELEASE CORD

3. REATTACH CORD GUARD

with both screws.

Secure onto unit in case of future need.

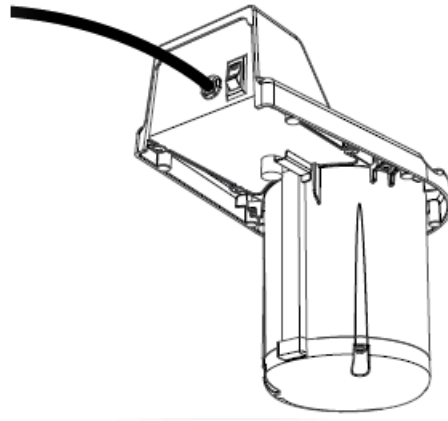

INSERT WATER PAN

- Insert green pan liner into bottom of pan.
- Fill 28 oz. of HOT water up to fill-line in pan.
Refer to water temperature charts below.
- Insert pan of water into basin.

Pour water into pan only.

DO NOT OVERFILL

Water above fill-line in pan may cause unsafe handling temperatures.

BE AWARE OF THE WATER TEMPERATURE

Help prevent bacteria growth. The FDA warns that bacteria grow most rapidly in the range of temperatures between 40°F—140°F. (4°C—60°C.)

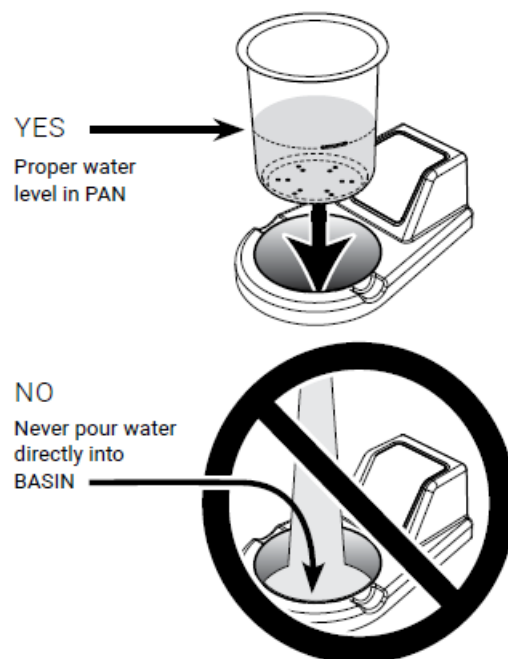

WATER HEATING TIMES

(When unit is not pre-heated)

INITIAL WATER TEMP. 70°F	TARGET TEMPERATURE	
	140°F	145°F
	45 min.	50 min.
110°F	30 min.	40 min.
120°F	20 min.	30 min.
130°F	20 min.	25 min.

WATER HEATING TIMES

(In pre-heated unit)

INITIAL WATER TEMP. 70°F	TARGET TEMPERATURE	
	140°F	145°F
	35 min.	40 min.
110°F	20 min.	25 min.
120°F	10 min.	15 min.
130°F	5 min.	10 min.

1. PLUG CORD INTO POWER SOURCE
2. TURN UNIT ONP
ress switch at back of unit.
3. PRESS RESET TO START
countdown cycle.
The timer is programmed for 2 hour cycles.

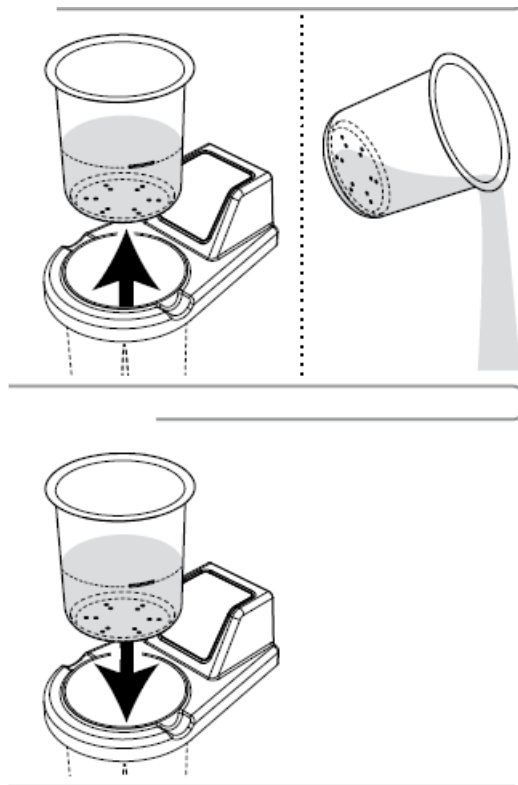

ONLY USE WITH UTENSILS SAFE IN HIGH TEMPERATURES

CAUTION- BURNS MAY RESULT

Do not use liquid or gel-filled utensils. Handles become extremely hot.

WHEN COUNTDOWN TIMER ENDS

The alarm will beep.

The display will indicate "END"

PRESS RESET TO STOP ALARM

- **CAUTION- HOT**

Unit, pan and water will be hot.

Take proper care while removing pan. Carefully pour water down a drain. Keep the pan liner inside pan.

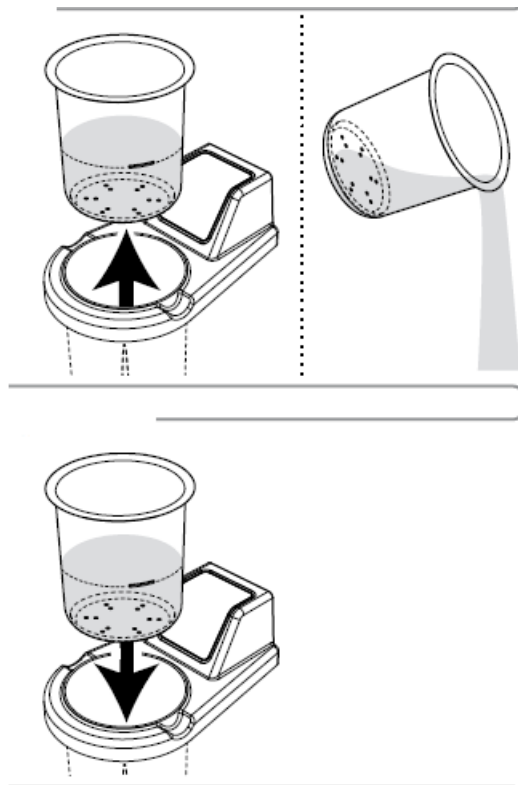

REFILL & RETURN WATER PAN TO BASIN

- Fill 28 oz. of new HOT water up to fill-line in pan.
- Insert pan of water into basin.
- Never pour water directly into basin of unit.
- Pour water into pan only.

PRESS RESET BUTTON

to restart the countdown cycle.

RESETTING COUNTDOWN TIMER

To replace water before countdown cycle completes:

- PRESS RESET BUTTON
to stop the timer.
- CHANGE OUT WATER
(See steps 2 & 3 above.)
- PRESS RESET BUTTON
again to restart timer cycle.

UNIT TAKE-DOWN

1. CAUTION- HOT
Allow unit to cool first or take proper care with hot surfaces.
2. PRESS SWITCH TO OFF
3. UNPLUG CORD

4. REMOVE PAN FROM BASIN

Pour water down a drain. Clean pan and pan liner (See page 9.)

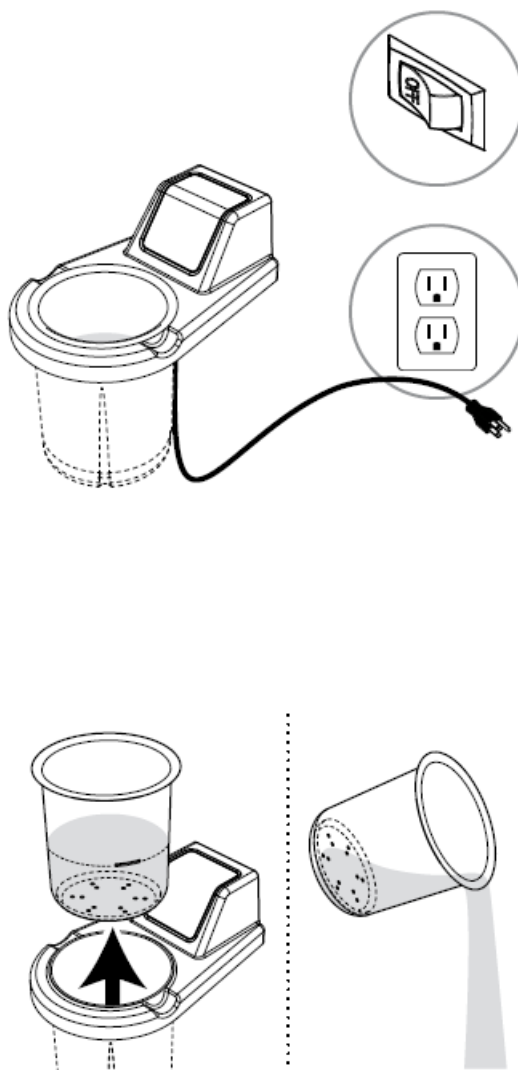

SAFETY

WARNING

ELECTRICAL SHOCK COULD OCCUR This unit must be earthed or grounded. This requires all three prongs (terminals) on cord plug to be plugged into power source.

IMPORTANT TO KNOW

Certain ice cream scoops and spades contain heat-conductive fluid inside handles.

CAUTION-BURNS MAY RESULT

Do not use liquid or gel-filled utensils.

Handles become extremely hot.

Only use ConserveWell™ with utensils safe at high temperatures.

BE AWARE OF THE WATER TEMPERATURE

Help prevent bacteria growth. The FDA warns that bacteria grow most rapidly in the range of temperatures between 40°F—140°F. (4°C—60°C.)

CLEANING

WARNING- ELECTRICAL SHOCK COULD OCCUR

- Electrical components of unit could be damaged from water exposure or any liquid.
- Never immerse unit into water or any liquid.
- Never use any water jet or pressure sprayer on unit.
- Ensure unit is “OFF” and unplugged.

CAUTION- HOT

Allow unit to cool before cleaning.

CLEAN THE PAN & PAN LINER

1. CLEAN

Wash water pan and pan liner with soap and hot water.

2. RINSE

fully with clear water.

3. SANITIZE

all parts according to local sanitization requirements. All parts in contact with food must be sanitized.

4. DRY

pan fully with a clean soft cloth. Air dry pan liner fully.

5. CLEAN EXTERNAL SURFACES

- Wipe daily with a clean damp cloth.
- Dry with a clean soft cloth.
- Glass and surface cleaners approved for use in food contact areas may be used.]

CARE OF STAINLESS STEEL

The water pan is constructed of stainless steel.

If you notice corrosion beginning on any stainless steel surface, you may need to change the cleansing agent, sanitizing agent, or the cleaning procedures you are using.

- A mildly abrasive nylon or brass brush may be used to remove any stubborn deposits on interior surfaces of unit.
- Fully rinsing and drying all parts can help prevent corrosion. Elements and minerals in tap water can accumulate on stainless steel parts and create corrosion.
- Do not use abrasive, caustic or ammonia based cleansers.
- Do not use products containing acids, alkalines, chlorine, or salt. These agents can corrode stainless steel.
- Do not use metal scrapers or cleaning pads that could scratch surfaces.

WIRING DIAGRAM

87772

120V USA

with Countdown Timer

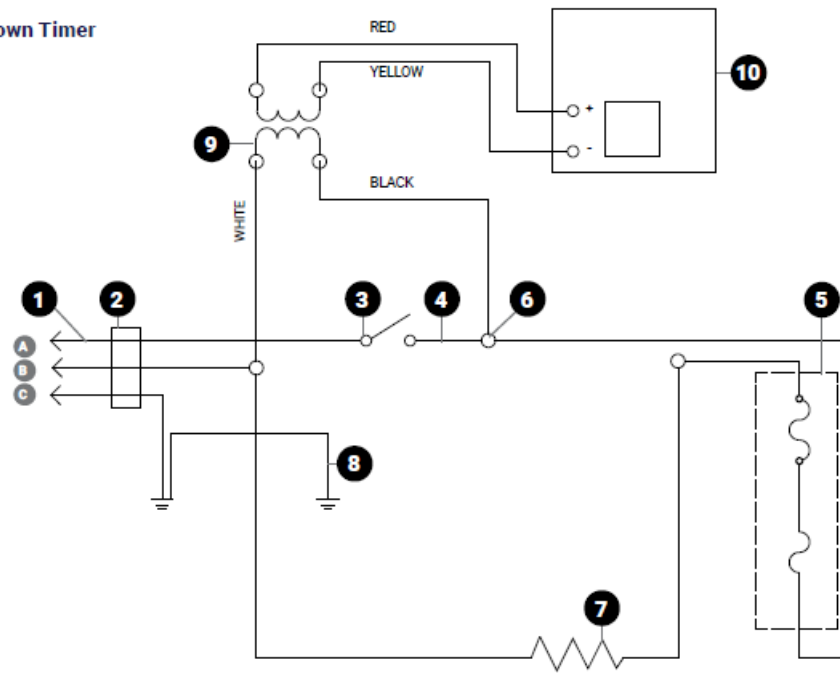

1. Cord Assembly 120V
 1. Black
 2. White
 3. Green
2. Bushing/Strain Relief
3. Rocker Switch
4. Wire Assembly, 18GA, Black, 4"
5. Thermal Assembly, Cut-out
6. Wire Nut
7. 100W Silicone Element
8. Wire Assembly, 18GA, Green, 14"
9. Transformer Assembly
10. Timer Board

TROUBLESHOOTING

UNIT DOES NOT HEAT?

- Ensure cord is securely plugged in.
- Ensure power is available from source.
- Ensure unit is on.

UNIT OVERHEATING?

- Ensure water has not spilled or leaked from pan into the basin.

CAUTION:

WATER IN BASIN MAY STEAM & BURN.

- Allow unit to cool. Pour out any water and dry basin.

UTENSILS OR TOP OF PAN GETTING TOO HOT?

- Do not use liquid or gel-filled utensils.
Handles become extremely hot. Only use utensils safe at high temperatures.
- Limit water volume to the fill-line. (Do not exceed 28 oz. of water.)

DO NOT OVERFILL

Water above fill-line in pan may cause unsafe handling temperatures.

- Overfilling pan with water may conduct excessive heat to utensil handles or top of pan.

WATER NOT REACHING 140° F?

- Make sure to use HOT water in pan. Refer to temperature charts on page 5.
- Damaged pan may not heat properly.
- Inspect and replace pan if needed.
- Use pan liner to protect pan bottom from damage.



SERVER PRODUCTS LIMITED WARRANTY

This Server product is backed by a two-year limited warranty against defects in materials and workmanship. See Server-Products.com for details.

GENERAL SERVICE, REPAIR OR RETURNS

Before sending any item to Server Products for service, repair, or return, contact Server Products customer service to request a Return Authorization Number. Merchandise must be sent to Server Products with this number. Service is extremely prompt. Typically, units are repaired and ship out within 48 hours of receipt.

Merchandise being returned for credit must be in new and unused condition and not more than 90 days old and will be subject to a 20% restocking charge. Electrical parts (thermostats, heating elements, etc.) are not returnable.

Servicing Cord: Specific tools are required for safe and proper power supply cord removal and installation. If cord must be replaced, only a representative of the OEM (original equipment manufacturer) or a qualified technician may replace cord. Cord must meet code designation H05 RN-F requirements.

CONSERVEWELL® DROP-IN

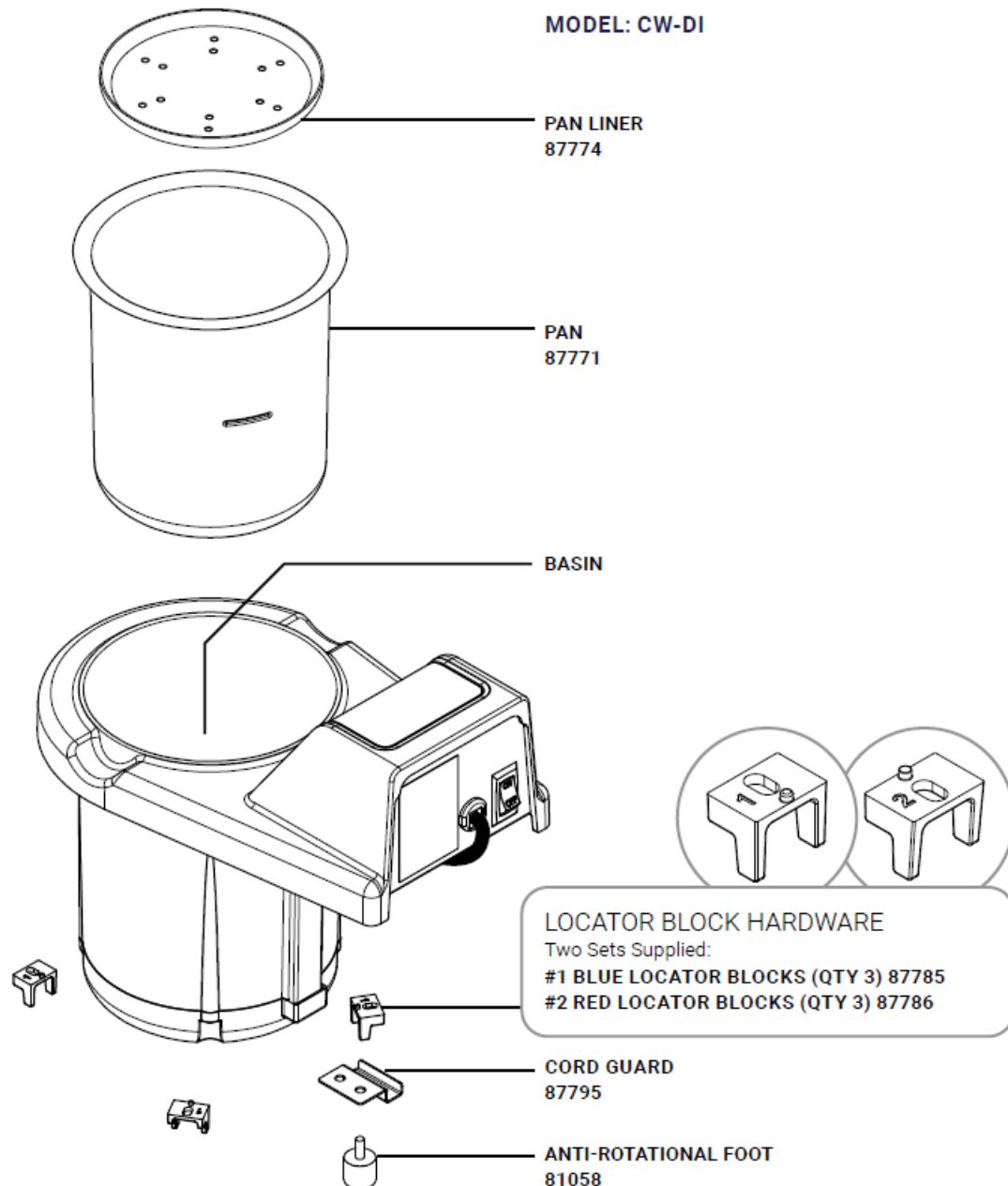

Server Products Inc.
3601 Pleasant Hill Road Richfield, WI 53076 USA
Chat with us!
spsales@server-products.com
262.628.5600 | 800.558.8722

Documents / Resources

	<p>SERVER CW-DI ConserveWell Drop In Unit with Timer [pdf] Instruction Manual CW-DI, ConserveWell Drop In Unit with Timer, CW-DI ConserveWell Drop In Unit with Timer</p>
---	---

References

- [products.com](#)
- [Server Products](#)