

Senze
SZ-933A Switch
Game Controller



Senze SZ-933A Switch Game Controller User Manual

[Home](#) » [Senze](#) » Senze SZ-933A Switch Game Controller User Manual 

Contents

- 1 [Senze SZ-933A Switch Game Controller](#)
- 2 [Specifications](#)
- 3 [Connection operation instruction](#)
- 4 [Wake up / Re-Connection Function](#)
- 5 [Charging Indication](#)
- 6 [Reset Function](#)
- 7 [Product Specification](#)
- 8 [FCC Statement](#)
- 9 [Frequently Asked Questions](#)
- 10 [Documents / Resources](#)
 - 10.1 [References](#)
- 11 [Related Posts](#)

Senze

Senze SZ-933A Switch Game Controller



Specifications

- Bluetooth Switch mode
- Bluetooth standard Android Mode
- Bluetooth IOS protocol Android Mode
- Bluetooth IOS Mode
- Bluetooth PC (X-INPUT) Mode

Thank you very much for choosing this Switch Game Controller. Please read this Manual in detail before use to operate and use it correctly, and bring the superior performance of the product into full play. The descriptions in this Manual are based on the default settings of the device, all the pictures, statements, and text information are for reference only, please refer to the actual product. The content is subject to update without further notice. The update will be included in the new version of the Manual, and the Company reserves the right to final interpretation. Available functions and additional services may vary by device, software, or service provider. Please charge the Controller before use. If there are typographical errors or translation errors, we sincerely hope for all users understand understand howto



Connection operation instruction

Mode and Connection operation instruction Bluetooth Switch mode

1. Turn the Switch console on, click the System Setting Menu button on the home screen, enter the next level of the Menu option and click the Airplane Mode option, then click the Controller Connection (Bluetooth) option to turn the Bluetooth function ON, and then turn the Airplane Mode option off.

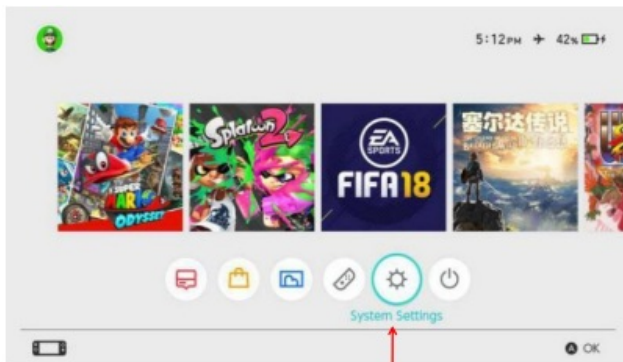

(1)

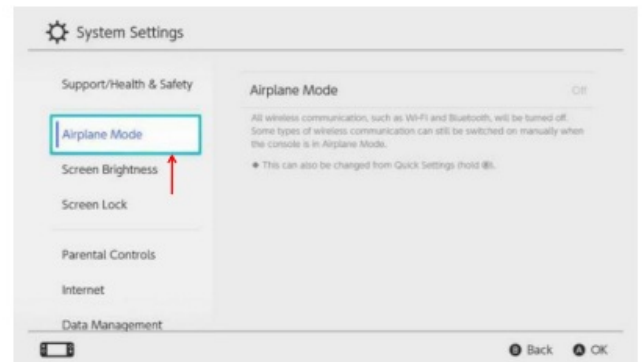

(2)

2. Enter the Switch console Bluetooth Pairing Controller mode click the Controllers Menu button on the Console home screen, and after entering the next level of Menu options, click the Change Grip/Order option and the Console will automatically search for the matching Controller.

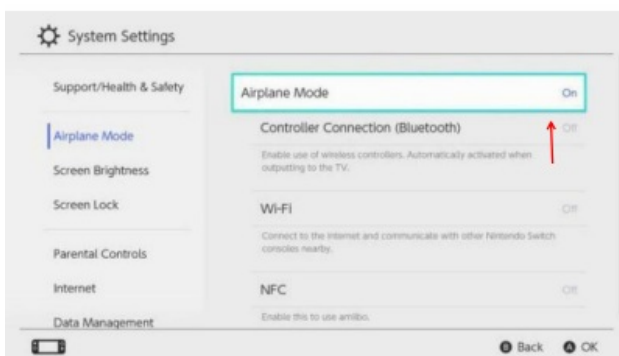

(3)

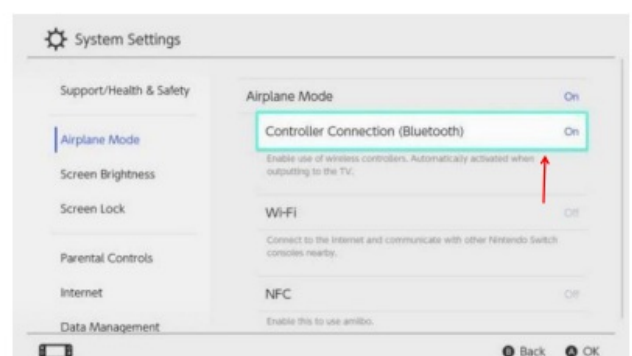

(4)

3. In the shutdown state, press the Y+HOME button of the Controller or long-press the Pairing button 3S to enter Bluetooth pairing mode, LED1-LED4 light flash quickly, after the successful connection, the Switch Console will automatically distribute Controller channel, and the corresponding channel indicator light will always be on; Synchronizing states or pairing with the Console: LED1-LED4 light flashing quickly.

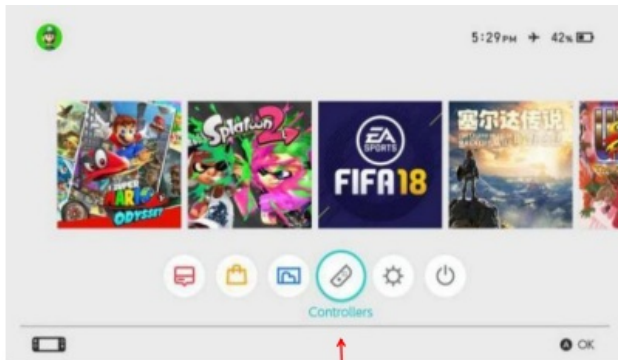

(5)

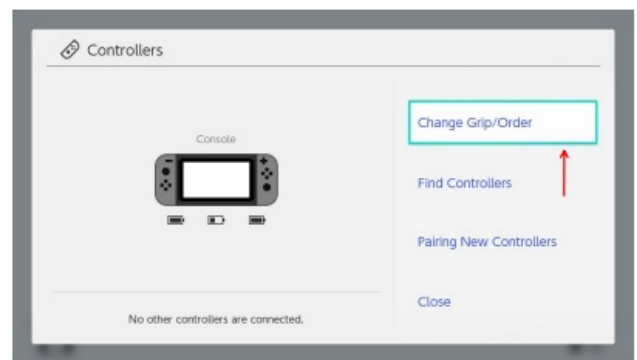

(6)

4. In the shutdown state, directly insert the USB data cable into the USB port of the Switch console, if the console and the original charging base are integrated, insert the USB into the charging base (Remark: need to open the wired controller connection option in the Console Setting), pair the console through the USB cable connection, and the Controller will automatically connect back to the console through Bluetooth wireless mode after unplugging the USB cable.

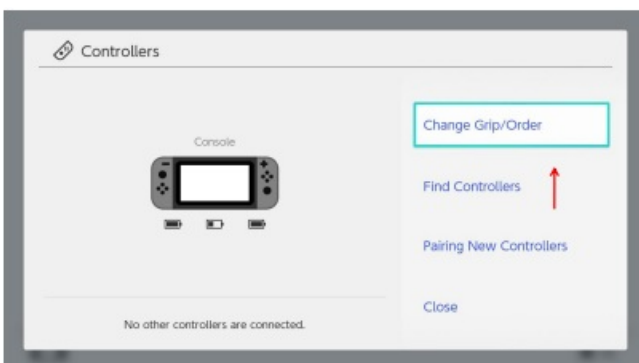

(7)

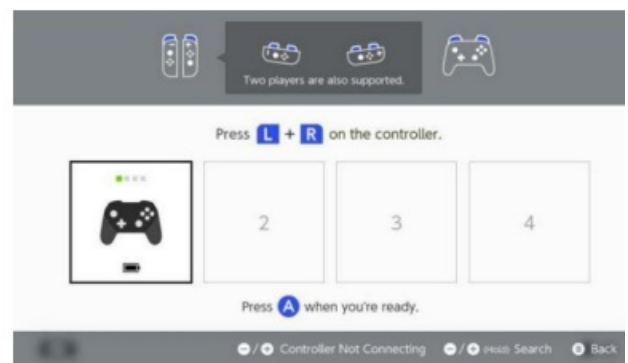

(8)

Bluetooth standard Android Mode

In the shutdown state, press and hold the Controller +HOME button to enter Bluetooth pairing mode, LED2+LED3 flashing quickly then open the Android device Bluetooth for search, find and click the "Gamepad" device name in the list of available devices to pair the LED2+LED3 are light on after pairing successful.

Remark: In Android mode, the Controller has no vibration, or axis functions.

Bluetooth IOS protocol Android Mode

In the shutdown state, press the X+HOME button to enter pairing mode, LED1+LED4 flashing, then open Android device Bluetooth for search, find and click the "Xbox Wireless Controller" device name in the list of available devices to pair. After the pairing succeeds, the corresponding LED1+LED4 is steady on.

Bluetooth IOS Mode

In the shutdown state, press the X+HOME button to enter pairing mode, LED1+LED4 flashing, then open IOS device Bluetooth for search, find and click the "Xbox Wireless Controller" device name in the list of available devices to pair. After the pairing succeeds, the corresponding LED1+LED4 is steady on.

(Remark: The IOS device system need be 13.0 or above, the Controller has no vibration, axis functions in this mode).

Bluetooth PC (X-INPUT) Mode

In the shutdown state, press the X+HOME button to enter pairing mode, LED1+LED4 flashing, then open the PC Bluetooth for search, find, and click the "Xbox Wireless Controller" device name in the list of available devices to pair. After the pairing succeeds, the corresponding LED1+LED4 is steady on, and the Controller enters X-INPUT mode, which can be used directly in the Windows 10 system and above.

USB Mode

In the Controller power-off state, insert it into the PC USB port through the data cable, it is automatically recognized as X-INPUT mode (default mode) and LED1+LED4 is light on. In PC X-INPUT mode, long press the "-"+"+" button 3S to switch to D-INPUT Controller mode, and LED2+LED3 is light on.

TURBO speed adjustment

Hold down the TURBO key and press the corresponding key to set TURBO; to set the automatic TURBO mode, repeat the setting, you can set keys key: A, B, X, Y, L, ZL, R, and ZR; To cancel the TURBO function, repeat the Settings There is three gear TURBO speed adjustment (5-10-15HZ); TURBO + right 3D rocker push up: increase the speed of continuous shooting by 1 gear; TURBO+ right 3D rocker push down: reduce the speed of continuous shooting by 1 gear, default middle gear.

Motor vibration intensity adjustment

Press and hold the TURBO+ left 3D rocker push up:increases motor vibration strengthens; TURBO+ Left 3D rocker push down: decreases the motor vibration 100% -75% – 50%- 0% 4 gear intensity adjustable, Controller motor adjustment has a memory function.

RGB Light Effect Set

- Short press the LIGHT+R3 key together (right rocker push down) to switch the light effect mode, each press can switch the light effect mode (Dazzling light – single color light – single color breathing light – single color breathing cycle light).
- In Dazzling light mode, short press the LIGHT+L3 key together (left rocker push down) to pause and save the current Dazzling light effect mode.
- In single-color light mode short press the LIGHT+L3 key (left rocket push down) to swithe lightightsingle-colorr color breathing light mode, short press the LIGHT+L3 key (left rocker to push down) to Switch the light color.
- In single-color breathing cycle light mode, short press the LIGHT+L3 key (left rocker push down) to pause and save the current mode and press again to turn on the Breathing mode again.
- In each mode, the brightness of the RGB light can be adjusted by pressing the LIGHT+(UP/DOWN arrow key) at the same time, by pressing the combination key once to adjust the one-gear brightness; The LIGHT+UP combination key increases the brightness, and the LIGHT+DOWN combination key decreases the brightness.
- Long press the LIGHT key 5S to close or open the RGB light. Light effect Settings with memory function will automatically save the current setting of the light effect mode.

Wake up / Re-Connection Function

- Press the HOME button for 1 second to wake up the Controller, reconnect, and wake up the hibernating Switch console, the Controller will automatically sleep if the connection fails in 15 seconds.
- The controller has a mode memory function, which will keep the current mode after shutdown. Press the HOME button to wake up the Controller, and you can directly reconnect to the last saved mode.

Charging Indication

- In the controller shutdown state, the LED1-LED4 mode indicator blinks slowly while charging, and the LED is off after fully charging.
- Battery low voltage alarm The current mode indicator is blinking (quickly). The current mode indicator blinks (slowly) when charging, and the current mode indicator is steady when fully charged.

Automatic sleep/Power-On/Off

The console screen closes, and the Controller automatically sleeps; the Controller automatically sleeps without any key action (including sensor action) after 5 minutes. In Bluetooth mode, long press the HOME key for 5 seconds to close the Controller.

Lower voltage alarm

When the Controller battery is low, the current mode indicator blinks quickly indicating that the battery is low, if you continue to use the Controller until the voltage is lower than a certain value, the Controller will automatically enter the sleep state.

3D joystick calibration

When there is a problem with the left and right 3D joystick, you can calibrate the 3D joystick through the console. Enter the calibration operation interface as shown in the following figure, and complete the corresponding actions according to the console instructions. When the console pops up the calibration completed, the calibration is complete.

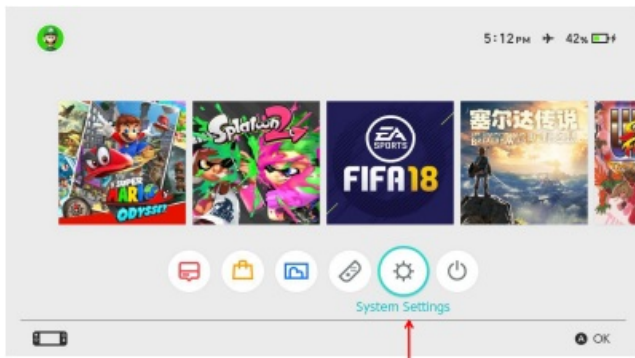

(1)

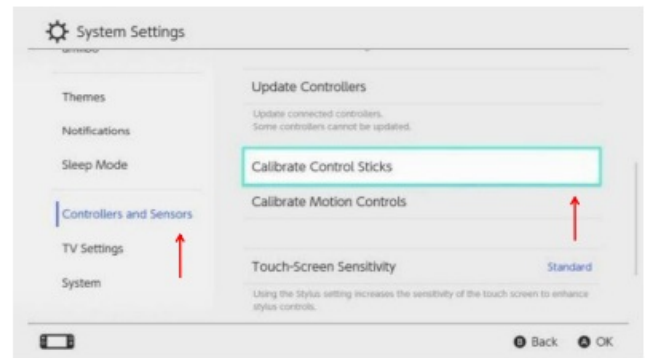

(2)

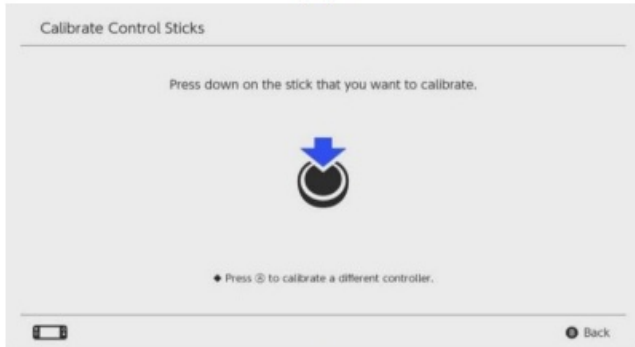

(3)

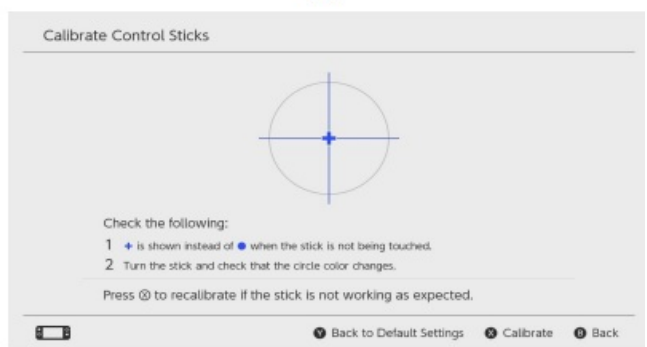

(4)

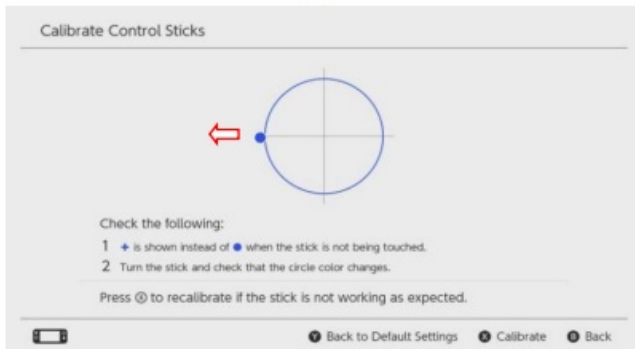

(5)

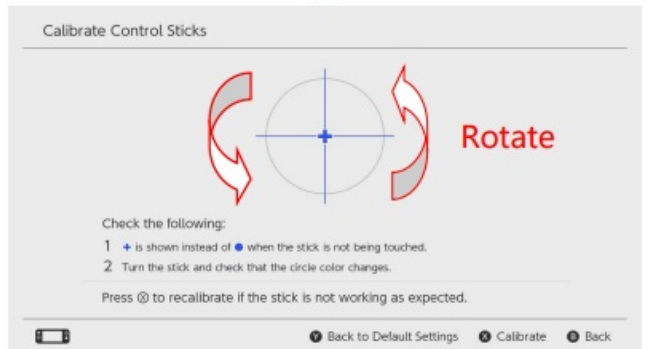

(6)

Six-axis Calibration

If the axis sensor on the Controller has abnormal problems, the axis sensor of the Controller can be restored to normal work through the axis calibration function; Axis calibration operations can be performed in any of the following ways.

1. In the connection state, enter the sensor calibration interface through the console, keep the Controller flat on the plane, and press the "+" or "-" key, when the console pops out the calibration completed, the calibration is complete.

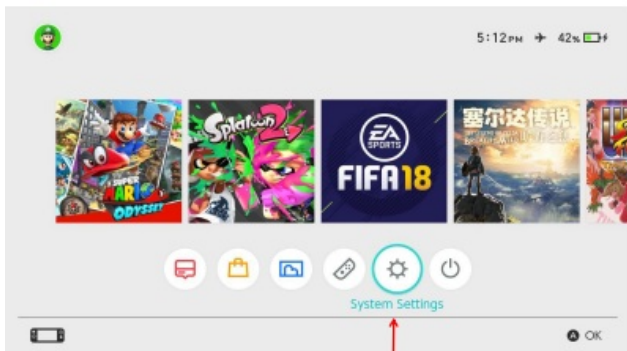

(1)

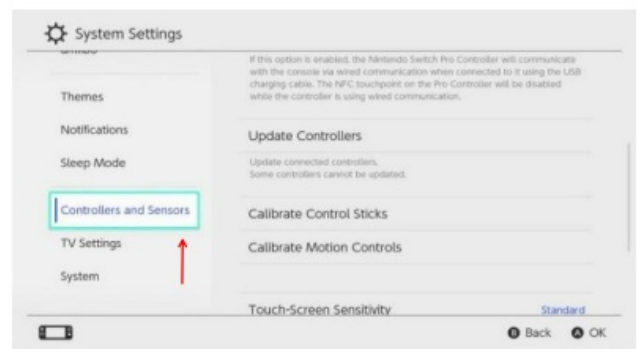

(2)

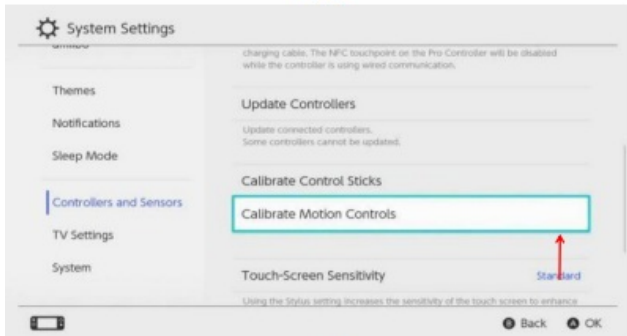

(3)

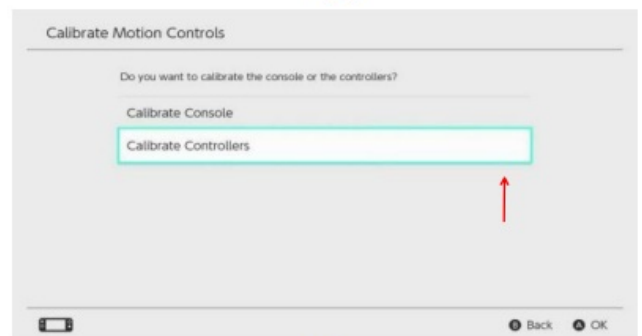

(4)



(5)

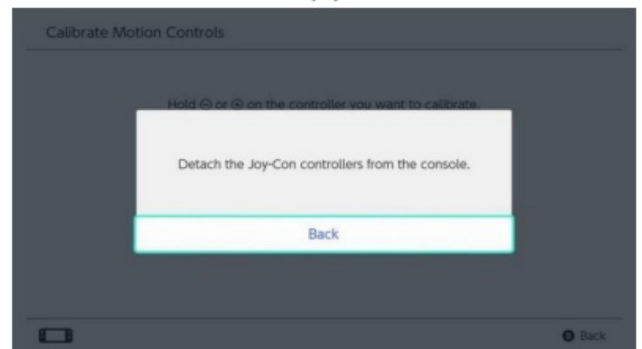

(6)

2. In the shutdown state, press and hold the “A”+“-”+ HOME keys 3S to turn on the Controller Two groups of front and rear lights flash each other, press the “+” key again, LED lights extinguished then the calibration is complete.

Button Test

If the Controller buttons fail or do not work, you can use the console button test option to test whether each button function is normal.

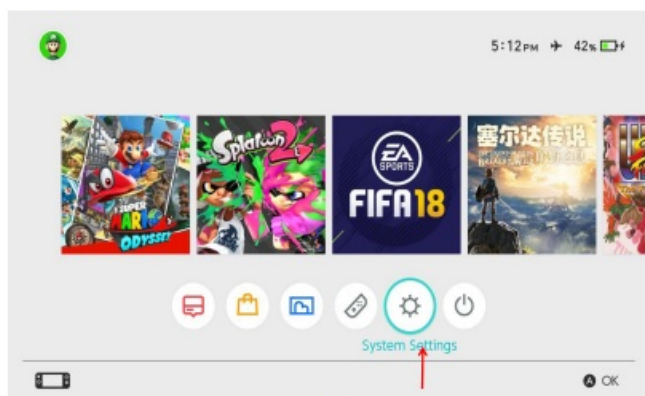

(1)

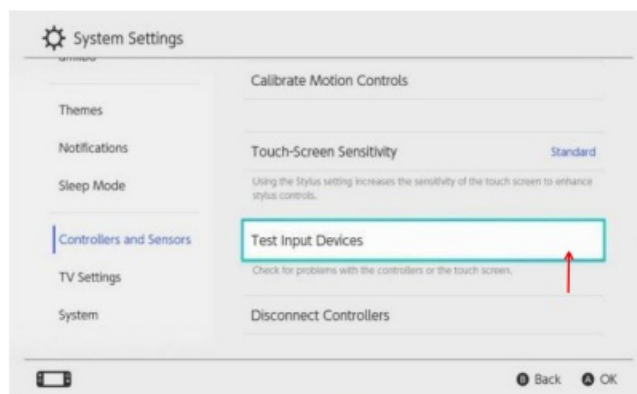

(2)

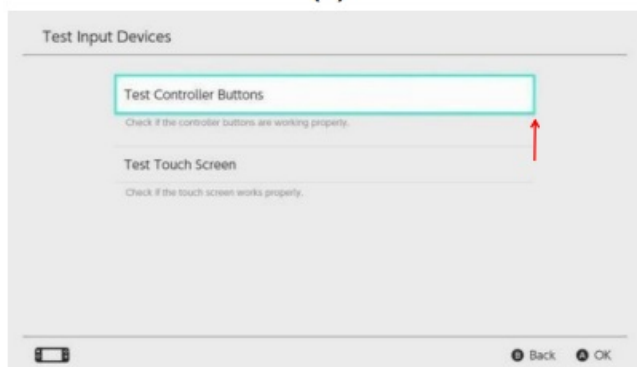

(3)

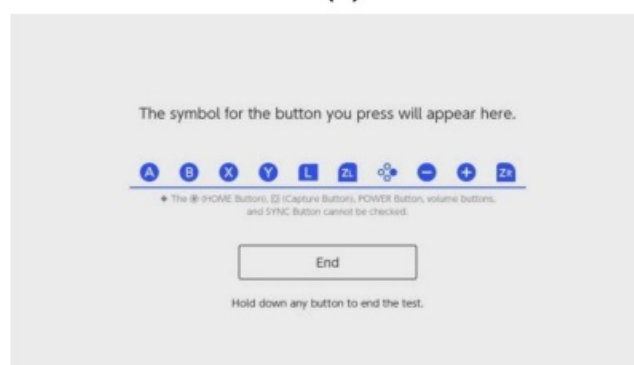

(4)

Reset Function

When the Controller function is abnormal or stops working, you can reset the Controller by pressing the Reset button at the bottom of the Controller.

Product Specification

- **Product Name** SWITCH Wireless Controller
- **Battery** 3.7V 800 mAh Li battery
- **Charge Voltage** DC 5V
- **Charge Current** ≈500mA
- **Charge Time** ≈2.5
- **Product Model** SZ-933A axis
- **sensor** Six axis gyro sensor
- **Working voltage & current** 3V & ≈25-100mA
- **Static working current** <5μA
- **Working distance** 6m

FCC Statement

This equipment has been tested and found to comply with the limits for a Class B digital device, under part 15 of the FCC Rules. These limits are designed to provide reasonable protection against harmful interference in a residential installation. This equipment generates, uses, and can radiate radio frequency energy and, if not installed and used by the instructions, may cause harmful interference to radio communications. However, there is no guarantee that interference will not occur in a particular installation. If this equipment does cause harmful interference to radio or television reception, which can be determined by turning the equipment off and on, the user is encouraged to try to correct the interference by one or more of the following measures:

- Reorient or relocate the receiving antenna.
- Increase the separation between the equipment and the receiver.
- Connect the equipment to an outlet on a circuit different from that to which the receiver is connected.
- Consult the dealer or an experienced radio/TV technician for help.

Caution: Any changes or modifications to this device not explicitly approved by the manufacturer could void your authority to operate this equipment.

This device complies with part 15 of the FCC Rules. Operation is subject to the following two conditions:

1. this device may not cause harmful interference,
2. this device must accept any interference received, including interference that may cause undesired operation.

RF Exposure Information

The device has been evaluated to meet general RF exposure requirements. The device can be used in portable exposure conditions without restriction.

Frequently Asked Questions

- **Q: How do I pair the Controller in Bluetooth Switch mode?**
 - A: Follow the steps provided in the user manual. Turn on the Switch console, enable Bluetooth in the System Settings, and pair the Controller through the Controllers Menu.
- **Q: Can the Controller be used with Android devices?**
 - A: Yes, the Controller can be paired with Android devices in Bluetooth Standard Android Mode. Follow the instructions to enter pairing mode and connect to your device.

Documents / Resources

	<p>Senze SZ-933A Switch Game Controller [pdf] User Manual SZ-933A, SZ-933A Switch Game Controller, Switch Game Controller, Game Controller, Controller</p>
---	--

References

- [User Manual](#)

Manuals+. [Privacy Policy](#)

This website is an independent publication and is neither affiliated with nor endorsed by any of the trademark owners. The "Bluetooth®" word mark and logos are registered trademarks owned by Bluetooth SIG, Inc. The "Wi-Fi®" word mark and logos are registered trademarks owned by the Wi-Fi Alliance. Any use of these marks on this website does not imply any affiliation with or endorsement.