

SENSOR PO13 Keypad Phone



# SENSOR PO13 Keypad Phone User Manual

[Home](#) » [Sensor](#) » SENSOR PO13 Keypad Phone User Manual 

## Contents

- 1 SENSOR PO13 Keypad Phone
- 2 Basic Information
- 3 Before Use
- 4 Description of Buttons
- 5 Phone Menu Functions
- 6 Phone
- 7 Organiser
- 8 Entering Text
- 9 Care and Maintenance
- 10 Technical Specifications
- 11 Warranty Conditions
- 12 CONTACT
- 13 Documents / Resources
  - 13.1 References

# SENCOR®

**SENSOR PO13 Keypad Phone**



## Basic Information

### Basic Description of Functions

Thank you for selecting the Element mobile phone with a colour display. While reading this manual, get familiar with the phone's operation, features and control method.

The mobile is designed to be used in a GSM/GPRS network environment and allows for using two SIM cards in the standard mode. While there is an ongoing call on one of the SIM cards, the other SIM is disabled. In addition to the basic call features, the phone offers several hand features such as an address book, operating modes (profiles), messages, audio/video player, camera and video camera, alarm clock, calculator and other features that come in hand both at work and during leisure activities.

The mobile phone meets the GSM/GPRS requirements and has been certified by relevant authorities.

Our company reserves the right to modify the content of this manual without prior notice.

## Before Use

### Labelling and Description of Parts

#### Description of Device

1. Shared earpiece with speaker
2. LCD display
3. Centre OK key and directional navigation keys (↑, ↓, →, ←)
4. Left soft button
5. Dial button
6. Text and number keys
7. "\*" key – change ringtone profile
8. "O" key – lamp on/off
9. "#" key – keyboard lock
10. Call end button

- 11. Right soft button
- 12. Micro USB for data transfer and charging input
- 13. Headphone jack 3.5 mm input
- 14. Microphone
- 15. Lamp
- 16. Camera
- 17. Shared ringtone speaker

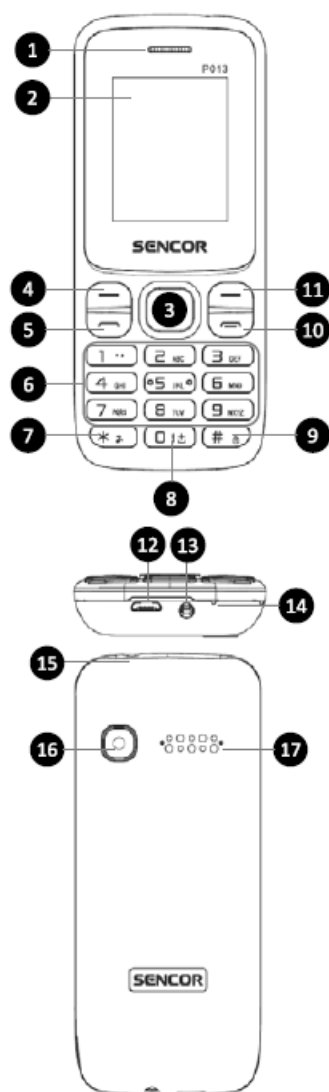

## Description of Buttons

Buttons	Function
<b>Left/right soft button</b>	<ol style="list-style-type: none"> <li>1. Performing the functions shown in the left t/ri get display bottom corner</li> <li>2. In standby, press the left soft button to enter the phone Menu or press the right button to enter Contacts (unless otherwise specified)</li> </ol>
<b>Navigation buttons</b>	The navigation buttons correspond to the direction buttons except for the special functions. During the call, press the up/ down keys to decrease/increase the speaker volume.
<b>Dial button</b>	<ol style="list-style-type: none"> <li>1. Press this button to dial a number or answer an incoming call.</li> <li>2. Press this button on standby to enter the call history list.</li> </ol>
<b>OK button (centre key)</b>	This is used to access the phone Menu from standby. Press DK on other screens to confirm our selection.
<b>Call end button</b>	<ol style="list-style-type: none"> <li>1. Hold down the button to turn your phone on/off.</li> <li>2. Press in an LI screen to return to the standby screen.</li> <li>3. Press to end the ongoing call or reject an incoming call.</li> </ol>

Buttons	Function
	These are used to dial and input numbers
<b>Text and</b>	characters. Hold down the number r
<b>number keys</b>	1 button to go to the preset voicemail. In
	text mode, you can input characters such
	as. , – ? and more.
<b>* Key</b>	<ol style="list-style-type: none"> <li>1. On the standby screen, hold down * after entering the phone number to enter the extension number: when the “+” sign appears, enter the extension.</li> <li>2. From the standby screen, press and hold the * button to switch between the Silent, Main and Meeting phone Profiles.</li> </ol>
<b>#key</b>	In the text edit screen, press # to switch the text input method. The current mode will be displayed in the top left corner.
<b>o-key</b>	In standby mode, hold down the “O” key to enable/disable the phone lamp.

### Inserting SIM and Memory Cards

Before using your phone for the first time. It is necessary to insert the SIM card. You will obtain the SIM card from your mobile operator.

If you buy the services in a mobile network, you will obtain the SIM card along with the details such as your PIN code and optional services available.

**Caution:** Avoid bending the SIM card and protect it from scratching. Do not expose the SIM card to static electricity, water and pollution. When inserting and removing the SIM cards as well as the memory card, take utmost care to avoid damage to the slots and the phone's motherboard.

#### Warning

Before handling cards (SIM and memory cards), first, disconnect the charger, turn off the phone and remove the battery.

- To open the back cover, lift it with a finger or a blunt object at the cut-out (on the bottom left corner of the phone near the rear battery cover) and gently prise the cover around the entire perimeter of the phone.

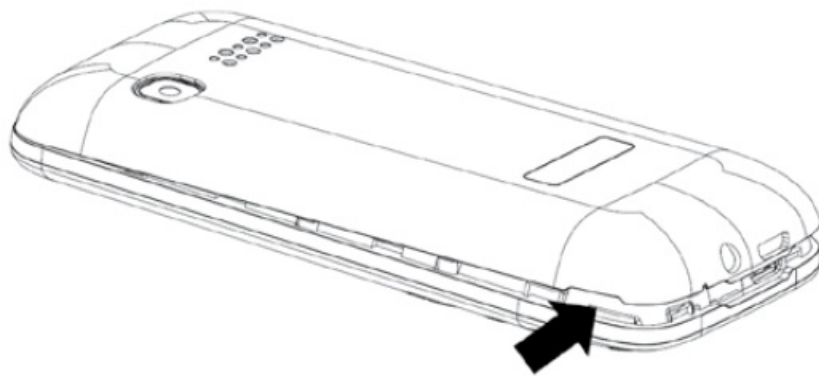

- Lift the battery with a finger or a flat tool on the phone's top part in the notch near the battery (on the inserted battery's top edge).

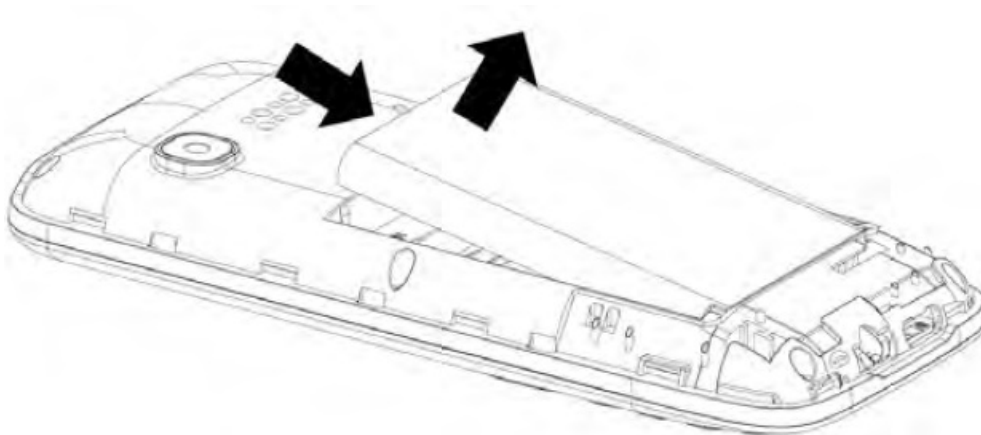

Insert the SIM cards into the appropriate slots under the battery with the contacts facing downwards so that the SIM card contacts touch the built-in SIM contacts inside the phone.

Insert the SIM 1 card into the left slot with the tapered corner facing the lower right corner of the slot, then insert the SIM 2 card into the right slot with the tapered corner facing the lower right corner of the slot.

**The memory card** is to be inserted into the slot in the lower right corner of the space under the battery which is protected by a retaining tab. Press the retaining tab gently and shift it to the right to release.

Insert the memory card under the retaining tab with the contacts facing downward in a way that the memory card contacts touch the phone's built-in contacts for a memory card and the memory card edge with notches faces the battery contacts downward. A properly attached memory card follows the shape of the slot and can be pressed evenly into the slot by applying slight pressure. Position the retaining tab over the memory card with a slight

pressure while moving it to the left to secure the tab against the motion.

**Caution:** If the memory card does not work, please check if it is correctly inserted and if the contacts are good. The maximum size of the supported memory cards is 8GB. The card must be formatted to FAT32.

When inserting the battery into the phone, first connect the battery contacts with the contacts inside the phone (at the bottom right) and then gently push the battery downwards into the battery compartment.

When putting on the rear cover, make sure that the cover is correctly placed on the battery compartment and gradually, gently push down the cover edges from the top edge downwards along the entire perimeter until it slides properly onto the phone body at all points.

**Please note:** phone functions such as voice calls, receiving and sending text messages and data transfers at different speeds are only possible and available when at least one SIM card with activated operator features is inserted and within range of the operator's wireless network. Request information from the operator about available services on SIM cards and the accessibility of the network.

### **Turning the Phone On/Off**

To turn the phone on, hold down the call end button.

To turn the phone off, hold down the call end button in the standby mode.

### **Charging the Battery**

Plug the charging adapter into the charging connector on the bottom of the phone.

Then connect the charging adapter to a standard electrical outlet and the battery icon on the display will start to move. The phone's standby screen displays information about the charging in progress. When the battery indicator stops moving, the battery is finished charging. Press the charging adapter connector with two fingers and pull gently to disconnect it from the phone.

**Caution:** Use the original charging accessories to ensure the reliable operation of the mobile phone.

### **Security Password**

#### **PIN**

The PIN code is designed to prevent illegal usage of SIM cards. The PIN code is usually attached to your SIM card. If you enter the wrong PIN three times consecutively, you can unlock it by entering the PUK. For more details, please contact the mobile operator.

#### **PIN2**

You need to enter the PIN2 code to access certain features (e.g. call charging); if you enter the wrong PIN2 code three times in a row, LIOU can unlock it by entering PUK2. For more details, please contact mobile operator.

#### **PUK**

When removing the locked PIN code, you must enter the PUK. The PUK code is attached to the SIM card. If the PUK is not attached, please contact the LIOU cellular operator. Entering the wrong PUK ten times consecutively will no longer be able to use a SIM card. Please contact your phone operator to purchase a new card. The PUK cannot be changed. If you lose the PUK, please contact your cellular operator.

#### **PUK2**

When removing the locked PIN2 code, you must enter the PUK2. If you enter the wrong PUK2 ten times consecutively, you will no longer be able to use the functions that require entering the PIN2. Please contact your phone operator to purchase a new card. The PUK2 cannot be changed. If you lose the PUK, please contact your cellular operator.

### **Quick Calling Operation Guide**

When LIOU starts your phone for the first time, you will be asked to enter your PIN if it is set on your SIM card. In

the next step, your phone will ask you for the "Time and date". There is no need to set it at this point. The time and date will be set automatically when the phone is connected to the mobile network. The next item is "Language" - here LIQU selects the language in which the phone will communicate with LIQU. Press the OK button to confirm the selected language and press the back button to end the first setup.

If English is the default language After initially turning the phone on, please navigate through the phone Menu items as follows: Menu/ Settings/ Phone settings/ Language and select the desired language from the menu. To unlock/lock the lock, press the left soft key and then # on the standby screen.

### **Dialling a Call**

In standby, press the numeric keys to enter the number wish to dial. When the number is entered, press the dial number to make a call. If there are 2 active SIM cards in the phone, the phone will prompt to select the SIM to be used for calling. If want to make an international call, add an area prefix before the number.

### **Rejecting a Call**

You can reject an incoming call by pressing the call end button.

### **Answering a Call**

If there is an incoming call, the phone will alert in an appropriate manner (by vibration, ringing etc.). If this feature is supported by a telephone network, the display will show the caller's name and phone number; at this moment, can press the dial button to accept the incoming call.

### **Ending a Call**

When finished with the conversation, can end the call by pressing the call end button.

### **Emergency Calls**

You can make emergency calls directly without a SIM card. Different networks use different emergency numbers. For details, please contact mobile operator.

### **Fast Extension Selection**

To insert a pause in a phone number (e.g. to enter the extension number), press and hold the "\*" button while entering the number.

### **Call Volume Level**

During an ongoing call, can change the volume level using the arrow navigation keys (up/down). The shared speaker is designed in a manner to allow ringing, hands-free function and the earpiece and does not allow for more audio operations to be performed at one time. No sound is output from the speaker as well as the earpiece at higher volume levels.

## **Phone Menu Functions**

### **Messages**

The messaging service is a telephone network service. The correct function of this menu depends on the SIM card type and on the services provided mobile operator. Therefore, verify them before using this function. The message capacity of SIM depends on the SIM type. Before using this function, make sure to set the phone operator's service centre number.

**Typing a message:** Type the text of the message on the lines using the keyboard. For instructions on how to insert text, please refer to a separate chapter. To send a message, use the menu available via the left soft (Options/Send) or press the centre OK. Then enter the recipient of the message, enter the telephone number or select "Add from list" and confirm with the OK centre key.

**Inbox:** Stores the received messages.

**Outbox:** Stores the messages that were not sent successfully!

**Drafts:** Stores saved unfinished messages.

**Sent:** Stores successfully sent messages.

### **Contacts**

This function allows you to browse through the telephone directory, as well as save, edit and delete names and phone numbers in the phone and on the SIM card. The capacities of SIM cards vary and the maximum capacity of the phone's memory is 300 contacts. To save a new contact, select Add contact (first entry in the list), press the centre key and select Options/Edit to edit the selected saved entry.

### **Call Listing**

The call history list offers the call overview and the option to delete the items.

### **Call Listings**

**Missed calls:** A list of recently missed calls is shown here. **Outgoing calls:** A list of recent call numbers is shown here.

Incoming calls: A list of recently received is shown here. All calls: Displays a complete list of incoming, outgoing and missed calls.

**Delete call listings:** You can delete all records of dialed numbers, and incoming, missed and outgoing calls.

### **Call Settings**

**SIM 1/SIM2 Call listing settings:** Here you can set call waiting, call forwarding, blocking or line switching. These functions are tied to the network operator, so please consult with them first to see if the function is supported.

### **Advanced settings**

**Blocked numbers:** Here you can set a list of numbers that you want to be blocked as incoming at the device level.

**Automatic redial:** If the called number does not answer the call the call will be automatically redialed.

**Call time alert:** Option to set a beep during a call to sound repeatedly every minute or once, a beep will sound during the call

**Call answer mode:** All keys – you can answer the call with any key on the phone

### **Multimedia**

#### **Camera**

The device is equipped with a camera. For the correct camera function, the memory card should be inserted and set as the default storage.

To adjust zoom, press the up/down arrow key. Press the OK button to take a picture, and use the left soft key to send or delete the picture.

Press the Options button (during shooting) to display the menu of available functions:

1. **Switch to video recorder:** Allows you to take and save a video using the Camera function in the Video camera mode.
2. **Photos:** allows you to enter the browser of saved images.

**Camera settings:** offers the ability to adjust the properties settings.

**Image settings:** image size and image quality – adjust as needed

**Memory:** select the memory to store the image. Select a memory card.

**Factory settings:** Selecting and confirming this function will set the camera to the default settings.

#### **Image**

Allows you to enter the viewer of saved images.

#### **Video Recorder**

Allows you to watch videos. Your phone supports 3GP, AVI and MP4 video formats. To operate the player and the volume, please use the navigation keys and the centre key.

**Upload:** upload stations to the memory card.

The recording device allows you to record audio and video.

Press OK to start/pause playback.

#### **Games**

The phone offers games that can be controlled with navigation keys, centre keys or keyboard buttons.

### **Audio Player**

Your phone can play MP3 files saved in the phone's memory or on the memory card and supports background playback. To operate the player and the volume, please use the navigation keys and the centre key. Pressing the left soft key will take you to the playlist editing or further to the Settings:

**Repeat:** Set the playback repeat mode

**Random:** Set the random playback mode

**Volume control:** The volume is controlled by the "\*" volume down "#" volume up buttons.

### **Audio Recording**

The recording device allows you to record audio. Press the Options button to select: New Recording – to start recording. List – to view all recordings. Settings – to select a storage location and set the audio quality. Select New Recording – to start recording. List – to view all recordings. Settings – to select a storage location and set the audio quality.

### **FM Radio**



To receive FM radio, we recommend placing the phone in a suitable location with strong FM reception. The phone has an integrated FM antenna. You can dial or receive calls without restrictions while listening to the radio. The radio sound will be muted automatically during the call.

Press left/right arrow key to switch stations. Press OK to stop/switch on the FM radio broadcast. To control the volume, use the “\*” keys to decrease the volume “#” keys to increase the volume. On the radio playback screen, press the left soft key to enter the options menu where the following actions can be performed:

1. Stations list: Allows you to play, and edit the name or the frequency of a selected station.
2. Manual control: You can search and store the frequencies manually.
3. Automatic tuning: Starts automatic searching and stores the found stations in the station list.

File list: shows a list of recorded and saved songs from FM radio and audio recording.

### **File Manager**

Allows you to view images and photos or video files on the memory card or in the phone using the photo album. Furthermore, you can set an image as the wallpaper or share a file via Bluetooth.

**Tip:** The files taken by the camera are stored in the Photos folder and the videos are stored in the Video folder.

## **Services**

### **Browser**

Your phone is equipped with an internet browser. For the correct browser function, a memory card with free space must be inserted. Before making the first settings, make sure to have mobile data services enabled with your cellular provider. If the network connection parameters are not set automatically, they need to be set manually in the application, in the Settings / Data account section. For parameters necessary for mobile data, please contact your cellular operator. The browser is designed to work with basic websites. Enter the address of the desired website in the line at the top of the display (enter URL).

**Caution:** The internet function primarily shows the Wap pages. Web pages may not always be shown correctly and may not support some active graphic elements. The unit may show an alert to a lack of space of the web page is too big and the integrated browser cannot show it.

### **SIM Toolkit**

The SIM toolkit services availability is based on the SIM card. For more information, please contact your mobile operator.

### **Settings**

You can adjust your phone settings, display, security or ringing profiles.

### **Profiles**

The preset profiles are Home, Silent, Meeting and Outdoors. The settings of some profiles can be customised.

### **Dual SIM Settings**

This is used to set the active SIM cards (only the selected SIM or both SIM cards).

## **Phone**

### **Time and Date**

You can set the phone's date and time as well as their display mode.

### **Language**

You can change the language of your phone.

### **Preferred Input Method**

Select the type of insertion when writing a message or contact. The most commonly used insertion type is Abc where the first letter after the full stop will always be uppercase.

### **Display**

Allows you to customise your phone's standby display wallpaper settings, auto key lock, and welcome and shutdown animation.

### **Navigation Keyboard**

You can change the speed dial assignment for the navigation keys in standby mode (up, down, right, left).

## **Aircraft Mode**

The aircraft mode is used to turn off all of the phone's transmission and reception modes (such as turning off the GSM/GPRS and Bluetooth signals).

**Attention:** Do not use this function during flight, switch off the whole device.

## **Other Settings**

LCD backlight. Here you can set the LCD brightness change and the time of illumination period. Use the left and right arrows, the function selection is done with the up and down arrows.

## **Network Settings**

Select the SIM card on which you want to make the network setting change. Always consult with your network operator to make the change

## **Security Settings**

- This contains the item to set individual SIMs and the phone security:
- PIN: offers PIN activation/deactivation.
- Change PIN: allows you to change the PIN settings.
- Change PIN2: allows you to change the PIN2 settings.
- Phone security: allows you to activate or deactivate the phone lock. The default password is "1122"
- Change password: this allows you to change your phone password.
- Privacy: you can set to use a phone lock to open selected functions.

## **Connection**

### **SIM Data Connection**

Select the SIM card that will be active for data services.

### **Data Accounts**

It is possible to set the necessary values for data transfer for each SIM card. The parameters for data transfer settings are pre-set for most operators, if the Internet connection is not functional contact your network operator to check the entered values.

### **Restoring Settings**

You can restore some of your phone's settings to their default values. The initial code to restore the factory settings is as follows: "1122"

**Caution:** restoring the factory settings may lead to losing the stored settings and data.

## **Organiser**

### **Bluetooth**

**Bluetooth:** If the Bluetooth connection is enabled, further Bluetooth setting options can be edited. To activate/deactivate Bluetooth, use the first "Bluetooth" item by pressing the left soft key "On" / "Off".

**Visibility:** You can choose if your phone will be visible or hidden during the Bluetooth connection. If the Bluetooth visibility is disabled, other devices will be unable to discover your phone.

**My device:** A list of already paired devices is shown here. You can search for other Bluetooth devices and find compatible ones. If the pairing passwords of two devices are identical, the pairing will be successful. Some Bluetooth devices (such as Bluetooth headphones) have their pairing connection code preset. To find this code, please refer to the appropriate device's user manual.

**Search for audio devices:** a function that searches for possible connections to available audio devices.

**Name of the device:** Default: P013 – this name will be displayed for other devices. It can be changed as required.

**Caution:** Connection to audio devices is limited and the transmitted sound may not be of good quality. This is an optional feature.

### **Advanced**

**Audio path:** select whether the audio should be sent to the BT audio device or played from the phone.

**Memory:** select the memory to store the received files. Set the memory card if inserted.

### **Lamp**

Allows you to control the lamp located at the top of the phone. You can also enable/disable the lamp by pressing and holding the “O” key on the phone’s standby screen.

**Caution:** Never aim the lamp directly into anyone’s eyes. Should the light beam aim directly into your eyes, turn away your eyes immediately. Do not use any magnifying devices along with the lamp that would amplify the light beam.

### **Calculator**

This function allows you to perform simple mathematical operations. To control, please use the navigation arrow keys and the centre key according to the display hint.

### **Calendar**

You can use this function to display the calendar days easily. Press the up/down/left/right arrow keys to go to another date.

### **Alarm Clock**

You can make presets of several enabled or disabled alarm clocks. For each alarm clock, please select if it’s to be enabled or disabled. Press the centre OK key to enter in the selected alarm clock edit mode. In the edit mode, you can use the arrow buttons to move up or down and go to other options. With the cursor on the desired item, you can press the left/right buttons to select the change options with some items (such as hours and minutes of the wake-up time). With other items (usually marked with a drop-down list icon), press “OK” and then select one of the displayed options.

### **World Time**

This function allows you to display the current time in the selected cities.

## **Entering Text**

The unit offers several text input modes to allow you to enter text or data into your contacts, edit contact entries, search for names and type SMS messages.

If you want to change the input method in the “text input” mode, press the “#” button. The selected text input mode appears at the top of the screen.

### **Letters (upper case, normal)**

Enter the editing page, press the “#” button and switch the input mode to “letters” (such as “Cz”), then use the numeric buttons and the selected numbers will appear on the screen.

Press the numeric button once to enter the first letter shown on the button, and press twice quickly to enter the second letter. If the letter to be entered is located on the same button as the previous letter, wait for the cursor to reappear and then input the next letter.

If you want to enter “ok”, for example, you must press the “6” button three times to input “o”, then press the “5” button twice and the display will show “k”. Press the right soft button to delete the entered text.

### **Numbers**

Enter the edit mode and press “\*” to switch the input method to “numbers” (such as “123”). Then use the numeric buttons and the display will show the relevant numbers. Individual 0-9 buttons represent the numbers from 0 to 9. After entering the desired number, you can press the relevant button. Press the right soft button to delete the input number.

To input the punctuation marks in letter mode, use the selection by pressing the \* button. To speed up the selection, you can use the “1” key (press repeatedly). To insert a space in text in the letter mode, press the “O” key.

## **Care and Maintenance**

### **Battery Care**

- The unit is powered from the battery. The battery must be recharged when flat. To reach the maximum power of a new battery, only charge a fully flat battery.
- Disconnect the charger from the main socket and the unit if it’s not to be used. Do not let a fully charged battery

be charging longer than it's necessary. Overcharging may lead to shortening the battery's lifetime.

- The temperatures influence the level to which the battery can be charged. Therefore, the battery must be left at room temperature before charging. The battery cannot be charged if its temperature exceeds 40 °C. Use the battery only for the intended purpose and prevent it from short-circuiting. A random short-circuit may occur if a metallic object causes a direct connection between the positive (+) and negative (-) battery contact.
- Do not use a damaged battery.
- Do not leave the battery at hot or cold locations. This will shorten its capacity and lifetime. A unit with a hot or cold battery may not function temporarily even if the battery is fully charged.
- Do not put the batteries in fire as they may explode. Please dispose under local regulations.
- The following recommendations will help you to extend your phone's lifetime.
- Keep the unit and accessories out of the reach of small children.
- Keep your device dry. All kinds of fluids and humidity will lead to electronic circuitry malfunction.
- Avoid keeping the unit in rooms with high ambient temperatures. High temperatures may shorten the lifetime of electronic devices and deform or melt some plastics.
- Do not attempt to open the unit differently than is described in this manual. Unprofessional handling may lead to damaging the unit.
- When cleaning the unit, do not use aggressive chemicals or strong cleaning agents.

**Attention:** Use only the supplied or approved replacement accessories. Using non-original accessories may lead to the phone malfunction and void the warranty.

## Technical Specifications

### FM radio:

### Display

- **Size:** 1,77" TFT
- **Resolution:** 160 × 128
- **Chipset**
- **CPU:** MT6261D

### Memory

- Operating memory: 32MB
- ROM: 32MB
- Micro SDHC card slot (up to 32 GB)

### Video recorder

- Rear: 0.08 Mpx (VGA)

### Network/connectivity

- DUAL SIM
- GSM bands 850/900/1800/1900 MHz

- Bluetooth 3.0

## Features

- Lamp
- FM radio
- Vibration ringing
- Video and music player
- Keyboard lock

## Other

- Micro USB
- Rechargeable battery: Li-Ion 600 mAh
- Dimensions: 114 × 48 × 14.2 mm
- Weight: 75 g
- Accessories: Charging adapter, instruction manual

<b>FM radio</b>	Band range	87.5MHz – 108MHz
<b>GSM/OCS</b>		gsm850:824mhz-894mhz gsm900:880mhz-960mhz dcs1800:1710mhz-1880mhz pcs1900:1850mhz-1990mhz
<b>Bluetooth</b>	Version	3.0
	Maximum Transmitter Power	100mW @ 2.4GHz – 2.4835GHz

<b>Value and accuracy</b>	
<b>Manufacturer's name or trademark, company ID and address</b>	Shenzhen TongLiJi a Wire Rod Co.,Ltd 7th Floor, Building B, No. 38, Zhuao Third Industrial Zone, Gushu, Xixi ang, Baoan District, Shenzhen
<b>Madel identification code</b>	YHD-188-DSIJSOOM
<b>Input voltage</b>	AC100-241JV
<b>Input frequency</b>	50/E,D Hz
<b>Output voltage</b>	SV
<b>Output current</b>	0.S A
<b>Output power</b>	2.S W
<b>Average efficiency in active made</b>	70%
<b>Efficiency at law load (10%)</b>	/%
<b>Na load power consumption</b>	IJ.07W

## INSTRUCTIONS AND INFORMATION ON DISPOSING OF USED PACKAGING MATERIALS

Dispose of used packaging material at a site designated for waste in your municipality.

## DISPOSING OF USED ELECTRICAL AND ELECTRONIC EQUIPMENT

This symbol on products or original documents means that used electric or electronic products must not be added to ordinary municipal waste. For proper disposal and recycling, take these products to designated collection points. Or in some European Union states or other European countries the products can be returned to the local retailer when buying an equivalent new product. Disposing of this product correctly helps save valuable natural resources and prevents damage to the environment by improper waste disposal. Ask your local authorities or collection facility for more details. In accordance with national regulations penalties may be imposed for the incorrect disposal of this type of waste.



### For business entities in European Union states

If you want to dispose of electric or electronic devices, ask your retailer or supplier for the necessary information.

### Disposal in other countries outside the European Union

This symbol is valid in the European Union. If you wish to dispose of this product, request the necessary information about the correct disposal method from the local council or from your retailer.



- FAST CR a.s. hereby declares that the radio equipment type P013 complies with the Directive 2014/53/EU.
- For full version of the EU declaration of conformity, please refer to [www.sencor.eu](http://www.sencor.eu) website.
- The text, design and technical specifications may be changed without prior notice and we reserve the right to make these changes.
- The original version is in the Czech language.
- Manufacturer's address: Fast CR, a. s., U Sanitasu 1621, CZ 251 01 Ricany, Czech Republic

## **Warranty Conditions**

### **Warranty card is not a part of the device packaging.**

This product is warranted for the period of 24 months from the date of purchase to the end-user. Warranty is limited to the following conditions. Warranty is referred only to the customer goods using for common domestic use. The claim for service can be applied either at dealer's shop where the product was bought, or at below mentioned authorized service shops. The end-user is obligated to set up a claim immediately when the defects appeared but only till the end of warranty period. The end user is obligated to cooperate to certify the claiming defects. Only completed and clean (according to hygienic standards) product will be accepted. In case of eligible warranty claim the warranty period will be prolonged by the period from the date of claim application till the date of taking over the product by end-user, or the date the end-user is obligated to take it over. To obtain the service under this warranty, end-user is obligated to certify his claim with duly completed following documents: receipt, certificate of warranty, certificate of installation.

### **This warranty is void especially if apply as follows:**

- Defects which were put on sale.
- Wear-out or damage caused by common use.
- The product was damaged by unprofessional or wrong installation, used in contrary to the applicable instruction manual, used in contrary to legal enactment and common process of use or used for another purpose which has been designed for.
- The product was damaged by uncared-for or insufficient maintenance.
- The product was damaged by dirt, accident of force majeure (natural disaster, fire, and flood).
- Defects on functionality caused by low duality of signal, electromagnetic field interference etc.
- The product was mechanically damaged (e.g. broken button, fall).
- Damage caused by use of unsuitable media, fillings, expendable supplies (batteries) or by unsuitable working conditions (e.g. high temperatures, high humidity, quakes).
- Repair, modification or other failure action to the product by unauthorized person.
- End-user did not prove enough his right to claim (time and place of purchase).
- Data on presented documents differs from data on products.
- Cases when the claiming product cannot be identified according to the presented documents (e.g. the serial number or the warranty seal has been damaged).

## **CONTACT**

### **Manufacturer**

- FAST ER, a.s., U Sanitasu 1621, Ricany 251 01, Czech Republic
- Visit [www.sencor.com](http://www.sencor.com) for detailed information about authorized service centers.
- The original version of the instructions is in the Czech language, other language versions are made by the appropriate translation.

---

## Documents / Resources

 <p><b>SENCOR</b> Element PO13</p> <p>EN • User Manual CZ • Uživatelská příručka SK • Používateľská príručka PL • Podręcznik użytkownika</p> <p>MOBILE PHONE MOBILE TELEPHONE MOBILE TELEPHONE MOBILE TELEPHONE TELEPHONE (MOBILE)</p>	<p><a href="#">SENSOR PO13 Keypad Phone</a> [pdf] User Manual PO13 Keypad Phone, PO13, Keypad Phone, Phone</p>
---	--

## References

- [User Manual](#)

### Manuals+ Privacy Policy

This website is an independent publication and is neither affiliated with nor endorsed by any of the trademark owners. The "Bluetooth®" word mark and logos are registered trademarks owned by Bluetooth SIG, Inc. The "Wi-Fi®" word mark and logos are registered trademarks owned by the Wi-Fi Alliance. Any use of these marks on this website does not imply any affiliation with or endorsement.