

ER-A

**Indoor Recessed
PIR Infrared
Motion Sensor
Head**



ER-A Indoor Recessed PIR Infrared Motion Sensor Head Owner's Manual

[Home](#) » [Sensor](#) » ER-A Indoor Recessed PIR Infrared Motion Sensor Head Owner's Manual 

Contents

- [1 ER-A Indoor Recessed PIR Infrared Motion Sensor Head](#)
- [2 Product Usage Instructions](#)
- [3 FAQ](#)
- [4 Product Information](#)
- [5 Wiring Diagram](#)
- [6 Sensing head installation](#)
- [7 Sensing head application](#)
- [8 Installation precaution](#)
- [9 Documents / Resources](#)
 - [9.1 References](#)

ER-A

ER-A Indoor Recessed PIR Infrared Motion Sensor Head

**Specifications:**

- Product Name: ER-A PIR Motion Sensing Head Sensor
- Power Supply: AC100-240V, 12-24VDC Constant Voltage
- Output Current: 8A
- Wire Length: 1 meter
- Operating Voltage: 12-24VDC
- Signal Input: 5V level signal

Product Usage Instructions**Sensing Head Installation:****Wall Mounting:**

- Diameter: 1.2~1.5m

Ceiling Mounting:

- Height: 1~1.5m
- Diameter: 1.2~1.5m

Sensing Head Application:**Functionality:**

- Not in sensing range: Light is off
- Entering the sensing range: Light turns on
- Out of the sensing range: Light turns off after 30 seconds

Installation Precaution:

1. Recommended for wall mounting.
2. Avoid direct sunlight exposure to prevent interference signals.
3. Install in a dry environment away from windows, air conditioners, and fans.
4. Avoid heat sources like kitchen appliances, walls in direct sunlight, and heating elements.
5. Recommended installation height: Wall-mounted 1-1.5 meters, Ceiling-mounted no more than 3 meters.
6. Avoid placing any shelter (screen, furniture, large bonsai) within the detection range.

FAQ

- **Q: What should I do if the light does not turn on when someone enters the sensing range?**
 - **A:** Check the power supply connection and ensure that the sensing head is properly installed within the specified range.
- **Q: Can I adjust the duration for which the light stays on after someone exits the sensing range?**
 - **A:** No, the light is designed to turn off after 30 seconds once the sensing range is exited.

PIR Motion Sensing Head

Product Information

- Concealed PIR motion sensing head.
- Sensor head detection distance: 3-4 meters, detection angle: 120°.
- Powered by low voltage 5VDC, output 5V level signal.
- Bilateral snap design for easy installation.
- Used for lighting stairs, garages, cabinets, closets, wine cabinets and more.

Wiring Diagram

- Power supply using constant voltage power supply + junction box

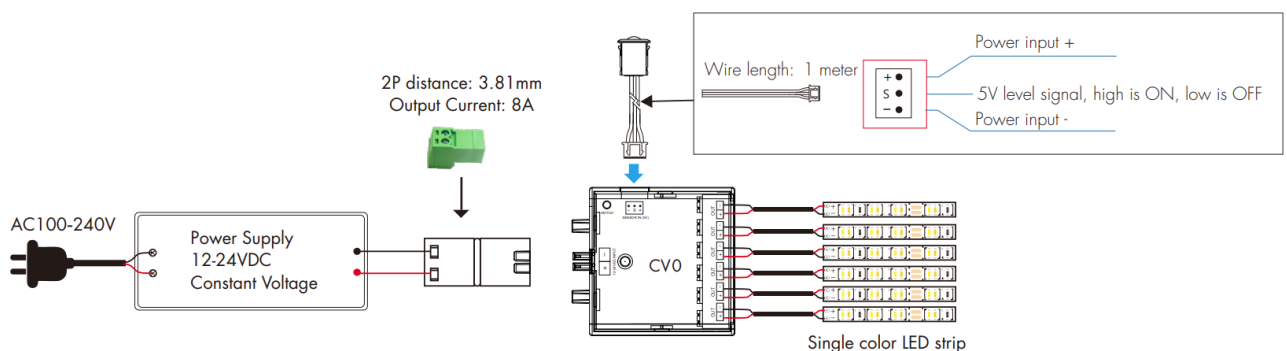

- Power supply using cabinet constant voltage power supply + junction box

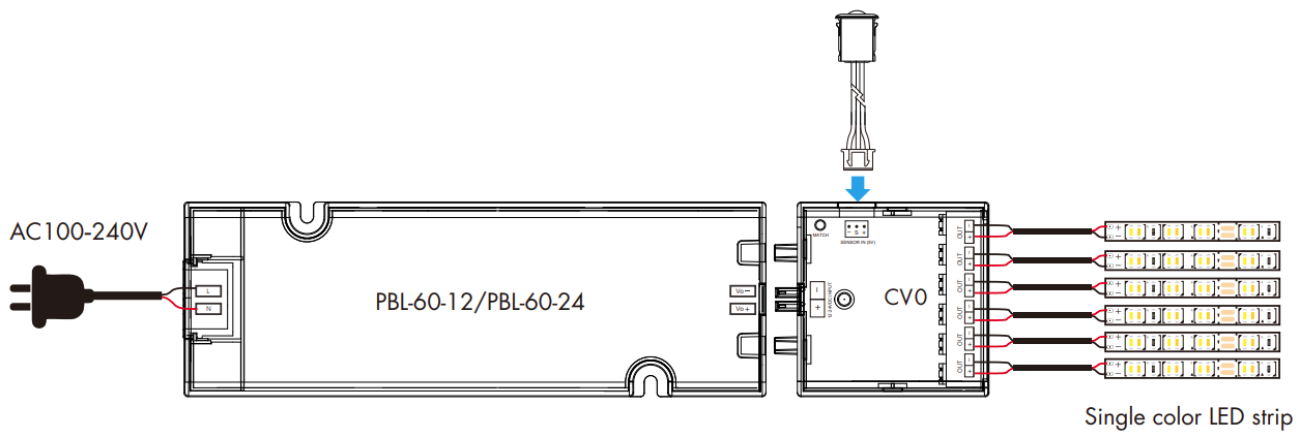

Sensing head installation

Wall mounting:

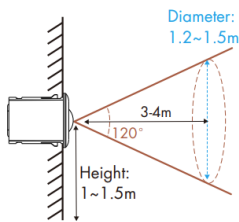

Ceiling mounting:

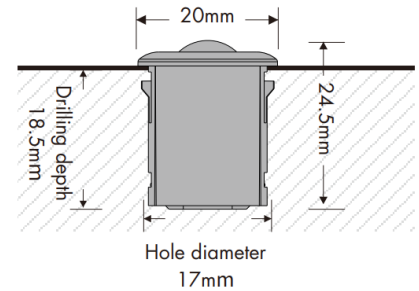
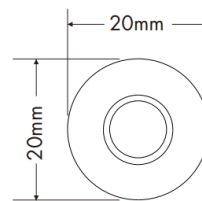
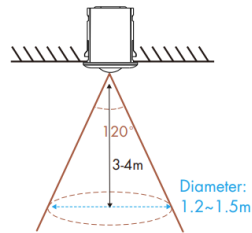

Sensing head application

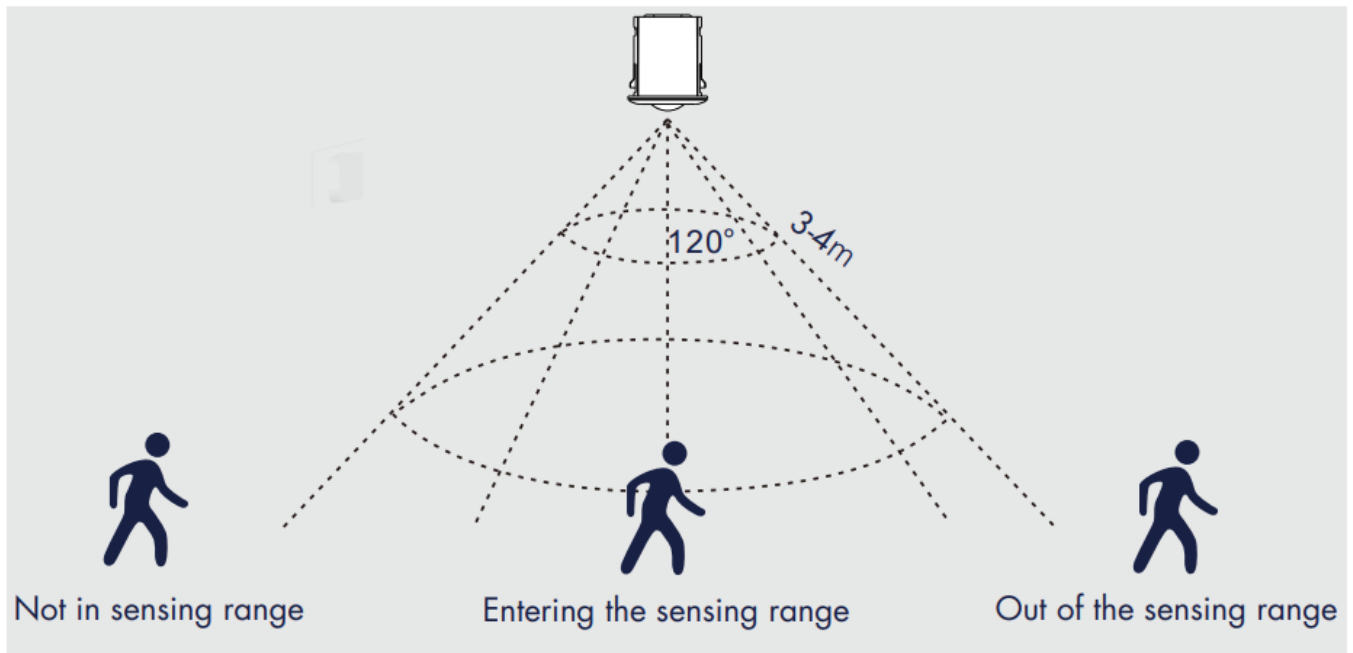

- When people enter the sensing range, the light turn on; when people exit the sensing range, the light turn off after 30 seconds.

Installation precaution

1. Recommended for wall mounting.
2. If the sensing head is exposed to direct sunlight, an interference signal will be introduced.

3. The sensing head should be installed in a dry environment and kept away from windows, air conditioners and fans.
4. Make sure that the sensing head stays away from heat sources, such as countertops, kitchen appliances that generate hot steam, walls and windows in direct sunlight, air conditioners, heating, refrigerators, stoves and so on.
5. We recommend the wall-mounted installation height is 1-1.5 meters and the ceiling mounting height is no more than 3 meters.
6. There should not be shelter(screen, furniture, large bonsai) within the range of detection.

Documents / Resources

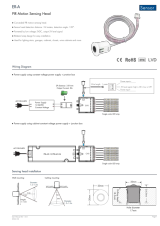
	<p>Sensor ER-A Indoor Recessed PIR Infrared Motion Sensor Head [pdf] Owner's Manual ER-A Indoor Recessed PIR Infrared Motion Sensor Head, ER-A, Indoor Recessed PIR Infrared Motion Sensor Head, Recessed PIR Infrared Motion Sensor Head, PIR Infrared Motion Sensor Head, Motion Sensor Head, Sensor Head</p>
---	---

References

- [User Manual](#)

Manuals+, Privacy Policy

This website is an independent publication and is neither affiliated with nor endorsed by any of the trademark owners. The "Bluetooth®" word mark and logos are registered trademarks owned by Bluetooth SIG, Inc. The "Wi-Fi®" word mark and logos are registered trademarks owned by the Wi-Fi Alliance. Any use of these marks on this website does not imply any affiliation with or endorsement.