



# Sens Design NL-A12 WC Unit Washing machine Installation Guide

[Home](#) » [Sens Design](#) » Sens Design NL-A12 WC Unit Washing machine Installation Guide 

## Sens Design

### Installation Guide

#### Contents

- [1 Installation Steps](#)
- [2 Package Include](#)
- [3 WARNING](#)
- [4 Installation Details](#)
- [5 Documents / Resources](#)
  - [5.1 References](#)

## Installation Steps



## Package Include

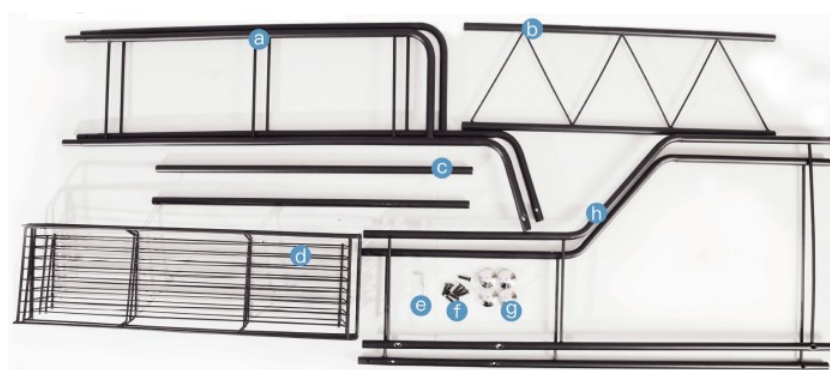

## WARNING

**Warning:** Keep the product away from fire.  
Keep away from children during installation

## Installation Details

Installation order and accessory names are shown on the left.

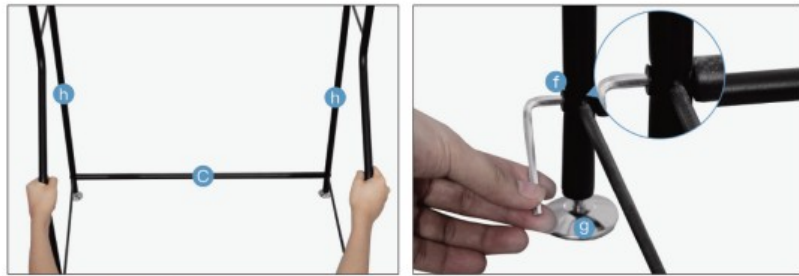

1. Connect c between two h

2. Use e to tight the screws f and install g

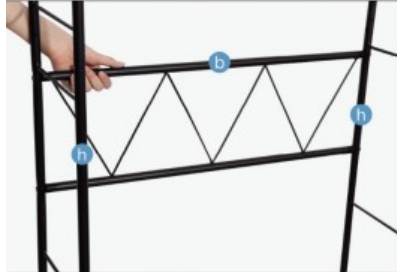

3. Connect b between two h



2. Connect c between two a

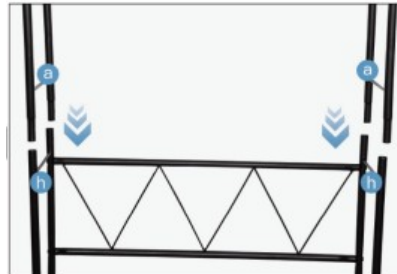

4. Connect a between two h

5. Put the three d into the rack



# Sens Design

## Documents / Resources

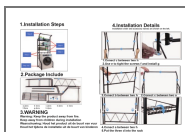

[Sens Design NL-A12 WC Unit Washing machine](#) [pdf] Installation Guide

NL-A12 WC Unit Washing machine, NL-A12, WC Unit Washing machine, Washing machine, machine

## References

- [User Manual](#)

[Manuals+](#), [Privacy Policy](#)

This website is an independent publication and is neither affiliated with nor endorsed by any of the trademark owners. The "Bluetooth®" word mark and logos are registered trademarks owned by Bluetooth SIG, Inc. The "Wi-Fi®" word mark and logos are registered trademarks owned by the Wi-Fi Alliance. Any use of these marks on this website does not imply any affiliation with or endorsement.