



## SENOA SNAS-PP Power Point User Guide

[Home](#) » [SENOA](#) » SENOA SNAS-PP Power Point User Guide 

# SENOA

Let's get connected.  
ACCESSIBILITY RANGE  
Power Point



## Contents

- 1 Important – Read before installing.
- 2 Using the Power Point.
- 3 Connect the wiring.
- 4 Pair and setup with Zima.
- 5 Status Indicator.
- 6 Documents / Resources
- 6.1 References

## Important – Read before installing.



Must only be installed by a LICENSED ELECTRICIAN to local wiring regulations.



Failure to follow these instructions can result in serious injury or death.

Megger testing may lead to low readings due to electronic components so disconnect all electronic devices before taking a reading. Install the included warning sticker with circuit detail in the main electrical switchboard.

### AVOID THE RISK OF ELECTRIC SHOCK

Once the product has been fastened to the wall, ensure the screw caps are inserted firmly into place over the screw mounting holes. (See diagram below)

## Using the Power Point.

### Factory Reset

Press until indicator flashes blue to restore factory settings. When the indicator turns blue, it's ready to pair. *(behind fascia)*



**Screw Cap**  
*(behind fascia)*

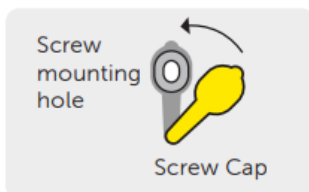

### Status Indicator

See overleaf for the meaning of each colour status.

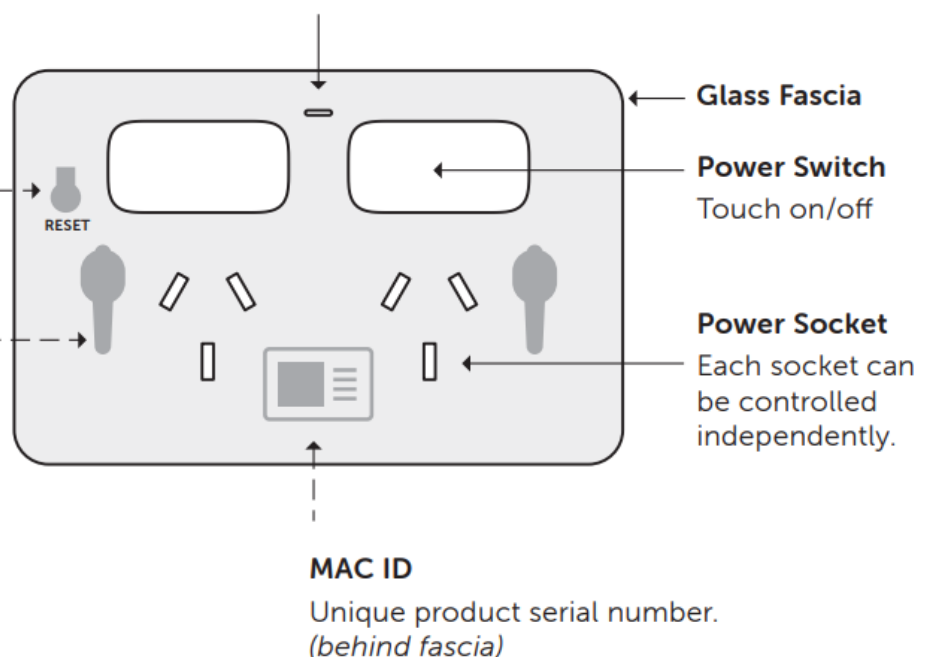

## Connect the wiring.



Surge protection is recommended at the main switchboard. Products damaged by power surges are not covered by warranty.

**Part Number:**

White	SNAS-PP
Black	SNAS-PPBK

**Line Voltage Frequency:**

50Hz Nominal

**Rated Load:**

Maximum Load 10A @ 250V / 2500W

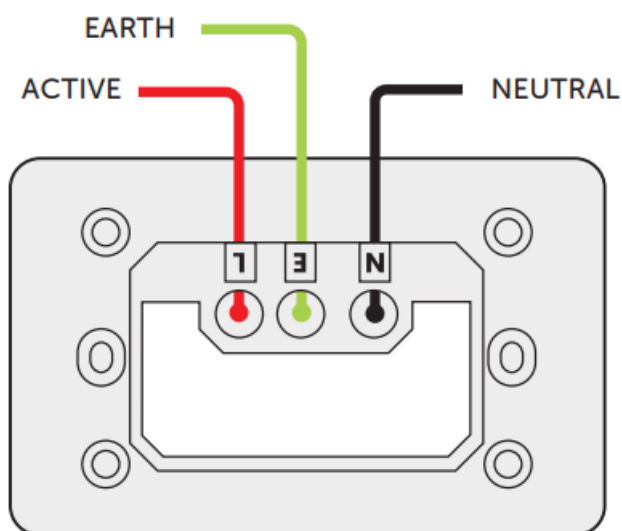
**Pair and setup with Zima.**

- Download the Zima App.
- Choose 'Add Device'.
- Follow the on screen instructions.

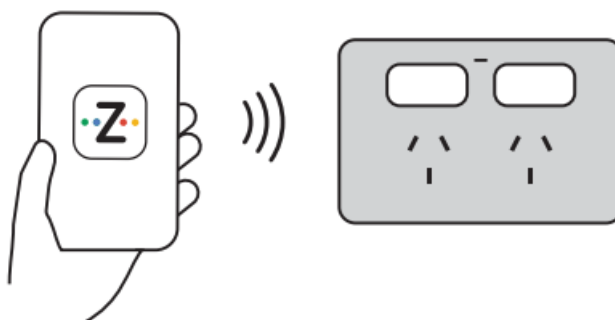
**Download Zima App.**

Point your phone camera at the QR code to open the app store.



<http://onelink.to/arrs92>

### Zimi Cloud Connect.

Enjoy the full experience with all your Zima devices.



Remote access  
anywhere.



Voice control  
hands free.



Sunrise & Sunset  
schedules.







Internet connection required.

Want to learn more or need help?

Enjoy all the features to make your life easier. Visit our website for tips, tricks and help. [support.zimi.life](http://support.zimi.life)

<b>Power Lock</b> Prevent power use at the switch.	<b>Schedules</b> Turn it on and off any day or time.	<b>Energy Use</b> Monitor the power usage and cost.

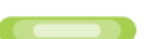
### Status Indicator.

	Blue	<b>Ready to pair.</b> 'Add device' in Zima to pair and complete setup.
	White	<b>Setup is complete.</b> This device has been paired and setup completed.
	White pulsing	<b>Action in progress.</b> This lets you know an automatic function is being activated.
	Blue & White pulsing	<b>Action in progress.</b> This lets you know an automatic function is being activated.
	Green pulsing	<b>Energy alert.</b> This shows the device is using high power.
	Red	<b>Device problem.</b> Please refer to support to resolve the problem.
	Off	<b>Indicator is off.</b> The status indicator can be turned on and off in settings.

**Manufacturer's Warranty** This product has been manufactured to the highest quality standards. This product is warranted to the original purchaser and is not transferable. The product is guaranteed to be free from defects in workmanship and parts for a period of 1 Year from the date of purchase. Defects that occur within this warranty period, under normal use and care will be repaired, replaced or refunded. The benefits conferred by this warranty are in addition to all other rights and remedies of the consumer under a Commonwealth, State and Territory laws in relation to the goods or services to which this warranty relates and Australian Consumer Law. Risk in regard to the product to be repaired shall at all times remain with the Purchaser. The warranty is given on the condition that the product to which it applies is used for the purpose and in the manner intended by its construction and for no other purposes whatsoever. Zima Ltd shall not be responsible for damage of any kind, caused by accidents, power surges, electrical storm damage, incorrect power current, infestation (vermin or insect), incorrect installation, incorrect electricity or plumbing installation, improper use of controls or failure to use the unit in accordance with the operating instructions, general misuse or abuse or from normal wear and tear. Any attempt by an Unauthorised person to repair or tamper with the equipment shall render the warranty null and void. Goods presented for repair under this warranty may be replaced by refurbished goods of the same type rather than being repaired. Refurbished parts may be used to repair the goods. Zima Ltd.'s liability under this warranty is limited to the replacement and/or repair of the defective parts within the warranty period and does not extend to installation or removal of the product. Acceptance of liability by Zima Ltd contained herein is to the exclusion of any other remedy whatsoever and howsoever arising in respect of any equipment to which it applies.

**Proof of Purchase** Please keep your purchase docket or receipt as proof of purchase and as proof of the date on which the purchase was made. The purchase docket or receipt must be presented with the warranty when making a claim under this warranty. Failure to produce documentary proof of the date of original acquisition by the original Purchaser will result in a charge being levied for work done, labor and parts supplied. Likewise a charge will be made for any calls following warranty claim where no fault is found with the unit.

**Service during the warranty period** The first point of contact for product issues is the place of purchase. The product must be returned to the original place of purchase for product repair, replacement or refund. Please ensure the product is properly packaged so as to ensure that no damage occurs to the product during transit and make sure that you have included an explanation of the problem. In the event of goods requiring repair under manufacturer's warranty the owner is responsible for the cost of transportation. Should the goods be found to be in sound working order the owner might be charged a fee. This warranty is given by Zima Ltd, 14 Millennium Circuit, Helens vale, QLD 4212

**Safety Warnings** Read all instructions and safety information. All electrical work must only be undertaken after disconnection of the power by removing fuses or turning off the circuit breaker, to ensure all pole disconnection from the electrical supply. All electrical work must be carried out by a licensed and qualified electrician and in accordance to AS/NZS 3000 Wiring Rules and applicable local authority regulations. This product is not intended for use by persons (including children) with reduced physical, sensory or mental capabilities, or lack of experience and knowledge, unless they have been given supervision or instruction concerning use of the product by a person responsible for their safety. Young children should be supervised to ensure that they do not play with the unit. Do not cut or notch joists, beams and rafters to install the unit. Do not damage hidden electrical wiring or utilities

when cutting. The product must be installed so that switches and other controls cannot be touched by a person in the bath or shower. Do not install the product in a location where water will splash onto it. Check and confirm that all connections are proper and secure to prevent causing property damages or injury. Do not install outdoor where it could be exposed to water or moisture (indoor use only).

**Trademarks** Zima and SENOA and their respective logos are registered trademarks of Zima Ltd. Google and Google Play are trademarks of Google LLC. Amazon, Alexa and all related logos are trademarks of [Amazon.com](https://www.amazon.com), Inc. or its affiliates. Apple, the Apple logo, Apple Watch and iPhone are trademarks of Apple Inc., registered in the U.S. and other countries. App Store is a service mark of Apple Inc., registered in the U.S. and other countries. Copyright © 2022 Zima Ltd. All rights reserved.



## Documents / Resources

A thumbnail image of a user guide for the SENOA SNAS-PP Power Point. The guide is titled "Let's get connected." and "SENOA SNAS-PP Power Point". It includes sections for "Important - Read before installing", "Using the Power Point", "Connect the wiring", and "Pair and setup with Zimi". The guide features diagrams, safety warnings, and a QR code for pairing with the Zimi app.	<p><b>SENOA SNAS-PP Power Point [pdf] User Guide</b> SNAS-PP, SNAS-PPBK, SNAS-PP Power Point, SNAS-PP, Power Point</p>
---	--

## References

- [a Amazon.com. Spend less. Smile more.](https://www.amazon.com)