



SENCORE SCP 2100 Signal Collection Platform User Guide

[Home](#) » [SENCORE](#) » SENCORE SCP 2100 Signal Collection Platform User Guide 



Quick Start Guide Signal Collection Platform – SCP 2100

Contents

- [1 Review package contents](#)
- [2 Installation](#)
- [3 Management](#)
- [4 Documents / Resources](#)
 - [4.1 References](#)
- [5 Related Posts](#)

Review package contents



- SCP 2100
 - Line cord (based on country)
- If anything is missing or damaged please contact your supplier

Installation



- Make all appropriate input or output connections on the back of the unit
- Connect an Ethernet cable from your network to either Network 1 or 2
- Connect the line cord

Management

The SCP 2100 is configured and controlled through either the built-in web interface or through the API. To change the network settings, use the steps below:

- Network 1: DHCP
- Network 2: IP: 10.0.0.72
Subnet: 255.255.255.0
Gateway: 0.0.0.0



1. From the home screen press any button to navigate to the main menu
2. Use the arrow keys to navigate to "Admin", then press OK
3. Use the arrow keys to navigate to "Unit Networking", then press OK
4. Use the arrow keys to navigate to the network interface you wish to configure, then press OK
5. Press OK again
6. Use the arrow keys to navigate to "IP Mode", then press OK
7. Use the arrow keys to select either "Static" or "DHCP", then press OK
8. If set to "DHCP" the unit will now get an IP address from the DHCP server. If set to "Static", use the arrow keys to set the address, pressing OK after each line is configured.
9. Open a web browser and type: `http://<IP Address>`

+1.605.978.4600

www.sencore.com

Documents / Resources

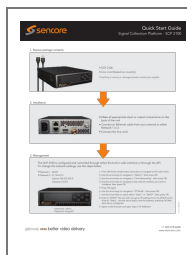

[SENCore SCP 2100 Signal Collection Platform](#) [pdf] User Guide
SCP 2100, Signal Collection Platform

References

- [Sencore - Video Broadcast Equipment Suppliers, Equipment Manufacturers](#)