



# Sena PI Universal Bluetooth Intercom Headset User's Guide

[Home](#) » [Sena](#) » Sena PI Universal Bluetooth Intercom Headset User's Guide 

## Contents

- 1 Sena PI Universal Bluetooth Intercom Headset
- 2 ABOUT pi
- 3 INSTALLING THE HEADSET ON YOUR HELMET
- 4 GETTING STARTED
  - 4.1 Checking the Battery Level
- 5 PAIRING THE HEADSET WITH OTHER BLUETOOTH DEVICES
- 6 MOBILE PHONE USAGE
- 7 BLUETOOTH INTERCOM
- 8 UNIVERSAL INTERCOM
- 9 FUNCTION PRIORITY
- 10 CONFIGURATION SETTING
- 11 TROUBLESHOOTING
- 12 FREQUENTLY ASKED QUESTIONS
- 13 VIDEO – PRODUCT OVERVIEW



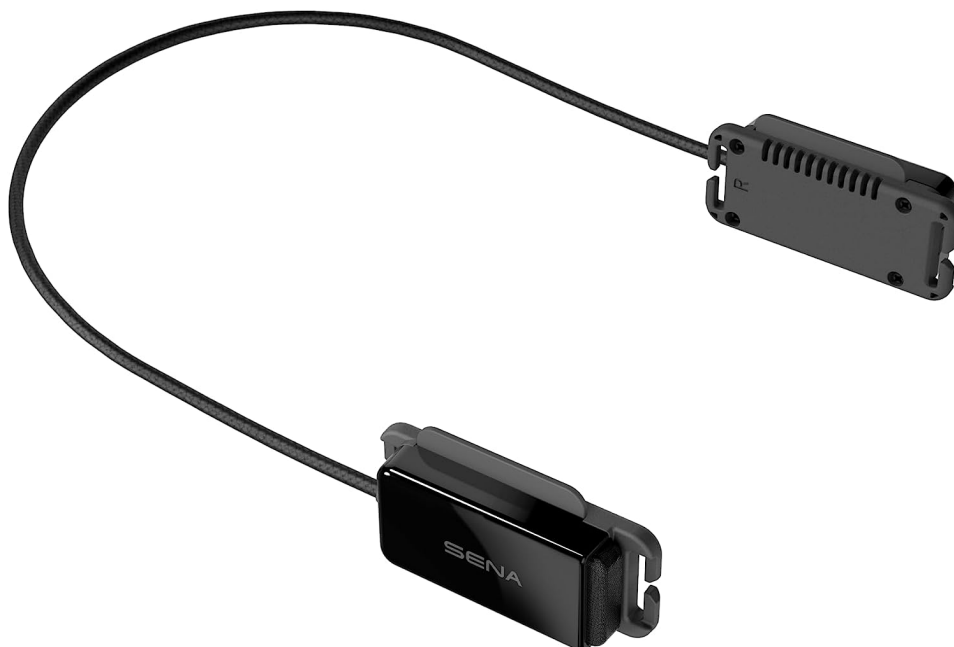

**SENA**

**Sena PI Universal Bluetooth Intercom Headset**



## ABOUT pi

### Product Features

-  Bluetooth® 4.1
-  Two-Way Intercom
-  Intercom up to 400 m (0.2 mi)\*
-  Advanced Noise Control™
-  in open terrain

### Product Details

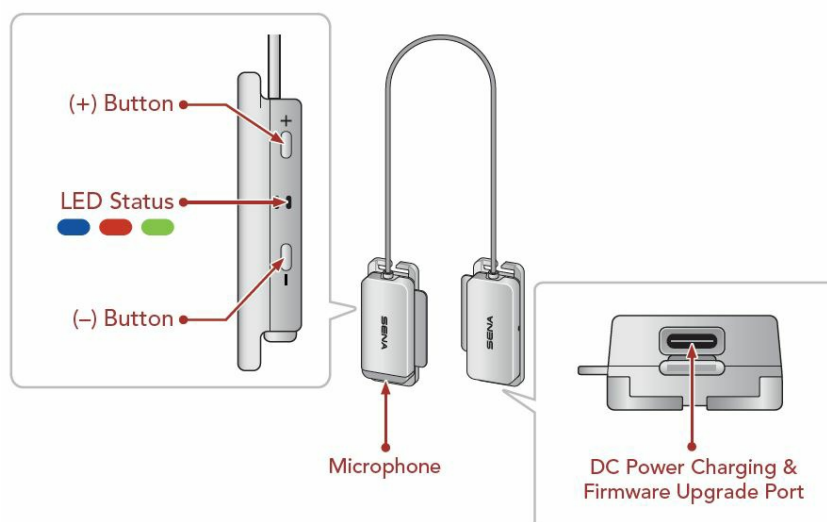



## Package Contents



Headset



USB Power & Data Cable  
(USB-C)

## INSTALLING THE HEADSET ON YOUR HELMET

1. Secure the headset to the chinstrap using the strap hooks on both sides.
2. Slide the headset as close to the helmet as possible.

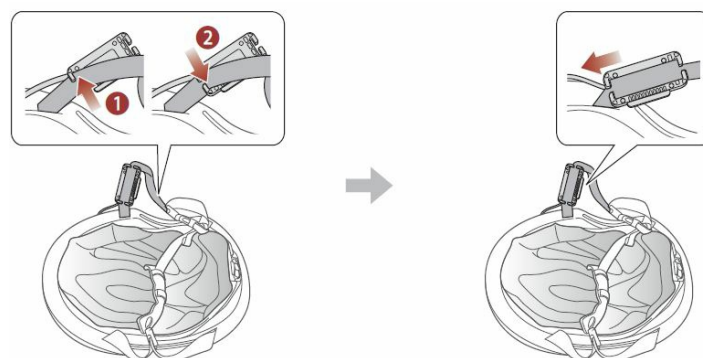

### Note:

- The (R) and (L) markings are located on the back of the headset.
- Make sure that the cable is facing toward the helmet.

1. Hide the cable under the inner pad in the front of the helmet.
2. Adjust the headset upward or downward so that the speakers are facing your ears.

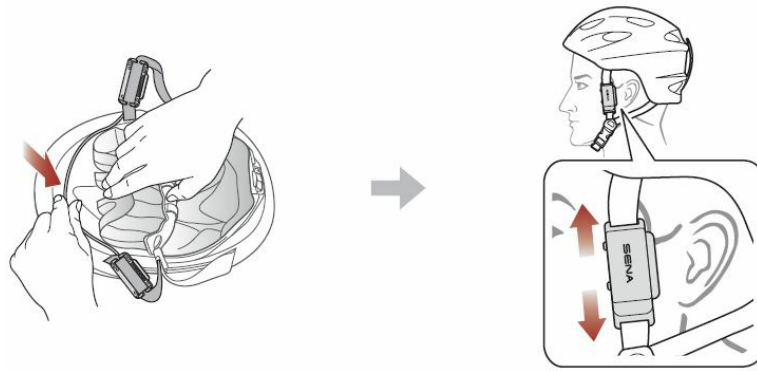

**Note:** The SENA logo will appear as above after proper installation.

## GETTING STARTED

Downloadable Sena Software

### Sena Cycling App

By simply pairing your phone with your headset, you can use the Sena Cycling App for quicker, easier set up and management.



- Download Sena Cycling App on Google Play Store or App Store.

### Sena Device Manager

The Sena Device Manager allows you to upgrade firmware and configure settings directly from your PC.



- Download the Sena Device Manager at [sena.com](http://sena.com).

### Firmware Upgrades

The headset supports firmware upgrades.

Please visit [sena.com](http://sena.com) to check for the latest software downloads.

- Download the firmware at [sena.com](http://sena.com).

### Charging

## Charging the Headset

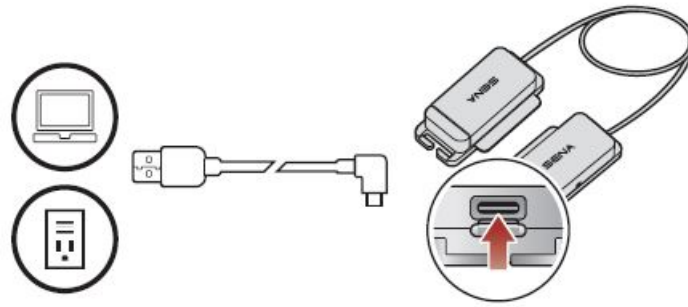

Depending upon the charging method, the headset will be fully charged in about 2.5 hours.

### Note:

- Please make sure to take off your headset while charging. The headset automatically turns off during charging.
- Any 3rd party USB charger can be used with Sena products if the charger is approved by either the FCC, CE, IC or other locally approved agencies that Sena accepts.
- The pi is compatible with 5 V input USB-charged devices only.

## Powering On and Off

### Powering On

- Press and hold the (+) Button and the (-) Button for 1 second.

### Powering Off

- Tap the (+) Button and the (-) Button.

## Checking the Battery Level

There are two ways to check battery level:

### 1. Visual Method

#### Powering On

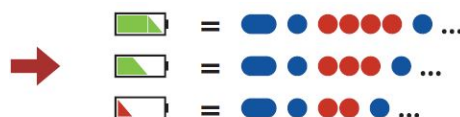

### 2. Audible Method

While the headset is on, press and hold the (-) Button for 3 seconds. ➡ 🔊 “ Battery level is high/medium/low”

### Note:

- The battery performance may be reduced over time with usage.

- Battery life may vary depending on conditions, environmental factors, functions of the product in use, and devices used with it.

## Volume Adjustment

Volume is set and maintained independently at different levels for each audio source, even when the headset is rebooted.

## Volume Up/Down

- Tap the (+) Button or the (-) Button.

## PAIRING THE HEADSET WITH OTHER BLUETOOTH DEVICES

When using the headset with other Bluetooth devices for the first time, they will need to be “paired.” This enables them to recognize and communicate with one another whenever they are within range. The pairing operation is required only once for each Bluetooth device. The headset can pair with multiple Bluetooth devices such as a mobile phone, GPS, or MP3 player via Mobile Phone Pairing and Second Mobile Phone Pairing.

## Phone Pairing

There are three ways to pair the phone.

### Initially Pairing the pi

The headset will automatically enter the phone pairing mode when you initially turn on the headset or in the following situation:

- Rebooting after executing Factory Reset.

1. Press and hold the (+) Button and the (-) Button →  “Phone Pairing” for 1 second.
2. Select pi in the list of Bluetooth devices detected.

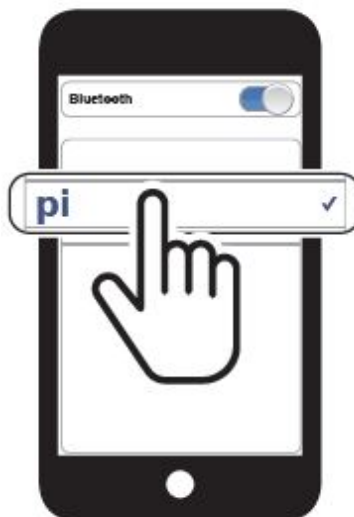

**Note:**

- The phone pairing mode lasts for 3 minutes.
- To cancel pairing, tap the (+) Button or (-) Button.

### Pairing When the pi Is Turned Off

1. While the headset is off, press and hold the (+) Button and the (-) Button
2. Select pi in the list of Bluetooth devices detected.

→  "Phone Pairing" for 5 seconds.

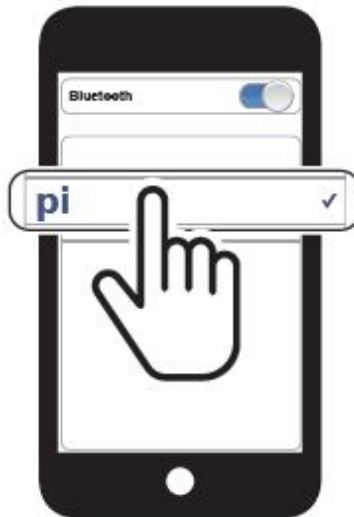

### Pairing When the pi Is Turned On

1. While the headset is on, press and hold the (+) Button for 5 seconds.
2. Select pi in the list of Bluetooth devices detected.

→  "Phone Pairing"

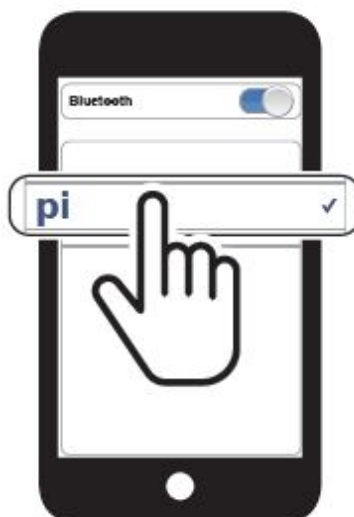

### Second Mobile Phone Pairing – Second Mobile Phone and GPS

1. Press and hold the (+) Button for 10 seconds. →  "Configuration menu"

2. Tap the (+) Button. →  "Second mobile phone pairing"

3. Select pi in the list of Bluetooth devices detected.

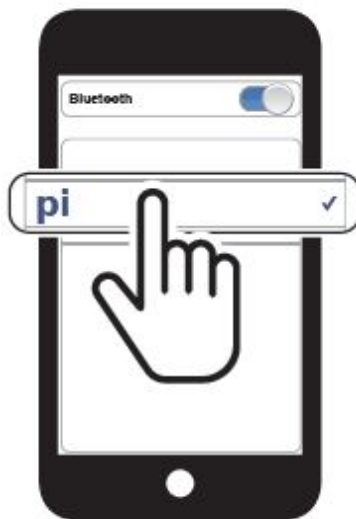

## MOBILE PHONE USAGE

### Making and Answering Calls

- **Answer a Call**

Tap the (+) Button.

- **End a Call**

Press and hold the (+) Button for 2 seconds.

- **Reject a Call**

Press and hold the (+) Button for 2 seconds.

- **Voice Dial**

Press and hold the (+) Button for 3 seconds in stand-by mode.

### Bluetooth Stereo Music

- **Play/Pause**

Press and hold the (+) Button for 1 second.

- **Track Forward**

Press and hold the (+) Button for 2 seconds.

- **Track Backward**

Press and hold the (-) Button for 2 seconds.

## BLUETOOTH INTERCOM

The headset can be paired with another headset for Bluetooth intercom conversation.





### Intercom Pairing

There are two ways to pair the headset.

### Using the Smart Intercom Pairing (SIP)

SIP allows you to quickly pair with your friends for intercom communication by scanning the QR code on the Sena Cycling App without remembering the button operation.

1. Pair the mobile phone with the headset.
2. Open the Sena Cycling App and tap (Smart Intercom Pairing Menu).
3. Scan the QR code displayed on your friend (B)'s mobile phone.

Your friend (B) can display the QR code on the mobile phone by tapping  > QR code (  ) on the Sena Cycling App.



4. Tap Save and check that your friend (B) is paired with you (A) correctly.

**Note:** The Smart Intercom Pairing (SIP) is not compatible with Sena products that use Bluetooth 3.0 or below.

### Using the Button

1. Press and hold the (-) Button on the headsets (A and B) for 5 seconds.

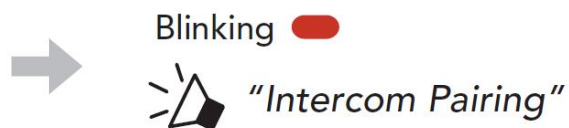

2. The two headsets (A and B) will be automatically paired.

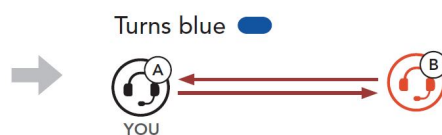

### Two-Way Intercom

Start/End Conversation with the Intercom Friend

- Press and hold the (-) Button for 1 second.

## HD Intercom

HD Intercom enhances the two-way intercom audio from normal quality to HD quality. If this feature is disabled, the two-way intercom audio will change to normal quality.

## UNIVERSAL INTERCOM

Universal Intercom allows you to have Two-way intercom conversations with users of non-Sena Bluetooth headsets. Non-Sena Bluetooth headset can be connected to the Sena headset if they support the Bluetooth Hands-Free Profile (HFP). You can pair the headset with only one non-Sena headset at a time. The intercom distance depends on the performance of the headset to which it's connected. When a non-Sena headset is paired with the headset, if another Bluetooth device is paired via Second Mobile Phone Pairing, it will be disconnected.

### Universal Intercom Pairing

1. Press and hold the (+) Button for 10 seconds to enter the configuration menu. ➡ 🔔 "Configuration menu"
2. Double tap the (+) Button. ➡ 🔔 "Universal intercom pairing"
3. Tap the (-) Button to enter into Universal Intercom Pairing mode.
4. Put the non-Sena Bluetooth headset in Hands-free Pairing Mode. The headset will automatically pair with a non-Sena Bluetooth headset.

### Two-Way Universal Intercom

You can initiate the Universal Intercom connection with non-Sena Bluetooth headsets using the same intercom connection method as you would between other Sena headsets.



You may start/end a Two-Way Universal Intercom using the same way as you do in a normal Two-Way Intercom. Please refer to section 6.2, "Two-Way Intercom".

## FUNCTION PRIORITY

The headset operates in the following order of priority:

- (highest)
  - Mobile phone
  - Bluetooth Intercom
- (lowest)
  - Bluetooth stereo music

A lower priority function is always interrupted by a higher priority function.

## CONFIGURATION SETTING

### Headset Configuration Menu

- **Accessing the Configuration Menu**

Press and hold the (+) Button for 10 seconds.

- **Navigating Between Menu Options**

Tap the (+) Button.

- **Execute Menu Options**

Tap the (-) Button.

Voice Configuration Menu	Tap the (-) Button
Second Mobile Phone Pairing	None
Universal Intercom Pairing	Execute
Factory Reset	Execute
Exit Configuration	Execute

### Software Configuration Setting

You can change the settings of the headset through the Sena Device Manager or the Sena Cycling App.



- **Unit Language**

You can select the device language. The selected language is maintained even when the headset is rebooted.

- **Voice Prompt (Default: Enable)**

You can disable voice prompts by software configuration settings, but the following voice prompts are always on.

- Headset configuration menu

- **Advanced Noise Control™ (Always on)**

The background noise is reduced during an intercom conversation.

## TROUBLESHOOTING

Please visit [sena.com](https://sena.com) for more troubleshooting information.

- **Customer Support: [sena.com](https://sena.com)**

### Fault Reset

When the USB charging & data cable connects a power supply to the headset, the headset will automatically be turned off and a fault reset will occur.

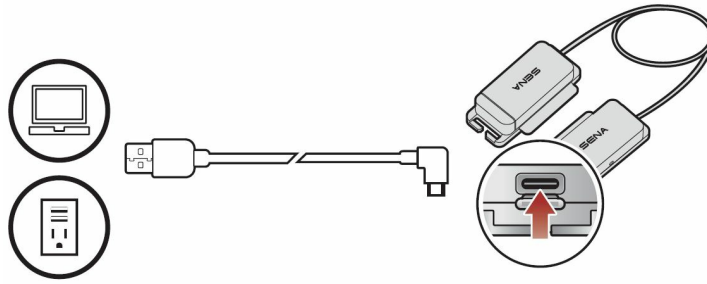

**Note:** Fault Reset will not restore the headset to the factory default settings.

## Factory Reset

To erase all of your settings and start fresh, use the Factory Reset. The headset automatically restores the default settings and turns off.

1. Press and hold the (+) Button for 10 seconds to enter the configuration menu. ➡ 🔔 "Configuration menu"
2. Tap the (+) Button three times. ➡ 🔔 "Factory Reset"
3. Tap the (-) Button to execute Factory Reset. ➡ 🔔 "Headset reset, good-bye"

**Copyright © 2022 Sena Technologies, Inc. All rights reserved.**

- © 1998–2022 Sena Technologies, Inc. All rights reserved.
- Sena Technologies, Inc. reserves the right to make any changes and improvements to its product without providing prior notice.
- Sena™ is a trademark of Sena Technologies, Inc. or its subsidiaries in the USA and other countries. SF1™, SF2™, SF4™, SFR™, SRL™, Momentum™, Momentum INC™, Momentum Lite™, Momentum Pro™, Momentum INC Pro™, Momentum EVO™, Cavalry™, Latitude SR™, Latitude SX™, Latitude S1™, 30K™, 33i™, 50S™, 50R™, 50C™, 5S™, 5R™, 5R LITE™, 20S EVO™, 20S™, 10S™, 10C™, 10C PRO™, ProRide EVO™, 10C EVO™, 10U™, 10Upad™, 10R™, ACS10™, ACS-RAM™, C1™, 3S™, 3S PLUS™, SMH5™, SMH5-FM™, SMH5 MultiCom™, SMH10™, SMH10R™, SPH10™, SPH10H-FM™, Savage™, Prism Tube WiFi™, Prism™, Bluetooth Audio Pack for GoPro®, Impulse™, FURY™, R1™, R1 EVO™, R1 EVO CS™, R2™, R2 EVO™, R2X™, M1™, M1 EVO™, RUMBA™, RC1™, RC3™, RC4™, Stryker™, Handlebar Remote™, Wristband Remote™, PowerPro Mount™, Powerbank™, FreeWire™, WiFi Docking Station™, WiFi Sync Cable™, WiFi Adapter™, +mesh™, +Mesh Universal™, MeshPort Blue™, MeshPort Red™, MeshPort Black™, Econo™, OUTLANDER M™, OUTRUSH™, OUTRUSH R™, OUTSTAR™, OUTSTAR S™, OUTFORCE™, OUTRIDE™, OUTRUSH M™, SPLASH™, EcoCom™, Parani A10™, Parani
- A20™, Parani M10™, pi™, Snowtalk™, Snowtalk2™, SR10™, SR10i™, SM10™, SPIDER RT1™, SPIDER ST1™, X1™, X1 Pro™, X1S™, Expand™, Expand Boom™, Expand Mesh™, Bluetooth Mic & Intercom™, Tufftalk™, Tufftalk Lite™, Tufftalk M™ are trademarks of Sena Technologies, Inc. or its subsidiaries. These trademarks may not be used without the express permission of Sena.
- GoPro® is a registered trademark of Woodman Labs of San Mateo, California. Sena Technologies, Inc. ("Sena") is not affiliated with Woodman Labs, Inc. The Sena Bluetooth Pack for GoPro® is an aftermarket

accessory specially designed and manufactured by Sena Technologies, Inc. for the GoPro® Hero3 and Hero4 allowing for Bluetooth capabilities.

- The Bluetooth® word mark and logos are owned by the Bluetooth SIG, Inc. and any use of such marks by Sena is under license. iPhone® and iPod® touch are registered trademarks of Apple Inc.

**Address:** 152 Technology Drive Irvine, CA 92618

## **FREQUENTLY ASKED QUESTIONS**

What is the Sena PI Universal Bluetooth Intercom Headset?

The Sena PI Universal Bluetooth Intercom Headset is a wireless communication device designed for motorcyclists, enabling them to communicate with other riders, listen to music, take phone calls, and use GPS navigation hands-free.

Is the Sena PI headset designed for motorcyclists only?

While designed with motorcyclists in mind, the Sena PI headset can be used in various scenarios, including cycling, skiing, and other outdoor activities that require communication.

What features does the Sena PI headset offer?

The Sena PI headset offers features like Bluetooth intercom communication between riders, music streaming, phone call integration, voice commands, and connectivity with GPS devices.

How many riders can connect through intercom mode?

The number of riders that can connect via intercom can vary based on the specific model. Some models support communication between two riders, while others support larger groups.

Is the Sena PI headset compatible with other Sena devices?

Yes, the Sena PI headset is generally compatible with other Sena Bluetooth devices, allowing seamless communication between different Sena headset models.

Can I connect the headset to my smartphone via Bluetooth?

Yes, you can connect the Sena PI headset to your smartphone via Bluetooth. This allows you to take calls, stream music, and use navigation features.

Does it have noise-cancelling features?

Many Sena PI models have noise-cancelling features that help reduce wind and background noise, providing clearer communication and audio playback.

How do I install the Sena PI headset on my helmet?

The installation process varies depending on the model, but generally, the Sena PI headset is designed to be attached to the inside of your helmet using adhesive mounts or clamps.

Can I use voice commands with the Sena PI headset?

Yes, some Sena PI models support voice commands, allowing you to control various functions using voice prompts.

What is the battery life of the Sena PI headset?

Battery life varies depending on the specific model and usage. It could range from several hours to a full day of use.

How do I charge the headset?

Most Sena PI headsets come with a charging cable that connects to a standard USB port. You can charge the headset's battery using this cable.

Can I listen to GPS navigation through the headset?

Yes, you can connect the Sena PI headset to your GPS device via Bluetooth and listen to navigation instructions while riding.

Is the headset water-resistant?

Many Sena PI headsets are designed to be water-resistant, making them suitable for use in various weather conditions.

Can I listen to FM radio with the Sena PI headset?

Some Sena PI models offer built-in FM radio capabilities, allowing you to listen to radio stations while riding.

How do I pair the Sena PI headset with other devices?

The pairing process involves putting the headset and the device you want to pair it with into Bluetooth pairing mode and following the instructions provided in the headset's manual.

Can I use the Sena PI headset for group conversations?

Yes, some models support group communication features, allowing multiple riders to communicate simultaneously.

Can I upgrade the firmware of the Sena PI headset?

Yes, Sena often releases firmware updates that can improve performance and add new features. You can usually update the firmware using Sena's Device Manager software.

## VIDEO – PRODUCT OVERVIEW



[Download the PDF link: Sena PI User's Guide](#)  
[Intercom-Headset-Users-Guide.mp4](#)

Manuals+