

Contents [[hide](#)]

- [1 SENA RC4 Handlebar Remote Button Operation](#)
- [2 Specifications](#)
- [3 Handlebar Remote Button Operation](#)
- [4 Music Control](#)
- [5 Information](#)
- [6 Handlebar Remote Button Operation](#)
- [7 Handlebar Remote Button Operation](#)
- [8 FAQs](#)
- [9 Documents / Resources](#)
 - [9.1 References](#)

SENA

SENA RC4 Handlebar Remote Button Operation



Specifications

- Type: Wristband with Handlebar Remote Button
- Basic Functions: Volume adjustment, Configuration menu, Mobile phone pairing, Bluetooth Media selective pairing, Phone selective pairing, Intercom pairing, Music control (Play/pause, Track forward/back, FM radio control)
- LED Indicators: Headset LED for status indication

Handlebar Remote Button Operation

- **Volume Adjustment:** Move the Joystick up or down
- **Configuration Menu:** Press the Side Button for 12 seconds
- **Mobile Phone Pairing:** Press the Joystick for 5 seconds, LED will flash blue & red alternatively
- **Second Mobile Phone Pairing:** Press the Side Button for 5 seconds until LED flashes blue, then tap the Top Button within 2 seconds
- **Bluetooth Media Selective Pairing:** Press the Joystick for 5 seconds until LED flashes red, then tap the Side Button within 2 seconds
- **Phone Selective Pairing:** Press the Joystick for 5 seconds until LED flashes blue, then tap the Top Button within 2 seconds
- **Intercom Pairing:** Press the Side Button for 5 seconds until LED flashes red, then tap the Side Button of any one of the two Handlebar Remotes
- **Answer & End Phone Call:** Tap the Top Button
- **Voice Dial / Speed Dial:** Tap the Top Button or Double tap the Top Button
- **Reject Incoming Call:** Press the Side Button for 2 seconds
- **Start/End Each Intercom:** Tap the Side Button or press the Side Button for 1 second to end all intercoms

Music Control

- **Play/Pause Bluetooth Music:** Press the Joystick for 1 second
- **Track Forward/Back:** Move the Joystick left or right for 1 second
- **FM Radio On/Off:** Press the Top Button for 1 second
- **Select Preset Station:** Tap the Top Button
- **Seek Stations on FM Radio:** Move the Joystick left or right for 1 second or double

tap the Top Button to stop scanning

- **Scan Up FM Band:** Double tap the Top Button to stop scanning or save preset while scanning by tapping the Top Button.

Information

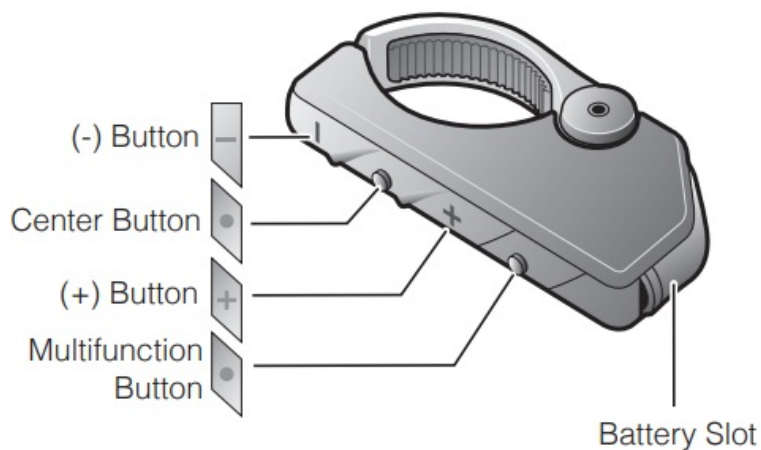

- Installation

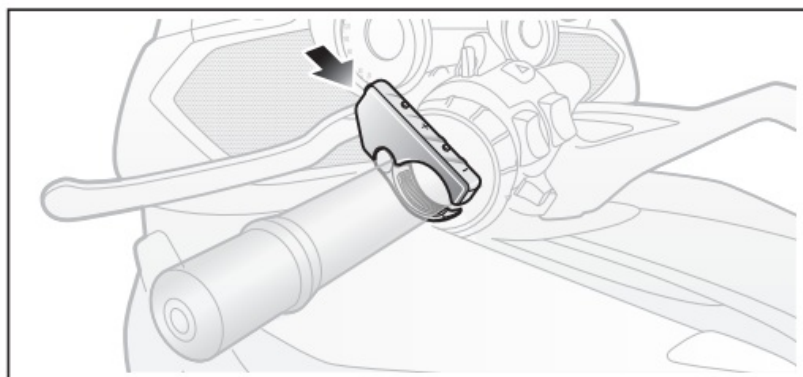

Note:

If your handlebar requires better grip for holding the RC4 in place, apply the rubber band around the handlebar.

- Getting Started

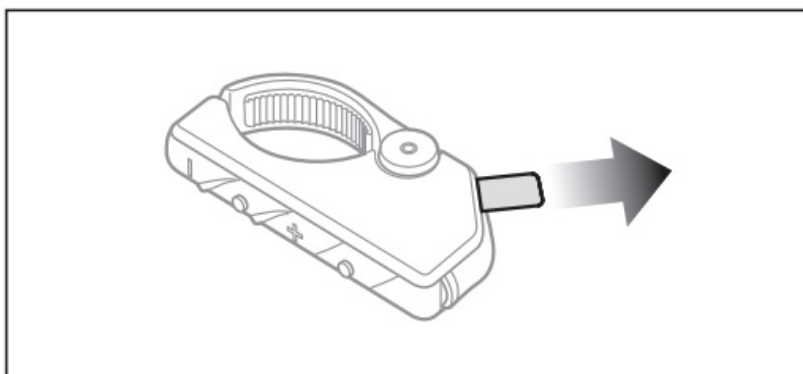

Remove the plastic tape from the battery slot to begin using the RC4.

- Replacing the Battery

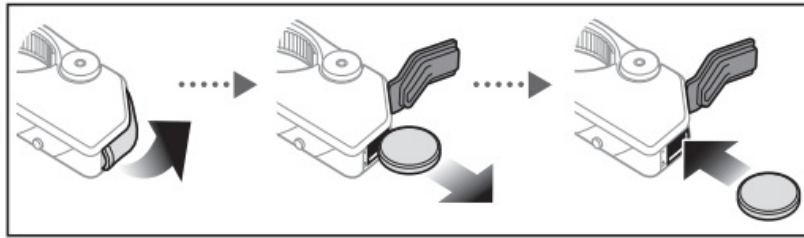

- Button Operation

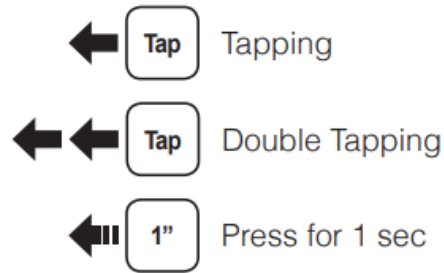

- Power On/Off



Note: You can control the headset using the RC4 only after you pair them together.

The RC4 suppo

- Battery Check

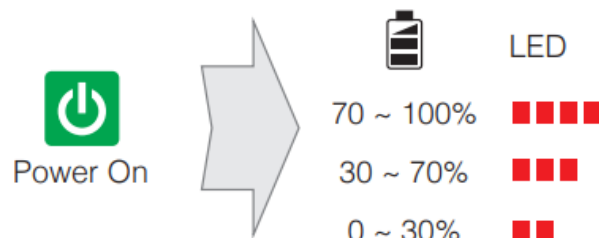

- Bluetooth Pairing

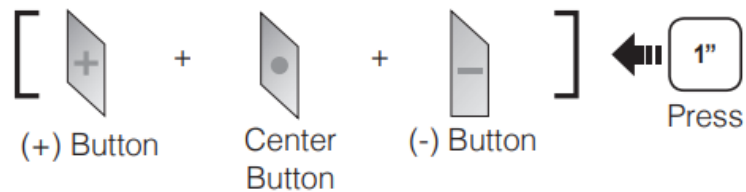

- Factory Reset

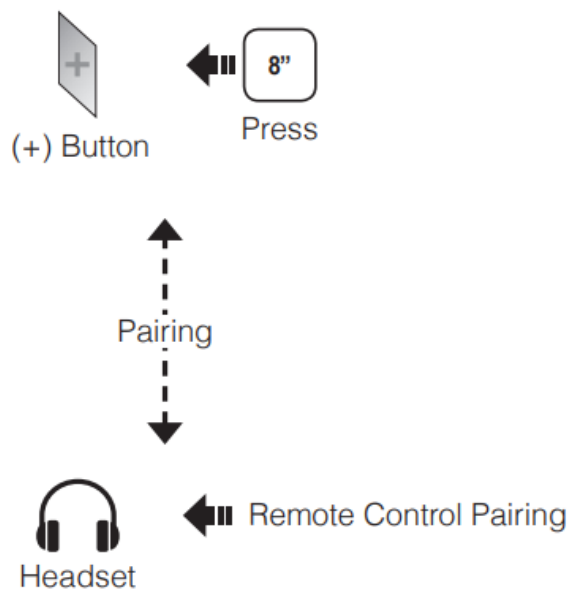

- Headset Control

To control your headset using the RC4, please refer to the Quick Reference Guide for button operations on functions such as phone, music, and intercom.

Note

The Multifunction Button remotely controls special buttons such as the Ambient Mode Button of the 20S and the Camera Button of the 10C. Please refer to the Quick Reference Guide for more details.

Handlebar Remote Button Operation

Type	Operation	Button Command	Headset LED
Basic Function	Volume adjustment	Move the Joystick up or down	—
	Configuration menu	Press the Side Button for 12 seconds	—
	Mobile phone pairing	Press the Joystick for 5 seconds	Blue & red alternatively flashing

Bluetooth Pairing	Second mobile phone pairing	Press the Side Button for 5 seconds	Blue flashing
		Tap the Top Button within 2 seconds	
	Media selective pairing	Press the Joystick for 5 seconds	Red flashing
		Tap the Side Button within 2 seconds	
	Phone selective pairing	Press the Joystick for 5 seconds	Blue flashing
		Tap the Top Button within 2 seconds	
	Intercom pairing	Press the Side Button for 5 seconds	Red flashing
		Tap the Side Button of any one of the two Handlebar Remotes	
Mobile Phone	Answer & end phone call	Tap the Top Button	—
	Voice dial	Tap the Top Button	—
	Speed dial	Double tap the Top Button	—
	Reject incoming call	Press the Side Button for 2 seconds	—
Intercom	Start/end each intercom	Tap the Side Button	—
	End all intercoms	Press the Side Button for 1 second	—

Handlebar Remote Button Operation

Type	Operation	Button Command	Headset LED
Music	Play/pause Bluetooth music	Press the Joystick for 1 second	—
	Track forward/back	Move the Joystick left or right for 1 second	—
FM Radio	FM radio on/off	Press the Top Button for 1 second	—
	Select preset	Tap the Top Button	—
	Seek stations	Move the Joystick left or right for 1 second	—
	Scan up FM band	Double tap the Top Button	—
	Stop scanning	Double tap the Top Button	—
	Save preset while scanning	Tap the Top Button	—



Sena Technologies, Inc.

www.sena.com

Customer Support: support.sena.com

E-mail: support@sena.com

FAQs

How do I pair my mobile phone with the device?

To pair your mobile phone, press the Joystick for 5 seconds until LED flashes blue & red alternatively. Follow on-screen instructions to complete pairing.

How do I control music playback?

To play/pause Bluetooth music, press the Joystick for 1 second. To track forward/back, move the Joystick left or right for 1 second.

How do I end an ongoing intercom session?

To end an ongoing intercom session, tap the Side Button. To end all intercoms, press the Side Button for 1 second.

Documents / Resources

Wristband Quick Reference

Handlebar Remote Button Operation

Button	Function	Operation
Joystick	Play/Pause	Press for 1 second
Joystick	Track Forward	Move right for 1 second
Joystick	Track Backward	Move left for 1 second
Side Button	End Session	Tap
Side Button	End All Sessions	Press for 1 second
Power Button	Power On/Off	Press for 5 seconds
Power Button	Reset	Press for 10 seconds
Power Button	Factory Reset	Press for 15 seconds
Power Button	Bluetooth Pairing	Press for 20 seconds
Power Button	Bluetooth Unpairing	Press for 25 seconds
Power Button	Bluetooth Pairing & Unpairing	Press for 30 seconds
Power Button	Bluetooth Pairing & Unpairing & Reset	Press for 35 seconds
Power Button	Bluetooth Pairing & Unpairing & Reset & Factory Reset	Press for 40 seconds
Power Button	Bluetooth Pairing & Unpairing & Reset & Factory Reset & Power On/Off	Press for 45 seconds
Power Button	Bluetooth Pairing & Unpairing & Reset & Factory Reset & Power On/Off & Reset	Press for 50 seconds
Power Button	Bluetooth Pairing & Unpairing & Reset & Factory Reset & Power On/Off & Reset & Factory Reset	Press for 55 seconds
Power Button	Bluetooth Pairing & Unpairing & Reset & Factory Reset & Power On/Off & Reset & Factory Reset & Power On/Off	Press for 60 seconds
Power Button	Bluetooth Pairing & Unpairing & Reset & Factory Reset & Power On/Off & Reset & Factory Reset & Power On/Off & Reset	Press for 65 seconds
Power Button	Bluetooth Pairing & Unpairing & Reset & Factory Reset & Power On/Off & Reset & Factory Reset & Power On/Off & Reset & Factory Reset	Press for 70 seconds
Power Button	Bluetooth Pairing & Unpairing & Reset & Factory Reset & Power On/Off & Reset & Factory Reset & Power On/Off & Reset & Factory Reset & Power On/Off	Press for 75 seconds
Power Button	Bluetooth Pairing & Unpairing & Reset & Factory Reset & Power On/Off & Reset & Factory Reset & Power On/Off & Reset & Factory Reset & Power On/Off & Reset	Press for 80 seconds
Power Button	Bluetooth Pairing & Unpairing & Reset & Factory Reset & Power On/Off & Reset & Factory Reset & Power On/Off & Reset & Factory Reset & Power On/Off & Reset & Factory Reset	Press for 85 seconds
Power Button	Bluetooth Pairing & Unpairing & Reset & Factory Reset & Power On/Off & Reset & Factory Reset & Power On/Off & Reset & Factory Reset & Power On/Off & Reset & Factory Reset & Power On/Off	Press for 90 seconds
Power Button	Bluetooth Pairing & Unpairing & Reset & Factory Reset & Power On/Off & Reset & Factory Reset & Power On/Off & Reset & Factory Reset & Power On/Off & Reset & Factory Reset & Power On/Off & Reset	Press for 95 seconds
Power Button	Bluetooth Pairing & Unpairing & Reset & Factory Reset & Power On/Off & Reset & Factory Reset & Power On/Off & Reset & Factory Reset & Power On/Off & Reset & Factory Reset & Power On/Off & Reset & Factory Reset	Press for 100 seconds

SENA

[SENA RC4 Handlebar Remote Button Operation \[pdf\]](#) User Guide

RC4 Handlebar Remote Button Operation, RC4, Handlebar Remote Button Operation, Button Operation, Operation

References

- [User Manual](#)

Leave a comment

Your email address will not be published. Required fields are marked *

Comment *

Name

Email

Website

☐ Save my name, email, and website in this browser for the next time I comment.

Post Comment

Search:

e.g. whirlpool wrf535swhz

Search

[Manuals+](#) | [Upload](#) | [Deep Search](#) | [Privacy Policy](#) | [@manuals.plus](#) | [YouTube](#)

This website is an independent publication and is neither affiliated with nor endorsed by any of the trademark owners. The "Bluetooth®" word mark and logos are registered trademarks owned by Bluetooth SIG, Inc. The "Wi-Fi®" word mark and logos are registered trademarks owned by the Wi-Fi Alliance. Any use of these marks on this website does not imply any affiliation with or endorsement.