



SENA 3S PLUS Universal Intercom User Guide

[Home](#) » [Sena](#) » SENA 3S PLUS Universal Intercom User Guide 

Contents

- [1 SENA 3S PLUS Universal Intercom](#)
- [2 Product Information](#)
- [3 Product Usage Instructions](#)
- [4 GETTING STARTED](#)
- [5 Installation](#)
- [6 Basic Operations](#)
- [7 Troubleshooting](#)
- [8 Documents / Resources](#)
 - [8.1 References](#)
- [9 Related Posts](#)

SENA

SENA 3S PLUS Universal Intercom



Product Information

The product is a communication device designed for use during motorcycle rides. It features a boom microphone type and a universal microphone type. It has a status LED, a pin-hole reset button, a DC power charging and firmware upgrade port, and microphone speakers. The product also includes a two-way intercom function with a range of up to 400 meters in open terrain. It is equipped with Advanced Noise Control™ technology to enhance audio quality.

Product Usage Instructions

1. Getting Started:

- Download the full version of the User's Guide from sena.com.
- Update the product firmware for free by visiting sena.com.
- Follow Sena on social media platforms to stay informed about product updates and announcements.

2. How to Use This Guide:

- The legend and callouts provided in the illustrations will help you understand the instructions.
- Perform actions by tapping or holding the specified buttons as indicated.

3. Installation:

- For the Boom Microphone Type:
 1. Attach the wired boom microphone.
 2. Connect the microphone speakers.
 3. Connect the DC power charging and firmware upgrade port.
- For the Universal Microphone Type:
 1. Attach the wired microphone.
 2. Connect the microphone connector speakers.
 3. Connect the DC power charging and firmware upgrade port.

4. Sena Motorcycles App:

- Download the SENA MOTORCYCLES App from Google Play Store or App Store to enhance your experience.

5. Sena Device Manager:

- Download the Sena Device Manager from sena.com to upgrade firmware and configure settings using your PC.

6. Basic Operations:

- Power On: Hold the power button for 1 second.
- Power Off: Tap the power button once.
- Volume Up: Tap the volume up button once.
- Volume Down: Tap the volume down button once.

7. Checking the Battery Level:

- Instruction is for when powering the headset on.
- Visual Method: Hold the power button for 1 second to check the battery level.

8. Phone Pairing:

- To pair with a mobile phone:
 1. Hold the phone pairing button for 5 seconds.
 2. Select “3S PLUS” on your mobile phone’s Bluetooth settings.

9. Mobile Phone:

- Answer a Call: Tap the button once.
- End a Call: Hold the button for 2 seconds.
- Reject a Call: Hold the button for 2 seconds.
- Redial Last Number: Hold the button for 3 seconds.
- Make a Call with the Voice Dialer: Hold the button for 3 seconds.

10. Music Controls:

- Play/Pause: Hold the button for 1 second.
- Next Track: Hold the button for 2 seconds.
- Previous Track: Hold the button for 2 seconds.

11. Bluetooth Intercom:

- The 3S PLUS can be paired with another headset for Bluetooth intercom conversation.
- Intercom Pairing:
 - Using Smart Intercom Pairing (SIP):
 1. Pair your mobile phone with the headset.
 2. Open the SENA MOTORCYCLES App and tap on the Intercom Pairing Menu.
 3. Scan the QR code displayed on your friend’s (B) mobile phone.

Boom Microphone Type

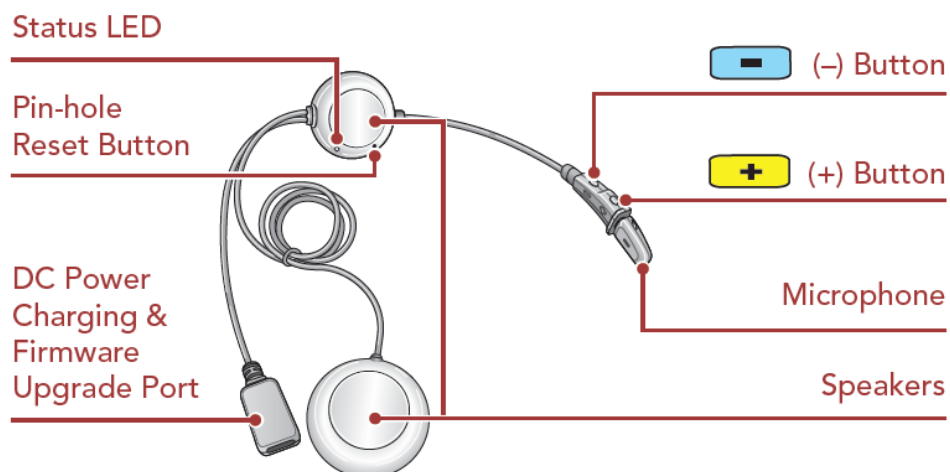

Universal Microphone Type

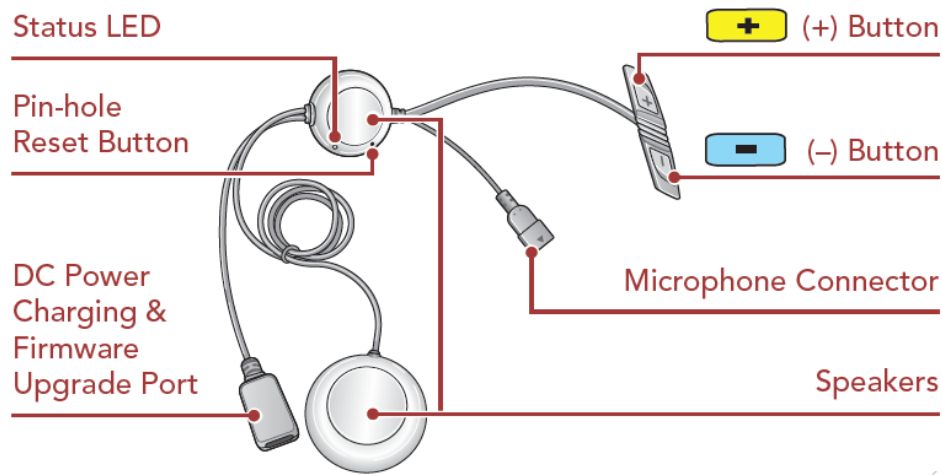

RIDE CONNECTED

Bluetooth® 5.1 advanced signal processing enables the 3S PLUS headset for scooter or motorcycle to deliver incoming and outgoing audio for music, phone calls, GPS directions, and talk over the intercom with your buddies



Bluetooth® 5.1



Two-Way Intercom



Intercom up to 400 m (0.2 mi)*



Advanced Noise Control™

* in open terrain

GETTING STARTED

1. This product comes with a Quick Start Guide, which is a basic version of the User's Guide. A FULL VERSION OF THE USER'S GUIDE CAN BE DOWNLOADED AT [SENA.COM](https://www.sena.com).
2. Update this product for free with the latest firmware to fully enjoy the new advanced features built into this product. Visit [sena.com](https://www.sena.com) to see how to update your product.
3. Users can follow Sena on Facebook, YouTube, Twitter and Instagram to receive the most up to date information on products, helpful tips and all other announcements regarding Sena products.

How to Use This Guide

The legend and callouts are here to help you read the illustrations. New technology can be confusing, but we've created a simple way to perform actions using illustrations.

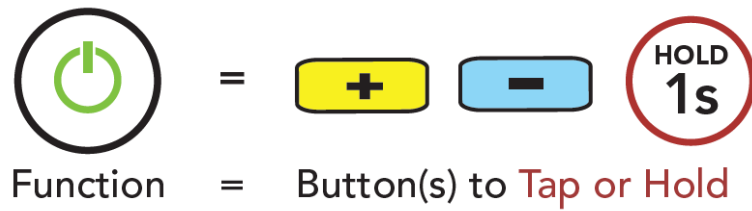

Icon Legend



Tap button the specified number of times



HOLD Press and Hold button for the specified amount of time



“Hello” Audible prompt

Buttons

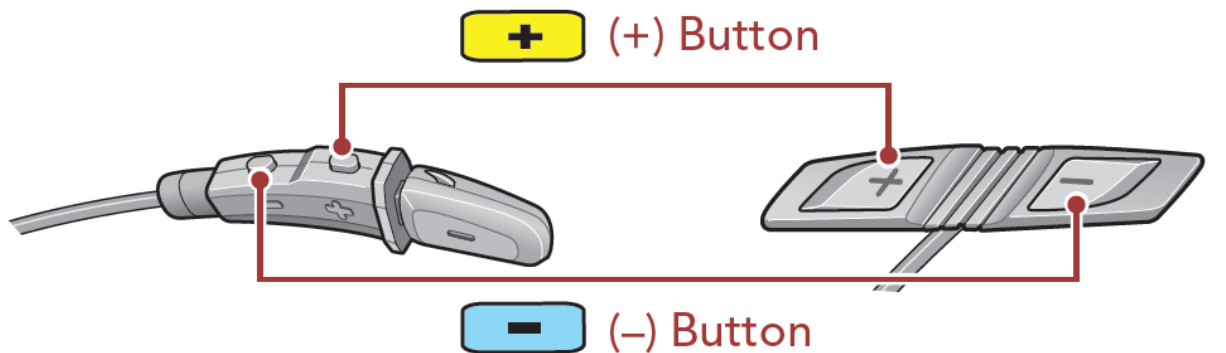

Boom Microphone Type

Universal Microphone Type

Installation

Boom Microphone Type

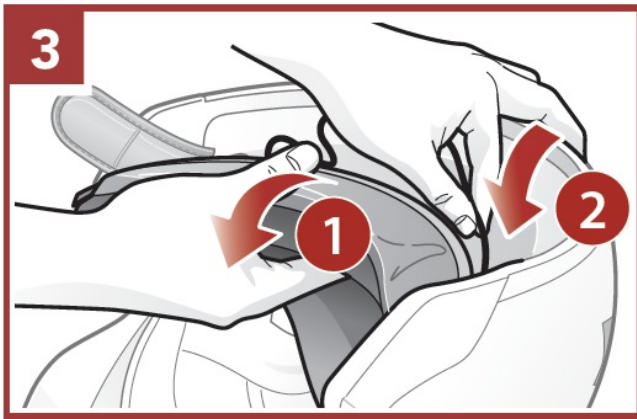
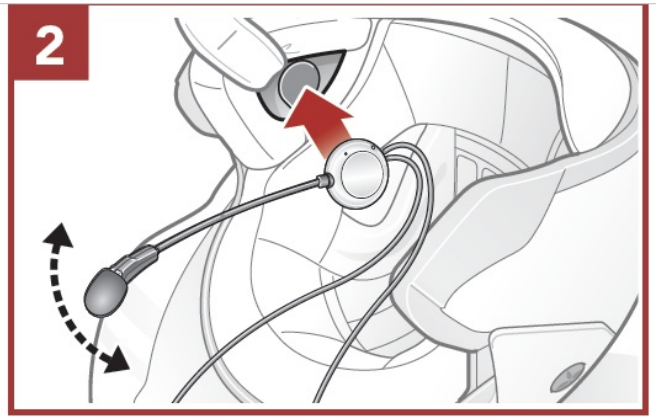
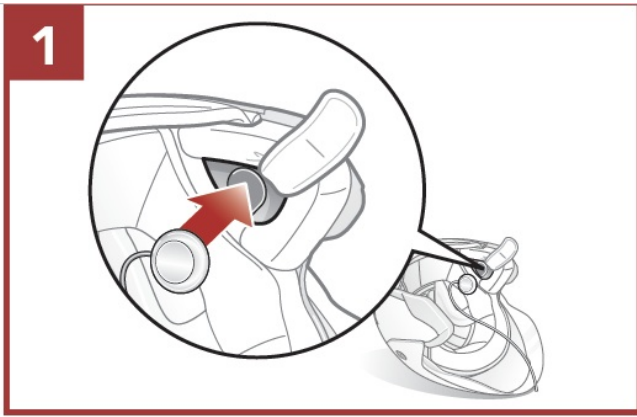

Universal Microphone Type

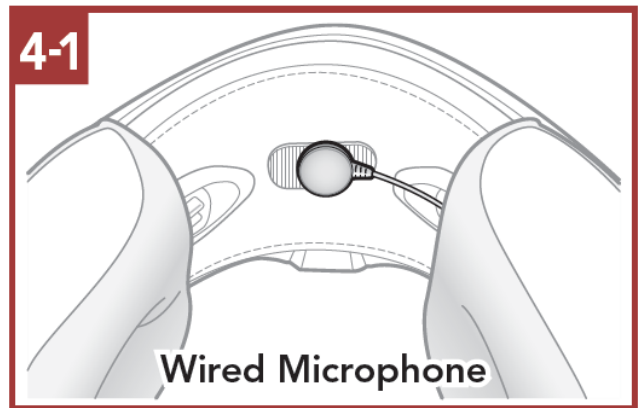
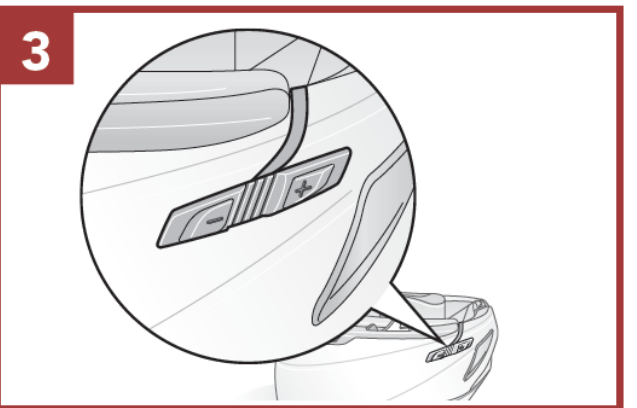
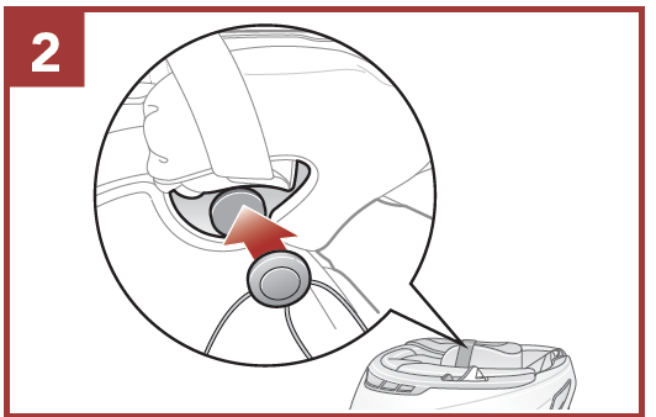
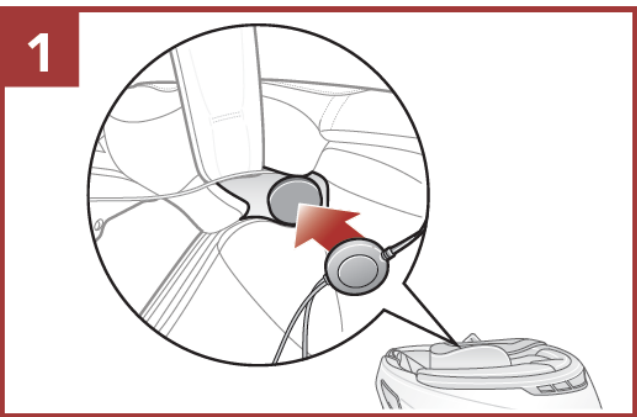

4-2

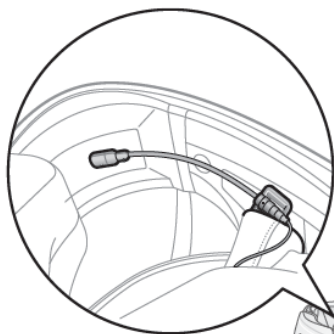

Wired Boom Microphone

5

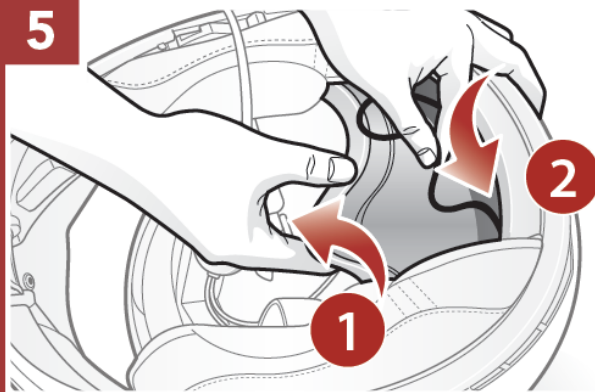
**Sena Motorcycles App**

Download the Sena Motorcycles App on Google Play Store or App Store.

**Sena Motorcycles**

- Device configuration setting

Sena Device Manager

The Sena Device Manager allows you to upgrade firmware and configure settings directly from your PC. Download the Sena Device Manager from sena.com.

NOTICE

- This Quick Start Guide (Version 2.0.0 or higher) explains how to operate the 3S PLUS with firmware version 2.0 or higher.
- For operating the 3S PLUS with a firmware version lower than 2.0, refer to the 3S PLUS Quick Start Guide that is available when you connect the 3S PLUS to the Motorcycles App.

Basic Operations**Power On****Power Off****Volume Up**



Volume Down

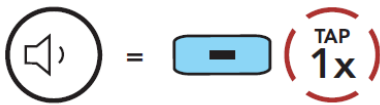

Checking the Battery Level

Instruction is for when powering the headset on.

Visual Method

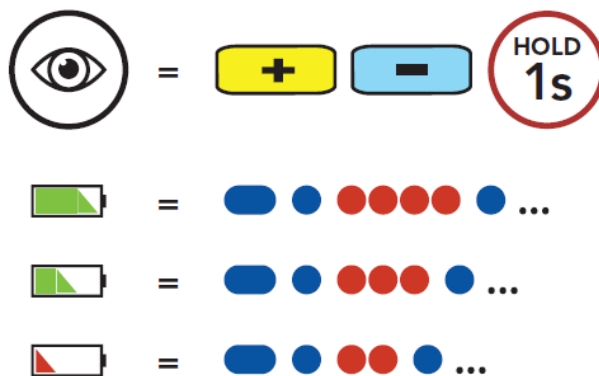

Phone Pairing

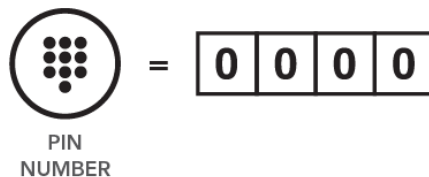
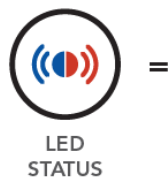

Select **3S PLUS**

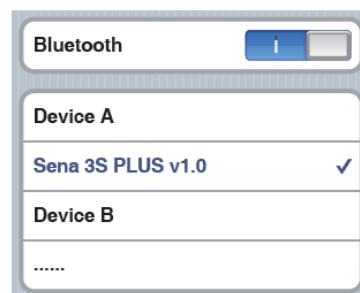

- For more information on phone pairing, refer to the User's Guide.

Mobile Phone

Answer a Call

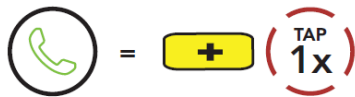

End a Call



Reject a call

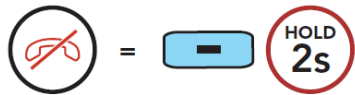

Redial Last Number

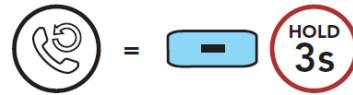

Make a Call with the Voice Dialer



Music Controls

Play/Pause



Next Track

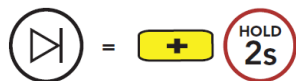

Previous Track

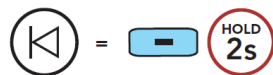

Bluetooth Intercom

The 3S PLUS can be paired with another headset for Bluetooth intercom conversation.





Intercom Pairing

There are two ways to pair the headset.

Using the Smart Intercom Pairing (SIP)

SIP allows you to quickly pair with your friends for intercom communication by scanning the QR code on the Sena Motorcycles App without remembering the button operation.

1. Pair the mobile phone with the headset.
2. Open the Sena Motorcycles App and tap (Smart Intercom Pairing Menu).
3. Scan the QR code displayed on your friend (B)'s mobile phone.

- Your friend (B) can display the QR code on the mobile phone by tapping  > QR code () on the Sena Motorcycles App.

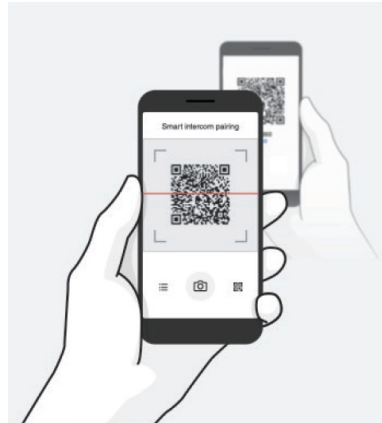

4. Tap Save and check that your friend (B) is paired with you (A) correctly.

Note: The Smart Intercom Pairing (SIP) is not compatible with Sena products that use Bluetooth 3.0 or below.

Using the Button

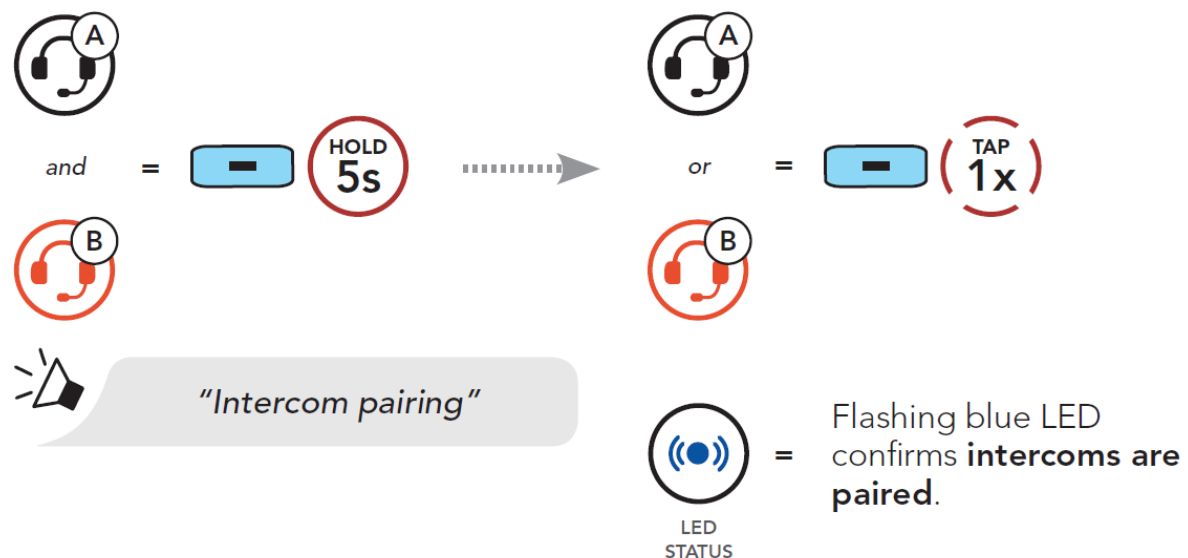

Start/End Conversation with Intercom Friend

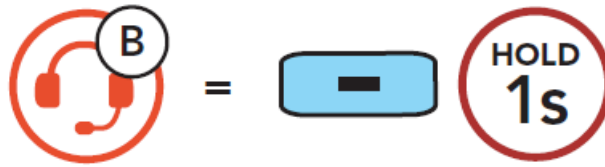

Configuration Menu

Access the Configuration Menu

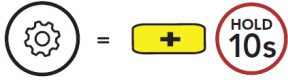

Navigate Between Menu Options



Execute Menu Options



Troubleshooting

Factory Reset

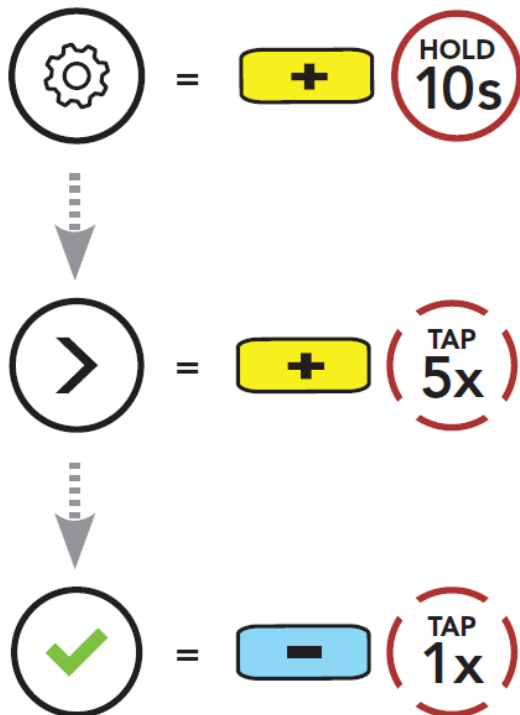



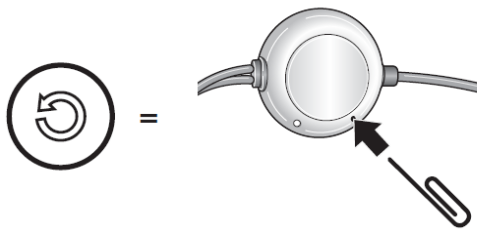















Fault Reset



Press the Pin-hole Reset Button for a second with light pressure. The headset will automatically be turned off and a fault reset will occur.

Note: Fault Reset will not restore the headset to the factory default settings.

TYPE	OPERATION	BUTTON COMMANDS
 Basic Operations	Power on	  
	Power off	  
	Volume up/down	 or  
 Mobile Phone	Answer a call	 
	End a call	 
	Reject a call	 
	Voice dial	 

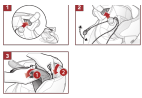

3S PLUS QUICK START GUIDE

QUICK START GUIDE

Universal Intercom Type

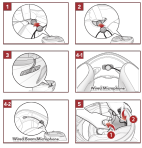

QUICK START GUIDE

SENA MOTORCYCLES App

Download the SENA MOTORCYCLES App on Google Play Store or App Store



SENA Device Manager

The SENA Device Manager allows you to update the firmware and the SENA Device Manager from your PC. Download the SENA Device Manager from the website.

NOTICE

- The Quick Start Guide (Version 1.0) applies to the 3S PLUS.
- The 3S PLUS with firmware version 1.0 or higher.
- For a complete list of the 3S PLUS with firmware version 1.0 or higher, refer to the 3S PLUS Quick Start Guide (Version 1.0).

QUICK START GUIDE

Basic Operations



Checking the Battery Level

Indication for when pressing the function.



QUICK START GUIDE

Phone Pairing



* For more information on phone pairing, refer to the Quick Guide.

QUICK START GUIDE

Mobile Phone



Music Controls



QUICK START GUIDE

Bluetooth Intercom

The 3S PLUS can be paired with another headset for Bluetooth intercom communication.



Intercom Pairing

There are two ways to pair the headsets.

Using the Quick Intercom Pairing (QIP)

QIP allows you to quickly pair with your headset for intercom communication by pressing the Call button on the SENA MOTORCYCLES App without installing the SENA Device Manager.

- Pair the mobile phone with the headset.
- Download the SENA MOTORCYCLES App and tap QIP (Quick Intercom Pairing).

- Confirm the QIP on the headset and tap QIP on the SENA MOTORCYCLES App.

- Tap the QIP button on the headset.
- Tap the QIP button on the SENA MOTORCYCLES App.

The 3S PLUS will be paired with the headset.

QUICK START GUIDE

- The SENA 3S PLUS can be paired with the 3S PLUS (Full) and the 3S PLUS (Half).

Using the Quick Intercom Pairing (QIP) on the 3S PLUS (Full) and the 3S PLUS (Half).



Using the Button



Intercom Pairing

Intercom Pairing

QUICK START GUIDE

Configuration Menu



Troubleshooting

Factory Reset



Reset the 3S PLUS

Press the 3S PLUS Reset button. The 3S PLUS will be reset to the factory settings.

QUICK REFERENCE

Icon	Function
	Power on
	Power off
	Volume up/down
	Mute/unmute
	Answer a call
	End a call
	Reject a call
	Make a call

S18 PLUS QUICK REFERENCE	
QUICK REFERENCE	
ITEM	OPERATION
1. Power on	Press the power button (1) to turn on the device.
2. Power off	Press the power button (1) for 5 seconds to turn off the device.
3. Answer call	Press the call button (2) to answer a call.
4. End call	Press the call button (2) to end a call.
5. Answer call	Press the call button (2) to answer a call.
6. End call	Press the call button (2) to end a call.
7. Answer call	Press the call button (2) to answer a call.
8. End call	Press the call button (2) to end a call.
9. Answer call	Press the call button (2) to answer a call.
10. End call	Press the call button (2) to end a call.

References

-  [The Best Motorcycle & Action Sport Bluetooth Devices | Sena](#)