

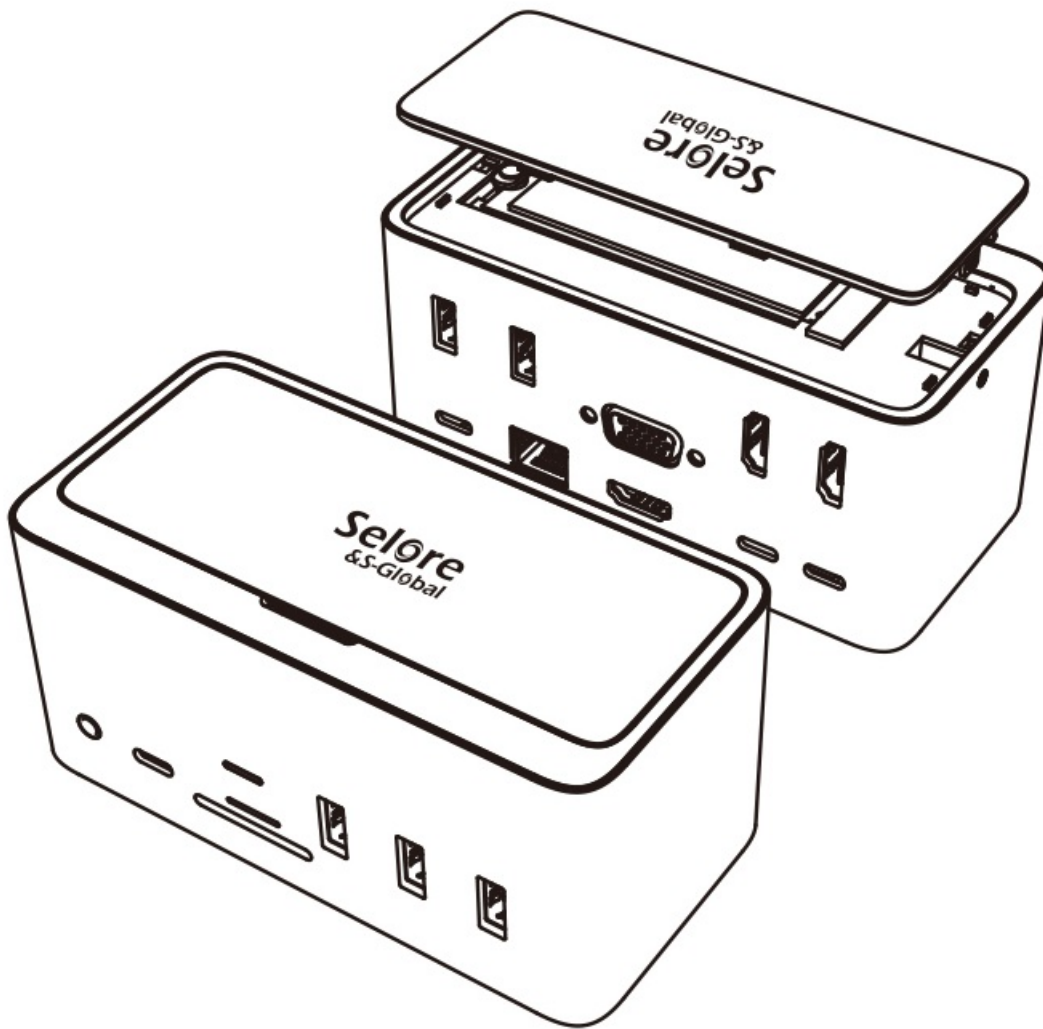

Selore S-Global SEDK0104 18 In USB C Quadruple Display Docking Station User Guide

[Home](#) » [Selore S-Global](#) » Selore S-Global SEDK0104 18 In USB C Quadruple Display Docking Station User Guide 

Selore[®]
&S-Global



SEDK0104 18 In USB C Quadruple Display Docking Station User Guide

USER GUIDE

The User Guider for ASIN: BO7FT6RN

Contents

- [1 SEDK0104 18 In USB C Quadruple Display Docking Station](#)
- [2 SAFETY INSTRUCTIONS](#)
- [3 Production Introduction](#)
- [4 About the display resolution](#)
- [5 Resolution Setting](#)
- [6 Display Settings for Mac](#)
- [7 Display Setting for Windows](#)
- [8 Connection](#)
- [9 Warm Reminder](#)
- [10 FAQ](#)
- [11 Documents / Resources](#)
- [12 Related Posts](#)

SEDK0104 18 In USB C Quadruple Display Docking Station

18-in-USB C Quadruple Display Docking Station With 4 Display Ports & M.2 SSD Enclosure



Attention Not all USB-C devices are created equal; your device(s) may have firmware or software requirements to make it work with this device. For some windows laptops only equipped with one USB C port, we suggest you connect to HOST2Z to get peripheral devices working via USB C cable.

You are welcome to contact us at support01@seloretech.com for assistance at no cost to you. Please be sure to provide the make and model of your laptop so that we can better assist you.

SAFETY INSTRUCTIONS

Please read the instruction thoroughly and familiarize yourself with the product before use.

1. Keep this User's Manual for future reference.
2. Keep this equipment away from humidity.
3. If any of the following situations arise, please contact us at support01@seloretech.com
 - The device has been dropped or damaged.
 - The device has an obvious sign of breakage.
 - The device has not been working well, or you cannot get it to work according to the User's Guide.
 - Please connect your power adapter to the USB C PD charging port of the dock before using. Our docking station requires about 15W of power, and some OEM adapters only provide enough power to run the laptop that they come with. If you are presented with a warning, you may wish to consider purchasing a power supply that provides more than your OEM power supply does.

Notice: Docking station supports Max 100W power pass through.

There are some common senses:

1. HDMI & VGA incompatibility problem—The native USB C port on your laptop didn't support video signal output.
2. Insufficient power supply—Our docking station requires about 15W of power, and some OEM adapters only provide enough power to run the laptop that they come with. If you are presented with a warning, you may wish to consider purchasing a power supply that provides more than your OEM power supply does. Notice: Solare Docking station supports Max 100W power pass through.
3. Thunderbolt 3 bandwidth is shared bandwidth which means all connected devices use the bandwidth for all protocols that transfer through the same USB, Ethernet, and Audio). Below is a chart that can help explain how different items can use the 40gbps total bandwidth. Solare 18-in-1 Docking Station can utilize up to the full 40 Gbps of bandwidth depending on what devices are attached to it. If the devices you connected over the total bandwidth, you may not get the result as you thought.

Port	Version	Throughput	Output
HDMI	1.	10.2 Gbps	Up to 4K@30Hz ture color
Mini Display port	1.	Up to 16 Gbps per lane	Up to 4K@60Hz
Full-Size Display Port	1.	Up to 16 Gbps per lane	Up to 4K@60Hz
VGA			Up to1080p@60Hz
RJ-45	IEEE 802.3		10/100/1000 Mb/s
USB	2.0 Type A	480 Mbps	5V@500mA, 2A Peak
USB	3.0 Type A	5 Gbps	5V@500mA, 2A Peak
USB w/Powershred	3.0 Type A	5 Gbps	5V@2A Power Share
USB Type-C Thunderbolt	Gen 3	Up to 40 Gbps	Up to 60W

If you have any problem, just contact us at Support01@seloretech.com

We hope that you enjoy the experience in the use of our product! Thank you for your support and purchase!

Production Introduction

1.1 Compatibility List:

Full compatible with these devices(Both Data Transfer And Charge, Not a full list)

1. MacBook 2015/ 2016/2017/2018/2019
2. MacBook Pro13"/15" 2016/2017/2018/2019
3. Google Chromebook 2016/2017/2018
4. Microsoft Lumia 950/950XL
5. Huawei Mat eBook 2016/2017/2018. An extra 60W power plug needed for power delivery to work.
6. Dell XPS13/15. An extra 60W power plug needed for power delivery to work.
7. Dell Latitude Series/Vostro Series/Precision Series/Inspiron series
8. HP Spectre Notebook/EliteBook Series/Pro Series/Zook Series
9. Acer Aspire R13/V15 Nitro/V17 Nitro
10. Asus Zen book Pro UX Series
11. Asus Ling Yao 3, Ling Yao 3 PRO, Ling Yao X Series
12. Lenovo ThinkPad 25/P Series/T Series/X Series
13. Lenovo IdeaPad 500/700/900 Series

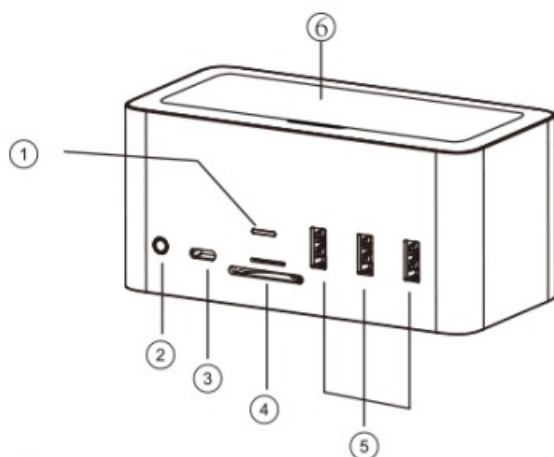

Front:

- ① LED indicator
- ② 3.5mm Audio & Microphone
- ③ USB-C
- ④ SD & Micro SD
- ⑤ USB3.0
- ⑥ M.2 SATA 3.0 NGFF SSD Enclosure

Back:

- ① USB2.0
- ② VGA
- ③ **HDMI** 2
- ④ **HDMI** 3
- ⑤ PD 3.0
- ⑥ RJ45
- ⑦ **HDMI** 1
- ⑧ USB-C input (connect to HOST1)
- ⑨ USB-C input (connect to HOST2)

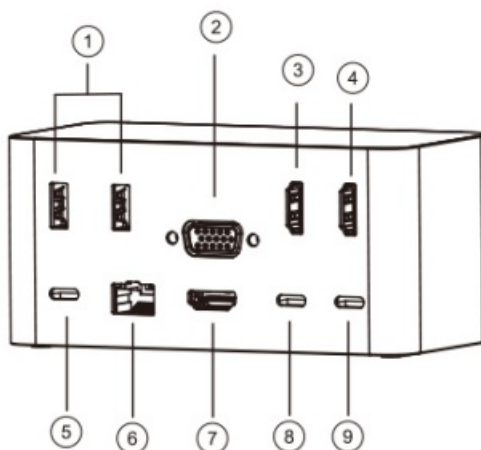

Make sure the type c power delivery port on your laptop supports the DisplayPort Alt Mode and the type c port is USB 3.1 Type-C (Gen2) or Thunderbolt 3 port.

Note: Some Thunderbolt 3 ports just work as the half-speed TB3 port(20Gbps Max), which means you will not get enough bandwidth to support all your monitors and other devices.

If you don't know whether the TB3 port in your laptop is the half-speed or full-speed TB3 port, you can try running the SSD via our docking station and download the Crystallisation, then you can know it from the Read and Write values. If the speed is obviously low, that's a half-speed TB3 port.

1.2 Product Introduction

This USB-C docking station is designed to meet the needs of multi-display expansion for Mac and Windows systems. In particular, this docking station uses advanced technology to break through the limitation that Apple's system does not support three-display expansion. At the same time, you can easily connect a M.2 SATA 3.0 NGFF SSD to a PC, Laptop, Router etc for data transfer and expanding storage.

The docking station is equipped with 4 display video outputs, with triple 4K Ultra HD display simultaneously. It allows you to split up the content to Triple display for Mac system or quadruple display for windows system. In addition, the docking station provides all connections you need. Including: 3x HDMI, 1x VGA, 3x USB3.0, 1x PD 3.0, 1 SD&Micro SD, 2xUSB2.0, 1x RJ45 Gigabit Ethernet, 1x USB-C, 1x Audio, 2x USB-C to HOST Port, M.2 SATA NGFF SSD Enclosure.

Structure Diagram

1.3 Specification:

Front:

1. LED indicator: Glow when the docking station is charged or worked.
2. 3.5mm Audio&Microphone: 2 in 1 combination port for speaker and microphone.
3. USB-C Data Transfer: Up to 5Gb/s data speed & maximum power output 5V/0.9A.
4. SD&Micro SD Card Reader: Read 50-104MB/s, Write: 30-80MB/s Data transfer rates are subject to the speed of the memory card itself and your computer's USB ports.
5. USB-A 3.0 (data + downstream charge): Up to 5Gbps, 5V/0.9A @7.5W.

Back:

1. USB-A 2.0: Speed up to 480Mbps, 5V/0.5A@2.5W; Designed for the connection of 2.4 GHz wireless devices, such as wireless keyboards/mouse adapters etc.
2. VGA: Resolution up to 1080P/60Hz.
3. HDMI2: 4K@60Hz.
4. HDMI3: 4K@30Hz.
5. USB-C PD3.0: Upstream charging the source devices such as Laptop/Notebook, charging limited to 87-96W for safety and affected by different firmware. Support 100W power adapter.
6. RJ45 Gigabit Ethernet: Up to 1000Mbps.
7. HDMI: 4K@60Hz.
8. USB-C: Connect to laptop (HOST1).
9. USB-C: Connect to laptop (HOST2).

Top:

1. M.2 SATA 3.0 NGFF SSD Enclosure

1.4 Connection

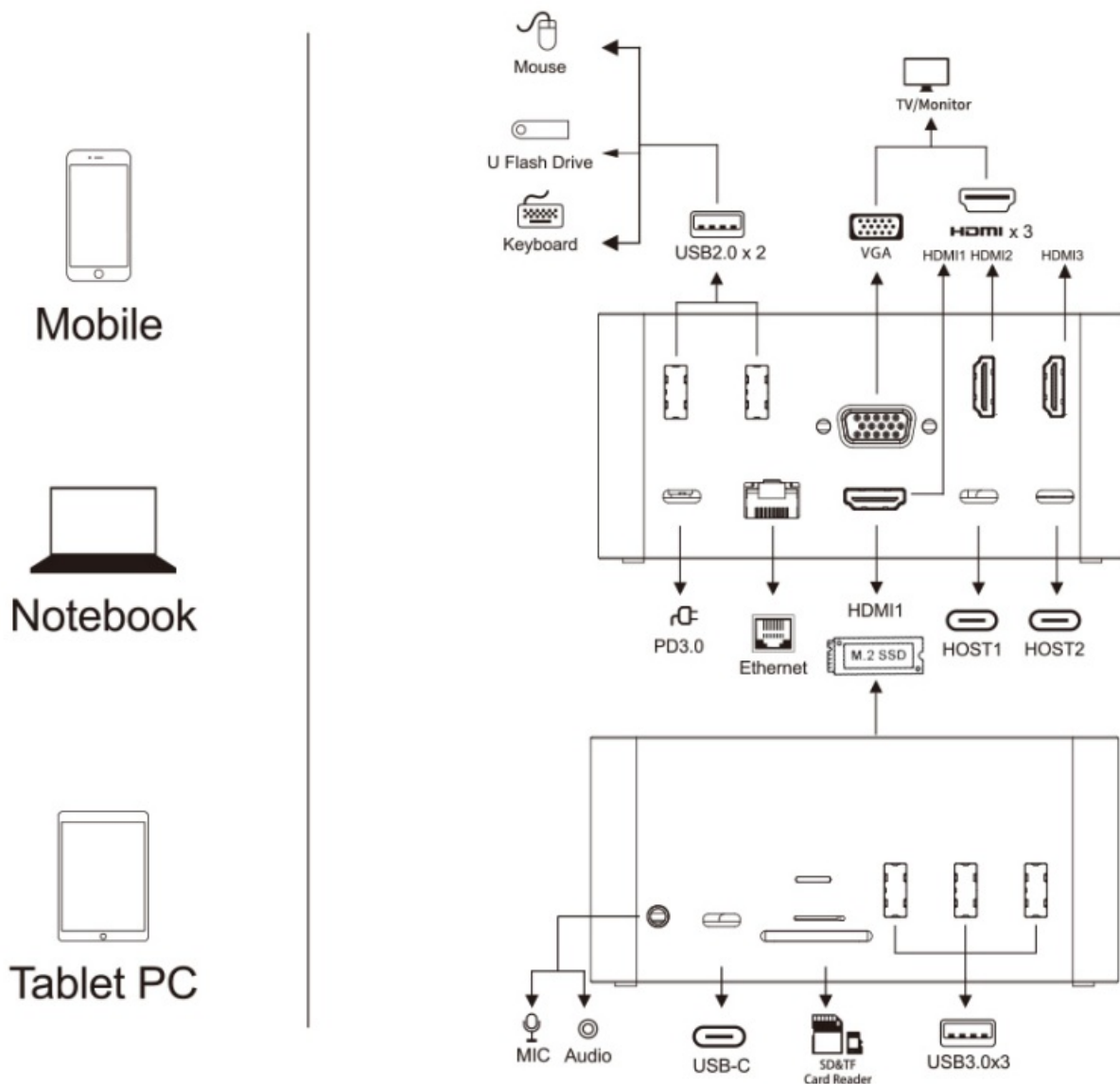

How To Set Up:

1. Connect the USB C Port (Carved “HOST1” or “HOST2”) with the USB-C or Thunderbolt 3 port on your host laptop via USB-C cable included.

Note: HOST1 system only drives HDMI1 output, all the other connections including HDMI2, HDMI3, and VGA output are for HOST2 system.

2. Plug the laptop PD charger into the dock.
3. Plug in your external peripheral into the hub.

About the display resolution

The matrix list shows the highest resolution supported by the Windows system and Apple system when connecting different video output ports for expansion.

				
	HOST1	HOST2		
Item	HDMI 1	HDMI2	HDMI3	VGA
1	4K/60Hz	X	X	X
2	X	4K/60Hz	X	X
3	X	X	4K/30Hz	X
4	X	X	X	1080P
5	X	4K/30Hz	4K/30Hz	X
6	X	1080P	1080P	1080P
7	41(/60Hz	1080P	1080P	1080P

HOST1+HOST2 for Mac				
	HOST1	HOST2		
Item	HDMI 1	HDMI2	HDMI3	VGA
1	4K/60Hz	X	X	X
2	X	4K/30Hz	X	X
3	X	X	4K/30Hz	X
4	X	X	X	1080P
5	X	1080P	1080P	1080P
6	4K/60Hz	4K/30Hz	4K/30Hz	X
7	4K/60Hz	1080P	1080P	1080P

Resolution Setting

3.1 Resolution Setting for windows

Right Click Desktop > Display Setting

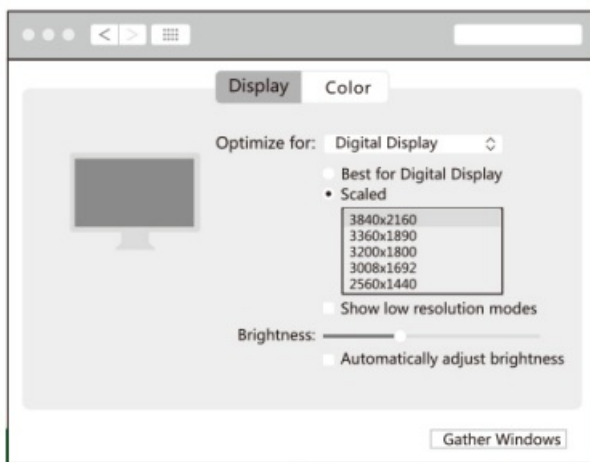
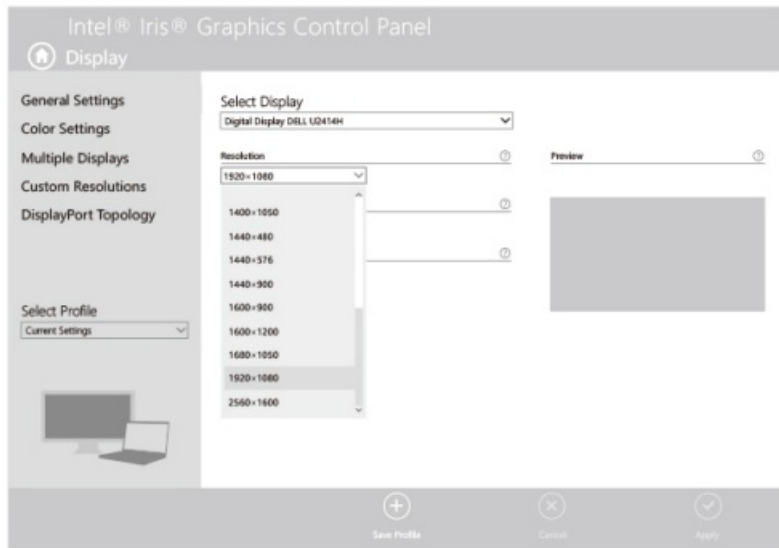

Select and rearrange displays Select a display below to change its settings. Some settings are applied to all displays.

3.2 Resolution Setting for Mac

Apple Icon > System Preferences > Displays

Display Settings for Mac

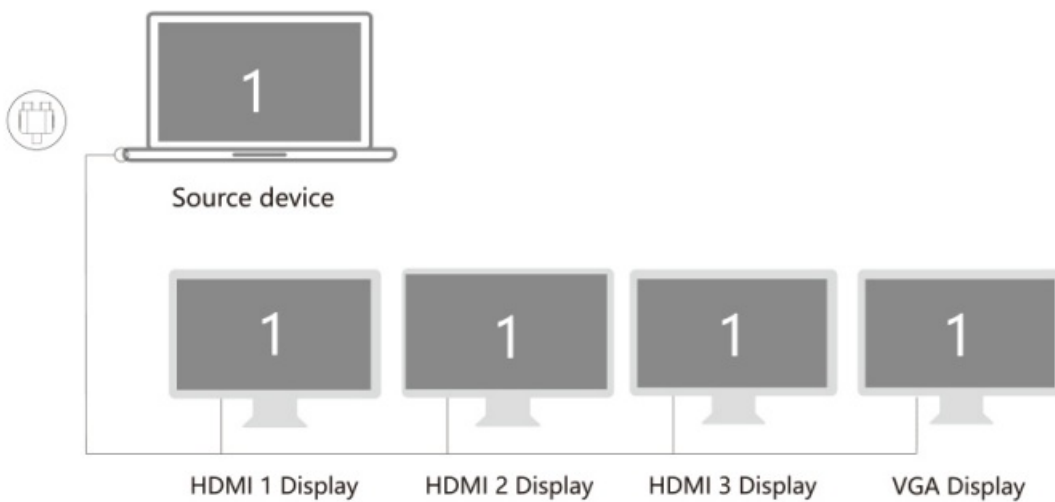
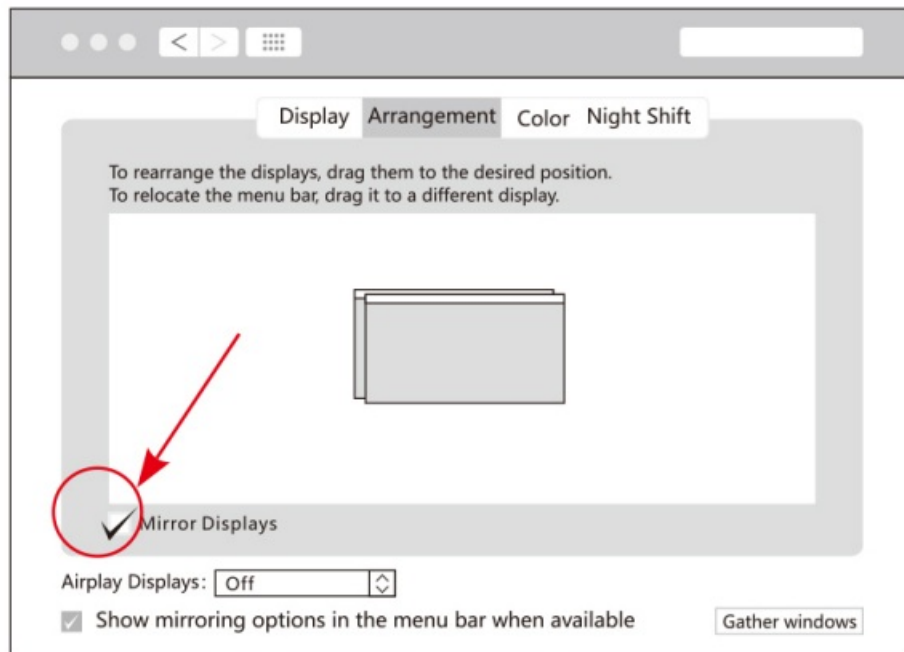

4.1 Mirror Display

Apple Icon > System Preferences > Displays

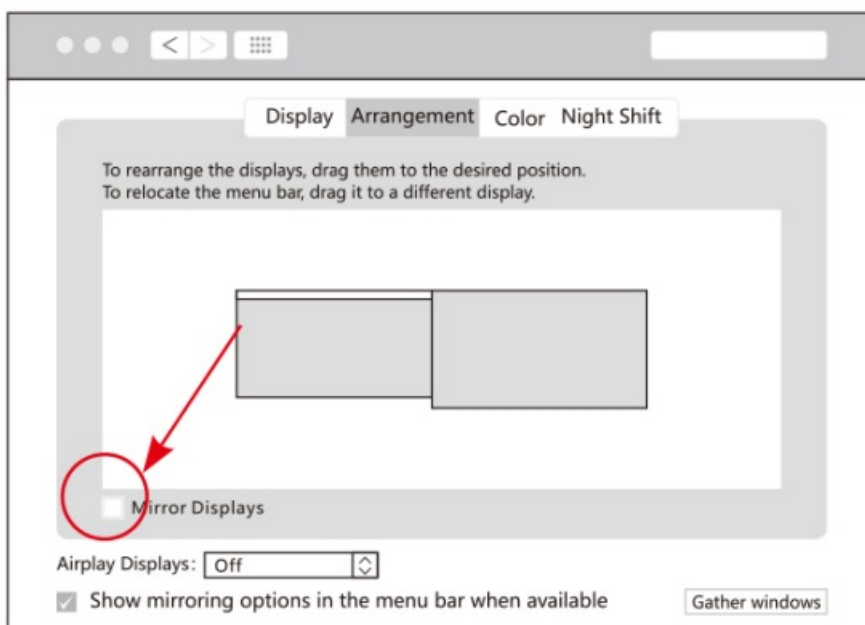

4.2 Extend Display

Apple Icon > System Preferences > Displays

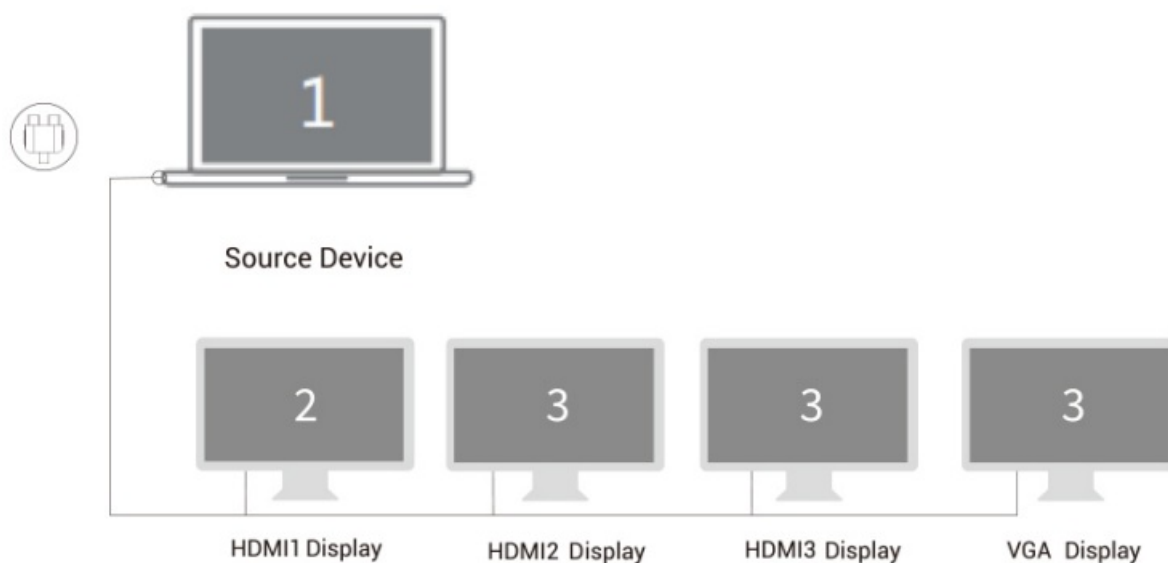

HDMI1 output is from HOST 1 system, HDMI2+HDMI3+VGA are from HOST 2 system, and due to the bandwidth limitation, these three ports all become 1080P.

Note: Please connect HDMI 1 port to get extend displays via dual USB-C to dual USB-C cord provided

Display Setting for Windows

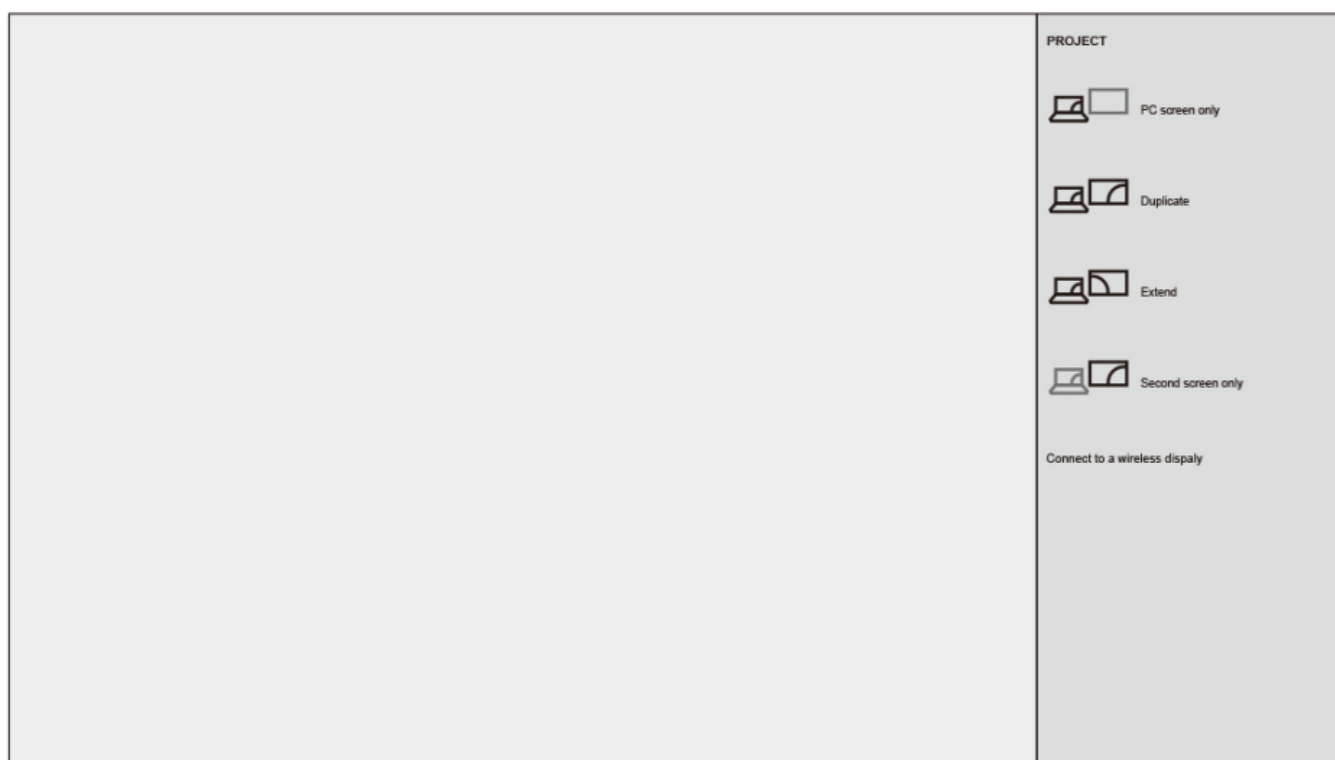

5.1 Hot key for entering mugil-display modes setting:

Windows  +P

General Settings	Select Display Mode
Color Settings	Single Display 1 2 3
Multiple Settings	<input checked="" type="checkbox"/> Clone Display Detect
Custom Resolutions	Extended Desktop
DisplayPort Topology	Collage
	Select One or More Active Displays
	Built-in Display ▼
	HDMI Display ▼
	VGA Display ▼

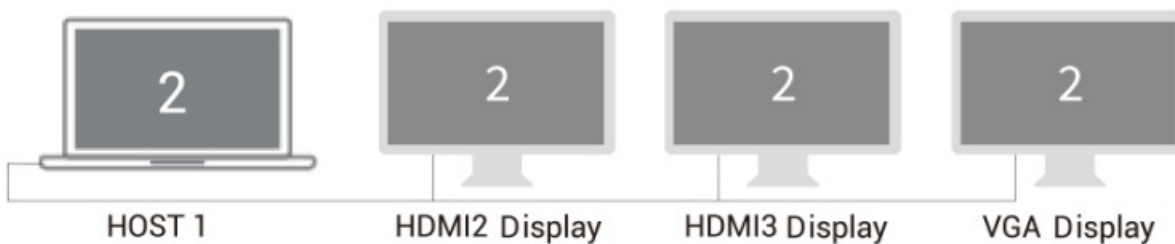

5.2 Clone Display

Right click desktop >Graphics Settings >Display

HOST1 system only drives HDMI1 display, other ports expect HDMI1 are from HOST2 system. For some Windows laptops only equipped with one USB C port, we suggest you connect to HOST2 to get peripheral devices working via USB C cord.

General Settings	Select Display Mode
Color Settings	Single Display 1 2 3
Multiple Settings	<input checked="" type="checkbox"/> Clone Display Detect
Custom Resolutions	Extended Desktop
DisplayPort Topology	Collage
	Select One or More Active Displays
	Built-in Display ▼
	HDMI Display ▼
	VGA Display ▼

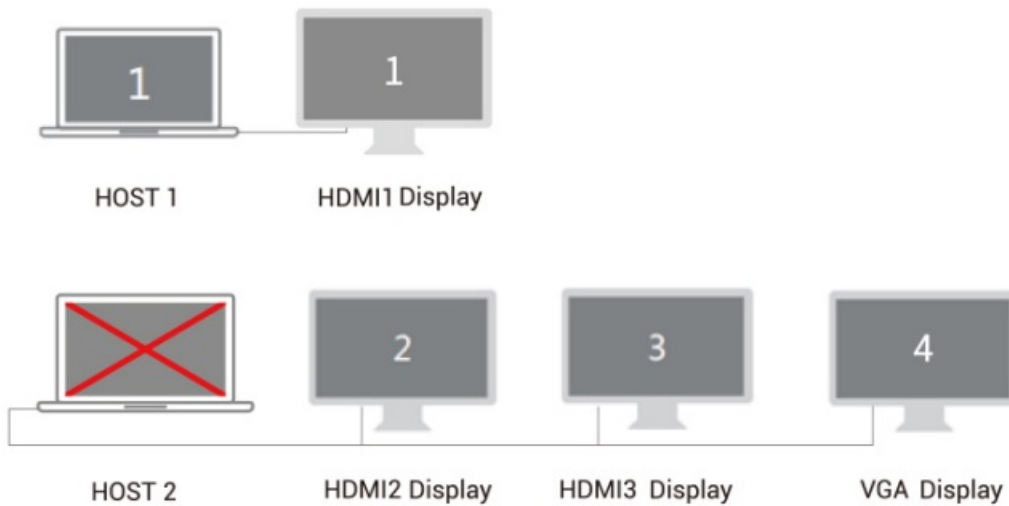

5.3 Extended Display

Right click desktop >Graphics Settings >Display HOST1 system only drives HDMI1 display, other ports expect HDMI1 are from HOST2 system. For some Windows laptops only equipped with one USB C port, we suggest you connect to HOST2 to get peripheral devices working via USB C cord. For HOST2, if your laptop equips with the Intel Graphics Card, one of 4 monitors will be no display under the limitation of Intel chipsets. Only three-screen will be displayed including the laptop's screen. But you could choose which monitor no display. While for AMD graphics cards, there is no such restriction.

Connection

6. 1 Connecting to an Ethernet Network

1. Connect an RJ45 patch cable to the Dock
2. Connect the patch cable to an active LAN or router port
3. Check the documentation of your LAN or router to configure network access
4. Link and Status LEDs should blink to indicate a live connection
5. If using a MacBook for Ethernet connectivity, do the following:- Click "System Preferences", "Network", click "+" and select USB 10/ 100 / 1000 LAN to create an application (Click on the app to show USB 10/100/1000 LAN green, connected successfully).

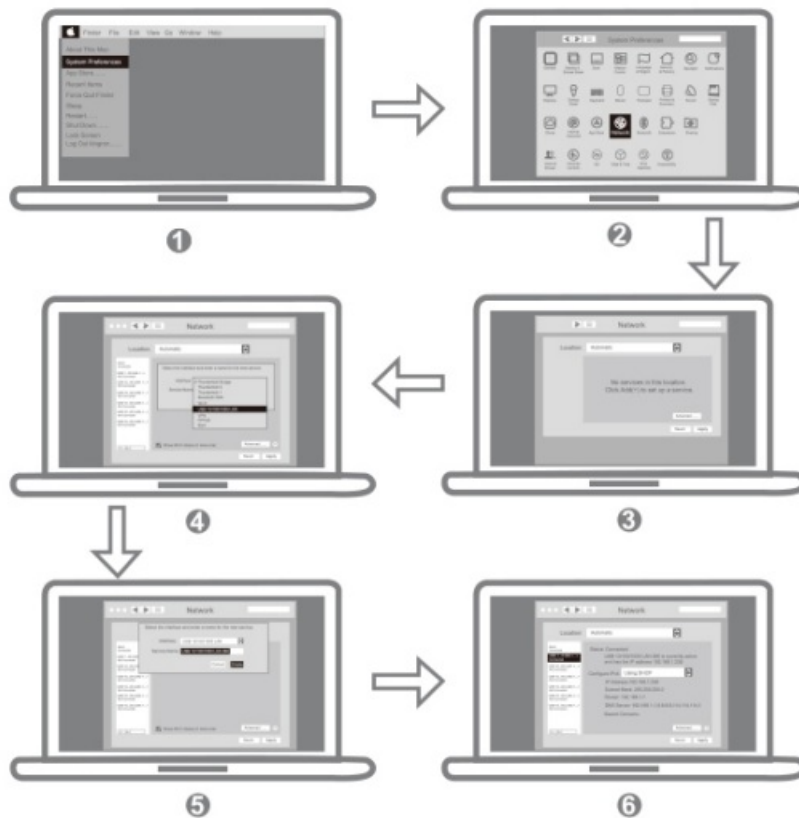

Troubleshooting Tips

1. Reboot the laptop and check that the LED Indicator Lights are lit, Status Solid Green Light + Flash Orange Light→ Connected & Working
2. Test the ethernet cable with a different device or try another ethernet cable.

6.2 Connecting an Audio Port

1. Connect an external 3.5mm mono microphone to the port.
2. Connect a stereo headset or external speaker to the combo audio port. This port also supports a headset/mic combo.
3. Sound settings:

Sound Settings for win10

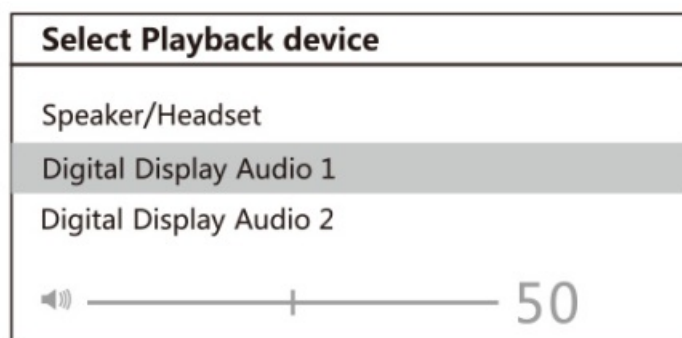

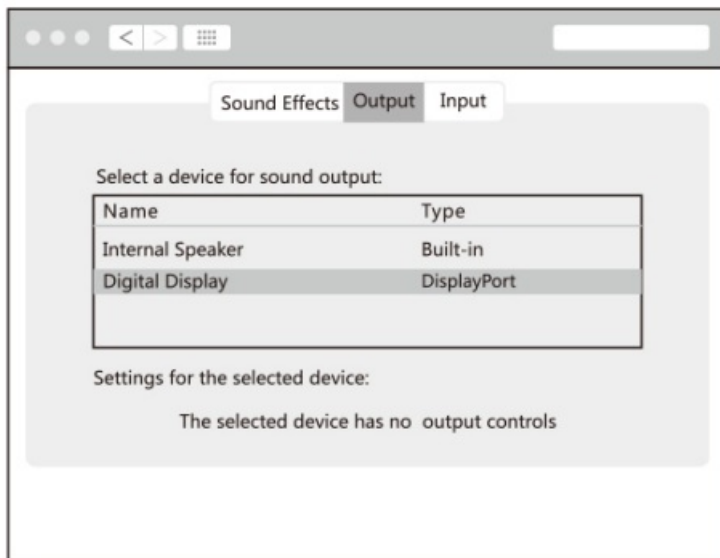

Sound Setting for Mac

Apple logo>System Preferences >Sound

6.3 Install and format M.2 NGFF SSD

1. After install, power on your computer with your Windows OS disc loaded.
2. Start the operating system installation process once the computer loads.
3. Follow the prompts and designate your install drive by confirming the capacity.
4. Select the drive and select "New".
5. Proceed with the default settings.

Note: If this isn't

a new PC build, you'll need to format the drive in the Disk Management utility. To access this, right-click the PC choose Manage(Step 1&2).

1. Your drive will show up as unallocated space, right-click and choose "New Simple Volume'(Step 3).
2. Follow the instructions to create volume and format disk.

Step 1

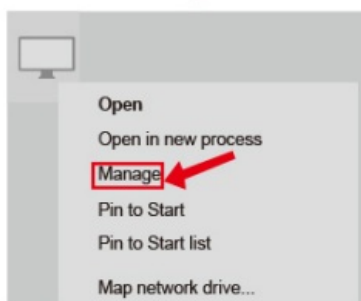

Step 2





Step 3



Step 4: Follow the instructions to create volume and format disk

Some specifications:

Support Connector Type: B Key , B & M Key 

Support Format: Windows: NTFS/FAT32/exFAT, Mac OS: HFS+/exFAT

Support Capacity: Support 2TB at Max

Support Length: 2230, 2242, 2260, 2280

Warm Reminder

1. Please make sure the USB-C port of your smart phone/Tablet/ Laptop supports the DisplayPort Alternate Mode, and the USB-C port is USB 3.1 Type-C (Gen2) or Thunderbolt 3 port (supports PD charging) before purchasing. Otherwise, your PC will not get output video signal.
2. Please plug in the Laptop's power adapter to the USB-C Power Delivery port before using multiple displays.
3. Please update Mac OS of your MacBook to Catalina (10.15.1) or above for better compatibility.
4. When connecting an external hard drive or multiple devices to this port replicator you may see "USB Power Consumption is too high" and your USB-C Port Replicator may cease working. This is normal self-protection activity for when USB connections exceed 1A of power. You'd better use the original charger directly to connect the laptop to charge.
5. If the docking station cannot be used after the laptop system is updated, please visit www.intel.com to update the USB driver and intel graphics card.
6. The first time using the M.2 NGFF SSD, please format the drive in the Disk Management utility.

FAQ



Made in China

Q: Why is there no video output?

- A: 1. If your laptop compatible with the docking station,
 - 1) Please check the connection is good.
 - 2) Please use standard HDMI or VGA cable, especially the 4K@60Hz needs the cable support 60Hz, or you can only reach 4K@30Hz at Max.
 - 3) Please make sure select the correct input source for your HDMI and VGA monitor.
 - 4) Probably laptop power supply insufficient. Please connect the power adapter to the PD charging port or use a 15W larger than the OEM adapter.
- 2. Probably your laptop is not compatible with the docking station.

Q: Why is there no audio output from HDMI port?

- A: 1. Please make sure that there is audio output function on the monitor.
- 2. Please set the external monitor as default audio output device.

Q: Can I connect my Apple SuperDrive to the dock?

- A: No, some devices such as the Apple SuperDrive look for Apple-specific signaling and will not work when connected through any USB hub.

– Q: My docking station not charging my laptop?

- A: 1. Verify if your system supports PD charging over USB-C and also identify which port has this functionality if multiple USB-C ports are available. Please note that some systems that charge over USB-C/Thunderbolt 3 may not support charging from universal docks and may only charge from approved chargers and devices from the system manufacturer.
- 2. Probably your laptop's rated wattage exceeds 100W. The PD charging port of the docking station support Max 100W power pass through.

Q: Why I can't get my three monitors to work with the Thunderbolt 3 port?

– A: It might because the thunderbolt 3 port in your device is a half-speed TB3, which bandwidth just support 20 Gbps at Max, it not enough to support your three monitors.

Q: Can i Hot Swap the SSD while using the Docking Station?

– A: Yes, it supports hot-swap, but please eject your SSD first and not using SSD as the system disk, or you might lose your data.

Documents / Resources

	Selore S-Global SEDK0104 18 In USB C Quadruple Display Docking Station [pdf] User Guide SEDK0104 18 In USB C Quadruple Display Docking Station, SEDK0104, 18 In USB C Quadruple Display Docking Station, Quadruple Display Docking Station, Display Docking Station, Docking Station
---	---