

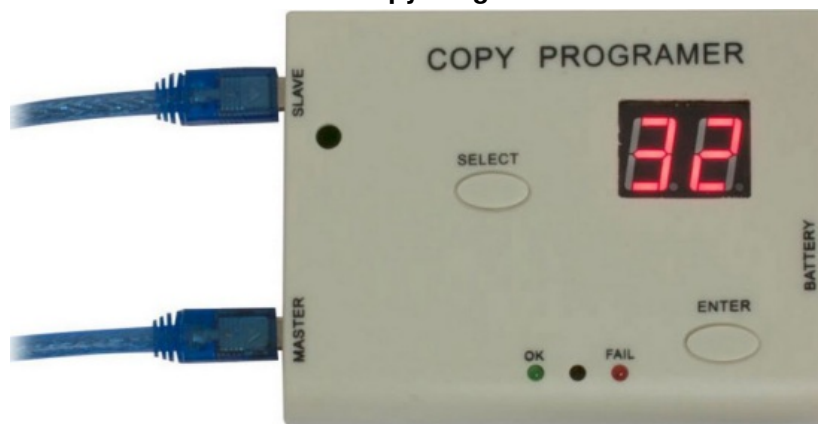

SeKi SK747 Remote Copy Programmer Instructions

[Home](#) » [SeKi](#) » SeKi SK747 Remote Copy Programmer Instructions 

SeKi SK747 Remote Copy Programmer Instructions



Contents

- [1 SEKI-HOTEL REMOTE CONTROL PROGRAMMER](#)
- [2 SEKI-HOTEL "MASTER" LEARNING REMOTE CONTROL](#)
- [3 SEKI-CARE LEARNING REMOTE CONTROL](#)
- [4 SEKI EASY-PLUS LEARNING REMOTE CONTROL](#)
- [5 Programming Master](#)
- [6 Programming Slave](#)
- [7 Documents / Resources](#)
 - [7.1 References](#)
- [8 Related Posts](#)

SEKI-HOTEL REMOTE CONTROL PROGRAMMER

COPY MACHINE REQUIRES MASTER & SLAVE REMOTES

This programmer is a system for very quickly replacing lost or broken remote controls. Ideal for situations where you have multiple remotes that are identical like in hotels, hospitals, hostels, aged care, etc.

Programming a new remote control can be a slow and tedious experience. With this system, you have a single

master remote that simply gets duplicated across to multiple slave remote controls. Easy!

- Supplied is the copy-programmer with comm leads (only)
- Requires Seki-Hotel SK746 to be used as a Master Remote
- Requires any compatible slave remote controls as required
- The SK746 is a universal remote control that “Learns” IR commands from the original remote control (See SK746 for details)
- Use the SK747 programmer to copy from SK746 to slave remotes
- Compatible with slave remote SK111, SK151, SK153 (only)

Direct IR Learning. Programming the Master SekiHotel remote directly from original remote.

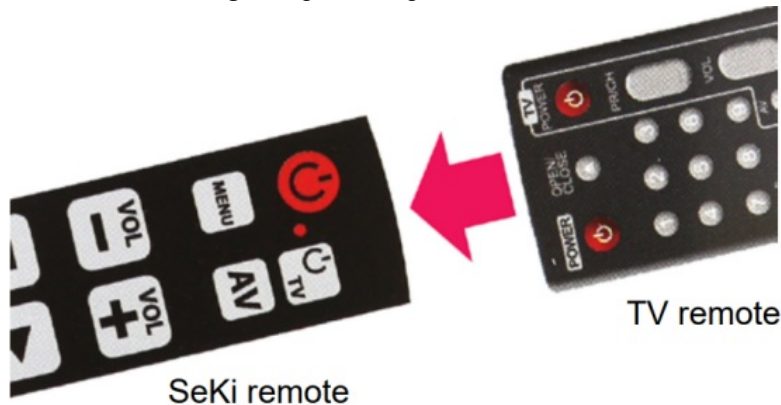

Save Time with making multiple identical remote controls using SeKi Hotel Programmer/Remote

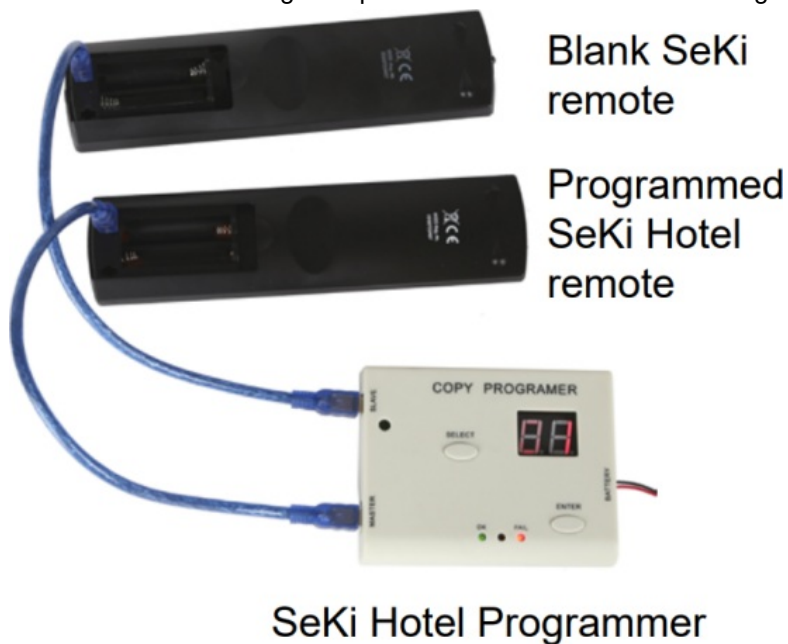

Remote controls are sold separate.

SK746 Seki-Hotel Remote (Sold Separate)



Compatible Seki Programmable remotes

SEKI-HOTEL “MASTER” LEARNING REMOTE CONTROL

FOR USE WITH THE SK747 COPY-PROGRAMMER

The Seki-Hotel remote control is the “Master” Remote control in the SeKiHotel easy rapid copy-program system. Seki-Hotel is a system for very quickly replacing lost or broken remote controls. Ideal for situations where you have multiple remotes that are identical like in hotels, hospitals, hostels, aged care, etc.

Programming a new remote control can be a slow and tedious experience. With this system, you have a single master remote that simply gets duplicated across to multiple slave remote controls. Easy!

This master remote features a full sized unit with large buttons for a simple layout with the most commonly used functions including a numeric keypad for direct channel select. Many remote controls can appear initially complicated to the casual user, while the SeKi-Easy range is designed to be simple and intuitive. This remote can duplicate the major functions of an original remote control by “Learning” the IR codes directly from the original remote. Requires 2x AAA batteries (sold separately). Full sized 190x45x20mm



SEKI-CARE LEARNING REMOTE CONTROL

The Seki Care remote control features a unique one-piece keypad that has no gaps between the buttons to prevent water and dirt from getting inside making it easy to clean. Perfect for sanitising between users as in hospitals, B&B, special-care places, etc. The remote includes an intuitive button layout with commonly used functions. Aids usage by the infirm, sight impaired, or casual user. Can learn directly from original remote control or is compatible with the SeKi-Hotel copy system*. Requires 2x AAA batteries (sold separately). Full sized 190x50x20mm



***Compatible with the SeKi-Hotel copy system.**

Requires master remote Seki-Hotel SK746 and the Seki-Hotel Copy-Programmer SK747.

SEKI EASY-PLUS LEARNING REMOTE CONTROL

The Seki-Easy Plus remote control features a full sized unit with large buttons for a simple layout with the most commonly used functions including a numeric keypad for direct channel select. Many remote controls can appear initially complicated to the casual user, while the SeKi-Easy Plus is designed to be simple and intuitive. This remote can learn directly from original remote control or is also compatible with the SeKi-Hotel rapid copy system*. Requires 2x AAA batteries (sold separately). Full sized 190x45x20mm



Compatible with the SeKi-Hotel copy system.

Requires master remote Seki-Hotel SK746 and the Seki-Hotel Copy-Programmer SK747.

Programming Master

Step 1

Press buttons "AV" and "VOL -" at the same time.

Hold both of the keys for at least 5 seconds until the corresponding indicator lights up.

The learning system is on now.

Step 2

Hold the sending end of the established remote aiming at the receiving end of SeKi. (distance 2-5cm)

Step 3

Press the button of SeKi remote control you want to program. The indicator will flash 2 times.

Step 4

Press the targeted button of the original remote control. When receiving the correct data, LED will flash 2 times and then light.

Step 5

To learn other buttons repeat steps 3 + 4 until the end of all learning.

Step 6

When learning is completed, press button "AV" to exit learning state.

You are done and can now use your SeKi Care.

Programming Slave

Step 1

Put batteries into the programmer and switch it on. LED display, OK and FAIL indicator will flash.

Step 2

Press SELECT key until display shows „32“. Please press ENTER. OK and FAIL indicators will be off.

Step 3

Connect the already programmed SeKi Care remote via mini USB cable (USB jack in the battery case) with Master jack of the programmer and the new SeKi Care with Slave jack.

Step 4

Press ENTER to start copying.

Step 5

OK indicator will light when copying was successful. If FAIL indicator will light on, copying failed. In this case, please unplug both remotes and repeat programming, starting from **step 3**.

Step 6

Unplug both remotes and switch off the programmer.

You are done. Both SeKi remotes are having same codes now and can be used.

For further information or for troubleshooting please visit our website at www.my-seki.com

www.my-seki.com



Documents / Resources



[SeKi SK747 Remote Copy Programmer](#) [pdf] Instructions

SK746, SK747, SK747 Remote Copy Programmer, SK747, Remote Copy Programmer, Copy P rogrammer, Programmer

References

-  [My SeKi - Simple remote controls for everyone](#)
- [User Manual](#)

[Manuals+](#), [Privacy Policy](#)

This website is an independent publication and is neither affiliated with nor endorsed by any of the trademark owners. The "Bluetooth®" word mark and logos are registered trademarks owned by Bluetooth SIG, Inc. The "Wi-Fi®" word mark and logos are registered trademarks owned by the Wi-Fi Alliance. Any use of these marks on this website does not imply any affiliation with or endorsement.