

**Segotep** 

Slath Mini  
ITX PC  
Gaming  
Computer  
Case



# Segotep Slath Mini ITX PC Gaming Computer Case Instruction Manual

[Home](#) » [Segotep](#) » Segotep Slath Mini ITX PC Gaming Computer Case Instruction Manual 

## Contents

- [1 Segotep Slath Mini ITX PC Gaming Computer Case](#)
- [2 Installation Instructions](#)
- [3 Documents / Resources](#)
  - [3.1 References](#)
- [4 Related Posts](#)

**Segotep** 

**Segotep Slath Mini ITX PC Gaming Computer Case**



**You can't use it for:**

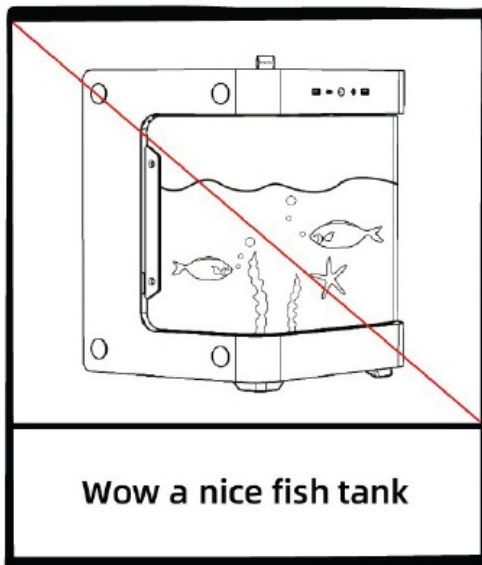

**You can use it for:**

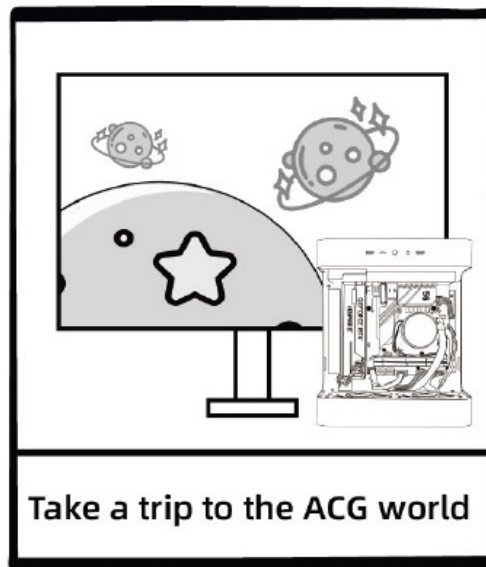
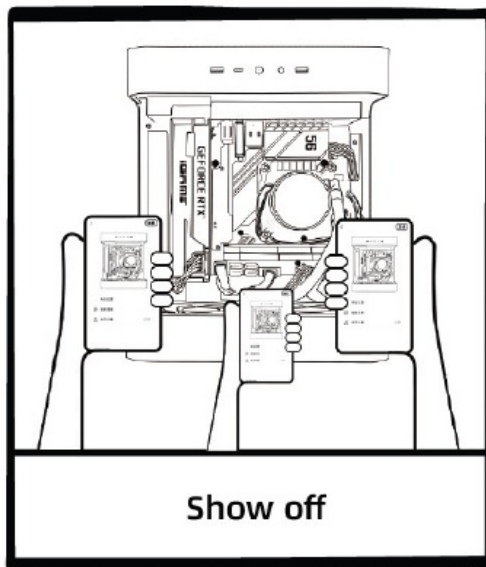

## Installation Instructions

- Unscrew the screws on the left and right sides of the case and remove the transparent front panel; then take the plastic upper and lower covers, the hardware rear panel and the heat sink bracket in turn.

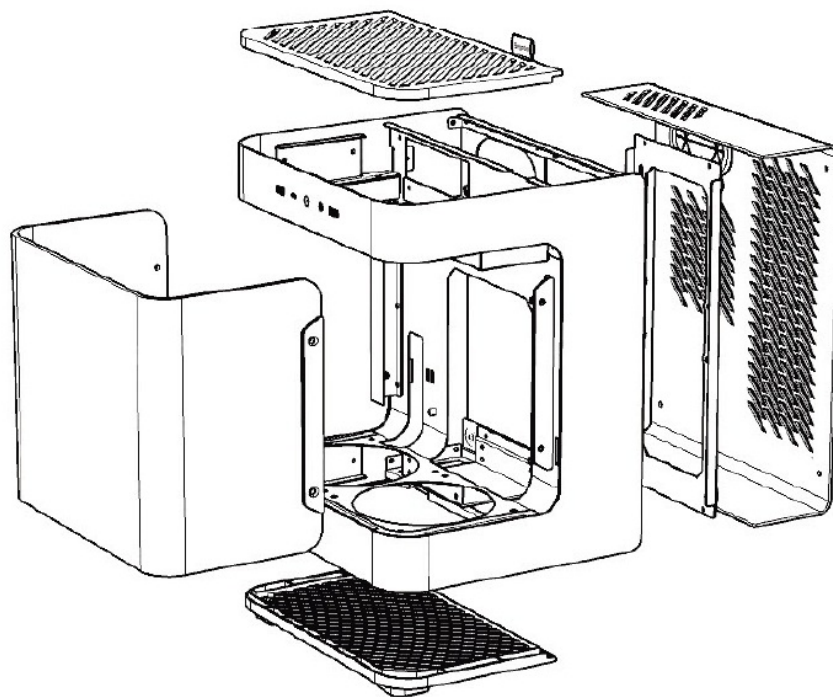

- Install the CPU and M.2 SSD on the motherboard.

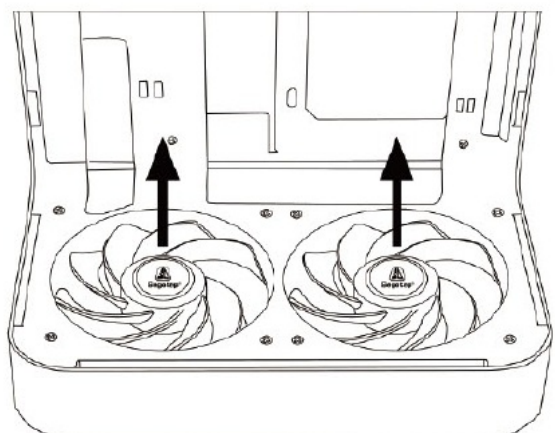
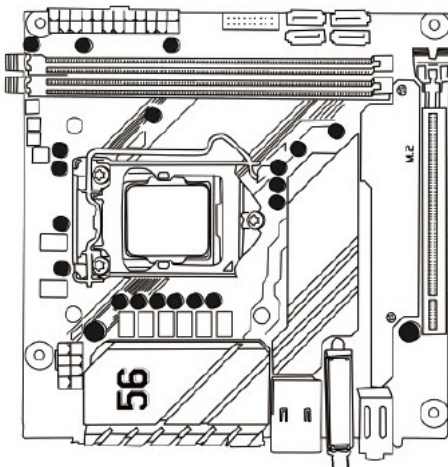

- The fan wire is passed through the bottom of the case, as shown in the figure; Then fixed the fans with screws (Exhaust fans in the video, be ware of the direction airflow, the arrow indicates the direction of the air).

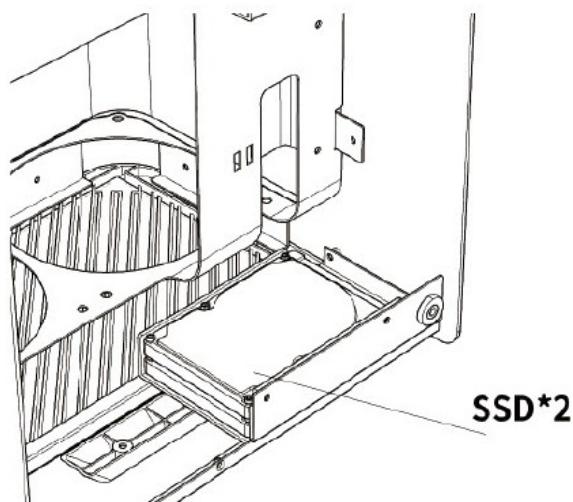
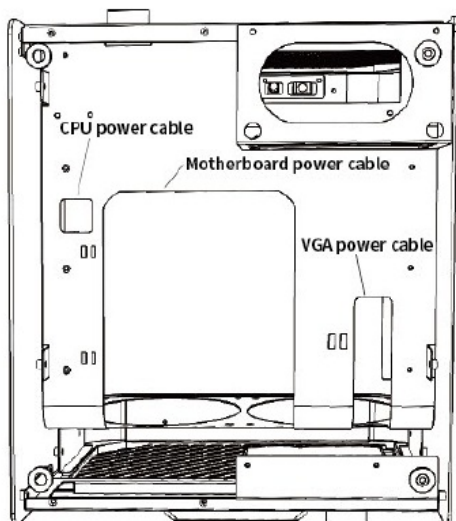

- Setup the power module cable first, then pass the graphics card/CPU/motherboard power supply wire through the corresponding wiring hole, as shown in the figure.
- Remove the bottom hard drive cage, align the holes, lock the screws, secure the 2.5" SSD to the bracket and connect the hard drive power cable  
(**Note:** 2.5"SSD\*2 is supported here)
- Lock the fans on the heat sink, and pass the liquid pipe through the middle of the hardware motherboard (be ware of the direction of the fan wiring, as shown in the picture).

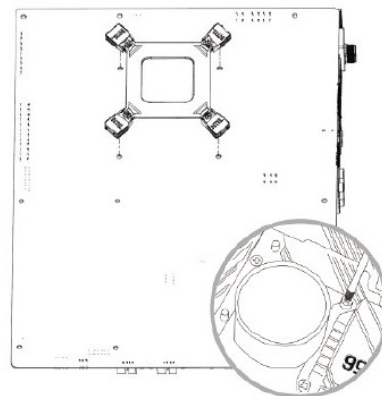
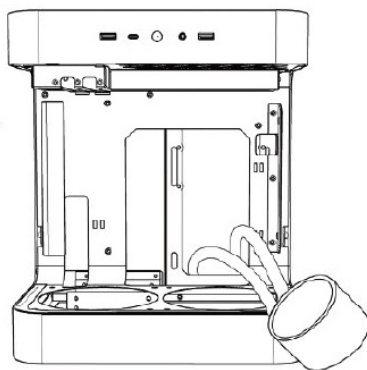
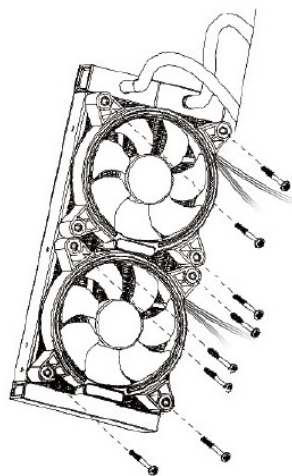

- Install the corresponding radiator bracket according to the motherboard model  
(**Note:** refer to the radiator installation instructions)



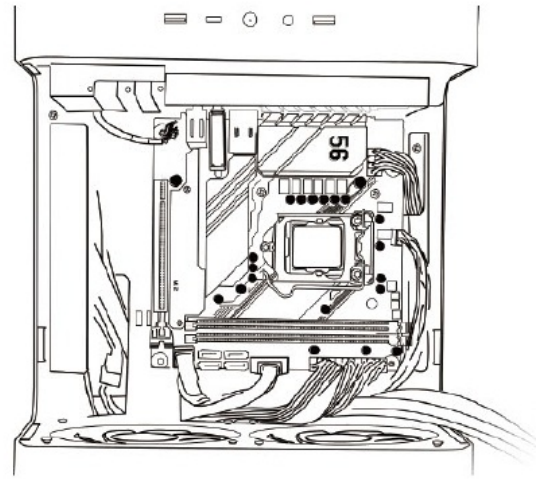
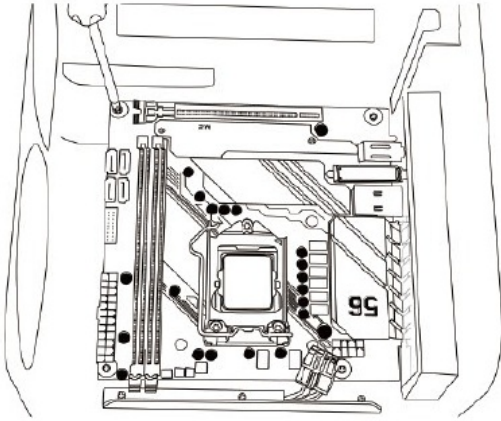

- Install the IO baffle on the top of the chassis, align the holes then lock the motherboard screws.
- Connect the motherboard power supply, CPU power cable, fan 1-to-2 adapter cable\*2, audio cable, USB cable, and switch cable in order.
- Install the memory stick onto the motherboard

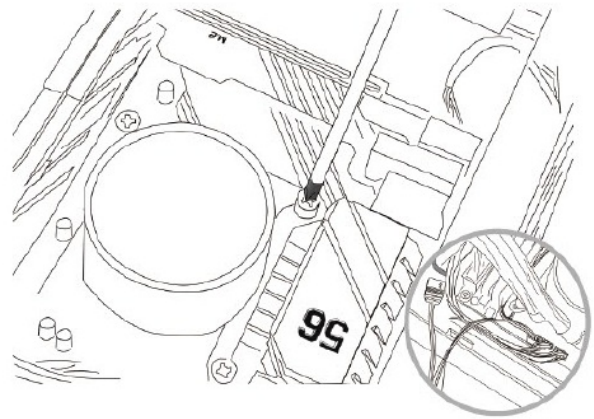
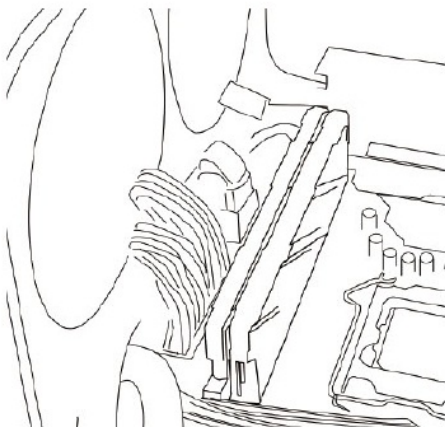

- Apply silicone grease evenly on the CPU surface, tear off the sticker on the bottom of the cold head. Align the cold head with the hole and tighten nuts, connect the power supply wire of the cold head to the CPU. FAN interface on the motherboard. The wire of the fans and cooling head lighting passed through the bottom wiring hole, as shown in the figure.
- Align the holes, lock the four screws, and fix the heat sink bracket (be aware of the orientation of the heat sink bracket).

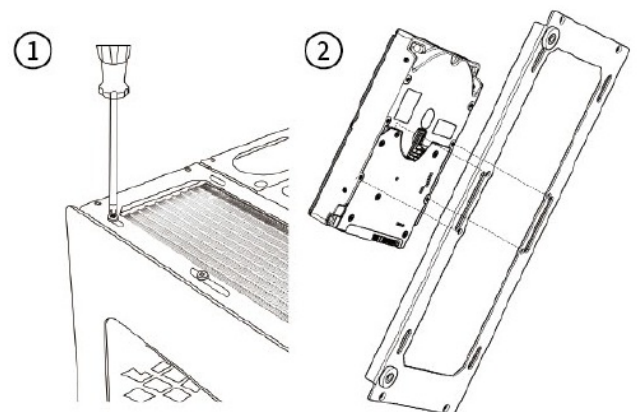
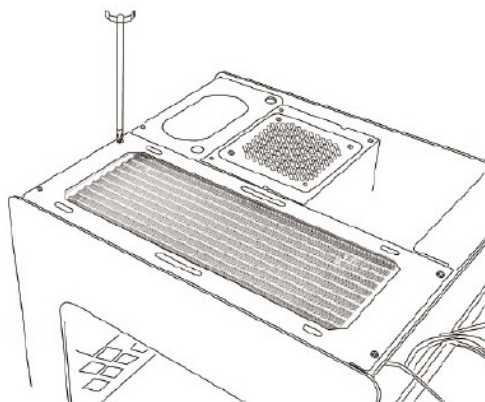

1. Align the holes, lock the heatsink screws and secure to the bracket.
2. Align the holes, lock the hard drive screws and fix on the bracket

(**Note:** 3.5" HDD\*1 is supported here, 3.5" HDD hard drive and 240 water cooling cannot be installed at the same time)

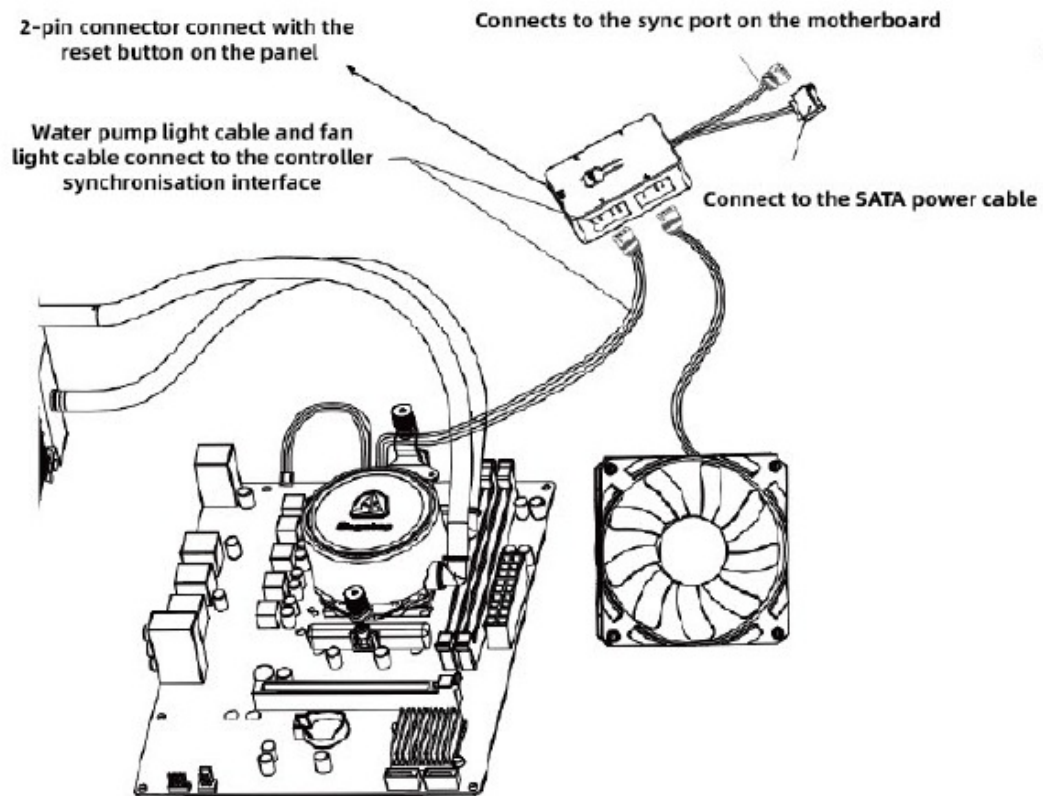

1. Connect the pump light cable and fan light cable to the controller synchronization interface
2. Connect the controller's SATA interface to the computer's energy SATA interface or connect the controller's synchronization interface to the computer's motherboard synchronization interface
3. You can connect the controller 2-pin interface to the reset button to replace the controller mode.

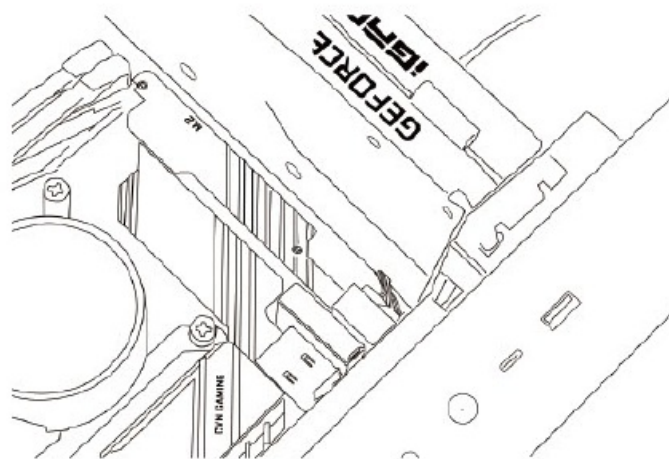

Insert the graphics card into the corresponding slot and tighten the screws, then connect the graphics card power supply cables.

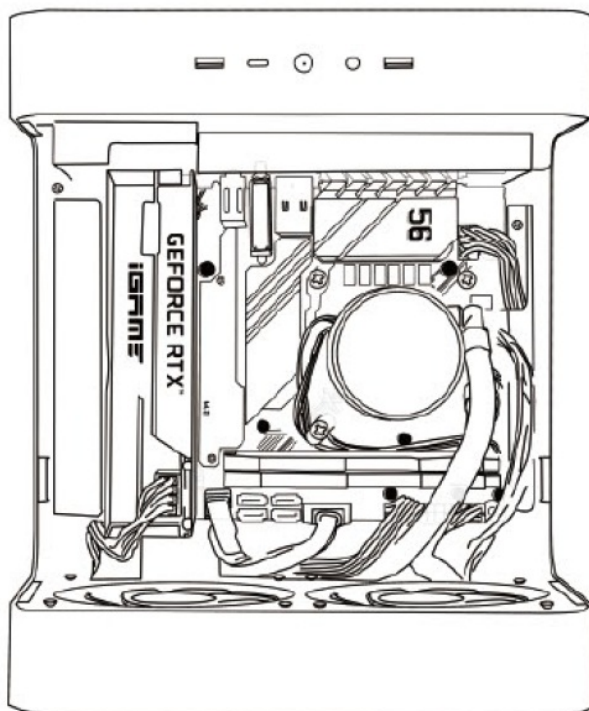

Put all the parts back into the chassis in sequence.

## Documents / Resources



[Segotep Slath Mini ITX PC Gaming Computer Case](#) [pdf] Instruction Manual  
Slath Mini ITX PC Gaming Computer Case, Slath Mini, ITX PC Gaming Computer Case, PC Gaming Computer Case, Gaming Computer Case, Computer Case, Case

## References

- [User Manual](#)

[Manuals+](#), [Privacy Policy](#)

This website is an independent publication and is neither affiliated with nor endorsed by any of the trademark owners. The "Bluetooth®" word mark and logos are registered trademarks owned by Bluetooth SIG, Inc. The "Wi-Fi®" word mark and logos are registered trademarks owned by the Wi-Fi Alliance. Any use of these marks on this website does not imply any affiliation with or endorsement.