



Contents [[hide](#)]

- [1 SEENSINY 4.3in Square Table Lamp](#)
- [2 INTRODUCTION](#)
- [3 SPECIFICATIONS](#)
- [4 WHAT'S IN THE BOX](#)
- [5 FEATURES](#)
- [6 SETUP GUIDE](#)
- [7 CARE & MAINTENANCE](#)
- [8 TROUBLESHOOTING](#)
- [9 PROS & CONS](#)
- [10 WARRANTY](#)
- [11 FREQUENTLY ASKED QUESTIONS](#)
- [12 References](#)



SEENSINY 4.3in Square Table Lamp



INTRODUCTION

The SEENSINY 4.3in Square Table Lamp is a little, understated bedside light that adds flair and usefulness to your room. This lamp, which was first introduced by SEENSINY on August 2, 2022, provides cozy, ambient lighting that is perfect for offices, dorms, nurseries, and bedrooms. At only **\$15.99**, it's a cost-effective addition to contemporary interior design. Its wooden base and square linen fabric shade let it to fit neatly on desks, bookshelves, or nightstands without taking up too much room. A 2700K E26 LED bulb is included with the lamp, providing soothing, non-flickering light that is easy on the eyes and ideal for working or reading. With a 400-lumen output and a height of just over 10 inches, the lamp is bright enough without being overpowering. The SEENSINY table lamp combines functionality and stylish design with ease of assembly, UL certification, and USB connectivity, providing great value for lighting needs in small spaces.

SPECIFICATIONS

Product Name	SEENSINY 4.3in Square Table Lamp
Price	\$15.99
Finish Type	Fabric Linen
Base Material	Wood
Lamp Shade Material	Fabric Linen
Bulb Base Type	E26
Bulb Included	Yes – LED bulb (energy-saving, eye-friendly, 2700K warm white)
Light Output	400 Lumens
Light Type	LED
Shape	Square
Dimensions	4.3" x 4.3" x 10.6".
Weight	9.12 ounces
Room Suitability	Bedroom, Living Room, Office, Study, Kids Room, Nursery
Recommended Uses	Reading, studying, relaxing, working, sleeping, decoration
Power Source	Corded Electric
Control Method	Push Button
Connectivity	USB
Assembly	Easy to assemble (UL-certified)
Special Features	Soft, non-flickering, eye-caring light; minimalist design

Waterproof	No
First Available Date	August 2, 2022
Manufacturer	SEENSINY

WHAT'S IN THE BOX

- Table Lamp
- User Guide

FEATURES

- **Compact Size:** Ideal for tiny settings, this item is 4.3" x 4.3" x 10.6".

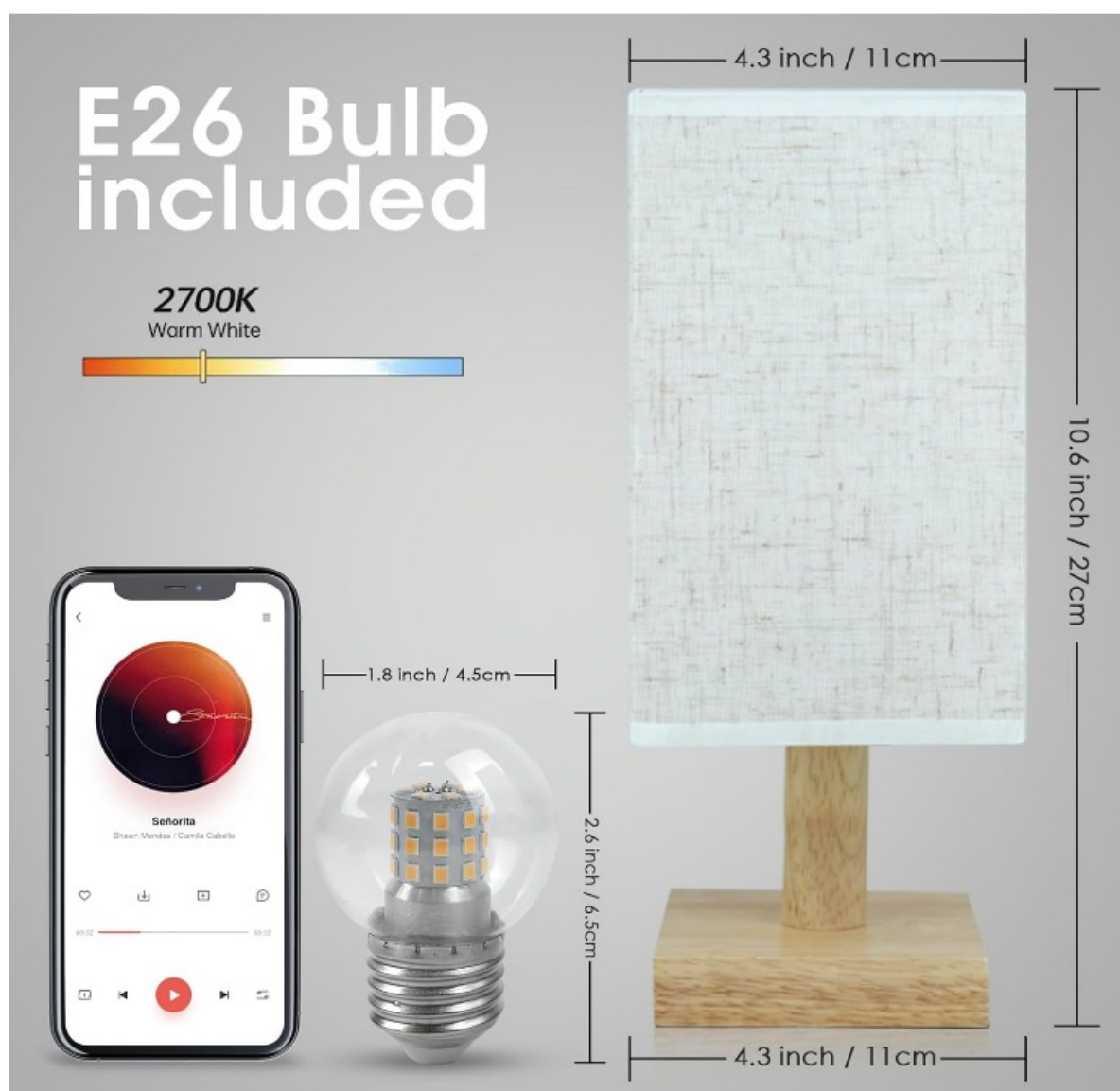

- **Minimalist Design:** Has a wood base and a square linen shade for a contemporary

appearance.

- **Warm White Light:** A romantic, homey ambiance is produced by the 2700K brightness.
- **Energy-Efficient LED:** An E26 LED bulb that uses up to 80% less energy is included.
- **Eye-Caring Light:** Provides gentle, flicker-free light to safeguard your eyes.
- **UL Certified:** Adheres to safety regulations for worry-free operation.



- **Multi-Room Use:** Perfect for libraries, workplaces, baby rooms, dorm rooms, and bedrooms.
- **Bright Output:** A brightness of 400 lumens is adequate for working or reading.
- **Push Button Control:** An easy-to-use on/off button.
- **Corded Electric:** Requires no batteries and is powered by a cord.
- **One Light Source:** One bulb is included for concentrated lighting.
- **USB Compatible:** Suitable for installations with a USB connection.
- **Sturdy Foundation:** On level surfaces, stability is guaranteed by the solid wood

foundation.

- **No Glare or Flicker:** Provides steady illumination for extended use.
- **Reasonably Priced:** Coming in at only \$15.99.



1 Unscrew the nut on the bulb base



2 Place lampshade on the bulb base

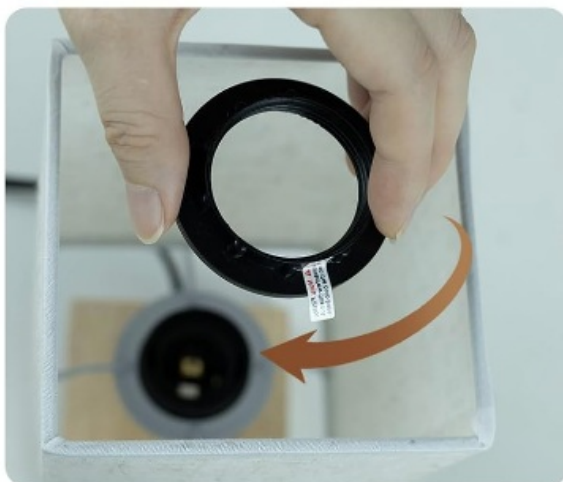

3 Get the nut fixed over the bulb holder



4 Install the E26 bulb

SETUP GUIDE

- **Unpack Carefully:** Remove the light and all protective materials after carefully unpacking.
- **Place on Surface:** Set it down on a level, sturdy surface, such as a bedside table.
- **Insert Bulb:** Screw the included E26 LED bulb into the socket.
- **Verify Fit:** Make sure the lightbulb is firmly attached, but avoid overtightening.
- **Plug In:** Attach the power cord to an outlet on the wall.
- **Turn On:** To turn on the light, use the push button.
- **Adjust Position:** To get the optimal lighting, move or angle the lamp as necessary.

- **Test Light:** Verify that the lightbulb illuminates continuously and without flickering.
- **Use Indoors Only:** Stay away from moisture and damp environments.
- **Steer Clear of Overloading:** Avoid using high-wattage bulbs.
- **Maintain Ventilation:** When used, do not cover the base or shade.
- **Use Surge Protection:** To shield the lamp from power spikes.
- **Label for Sharing:** If you want to use it in a shared or dorm room, tag it.
- **Store Packaging:** Keep the manual and box for further use.

CARE & MAINTENANCE

- **Dust Frequently:** Use a dry towel once a week to wipe the base and shade.
- **Steer Clear of Chemicals:** Avoid using strong cleansers on wood or cloth.
- **Unplug First:** Prior to cleaning or servicing, always unplug.
- **Examine Cable:** Look for signs of wear or damage on the power cable.
- **Clean Gently:** For minor stains on the shade, use a gently moist towel.
- **Keep Dry:** Avoid using in moist or damp environments.
- **Use the Correct Bulb:** Only use an E26 LED bulb in its place.
- **Avoid Sunshine:** To avoid discoloration, stay away from direct sunlight.
- **Secure Base:** To prevent tipping, make sure the light stays on a level surface.
- **Store Safely:** To avoid damage, pack the light carefully if you're relocating.
- **Avoid Overheating:** When using the lamp, avoid covering it.
- **Check Switch:** Verify that the push button operates smoothly.
- **Keep Away from Children:** For safety, keep out of children's reach.
- **Avoid Impact:** Be careful not to drop or bang the lamp.
- **Rotate Occasionally:** To prevent uneven fading or wear, rotate the lamp's position.

TROUBLESHOOTING

Issue	Possible Cause	Solution
Lamp doesn't turn on	Loose plug or faulty power source	Check plug and try a different outlet
Flickering light	Loose bulb or defective bulb	Tighten or replace the bulb

Issue	Possible Cause	Solution
Dim light output	Wrong bulb type or low voltage bulb	Use the included E26 LED bulb (400 lumens)
Bulb burns out quickly	Incompatible or low-quality bulb used	Replace with UL-listed LED E26 bulb
Shade looks uneven	Misaligned during assembly	Adjust and tighten screws properly
Button doesn't work	Mechanical jam or defect	Press firmly; if issue persists, contact support
Lamp gets hot	Incorrect bulb wattage	Use only recommended LED bulb
USB charging not working	Faulty cable or device	Test with another cable/device
Light too bright or too dim	Single brightness level setting	Use external dimmer adapter if compatible
Wood base wobbling	Uneven surface or loose screws	Place on flat surface and re-tighten base

PROS & CONS

Pros:

- Warm 2700K light creates a cozy atmosphere.
- Compact and stylish design suits any décor.
- LED bulb included; energy-efficient and eye-friendly.
- Easy to assemble and UL-certified for safety.
- Affordable price with solid construction.

Cons:

- Not waterproof—indoor use only.
- No dimming function included.
- Limited brightness control (single light setting).
- Push-button control may not suit all preferences.
- Fabric shade requires gentle cleaning.

WARRANTY

The SEENSINY 4.3in Square Table Lamp is backed by the manufacturer's standard limited warranty, covering defects in materials and workmanship under normal use. While the duration and conditions may vary by retailer, customers typically receive quick and friendly customer service for replacement or support. It's recommended to keep your purchase receipt and reach out to SEENSINY's support for any warranty claims.

FREQUENTLY ASKED QUESTIONS

What material is used in the SEENSINY 4.3in Square Table Lamp?

The SEENSINY 4.3in lamp features a wooden base and a square fabric linen shade, giving it a warm, modern, and minimalist aesthetic.

What kind of light does the SEENSINY 4.3in lamp provide?

It offers a soft, warm white glow at 2700K, perfect for relaxing, reading, or creating a cozy atmosphere in any room.

How is the SEENSINY 4.3in Square Lamp powered?

It operates via corded electric power, ensuring stable and uninterrupted use without needing batteries.

What type of bulb base does the SEENSINY 4.3in lamp use?

It uses an E26 bulb base, which is standard and widely compatible with other LED or smart bulbs.

Why is my SEENSINY 4.3in lamp flickering?

Flickering may be caused by a loose bulb or incompatible replacement. Use the included E26 LED bulb or a compatible one for best results.

What should I do if the bulb in my SEENSINY 4.3in lamp burns out quickly?

Replace it with another energy-efficient E26 LED bulb. If the issue persists, reach out to SEENSINY customer support for assistance.

Is the SEENSINY 4.3in Square Table Lamp waterproof?

This lamp is not waterproof and should be kept away from areas with high moisture or water exposure.

References

- [User Manual](#)

🔖 4.3in Square Table Lamp, B0D1R3GBYG , SEENSINY , user

📁 SEENSINY guide

Leave a comment

Your email address will not be published. Required fields are marked *

Comment *

Name

Email

Website

☐ Save my name, email, and website in this browser for the next time I comment.

Post Comment

Search:

e.g. whirlpool wrf535swhz

Search

Manuals+ | Upload | Deep Search | Privacy Policy | @manuals.plus | YouTube

This website is an independent publication and is neither affiliated with nor endorsed by any of the trademark owners. The "Bluetooth®" word mark and logos are registered trademarks owned by Bluetooth SIG, Inc. The "Wi-Fi®" word mark and logos are registered trademarks owned by the Wi-Fi Alliance. Any use of these marks on this website does not imply any affiliation with or endorsement.