



Contents [[hide](#)]

- [1 SEENDA COE202 Multi Device Colored Keyboard Mouse Combo](#)
- [2 Product Features](#)
- [3 2.4G USB Connection](#)
- [4 Keyboard Bluetooth Connection](#)
- [5 Keyboard Channel Switching](#)
- [6 Mouse Channel Switching](#)
- [7 Keyboard Low Battery Instructions](#)
- [8 Multimedia Function Keys](#)
- [9 Product Specifications](#)
- [10 Memory Function](#)
- [11 Package Content](#)
- [12 Safety](#)
- [13 EU Declaration of Conformity](#)
- [14 Product Warranty](#)
- [15 Documents / Resources](#)
 - [15.1 References](#)

SEENDA

SEENDA COE202 Multi Device Colored Keyboard Mouse Combo



Product Features

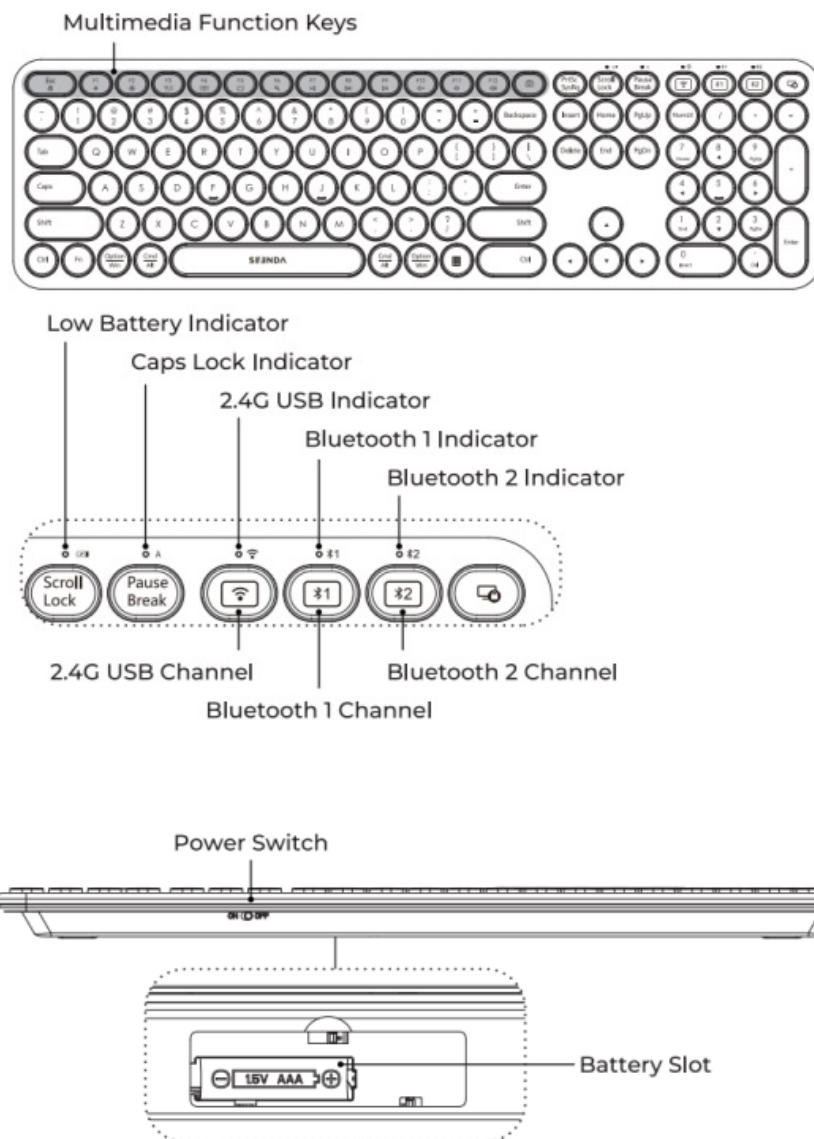

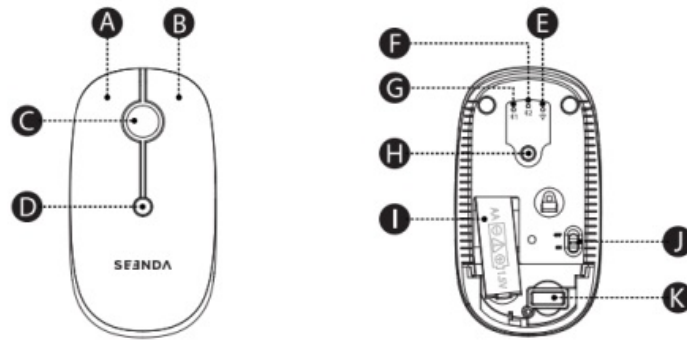

- A Left Button
- B Right Button
- C Scroll Wheel
- D DPI Button
- E 2.4G USB Indicator / DPI Indicator
- F Bluetooth 2 Indicator / DPI Indicator
- G Bluetooth 1 Indicator / DPI Indicator
- H Channel Switch Button
- I Battery Slot
- J Power Switch
- K USB Receiver

2.4G USB Connection

1.

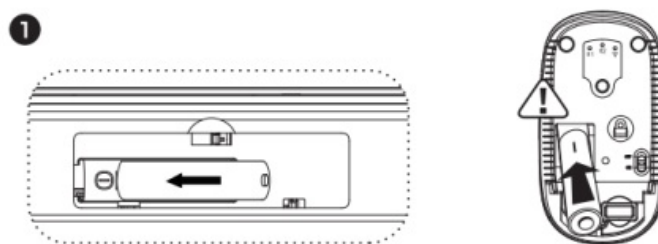



Remove the battery cover, and insert the battery. (Please ensure that the positive and negative terminals are placed correctly.)

2.

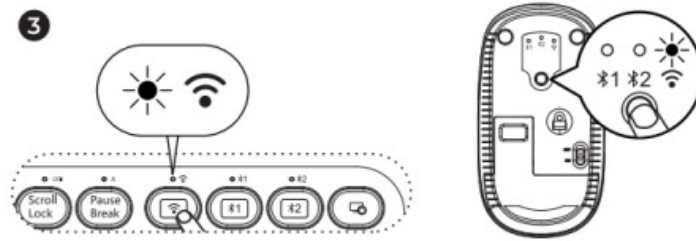

Turn the power switch to ON.



3. Press the  channel button, and the  channel indicator light is on, the keyboard enters the 2.4G USB channel.

Press the channel switch button until the  channel indicator light is on, and the mouse enters the 2.4G USB channel.

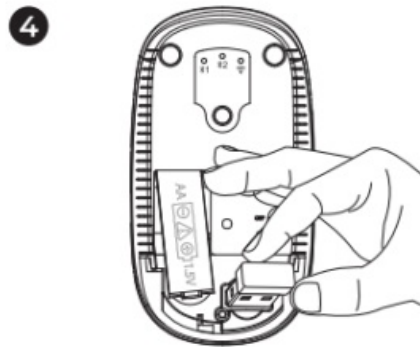

4. Take out the USB receiver.

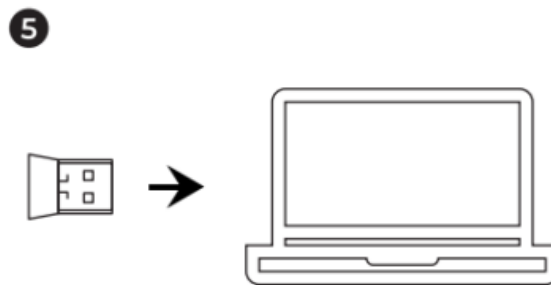

5. Plug the USB receiver into the USB port of the computer, the keyboard and mouse will connect automatically.

Keyboard Bluetooth Connection

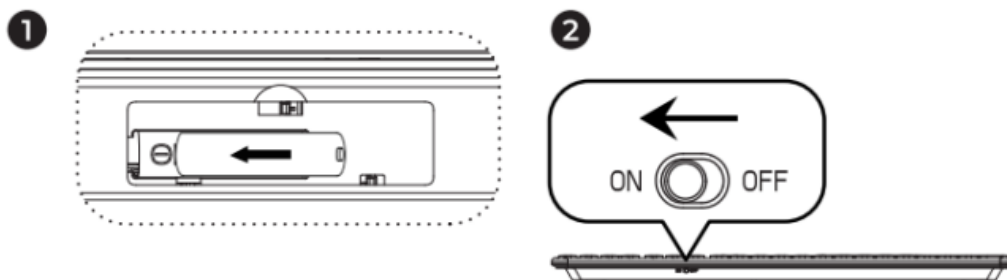

1. Remove the battery cover, and insert the battery.(Please ensure that the positive and negative terminals are placed correctly.)

2. Turn the power switch to ON.

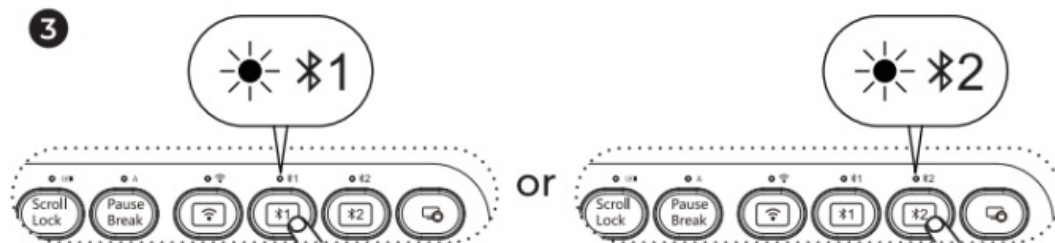

3. Press **1** / **2** channel button, and the **1** / **2** corresponding indicator light is on, the keyboard enters the Bluetooth channel. Long Press this selected channel button for 3~5 seconds until the corresponding indicator light flashes quickly, and the keyboard enters Bluetooth pairing mode.

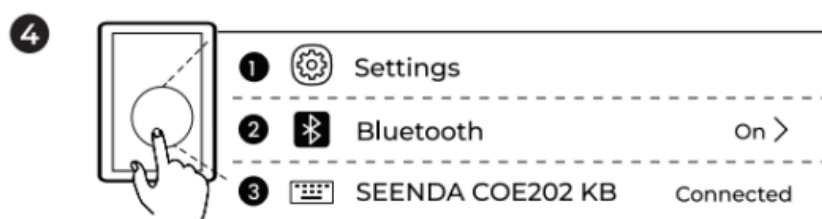

4. Turn on the Bluetooth settings on your device, search or select “SEENDA COE202 KB” and start Bluetooth pairing until the connection is completed.

Mouse Bluetooth Connection

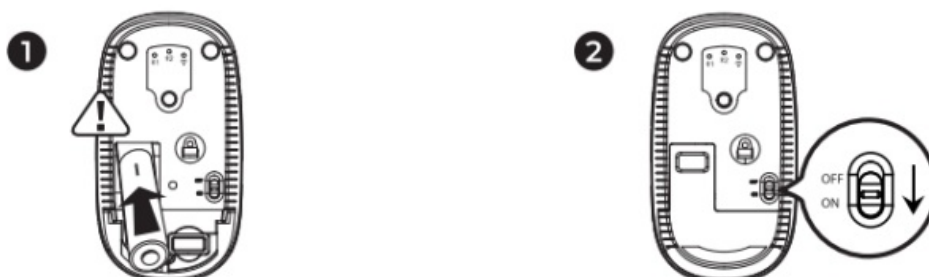

1. Remove the battery cover, and insert the battery.(Please ensure that the positive and negative terminals are placed correctly.)
2. Turn the power switch to ON.

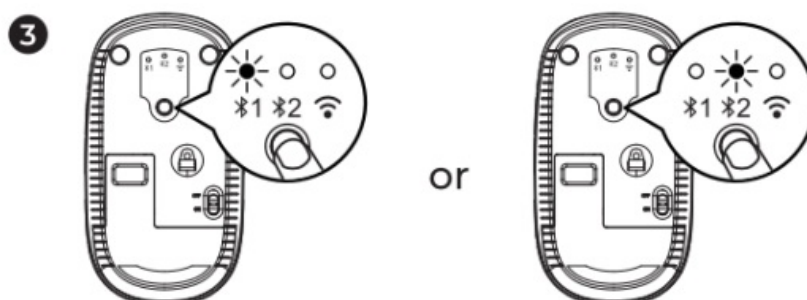

3. Press the channel switch button until the **1** / **2** channel indicator light is on, and the mouse enters the Bluetooth channel. Long press the channel switch button for 3~5 seconds until the indicator light flashes quickly, and the mouse enters Bluetooth

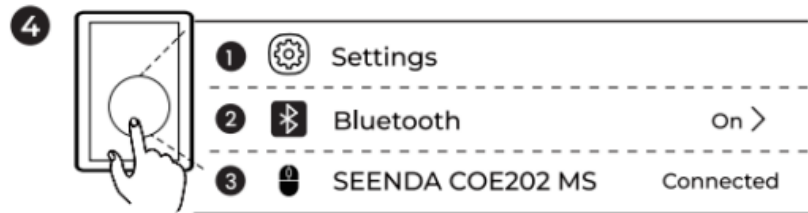

pairing mode.



4. Turn on the Bluetooth settings on your device, search or select “SEENDA COE202 MS” and start Bluetooth pairing until the connection is completed.

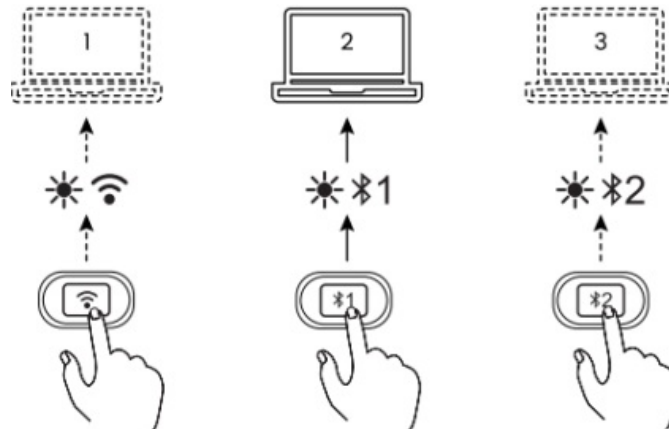

Keyboard Channel Switching

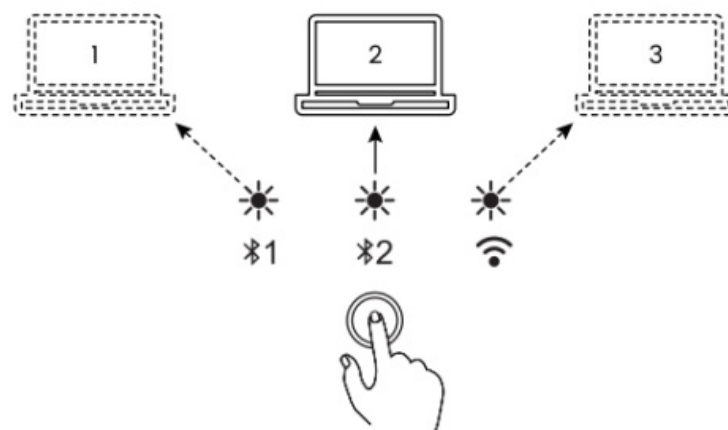

After ( |  | ) are connected, single press the channel button on the keyboard, easily switch between multiple devices.

Mouse Channel Switching

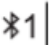
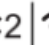

After  |  |  are connected, single press the channel switch button on the bottom of the mouse, easily switch between multiple devices.

Keyboard Low Battery Instructions

When the low battery indicator flashes red, it indicates that the keyboard is entering a low battery state and will shut down automatically if the battery is not replaced. The keyboard requires one AAA battery. When installing the battery, please ensure that the positive and negative terminals are correctly aligned.

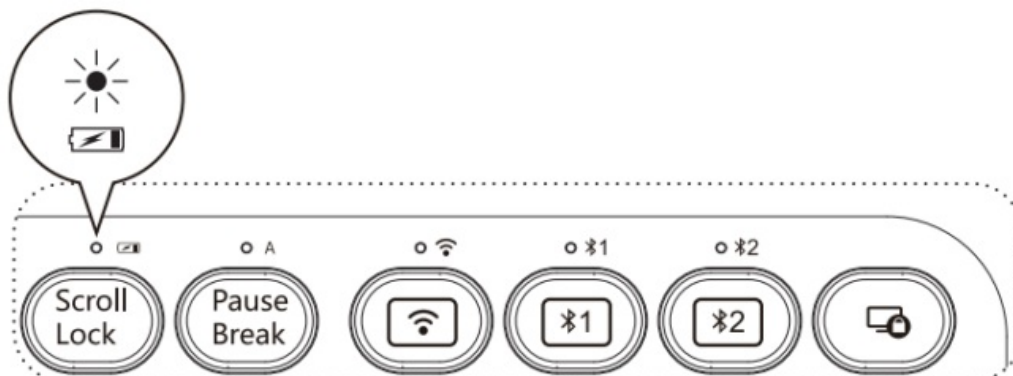

Multimedia Function Keys

Keys	Windows	Android	iOS	Mac OS
	Light -	Light -	Light -	Light -
	Light +	Light +	Light +	Light +
	Application Switch	Application Switch	Window Switch	Window Switch
	Window Switch	Window Switch	Application Switch	Application Switch
	Display Desktop	Go Home	Go Home	Go Home
	Search	Search	Search	Search
	Previous Track	Previous Track	Previous Track	Previous Track
	Play & Pause	Play & Pause	Play & Pause	Play & Pause
	Next Track	Next Track	Next Track	Next Track
	Mute	Mute	Mute	Mute
	Volume -	Volume -	Volume -	Volume -
	Volume +	Volume +	Volume +	Volume +
	Screenshot	Screenshot	Screenshot	Screenshot
	FN+ESC (FN lock) button to turn on or turn off the FN function			

Note: The FN function is a cyclic mode (F1-F12 and multimedia functions are cyclically used).

Product Specifications

Keyboard Parameters

Working voltage	1.5V
Working current	≤5mA
Standby current	≤0.4mA
Sleeping current	≤0.04mA
Standby time	300 Days
Working time	100 Hours
Wake up way	Press any key
Keyboard Size	436x124x22mm /17.2*4.9*0.9in
Keyboard Weight	510g/1.13lb

Mouse Parameters

Engine	Optical
DPI	1000-1600-2400
Working voltage	1.5V
Working current	≤10mA
Standby current	≤0.6mA
Sleeping current	≤0.05mA
Standby time	300 Days
Working time	100 Hours
Wake up way	Press any key
Mouse Size	110*60*31mm /4.3*2.4*1.2in
Mouse Weight	60g/0.13lb

System Compatibility

2.4G USB Channel	An available USB port; Windows 7 to 11 or above.
Bluetooth 1/2 Channel	Bluetooth receiving device; Windows 8/10 or above, macOS 10.12 or above, iOS 8.0 or above, Android 4.4 or above.

Sleep Mode

1. When the keyboard/mouse stops working for 60 minutes, it will automatically enter the sleep mode for energy saving.
2. When use the keyboard/mouse again, you only need to press any key, and the keyboard/mouse will wake up within 3-5 seconds.
3. The channel indicator light will turn on again and start working.

Memory Function

The keyboard/mouse has a memory function. When a channel is connected normally, the keyboard/mouse defaults to this channel after turning off the device and turn back on, and the channel indicator lights up.

Package Content

- 1* Wireless Keyboard
- 1* Wireless Mouse
- 1* USB Receiver
- 1* User Manual

Safety

Safety Warning

IMPORTANT: To reduce risk of fire, electric shock, or injury, follow these safety instructions.

- Heat Exposure: Avoid leaving the item in high-temperature environments or in direct sunlight, which could result in a fire hazard.
- Liquid Exposure: Keep the item away from water and liquids. Do not use if wet until thoroughly dried.
- Damage and Leakage: Cease usage and consult customer service if the item is damaged or the battery leaks.
- Correct Disposal: Follow local regulations for disposing of electronic devices and batteries. Do not dispose of with household waste.
- Radio Frequency Interference: This device may cause interference with other electronics. Keep a safe distance from sensitive devices.

- Child Safety: Keep the item and its components out of reach of children to avoid choking or battery ingestion hazards. Never allow children to handle the item unsupervised.

CAUTION: Non-compliance with the above warnings can lead to serious injury or property damage.

EU Declaration of Conformity

- Declared Object: Multi-Device Colored Keyboard Mouse Combo
- Model: COE202
- Rating: Keyboard: 1.5V  10mA
- Mouse: 1.5V  10mA
- Place of Production: Made in China
- Manufacturer: Dongguan Lingjie Electronics& Technology Co., Ltd
- E-mail: andymo@szforter.com
- Address: Kulding Ton, D, Thgang My, Road, Ta Province, China, 523590

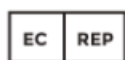

European Representative:

- Business name: g.L.L. GmbH
- Business address: Bauernvogtkoppel, 55c, 22393, Hamburg, Germany
- Email: g.L.L.DE@outlook.com



Business name: AMANTO INTERNATIONAL TRADE LIMITED

- Business address: The Imperial, 31-33 St Stephens Gardens, Notting Hill, London, United Kingdom, W2 5NA
- Email: AmantoUK@outlook.com

It is our sole responsibility to declare that the above products are in full compliance with Directive 2014/53/EU, 2011/65/EU (as amended)

- Position: Managing Director

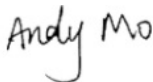

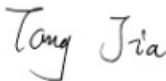
- Signature: 
- Date of Sign: 2022.1.5

- EU agent name: 
- Date of Sign: 2022.1.5

Product Warranty

All Seenda products come with a 24-month warranty policy, please do not hesitate to contact us if you have any questions. Our support team will try our best to provide you with a pleasant shopping experience.

- Our email: support@seenda.com
- Our website: www.seenda.com
- Phone: +1 [844-968-2543](tel:844-968-2543) Mon-Fri: 10AM – 2PM; 3PM – 7PM ET *Closed during Holidays

-  3-Channel Multi-OS Connection
-  Full Size 110-Key Design
-  Quiet Soft Typing Experience

Documents / Resources

	<p>SEENDA COE202 Multi Device Colored Keyboard Mouse Combo [pdf] User Manual</p> <p>COE202, COE202 Multi Device Colored Keyboard Mouse Combo, Multi Device Colored Keyboard Mouse Combo, Device Colored Keyboard Mouse Combo, Colored Keyboard Mouse Combo, Keyboard Mouse Combo</p>
---	--

References

- [User Manual](#)

Leave a comment

Your email address will not be published. Required fields are marked *

Comment *

Name

Email

Website

☐ Save my name, email, and website in this browser for the next time I comment.

Post Comment

Search:

e.g. whirlpool wrf535swhz

Search

[Manuals+](#) | [Upload](#) | [Deep Search](#) | [Privacy Policy](#) | [@manuals.plus](#) | [YouTube](#)

This website is an independent publication and is neither affiliated with nor endorsed by any of the trademark owners. The "Bluetooth®" word mark and logos are registered trademarks owned by Bluetooth SIG, Inc. The "Wi-Fi®" word mark and logos are registered trademarks owned by the Wi-Fi Alliance. Any use of these marks on this website does not imply any affiliation with or endorsement.