



Seeded Technology S210X Air Temperature and Humidity Sensor User Guide

[Home](#) » [Seeded Technology](#) » Seeded Technology S210X Air Temperature and Humidity Sensor User Guide 



Quick Start for SenseCAP S210X Sensors

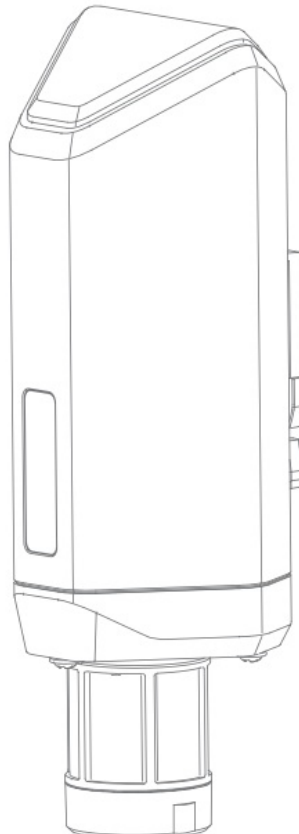

Contents

- [1 Product Catalog & User Guide](#)
- [2 Download SenseCAP Mate App](#)
- [3 Frequency Explained](#)
- [4 Replacing Battery](#)
- [5 Installation Instructions](#)
- [6 Warranty Policy](#)
- [7 FCC Warning](#)
- [8 Documents / Resources](#)
 - [8.1 References](#)
- [9 Related Posts](#)

Product Catalog & User Guide

Please read the product catalog and user guide carefully before using the product. You can scan the QR Code below to read and download documents. Or visit the link:

sensecap-docs.seeed.cc



Documents

<https://sensecap-docs.seeed.cc/index.html>

Download SenseCAP Mate App

SenseCAP Mate provides a simple way to experience sensors.

1. Pair via Bluetooth
2. Configure device parameter
3. Check device status and data
4. Upgrade the firmware via OTA

For iOS, please search for “SenseCAP Mate” at the App Store to download.

You can also scan the QR Codes below to download the App in the Android or iOS version.



Android

<http://sensecap-app-download.seeed.cn>



<https://apps.apple.com/app/sensecap-m>

Frequency Explained

Sensors are manufactured to support a universal frequency plan from 902MHz ~928MHz in one SKU. The frequency plan setting is none by default and it will not transmit RF signal until it has been set by App via Bluetooth at the first power up. And it can be changed to another frequency plan at any time.

Replacing Battery

STEP 1

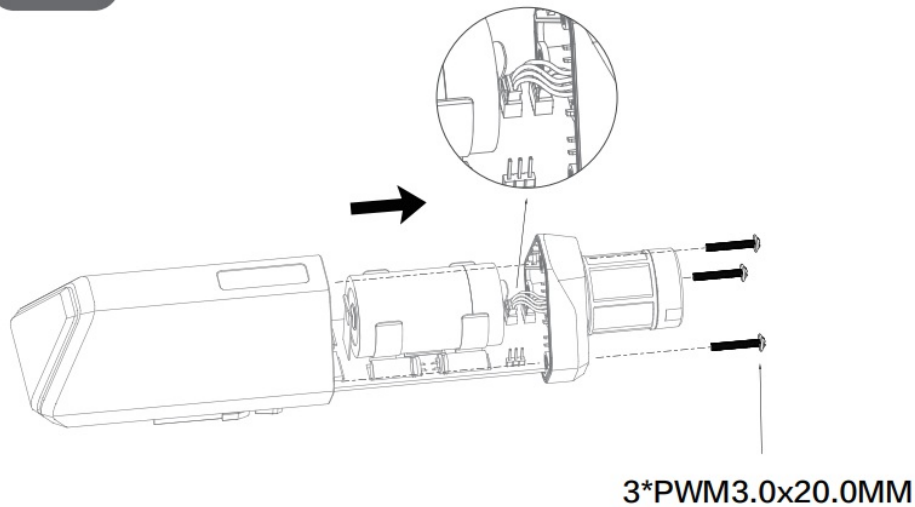

Note: The sensor and PCBA are connected by wire, and the abnormal contact of the sensor will be caused by strong pull.

STEP 2

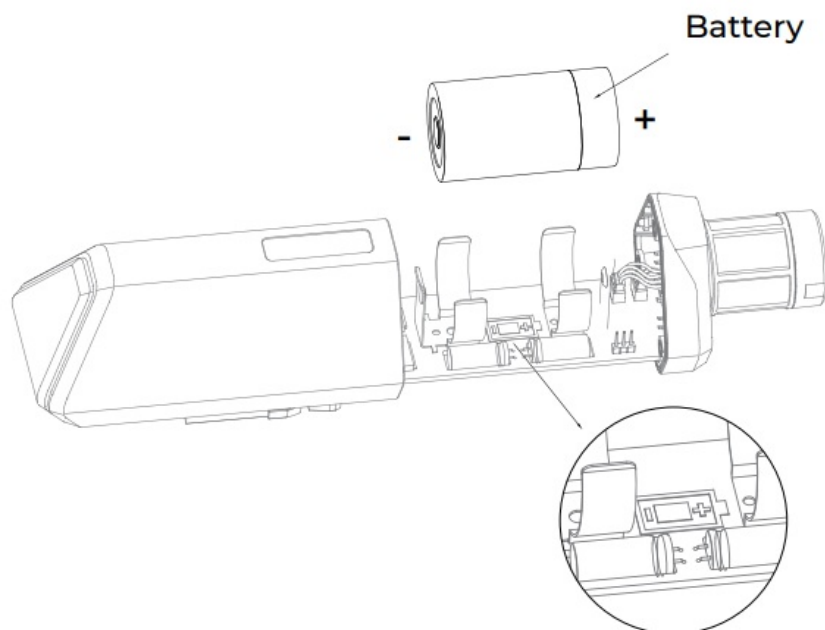

Note: Do not invert the positive and negative batteries. Otherwise, a short circuit may occur and the device may be damaged.

STEP 3

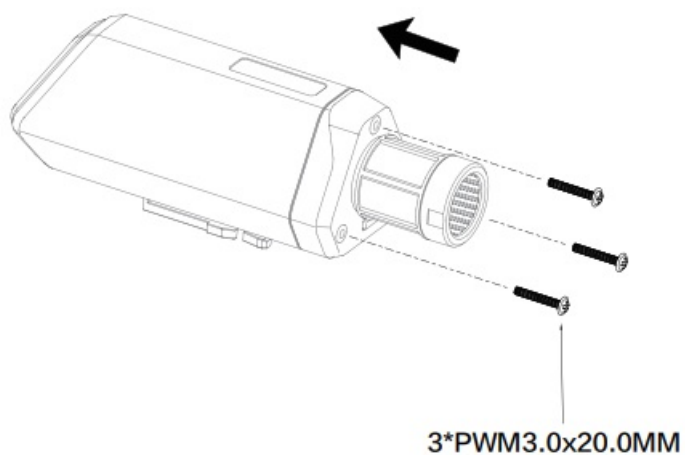

Note: During the installation, ensure that the waterproof washer is properly installed and the screws are locked; otherwise, water will flow into the device.

Installation Instructions

Install the bracket

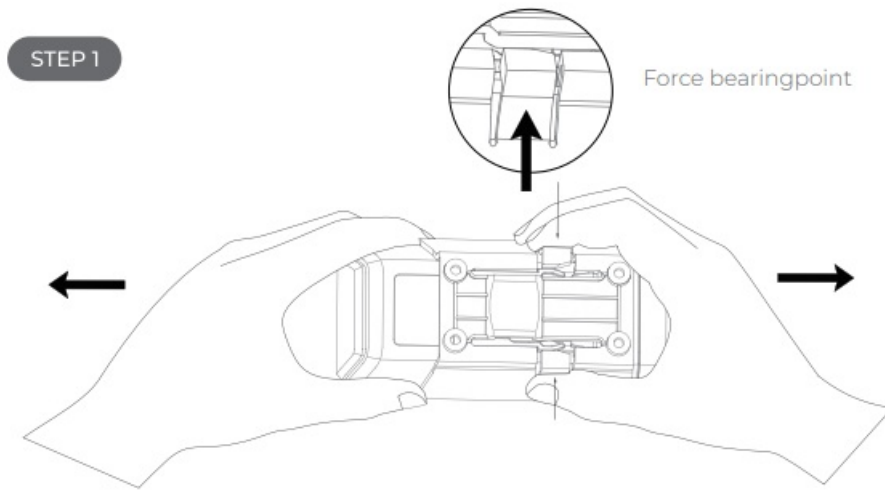

One hand holds the clasp while the other holds the device. Pull outward with opposite force.

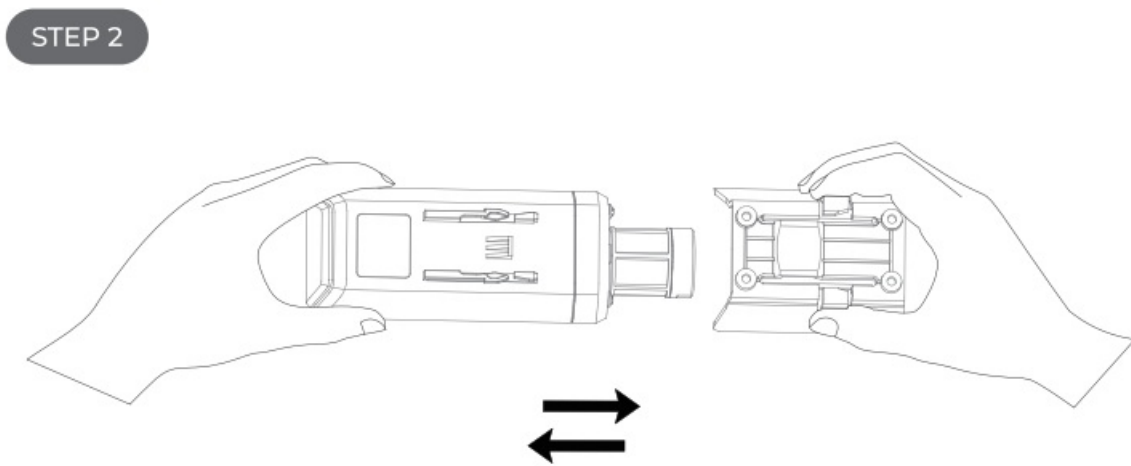

Mount on the pole

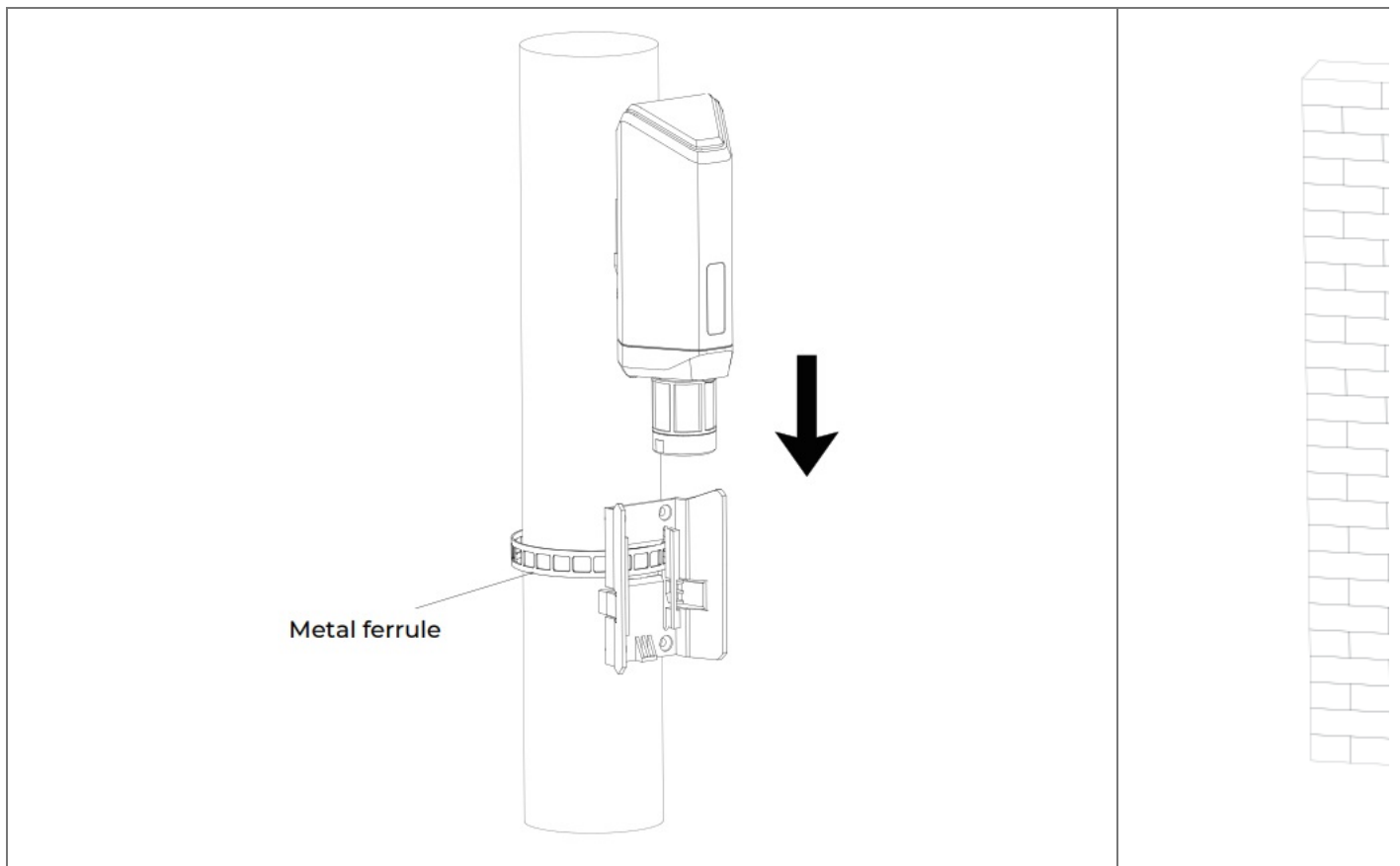

Warranty Police

Warranty period for Sensors is 12 months as of the date of delivery. Please refer to this link for detailed information:

seeedstudio.com/get_help/ReturnsRefund

Support

Contact Seeed technical support at sensecap@seeed.cc.

Please kindly provide the following information:

1. Product name, model, and EUI
2. Location of the installation site
3. Contact information of a technical person who can provide further information on the problem

FCC Warning

Changes or modifications not expressly approved by the party responsible for compliance could void the user's authority to operate the equipment.

This device complies with Part 15 of the FCC Rules. Operation is subject to the following two conditions:

1. this device may not cause harmful interference, and
2. this device must accept any interference received, including interference that may cause undesired operation.

This transmitter must not be co-located or operating in conjunction with any other antenna or transmitter.

Note: This equipment has been tested and found to comply with the limits for a Class B digital device, pursuant to Part 15 of the FCC Rules. These limits are designed to provide reasonable protection against harmful interference in a residential installation. This equipment generates, uses, and can radiate radio frequency energy, and if not

installed and used in accordance with the instructions, may cause harmful interference to radio communications. However, there is no guarantee that interference will not occur in a particular installation. If this equipment does cause harmful interference to radio or television reception, which can be determined by turning the equipment off and on, the user is encouraged to try to correct the interference by one or more of the following measures:

- Reorient or relocate the receiving antenna.
- Increase the separation between the equipment and receiver.
- Connect the equipment into an outlet on a circuit different from that to which the receiver is connected.
- Consult the dealer or an experienced radio/TV technician for help.

This device complies with FCC radiation exposure limits set forth for an uncontrolled environment. This device should be installed and operated with a minimum distance 20cm between the radiator & your body.

Documents / Resources

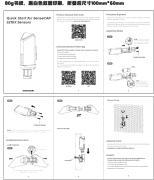
	Seeed Technology S210X Air Temperature and Humidity Sensor [pdf] User Guide S210X, Z4T-S210X, Z4TS210X, S210X Air Temperature and Humidity Sensor, Air Temperature and Humidity Sensor
---	---

References

- [🌐 How To Get Help -Seeed Studio](#)
- [🌐 SenseCAP API Document](#)