



# Seeed Studio BliKVM Plug Play Pcle Handbook Instruction Manual

[Home](#) » [seeed studio](#) » Seeed Studio BliKVM Plug Play Pcle Handbook Instruction Manual 

## Seeed Studio BliKVM Plug Play Pcle Handbook Instruction Manual



### Contents

- 1 Product Overview
- 2 Unpack and take out the devices
- 3 Install the main device
- 4 Connect USB and ATX
- 5 Connect OLED
- 6 Connect the HDMI cable
- 7 Connect the network cable
- 8 Connect PWR-IN
- 9 Test
- 10 Install the product into the computer case
- 11 Appendix 2.Install the cooling fan
- 12 Appendix 3.Install wi fi antenna
- 13 Documents / Resources
  - 13.1 References
- 14 Related Posts

## Product Overview



## Unpack and take out the devices



## Product List



## Install the main device



✓ Install CM4 and 4 Hex spacers (This article takes CM4 lite as an example, using the image in the Micro SD card, CM4 eMMC user need to burn the image by yourself.) Stick a heat conductive sheet on the top of CM4 , tear off the protective film of the sheet.

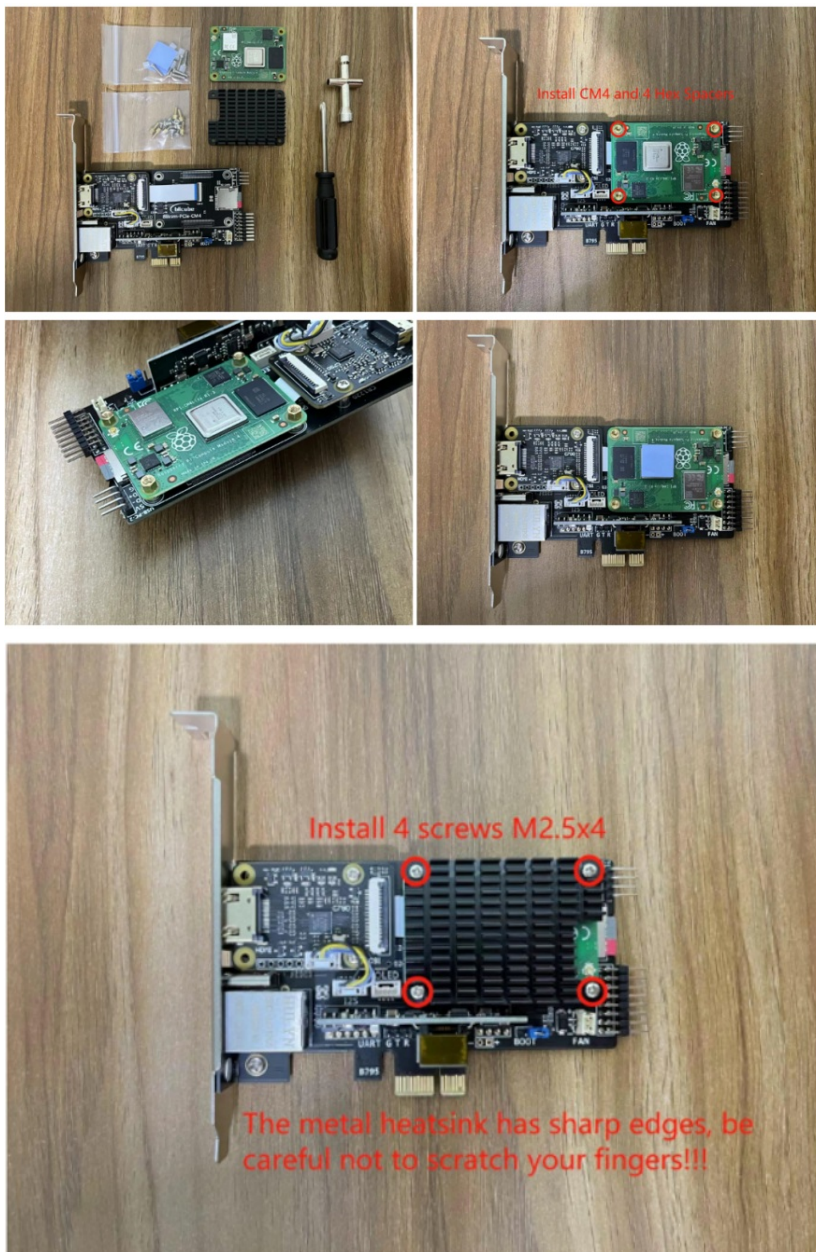

The main device installation is complete.



## Connect USB and ATX

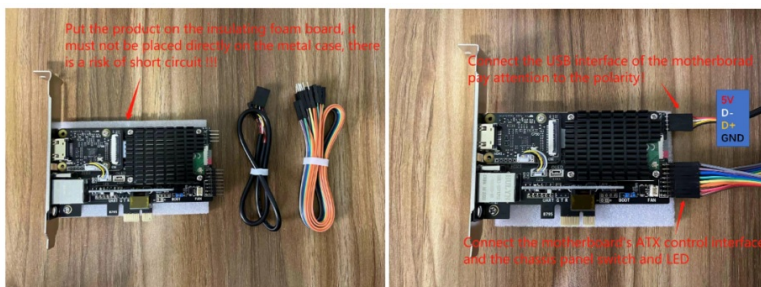

The motherboard used in this article is Asus H520M-E, the interface definition of different motherboards may be different, please refer to your motherboard manual.

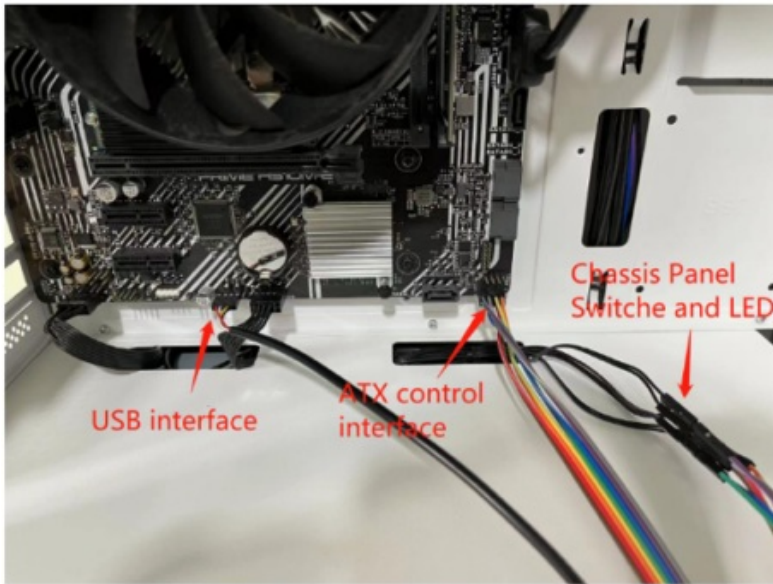



mother board Asus H510M-E	Bilk- Pie	Chassis Panel Switches and LEDs
		
1	LED PWR+	POWER LED+
2	LED PWR-	POWER LED-
3	BIN PWR+	POWER SW
4	BTN PWR-	
5	LED HDD+	HDD LED+
6	LED HDD-	HDD LED-
7	BTN RST+	RESET SW
8	BTN RST-	

## Connect OLED



The **OLED** you received does not have a bracket installed. Please refer to the picture for installation. In addition, **OLED** support is made of acrylic material, which needs to be used after removing the protective film on the surface.

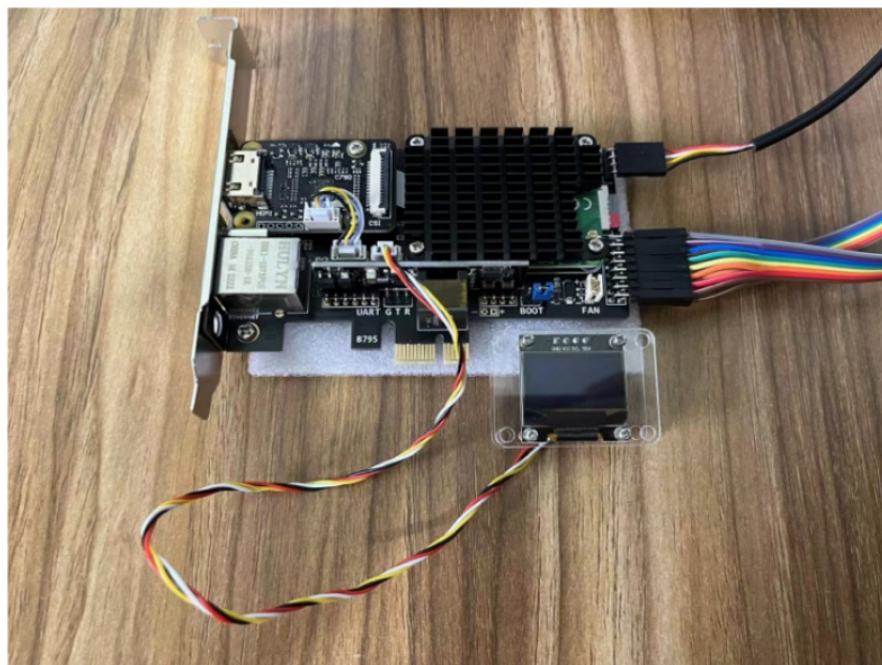

## Connect the HDMI cable



Connect the HDMI output port of the computer directly to the HDMI IN port of the product with an HDMI cable. The HDMI pass-through EDID emulator is not necessary! If your computer does not output the correct HDMI format, plug the HDMI pass-through EDID emulator into the HDMI output port of the computer. This allows

you to configure a fixed HDMI output format on your computer.



### Connect the network cable



Gigabit Ethernet port standard: IEEE 802.3af Po E input voltage:37v-57v.

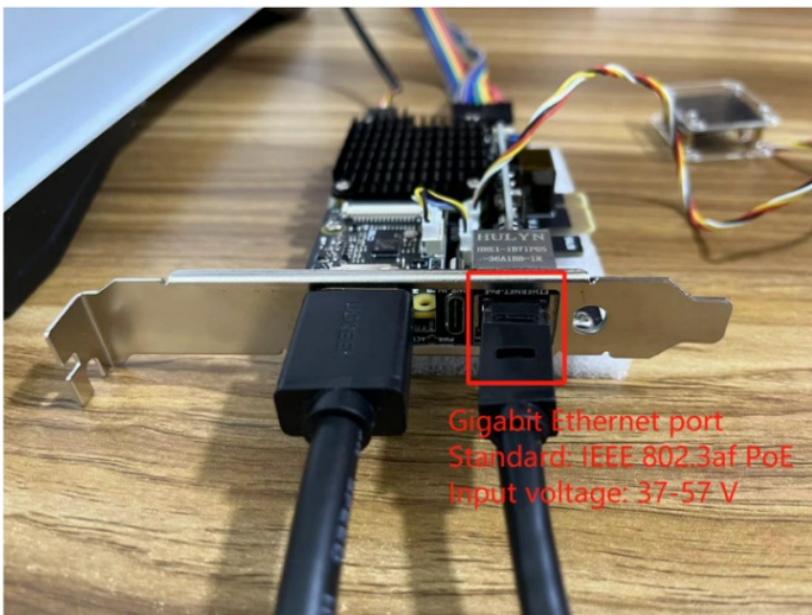

When using Po E power supply, there is no need to connect the **PWR-IN** port.

### Connect PWR-IN

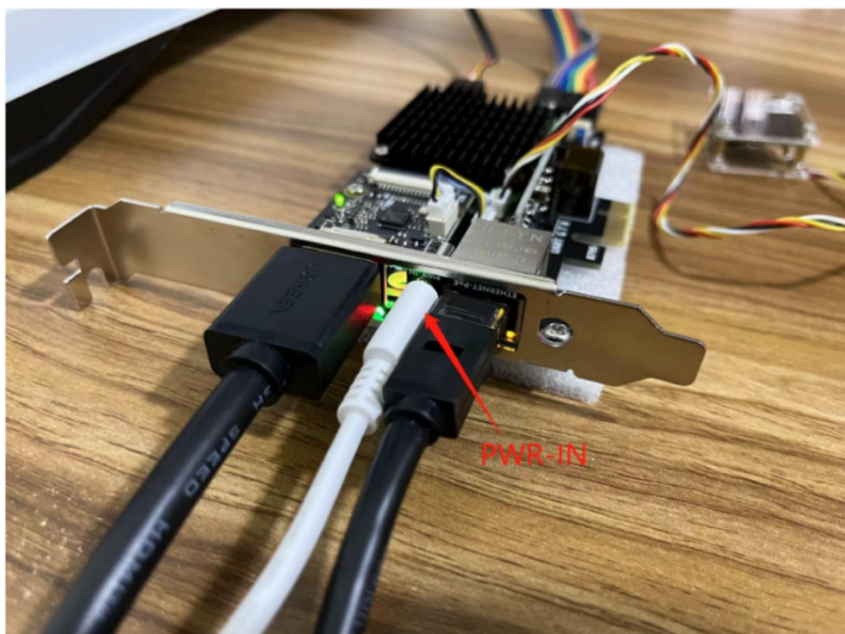

When not using Po E power supply, connect the **PWR-IN** port to a standard 5V/3A USB power supply.

## Test



OLED screen showing device IP and other information.

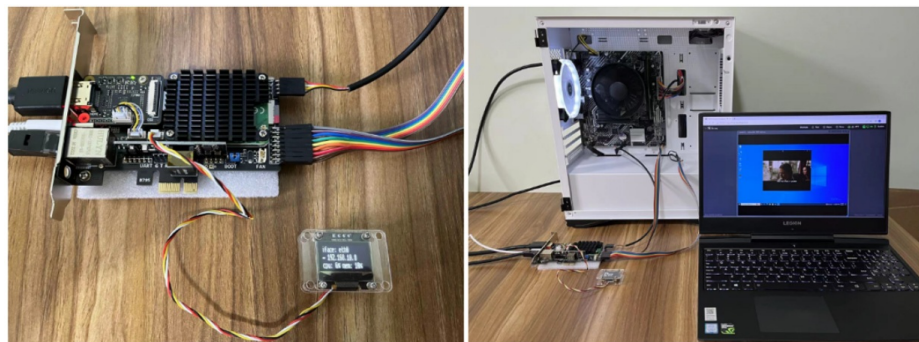

Access the IP address in browser. After passing the test, install the product into the computer case.

## Install the product into the computer case



Disconnect power and wiring, install the product on the motherboard, and reconnect the cables after installation is complete. The color of ATX cable received in different batches may be different. Please directly refer to the pin definition for connection.

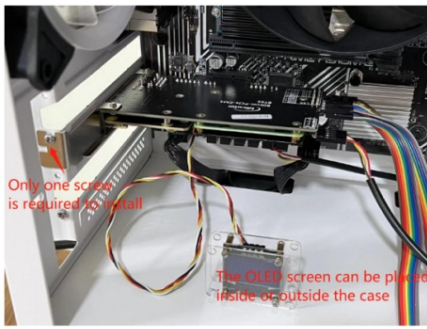

**Enjoy!**

Appendix 1. Install a low profile PCIe I/O bracket



**Note**

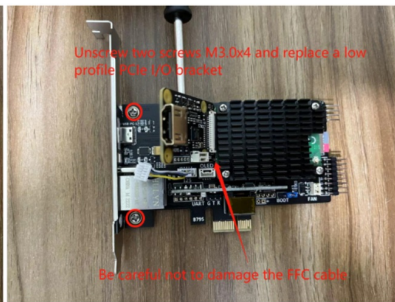

**Appendix 2. Install the cooling fan**



Usually the metal heatsink is sufficient, the cooling fan is not necessary.

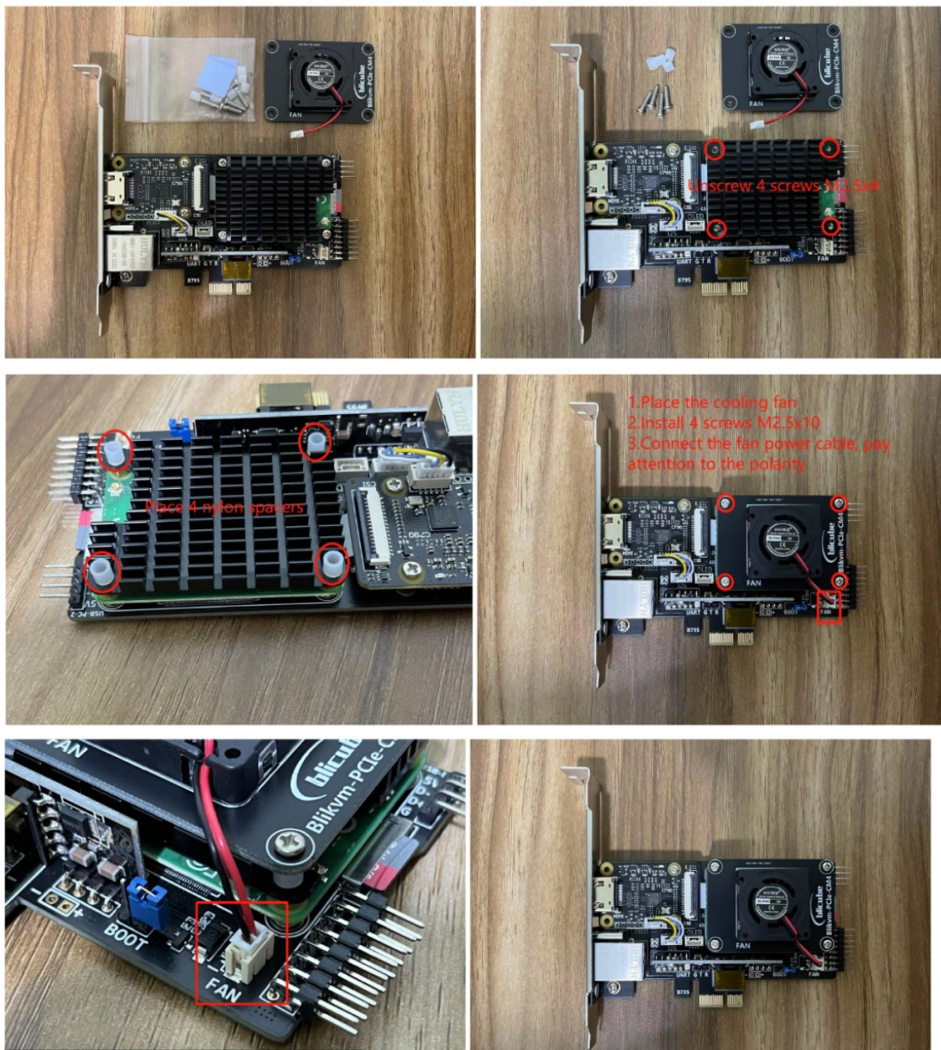

The cooling fan is controlled by CM4 via GPIO12.

### Appendix 3. Install wi fi antenna



Please note that not all **CM4** versions come with wi-fi modules.

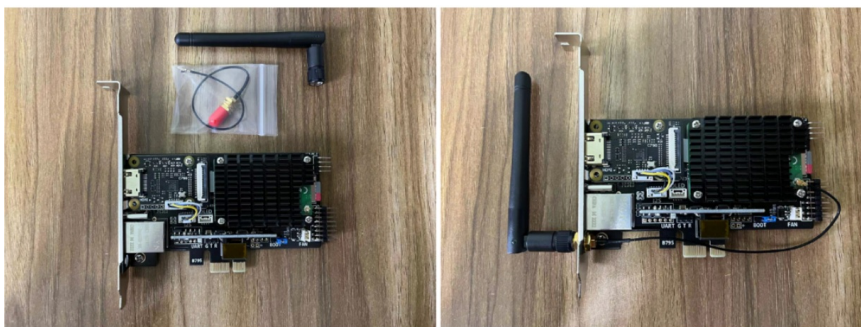

More

See <https://wiki.blicube.com/blikvm/en/>

Documents / Resources

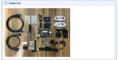
<div><div><div>Product Overview</div></div><div><div>1. Unpack and take out the device</div></div></div>	<p><a href="#">Seeed Studio BliKVM Plug Play Pcle Handbook</a> [pdf] Instruction Manual</p> <p>BliKVM, BliKVM Plug Play Pcle Handbook, Plug Play Pcle Handbook, Play Pcle Handbook, Pcl e Handbook, Handbook</p>
----------------------------------------------------------------------------------------------------------------------------------------------------------------------------------------------------------------------------------------------------------------------------	------------------------------------------------------------------------------------------------------------------------------------------------------------------------------------------------------------------

References

- [🌐 BliKVM Overview - BliKVM Handbook](#)