



SecuX Nifty Hardware Wallet User Guide

[Home](#) » [SecuX](#) » SecuX Nifty Hardware Wallet User Guide 

SecuX

Nifty Hardware Wallet
User Guide

Contents

- [1 Overview](#)
- [2 Device Initialization](#)
- [3 Introduction to the Main Menu of the Device](#)
- [4 Add wallet to Nifty App](#)
- [5 Features of Nifty APP](#)
- [6 Documents / Resources](#)
- [7 Related Posts](#)

Overview

SecuX Nifty hardware Wallet (the device) is to secure your crypto assets in a safe place (saving private key in a secure element) and provide you an easy way to receive, send or manage these crypto assets including crypto and NFT. To make the device work, you need to initialize the device first and then connect to the Nifty APP for further applications.



(Nifty hardware wallet)

(Nifty App)

Device Initialization

Once the Device leaves factory, there is no private key pre-set in the device. You will be asked to generate your own unique private key or restore an existing private key (recovery words) during device initialization.

Step 1: Charge the device

Charge the device by connecting the device to an USB power adapter via the supplied USB cable. For the 1st time charging it is suggested to charge at least 2 hours.

Press power button to power on the device and then move to Step 2.



Step 2: Set your personal device PIN

Please set your personal (4 ~ 8 digits) PIN. This PIN will be verified whenever you access into the device.

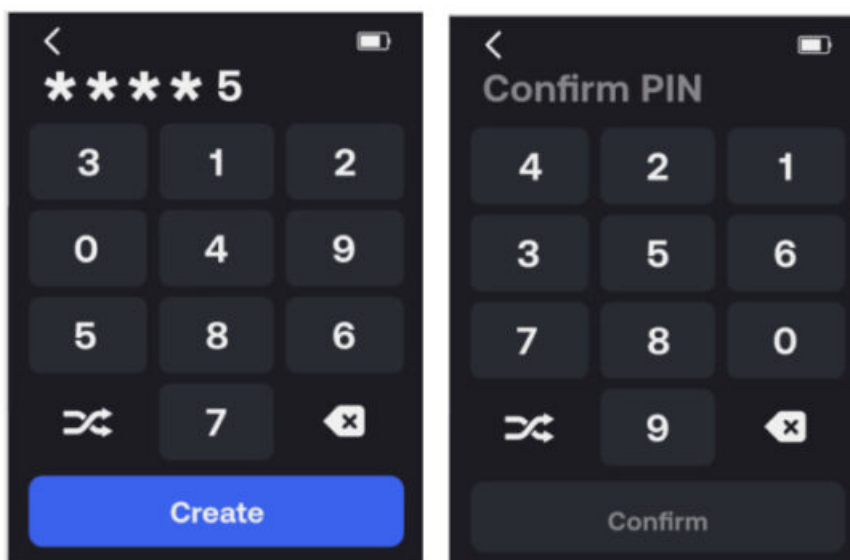

Step 3: Select configuration mode

There are two options for the device configuration:

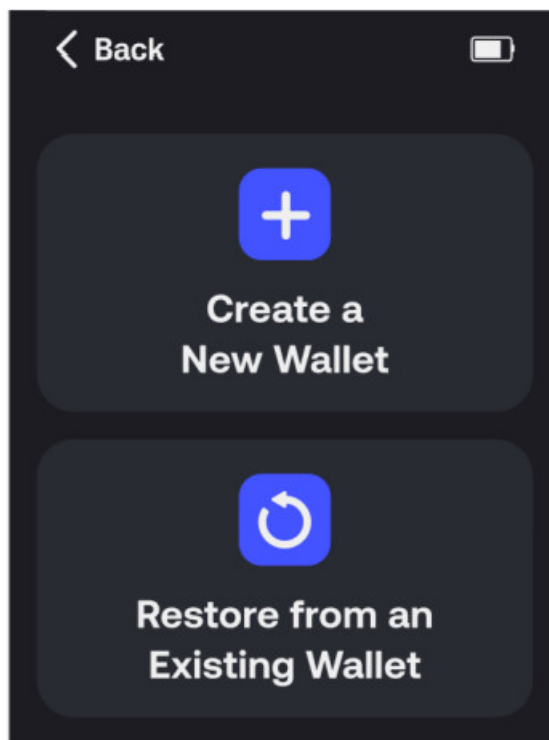

- Configure as a new wallet

The device will randomly generate a list of 24 recovery words which are unique to you. Please write them down sequentially on the recovery sheet and keep it in a safe place. If the device is reset, damaged, lost or stolen, you can use these 24 recovery words to restore your crypto assets (accounts) to any SecuX wallet or other BIP standard compatible wallets.

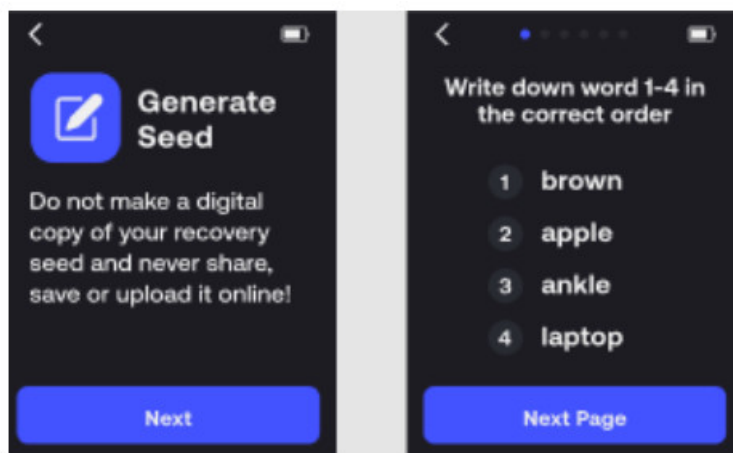

- Restore from an existing wallet.

The SecuX wallet can restore the crypto assets from other BIP standard compatible wallet via sequentially entering its 12, 18 or 24 recovery words. Please have your existing recovery words ready for next step.

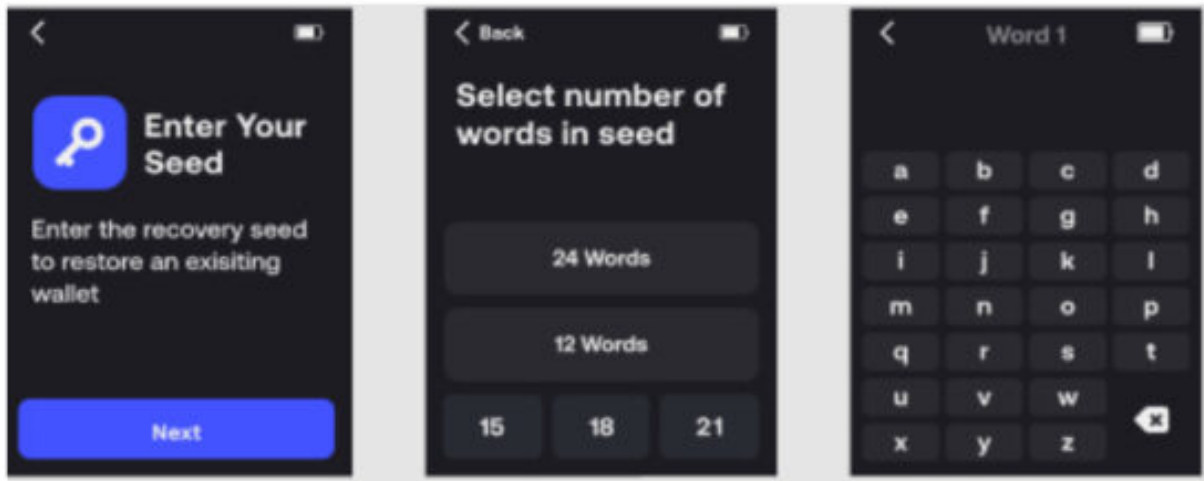

Step 4: Generate the private key

The device will then generate the private key based on the recovery words, which will be securely stored inside the device's security chip.

Once the device has been initialized successfully, the device will switch to operation mode and turn on the Bluetooth. You can touch the Bluetooth icon on the device to turn off the Bluetooth.

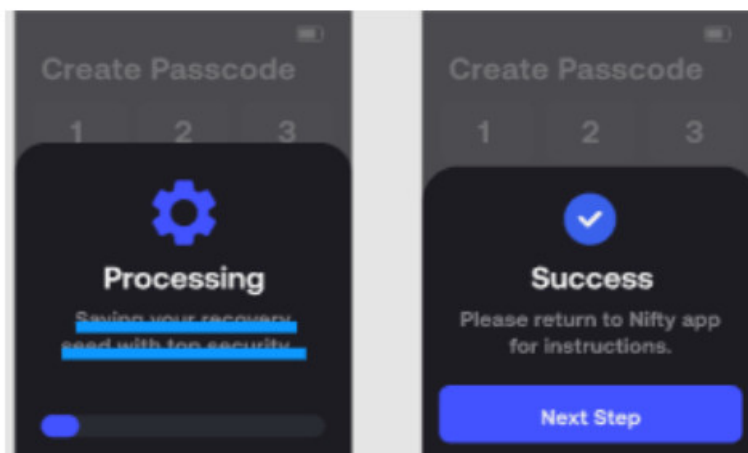

Introduction to the Main Menu of the Device

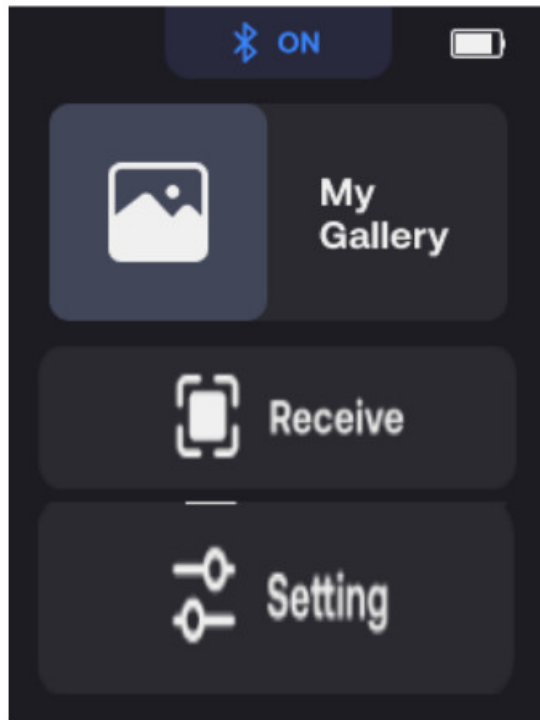

My Gallery

Allow user to download NFTs from App to the device

Receive

To show the receive address in QR code format.

Settings

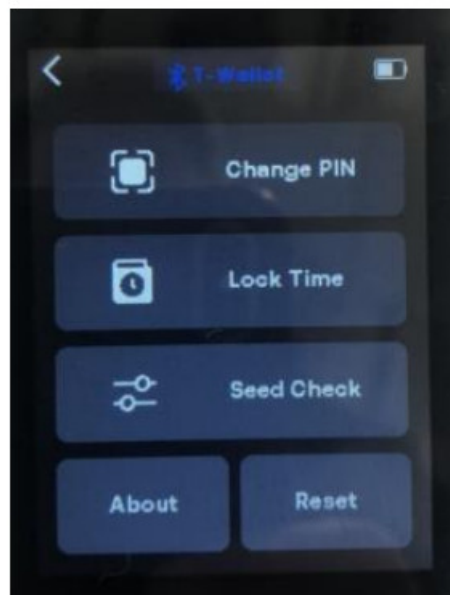

- Lock Time
To set the time duration to lock the device
- Change PIN Code
You may change the device PIN at all times, which was initially set during device initialization.
- Seed Check
To enter a set of recovery words to double check if it matches the one for this device.

- Reset

All the preference settings including PIN, device name, and the private key will be wiped off when you confirm to reset the device.

- About

To view the information about the firmware version and the certifications received.

Add wallet to Nifty App

First, download Nifty App from Apple Store or Google Play marketplace.

Nifty App supports two type of wallets, Nifty hardware wallet and View-only wallet (by importing an valid ETH address) To add a new wallet, please follow the instructions below.

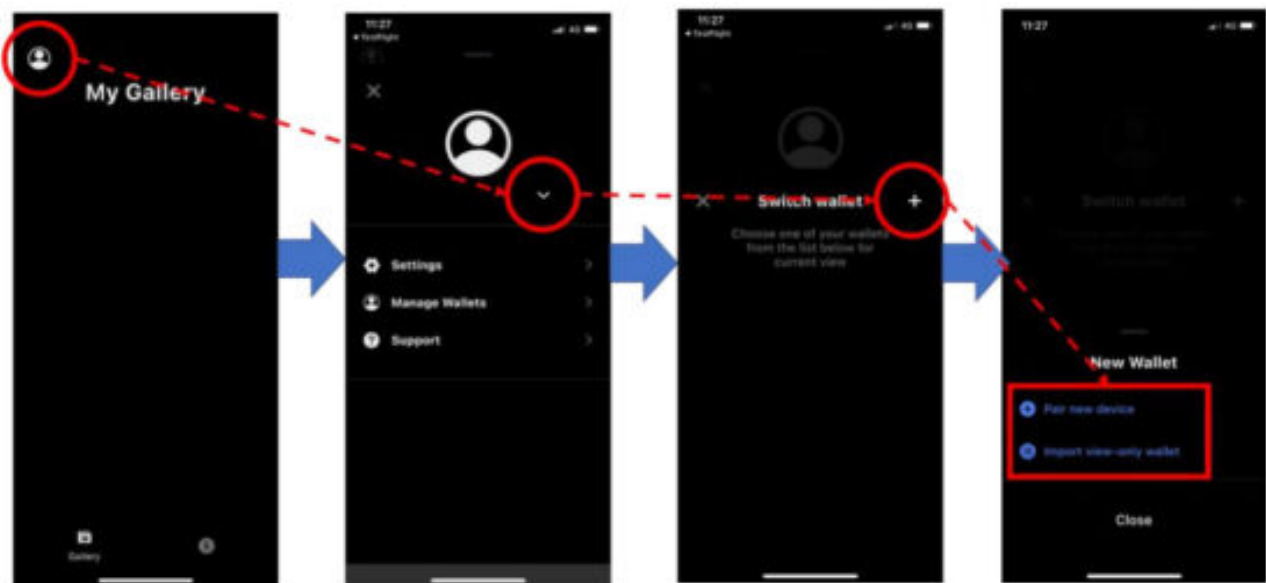

1. From wallet profile icon → Switch wallet → Add New Wallet

2. There two options to add a new wallet.

– Pair a new device (Nifty wallet)

Please turn on Nifty wallet and ensure Bluetooth is on. Nifty App will search the Nifty device. Please click it to connect it.

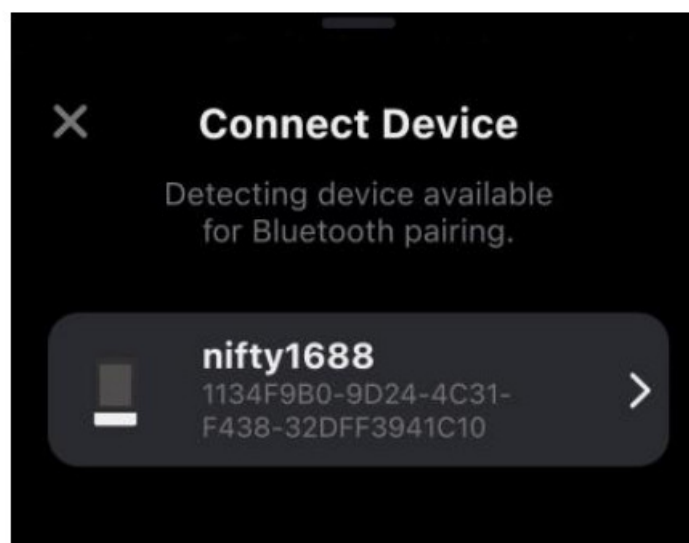

– Import View-only wallet (importing an Ethereum address)

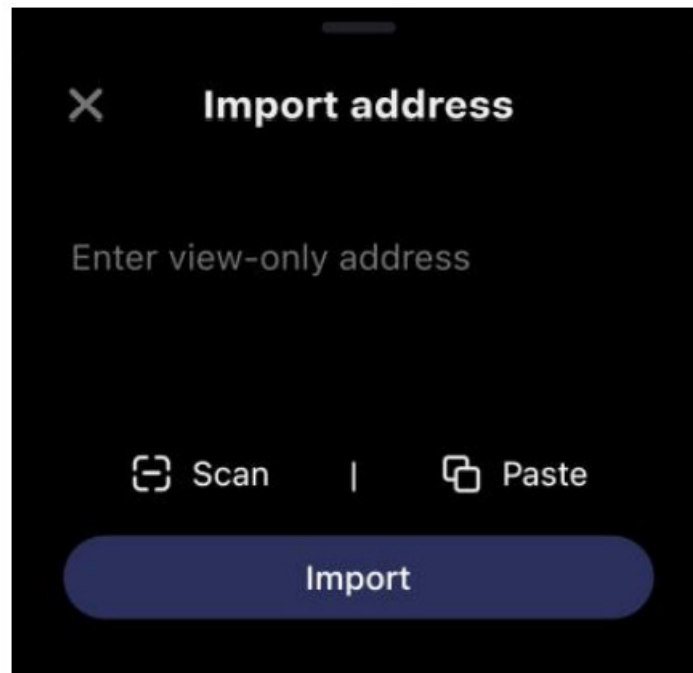

Features of Nifty APP

Nifty App can be downloaded from Apple Store or Google Play marketplace. Nifty App supports multiple wallets, Nifty device or View-only wallet (by importing address). Manage wallets feature allows users to create new wallets, switch wallet, edit wallet name and remove wallet.

Wallet Profile

In Wallet Profile, you are allowed to add a new wallet, switch between added wallets, manage wallet, and change settings.

- Add a new wallet: You can import an ETH address to add a new view-only wallet or pair a new Nifty wallet.
- Switch Wallet: You can click any added wallet as the current running wallet.
- Manage Wallets: You can edit the wallet name, change the wallet profile icon, check and update the device firmware or remove the current running wallet.

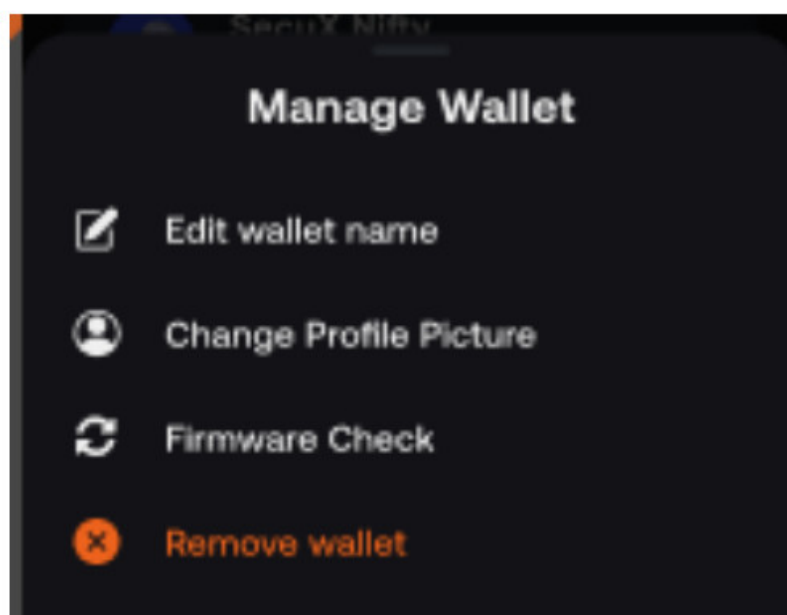

- Change Settings: You can set preferred language or currency.

After setup a new wallet, you can use the three features, Gallery, Crypto Dapp to manage the cryptos or NFTs for your wallet.

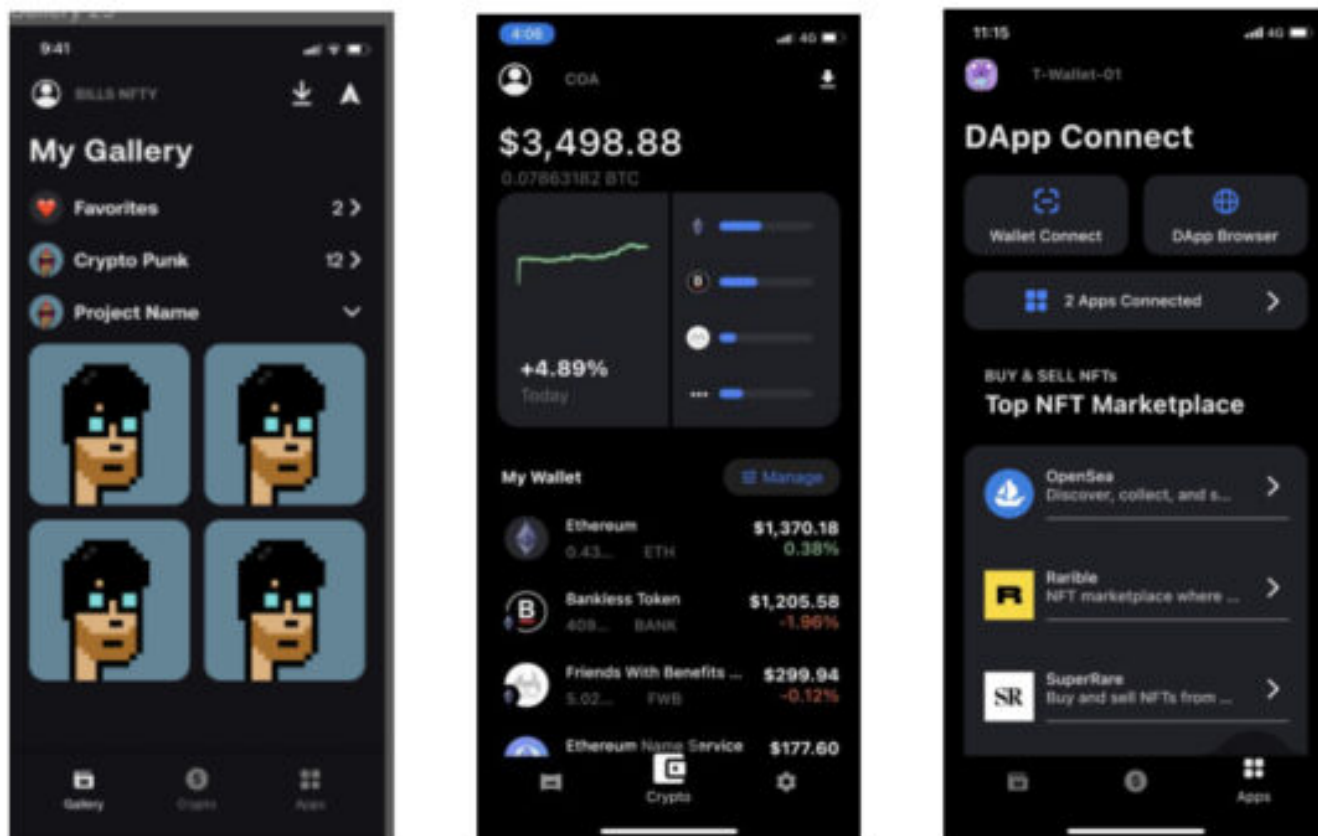

- Gallery
Galley function allow users to showcase the NFTs, detailed information of the NFTs, market price of the NFTs, Send or Receive NFTs.
- Crypto
Crypto function allow users to view the account balance, market price of the cryptos, Send or Receive cryptos.
- Dapp
Dapp function allows user to access DeFi App like Uniswap or NFT marketplace like Opensea via WalletConnect.

Documents / Resources

<p>SecuX</p> <p>User's Guide SecuX Nifty Hardware Wallet</p> 	<p>SecuX Nifty Hardware Wallet [pdf] User Guide SX050, 2ASNW-SX050, 2ASNWSX050, Nifty Hardware Wallet, Nifty Hardware Wallet</p>
--	--