



# Secrui M508+D017 Wireless Door Sensor Chime User Manual

[Home](#) » [secrui](#) » Secrui M508+D017 Wireless Door Sensor Chime User Manual 

## Contents

- [1 Secrui M508+D017 Wireless Door Sensor Chime](#)
- [2 PRODUCT OVERVIEW](#)
- [3 Product Introduction](#)
- [4 Operating Instructions](#)
- [5 Installation for magnetic door sensor](#)
- [6 Specifications](#)
- [7 FREQUENTLY ASKED QUESTIONS](#)
- [8 VIDEO – PRODUCT OVERVIEW](#)
- [9 Related Posts](#)

**secrui**

**Secrui M508+D017 Wireless Door Sensor Chime**



## PRODUCT OVERVIEW

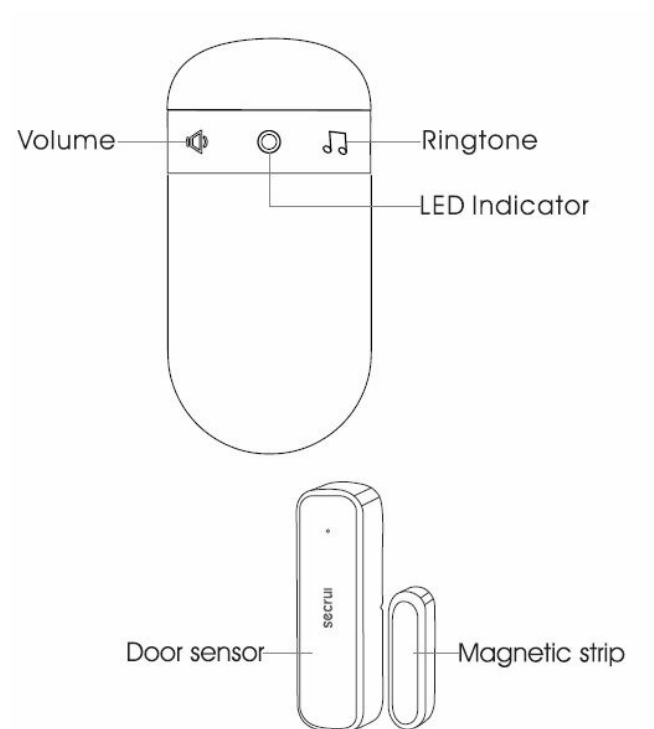

## Product Introduction

It's a Wireless Door Open Chime kit. When the two parts of the door sensor are separated more than 0.4 inches, the door sensor will be triggered, then you will hear the ringtone from the receiver. which can help deter break-ins, keep your children and pets safe, and never miss a customer when they come. It is an ideal door alarm for homes, offices, stores, warehouses, garages, and more!

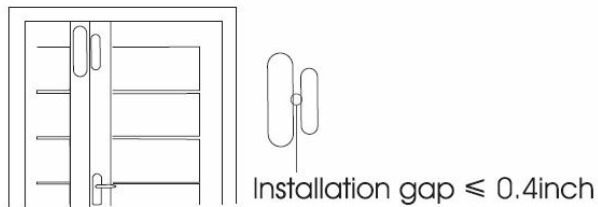

## Package List



Secrui Doorbell Receiver(s), Secrui Magnetic Door Sensor(s), User Guide

## Features

- 58 tones optional
- Colorful LED indicator
- 5 volume levels adjustable (mute mode with light only)
- **Memory function:** Keep the previous set tune after re-plugging it

## Operating Instructions

### Button Press

-  Short press < 3s
-  Long press > 3s

### ON

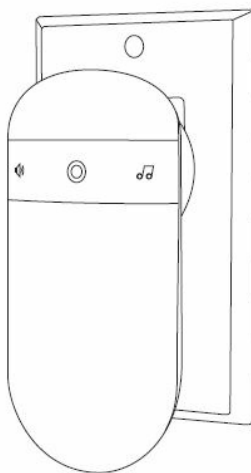

100-240V, 50-60Hz AC outlet

## Door Sensor & Magnetic Strip Matching

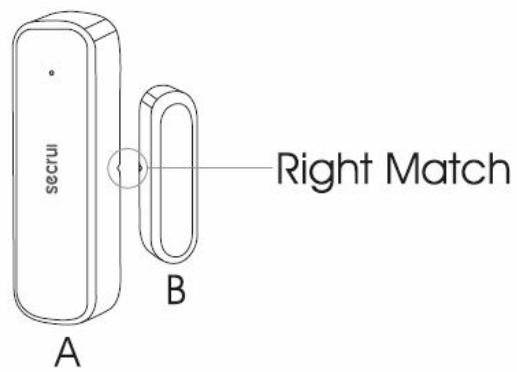

### Selecting the Ringtone

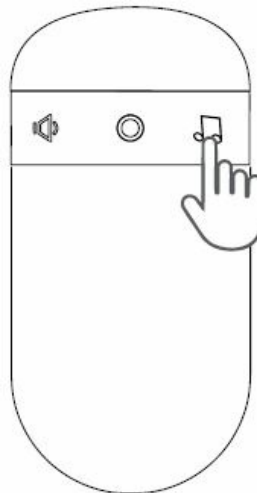

- Short press Cycle FORWARD through the tones
- Long press [ hear a short beep sound ] Cycle REVERSE through the tones

### Setting the Volume

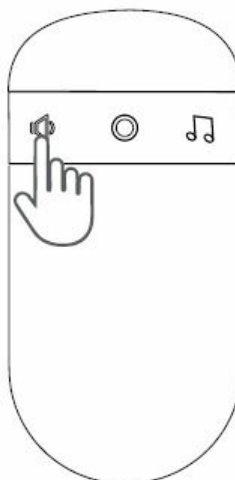

Short press, 1 ~5 volume setting

**Note:** The volume changes to the largest automatically every time after the receiver is powered on.

### Receiver and Door Sensor Pairing

1. CD Long press, receiver beeps once

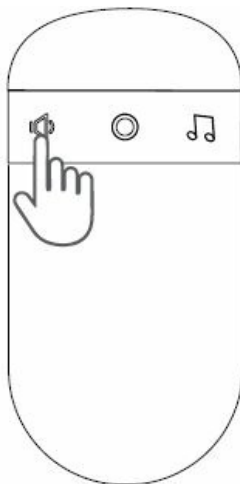

2. Move B Receiver beeps twice Get the two parts together

Turns red

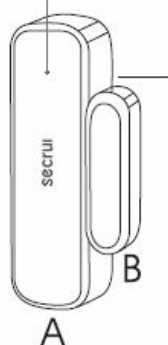

3. Move B again Receiver beeps once Get the two parts together

4. Short press

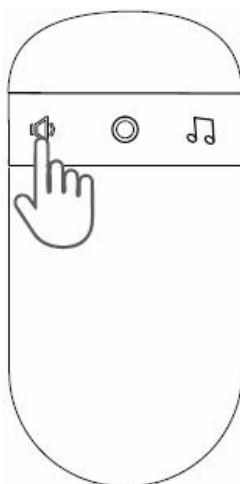

5. Move B Music is ringing, adding Successfully

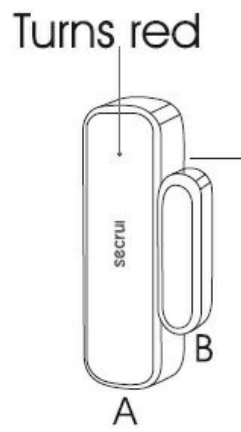

(Adding the second door sensor or more please according to the above steps )

**Fixed-tone: Adding a door sensor with a FIXED receiver ringtone**

1. Short press select the favorite tone

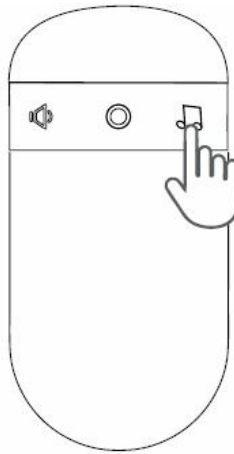

2. Long press simultaneously Receiver beeps once

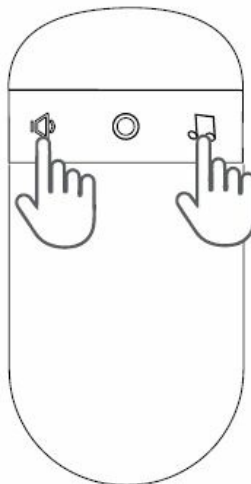

3. Move B Receiver beeps 1wice Get the 1wo parts together
4. Move B again Receiver beeps once Get the 1wo parts together

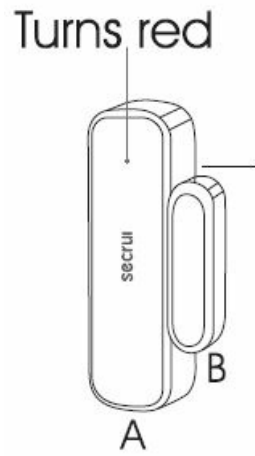

5. Short press

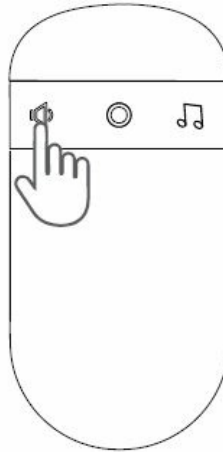

6. MoveB Music is ringing, adding successfully

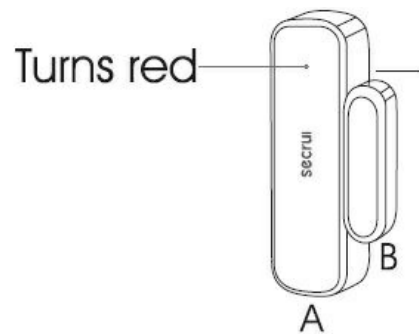

(Adding the second door sensor or more with a FIXED receiver ringtone please according to the above steps )

**Note:** When in adding state, short press any keys on the receiver or leaves it 20s without any operation, the receiver will automatically quit the adding state.

### Installation for magnetic door sensor

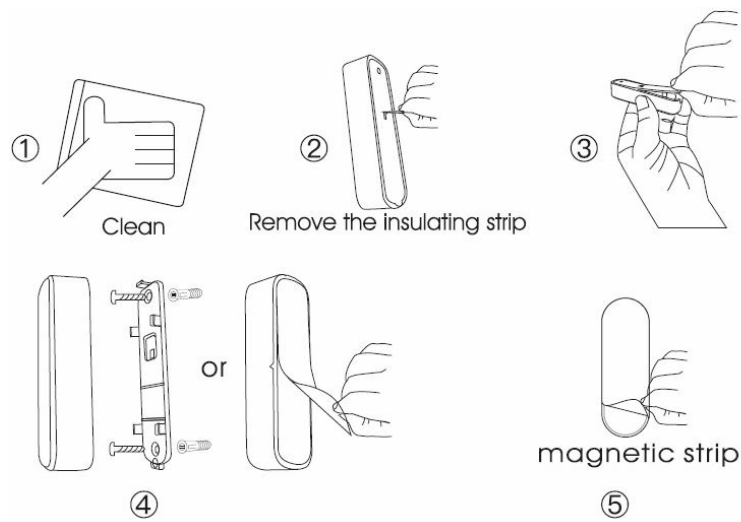

### Clear All Settings – Unpair all door sensors from receiver

- Press and hold (don't release it), plug in the receiver.

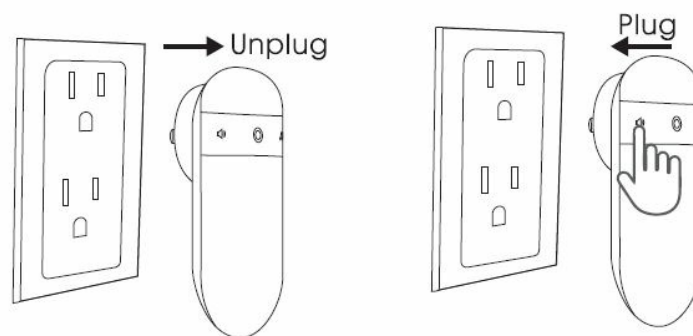

- Press and hold, continuous I O beeps and the LED indicator flashes I O times. then gives a series of fast beeps.

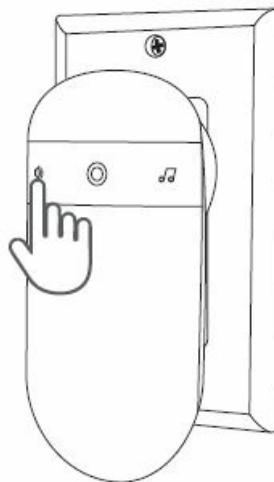

## Specifications

### Specifications of Receiver

- **Working voltage:** 100-240V, 50-60Hz AC Standby current: < 3mA
- **Working current:** < 11 mA
- **Radio frequency:** 433MHz
- **Operation range:** 400 feet [in open area]



## Specifications of Transmitter Button

- Ip55 waterproof
- **Working Temperature:** -4 °F – | 22°F Working Humidity: :5 85%

## Specifications of Door sensor

- Non-waterproof
- **Working Range:** 400 ft (in open area)
- **Working current:** 3uA(standby), | 5mA(Transmitting) Installation gap: :5 0.4inch
- **Working Temperature:** -4 °F – | 22°F
- **Working Humidity:** .; 85%

## Supplier's Declaration of Conformity 47 CFR § 2.1077 Compliance Information

### The following equipment:

* Product	Doorbell
* Model (s)	M508
* Brand Name	SECAUI
* Manufacturer's Name	SHENZHEN KERUI SMART TECHNOLOGY CO. LTD
* Manufacturer's Address:	Room 1501, T2, Jinlitong Building, No. 1100, Xingye Road, Xin'an Street, Bao'an District, Shenzhen, Guangdong, China
* Test Report Number	TB-FCC183394

is herewith confirmed to comply with the requirements of FCC Part 15 Rules.

### Operation is subject to the following two conditions:

1. This device may not cause harmful interference, and
2. This device must accept any interference received, including interference that may cause undesired operation.

The result of electromagnetic emission has been evaluated by Shenzhen TOBY Technology Co., Ltd. ([www.tobylab.cn](http://www.tobylab.cn)) laboratory (FCC Accredited Test Firm Registration Number: 854351) and showed in the test report. It is understood that each unit marketed is identical to the device as tested, and any changes to the device which could adversely affect the emission characteristics will require retest. The following importer / manufacturer (Located in the United States) is responsible for this declaration:

<b>Company Name</b>	<b>SEA&amp;MEW CONSULTING INC</b>
Company Address	1007 NORANGE ST, 4TH FLOOR , #96
Telephone	+( 001 )3134133043
Name (Full name)	Position
Person is responsible for making this declaration:	

**Email :** [contact@secrui.com](mailto:contact@secrui.com)

## FREQUENTLY ASKED QUESTIONS

What is the Secrui M508+D017 Wireless Door Sensor Chime?

The Secrui M508+D017 is a wireless door sensor chime designed to alert you when a door or window is opened, enhancing security and convenience.

How does the wireless door sensor chime work?

The chime consists of a sensor that is attached to a door or window and a receiver placed inside your home. When the door or window is opened, the sensor sends a signal to the receiver, which produces a chime or alert.

Is installation difficult for the Secrui M508+D017?

Installation is typically straightforward. You attach the sensor to the door or window and place the receiver in a location of your choice. No extensive wiring is required.

Can I adjust the chime volume and melody?

Most wireless door sensor chimes, including the Secrui M508+D017, allow you to adjust the volume and choose from different chime melodies to suit your preferences.

Is the chime suitable for both home and business use?

Yes, wireless door sensor chimes are versatile and can be used in both home and business settings to monitor entry points.

What is the range of the wireless signal between the sensor and receiver?

The wireless range varies by model but is typically sufficient to cover standard door and window distances. Ensure the chime you choose has a range suitable for your needs.

Is the Securi M508+D017 compatible with other security systems?

Compatibility with other security systems depends on the specific model. Some chimes can integrate with existing security systems, so check the product details for compatibility information.

Can I use multiple sensors with a single receiver?

Many wireless door sensor chimes support multiple sensors, allowing you to monitor multiple entry points with a single receiver.

Is the system battery-powered or does it require an electrical connection?

Wireless door sensor chimes are typically battery-powered, providing flexibility in sensor placement. Check the product specifications for battery requirements.

Can I temporarily disable the chime if needed?

Yes, most chimes allow you to mute or disable the chime temporarily when you don't want to be alerted, such as during a party or family gathering.

Does the chime provide a visual indicator in addition to the audible alert?

Some models may include a visual indicator, such as an LED light, in addition to the audible alert, providing an additional alert method.

Is the chime weather-resistant for outdoor use?

Most wireless door sensor chimes are designed for indoor use. Using them outdoors may require protection from the elements.

Can I expand the system with additional sensors at a later time?

Many chimes offer the option to expand the system by adding more sensors as your needs grow.

What is the typical lifespan of the sensors' batteries?

The battery life of sensors can vary but often lasts for several months to a few years, depending on usage and the type of batteries used.

Are there any security concerns related to wireless door sensor chimes?

While wireless door sensor chimes enhance security, they are not typically connected to alarm systems. Consider using them as a supplemental security feature.

Can I use the chime to monitor non-entry points, such as a medicine cabinet or liquor cabinet?

Yes, you can use the wireless door sensor chime to monitor various areas in your home, not limited to entry points.

## VIDEO – PRODUCT OVERVIEW



[Download the PDF link - Section 1508-BS/2020 Wireless Door Sensor Chime User Manual Door-Sensor-Chime-User-Manual.mp4](#)

[Manuals+.](#)