



## secrui D121 Door Sensor Alarm for Home With Remote User Manual

[Home](#) » [secrui](#) » secrui D121 Door Sensor Alarm for Home With Remote User Manual 

### secrui D121 Door Sensor Alarm for Home With Remote User Manual



#### Contents

- [1 Product introduction](#)
- [2 Function](#)
- [3 Documents / Resources](#)
  - [3.1 References](#)
- [4 Related Posts](#)

### Product introduction

This door open chime kit has the function of real- time detection when doors and windows are opened, and also have the function of matching remote control and detector. The shape design is novel, the lines are smooth, and it

is well matched with the home decoration. It can be integrated with the installation environment. When the door magnetic alarm host is separated, it will alarm immediately to prevent the intruders who attempt to intrude from door or window. The door magnetic alarm host can be connected infrared detectors, door magnets, smoke detectors, gas detectors, emergency buttons and other accessories etc.

## Function

1. Turn on the host, it will beeps once.
2. Short press SET 1 second, it shift to Arm or Disarm. ( beeps once means Arm, beeps twice means Disarm)
3. At Arm station, when separate host and the door sensor, it will alarm at once.

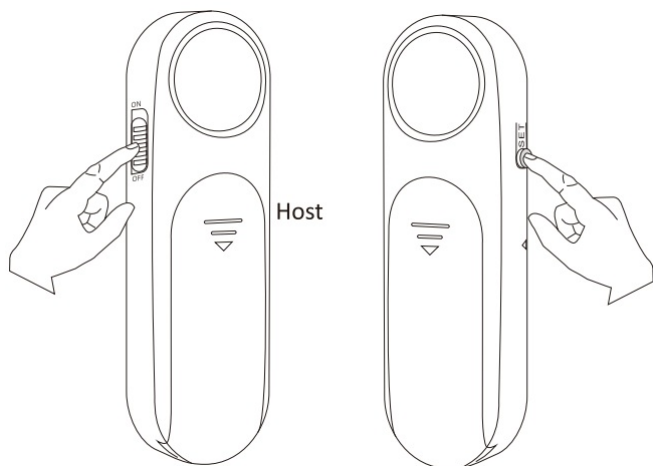

## Operation

Pairing with remote

1. Long press [SET] for 5 seconds, the host is in pairing station. Press any key on the remote controller, the host will beeps twice. means it is matched successfully.
2. Host beeps once, means it has been matched already.
3. Host beeps 3 times, means it is full to match.

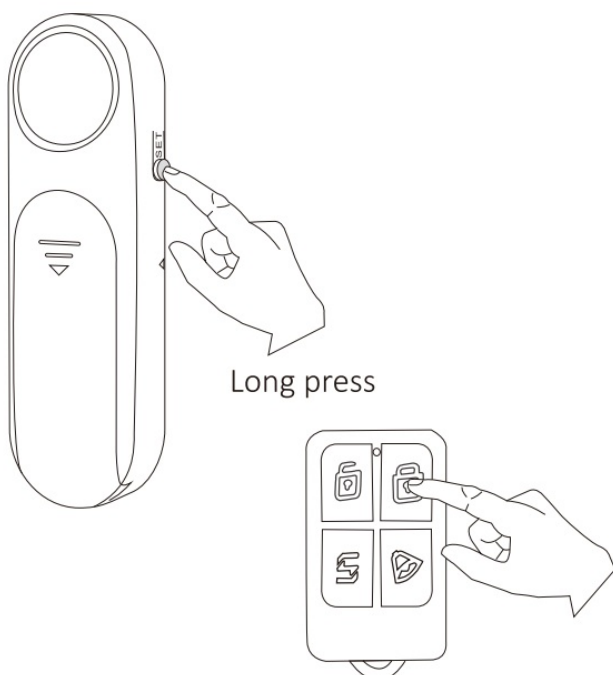

**Note:**

1. In pairing station, long press [SET] for 5 seconds. The host will beep 4 times, and the host will delete all paired accessories and exit the learning state.
2. In pairing station, short press [SET] or leave it 20 seconds without any operation, the host will exit the pairing station.
3. The host can be matched up to 30 accessories at most.

### Remote

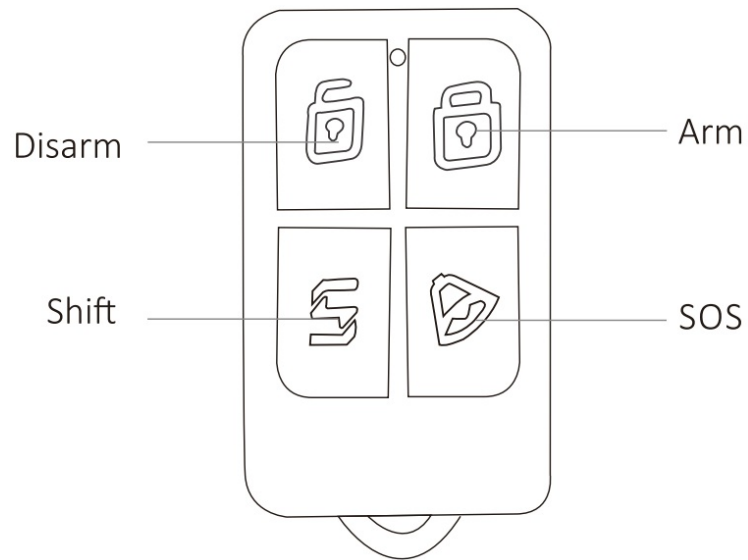

### Installation of the host

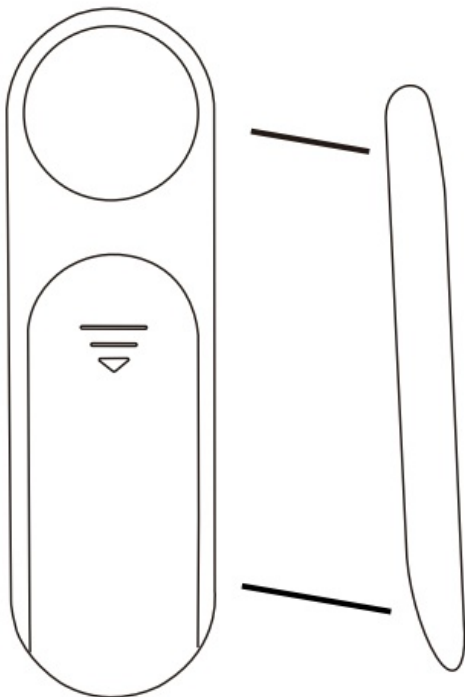

Stick the double sided tape on the back of host.

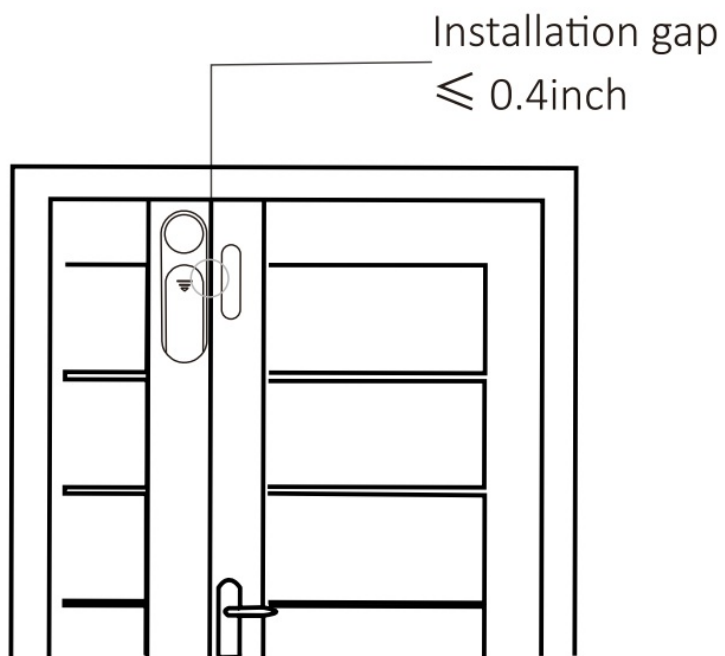

**Note:**

The door magnetic alarm and magnetic strip should be installed separately, the door magnetic alarm should be installed on the fixed door frame or window frame, and the magnetic strip should be installed on the movable door and window.

**Attention**

Do not install outdoors where it is easily damaged

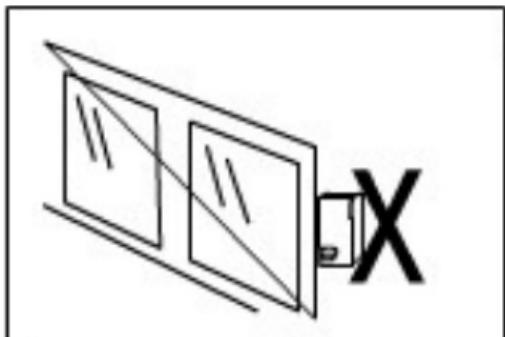

Do not install in a place where the installation base is not strong.

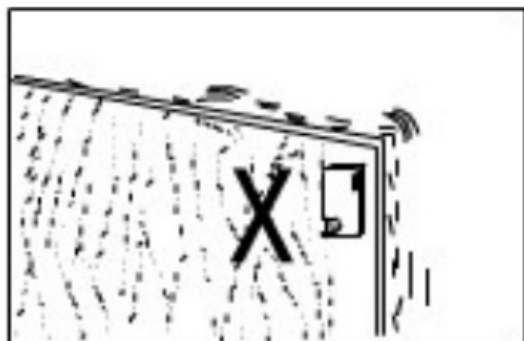

Do not install in a place where the installation base is not strong.



### Low-battery Indicate

When the door magnet is low battery, the alarm time of the door magnetic host will be shorter, the alarm sound will be smaller, The lower of the battery power is, the smaller of the alarm sound is. Until the door magnet host can not alarm, the battery must be replaced, otherwise the door magnetic host will not work

### Resetting

Hold on and press until it will beeps 10 times, then leave it, that indicates all the accessories are deleted. the host returns to the factory settings.

Product introduction

### Working voltage:3.0v(2pcs AAA Alkaline batteries)

- Standby current:<10uA
- Working current:<80mA
- Wireless frequency:433MHz
- Alarm time:60 seconds
- Alarm volume:120dB
- Alarm ways: open the door and trigger the detector it will alarm in Arm State.

**Manufacturer:** Shenzhen Kerui Smart Technology Co., Ltd

**Address:** Room 1501, T2, Jinlitong Building, No. 1100, Xingye Road Xin'an Street, Bao'an District Shenzhen, Guangdong, China

**Email:** [support@secrui.com](mailto:support@secrui.com)

**Youtube:** Secrui Tech

**WEEE-Reg-Nr.** DE 32683954

Made in China



Points de collecte sur [www.quefairedemesdechets.fr](http://www.quefairedemesdechets.fr) Privilégiez la réparation ou le don de votre appareil



---

## Documents / Resources

	<p><a href="#">secrui D121 Door Sensor Alarm for Home With Remote</a> [pdf] User Manual</p> <p>D121 Door Sensor Alarm for Home With Remote, D121, Door Sensor Alarm for Home With Remote, Sensor Alarm for Home With Remote, Alarm for Home With Remote, Remote</p>
---	---

## References

- [User Manual](#)