



SEBSON WAL SENSOR P INT Wall Light With Motion Detector 20W User Guide

[Home](#) » [SEBSON](#) » SEBSON WAL SENSOR P INT Wall Light With Motion Detector 20W User Guide 

Contents

- [1 SEBSON WAL SENSOR P INT Wall Light With Motion Detector 20W](#)
- [2 Specifications](#)
- [3 Product Usage Instructions](#)
- [4 Technical Data](#)
- [5 Possibilities of adjustments](#)
- [6 FAQ \(Frequently Asked Questions\):](#)
- [7 Documents / Resources](#)
 - [7.1 References](#)
- [8 Related Posts](#)



SEBSON WAL SENSOR P INT Wall Light With Motion Detector 20W



Specifications

- **Operating voltage:** 220-240V AC 50/60Hz
- **Power:** 20W
- 1,700lm 6,000K
- IP65II

Product Usage Instructions

Allgemeine Sicherheitshinweise (General Safety Instructions)

- **Gefahr:** Welding The installation dies from the products of the machine after the jewels last the electrical and safety regulations durchführen.

Thank you for choosing a product of SEBSON. Please read the instructions carefully and keep them looking up before starting this product. A long and failure-free operation can only be guaranteed if the installation and start-up is done properly. Before starting up this product, please check for external damage. In case of visible external damage, we immediately dis-advise the start-up of this product! Please remove all packaging material of this product before the first start-up an and check the content for completeness!

Intended use

This SEBSON outdoor light is suitable for indoor and outdoor installation. The integrated infrared motion detector detects the heat radiation from moving bodies and then switches the light on.

Scope of delivery

- 1 Outdoor light
- Screws for fixing (3 pieces)
- Dowels Ø 6mm (3 pieces)

General safety information:

- **Danger:** The installation of this product may be done only by a qualified person according to the valid regulations for electrical installation!
- **Danger:** If the power cables are damaged or come into contact with wetness, immediately disconnect the product from the power supply and ensure that it cannot be switched on again!
- **Danger of suffocation:** Please keep this product away from children and animals. The packaging contains small parts that can be swallowed!
- **Caution:** Set up the light beam of the light never directly at people or animals to prevent fire damage or eyes damage and avoid looking directly into the light source!

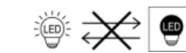

An exchange of the built-in luminous in the light is not possible!

- The remodeling of this product is not allowed! The proper and safe functioning of the device can no longer be guaranteed if it is modified! In addition, this will invalidate the warranty claim!
- Do not connect a dimmer as this may cause damage to the lamp.
- Do not cover the light with heat-insulating materials! As a result of a strong heat development, the LED can be damaged!
- The manufacturer does not accept any responsibility for injuries or damage resulting from improper use of this product!
- Any other use than the description may result in damage to the product. So the dangers are such as electric shock, short circuit, fire etc.
- We reserve the right to make changes to the product, the packaging or the operating instructions as well as printing errors.
- This product is suited for indoor- and outdoor use.
- Protect the product from external damage, heavy dirt, moisture, and excessive heat!
- so that the warranty claim does not expire please use only the supplied items. Repairs may only be done by an expert and only by using original spare parts!
- In commercial institutions, the accident prevention regulations of the professional trade association for electrical equipment and facilities must be adhered to.

Instruction for installation

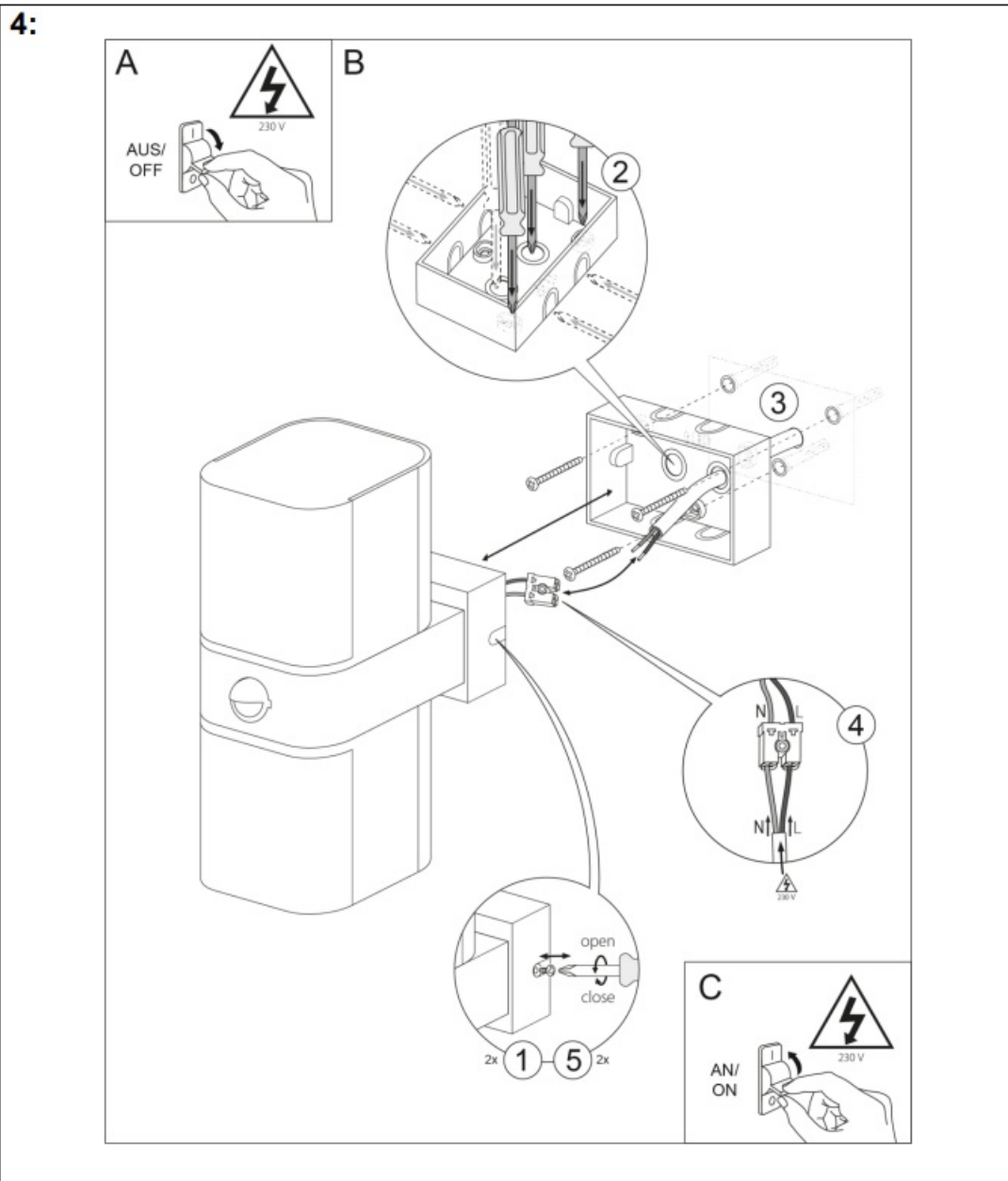

- **Danger:** Before installing please make sure that the circuit is interrupted! For installation, the work on the mains voltage is required. Please remove the associated mains fuse or deactivate the switch fuse! Check by using a voltage tester if the line is de-energized. Make sure that the current circuit will not be closed during the installation!
- **Danger:** The installation of this product may be done only by a qualified person according to the valid regulations for electrical installation!
- **Attention:** Before drilling the mounting holes, make sure that there are no gas, electricity or water pipes at the drilling location that could be damaged by this!
- Please observe the safety instructions and technical data before installing this product!

Note on installation

- **L:** Live wire (black or brown)
- **N:** Neutral conductor (blue or grey)
- For optimum range, select the mounting height recommended.

To ensure the optimum sensitivity of the sensor, install the device in the room in such a way that the movements are transverse to the device. Movements that are directly to and from the device are less well detected (see Fig. 2a).

The following environments or surfaces are not suitable for mounting, as they may impair the detection of thermal radiation (see Fig. 2b):

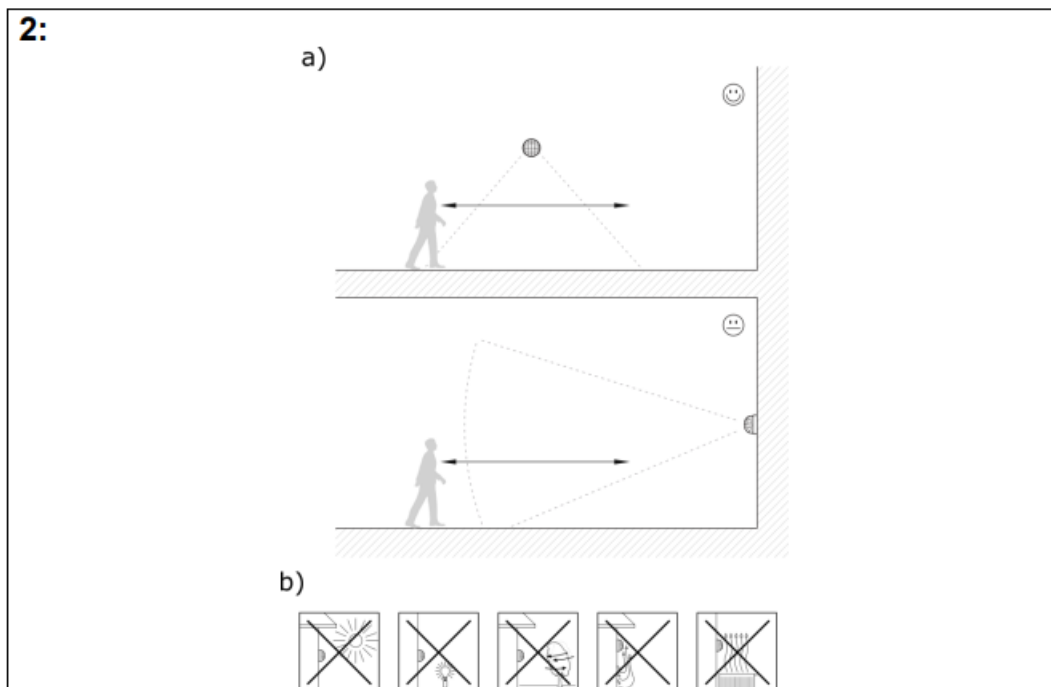

- Metal surfaces e.g. metal door frames
- Near electronic devices such as computers, monitors etc
- Heat sources e.g. radiant heaters, radiators or lamps
- In the vicinity of e.g. fume cupboards or fans
- Within the radiation range of luminaires (minimum distance from luminaires >50cm)

Function of the motion sensor

The sensor integrated in this device detects heat radiation from moving bodies, e.g. from humans or animals. After the movement is detected, the light switches on. The detection of heat radiation can be limited by large furniture, glass panes or very high ambient temperatures of over 40°C, for example in summer. While movements in the detection area are detected by the sensor, the light remains switched on.

Detection area

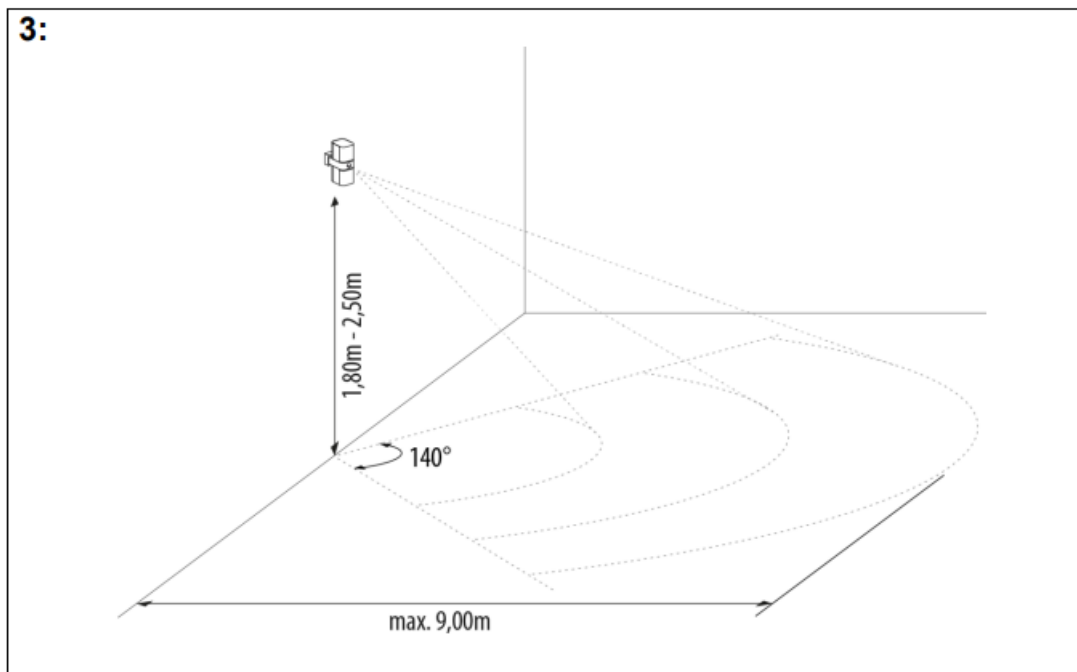

The detection range of the motion detector is approx. 9m and 140° (free area) at a mounting height of 1,8-2,5m on the wall. In closed rooms the detection distance can be lower, according to room layout.

Sensitivity when switching (about the ambient brightness)

	<p>This setting control can be used to regulate the switch-on sensitivity of this unit depending on the ambient brightness (between 3 and 2.000 LUX).</p>
--	---

Time setting (switching off delay)

	<p>The duration of the operating time can be set continuously from approx. 10s to 5min. The timer is restarted if a movement from the sensor is detected before the set time has elapsed.</p>
--	---

Function test

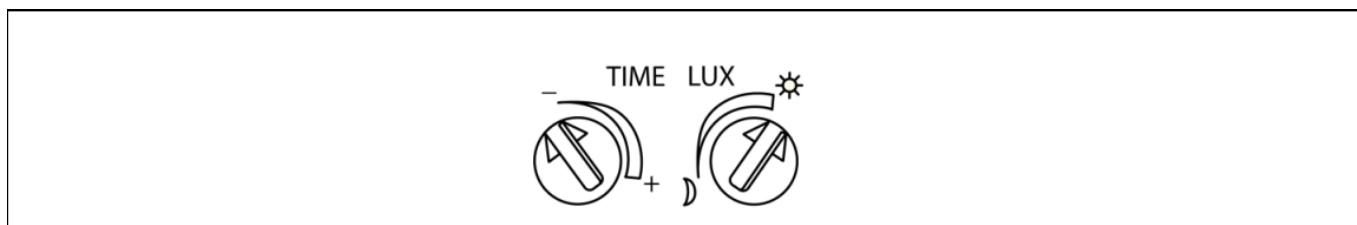

Ensure that the motion detector is not obscured. Ensure that the coverage area is not restricted by items such as through large furniture. To set the detection range and the daylight test, turn the knobs to the positions shown. The motion detector is activated after a warm-up phase of approx. 30s. If no further movement takes place in the sensing area of the sensor, the sensor switches off.

Technical Data

Operating voltage:	220-240V AC 50/ 60Hz
Nominal wattage:	20W
Nominal luminous flux:	1.700lm
Rated color temperature:	6.000K
Electrical protection:	IP65
Protection class:	II
Ambient temperature:	-20° - +40°C
Humidity:	<93%
This product contains a light source of energy efficiency class F.	

Possibilities of adjustments

Detection area:	Max.9m (<24°C)/ 140°
Sensitivity when switching (with regard to the ambient brightness):	<3-2.000LUX
Time setting (switching off delay):	Min. 10s +/- 3s - Max. 5min +/-1min

Information for private households (WEEE)

The Electrical and Electronic Equipment Act (WEEE) contains a large number of requirements for the handling of electrical and electronic equipment. The most important ones are summarised here.

1. Separate collection of waste equipment Old, worn-out, or defective electrical and electronic equipment is referred to as waste equipment. These devices must not be disposed of in the normal household waste or together with the residual waste. The devices should be transferred to special collection and return systems.
2. Batteries and rechargeable batteries as well as illuminate As a rule, owners of WEEE shall separate spent batteries and accumulators that are not enclosed in the WEEE, as well as light sources that can be removed from the WEEE without causing damage, before handing it over to a collection point. This does not apply if WEEE is prepared for reuse with the participation of a public waste management authority. Batteries or rechargeable batteries that contain harmful substances are marked with the symbol of a crossed-out dustbin and must not be disposed of in household waste. Below the dustbin symbol is the chemical name of the pollutant – in the example below

“Cd” for cadmium. “Pb” stands for lead, “Hg” for mercury:

If disposed of improperly, the substances contained in the batteries may cause hazards to health and the environment. The hazards are averted by the separate collection and proper disposal of used batteries.

Options for returning old appliances

Owners of WEEE from private households can hand it in free of charge at the collection points of the public waste management authorities or the take-back points set up by manufacturers or distributors.

Data privacy notice

Old devices often contain sensitive personal data. This applies in particular to information and telecommunications technology devices such as computers and smartphones. In your interest, please note that each end user is responsible for deleting the data on the end-of-life devices to be disposed of.

Meaning of the “crossed-out dustbin” symbol

The symbol of a crossed-out dustbin regularly displayed on electrical and electronic equipment indicates that the respective device must be collected separately from unsorted municipal waste at the end of its service life.

Cleaning

Danger: Before start cleaning the product interrupt the current circuit by switching off the circuit breaker or unscrewing the fuse! Use a slightly moistened cloth for cleaning. In order not to damage the product, it is essential

to avoid water penetrating into the housing! Never clean the device under running water! Do not use solvent-containing cleaner for cleaning.

FAQ (Frequently Asked Questions):

- **1. How can I adjust the switch-on sensitivity of the motion sensor?**
 - You can adjust the switch-on sensitivity by setting the desired level between 3 and 2000 LUX.
- **2. Can I adjust the duration of the operating time?**
 - Yes, you can adjust the duration of the operating time from approximately 10 seconds to 5 minutes.
- **3. What is the recommended installation process for this product?**
 - We highly recommend having this product installed by a professional per the applicable electrical and safety regulations.
- **4. Can I use this product outdoors?**
 - Yes, this product has an IP65 rating, making it suitable for outdoor use.

Address: SEBSON Sebastian Sonntag Walter-Behrendtstr.10 44329 Dortmund Germany
support@sebson.de VAT-Nº: GB179436663 WEEE-Reg.-ID.: 500617

Documents / Resources

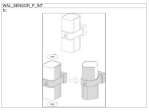
	<p>SEBSON WAL SENSOR P INT Wall Light With Motion Detector 20W [pdf] User Guide WAL SENSOR P INT Wall Light With Motion Detector 20W, WAL SENSOR P INT, Wall Light With Motion Detector 20W, Motion Detector 20W, Detector 20W</p>
---	--

References

- [➤ Informationen für Verbraucher | SEBSON](#)
- [User Manual](#)