



**SEBSON
SDL_FLEXIBLE_E,
SDL_FLEXIBLE_F
Socket Lamp**



SEBSON SDL_FLEXIBLE_E, SDL_FLEXIBLE_F Socket Lamp Owner's Manual

[Home](#) » [SEBSON](#) » SEBSON SDL_FLEXIBLE_E, SDL_FLEXIBLE_F Socket Lamp Owner's Manual 

Contents

- [1 SEBSON SDL_FLEXIBLE_E, SDL_FLEXIBLE_F Socket Lamp](#)
- [2 FAQ](#)
- [3 PRODUCT OVERVIEW](#)
- [4 Start up](#)
- [5 Technical Data](#)
- [6 General technical information USB-A and USB-C](#)
- [7 Information for private households WEEE](#)
- [8 Cleaning](#)
- [9 Documents / Resources](#)
 - [9.1 References](#)



SEBSON SDL_FLEXIBLE_E, SDL_FLEXIBLE_F Socket Lamp



FAQ

Q: Can the socket lamp be used outdoors?

A: No, the product is only suitable for indoor use.

Q: What should I do if the product gets damaged or comes in contact with water?

A: Turn off the product immediately without tension and ensure that a restart is not possible. Contact a professional for repair.

PRODUCT OVERVIEW

1:

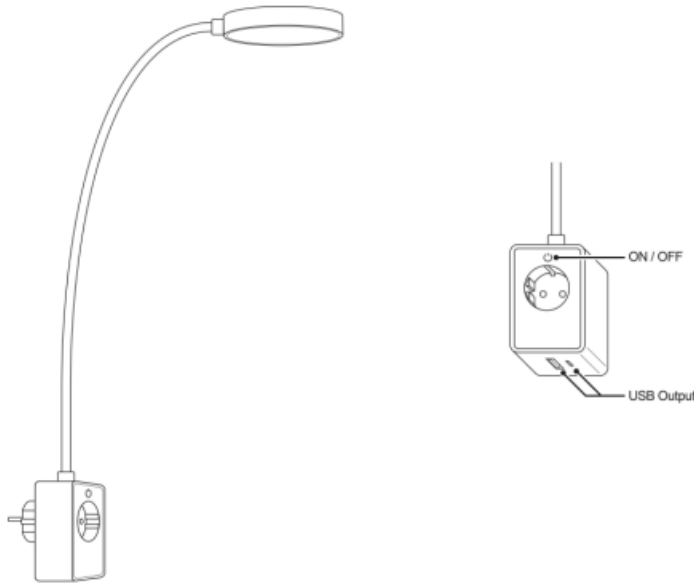

Danger of suffocation: Keep this product away from children and animals! The packaging contains small parts that can be swallowed!

Caution: Set up the light beam of the light never directly at people or animals to prevent fire damage or eyes damage and avoid looking directly into the light source!



An exchange of the built-in luminous in the light is not possible!

- Operate this product at a suitable power outlet (230V AC 50Hz).
- The remodeling of this product is not allowed! The proper and safe functioning of the device can no longer be guaranteed if it is modified! In addition, this will invalidate the warranty claim!
- Do not connect a dimmer as this may cause a damage to the lamp. As a result of a strong heat development the LED can be damaged!
- Do not cover the light with heat insulating materials! As a result of a strong heat development the LED can be damaged!
- The manufacture does not accept any responsibility for injuries or damage resulting from improper use of this product!
- Any other use than the description may result in damage to the product. So the dangers are such as electric shock, short circuit, fire etc.
- This product is only suited for indoor-use and not for outdoor-use!
- We reserve the right to make changes to the product, the packaging or the operating instructions as well as printing errors.
- Protect the product from external damage, heavy dirt, moisture and excessive heat!
- In order that the warranty claim does not expire please use only the supplied items. Repairs may only be done by an expert and only by using original spare parts!
- In commercial institutions, the accident prevention regulations of the professional trade association for electrical equipment and facilities must be adhered to.

Start up

(Fig.2):

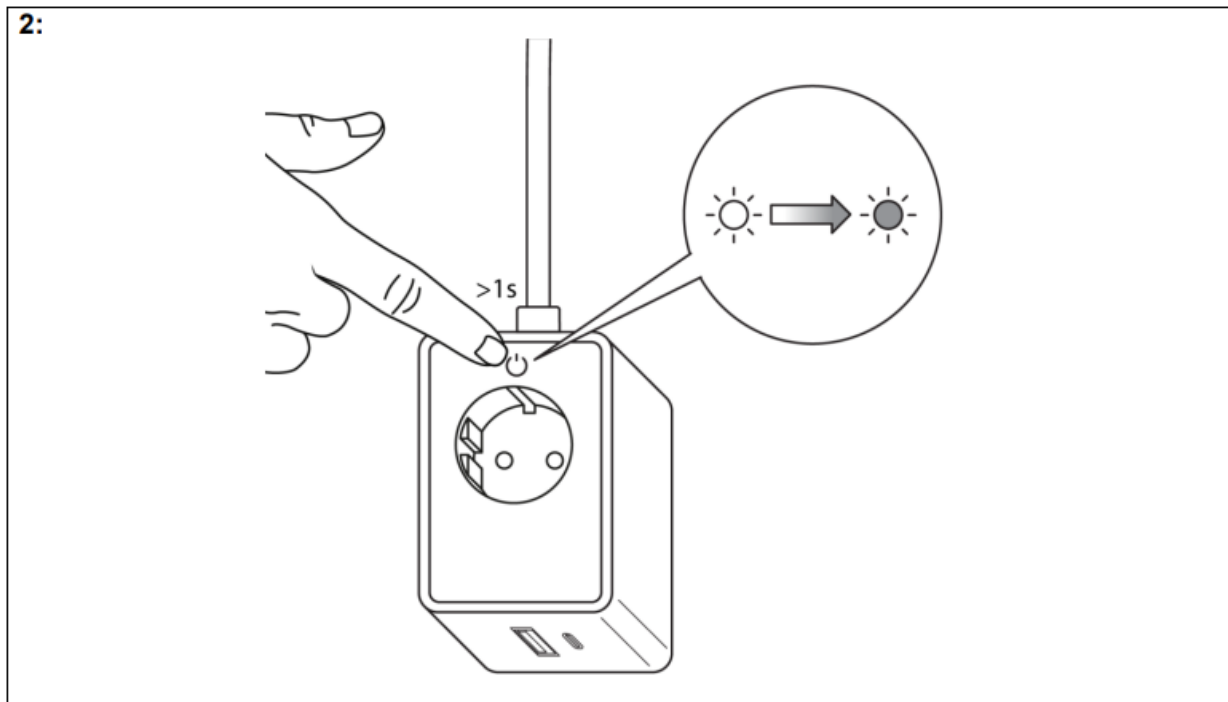

Danger: Do not close several switches consecutively! Danger of overheating!

Connect the socket light to a socket outlet that corresponds to the specifications (see technical data). After a short warm-up phase of a few seconds, the device can be switched on as follows:

The light can be switched on and off by briefly pressing the ON/OFF button. The brightness can be infinitely varied by pressing and holding the ON/OFF button. The last light level set is saved using the integrated memory function.

Technical Data

- Operating voltage:
200-240V AC 50/60Hz
- Nominal wattage:
Max. 4,5W
- Maximum load:
Max. 3.680W
- Nominal luminous flux:
Max.420lm
- Rated color temperature:
4.000K
- Electrical protection:
IP20
- Protection class:
This product contains a light source of energy efficiency class F.

General technical information USB-A and USB-C

- USB-A; max. 5V 2,1A 10,5W
- USB-C: max. 5V 2,1A 10,5W
- USB-A + USB-C (use at the same time): max. 5V 2,4A 12W

Information for private households WEEE

The Electrical and Electronic Equipment Act (WEEE) contains a large number of requirements for the handling of electrical and electronic equipment. The most important ones are summarised here.

1. Separate collection of waste equipment

Old, worn-out or defective electrical and electronic equipment is referred to as waste equipment. These devices must not be disposed of in the normal household waste or together with the residual waste. The devices should be transferred to special collection and return systems.

2. Batteries and rechargeable batteries as well as illuminants

- As a rule, owners of WEEE shall separate spent batteries and accumulators that are not enclosed in the WEEE, as well as light sources that can be removed from the WEEE without causing damage, from the WEEE before handing it over to a collection point. This does not apply if WEEE is prepared for reuse with the participation of a public waste management authority.
- Batteries or rechargeable batteries that contain harmful substances are marked with the symbol of a crossed-out dustbin and must not be disposed of in household waste. Below the dustbin symbol is the chemical name of the pollutant – in the example below “Cd” for cadmium. “Pb” stands for lead, “Hg” for mercury:
- If disposed of improperly, the substances contained in the batteries may cause hazards to health and the environment. The hazards are averted by the separate collection and proper disposal of used batteries.

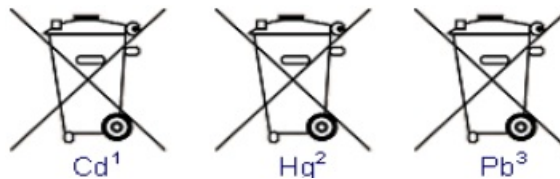

3. Options for returning old appliances

Owners of WEEE from private households can hand it in free of charge at the collection points of the public waste management authorities or at the take-back points set up by manufacturers or distributors.

4. Data privacy notice

Old devices often contain sensitive personal data. This applies in particular to information and telecommunications technology devices such as computers and smartphones. In your own interest, please note that each end user is responsible for deleting the data on the end-of-life devices to be disposed of.

5. Meaning of the “crossed-out dustbin” symbol



The symbol of a crossed-out dustbin regularly displayed on electrical and electronic equipment indicates that the respective device must be collected separately from unsorted municipal waste at the end of its service life.

Cleaning

Danger : Before cleaning, disconnect the product from the power supply by pulling the power plug out of the socket! Use a slightly moistened cloth for cleaning. In order not to damage the product, it is essential to avoid water penetrating into the housing! Never clean the device under running water! Do not use solvent-containing cleaner for cleaning. Do not use solvent-containing cleaner for cleaning!

SEBSON

Sebastian Sonntag Walter-Behrendt-Str.10 44329 Dortmund Germany

support@sebson.de

Documents / Resources

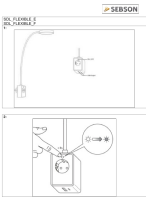
	<p>SEBSON SDL_FLEXIBLE_E, SDL_FLEXIBLE_F Socket Lamp [pdf] Owner's Manual SDL_FLEXIBLE_E, SDL_FLEXIBLE_F, SDL_FLEXIBLE_E SDL_FLEXIBLE_F Socket Lamp, S DL_FLEXIBLE_E SDL_FLEXIBLE_F, Socket Lamp, Lamp</p>
---	--

References

- [User Manual](#)

[Manuals+](#), [Privacy Policy](#)

This website is an independent publication and is neither affiliated with nor endorsed by any of the trademark owners. The "Bluetooth®" word mark and logos are registered trademarks owned by Bluetooth SIG, Inc. The "Wi-Fi®" word mark and logos are registered trademarks owned by the Wi-Fi Alliance. Any use of these marks on this website does not imply any affiliation with or endorsement.