

SEALEY

APMRT3 Modular
Racking Top 1 Shelf
and Pegboard Unit
580mm

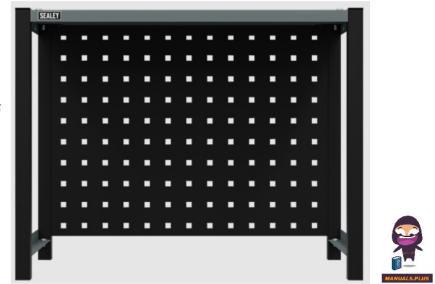

SEALEY APMRT3 Modular Racking Top 1 Shelf and Pegboard Unit 580mm Installation Guide

[Home](#) » [SEALEY](#) » SEALEY APMRT3 Modular Racking Top 1 Shelf and Pegboard Unit 580mm Installation Guide



Contents

- [1 SEALEY APMRT3 Modular Racking Top 1 Shelf and Pegboard Unit 580mm](#)
- [2 SAFETY](#)
- [3 INTRODUCTION](#)
- [4 SPECIFICATION](#)
- [5 CONTENTS](#)
- [6 ASSEMBLY](#)
- [7 ENVIRONMENT PROTECTION](#)
- [8 Documents / Resources](#)
 - [8.1 References](#)
- [9 Related Posts](#)

SEALEY

SEALEY APMRT3 Modular Racking Top 1 Shelf and Pegboard Unit 580mm

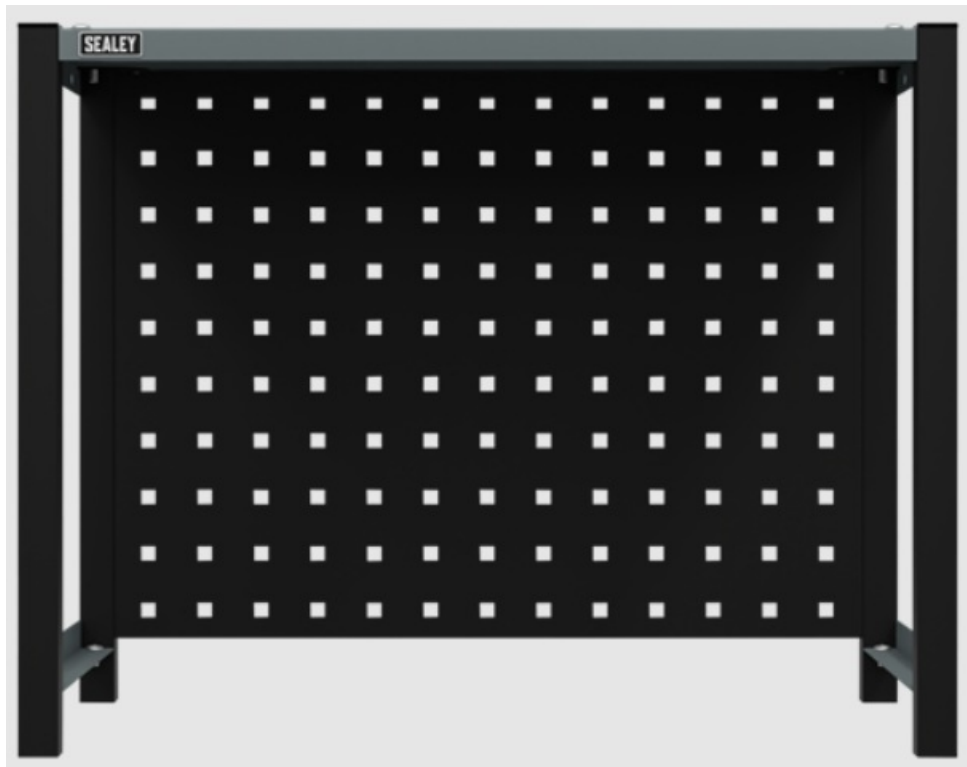

MODEL NO: APMRT3

Thank you for purchasing a Sealey product. Manufactured to a high standard, this product will, if used according to these instructions and properly maintained, give you years of trouble-free performance.

IMPORTANT: PLEASE READ THESE INSTRUCTIONS CAREFULLY. NOTE THE SAFE OPERATIONAL REQUIREMENTS, WARNINGS & CAUTIONS. USE THE PRODUCT CORRECTLY AND WITH CARE FOR THE PURPOSE FOR WHICH IT IS INTENDED. FAILURE TO DO SO MAY CAUSE DAMAGE AND/OR PERSONAL INJURY AND WILL INVALIDATE THE WARRANTY. KEEP THESE INSTRUCTIONS SAFE FOR FUTURE USE.



Refer to
instructions



Wear eye
protection

SAFETY

1. **WARNING!** Ensure Health & Safety, local authority, and general workshop practice regulations are adhered to when using this product.
2. Locate the product in a suitable working area.
3. Keep the work area clean, uncluttered and ensure there is adequate lighting.
4. **WARNING!** Use the product on level and solid ground, preferably concrete. Avoid tarmacadam since the product may sink into the surface.
5. Keep the product clean and tidy in accordance with good workshop practice.
6. Keep children and unauthorised persons away from the working area.
7. DO NOT use the product for any purpose other than that for which it is designed.
8. DO NOT exceed the maximum capacity of product.

9. DO NOT undertake work on the product without the work piece being adequately secured. Use clamps or a vice (not included) to secure the work piece. Available from your Sealey stockist.
10. DO NOT use the product outdoors.
11. DO NOT get the product wet or use in damp or wet locations or areas where there is condensation.
12. DO NOT clean the product with any solvents that may damage the paint surface or the protective coating.

INTRODUCTION

The Sealey modular racking system is finished with a heavy-duty textured powder coat to prevent against rusting. Simply choose your base, middle and top units and push together using nylon connectors to create versatile storage for the workshop, garage, home or office. All drawers have ball-bearing drawer slides for smooth operation and cupboard doors are fitted with spring loaded hinges allowing them to be fitted the side that suits your environment. Buy individually (see specific model number for full specs) or as one of our pre-created combo's.

SPECIFICATION

Model no:	APMRT3
Nett Weight:	5kg
Size (W x D x H):	580 x 340 x 444mm
Shelves:	1

CONTENTS

Item	Part	Description
1	APMRT3-01	Front Upright, Left
2	APMRT3-02	Front Upright, Right
3	APMRT2-02	Top Panel
4	APMRT3-04	Back Board
5	APMRM6-03	Support Bar
6	APMRBI-07	Plastic End Plug
7	MSP612.S	Machine Screw Pan Head Phillips M6 x 12mm
10	APMRTI-11	Sealey Badge
—	APMRBI-09	Self-Tapping Screw ST4.8 x 30mm (Not Shown)
—	APMRBI-10	Expansion Plug M8 x 40mm (Not Shown)

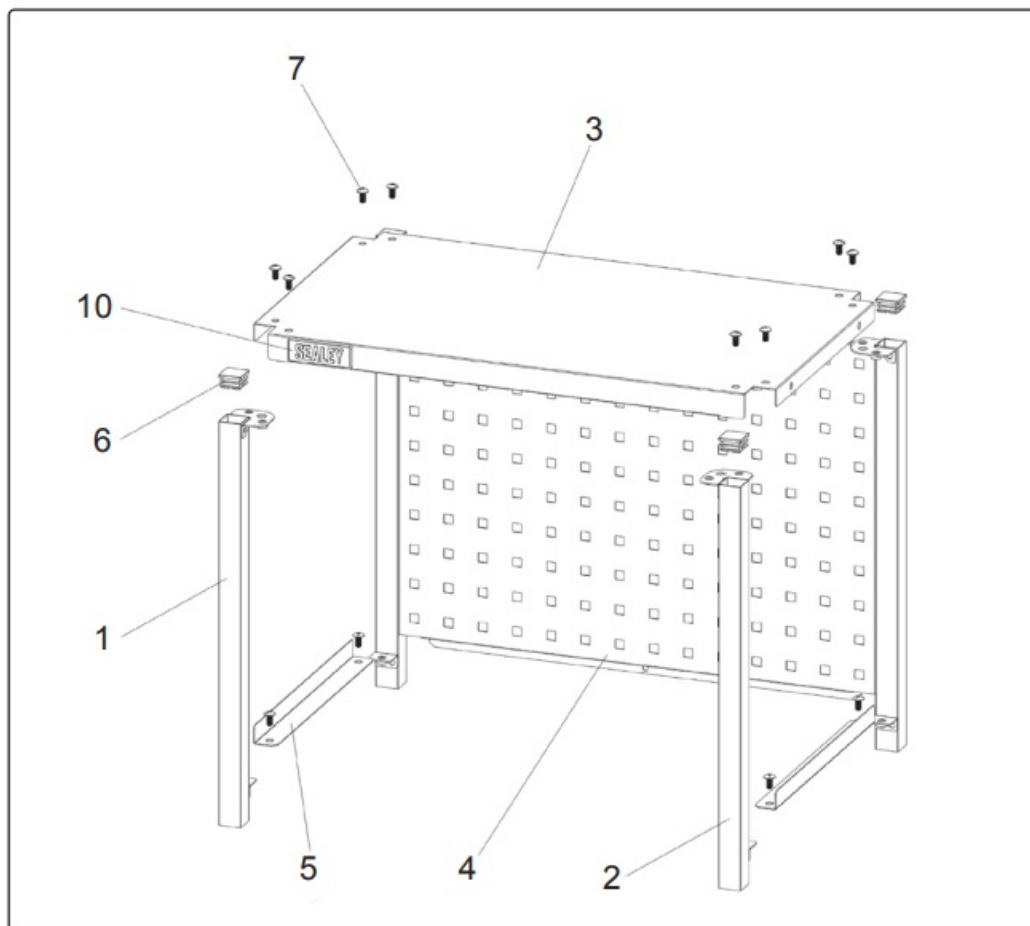

ASSEMBLY

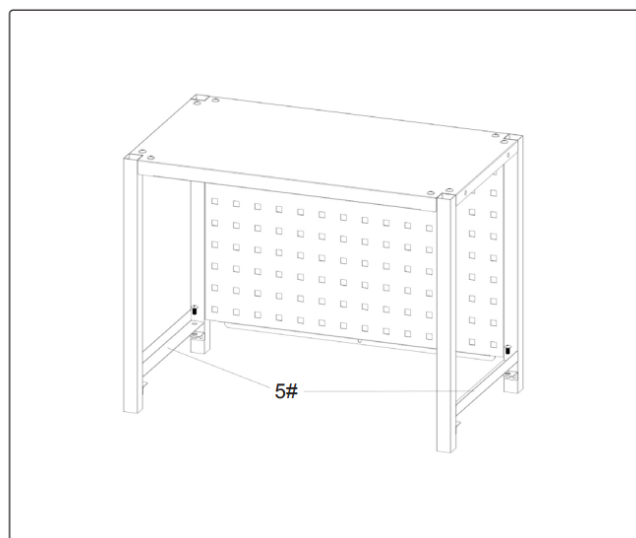
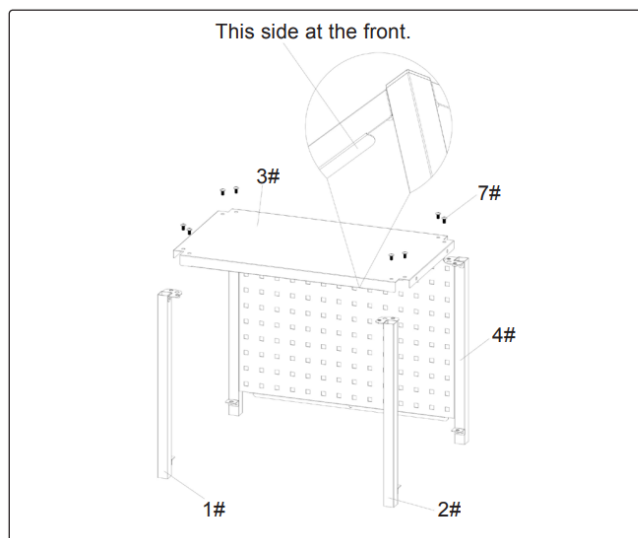

Step 1. Assemble the pegboard, uprights, top panel with screw M6*12 as shown. Note: That the top panel is in the right direction.

Step 2. Assemble the cross-bars with screws M6*12.

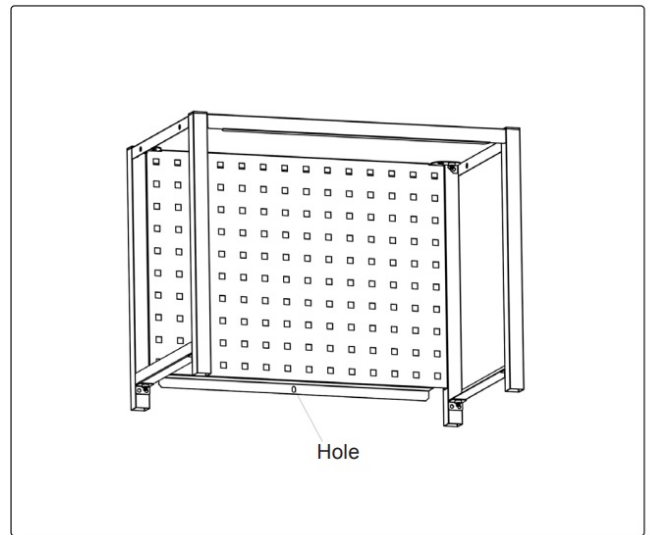
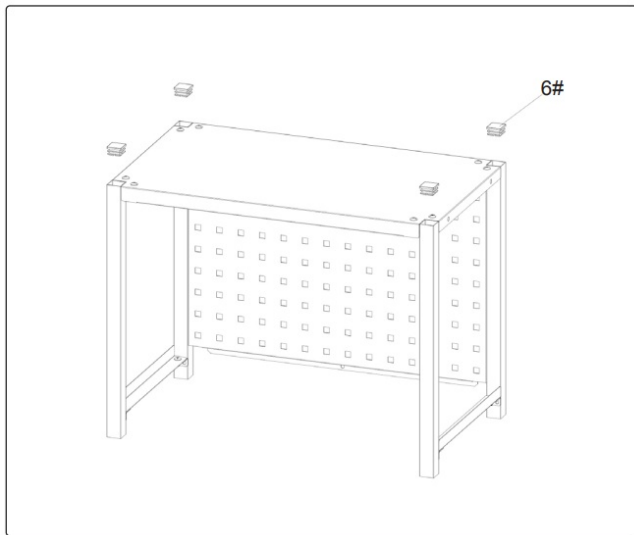

Step 3. Insert the plastic end plugs into the uprights.

Step 4. To fix on the wall, mark the wall according to the hole which is at the back of pegboard, after assembly.

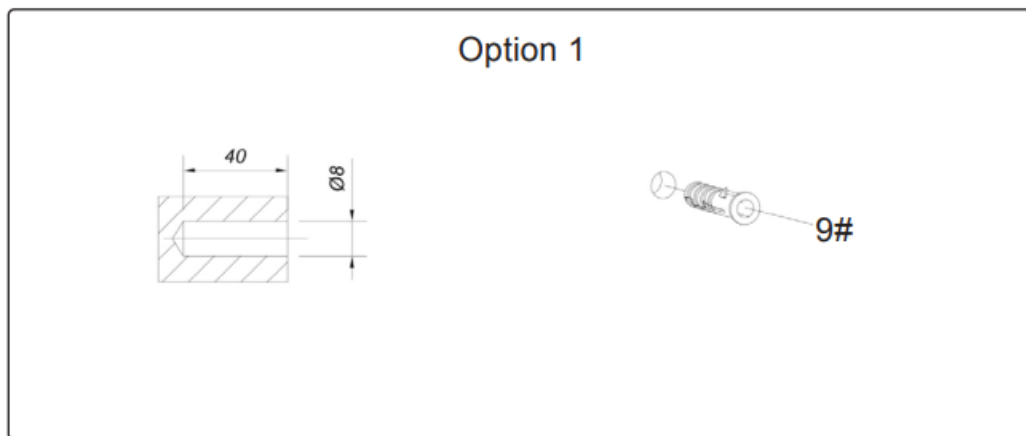

Step 5. To fix the cabinet on the wall. Mark the wall out before drilling the hole, after the wall has been marked out drill a hole the size required see above illustration, Insert the wall plug 8*40 into the drilled hole.

Option 1

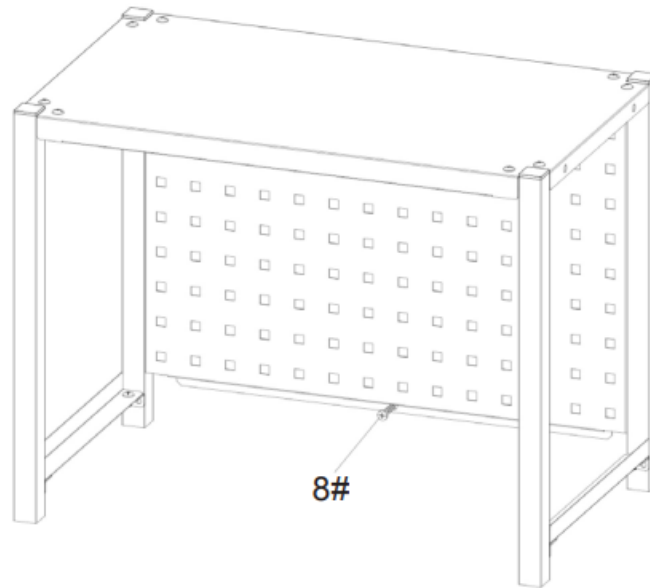

Fix the cabinet to the wall using the self-tapping screw ST4.8*30.

Option 2

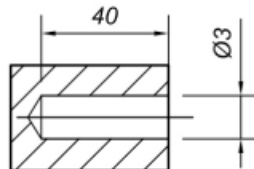

Step 6. To fix the cabinet on to a wooden wall. Mark the wall out before drilling. After the wall has been marked, drill a hole the correct size.

Option 2

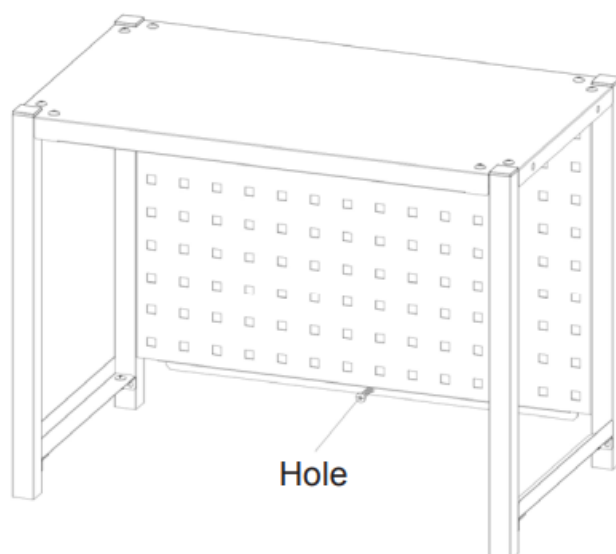

Fix the cabinet on the wooden wall with the self-tapping screw ST4.8*30, no wall plug is required.

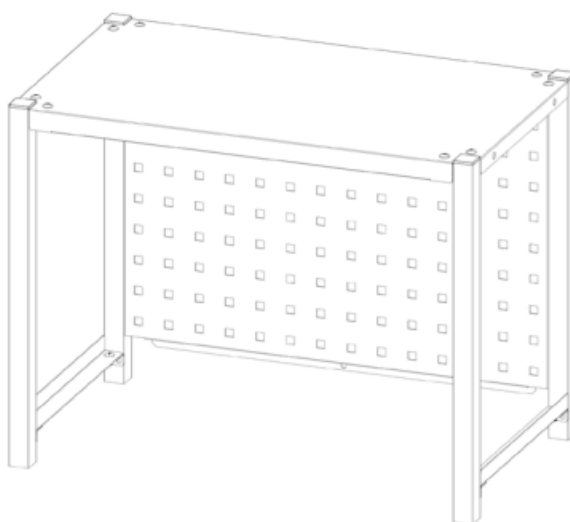

Step 7. Assembly completed.

ENVIRONMENT PROTECTION



Recycle unwanted materials instead of disposing of them as waste. All tools, accessories and packaging should be sorted, taken to a recycling centre and disposed of in a manner which is compatible with the environment. When the product becomes completely unserviceable and requires disposal, drain any fluids (if applicable) into approved containers and dispose of the product and fluids according to local regulations.



REGISTER YOUR
PURCHASE HERE

NOTE: It is our policy to continually improve products and as such we reserve the right to alter data, specifications and component parts without prior notice.

IMPORTANT: No Liability is accepted for incorrect use of this product.

WARRANTY: Guarantee is 12 months from purchase date, proof of which is required for any claim.

Sealey Group, Kempson Way, Suffolk Business Park, Bury St Edmunds, Suffolk. IP32 7AR

01284 757500

sales@sealey.co.uk

www.sealey.co.uk

Original Language Version

© Jack Sealey Limited

APMRT3 Issue 2 03/07/24

Documents / Resources

	<p>SEALEY APMRT3 Modular Racking Top 1 Shelf and Pegboard Unit 580mm [pdf]</p> <p>Installation Guide</p> <p>APMRT3 Modular Racking Top 1 Shelf and Pegboard Unit 580mm, APMRT3, Modular Racking Top 1 Shelf and Pegboard Unit 580mm, Racking Top 1 Shelf and Pegboard Unit 580mm, Pegboard Unit 580mm</p>
---	---

References

- [User Manual](#)

[Manuals+](#), [Privacy Policy](#)

This website is an independent publication and is neither affiliated with nor endorsed by any of the trademark owners. The "Bluetooth®" word mark and logos are registered trademarks owned by Bluetooth SIG, Inc. The "Wi-Fi®" word mark and logos are registered trademarks owned by the Wi-Fi Alliance. Any use of these marks on this website does not imply any affiliation with or endorsement.