



# Seagate 203651700B Lyve Mobile Mount Front Loader User Guide

[Home](#) » [Seagate](#) » Seagate 203651700B Lyve Mobile Mount Front Loader User Guide 

## Contents

- [1 Seagate 203651700B Lyve Mobile Mount Front Loader](#)
- [2 Product Information](#)
- [3 Product Usage Instructions](#)
- [4 Part List](#)
- [5 Setup Requirements](#)
- [6 Mounting slots](#)
- [7 Recommended clearance zones](#)
- [8 Connecting Lyve Mobile Mounts Vertically](#)
- [9 Installation](#)
- [10 Secure lock catch](#)
- [11 FCC DECLARATION OF CONFORMANCE](#)
- [12 Documents / Resources](#)
  - [12.1 References](#)
- [13 Related Posts](#)



**Seagate 203651700B Lyve Mobile Mount Front Loader**



## Product Information

The Lyve Mobile Mount is a device used to securely mount the Lyve Mobile Array in a vehicle. It comes with various screws and cable holder covers to assist with installation. It also has a lock bezel that can be secured with a padlock to prevent unauthorized access to the mounted device. The mount can be installed vertically or horizontally, depending on the user's preference.

## Product Usage Instructions

1. Begin by checking that the Lyve Mobile Mount is securely fixed to the vehicle before inserting any compatible devices.
2. To install the mount, insert M6-0.1 x L20 (10.0,6) socket cap screws into any of the M6 tap holes on the bottom of the mount. Use at least four screws to secure the mount (two at the front of the mount, and two at the back).
3. If you wish to stack two Lyve Mobile Mounts vertically, align the six attachment holes on the top and bottom of the mounts and use four M3-0.5 x L16 (5.8,1.0) screws to attach them together.
4. If you prefer to place two Lyve Mobile Mounts side-by-side horizontally, align the eight attachment holes on the sides of the mounts and use eight M3-0.5 x L7 (5.8,1.0) screws to attach them together.
5. If you are connecting a computer directly to Lyve Mobile Array's host port, you'll need to remove the guide pins. Use a 6mm hex key wrench to unscrew the guide pins from the bottom of Lyve Mobile Mount.
6. To route cables through the front of Lyve Mobile Mount, use the internal channel that runs the length of the mount. Five plastic cable holder covers are provided to secure the cables in the channel.
7. To install the device, release the handle on the front of Lyve Mobile Mount and lower the front lock bezel to open the mount. Insert the device with the ports facing the back of the mount, then slide the device towards the back of the mount. Raise the front lock bezel until it snaps in place to lock the device in place.
8. The front lock bezel and lock catch can be secured with a padlock to prevent unauthorized access to the mounted device.

## Part List

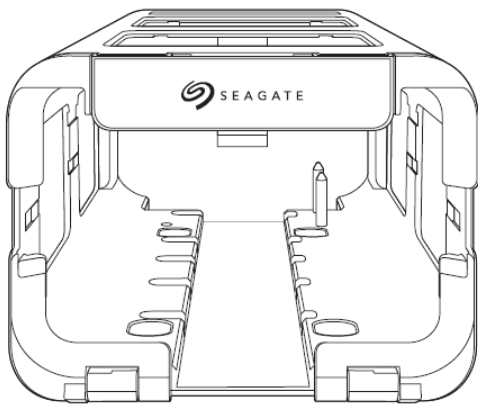

Lyve™ Mobile Mount



Shoulder screw  
8 mm x M6-1.0 x  
47+L13 (16.0,6.3) (x1)

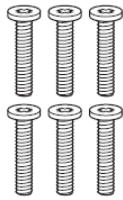

M3-0.5 x L16 (5.8,1.0),  
Phillips screw (6x)



M3-0.5 x L7 (5.8,1.0),  
Phillips screw (10x)

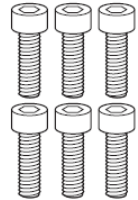

M6-0.1 x L20 (10.0,6),  
hex socket cap screw (6x)

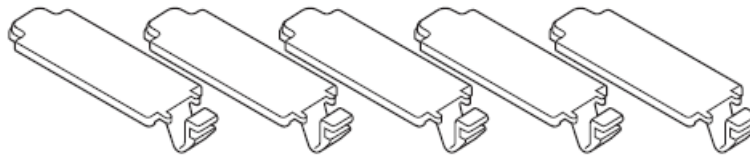

Cable holder cover (5x)

## Setup Requirements

### Lyve Mobile Security

Lyve Mobile offers two ways for project admins to manage how end users securely access Lyve Mobile storage devices:

- **Lyve Portal Identity**

End users authorize client computers to access Lyve Mobile devices using their Lyve Management Portal credentials. Requires an internet connection for initial setup and periodic reauthorization through Lyve Management Portal.

- **Lyve Token Security**

End users are provided with Lyve Token files that can be installed on certified client computers and Lyve Mobile Padlock devices. Once configured, computers/Padlock devices unlocking Lyve Mobile devices do not require continual access to Lyve Management Portal or the internet.

For details on setting up security, go to [www.seagate.com/lyve-security](http://www.seagate.com/lyve-security).

## Mounting slots

**Lifting hazard.** The following instructions include moving and installing heavy equipment. To avoid injury, always

use proper lifting techniques. Do not attempt to lift or assemble Lyve Mobile Mount with compatible devices inserted.

Before installing Lyve Mobile Array, ensure that Lyve Mobile Mount is securely fixed to the vehicle to avoid excessive motion. Attach Lyve Mobile Mount to the appropriate surface by inserting M6-0.1 x L20 (10.0,6) socket cap screws into any of the M6 tap holes on the bottom of the mount. Use at least four screws to secure the mount (two at the front of the mount, and two at the back).

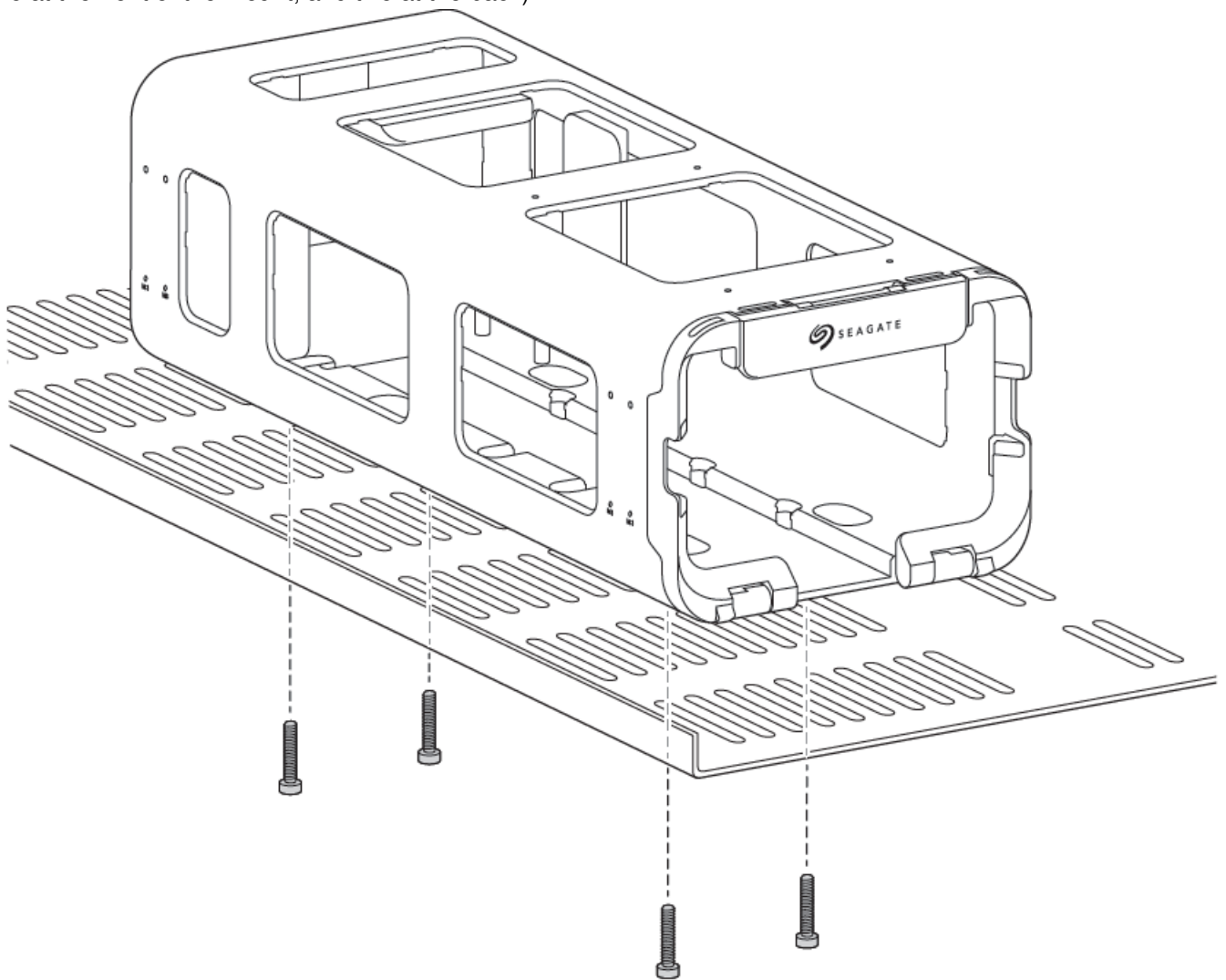

### Recommended clearance zones

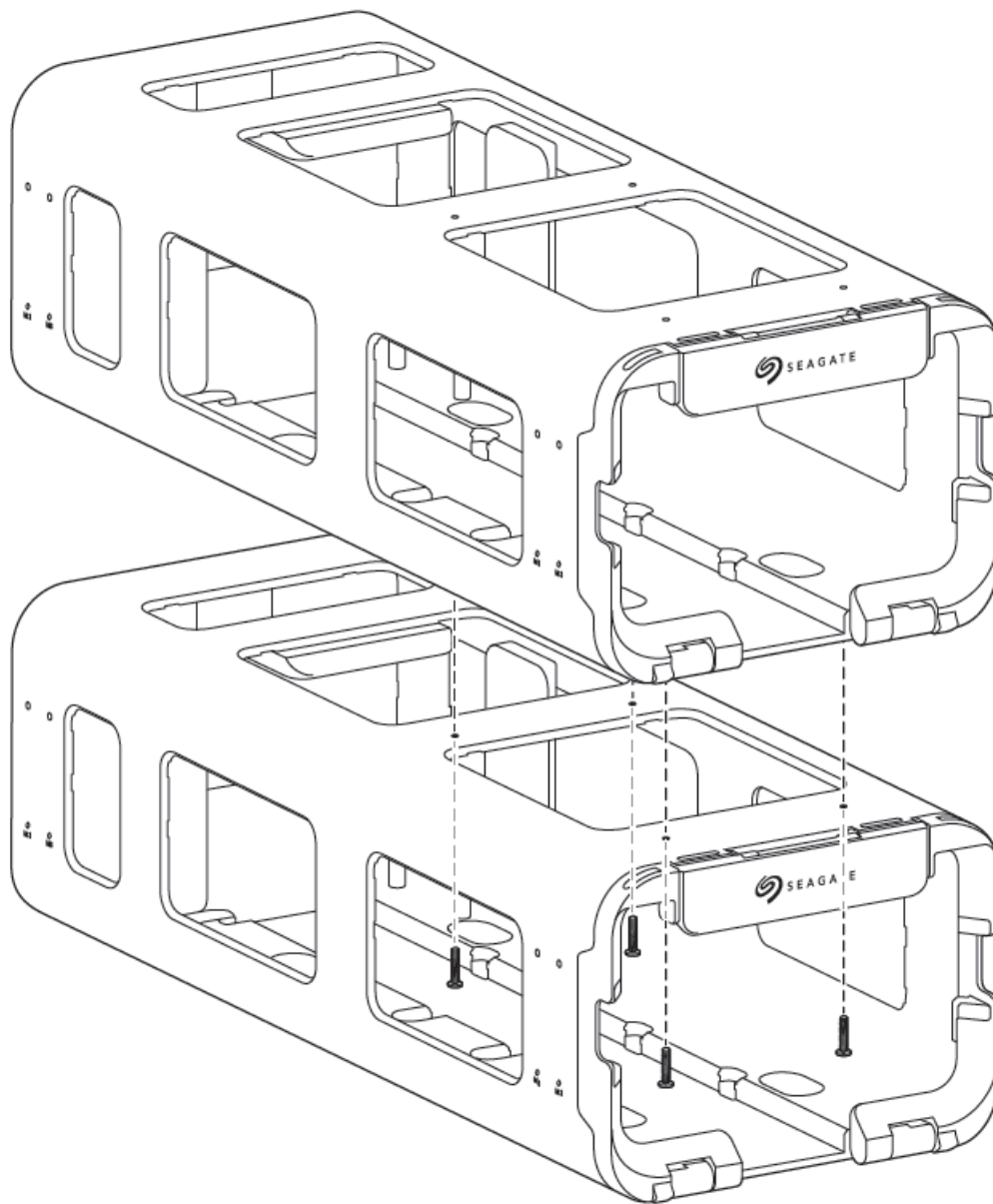

### **Connecting Lyve Mobile Mounts Vertically**

Stack two Lyve Mobile Mounts and align the six attachment holes on the top and bottom of the mounts. Use four M3-0.5 x L16 (5.8,1.0) screws to attach the two mounts.

### **Connecting Lyve Mobile Mounts Horizontally**

Place two Lyve Mobile Mounts side-by-side and align the eight attachment holes on the sides of the mounts. Use eight M3-0.5 x L7 (5.8,1.0) screws to attach the two mounts.

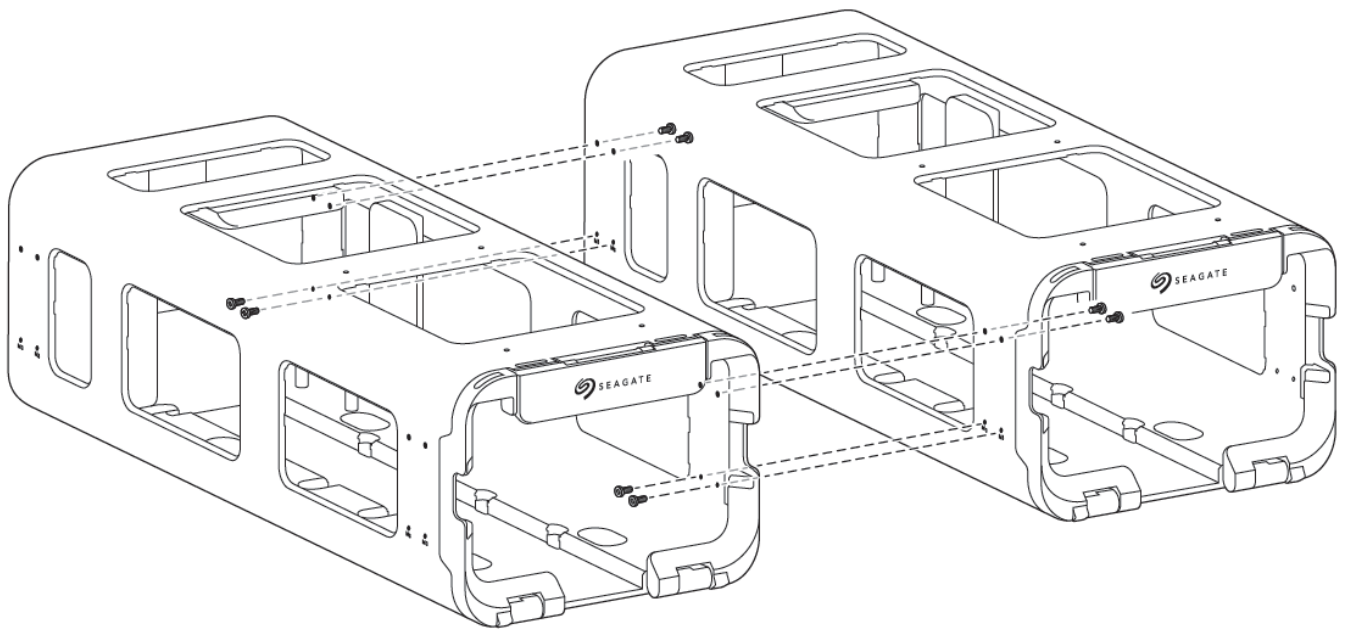

### **Remove guide pins**

Guide pins for use with a PCIe Adapter are preinstalled on Lyve Mobile Mount. If you are connecting a computer directly to Lyve Mobile Array's host port, you'll need to remove the guide pins. Use a 6mm hex key wrench to unscrew the guide pins from the bottom of Lyve Mobile Mount.

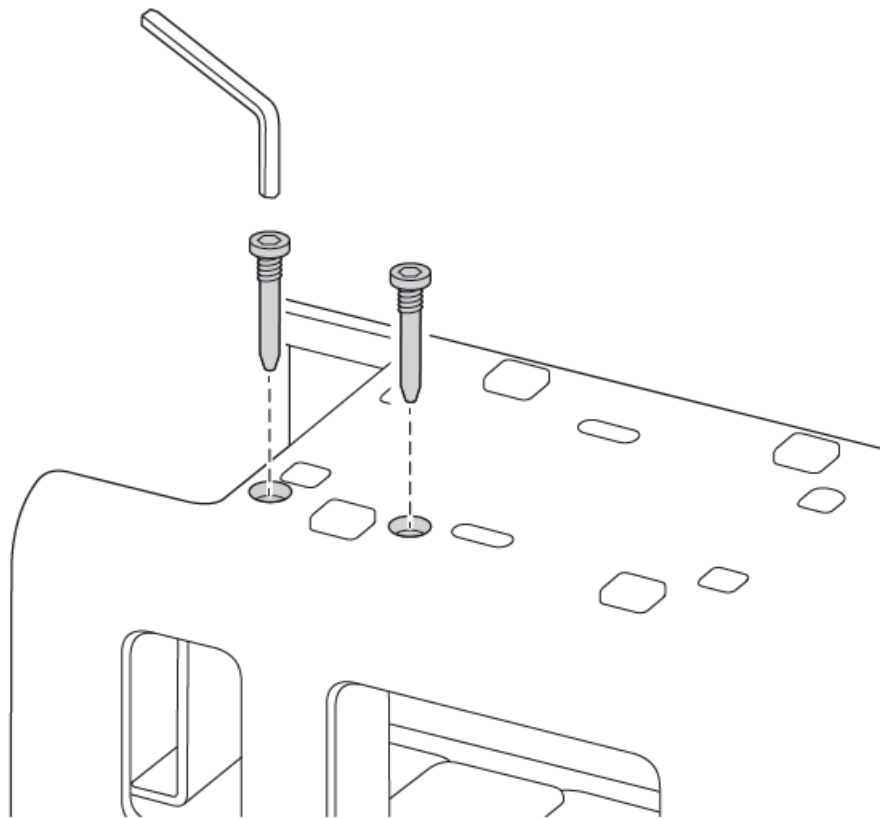

### **(Optional) Route cables through the front of Lyve Mobile Mount**

You can route cables through the front of Lyve Mobile Mount using the internal channel that runs the length of the mount. Five plastic cable holder covers are provided to secure the cables in the channel. To attach a cover, insert the rounded tab into a notch on the right side of the channel. Snap the hooked release tab into the corresponding slot on the left of the channel.

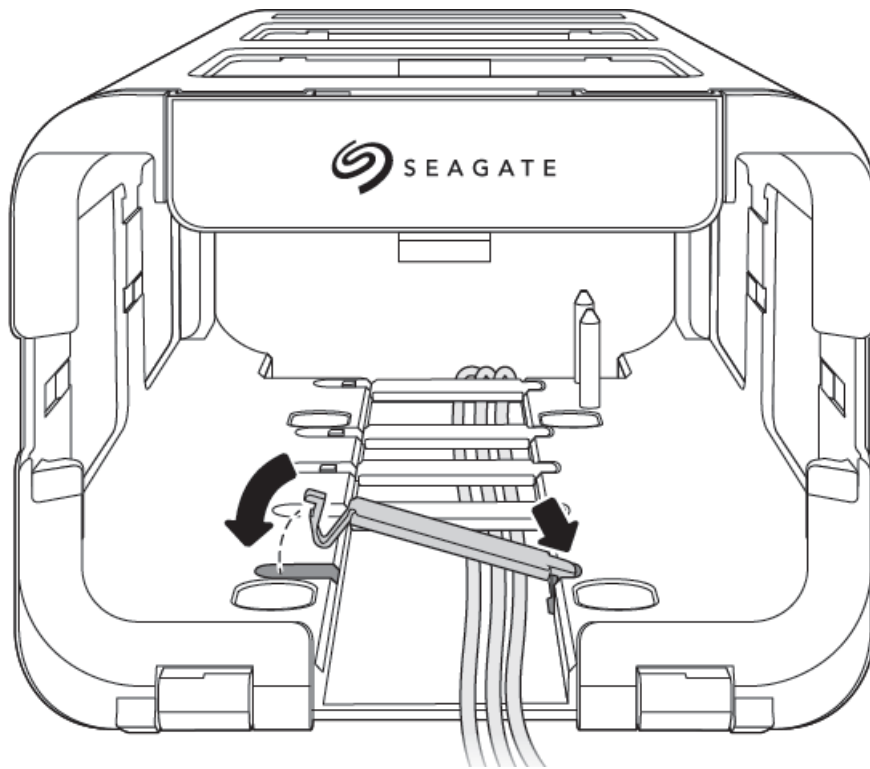

## Installation

### 1. Release handle

- **A** Grasp the lock catch on the front of Lyve Mobile Mount and pull it forward to release the front lock bezel.
- **B** Lower the front lock bezel to open Lyve Mobile Mount.

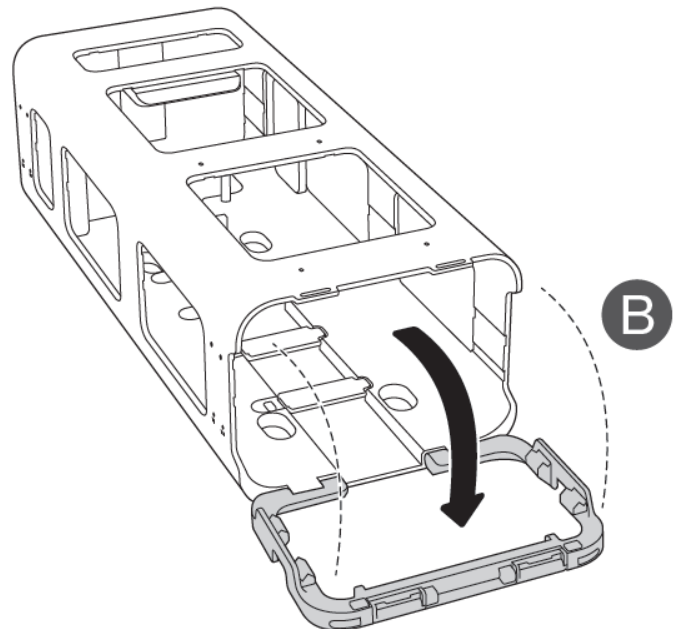
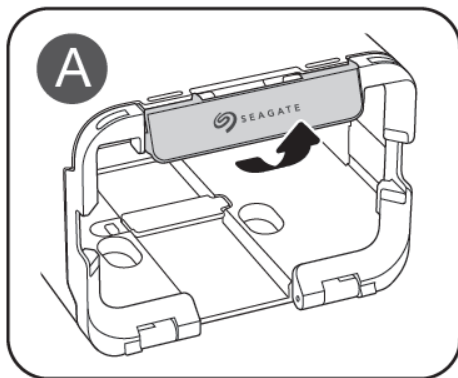

### 2. Insert device

Insert the device with the ports facing the back of Lyve Mobile Mount. Slide the device toward the back of the mount.



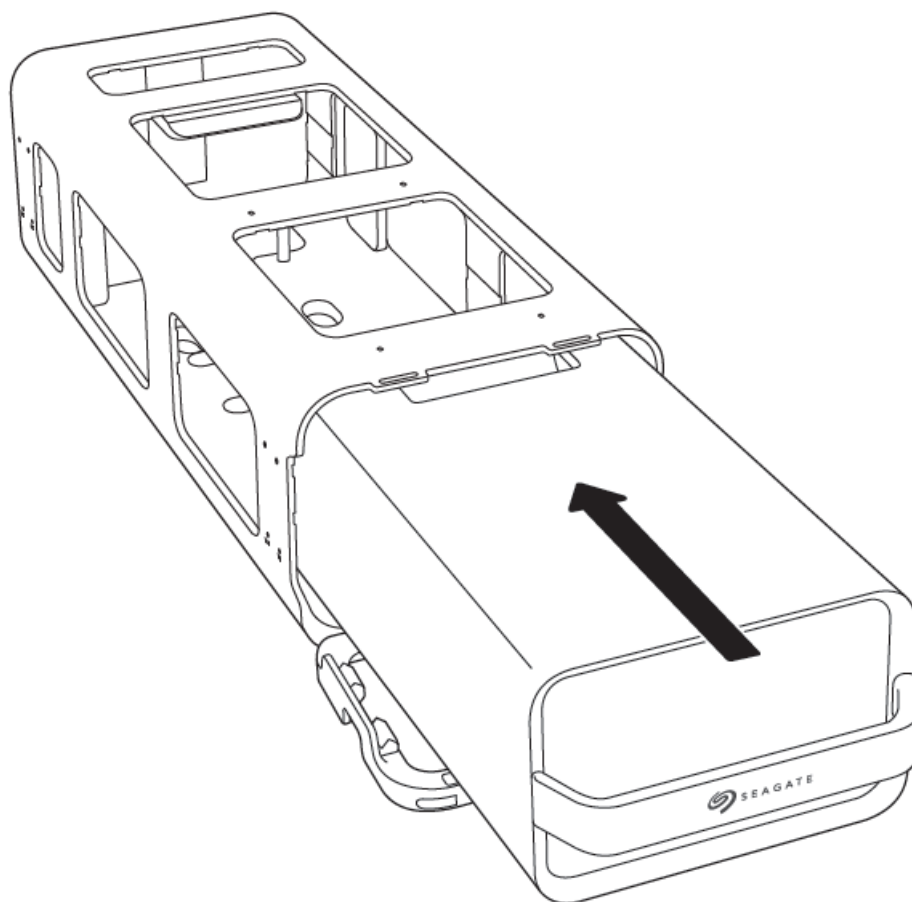

**Lifting hazard.** To avoid injury, use proper lifting techniques when removing Lyve Mobile Array from its packaging and installing it in Lyve Mobile Mount.

**Lyve Mobile Array weight:** 27.8 lb/12.6 kg

### 3. Lock device in place

Raise the front lock bezel until it snaps in place.

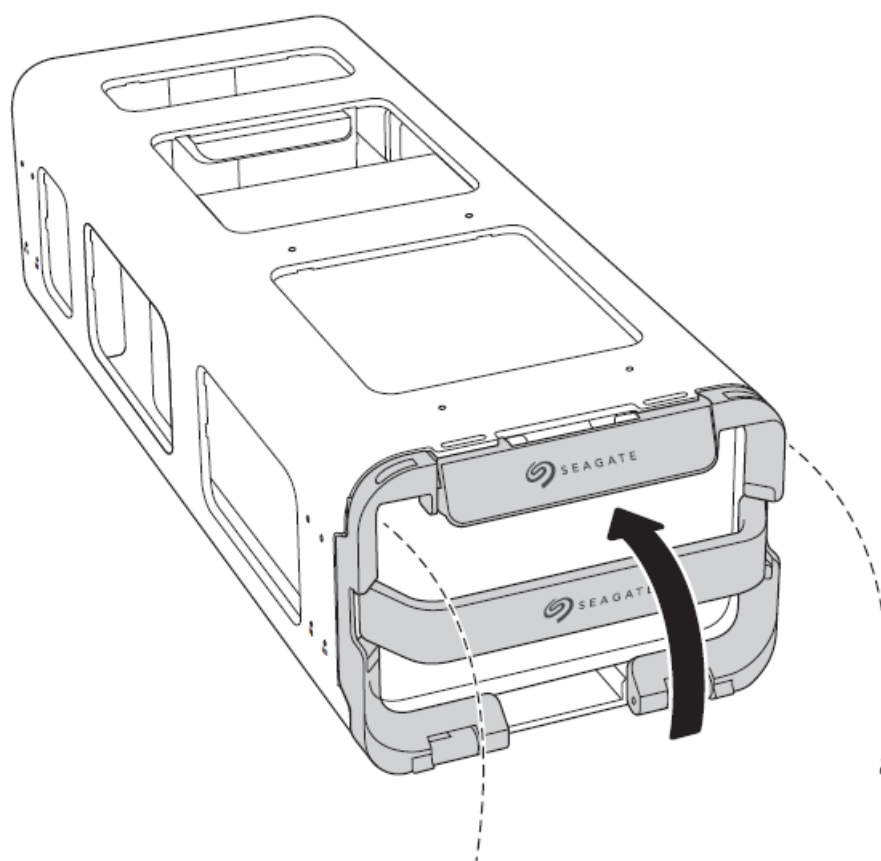



## Secure lock catch

The front lock bezel and lock catch can be secured with a padlock\*. Insert the padlock shackle through the openings to the right or left of the catch plate.

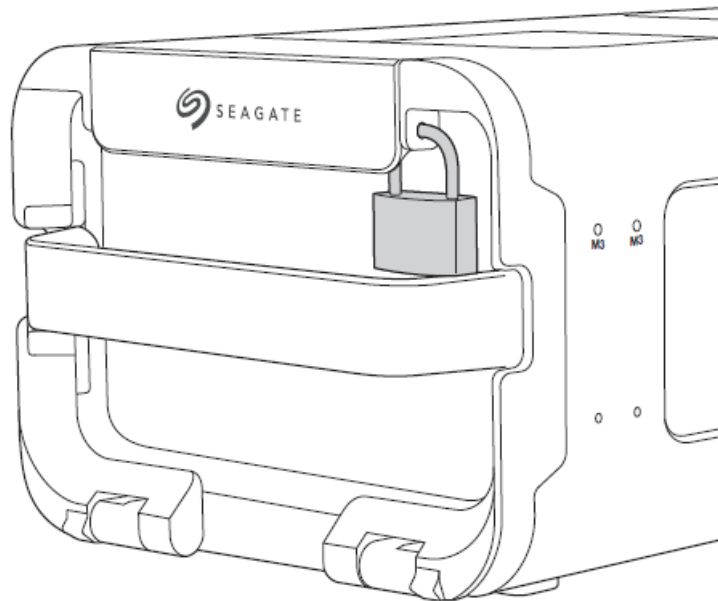

- [www.seagate.com/lyve-mount-manual](http://www.seagate.com/lyve-mount-manual)
- [www.seagate.com/support/mobile-mount](http://www.seagate.com/support/mobile-mount)

## FCC DECLARATION OF CONFORMANCE

This device complies with Part 15 of the FCC Rules. Operation is subject to the following two conditions: (1) this device may not cause harmful interference, and (2) this device must accept any interference received, including interference that may cause undesired operation.

**CLASS B** This equipment has been tested and found to comply with the limits for a Class B digital device, pursuant to Part 15 of the FCC Rules. These limits are designed to provide reasonable protection against harmful interference in residential installation. This equipment generates, uses, and can radiate radio frequency energy and, if not installed and used in accordance with the instructions, may cause harmful interference to radio communications. However, there is no guarantee that interference will not occur in a particular installation. If this equipment does cause harmful interference to radio or television reception, which can be determined by turning the equipment off and on, the user is encouraged to try to correct the interference by one or more of the following measures:

- Reorient or relocate the receiving antenna.
- Increase the separation between the equipment and receiver.
- Connect the equipment into an outlet on a circuit different from that to which the receiver is connected.
- Consult the dealer or an experienced radio/TV technician for help.

**CAUTION:** Any changes or modifications made to this equipment may void the user's authority to operate this equipment.

## China RoHS 2 table

China RoHS 2 refers to the Ministry of Industry and Information Technology Order No. 32, effective July 1, 2016, titled Management Methods for the Restriction of the Use of Hazardous Substances in Electrical and Electronic Products. To comply with China RoHS 2, we determined this product's Environmental Protection Use Period (EPUP) to be 20 years in accordance with the Marking for the Restricted Use of Hazardous Substances in Electronic and Electrical Products, SJT 11364-2014.

## Taiwan RoHS table

Taiwan RoHS refers to the Taiwan Bureau of Standards, Metrology and Inspection's (BSMI's) requirements in standard CNS 15663, Guidance to reduction of the restricted chemical substances in electrical and electronic equipment. Beginning on January 1, 2018, Seagate products must comply with the "Marking of presence" requirements in Section 5 of CNS 15663. This product is Taiwan RoHS compliant. The following table meets the Section 5 "Marking of presence" requirements.

© 2022 Seagate Technology LLC. All rights reserved. Seagate, Seagate Technology and the Spiral logo are registered trademarks of Seagate Technology LLC in the United States and/or other countries. Lyve is either a trademark or registered trademark of Seagate Technology LLC or one of its affiliated companies in the United States and/or other countries. The PCIe word mark and/or PCIExpress design mark are registered trademarks and/or service marks of PCI-SIG. All other trademarks or registered trademarks are the property of their respective owners. Complying with all applicable copyright laws is the responsibility of the user. Seagate reserves the right to change, without notice, product offerings or specifications.

Seagate Technology LLC., 47488 Kato Road, Fremont, CA 94538 USA [www.seagate.com](http://www.seagate.com).

Seagate Technology NL B.V., Tupolevlaan 105, 1119 PA Schiphol-Rijk NL

Seagate Technology NL B.V. (UK Branch), Jubilee House, Globe Park, 3rd Ave, Marlow SL7 1EY, UK

Seagate Singapore International Headquarters Pte. Ltd., 90 Woodlands Avenue 7 Singapore 737911

## Documents / Resources

 <p>Seagate LYVE Mobile Mount</p> <p>QUICK START GUIDE</p>	<p><a href="#">Seagate 203651700B Lyve Mobile Mount Front Loader</a> [pdf] User Guide</p> <p>203651700B Lyve Mobile Mount Front Loader, 203651700B, Lyve Mobile Mount Front Loader, Mount Front Loader, Front Loader</p>
--	--

## References

- [The Leader in Mass Data Storage Solutions | Seagate US](#)
- [Lyve Mobile Mount - Front Loader | Seagate US](#)
- [Lyve Mobile Security | Seagate US](#)
- [Mobile Mount | Support Seagate US](#)