



**19403 and
19404 Universal
Float Switch**



SEACHOICE 19403 and 19404 Universal Float Switch Instruction Manual

[Home](#) » [SEACHOICE](#) » SEACHOICE 19403 and 19404 Universal Float Switch Instruction Manual 

Contents

- [1 SEACHOICE 19403 and 19404 Universal Float Switch](#)
- [2 Product Usage Instructions](#)
- [3 SPECIFICATION](#)
- [4 Dimensions](#)
- [5 ASSEMBLY INSTRUCTION](#)
- [6 Wire Connection](#)
- [7 Documents / Resources](#)
 - [7.1 References](#)
- [8 Related Posts](#)



SEACHOICE 19403 and 19404 Universal Float Switch



Specifications:

- **Model:** 19403 & 19404
- **Voltage:** 12/24/32VDC for both models
- **Wire Size:** 18 Gauge (1.2 mm)
- **Wire Length Max:** 39 inches (1 meter)
- **Max Amps:**
 - 19403:
 - 15 A (12 V)
 - 7.5 A (24 V)
 - 5 A (32 V)
 - 19404:
 - 20 A (12 V)
 - 10 A (24 V)
 - 8 A (32 V)
- **Guard:** No guard for both models

Product Usage Instructions

Mounting and Installation:

All mounting holes must be sealed with a marine-grade sealant to prevent water intrusion. The switch must be mounted equal to or above the pump base for positive shut-off.

Wire Connections:

Keep all wire connections above the highest water level. Wires must be joined with connectors and a marine-grade sealant to prevent wire corrosion.

Fuse Installation:

Always install the proper size fuse to prevent damage. In case of a short circuit, failure to install the proper fuse could increase the risk of pump malfunction and potential personal injury or fire hazard.

Usage Precautions:

This unit is suitable for use with fresh water and saltwater only. Using it with any other hazardous, caustic, or corrosive material could result in damage to the pump, the environment, exposure to hazardous substances, and injury.

Testing the Float Switch:

Disconnect power from the system before working on the unit to avoid personal injury, damage to the environment, or damage to the unit.

Frequently Asked Questions (FAQ):

Q: Can this float switch be used with hazardous materials?

A: No, this float switch is designed for use with fresh water and saltwater only. Using it with hazardous materials could result in damage and hazards.

Q: What should I do if the pump malfunctions?

A: If the pump malfunctions, first disconnect power and check for proper fuse installation. Ensure all connections are secure and consult the user manual for troubleshooting steps.

SPECIFICATION

Model	Voltage	Wire Size	Wire Length	Max, Amps	Guard
19403	12/24/32VDC	18 Gauge (1.2 m m)	39" (1 m)	15 A (12 V) 7.5 A (24 V) 5 A (32 V)	No
19404	12/24/32VDC	18 Gauge (1.2 m m)	39" (1 m)	20 A (12 V) 10 A (24 V) 8 A (32 V)	No
	All mounting holes must be sealed with a marine grade sealant to prevent water intrusion.				

Dimensions

Model: 19403 & 19404

Dimensions in Inches (Millimeters)

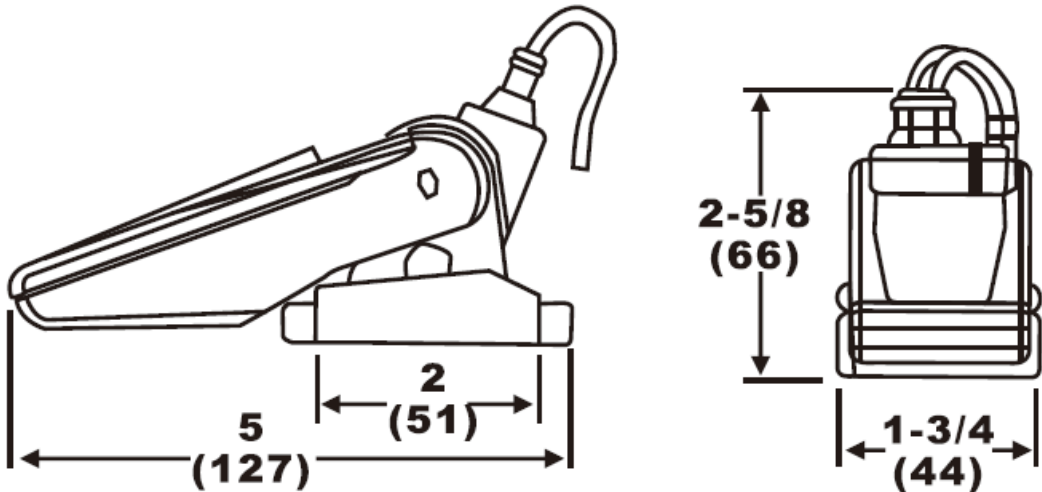

CAUTION

- Switch must be mounted equal to or above the pump base for positive shut-off.
- Keep all wire connections above the highest water level.

Wires must be joined with connectors and a marine grade sealant to prevent wire corrosion.

- Always install proper size fuse to prevent damage. Should a short occur, failure to install proper fuse could increase risk of pump malfunction and potentially result in personal injury and / or fire hazard.

ASSEMBLY INSTRUCTION

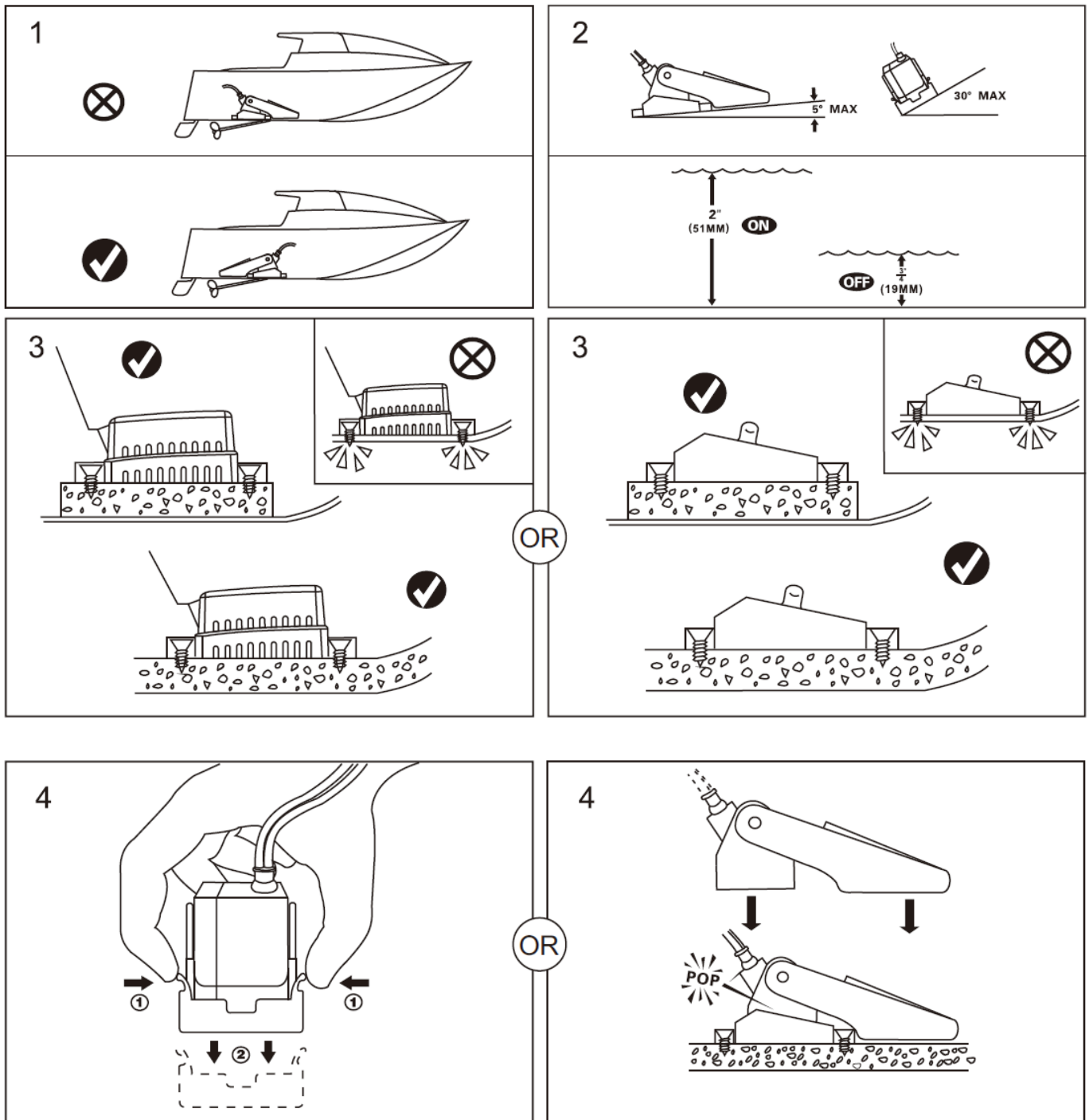

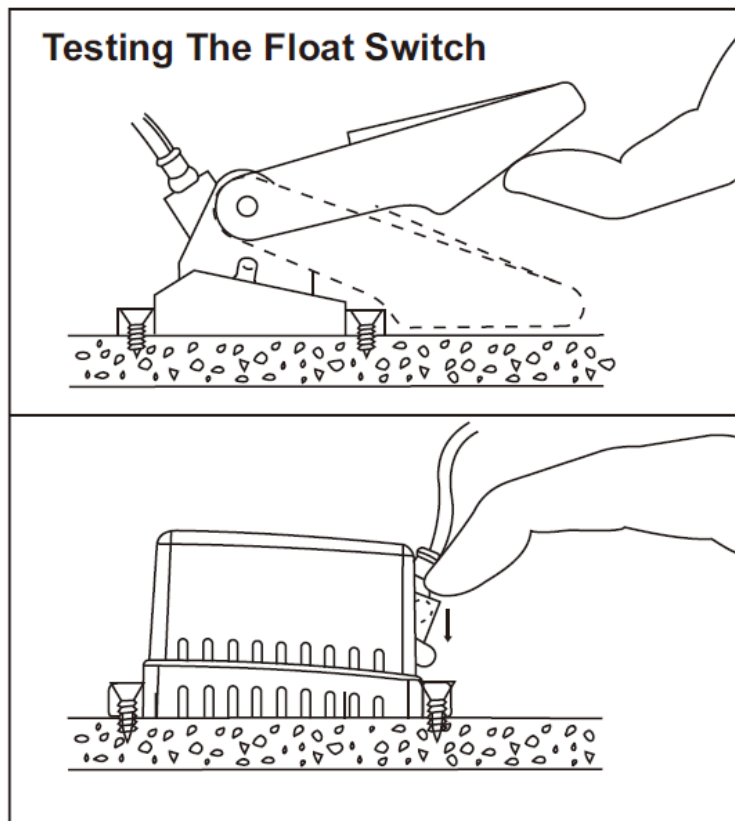

CAUTION

This unit is designed for fresh water and salt water ONLY. Using with any other hazardous, caustic, or corrosive material could result in damage to the pump and the surrounding environment, possibly exposure to hazardous substances and injury.



CAUTION

Disconnect power from the system before working on the unit to avoid personal injury, damage to the surrounding environment and/or damage to the unit.

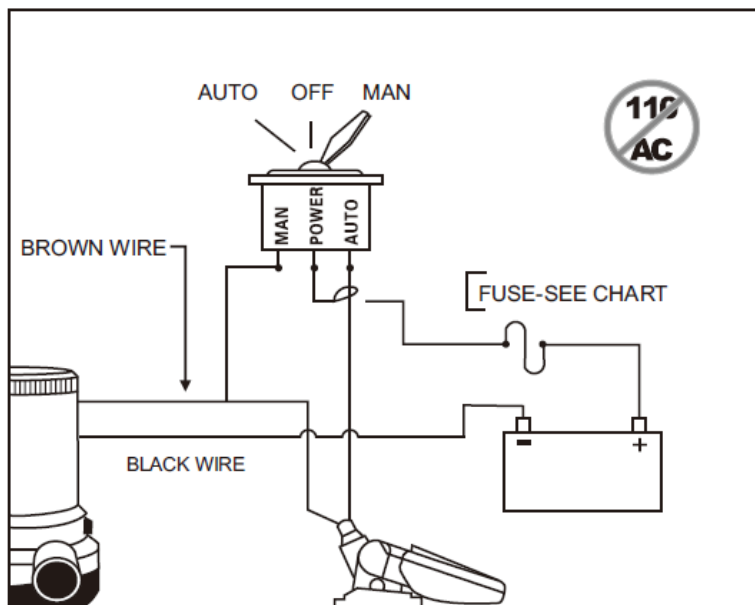

Wire Connection

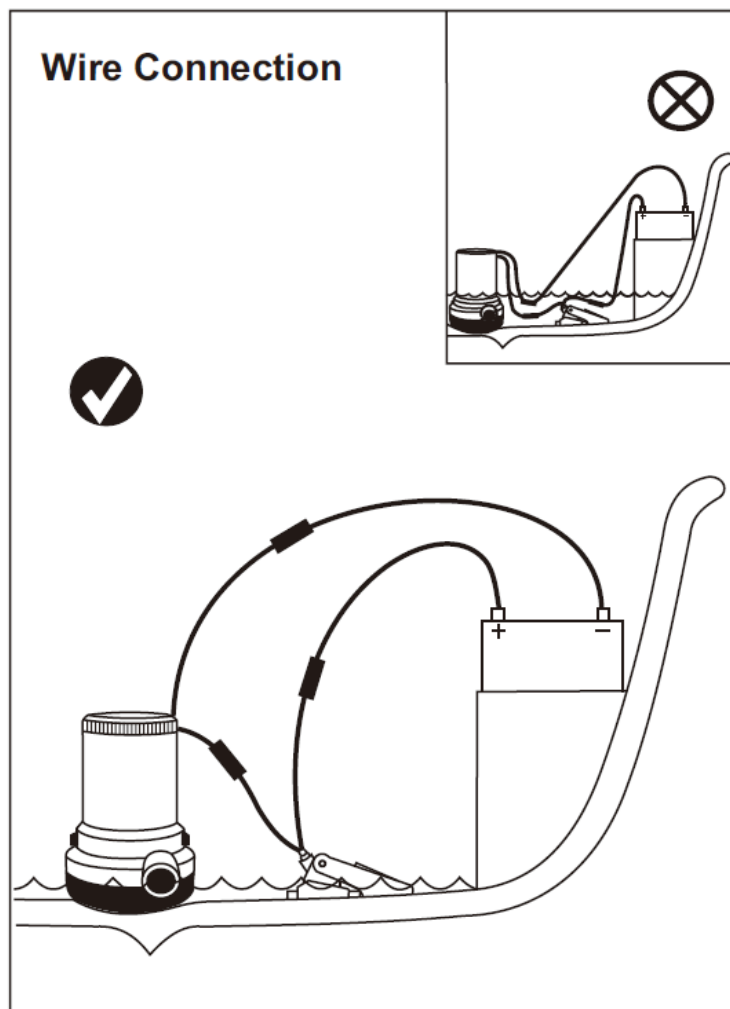

Documents / Resources



[SEACHOICE 19403 and 19404 Universal Float Switch](#) [pdf] Instruction Manual
19403 and 19404, 19403 and 19404 Universal Float Switch, Universal Float Switch, Float Switch, Switch

References

- [User Manual](#)

[Manuals+.](#) [Privacy Policy](#)

This website is an independent publication and is neither affiliated with nor endorsed by any of the trademark owners. The "Bluetooth®" word mark and logos are registered trademarks owned by Bluetooth SIG, Inc. The "Wi-Fi®" word mark and logos are registered trademarks owned by the Wi-Fi Alliance. Any use of these marks on this website does not imply any affiliation with or endorsement.