



SDC LR100 Series ADA Compliant Latch Retraction Exit User Guide

[Home](#) » [SDC](#) » SDC LR100 Series ADA Compliant Latch Retraction Exit User Guide 

Contents

- [1 SDC LR100 Series ADA Compliant Latch Retraction Exit](#)
- [2 Device Application](#)
- [3 Documents / Resources](#)
 - [3.1 References](#)
- [4 Related Posts](#)



SDC LR100 Series ADA Compliant Latch Retraction Exit



Device Application

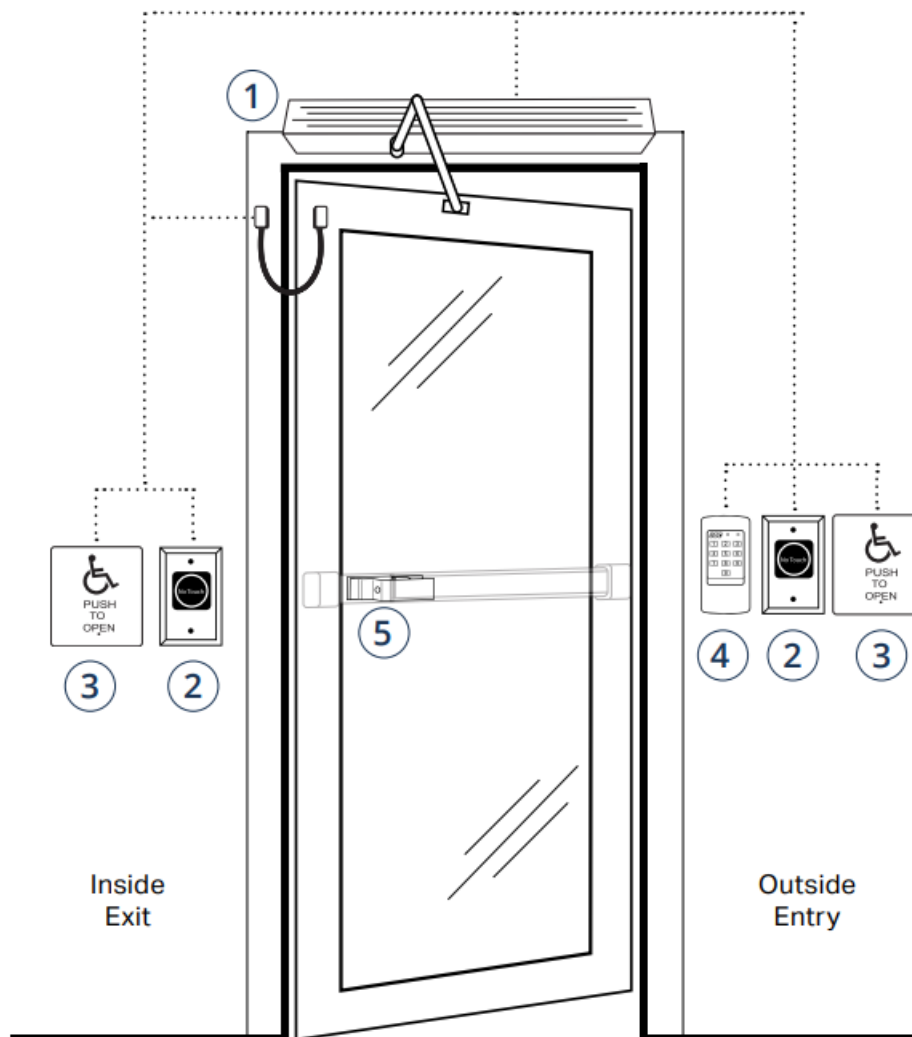

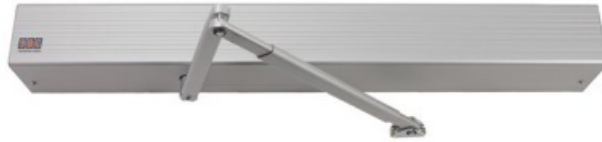

- Easy one-man installation
- Single button, self-tuning setup
- Built-in 1 Amp power supply
- On-board lock sequencing
- Hold open feature

470 Series

No Touch Switches



- WAVE-TO-OPEN
- IR sensing technology
- Wave activation up to 5"
- Illuminated dual LED sensor (red/green)

480 Series

ADA Actuators



- PUSH-TO-OPEN plates
- HDPE antimicrobial options
- Single or double gang
- Round and narrow options
- Recessed, surface, and bollard mounting



920 Series

Access Control Keypads

- Built-in prox readers
- Indoor/outdoor use
- Surface or single-gang mount
- Heavy cast vandal resistant housing

LR100 Series

Motorized ELR Retrofit Kits



- Motorized latch retraction and dogging
- Eliminates costly replacement of existing device
- Available for over 30 major brands

HANDS FREE DOOR SOLUTIONSTM

- Hands Free convenience
- Hands Free code compliance
- Hands Free hygiene and contamination control

Even with national ANSI and ADA standards, building code enforcement relating to automatic door and switch placement varies across the country. Consult your local authority having jurisdiction (AHJ) for compliance requirements.

Requires power transfer device such as our PT-3 LIT-FL-SF-HF_LR100_022522 [sdcsecurity.com](https://www.sdcsecurity.com) 800.413.8783 the lock behind the system

© 2022 Security Door Controls

Documents / Resources

	<p>SDC LR100 Series ADA Compliant Latch Retraction Exit [pdf] User Guide LR100 Series ADA Compliant Latch Retraction Exit, LR100 Series, ADA Compliant Latch Retraction Exit, Compliant Latch Retraction Exit, Latch Retraction Exit, Retraction Exit, Exit</p>
---	---

References

- [SDC Electric Strikes, Magnetic Locks, Electric Door Locksets](#)