



# SDB SR800 Wireless Transmitter User Guide

[Home](#) » [SDB](#) » SDB SR800 Wireless Transmitter User Guide 

## Contents

- [1 SDB SR800 Wireless Transmitter](#)
- [2 Overview](#)
- [3 Quick Start](#)
- [4 Specifications.](#)
- [5 Contact Us](#)
- [6 Documents / Resources](#)
- [7 Related Posts](#)

# SDB SR800

**SDB SR800 Wireless Transmitter**



## Overview

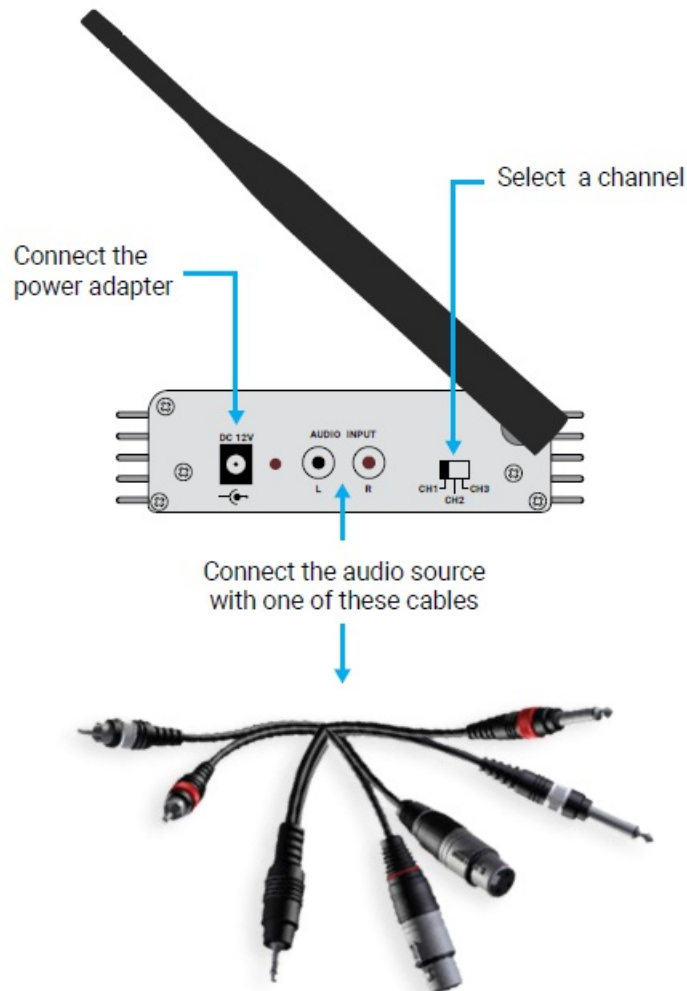

The SILENT DISCO BOX SR800 is specially designed for the SILENT DISCO BOX headphones. The transmitter has an external antenna which achieves an effective range of 50 meters. The basic design and straightforward controls are easy to use. The transmitter is equipped with a stereo input on a RCA connector. The transmitter can communicate on one to three channels, equal to the SILENT DISCO BOX wireless headphones.

## Quick Start

1. Connect the power adapter to the transmitter and the 230V power outlet.
2. When the power is connected the red LED indicator is illuminated. However, without an audio signal the transmitter will power off in 3 to 5 minutes.
3. Connect the audio source to the stereo RCA input. When there is no audio signal present the transmitter will power down after 3 to 5 minutes.
4. Match the channel switch to the headphones.

## Specifications.

- Wireless Stereo transmitter UHF/RF system FM modulation.
- Operating distance up to 50 meters.
- LED power/audio indicator.
- Frequencies; 863.100Mhz, 863.800Mhz, 864.950Mhz.
- Frequency response 30-20000 Hz
- Power supplied DC 12V 150mA.

- Signal to noise ratio >75dB.
- Channel separation >50dB.
- Distortion <1%

## Contact Us

**T:** 0031-(0)857326859

**E:** [info@silentdiscobox.com](mailto:info@silentdiscobox.com)

**Office:** De Hanze 14, 6049 HZ Herten (Netherlands)

**Warehouse:** De Hanze 14, 6049 HZ Herten (Netherlands)

[www.silentdiscobox.com](http://www.silentdiscobox.com)

## Documents / Resources



[SDB SR800 Wireless Transmitter](#) [pdf] User Guide  
SR800 Wireless Transmitter, SR800, Wireless Transmitter, Transmitter